

COBRA

Electric Blower Vac

BV2600



WARNING! Read all safety warnings and all instructions. Failure to follow the warnings and instructions may result in electric shock, fire and/or serious injury. Keep this manual safe.

Contents

- Know Your Product.....02
- Technical Specifications..... 02
- Description of Symbols..... 03
- Contents of Electric Blower Vac..... 03
- General Safety Instructions..... 04
- Additional Safety Instructions for Electric Blower Vac..... 07
- Assembly Instructions.....09
- Operation.....10
 - Turning On and Off10
 - Mode Selection.....11
 - Blowing Mode.....11
 - Vacuum Mode.....11
 - Tips For Using Your Electric Blower Vac..... 12
- Maintenance..... 13
- Warranty.....14

Know Your Product

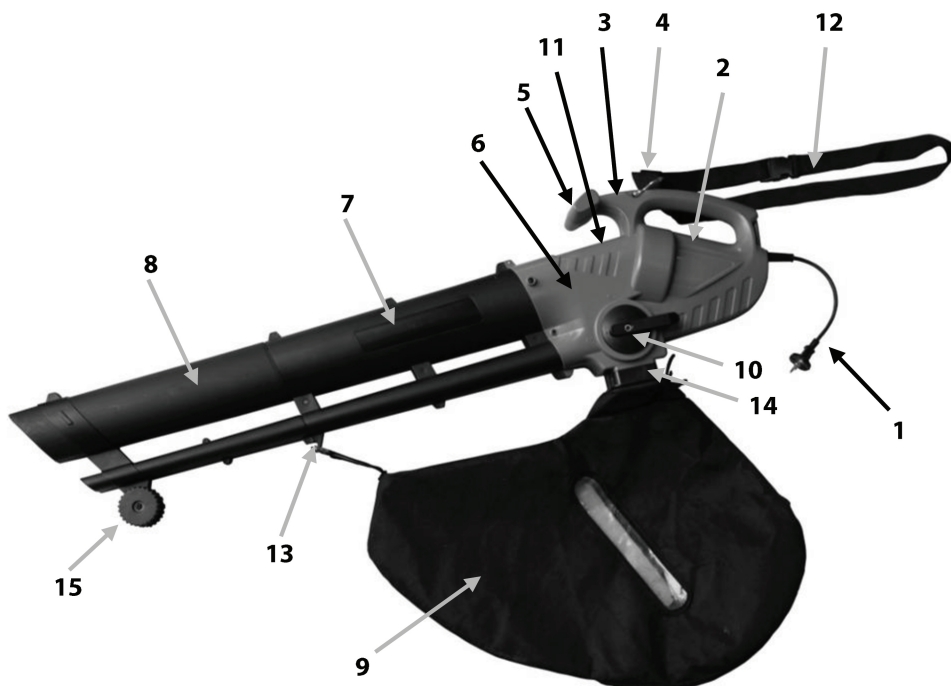

- 1. Electrical power lead
- 2. On/Off switch
- 3. Handle
- 4. Hook for shoulder strap
- 5. Handle assistant
- 6. Motor housing
- 7. Upper blower tube
- 8. Lower blower tube

- 9. Waste collection bag
- 10. Mode selection knob
- 11. Speed control
- 12. Shoulder strap
- 13. Hook to attach waste collection bag
- 14. Waste outlet
- 15. Nose wheels

Technical Specifications

| | |
|-----------------------------|-----------------------|
| Mains voltage / frequency : | 230V/50Hz |
| Rated power : | 2400 W |
| No-load speed : | 11000-15000/min |
| Wind velocity : | Up to 270 km/H |
| Wind volume : | 12m ³ /min |
| Waste collection bag : | 40 Litres |
| Mulch ratio : | 10 : 1 |

Description of symbols

The rating plate on your tool may show symbols. These represent important information about the product or instructions on its use.



Read and understand instruction manual before using this product.



Do not use in wet weather.



Wear hearing protection.
Wear eye protection.
Wear breathing protection.



Disconnect and discontinue use if the power cord is damaged.



Switch off and remove plug before undertaking any adjustments, cleaning or maintenance work.



Denotes risk of personal injury, loss of life or damage to the tool in case of non-observance of the instructions in this manual.



Keep hands out of the openings while the tool is running



Z1096

Conforms to relevant standards for electromagnetic compatibility.



Class II tool.



Keep bystanders away.



Be aware of people around you and do not direct towards them.

Contents of Electric Garden Blower Vac carton

- 1 x Unit
- 1 x Blower tube
- 1 x Waste collection bag
- 1 x Instruction manual

General Safety Instructions



WARNING! Read all instructions. Failure to follow all instructions listed below may result in electric shock, fire and/or serious injury. The term "power tool" in all of the warnings listed below refers to your mains operated (corded) power tool or battery operated (cordless) power tool.

SAVE THESE INSTRUCTIONS

Work Area:

- **Keep work area clean and well lit.** Cluttered and dark areas invite accidents.
- **Do not operate power tools in explosive atmospheres, such as in the presence of flammable liquids, gases or dust.** Power tools create sparks which may ignite the dust or fumes.
- **Keep children and bystanders away while operating a power tool.** Distractions can cause you to lose control.

Electrical Safety:

- **Power tool plugs must match the outlet. Never modify the plug in any way.** Do not use any adapter plugs with earthed (grounded) power tools. Unmodified plugs and matching outlets will reduce the risk of electric shock.
- **Avoid body contact with earthed or grounded surfaces such as pipes, radiators, ranges and refrigerators.** There is an increased risk of electric shock if your body is earthed or grounded.
- **Do not expose power tools to rain or wet conditions.** Water entering a power tool will increase the risk of electric shock.
- **Do not abuse the cord. Never use the cord for carrying, pulling or unplugging the power tool. Keep cord away from heat, oil, sharp edges or moving parts.** Damaged or entangled cords increase the risk of electric shock.
- **Replacement of the supply cord.** If the supply cord is damaged, it must be replaced by an electrician or a power tool repairer.
- **When operating a power tool outdoors, use an extension cord suitable for outdoor use.** Use of a cord suitable for outdoor use reduces the risk of electric shock.
- **If operating a power tool in a damp location is unavoidable, use a residual current device (RCD) protected supply.** Use of an RCD reduces the risk of electric shock.
- **Have your tool repaired by an authorised service dealer.** This power tool complies with relevant safety requirements. To avoid danger, electrical appliances must only be repaired by qualified personnel using original spare parts; otherwise this may result in considerable damage to the user.

General Safety Instructions (Cont.)

Personal Safety:

- **Stay alert, watch what you are doing and use common sense when operating a power tool. Do not use a power tool while you are tired or under the influence of drugs, alcohol or medication.** A moment of inattention while operating power tools may result in serious personal injury.
- **Use safety equipment. Always wear eye protection.** Safety equipment such as dust mask, non-skid safety shoes, hard hat, or hearing protection used whenever conditions require will reduce personal injuries.
- **Avoid accidental starting. Ensure the switch is in the 'off' position before plugging in.** Carrying power tools with your finger on the switch or plugging in power tools that have the switch on invites accidents.
- **Remove any adjusting key or wrench before turning the power tool on.** A wrench or key left attached to a rotating part of the power tool may result in personal injury.
- **Do not overreach. Keep proper footing and balance at all times.** This enables better control of the power tool in unexpected situations.
- **Dress properly. Do not wear loose clothing or jewelry. Keep your hair, clothing and gloves away from moving parts.** Loose clothes, jewelry or long hair can be caught in moving parts.
- **If devices are provided for the connection of dust extraction and collection facilities, ensure these are connected and properly used.** Use of these devices can reduce dust related hazards.

Power Tool Use and Care:

- **Do not force the power tool. Use the correct power tool for your application.** The correct power tool will do the job better and safer at the rate for which it was designed.
- **Do not use the power tool if the switch does not turn it on and off.** Any power tool that cannot be controlled with the switch is dangerous and must be repaired.
- **Disconnect the plug from the power source before making any adjustments, changing accessories, or storing power tools.** Such preventive safety measures reduce the risk of starting the power tool accidentally.
- **Store idle power tools out of the reach of children and do not allow persons unfamiliar with the power tool or these instructions to operate the power tool.** Power tools are dangerous in the hands of untrained users.

General Safety Instructions (Cont.)

Power Tool Use and Care (Cont.):

- **Maintain power tools. Check for misalignment or sticking of moving parts, breakage of parts and any other condition that may affect the power tool's operation.** If damaged, have the power tool repaired before use. Many accidents are caused by poorly maintained power tools.
- **Keep cutting tools sharp and clean.** Properly maintained cutting tools with sharp cutting edges are less likely to stick and are easier to control.
- **Use the power tool, accessories and tool bits etc. in accordance with these instructions and in the manner intended for the particular type of power tool, taking into account the working conditions and the work to be performed.** Use of the power tool for operations different from intended use could lead to a hazardous situation.

Service:

- **Have your power tool serviced by an authorised repair person using only identical replacement parts.** This will ensure that the safety of the power tool is maintained.

Additional Safety Instructions for Electric Garden Blower Vac

- Always wear adequate protective clothing when operating the tool to avoid injuries to face, eyes, hands, feet, head or hearing. Use safety glasses or a face shield, high boots or sturdy shoes, longtrousers, work gloves, a hard hat and ear defenders.
- Do not start the tool when it is upside down or when it is not in the operating position.
- Switch the motor off and remove the plug when the tool is not being used, left unattended, being cleaned, being moved from one place to another or when the extension cord is entangled or damaged.
- Do not operate the tool near people, especially children or pets. Turn it off if they get too close. Maintain a safe distance of at least 5m from other people when using the tool.
- Never direct the blower direction nozzle towards bystanders or pets. Never blow debris in the direction of bystanders or pets. The operator is responsible for accidents or hazards occurring to other people or their property.
- Do not handle the plug or the tool with wet hands and do not use the tool in the rain.
- Use only outdoor rated extension leads that are so marked. Keep the extension cord away from heat, oil and sharp edges.
- Ensure that the extension lead is secured in a manner that prevents it from disconnecting from the plug whilst in use.
- Keep all the air intakes and the blower tube free of dust, lint hair and other material that may cause a reduction in airflow.
- Keep a balanced and stable stance while using the tool. Do not switch on the tool in enclosed or poorly ventilated spaces or in the presence of inflammable and/or explosive substances such as liquids, gasses and powders.
- Do not get distracted and always concentrate on what you are doing. Use common sense. Never operate the tool when you are tired, sick or under the influence of alcohol or other drugs.
- Do not operate this appliance with long loose hair or loose fitting jewellery. Tie long loose hair back and remove loose fitting jewelry.
- Only operate the tool during broad daylight or with adequate artificial light.
- When the tool is not in use, store it in a dry place and out of reach of children.
- Only use the tool according to the instructions given in this manual.
- Check regularly that the screws are tight.
- Do not allow the blower vac to pick up any burning or smoldering materials like ashes, cigarette butt etc.

Additional Safety Instructions for Electric Garden Blower Vac (Cont.)

- Do not attempt to pick up breakable objects like glass, plastics, china, etc.
- Do not use in vacuum operation without the waste collection bag fitted.
- Do not use the blower vac in either the vacuum or the blow position on gravel surfaces.

Assembly Instructions

- The suction/blowing pipes must be assembled before the machine is used. (Fig.1)
- Fit guiding grooves on the lower section of suction/blowing pipes into upper section.
- Push two sections firmly together until the clip in the moulding engages.

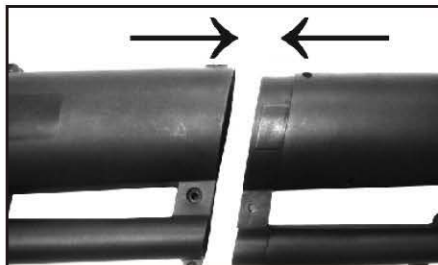

Fig. 1

- Fasten bolt and nut to place A where the suction/ blowing pipe cannot reach. The M6x35 bolt and nut are enclosed in the accessories (Fig. 2).
- Slide the suction/blowing pipe into motor housing

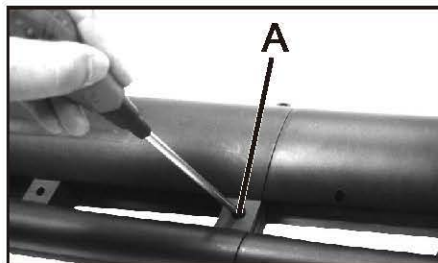

Fig. 2

- Secure screws on both sides of position A and B. The screws are enclosed in the accessories. (Two ST5x16 screws for position B, two ST4x16 screws for position A) Make sure the suction/blowing pipes are firmly closed with the housing (Fig. 3).

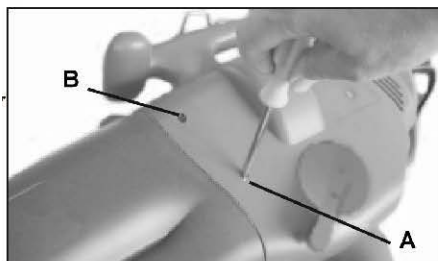

Fig. 3

- Attach the vacuum bag to the hook on the suction/ blowing pipes (Fig. 4).



Fig. 4

Assembly Instructions (Cont.)

- Insert the clip joint of the collection bag into the ejection pipe at the motor housing. (Fig. 5)

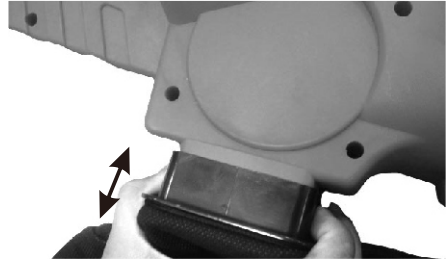

Fig. 5

Operation

Before starting the machine, make sure that the debris collection bag (9) is correctly fitted and the shoulder strap (12) is adjusted to a suitable working position.



Ensure the blower tubes are properly secured prior to operation.

Turning On and Off:

- **To Switch On:** Push the On/Off Switch (2) to the '1' on position.
- **To Switch Off:** Push the On/Off Switch (2) to the '0' off position.

Operation continued

Operation (Cont.)

Mode Selection:

Next to the mode selection knob are icons that indicate the blowing and vacuum settings.

- **Blowing Mode:** Rotate the mode selection knob (10) so that the arrow of the knob points to the "blowing" icon (Fig.1). Ensure that when the knob is rotated it clicks into place.
- **Vacuum Mode:** Rotate the mode selection knob (10) so that the arrow of the knob points to the "vacuuming" icon (Fig.2). Ensure that when the knob is rotated it clicks into place.

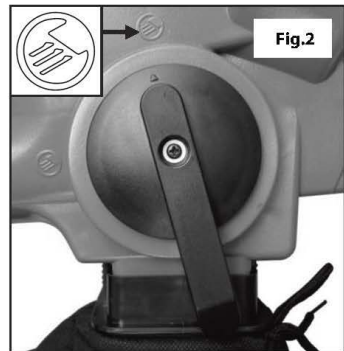
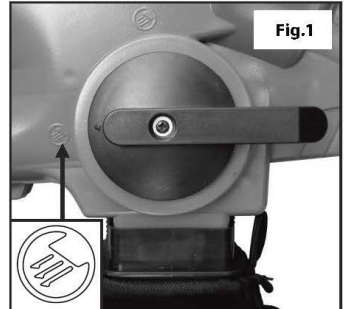

Blowing Mode:

The blowing mode is ideal for blowing leaves, grass clippings and other debris from courtyards, driveways, decks, car parks, verandahs and footpaths. Be careful where you direct the jet of air as it could move heavy material and cause possible injury or property damage.

Vacuum Mode:

When using the vacuum mode ensure the collection bag is properly fitted.

Switch the machine on. Hold the machine, tilting the Blower/Suction tube slightly, and use a sweeping action to collect light debris with approximately 5cm distance between the opening of the Blower/Suction tube and the floor or ground to be cleaned up (refer to Fig.3). The leaves will be sucked up into the tube, chopped up and thrown into the collection bag

Operation (Cont.)

Vacuum Mode (Cont.):

When the collection bag is full, the vacuum power will be greatly reduced. When this happens, turn the switch to the position "0" (off):

- Turn the switch to the position "0" (off)
- Disconnect the plug from the power supply
- Open the zip fastener of the collection bag. Spread out the opening and empty the bag of its contents. If you have collected only leaves or vegetable matter, they will already have been shredded and will be ready for composting.
- Zip up the waste collection bag and resume work.

NOTE: Before re-fitting the bag, first ensure the machine is disconnected from the power supply then clean the inside of the exhaust opening, removing any shredded deposits. Pay special attention to the cleaning of supporting edges of the air flow deviator on the inside of the tube.

Tips for using your Electric Garden Blower Vac:

The following points may assist you in the operation of the blower vac:

- Always try and vacuum dry leave, cuttings or general garden debris.
- Wet material is difficult to mulch and also can cause the blower vac to clog.
- If the leaves or branches are damp, then use the blower vac in blow selection to pile the leaves and branches into one area, then vac and mulch the leaves and branches when dry.
- Avoid using the vac on areas where there are stones or other hard objects. These objects will damage the impellor of the blower vac and thereby void the warranty.
- It is also advisable not to allow the blower vac to pick up soil. Soil generally contains moisture and when combined with other garden debris can clog the blower vac.
- The blower vac is not a garbage disposal unit. Do not attempt to mulch any material than general garden debris.
- For better performance and comfort, it is recommended the collection bag is emptied when it becomes approximately half full. This reduces the weight and also allows the vac operation to perform at its highest level.

Maintenance

- Place switch in "0" off position and unplug from the power supply before the blower vac is serviced, cleaned or maintenance is performed.
- Keep air intake clean and air vents free of debris to avoid overheating the motor.
- Do not use cleaning agents to clean the plastic parts of the tool. A mild detergent on a damp cloth is recommended. Water must never come into contact with the tool.
- If the blower vac vibrates abnormally, stop motor immediately. Abnormal vibration usually indicates a mechanical problem present and continued operation could lead to injury or damage.
- This tool is designed for consumer use only. Use in commercial or industrial environments will void the warranty.

Guarantee Policy

Thank you for choosing a Cobra Blower Vac. In order to get maximum benefit from your new purchase, please be aware of the warranty provisions outlined in this document.

Your Electric Blower Vacuum is guaranteed for a period of 12 months from the original date of purchase. As the product is intended exclusively for home consumer use, thus use of this product for professional, industrial or high frequency use will **VOID** this warranty. If your product is defective, it will be repaired or replaced in accordance with the terms of this warranty.

The warranty is provided by Cobra Garden part of Henton and Chattell Ltd.

Rights and Remedies

We are dedicated to delivering a quality product to all our customers. All of our products are warranted for 12 months from date of purchase against defects in material and workmanship.

If we determine that the product has a manufacturing fault, we will repair or replace it free of charge to you. The decision to repair or replace is solely at the discretion of Henton and Chattell Limited.

What do we require?

It is our requirement that all warranty claims are accompanied by a proof of purchase (sales receipt) to allow verification of the date of purchase. Where proof of purchase is not provided, Henton and Chattell Ltd. reserves the right to charge a service fee and/or charge for parts replaced/repaired. A return delivery charge may apply.

The warranty is 'return to base' and not a free in-home service. This means the customer is responsible for any inwards delivery charge to return the product to Henton and Chattell Ltd. or where the product was purchased from, for the warranty to be applicable.

Please retain your Proof of Purchase.

Only the original owner is covered by the manufacturer's warranty and must have purchased the product from an authorised Cobra dealer.

What is not covered under warranty?

- Professional, Industrial or high frequency use if the purpose of the tool is stated as consumer use in the instruction manual.
- If the tool has been operated on a supply voltage other than that specified on the tool.
- If the tool shows signs of damage or defects caused by or resulting from abuse, accidents or alterations.
- Failure to perform maintenance as set out within the instruction manual.
- If the tool is disassembled or tampered with in any way
- General wear and tear
- Servicing by an unauthorised service agent
- Any consumable parts

Exclusions

- Any consequential loss or damage to any person or property directly or indirectly as a result of using product.
- The Warranty is only valid in the country of purchase. If you file a warranty claim outside of the country of purchase you will be charged fees by the local provider.

9. Declaration of Conformity



We, the undersigned,

Cobra Garden, Henton and Chattell Ltd., London Road, Nottingham NG2 3HW UK

Declare that

The following devices are appropriate and consistent with the basic safety Health and EC directives (see point 3), based on their design and type, as circulated by us.

This declaration relates exclusively to the machinery in the state in which they were placed on the market and excludes added and / or components operations carried out subsequently by the end user.

1. Description / Function: Electric Blower Vacuum 2600W
2. Type: BV2600 (623306A)
3. EC directives:

2006/42/EC
2006/95/EC
2004/106/EC
2000/14/EC & 2005/88/EC

4. Harmonized standards:

EN 60335-1/A13 : 2008 IEC
60335-2-100 : 2002 EN
62233 : 2008
EN 55014-1 : 2006 EN
55014-2/A1 : 2001 EN
61000-3-2 : 2006 EN 6100-3-3/
A2 : 2005

5. Responsible for documentation : Peter J. Chaloner

Cobra Garden, Henton and Chattell Ltd., London Road, Nottingham NG2 3HW UK

Guaranteed sound power 101 dB(A)

Conformity assessment body :

TÜV SÜD Shanghai, No. 88 Heng Tong Road, Shanghai 200 070, P.R. China

Date: 2013-07-01

COBRA