

ferrano
KitchenExpress BG33

**USER
MANUAL**



CONTENTS

SAFETY PRECAUTIONS

2 - 4

PRODUCT PARTS

5

CLEANING INSTRUCTIONS

| | |
|-------------------------------|-------|
| How to Remove Each Part | 6 |
| How to Wash Each Part | 7 - 8 |

WHAT YOU CAN DO WITH THIS PRODUCT

9

HOW TO USE

| | |
|---|---------|
| Speed Dial/Safety Switch/Thermal Motor Protection | 10 |
| Blending | 11 - 13 |
| Grinding/Crushing | 14 - 15 |

RECOMMENDED PROCESSING SPEED & TIME

| | |
|--------------------------------------|----|
| Blending Juices and Milkshakes | 16 |
| Grinding/Crushing | 17 |

TROUBLESHOOTING

18 - 19

SPECIFICATIONS

20

SAFETY PRECAUTIONS

Please carefully read these safety precautions before using this product. This explains the instructions to be observed in order to prevent any injury to oneself or other persons using this product and to prevent damages to property arising from use of the product.

The extent of hazards or the damages arising from incorrect handling are preceded by the following symbols.

| | |
|---|--|
|  WARNING | <p>This includes the risks that can lead to death or serious injury.</p> |
|---|--|

| | |
|--|--|
|  CAUTION | <p>This includes the risks that can lead to minor injury and damage to property.</p> |
|--|--|

Instructions to be observed are preceded by the following symbols.

| | |
|---|---------------------------|
|  | <p>Be sure not to do.</p> |
|---|---------------------------|

| | |
|---|--|
|  | <p>Be sure to follow instructions.</p> |
|---|--|

|  WARNING | |
|--|---|
| GENERAL | <p>Only use this appliance for its intended domestic use and similar applications.</p> |
| | <p>This appliance is not intended for use by persons (including children) with reduced physical sensory or mental capabilities, or lack of experience and knowledge, unless they are being supervised or have been given instructions concerning use of the appliance by a person responsible for their safety.</p> |
| | <p>If the supply cord is damaged, it must be replaced by the manufacturer, its service agent or similarly qualified persons in order to avoid a hazard.</p> |
| | <p>Ensure that the appliance is switched off before removing the container from the main unit.</p> |
| | <p>Switch off the appliance and disconnect from power supply before changing accessories or touching parts that move while in use.</p> |
| | <p>Care should be taken when handling the sharp cutting blades, emptying the bowl and during cleaning.</p> |

SAFETY PRECAUTIONS



WARNING

| | | |
|---|--|--|
| TO PREVENT FIRE | | Do not scratch, pull, or tamper with the power supply plug or cord. |
| | | Do not exceed the rated value of socket or wiring device and do not exceed the alternate current (AC) of 230V. Do not overload an electrical circuit. |
| | | Do not wind the cord around main body or do not use the cord in a bundled state. |
| | | Wipe off dust accumulated on the power supply plug with a damp cloth. |
| Stop using the product immediately in case of any abnormality (e.g. burning smell, smoke, overheating of appliance body) and disconnect the power supply plug. Unplug the appliance when not in use. | | |
| TO PREVENT ELECTRIC SHOCKS AND INJURIES | | Do not handle power supply plug with wet hands. |
| | | Do not insert fingers into inlet of the cap or cover while product is in use. |
| | | Do not rinse main appliance body under the tap, or immerse it in water or any other fluid. |
| | | Do not use the appliance near fire or in places where it can come into contact with water. Do not use the appliance near flammable items such as carpet, vinyl, discolths, and towels. |
| | Do not disassemble or remodel the product. | |
| | If there is water on the power supply plug, wipe dry before inserting into power socket. | |

SAFETY PRECAUTIONS



CAUTION

| | | |
|---|--|--|
| TO PREVENT INJURY | | Do not operate product on unstable surfaces. |
| | | Do not move the product during operation. |
| | | Do not open the cover or the cap until the blade has stopped rotating. |
| | | Do not touch the sharp edge of the blade. |
| | | Do not operate the safety switch except when the bottle and cover are properly attached (do not push the safety switch with chopstick / screwdriver/ toothpick). |
| | | Do not use this product for material other than foodstuff. |
| | | This product is not intended for use by children or inexperienced persons. Ensure that the product is used and stored out of reach of young children. |
| | | To transport the product, hold the base of the main body with both hands. |
| | | Disconnect the power cord before putting on or taking off the bottle or blade. |
| | | During operation, push down on the cover to prevent the appliance from shifting or toppling. |
| TO PREVENT SHORT CIRCUIT OR ACCIDENT | | Be careful if hot liquid is poured into the blender. The liquid may be ejected from the appliance due to sudden steaming. |
| | | Do not use power supply plug or cord if damaged or plug socket connection is loose. |
| | | Avoid rapid heating or cooling. |
| | | Do not process ingredients exceeding 40°C. |
| | | Do not fill the jug beyond the marking indicated "MAX". |
| | | Do not heat the jug or other parts in microwave or oven. |
| | | Do not rinse the jug or containers with water exceeding 40°C. |
| | | Do not switch on the appliance when the container or jug is empty. |
| | | Do not insert objects besides foodstuff into the appliance while it is in operation. |
| | | Avoid storing the product in places <ul style="list-style-type: none"> ● near fire. ● high above ground. ● exposed to direct sunlight. ● with high humidity. |
| | | Do not soak the blender and mill blades. Wash after use and air dry. |
| | | Fully insert the power plug into the socket before operating the appliance. |
| | | Unplug the power cord from the socket by pulling out the plug and not the cord. |
| | | Ensure silicone seal is inserted into blender/grinder base before operating the appliance. |
| | | Do not blend very large ice cubes. |
| Observe the recommended amount of time for each operation. Keep a 3-minute interval before repeating operation. | | |
| Do not operate the appliance beyond the recommended timing. | | |
| Do not subject the main body and components to strong impact or pressure. | | |
| Do not clean main body in dish washer. | | |

PRODUCT PARTS

- 1 Blender Cup
- 2 Blender Lid
- 3 Blender Jug
- 4 Blender Silicone Seal
- 5 Blender Base
- 6 Tamper
- 7 Grinder Cup
- 8 Grinder Silicone Seal
- 9 Grinder Base
- 10 Main Body

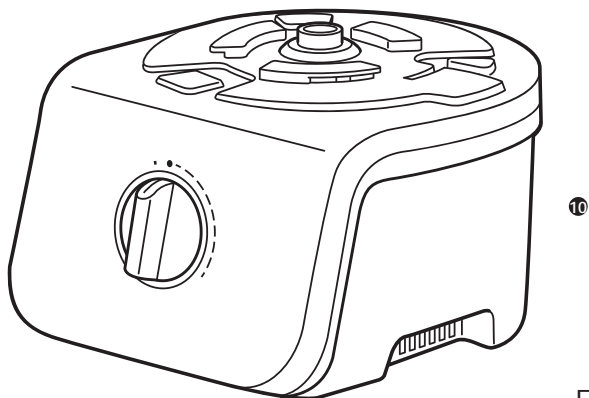
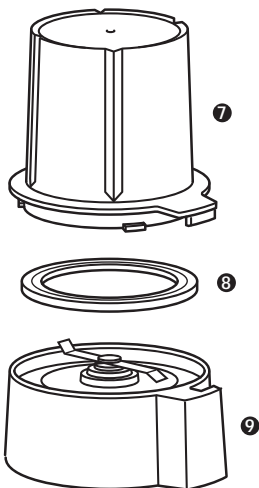
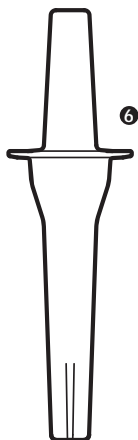
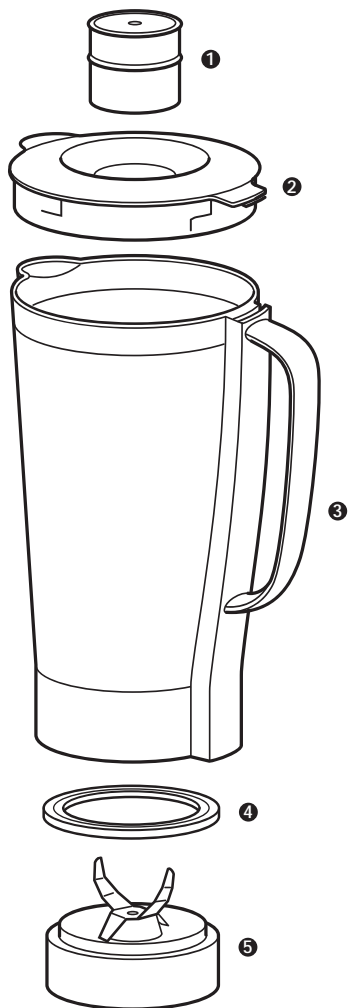

CLEANING INSTRUCTIONS

HOW TO REMOVE EACH PART

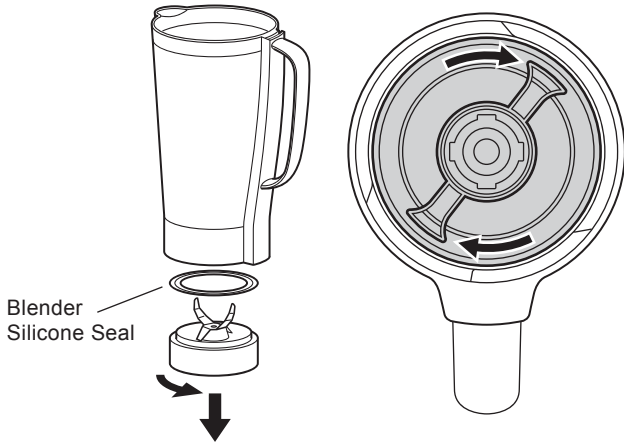

Blender Jug and Blender Base.

The Blender Base has the Blender Silicone Seal inserted at the bottom. If you want to wash the Blender Silicone Seal, take the Blender Base out by pushing it up while turning it in the direction of the arrow mark, as shown in picture.

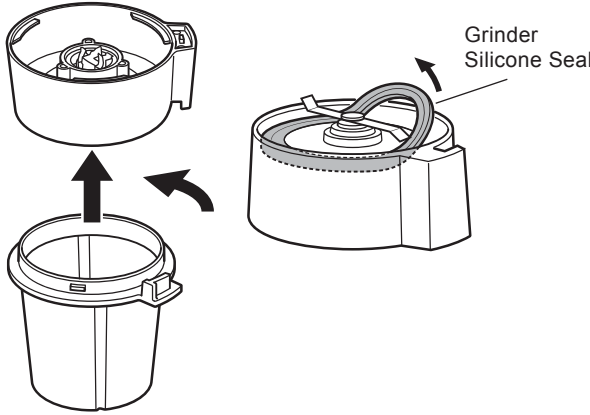

Grinder Base and Grinder Cup.

Turn the Grinder Cup upside down and remove the Grinder Base by turning it in the direction of the arrow mark, as shown in picture. The Grinder Cup has the Grinder Silicone Seal inserted at the bottom. If you want to wash the Grinder Silicone Seal, remove it by using a toothpick.

CLEANING INSTRUCTIONS

HOW TO WASH EACH PART

Some parts of the product cannot be rinsed or immersed in fluid. Please refer to the table below for more details on how to clean each part.

| Parts | Rinsing | Soaking | Dish Washer | How To Wash |
|--------------|---------|---------|-------------|--|
| Main Body | × | × | × | Wipe with a damp cloth. |
| Blender Jug | ○ | × | × | Use soft sponge and diluted dishwashing detergent (neutral). |
| Grinder Base | ○ | × | × | |
| Tamper | ○ | ○ | ○ | |

- If the Blender and Grinder blades are soaked, water may penetrate the internal parts of the blender and grinder blades, causing damage.
- Remove the blender and grinder silicone seals before washing. Take note to replace them to their original position after washing.



- Unplug and allow the appliance to cool down before cleaning. Parts may be hot due to continuous operation.
- Do not use the nylon (hard) surface of the sponge, scrubbing brushes, and/or chemical-treated cloths for cleaning. These may damage the product parts.
- Do not use benzene, thinner, alcohol, cleanser or other bleaching agents. These may cause damage or discoloration.
- Do not clean the product in a dishwasher and/or dryer, or with water exceeding 40°C. Doing so may cause damage and deformation.
- Do not perform ultraviolet sterilization. This may cause discoloration or deformation.

CLEANING INSTRUCTIONS

HOW TO WASH EACH PART

Cleaning the Blender.

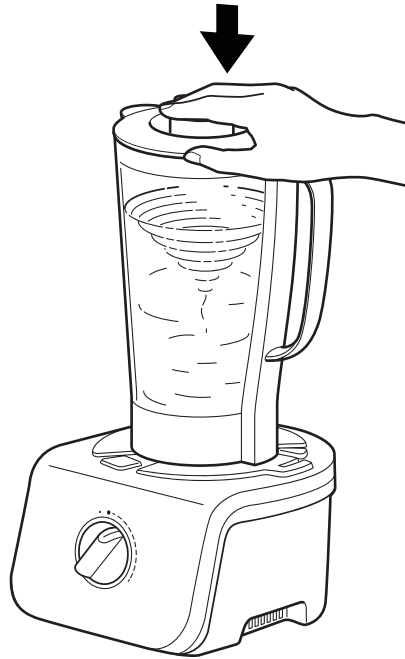

If you have difficulty removing stains from the Blender Jug, please follow the cleaning instructions below:

- 1 Put a few drops of dishwashing liquid and half a cup of water into the Blender Jug.
- 2 Place the Blender Jug on the Main Body and cover it with Blender Lid and Cap.
- 3 Operate for about 30 seconds while gradually increasing the speed from Speed 1 to 8.
- 4 Unplug the product from the power socket, and rinse the Blender Jug, Lid and Cap with water.

ABOUT DISCOLOURATION OF PLASTIC PARTS

The rubber parts of the silicon seal or the plastic parts of jug, lid, and blades may change colour due to the adherence of pigments from foods such as carrot, pumpkin, and leafy vegetables. The staining can not be completely removed with the use of a sponge or dishwashing liquid, but will not affect the safety of the product. Staining can be minimised with the immediate cleaning of parts after use.

WHAT YOU CAN DO WITH THIS PRODUCT

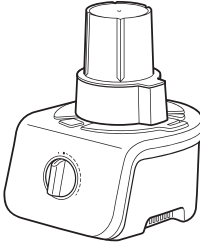
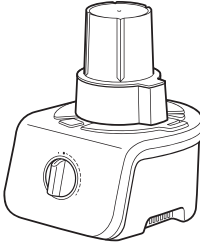
| Method of Food Preparation | Page | Main Parts to be Used |
|--|------|--|
| Blending To make mixed juices, soup and crushed ice | 11 |  |
| Grinding To grind beans, seeds and nuts | 14 |  |
| Crushing To make powder of dried ingredients | |  |

HOW TO USE

SPEED DIAL

The appliance is operated by turning the power dial to the left or right of the Off marking. To turn it off, turn the dial back to the Off marking.

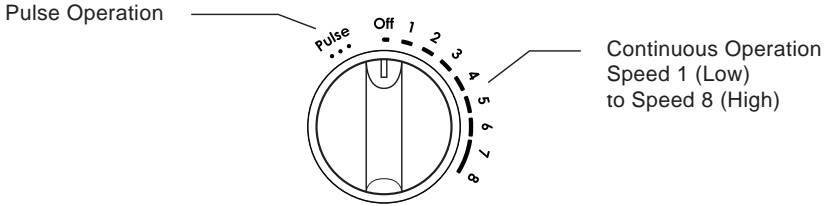



| | |
|--|--|
| Continuous Operation (Speed can be adjusted during operation) | Turn the dial to the right to start continuous operation. Depending on the recipe and ingredients used, rotation speed can be increased or reduced as required while the product is in operation. |
| Pulse Operation | Turn the dial to the left to start pulse operation. If dial is released during operation, it will return to the Off position and operation will stop. This is useful when preparing ingredients that require frequent checking. |

SAFETY SWITCH

When the jug/cup and lid are attached correctly to the main body, the safety switch located on the main body will be depressed.

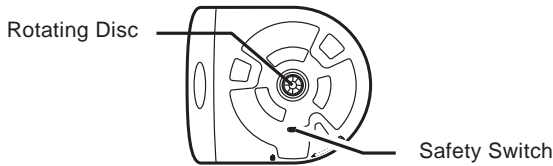
To start operation, plug the power cord into the socket and turn the dial.



| | |
|--|---|
|  CAUTION | Do not push the safety switch. The disc may start rotating if the power dial is engaged by accident while the main body is plugged into the power socket. |
|--|---|

THERMAL MOTOR PROTECTION

The KitchenExpress is equipped with a Thermal Motor Protection device, which protects the motor from overheating during prolonged or heavy use. If your KitchenExpress shuts down after running for a long time or when you are preparing a large amount of food, return the Speed Dial to the Off position and unplug the base unit. You should be able to resume use of the appliance after five minutes.

If the base unit does not start up, consult the Troubleshooting section on page 18.

HOW TO USE

BLENDING

The Blender Jug and Blender Base are used in mixing fruit and vegetables into juices.

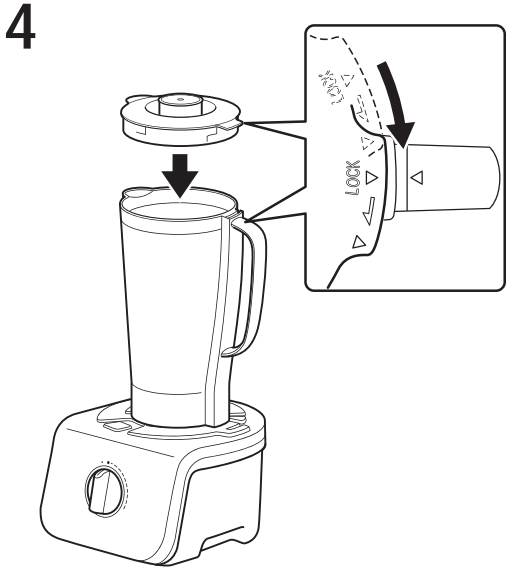
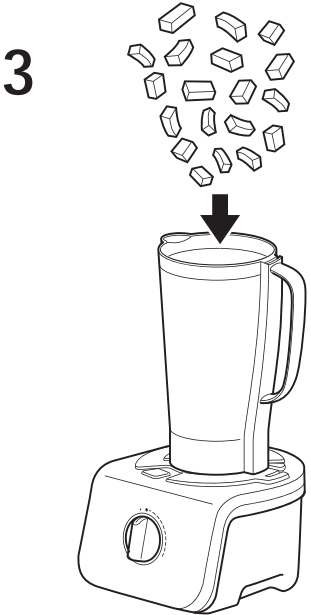
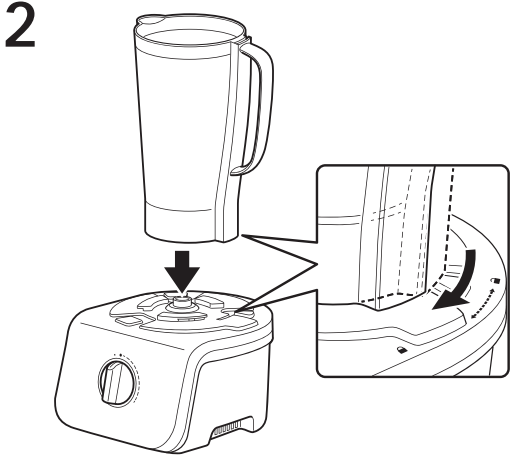
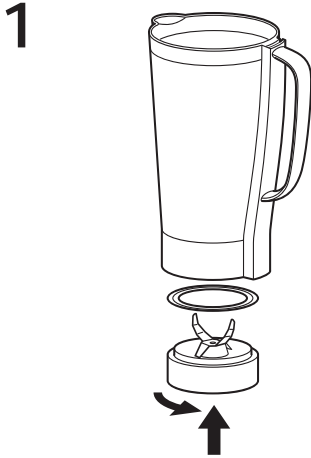

HOW TO USE

5

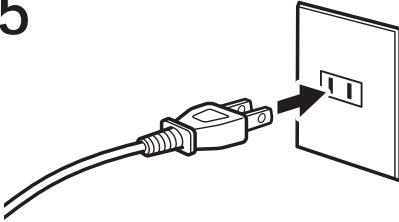

6

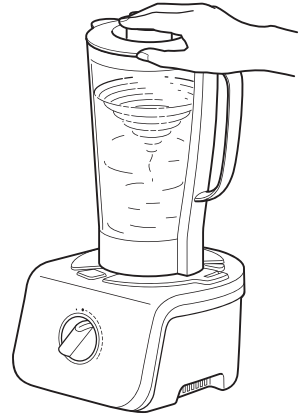

7

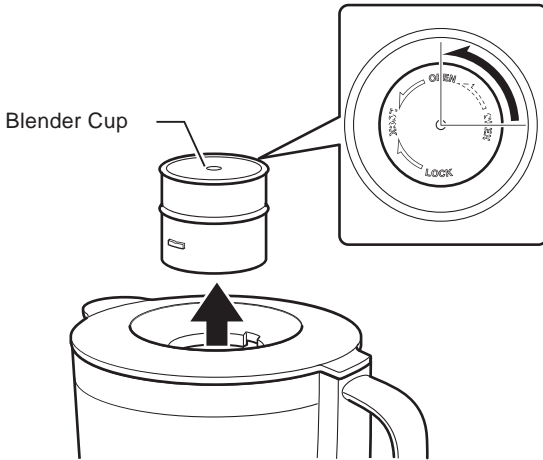

MEMO

1 The appliance will stop if blender lid is removed during operation.

2 While blending, follow the sequence below to move material in the blender using the tamper:

- Stop operation and remove the Blender Cup.
- Push the tamper until it touches the material (the tamper has a safety guard attached, and will not touch the blade even when fully inserted).
- Restart operation from low speed (Speed 1~2)
- Push the material with tamper.



CAUTION

Pushing material in the blender with the tamper too vigorously might activate the motor protection function (see pg12).

HOW TO USE

8

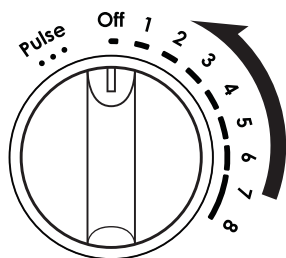

9

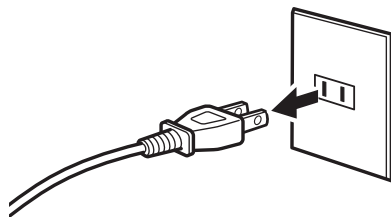

10



11

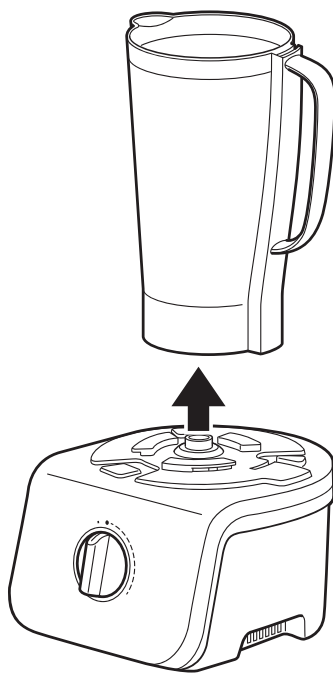

HOW TO USE

GRINDING/CRUSHING

The Grinder Base and Grinder Cup are used to grind and crush hard ingredients such as coffee beans into powder form.

1

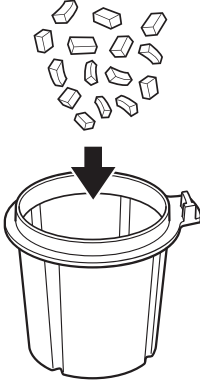

2

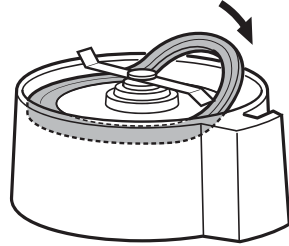

3

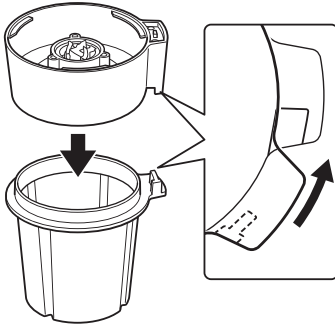

4

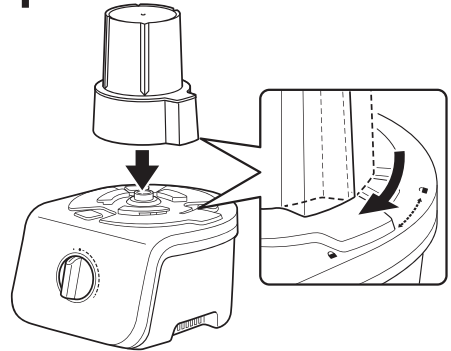

Please note that milling hard ingredients like spices, nuts, sugar, coffee, grains, etc. will cause scratching and clouding to the inside surfaces of the Grinder Cup. This is a cosmetic result from milling these kinds of ingredients, and does not affect the performance of the Grinder Cup.

HOW TO USE

5

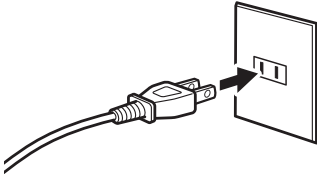

6

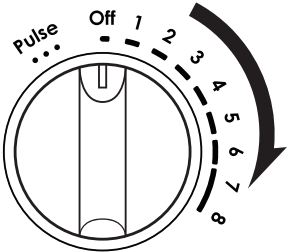

7

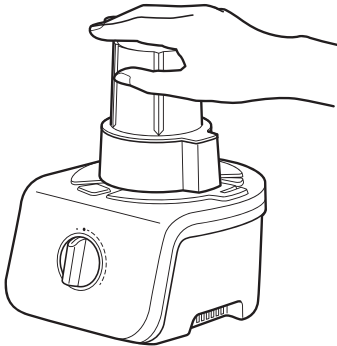

8

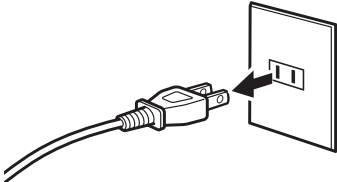

9

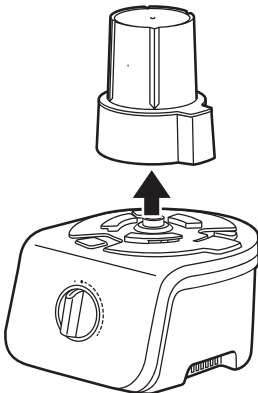

10

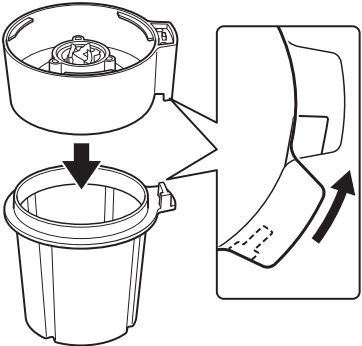

RECOMMENDED PROCESSING SPEEDS & TIMES

BLENDING JUICES & MILKSHAKES

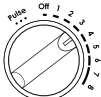
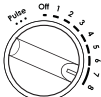

Use Blender Blade and Blender Jug

| Preparation Method | Ingredient | Min-Max Quantity | Recommended processing speed & time | Remarks |
|-------------------------|--|---|---|---|
| Juicing | Citrus fruits/ tomato | Citrus fruits/ tomato 700g + 300 - 500ml water |  <ul style="list-style-type: none"> • Speed 3-4 for 30 - 45 secs | <ul style="list-style-type: none"> - Remove the skin and seeds of citrus fruits and cut into four equal pieces. - Cut tomato into four equal pieces without removing skin or seeds. - Adjust the quantity of fruits, vegetables, and water to your use and preference. |
| Blending Fruit and Milk | Vegetables, fruits, frozen fruits, water, milk | Fruits/ vegetables 500 - 700g + 300 - 500ml water/milk |  <ul style="list-style-type: none"> • Speed 7-8 for 45 - 60 secs | <ul style="list-style-type: none"> - Adjust the quantity of fruits, vegetables, and water to your use and preference. |

RECOMMENDED PROCESSING SPEEDS & TIMES

GRINDING/CRUSHING

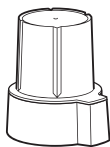

Use Grinder Base and Grinder Cup

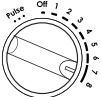
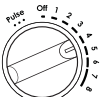
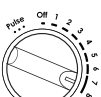
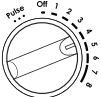
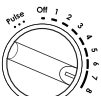
| Preparation Method | Ingredient | Min-Max Quantity | Recommended processing speed & time | Remarks |
|--------------------|----------------|---------------------------|---|--|
| Grinding | Coffee Beans | Standard quantity 100g |  <ul style="list-style-type: none"> Speed 7-8 for 20-30 secs | |
| Crushing | Almonds | 10g - 180g |  <ul style="list-style-type: none"> For 10g Speed 4-5 for 10-15 secs  <ul style="list-style-type: none"> For 180g Speed 7-8 for 20-30 secs | |
| | Dried Sardines | 10g - 60g |  <ul style="list-style-type: none"> For 10g Speed 4-5 for 10-15 secs  <ul style="list-style-type: none"> For 60g Speed 7-8 for 15-20 secs | - Remove heads and guts before processing. |

TROUBLESHOOTING

Follow the appropriate troubleshooting measures listed in the table below. If you cannot find the solution to your problem, please contact Customer Support.

| Condition | Part | Potential Causes | Measures |
|---|---------|--|--|
| Operation does not start even after turning the speed dial. | Overall | Is the power supply plug plugged in? | Insert the power supply plug into a socket |
| | | Was the appliance under heavy use a short while ago? | Under heavy load, the motor stops temporarily to avoid overheating. Unplug the base, wait for 5 minutes, then start again. |
| | | Is the container overfilled? | Reduce the ingredient quantity. |
| | | Is the ingredient quantity too much or too large in size? | Reduce the ingredient quantity or cut the ingredient into small pieces. |
| | Blender | Are the Blender Base and Blender Silicone Seal firmly attached to the Blender Jug? | Firmly attach the Blender Base and the Blender Silicone Seal to the Blender. |
| | | Is the Blender Jug firmly attached to the Main Body? | Firmly attach the Blender Jug to the Main Body. |
| | | Is the Blender Lid firmly attached to the Blender Jug? | Firmly attach the Blender Lid to the Blender Jug. |
| | Grinder | Are the Grinder Base and Grinder Silicone Seal firmly attached to the Grinder Cup? | Firmly attach the Grinder Base and Grinder Silicone Seal to the Grinder Cup. |
| | | Is the Grinder Base firmly attached to the Main Body? | Firmly attach the Grinder Base to the Main Body. |

TROUBLESHOOTING

Follow the appropriate troubleshooting measures listed in the table below. If you cannot find the solution to your problem, please contact Customer Support.

| Condition | Part | Potential Causes | Measures |
|--|-----------------|--|--|
| Appliance stops midway through operation | Overall | Does the material exceed the MAX scale of the Jug or Cup? | If there is too much material in the container, the motor stops temporarily to avoid overheating. Unplug the base, wait for 5 minutes, then start again. |
| Ingredients leak out | Overall | Does the quantity of ingredients in the Jug or Cup exceed the MAX marking? | Reduce the ingredient quantity in the Jug or Cup. |
| | Blender/Grinder | Are the Blender Base and Blender Silicone Seal firmly attached to the Blender Jug? | Firmly attach the Blender Base and the Blender Silicone Seal to the Blender Jug. |
| | | Is the Blender Lid firmly attached to the Blender Jug? | Firmly attach the Blender Lid to the Blender Jug. |
| Blades spin idle during operation | Overall | Is the amount of ingredient quantity too little? | Fill the Jug or Cup with more of the ingredients. |
| | | Are there too many ingredients in the Jug or Cup? Are the ingredients too bulky? | Reduce the ingredient quantity or cut the ingredients into small pieces. |
| | | Are there any ingredient parts that cannot be processed? | Remove the parts that cannot be processed. |
| Increased vibration during operation | Overall | Are there too many ingredients in the Jug or Cup? Are the ingredients too bulky? | Reduce the ingredient quantity or cut the ingredients into small pieces. |
| | | Is the product placed on an unstable surface? | Place the product on a stable plain surface. |
| | | Does the appliance shift around during operation? | Press down on the lid or appliance during operation. |

SPECIFICATIONS

KitchenExpress BG33 Specification

| Configuration | Blender | Grinder |
|---|---|-----------|
| Electrical Power Consumption | 400W | 300W |
| No. of Rotations (Maximum 'No Load' Speed) | 16,000RPM | 17,000RPM |
| Rated Capacity (Maximum Capacity) | 1,500 ml | 100 g |
| Size (Approx.) | | |
| Width | 230 mm | 210 mm |
| Depth | 252 mm | 252 mm |
| Height | 428 mm | 292 mm |
| Weight | 3.6 kg | 3.1 kg |
| Colours | Ferrano Red, Pearl White, Sparkling Black and Nickel Star | |
| Safety Lock | Yes | |
| Speed Dial | Variable speed from 1~8 + Pulse | |
| Voltage | AC 220-240 V, 50/60 Hz | |
| Power | 1300 W | |
| Noise Level | < 78 dB | |
| Warranty | 12 months | |
| Material | RoHS Compliance | |
| Jug Material | BPA-free | |
| Power Cable Length | 1.6 m | |



This marking indicates that this product should not be disposed with other household wastes throughout the EU. To prevent possible harm to the environment or human health from uncontrolled waste disposal, recycle it responsibly to promote the sustainable reuse of material resources. To return your used device, please use the return and collection systems or contact the retailer where the product was purchased. They can take this product for environmental safe recycling.



www.ferrano.com

All Rights Reserved, 2015

Due to continued product improvement, the products illustrated/photographed in this brochure may vary slightly from the actual product.