



GALVANIC

USER MANUAL

L(A)B Life + Beauty

Is the creation of Oxford University Scientists and Sisters Lauren, Charlotte and Sophie. L(A)B's aim is to improve the effectiveness of your everyday skin and healthcare regimes with cutting edge scientific developments that can fit easily into your life.

“As Scientists we wanted to create apparatus that will improve your health and beauty routine and give visible, professional results at home”

- Charlotte, Lauren and Sophie

For more information on the L(A)B range and for Video Tutorials and Profesisonal tips and tricks on how to get the most out of your device visit:
www.lab-lifeandbeauty.com

L(A)B GALVANIC

Is a unique skincare system that utilises cutting edge scientifically proven Galvanic Current Technology to improve the overall appearance and luminosity of the skin, decrease fine lines and wrinkles and improve skin tone

Galvanic Technology is scientifically proven to improve the appearance of skin and decrease the signs of Ageing with no harmful chemicals.

Galvanic Current operates at the milli amp range which is completely safe and widely used by skincare professionals

Use L(A)B Galvanic to apply your Cleanser, Moisturiser and Serums to increase the penetration of active ingredients deeper in to the skin.



GALVANIC

Technology + Results

STEP 1 CLEANSE

Cleanse mode produces a Galvanic Current that works with your cleanser to break down dirt in the skin and remove impurities and excess oil from pores. Providing a deeper cleanse

STEP 2 NOURISH

Apply Serums and Moisturisers with L(A)B Galvanic in Bio-wave mode which charges the serum for deeper penetration into the skin, increasing absorption of active ingredients.

STEP 3 TONE

Use Toning Probe to firm and lift the skin

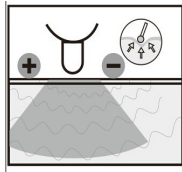
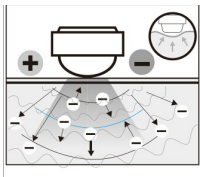
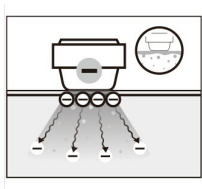

Apparatus



L(A)B GALVANIC

Apparatus

Rubber Cotton Pad Holder x 1

Cotton Pads x 1 set

L(A)B Activator Serum

USB Cable - Gives option to
charge through your laptop x 1

UK Plug for charging x 1

Charging Base and Storage Cradle
x 1

User Guide

Methodology - How to Use

Cleanse: Put GALVANIC into Cleanse mode

1. Secure cotton pad on the applicator probe as in diagram below
2. Apply your cleanser to the pad and use GALVANIC to cleanse face. When using ensure hand is in contact with Conduction strip
3. Use steady motions starting at the bottom of your face and working upwards and outwards covering your entire face
4. Once finished cleansing, rinse off any excess Cleanser
5. After use always wipe clean each probe - We recommend using a L(A)B UV Sanitizer to kill 99.9% of bacteria

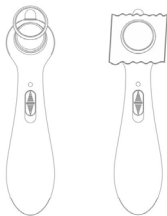

Methodology - how to use

Nourish + Hydrate

Galvanic Current increases the penetration of active ingredients deeper in to the skin amplifying their effectiveness.

Apply serum to the Applicator Probe. Place probe to face using gentle, steady sweeping motions upwards and outwards as in below diagram. Continue until Serum is fully absorbed.

For best results use with L(A)B Activator Serum.

Apply moisturiser in the same way. Use 2 times a day not less than 6 hours apart for the first month. To maintain results use 2 to 3 times per week.



For detailed tips and step by step video tutorials please visit :
www.lab-lifeandbeauty.com

Methodology - how to use

EYE AREA:

1. Prior to use apply serum to eye area to increase absorption and enhance anti-ageing results
2. Use the Eye area probe to smooth wrinkles and reduce puffiness and under eye bags. Move the probe slowly - approx 1cm per five seconds, repeat each position 4 times.
Use 2 times a day not less than 6 hours apart for the first month. to maintain results use 2 to 3 times per week.
3. After Use wipe clean all probes - to kill 99.9% Bacteria use a L(A)B UV SANITIZER



For detailed tips and step by step video tutorials please visit:
www.lab-lifeandbeauty.com

Toning + Lifting Routine

After application of your Serum and Moisturiser

Use the circular Toning Probe to massage the skin for up to 4 minutes using gentle steady sweeping upwards motions. This will further stimulate the subcutaneous tissue and muscle, repair skin elasticity to tone lift and massage the skin.

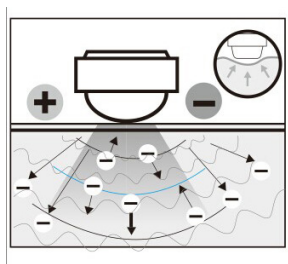

For tips and tricks and video tutorials please visit:
www.lab-lifeandbeauty.com

GALVANIC SKINCARE ROUTINE

FIRST 4 WEEKS: cleansing, moisturising, toning

Normal Skin	Twice a Day
Dry Skin	Once every 3 Days
Sensitive Skin	Once every Week
Oily Skin	Once 4-5 Days

MAINTENANCE

Use Once 2-3 Days per week

For best results use GALVANIC with L(A)B Device Driven Skincare.

Only use with water based skincare products

L(A)B DEVICE DRIVEN SKINCARE

L(A)B have created specialist skincare designed and made in England to be used with L(A)B Devices. Specifically formulated to heighten performance and deliver the most advanced results.

Included with L(A)B GALVANIC is a sample of our L(A)B Activator Serum. This product offers universal benefits for all skin types and contains the following active ingredients:

Collagen
Seabuckthorn
Rosehip Oil
Aloe
Cucumber

Cautions

Do not use if:

You have had eye surgery within a year

Are under 15 years old

Have Acute inflammation of the skin or Open Wounds

Have a medical metal implant including a pace maker

Recently underwent facial surgery

Stop using immediately if you experience any adverse effects

Take care around the eye area

Do not submerge in water. Do not wet charging cables.

Consult your Doctor if you are currently being treated for a skin condition

Only use this device for its intended purpose as described in this manual.

L(A)B Activator Serum:

Ingredients: Aqua, Aloe barbadensis (Organic leaf) extract, Glycerin, Polysorbate-20, Cucumis sativas (Cucumber) seed oil, Collagen (Marine), Rosa Rubiginosa (Rosehip) Oil, Phenoxyethanol & Ethylhexylglycerin, Carbomer, Hippophae rhamnoides (Seabuckthorn) seed oil, Sodium hydroxide, Benzyl alcohol

Batch: Best before 28/06/2015

Charging Galvanic

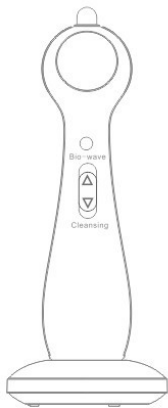

Figure 1

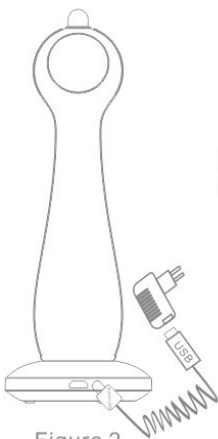

Figure 2

Charger holder:
please make sure 2 pins in right
direction, as showed in Figure 2

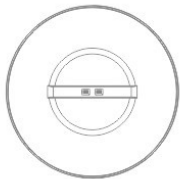

Figure 3

Please pay attention to the Micro-USB interface that it is in the correct direction to insert the charging holder
Charge either through USB direct into computer or through the adaptor into mains
Charging takes 2 hours during this time a red light will appear



www.lab-lifeandbeauty.com