

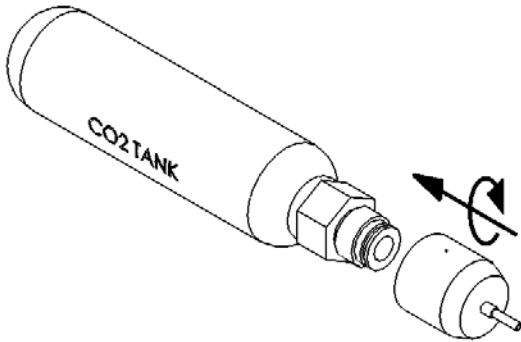

www.MadBullAirsoft.com
MAD BULL XM-CHARGER User Manual

NOTE: WEAR GOGGLE ALL THE TIME!



Step 01 : Attach XM-CHARGER onto your CO2 tank.

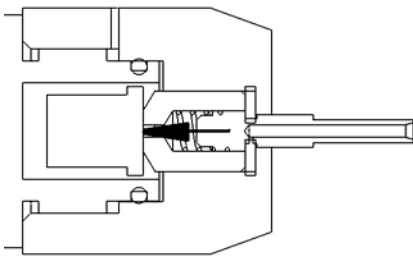

Step 02 : There should be CO2 output. If not, please follow the steps below: The CO2 tank valve is not pushed by the XM-CHARGER's brass screw. Not all tank valves are built the same and you need to do with the height of the pin located at the center of the valve.

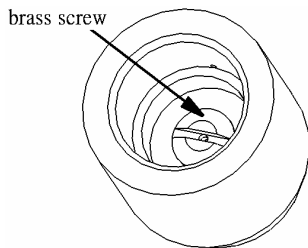

You can also adjust the brass screw inside the XM-CHARGER. In this case, you need to use screw driver and counter-clockwise to turn the brass screw up.

Important Notice:

1. This CHARGER is only for Airsoft. Unauthorized modified will cause damage.
2. Modify is not allowed. If you find problems with your CHARGER, consult with your local dealers.
3. Maintenance: Please use silicon oil to lubricate the components frequently.
4. Only replaced with the original factory parts in order to ensure the quality and safety.

Product Advisory for ALL Airsoft related products

MADE IN TAIWAN

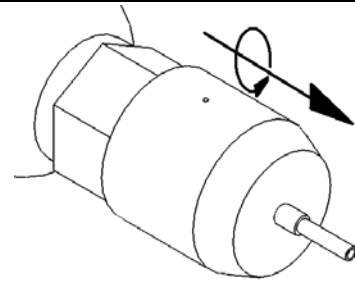

Step 03 : Take off the XM-CHARGER when you totally run out all CO2. If there is still CO2 in the tank, go to Step 04.

IMPORTANT!!

Always apply vertical force or the fill stem will be broken

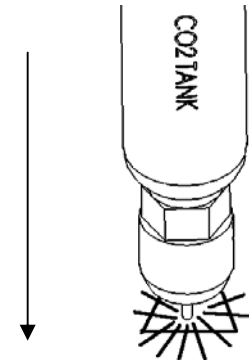

Step 04 : Removing the adaptor from a partially charged CO2 tank: You need to do the following.

Loosen the adaptor about 1/2 - 3/4 turn, and then press the stem against a hard surface to release the trapped CO2.

(Important !! Apply vertical force onto CO2 tank only or the fill stem will be broken.)

Once this is done, the adaptor should come off the rest of the way with no trouble at all.

This is the much the same procedure we use when removing the tank from a paintball gun.

On the paintball guns you'll see they've provided a small vent hole, which aids in the release of that bit of gas pressure.

There is also a vent hole on the XM-CHARGER which provides the same function.

Details :

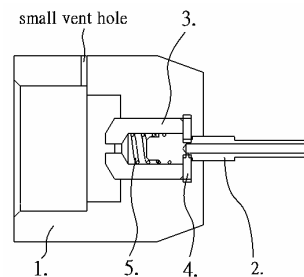

1.	Major Body	4.	Rubber packing
2.	Fill stem	5.	Spring of fill stem
3.	brass screw		

WARNING:

Don't change, obscure, alter, remove, or obliterate any coloration or markings on this gun. The coloration and/or marking on this product, including the blaze orange barrel tip are designed to comply with applicable state and federal law and regulations.

WARNING:

This product may be mistaken for a firearm by law enforcement officers or others. Any person who changes, alters, removes, or obliterate any coloration or markings that are required by state or federal law or regulation, in any way that makes this product look more like a firearm is guilty of a misdemeanor.

WARNING:

The open display, brandishing and/or exposing of this product in any "public place" may cause confusion and may be a crime. The term "public place" means any area opened to public, including but not limited to, streets, sidewalks, bridges, alleys, plazas, parks, driveways, front yards, parking lots, automobiles, whether moving or not, and buildings opened to the general public including those that serve food or during, or provide entertainment, and the doorways and entrances to buildings or dwellings.

WARNING:

Every person who, except in self-defense, draws or exhibits this product in a threatening manner against another in such a way as to cause a reasonable person apprehension or fear of bodily harm is guilty of a misdemeanor punishable by imprisonment in the county jail for a term of not less than 30 days.