

G·LITES™

WWW.GLITES.COM



ARCH 56
56X3W (RGBWA)

1. GENERAL INFORMATION

INTRODUCTION: Congratulations, you have just purchased one of the most innovative and reliable LED fixtures on the market today. Our company has been designed to perform reliably for years when the guidelines in this booklet are followed. Please read and understand the instructions in this manual carefully and thoroughly before attempting to operate this unit. These instructions contain important information regarding safety during use and maintenance.

Notice: As part of our ongoing commitment to continuous products update, company will keep the right to improve this products, the information in this menu may be changed in the future, the company reserve the right to change the data without any advises.

UNPACKING: Thank you for purchasing our company products. Every product has been thoroughly tested and has been shipped in perfect operating condition. Carefully check the shipping carton for damage that may have occurred during shipping. If the carton appears to be damaged, carefully inspect your fixture for damage and be sure all accessories necessary to operate the fixture have arrived intact. In the event damage has been found or parts are missing, please contact our customer support team for further instructions. Inside the box you should find: the fixture, a DMX XLR cable, a power cable, and this user manual. Please do not discard the shipping carton in the trash. Please recycle whenever possible.

2. SAFETY INSTRUCTIONS

Notice: To guarantee proper and consistent operation, it is important to follow the guidelines in this manual. Our company will not accept responsibility for damages resulting from the misuse of this fixture due to the disregard of the information printed in this manual.

- 1. In order to ensure the light could operate normally, the ambient temperature couldn't be higher than 35[°] and no lower than 2[°].
- 2. Under normal condition, the highest sectional surface temperature may be up to 50°C.
- 3. These projectors are designed depends on the electric shock protection, the projector should be connected with the power supply system which connected ground enough. The projector's ground cable should be connected with the ground cable of the power supply system as well. The ground mark of the light metal cover should be connecting with the installation bricked steadily.
- 4. Connecting the main power supply should be done by the professional person.
- 5. Please check the voltage, frequency data of power supply system is suitable for the mentioned on the projector. Please do avoid the different voltage between them and burn the projector.
- 6. Do not attempt to operate this fixture if the power cord has become damaged or frayed.
- 7. Never open this fixture while in use.
- 8. Never look directly into the light source. You risk injury to your retina, which may induce blindness.
- 9. Please be aware that damages caused by modifications to the device are not subject to warranty.

3. PERFORMANCE TRAIT AND SKILL SPECIFICATIONS

- Lighting equipment is installed with 56pcs LED. We use EDISON LED chip as default LED chip. Client also can choose LUXEON K2 high power LED chip.
- Low power consumption, super luminance, rich and splendid color.
- It adopt the LCD display, as its operating in terrace, the words can also be plus or reverse settled by 180°, very easy for using on the floor or hang on.
- With inner automatic run function, master/slave setting very easy to operate by users.
- The fixture's out shape adopt pressed construction design and strong wind refrigeration system which be know as a good cooling system.
- DMX channel: Two or three different DMX modes.
- Standard DMX-512.
- Color mixing: color additive mixing.
- Dimmer: continuous dimming 0~100%.
- Strobe: electronic strobe 0~18 fps.
- LED life: 100,000 hours rated life.
- LED power: 3W
- Voltage: AC90-260V/50-60Hz
- Power: 169W
- LED QTY: R20 + G18 + B18
- N.W.: 10.8 Kg.
- G.W.: 11.9 Kg.
- Carton size: 495 x 270 x 290 (mm)
- Body size: 428 x 202 x 246 (mm)
- IP rate: IP65
- Lens angle: 45°
- Choice lens angle: 60°

4. OPERATION PANEL

G-LITES™

IP65

Maximum ambient temperature $t_a=35^{\circ}\text{C}$.
Exterior surface temperature under steady state condition $=50^{\circ}\text{C}$.
Prolonged exposure to unshielded lamp can cause eye and skin burns.

F

0.8m

CE

MENU UP DOWN ENTER

5. DIMENSIONAL DRAWINGS

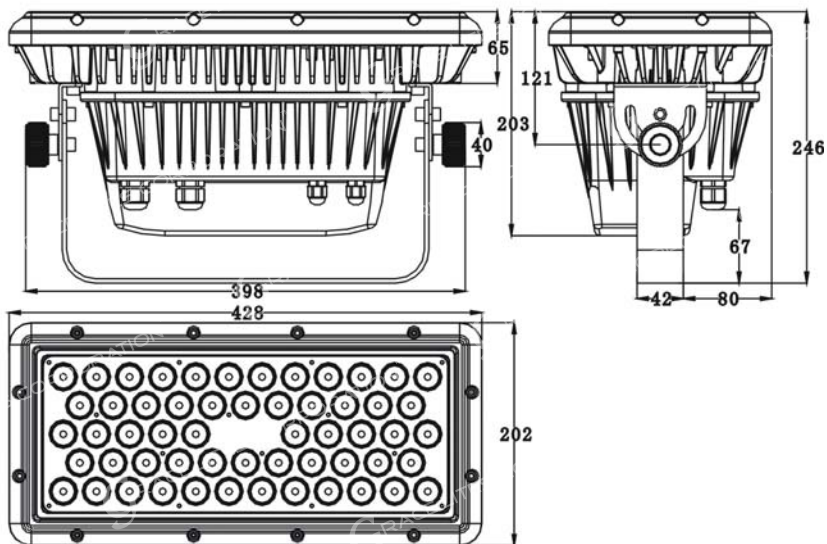

6. PHOTOMETRIC DATA

PL5603CT: 40° lens

R	1540	780	310	165	95	LUX
G	2120	1128	442	240	125	LUX
B	3500	1770	698	372	201	LUX
RGB	7240	3680	1440	770	420	LUX

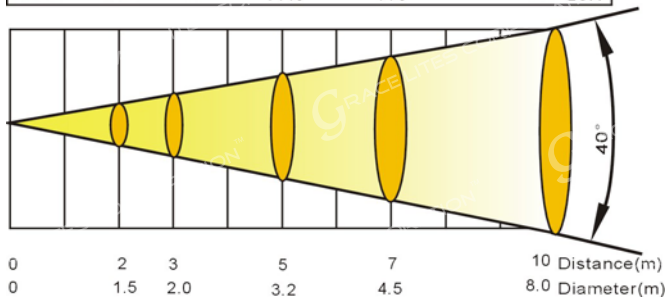

7. MOUNTING AND INSTALLATION

Cautions: For added protection mount the fixtures in areas outside walking paths, seating areas, and away from areas where unauthorized personnel might reach the fixture. Before mounting the fixture to any surface, make sure that the installation area can hold a minimum point load of 10 times the device's weight. Fixture installation must always be secured with a secondary safety attachment, such as an appropriate safety cable. To avoid injury, never stand directly below the device when mounting, removing, or servicing the fixture.

Mounting points: Overhead mounting requires extensive experience, including amongst others calculating working load limits, a fine knowledge of the installation material being used, and periodic safety inspection of all installation material and the fixture. If you lack these qualifications, do not attempt the installation yourself. Improper installation can result in bodily injury. Be sure to complete all rigging and installation procedures before connecting the main power cord to the appropriate wall outlet.



CAUTION!

Be sure a qualified electrician performs all electrical connections.

Mounting: Our company is fully operational in any mounting position, hanging
www.g-lites.com

upside-down, side mounted, or set on a flat level surface, etc. Be sure this fixture is kept at least 0.5m (1.5 feet) away from any flammable materials (decoration etc.).

When clamp mounting; always use and install the supplied safety cable as an added safety measure to prevent accidental damage in the event of a clamp failure. See the image below.

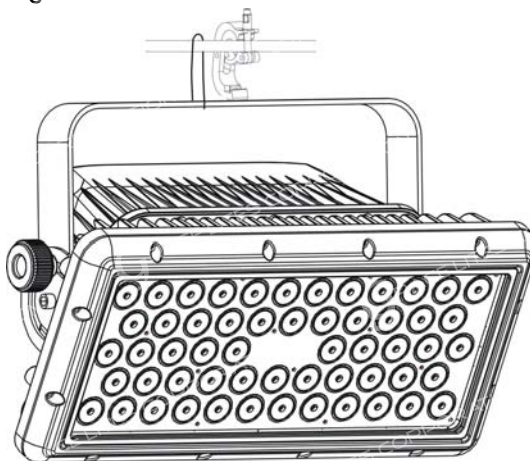

8. POWER SUPPLY AND SIGNAL CONNECTION

1. Power supply

Use the professional plug to connect the projector and main power supply. Please pay attention to the voltage, frequency the same as the mentioned on the projector. Suggest each light has separately switched of the power supply so that could turn on or turn off each projector desultorily.

2. Signal connection

Please use the round 3-pin XLR plugs & sockets offered by menu facture to connect the first projector's output to the second projector' input and connect the second projector's output to the third projector's input. And in the same way for the rest, eventually connect the last projector's output, all the projectors are together as the following figure.

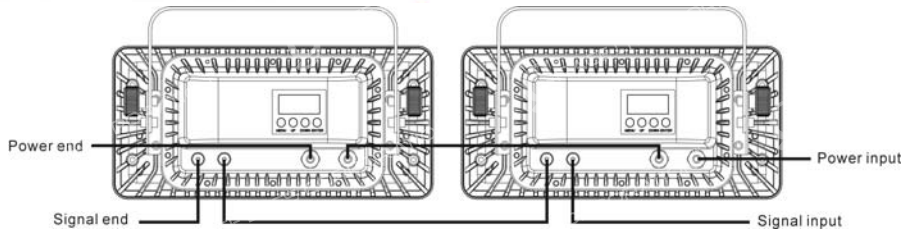

The projectors' control signal output or input by using the 3-pin XLR plug and socket. If need to long then the communication cable, please make sure the both side of 3-pin plug is one to one (one to one, two to two, three to three). Otherwise, the communication cable will be interrupted. The communication cable is 2-pin shielded cable 75Ω

Resistance with each core is at least a 0.5mm diameter. (Caution: All the inside leading wire of 3-pin XLR plug couldn't touch each other or plinth).

Recommend to use the DMX signal terminator for the installation to avoid the electronic noise damage the digital control signal. Simply speaking, DMX terminator is an XLR connector with a $120\Omega/1w$ resistor connected across pin 2 and 3. Which is then plugged into the output socket on the last projector in the chain. Refer to the connection as above: (Picture). We suggest using the DMX signal distributor when the distance of the lights over 15meter. In case of effect the light communication because of the signal feeble.

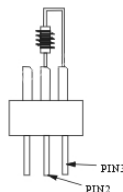

3. Light power connection:

After doing the above operation and making sure all the projectors had been installed with natural operate, press the power switch to check whether everything is working normally.

9. DISPLAY MENU

ADDR →	d.001	Adjusting DMX addressing data					
	d.002						
	↓						
	d.512						
↓							
PROG →	RUN.P →	PRG.1	Select built-in program				
		↓					
		PRG.8					
	SET.P →	XFAD	X.000	Adjusting built-in program's in ,out time			
			↓				
			X.255				
		SPED	S.000	Adjusting built-in program,s running speed			
			↓				
			S.255				
	STRB	S.000	Adjusting built-in program's strobe				
		↓					
		S.255					
↓							
MANU →	SET.M →	SCAN →	SCN.1 SCN.8	RED	R.000	Adjusting red's brightness manually	
				↓	R.255		
				GRN	G.000	Adjusting green's brightness manually	
					↓		
				BLUE	B.000	Adjusting blue's brightness manually	
					↓		
				STRB	S.000	Adjusting scene's strobe manually	
					↓		

MANU	SET.M	XFAD	X.000	Adjusting built-in program's in ,out time	
			↓		
		X.255	Adjusting built-in program's;running speed		
		S.000			
	SPED	↓			
		S.255			
RUN.M	STP.1	↓	Select manual programming		
			STP.8		
↓					
PERS	DATA	SLAV	Set as slave (default)		
		MAST	Set as master		
	CHAN	3CH	Select DMX mode(default 6CH)		
		4CH			
		6CH			
	DISP	HEAD	Digital tube face display(default)		
		REVE	Digital tube display up-side-down		
		ON	Digital tube set as always on		
		OFF	Digital tube set as off (default)		
	SET.C	-0.C	Set Temperature Protection		
		-1.C			
		↓			
		-6.C			
	REST	NO	Renew the factory's default values or not		
YES					
↓					
INFO	CPU	V*.**	Display CPU version number		
	TEM.1	000.C	Display drive board temperature		
	TEM.2	000.C	Display LED board's actual temperature		
	TIM.L	0000	Display RGB LED using time		
	TIM.R	0000	Display red LED using time		
	TIM.G	0000	Display green LED using time		
	TIM.B	0000	Display blue LED using time		

10. DMX TRAITS

When controlled by DMX512 control, there are three control modes: 3,4,6-channel mode, the settings from the display menu to choose to identify.

Channel Mode	Channel NO.	function	DMX value and effect
3	1	Red	0-1, no light 2-255, 0%~100% red
	2	Green	0-1, no light 2-255, 0%~100% green
	3	Blue	0-1, no light 2-255, 0%~100% blue
4	1	Red	0-1, no light 2-255, 0%~100% red
	2	Green	0-1, no light 2-255, 0%~100% green
	3	Blue	0-1, no light 2-255, 0%~100% blue
	4	Dimmer	0-255, 0%~100% light
6	1	Red	0-1, no light 2-255, 0%~100% red
	2	Green	0-1, no light 2-255, 0%~100% green
	3	Blue	0-1, no light 2-255, 0%~100% blue
	4	Color	0, no function 1-255, color macro

Channel Mode	Channel NO.	function	DMX value and effect
6	5	Dimmer	0-255, 0%~100% light

			0-1, no effect
			2-159, strobe from slow to fast
			160-169, no effect
			170-189, random strobe from slow to fast
			190-199, slow shadow open, fast close
			200-209, Medium-speed shadow open, fast close
			210-219, fast shadow open, fast close
			220-229, slow shadow close, fast open
			230-239, Medium-speed shadow close, fast open
			240-249, fast shadow close, fast open
			250-255, no effect
	6	Strobe	

11. CIRCUIT CONNECTING DIAGRAM

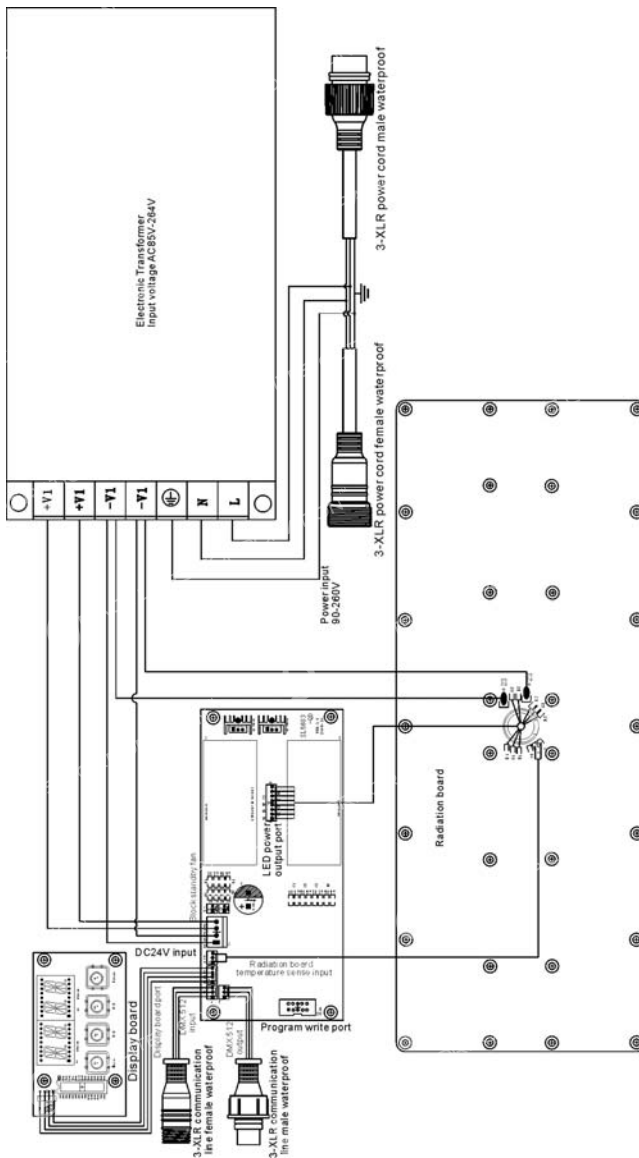

12. EXPLODE DIAGRAM AND LIST

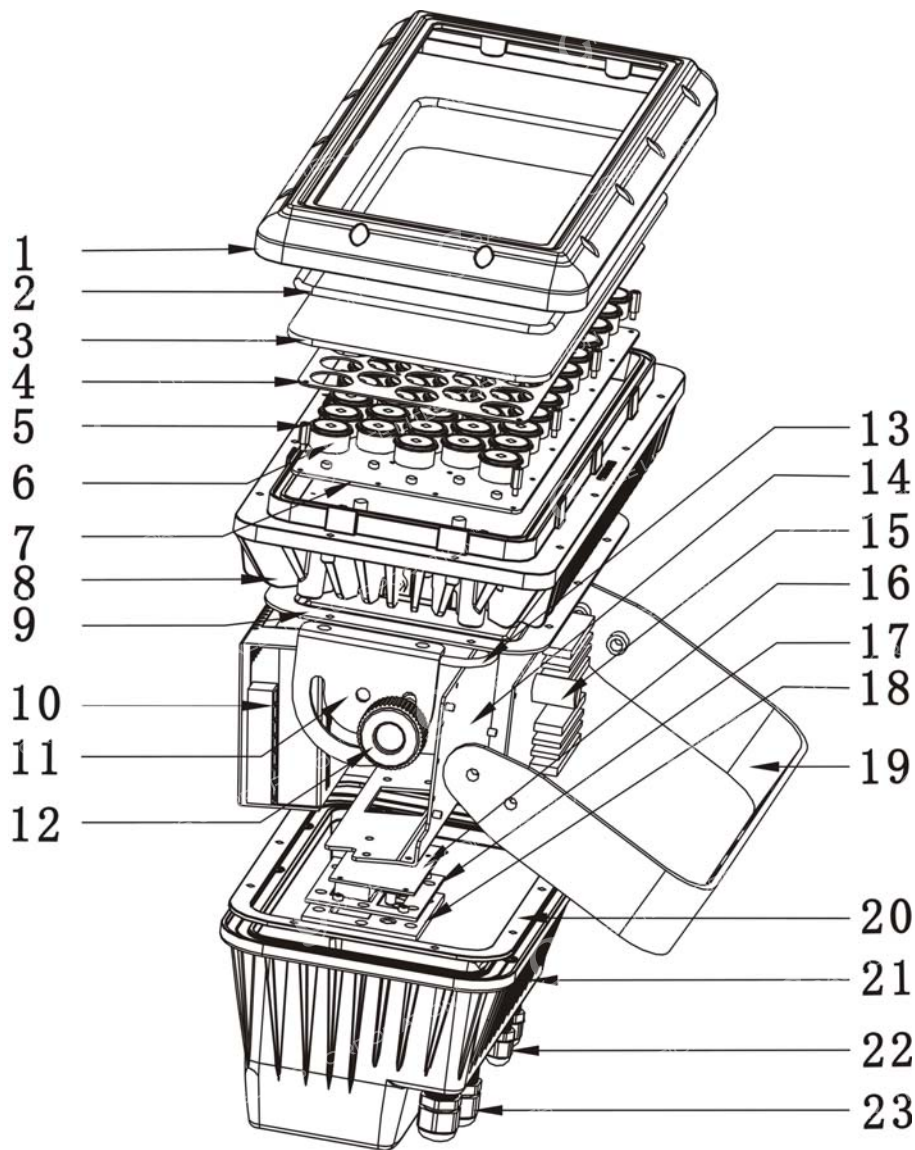

No.	Inquire number	No.	Inquire number
1	M0400150	13	M0300774
2	M0300772	14	M0101976
3	M0600825	15	Z0600160
4	M0101977	16	Z0600323
5	M0202129	17	M0101965
6	M0600908	18	M0300768
7	Z0600722	19	M0101979
8	M0400149	20	M0300773
9	M0101945	21	M0400151
10	M1000921	22	M1300767
11	M0101978	23	M1300768
12	M0300507		

13. TROUBLE DISPOSE

It is recommended some solution for some normal trouble shooting. Any electrical problem should always be handled by the professional person. Disconnect the power supply before maintenance the light.

●LED off:

1. Please check if install the suitable voltage
2. Please check whether the led will reach the end of their life can explode; please replace a same description led.
3. Please check if the power supply is enough.
4. Please check whether the DMX 512 controller pass the "turn on" order.

●Though the light is lighting, but it couldn't accept the control order:

1. Please check the start code address and the function option are correct.
2. Please check whether the communicate control cable is on good connection or the cable is too long or interrupt.
3. Please check the control system is not valid, check the signal amplifier of chain connected is valid.

4. Please check whether the communicate cable is too long or the other equipment is mutually conjugate.
 5. Please arrange the wire well, shorter the signal cable, put the high voltage cable and low voltage cable separately.
 6. Add the signal amplify isolator.
 7. Signal cable is used the excellent screening doublet (Resistance 75 OHM)
 8. The end the light and the end resistance.
- The light can't move:
1. Please check if the power supply is suitable for the light voltage data.
 2. Please check the fuse of input voltage is defective.
 3. Please check the light if there is deformation, inside parts is broken, become wet etc, will lead the loose contact.

14. CLEANING AND MAINTENANCE

- 1. In order to ensure the projector could work normally. It should be kept clean always .The lens should also be regularly cleaned to maintain an optimum light output. Do not use any type of solvent on lens. It will damage the projector.
- 2. Suggestion: The continue usage of the light don't exceed 4 hours. Or it will shorter the usage of the lamp. Please use the alternative operation to solve this problem.
- 3. Please disconnect the power supply when begin to maintenance take down the light. Please let the parts cool down 10 minute at least then begin to install.
- 4. Please inspect the lens or other moving parts timing and keep them clear and static. If find anything damaged or looseness must change a lamp or fix the lamp in order to avoid the accident.

CAUTION!

Disconnect from mains before starting maintenance operation.

1.5. DUTY EXONERATIVE AND COPYRIGHT PROTECTION

- Any products broken that didn't according to the instruction is not guarantee to keep it in good repair.
- The commentary for all the instruction belongs to the supplier in final.
- No authorize can't copy.