

TROUBLE SHOOTING

If the unit doesn't operate...	Check that the batteries are installed correctly, or Install new batteries.
If the volume is too low...	Install new batteries.
If the voice/music begins playing at a very high or low rate of speed...	Install new batteries.
If there is a continuous buzzing sound and the unit doesn't operate...	Install new batteries.
If the unit malfunctions...	Install new batteries.
If the lights become dim...	Install new batteries.

IMPORTANT INFORMATION

Care instructions:

- Keep the unit clean by wiping it with a slightly damp cloth.
- Keep the unit out of direct sunlight and away from any direct heat source.
- Do not expose the unit to moisture or water.
- Lamps cannot be changed on this product.

This product complies with the essential requirements of European directives 88/378/EEC, directives 89/336/EEC, 92/31/EC, 93/68/EEC, 2004/108/EC, 2002/96/EC, 2003/108/EC and 2002/95/EC.

InspirationWorks UK Ltd

Prudence Place
Proctor Way
LUTON
Bedfordshire
LU2 9PE
UK



www.inspirationworks.co.uk

www.firemansamonline.com

© 2010 CIDE Toys

© 2010 Prism Art & Design Limited. The Fireman Sam name and character are trademarks of Prism Art & Design Limited.

© HIT Entertainment Limited. HIT and the HIT logo are trademarks of HIT Entertainment Limited.

Warranty:

Should you in the unlikely event experience any problems with this product all our products have a six month guarantee. In the first instance, return the product back to the place of purchase where a replacement will be issued.

V00
May 2010
Printed in China
Made in China



WASTE ELECTRICAL PRODUCTS AND BATTERIES SHOULD NOT BE DISPOSED OF WITH HOUSEHOLD WASTE. PLEASE RECYCLE WHERE FACILITIES EXIST. CHECK WITH YOUR LOCAL AUTHORITY FOR RECYCLING ADVICE



AGE 2+

MY FIRST FIREMAN SAM LAPTOP

Instruction manual

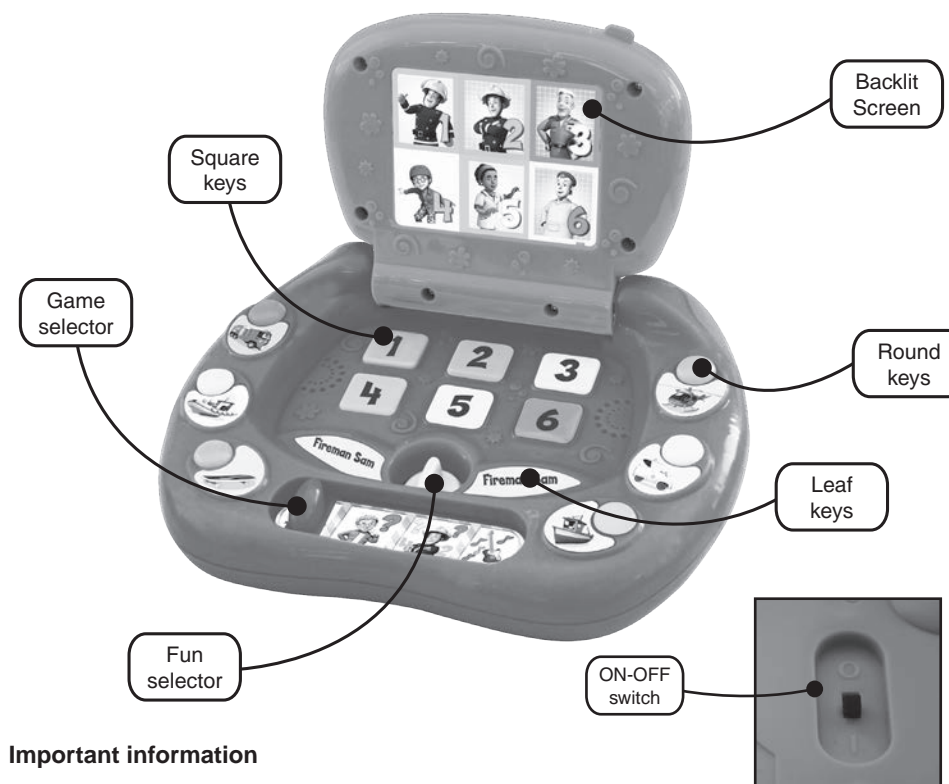

Important information

- This toy is suitable for children aged 2 years & over.
- Please retain this manual for further reference.
- **WARNING:** All packing materials such as internal bags, plastic collars, plastic films, carton inserts are not part of this product and should be discarded for your child's safety.
- **IMPORTANT:** for additional safety, check toys regularly for signs of damage during use.

CONTENT

- My First Fireman Sam Laptop
- This instruction manual

S0898



HOW TO PLAY

To switch the unit ON, move the switch located at the bottom of the unit.

Open the lid and the Laptop will play a welcome tune.

The Laptop offers 4 different game modes to play with. The game mode is selected using the game selector.

Game 1: Discovery mode

This game is selected when moving the game selector to the very left. In this mode, you can meet the Fireman Sam™ characters, discover their 6 different vehicles names and sounds by pressing the various keys of the laptop:

- The 6 square keys describe the pictures on the screen.
- The 6 round keys on the side describe the vehicle nearby, and give its sound.
- The 2 leaf keys and the fun selector play some cute tunes once pressed or turned, lighting up the screen at the same time.

Game 2: Quiz mode

This game is accessed by sliding the game selector one step to the right, from the Discovery mode.

My First Fireman Sam Laptop will ask you to find a specific character or vehicle. To answer the question, you simply have to press the corresponding key, or associate the square keys to the characters on the screen that have the same relative position. e.g. square key 1 corresponds to Fireman Sam™ picture on the screen. You have three attempts to give the correct answer. If after three attempts you have not found the correct answer, *My First Fireman Sam Laptop* will ask you another question.

Game 3: Colours & Counting Quiz mode

This game is accessed by sliding the game selector one step to the right, from the Quiz mode.

My First Fireman Sam Laptop will ask you questions on colours and quantities. To answer the question, you simply have to press the corresponding key. You have three attempts to give the correct answer. If after three attempts you have not found the correct answer, *My First Fireman Sam Laptop* will ask you another question.

Game 4: Music and sounds mode

This game is accessed by sliding the game selector to the very right.

In this mode, press on keys to hear music, notes and sounds!

- Each of the 6 square keys triggers a different musical note when pressed. You can compose your own tunes!
- The 6 round keys on the side give the vehicle sounds.
- The 2 leaf keys and the fun selector play some cute tunes once pressed or turned, lighting up the screen at the same time.

At any time, closing the lid will stop the games and send *My First Fireman Sam Laptop* into sleep mode.

HOW TO CHANGE BATTERIES

1. This product requires 3 x “AA” (LR6-AM3) 1.5V batteries
2. When required, using a suitable screwdriver, undo and remove the battery cover located under the unit.
3. Insert 3 x “AA” (LR6-AM3) 1.5V batteries into the compartment ensuring they are installed the correct way around.
4. The polarities are marked inside the battery compartment.
5. Should the batteries have no polarity markings, the flat end of the battery should always be inserted against the spring.
6. Reassemble the battery cover and tighten the screw to secure.
7. Do not over tighten.

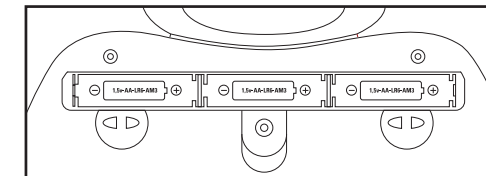

Please note the important points below when using batteries to power this product:

- Batteries should be inserted and removed by an adult.
- Only use the type of batteries specified in this user manual, or equivalent type. We recommend the use of alkaline batteries.
- Follow the polarity diagram inside the battery compartment and the polarity markings on the batteries.
- An incorrect location may either damage the toy, or cause battery leakage, or, to an extreme degree, lead to battery explosion.
- Do not try to charge non-rechargeable batteries, as they may leak or explode.
- Replace all batteries at the same time.
- Do not mix new with old batteries
- Do not mix different types of batteries (i. e. alkaline and zinc carbon).
- Remove the batteries during long periods of non-use. Always remove exhausted batteries from the product. Battery leakage and corrosion can damage the product.
- Do not short-circuit the supply terminals. Store batteries away from metal objects.
- Do not dispose of batteries in fire, as they may leak or explode. Never disassemble batteries.
- Rechargeable batteries should not be used.
- When rechargeable batteries are used anyway :
 - Rechargeable batteries shall be charged only under the supervision of an adult.
 - Rechargeable batteries shall be removed from the toy before being charged (if they can be removed).
- If a battery is swallowed, consult a Doctor or Medical Facility, don't forget to take the product with you
- If battery leakage occurs and come in contact with the skin or eyes, wash immediately with lots of water.
- Batteries are included for demonstration purposes only and may need replacing after purchase.
- The normal function of the product may be disturbed by Strong Electro Magnetic Interference. If so, simply reset the product to resume normal operation by following the instruction manual. In case the function could not resume, please use the product in another location.