

1. Safety Cautions

Electrical hazards

CAUTION Be careful the details below when you use.

Do not use a damaged power cord or loose outlet.

Risk of electric shock or fire.

Do not pull the cord when taking out the power cord, and keep wet hands away from connecting plug.

Risk of electric shock or fire.

Never pull the plug out of the outlet during the incubation period.

Incubation will be interrupted.

Do not twist or crush electric cord.

Risk of electric shock or fire.

Do not insert multiple connecting plugs in an outlet.

Risk of fire or electrical overload.

Setting Cautions

CAUTION Be careful the details below when you use.

Do not use for man.

Injury or death hazard

Do not leave an animal alone for a long time with the door closed.

Death hazard

Do not install in dusty or dirty environment.

Risk of damage or fire within the machine.

Do not install under the direct sunlight.

Risk of fire or interference with the incubation process.

Do not install in moist or humid environment.

Risk of fire or electric shock.

Do not install in excessively cold or hot conditions, cigarette smoke, etc.

Risk of interference with operation.

Install away from heat sources.

Risk of damage to the machine case and interference with operation.

Ensure that the machine is installed on a stable surface away from edges.

Risk of damage to machine and eggs and user from accidental knocks or drops.

Do not turn the machine upside down.

Water will pour out of the machine, and view window can be dropped or damaged.

Do not install where children or other people can touch with easy.

Risk of knocking the incubator or accidental interference with the controls.

Do not disassemble or modify the machine in any way.

Risk of electric shock or fire.

Please ensure that no small objects get into the holes in the machine.

Risk of electric shock or fire.

If the machine sounds strange or emits smoke contact your service center.

Risk of electric shock or fire.

Clean the machine thoroughly before storing.

If the machine requires repair disconnect from the power supply and please contact to your service center.

Cleaning Cautions

CAUTION Be sure to disconnect the electric cord from the outlet before cleaning.

Do not spray cleanser directly on the machine surface.

Clean the machine by a soft cloth with a neutral detergent.

Brush away dust on the plug with a dry cloth.

Do not use chemicals like wax, benzene, alcohol, thinner, aromatic, or lubricant, etc.

For special cleaning of inner part per year, contact to the service center.

If you don't clean the inside of machine for a long time, dust can cause some trouble or a fire.

2. Main Body and Name of Each Part



3. Basic Components

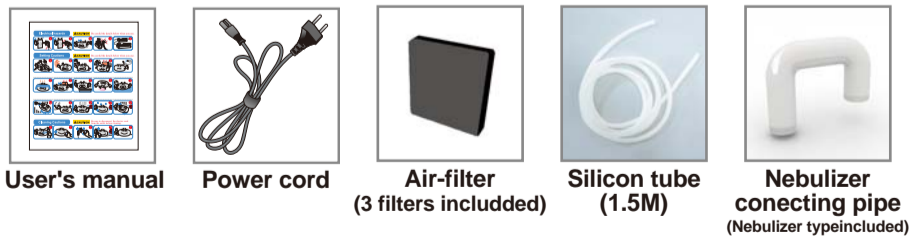

4. Components to be sold separately



5. Effect of Anion/ Option Application



Anion ...

The reason why we feel refreshing when we are in woods or mountain is that there are much anion, the atom element with electric charge. If we get anion, it increase the vitality by accelerating metabolism of cell. And, it cleans our blood and helps recovering from fatigue, heavy sleep, and improvement of appetite .

► Nebulizer, Oxygen tank Application Example



※ Nebulizer & Oxygen tank- Sold Separately

6. Before use

[Fig.- A]

[Fig.- B]

Please do not place water tank on the Brooder and use.

► Open the water cap on the front left and plenish the water as shown in Figure A. Please put silicon hose insert to the nipple to be supplied the water in the water tank.

► Connect the power as shown in Figure B.

※ Environmental room conditions(Temperature: 20-20 C°, Humidity: 40-60 %) If room temperature or humidity are against from the range,It can not be controlled automatically for setting condition.

The movement of device with water filled could cause failure so do not fill the water until the device is installed completely.

water container should have placed lower than sticker line of the machine. If not, water will be flowed out owing to water pressure.

7. Functions of Operation Part

Heater activation lamp

Temperature up

Temperature down

Conversion between Celsius / Fahrenheit

Nebulizer ON (Option)

Nebulizer OFF (Option)

TEMPERATURE

25.0 °C

HUMIDITY

50 %

HEAT

HUMI.

ANION

TEMPERATURE

HUMIDITY

SET

C/F

ON

NEBULIZER(OPT)

OFF

Anion activation lamp

Humidity activation lamp

Humidity Up

Humidity Down

Set

Anion ON/OFF

Dimmer Bright

Dimmer Dim

Intensive Care Unit

8. Easy Function Operation

Temperature setting	SET HOLD	➡ + TEMPERATURE - Set temperature to the required figure
Humidity setting	SET HOLD	➡ + HUMIDITY - Set humidity to the required figure
Initialization (Factory setting)	POWER OFF ➡ SET HOLD ➡ POWER IN ➡ rst	
How to turn off heater manually	SET HOLD	➡ + TEMPERATURE - H.OFF (HEATER OFF) Keep pressing Temperature Down button until "H.OFF" comes out.
How to turn off ventilation fan manually	SET HOLD	➡ + TEMPERATURE - A.OFF (FAN OFF) Keep pressing Temperature Down button until "H.OFF" appears. Then, press once again so that "A.OFF" appears.
How to turn off humidification device manually	SET HOLD	➡ + HUMIDITY - U.OFF (HUMIDITY OFF) Keep pressing Humidity Down button until "UOFF" comes out.

9. How to Use

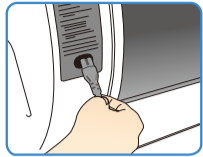

[Figure-A]

- ON** Connect the power cord as shown in Figure A to activate the unit
- OFF** Pull the plug off from the back of unit to turn power off

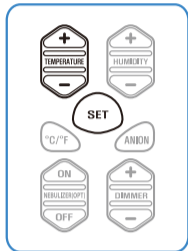
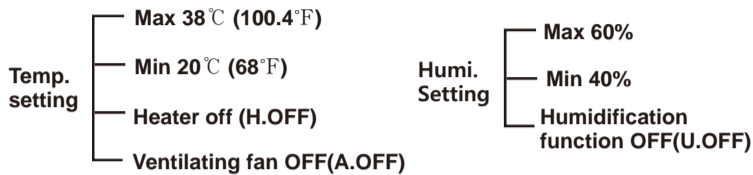

► **How to set Temperature**
Press TEMP+/TEMP- while being pressed SET button. Temperature will be input automatically.

► **How to set "OFF" to Heating / How to set "OFF" to Circulating**
If you set the temperature below 20°C, heater function will automatically stop operating. Then, the display show H.OFF and press "Temp-" button again (SET button is kept pressing) for stopping air ventilation fan, Display will show A.OFF. If you want to operate Heater or Air Ventilation Fan, Kept pressing SET button and press TEMP+ button in reverse order.

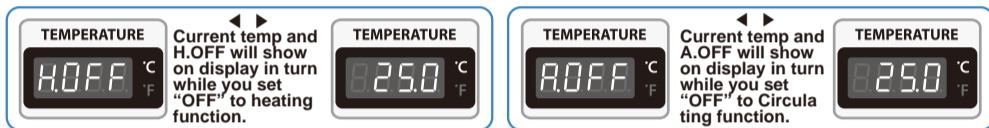

※ Display will show temperature even if you stop heater or air ventilation fan function. When you stop ventilation fan, indoor air will not be circulated and the temperature will not show exactly.

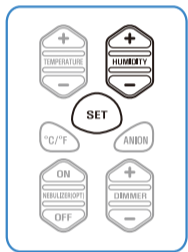

► **How to set Humidity**
Press TEMP+/TEMP- while being pressed SET button. Temperature will be input automatically.

► **How to set "OFF" to Humidity**
If you set the temperature below 20°C, heater function will automatically stop operating. Then, the display show H.OFF and press "Temp-" button again (SET button is kept pressing) for stopping air ventilation fan, Display will show A.OFF. If you want to operate Heater or Air Ventilation Fan, Kept pressing SET button and press TEMP+ button in reverse order.



⚠ **please set "off" to heating in case you do not want to activate the heating, Heating unit lifespan will be more longer.**

※ Display will show humidity even if you stop humidification function. When you stop ventilation fan, indoor air will not be circulated and the humidity will not show exactly.

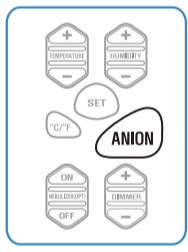

► **How to turn on/off ANION**

- ON** One time pressing of ANION button makes the Anion lamp turns on and the Anion starts to be generated.
- OFF** One more time pressing of ANION button makes the Anion lamp turn off and stops the generation of Anion (please refer to "Anion Effect")

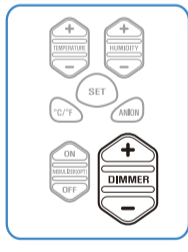

► **How to control the brightness of Indor(Dimmer)**

- Control the brightness of dimmer by pressing up button(+)/down button(-)
- Keep down button(-)pressed to turn dimmer out.
- Control to 10 stages of brightness

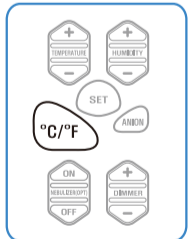

► **Convert from °C(Celsius) to °F(Fahrenheit) or from °F to °C**

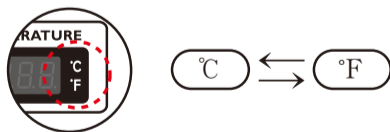

► Press °C/°F from one to the other(°C ↔ °F)

10. Dew Condensation

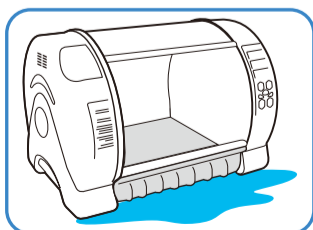

► Water can run out of view window, tray, or bottom part when the inner and outer temperature gap is variation in big. It is natural phenomenon, and it can remarkable at the high humidity condition. For preventing this, you should install the unit where the temperature gap between until inside and outside room are not big.

► If you turn off the machine directly. Remained water can form dew and stick to the wall of the unit. Remove water and operate for about an hour for preventing dew before turn off.

► When you do not use the unit for a long time, open the window and dry at the well ventilated room for a day.

※ Electric part of the units is coated specially for preventing moisture.

11. How to initialize the incubator

- It is used to return the incubator to the factory setting.
- Keep SET button pressed and unplug the power cord and re-plug. Then, "rSt" will appear on the temperature display and incubator returns to factory setting.

12. How to clean

- pull out the power cord from the connection jack on the back and disconnect the power plug from outlet.
- clean air-filter once a week, otherwise fault air flow can cause failure of machine.
- clean inside of humidity tank once a week, otherwise water level sensor (plot switch) can not be operated and it can cause failure of machine.
(We do not provide warranty for failure of humidity tank if you don't clean up properly)

⚠ **Please do not touch the humidity unit. It can cause body burn.**

► clean inside of brooder as shown below. (Please refer humidity tank and filter)

► After remove tray, clean the window with soft cloth

1

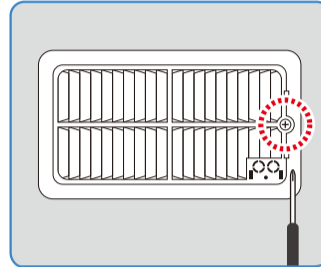

Unscrew with driver.

2

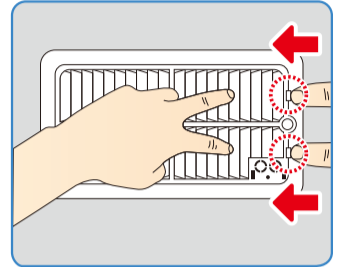

Push the marked point, pull and remove cover.

3

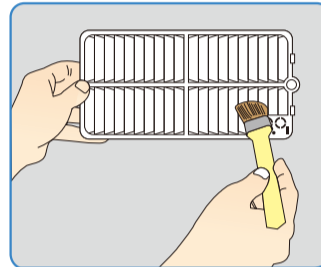

Brush and wash.

4

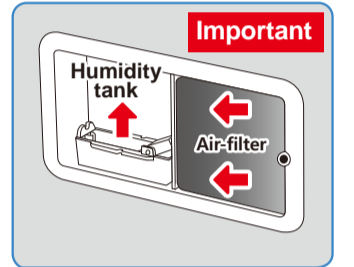

Pull out humidity tank, and remove air-filter and wash (once a week)

5

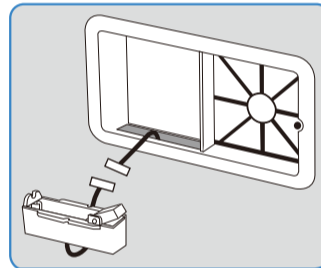

Disconnect connector, beware of not falling it inside of brooder

6

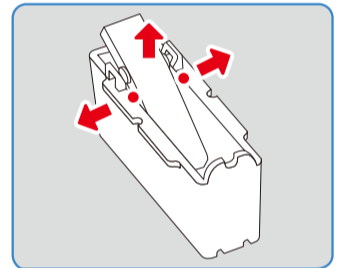

Spread slightly and remove plot. Clean scale inside of the water tank

⚠ **Cleaning cycle for air-filter and humidity tank :**
Wash air-filter once a week and replace with new air filter every 6 to 12 months.
Wash humidity tank once a week.

⚠ **We recommend you to use distilled water not for forming foreign substance (scale) in humidity tank. If you want to use other water, please ask purchase shop or send us email (Rcom@Rcom.co.kr). Do not use underground water and limewater. Clean once a week. We do not provide warranty for failure of humidity tank if you don't clean up properly.**

⚠ **Do not clean the incubators with benzene or thinner, it can cause modify or bleach.**

13. Specifications

Model No.	MX-BS500, MX-BS500(N)	MX-BL500, MX-BL500(N)
Power input	AC 100~110[V], 50/60[Hz] / AC 220~240[V], 50/60[Hz]	
Temperature control	Ambient temperature ~ 38[°C] (Ambient temperature ~ 100.4[°F])	
Working temp. Ambient temp.	20~ 25[°C] (68~77[°F])	
Humidity control	40 ~ 60[%] (Subject to change depending on the ambient environment)	
Working humi. Ambient temp.	40~ 60[%]	
Power consumption	Max. 100[W] / Average 60[W]	Max. 130[W] / Average 75[W]
Weight	9 [Kg] (N.W.) 13 [Kg] (G.W.)	10 Kg (N.W.) 14.5 [Kg] (G.W.)
Size	(W) 655x(L) 470x(H) 440 [mm]	(W) 855x(L) 470x(H) 440 [mm]
Fuse Standard	250[V] 5.0[A] (Ø6x30[mm])	

Visit our web site (www.Rcom.co.kr) for more information on our products and other informations. Update of information : download the necessary information from resource room in Rcom homepage. Rcom digital incubator is designed for easy and convenient use. For the improvement of the functions of the incubator, design, how to use, etc. can be changed without notice in advance.

AUTOELEX CO.,LTD.

• Head Office : Deokam 612 Juchon Gimhae 621-843 KOREA
• TEL : 82-55-337-2560 (Direct to sales team)
82-55-337-2561~3 (Office)
• FAX : 82-55-337-2568
• E-MAIL : Rcom@Rcom.co.kr

⚠ **The environment inside of brooder can be changed depending on various reasons and the manufacture and stores do not have responsibility for any loss in any case included users' fault, change purpose, and blackout.
(When you take care of high price animals, you must pay attention, especially)**