

# EnVivo

## User Manual

### Bluetooth Soundstage



#### AFTER SALES SUPPORT



GB 0333 200 5846 RE 1890 917 060



accessionx-uk@teknihall.com

MODEL: 67618

- Bluetooth Soundstage
- Remote control
- RCA & Line-in cable
- Power adaptor
- User Manual

# 3

YEAR WARRANTY

## WELCOME

You have made an excellent choice with the purchase of this quality EnVivo brand product.

By doing so you now have the assurance and peace of mind, which comes from purchasing a product that has been manufactured to the highest standards of performance and safety, supported by the high quality standards of EnVivo.

We want you to be completely satisfied with your purchase so this EnVivo product is backed by a comprehensive manufacturer's 3-year warranty and an outstanding after sales service through our dedicated Helpline.

We hope you will enjoy using your purchase for many years to come.

If you require technical support or in the unlikely event that the purchase you have made is faulty, please telephone our Helpline for immediate assistance. Faulty product claims made within the 3 year warranty period will be repaired or replaced free of charge provided that you have satisfactory proof of purchase (keep your till receipt safe!) This does not affect your statutory rights. However, be aware that the warranty will become null and void if the product is found to have been deliberately damaged, misused or disassembled.

## IN THE BOX

- Soundstage
- Remote control
- AC adapter
- Audio cable
- Manual
- Warranty Card

### AFTER SALES SUPPORT



0333 200 5846 1890 917 060

accessionx-uk@teknihall.com

MODEL: 67618

- Bluetooth
- Soundstage
- Remote control
- RCA & Line-in cable
- Power adaptor
- User Manual



# PRODUCT OVERVIEW

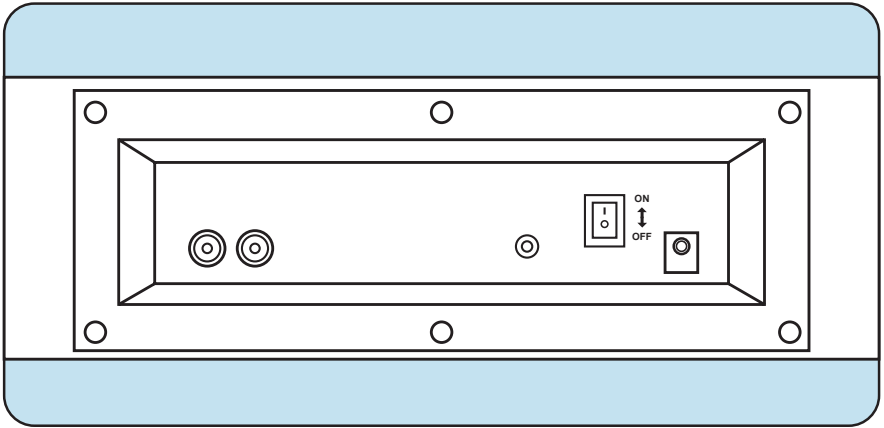

1. Power
2. Mute
3. Music Mode
4. Treble
5. Volume
6. Bass
7. Source

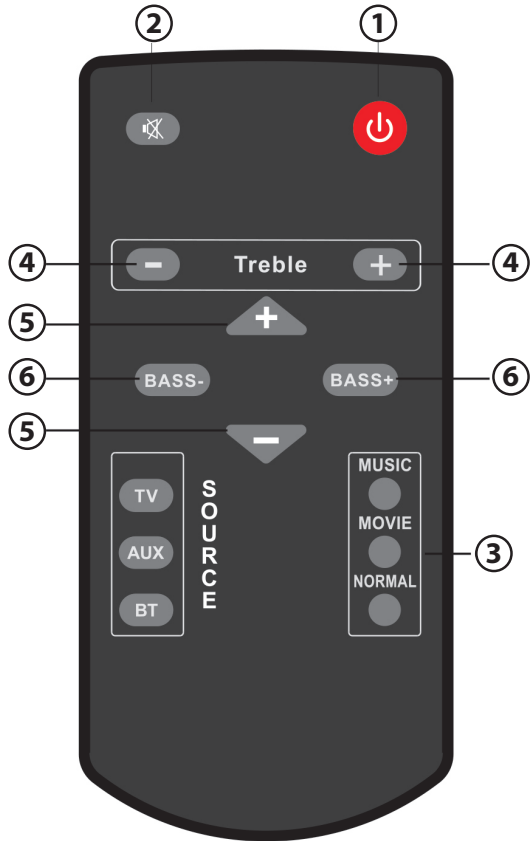

## AFTER SALES SUPPORT

☎ 0333 200 5846 ☎ 1890 917 060

📧 [accessionx-uk@teknihall.com](mailto:accessionx-uk@teknihall.com)

MODEL: 67618

- Bluetooth Soundstage
- Remote control
- RCA & Line-in cable
- Power adaptor
- User Manual



# GETTING STARTED

## Buttons Function

1. **Power** – Click to turn the speaker ON and OFF.
2. **Mute** – Click on this button to Mute and Unmute the soundstage
3. **Sound mode** – There are 3 sound modes suiting the different sound sources.  
**Music Mode** is tuned for general songs. The treble is higher and the bass is stronger, the signal is more dynamic.  
In **Movie Mode**, vocals are stronger and the surround sound effect is enhanced. This combined with the 3D sound effect, make the overall feeling more realistic.  
**Normal Mode** is tuned for general playback of all sound sources. It is a good balance of vocal, treble and bass.
4. **Treble** – Adjust the treble of the unit by using the + and – buttons for treble on the remote control.
5. **Volume** – Adjust the volume up and down by using the + and – buttons on the remote control.
6. **Bass** – Adjust the bass of the unit by using the Bass- and Bass+ buttons on the remote control.
7. **Source** – Select the desired sources by clicking one of the three different source buttons; **TV, AUX & BT**

### AFTER SALES SUPPORT



0333 200 5846 1890 917 060

accessionx-uk@teknihall.com

MODEL: 67618

- Bluetooth
- Soundstage
- Remote control
- RCA & Line-in cable
- Power adaptor
- User Manual

# 3

YEAR WARRANTY

## SETUP

### Power:

Plug the small end of the power cord into the DC input on the back of the speaker, and the large plug into a standard wall outlet.

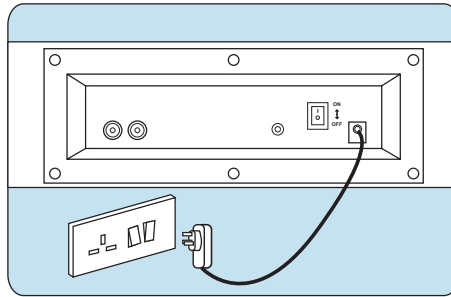

### Remote control:

Put 2 x AAA batteries inside the remote control.

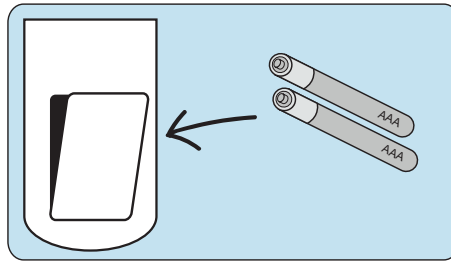

### Placement of TV on the unit:

Place the TV in the center of the soundstage unit for better sound quality and a more stable position.

**Note:** The max load on the soundstage is 30kg



### AFTER SALES SUPPORT

☎ 0333 200 5846 ☎ 1890 917 060

📧 [accessionx-uk@teknihall.com](mailto:accessionx-uk@teknihall.com)

MODEL: 67618

- Bluetooth Soundstage
- Remote control
- RCA & Line-in cable
- Power adaptor
- User Manual

# 3

YEAR WARRANTY

## BLUETOOTH CONNECTION

### Pairing a Bluetooth Device for the First Time

1. Power on the unit by pressing the Power button.
2. Press the BT button on the remote control to enter Bluetooth mode, this will be indicated by a blue light. The Led light will flash blue when in pairing mode.
3. Using the native controls on your Bluetooth device, select the "ENV-1392A" in your Bluetooth settings to pair.
4. When successfully paired and connected, the blue LED Indicator will display a solid blue light. After initial pairing, the unit will stay paired unless unpaired manually by the user.

**Note:** If your device should become unpaired or you find it is unable to connect, repeat the above steps.

**Note:** When pairing, remain within 3 feet of the unit.

**Note:** If your device requests a password, enter the default "0000". Refer to the "user's manual" for your specific device for instructions on pairing and connecting Bluetooth devices.

**Note:** When you switch to BT mode, the unit will search for last connected device automatically. If it is found and paired, the blue LED will display a solid blue light. This process may take 10 seconds or more.

### Playing Audio Wirelessly

1. Follow the instructions for **Pairing a Bluetooth Device**.
2. Use the native controls on the connected Bluetooth Device to select a track.
3. To play, pause or skip the selected track, use the native controls on the connected Bluetooth Device.
4. Audio played through the connected Bluetooth device will now be heard through the speakers.

#### AFTER SALES SUPPORT



GB 0333 200 5846 IE 1890 917 060



accessionx-uk@teknihall.com

MODEL: 67618

- Bluetooth
- Soundstage
- Remote control
- RCA & Line-in cable
- Power adaptor
- User Manual

# 3

YEAR WARRANTY

## USING THE RCA INPUT

When connecting two products using an RCA cable, match the coloured ports with the same coloured connection.

1. Connect the RCA Cable to the RCA Stereo Inputs located on the back of the unit, and to the audio outputs on the television.
2. Press the **Power** button to power on the unit.
3. Press the **TV** button on the remote control to enter **TV Mode**, indicated by a yellow light.
4. Audio played through the television will now be heard through the speakers.

**Note:** If the connection to TV output is “headphone”, do not turn the volume of the TV, to more than half of the maximum volume, to prevent distortion of sound signal.

## USING THE LINE IN INPUT

1. Plug one end of a 3.5 mm audio input cable (not included) into the **AUX IN** port on the unit.
2. Plug the other end of the cable into the audio output/headphone output on an MP3 Player or other audio source.
3. Press the **Power** button to power on the unit.
4. Press the **AUX** button on the remote control to enter **AUX IN Mode**, indicated by a green light.
5. Audio played through the connected device will now be heard through the speakers.

## LED INDICATORS

- Red LED
  - o Power indicator
  - o Volume indicator
  - o Input mode button indicator
- Green LED
  - o AUX input indicator
- Yellow LED
  - o TV input indicator
- Blue LED
  - o Bluetooth input indicator

### AFTER SALES SUPPORT



☎ 0333 200 5846 ☎ 1890 917 060

accessionx-uk@teknihall.com

MODEL: 67618

- Bluetooth Soundstage
- Remote control
- RCA & Line-in cable
- Power adaptor
- User Manual



**Note:** Please wait a few seconds to issue another command when you change input mode or turn on the unit.

## SPECIFICATIONS

- 2.1 Channel Speaker System
- Bluetooth v3.0
- Wireless range: 33 feet
- Digital volume control
- 3.5mm audio input
- RCA stereo audio inputs
- Output power: 10W(L) + 10W(R) + 30W(Sub), total: 50 watts
- Steel speaker grill
- 3 Sound modes: Music, Movie & Normal
- Product dimension: 550(W) x 330(D) x 76(H)mm
- Max load on Soundstage: 30kg

## WARNING

- This appliance is for household, indoor use only.
- To reduce the risk of fire or electric shock, do not expose this appliance to rain or moisture.
- The warranty for this appliance is invalidated if the appliance has been tampered with in any way. There are no user serviceable parts inside this product.
- Do not place this appliance directly onto furniture surfaces or soft, porous, or sensitively finished goods. As with any rubber compound made with oils, the feet could cause marks or staining where the feet reside. We recommend using a protective barrier such as a cloth or a piece of glass between the appliance and the surface to reduce the risk of damage and/or staining.
- Use of this appliance near fluorescent lighting may cause interference regarding use of the remote. If the appliance is displaying erratic behaviour move away from any fluorescent lighting, as it may be the cause.
- The battery, batteries, and battery pack shall not be exposed to excessive heat such as sunshine, fire, or the like.
- Shock hazard - Do Not Open.

## CAUTION

### AFTER SALES SUPPORT

 GB 0333 200 5846  1890 917 060

 [accessionx-uk@teknihall.com](mailto:accessionx-uk@teknihall.com)



MODEL: 67618

- Bluetooth Soundstage
- Remote control
- RCA & Line-in cable
- Power adaptor
- User Manual





- To prevent electric shock, make sure the plug is correctly and fully inserted.
- Always unplug the appliance from the power outlet when it is not in use and before cleaning. Only use this product with the adapter provided.
- Use of any controls or adjustments or performance of procedures other than those herein specified may result in hazardous radiation exposure.
- Danger of explosion if battery is incorrectly replaced. Replace only with the same or equivalent type.

	<p>WARNING: TO REDUCE THE RISK OF ELECTRIC SHOCK, DO NOT REMOVE COVER (OR BACK). NO USER SERVICEABLE PARTS INSIDE. REFER SERVICING TO QUALIFIED SERVICE PERSONNEL.</p>
	<p>The lightning flash with arrowhead symbol, within an equilateral triangle, is intended to alert the user to the presence of uninsulated “dangerous voltage” within the product’s enclosure that may be of sufficient magnitude to constitute a risk of electric shock to persons.</p>
	<p>The exclamation point within an equilateral triangle is intended to alert the user to the presence of important operating and maintenance (servicing) instructions in the literature accompanying the appliance.</p>

<p><b>AFTER SALES SUPPORT</b></p> <p>☎ 0333 200 5846 ☎ 1890 917 060</p> <p>📧 <a href="mailto:accessionx-uk@teknihall.com">accessionx-uk@teknihall.com</a></p> <p>MODEL: 67618</p>	<ul style="list-style-type: none"> <li>• Bluetooth Soundstage</li> <li>• Remote control</li> <li>• RCA &amp; Line-in cable</li> <li>• Power adaptor</li> <li>• User Manual</li> </ul>
---	---



## FAQ

- Q:** My Bluetooth device cannot find the Bluetooth soundstage.
- A:** Try disabling bluetooth on your Bluetooth device, and turn off the soundstage. Now enable Bluetooth on your Bluetooth device, turn on the soundstage again and try to pair again.
- A:** Try connecting the Bluetooth soundstage with another Bluetooth device.
- Q:** Why is there no sound coming out of the Bluetooth soundstage?
- A:** If you are using Bluetooth connection, please check that your Bluetooth device is connected to the Bluetooth soundstage.
- A:** Try turning up the volume on both your Bluetooth device and the Bluetooth soundstage.
- A:** Check that the sound cable is connected to an audio output port on the TV and not an audio input port.
- A:** Check that the correct sound source is selected on the soundstage.
- Q:** The sound quality is very poor through Bluetooth.
- A:** The Bluetooth device might be at max range, please move your Bluetooth device closer to the Bluetooth soundstage.
- Q:** The soundstage does not always react when I click on the remote control.
- A:** Make sure to point the remote control directly at the soundstage.
- A:** Check that the batteries in the remote control is not dead.

### AFTER SALES SUPPORT



0333 200 5846 1890 917 060



accessionx-uk@teknihall.com

MODEL: 67618

- Bluetooth Soundstage
- Remote control
- RCA & Line-in cable
- Power adaptor
- User Manual



## DISPOSAL



Batteries, electrical and electronic equipment (EEE) contain materials, parts and substances, which can be dangerous to the environment and harmful to human health if waste of electrical and electronic equipment (WEEE) are not disposed of correctly.

Batteries, electrical and electronic equipment, which are marked with the WEEE logo (as shown on the left), should not be thrown away with your household waste. Contact your Local Authority Waste Disposal Department, as they will be able to provide details of the recycling options available in your area.

### AFTER SALES SUPPORT



☎ 0333 200 5846 ☎ 1890 917 060



accessionx-uk@teknihall.com

MODEL: 67618

- Bluetooth
- Soundstage
- Remote control
- RCA & Line-in cable
- Power adaptor
- User Manual



# EnVivo

## WARRANTY CARD

**Bluetooth Soundstage - 67618**

Please keep your purchase receipt together with your card.

**NAME** \_\_\_\_\_

**ADDRESS** \_\_\_\_\_

\_\_\_\_\_



**DATE OF PURCHASE** \_\_\_\_\_

**LOCATION OF PURCHASE** \_\_\_\_\_

### Detailed description of malfunction

Accession ApS - Vandmanden 34 - DK - 9200 Aalborg SV  
www.accessionx.com  
accessionx-uk@teknihall.com

#### AFTER SALES SUPPORT



GB 0333 200 5846 DE 1890 917 060

accessionx-uk@teknihall.com

MODEL: 67618

- Bluetooth Soundstage
- Remote control
- RCA & Line-in cable
- Power adaptor
- User Manual

# 3

YEAR WARRANTY