

THE NAVIGATOR

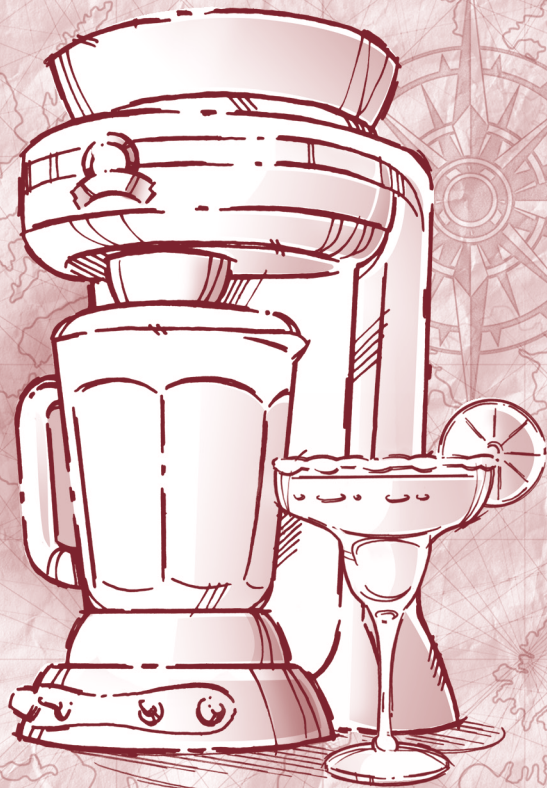

FROZEN CONCOCTION™ MAKER

The Best Margaritas Come From Margaritaville®



Model DM 1000-33 User Manual

IMPORTANT SAFEGUARDS

WHEN USING ELECTRICAL APPLIANCES, BASIC SAFETY PRECAUTIONS SHOULD ALWAYS BE FOLLOWED, INCLUDING THE FOLLOWING:

1. READ ALL INSTRUCTIONS BEFORE USING.

2. To protect against electric shock, do not immerse appliance, cord or plug in water or other liquids.
3. Close supervision is necessary when any appliance is used near children. This appliance should not be used by children.
4. Unplug from outlet when not in use, before putting on or taking off parts, and before cleaning.
5. Blinking power indicator light indicates Appliance is ready to operate. Avoid any contact with blades or moveable parts.
6. Do not operate any appliance with damaged cord or plug or after the appliance malfunctions, or is dropped or damaged in any manner. Contact 1-800-667-8623 for customer service.
7. Do not use outdoors.
8. Do not let cord hang over the edge of a table or counter, or touch hot surfaces, including the stove. Do not use an extension cord.
9. Keep hands and utensils out of container while blending and/or ice shaving to reduce risk of severe injury to persons or damage to the unit. A rubber spatula may be used but must be used only when the appliance is not running.
10. Blades are sharp; handle carefully.
11. Always operate appliance with Jar Lid and Ice Reservoir Lid in place.
12. The use of attachments not recommended or sold by the manufacturer may cause fire, electric shock or injury.
13. Do not use broken, chipped, or cracked Blending Jar or Ice Reservoir.
14. To reduce risk of injury to persons, never place blending blade assembly on base without the Glass Blending Jar properly attached.
15. Do not leave appliance unattended while it is operating.

17. To disconnect, turn control to off, then remove plug from wall outlet.
18. Do not use appliance for other than intended use.
19. Never place fingers or other utensils into feed or discharge areas.
20. Check Ice Reservoir for presence of foreign objects before using.
21. Be certain the Jar Lid and Ice Reservoir Lid are securely locked in place before operating appliance.
22. Do not blend hot liquids.

SAVE THESE INSTRUCTIONS

FOR HOUSEHOLD USE ONLY

Polarized Plug

This appliance has a polarized plug (one blade is wider than the other). As a safety feature, this plug will fit in a polarized outlet only one way. If the plug does not fit fully into the outlet, reverse the plug. If it still does not fit, contact a qualified electrician. Do not attempt to defeat this safety feature.

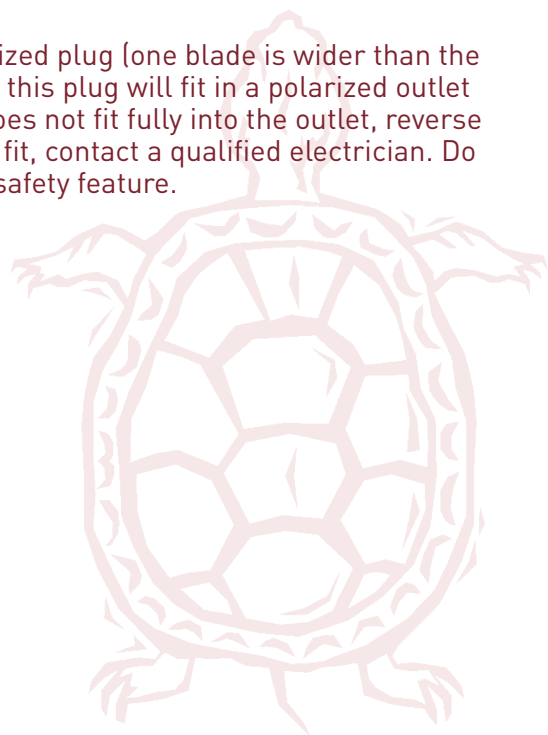



WELCOME

*Congratulations on your purchase of the Margaritaville®
Frozen Concoction™ Maker – DM 1000!*

To learn more about Margaritaville® products,
please visit us at www.margaritavillecargoc.com.

FROZEN CONCOCTION™ MAKER

PARTS LIST

- 1 Ice Reservoir Lid** – Covers the Ice Reservoir.
- 2 Ice Reservoir** – Holds the ice for making frozen drinks.
- 3 Shaving Paddle** – Moves ice across the Shaving Blade.
- 4 Ice Hopper** – Feeds ice from reservoir to Shaving Blade.
- 5 Ice Shaving Blade** – Shaves ice.
- 6 Shaving Blade Assembly Nut** – Holds Shaving Blade in place.
- 7 Ice Chute** – Directs ice from Ice Hopper into Blending Jar.
- 8 Blending Base** – Holds Blending Jar securely in place.
- 9 Control Panel** – Contains all necessary controls to operate your unit

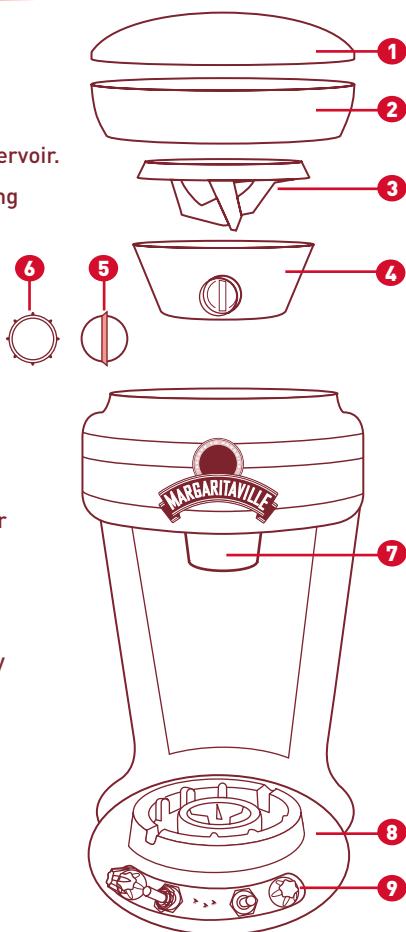

- 10 Jar Lid** – Seals the blending jar.
- 11 Glass Blending Jar** – Made from heavy-duty glass, has maximum capacity of 36 oz.
- 12 Blending Blade Sealing Ring** – Seals the blending jar and blending base.
- 13 Blending Blade** – Creates forward action when blending drinks.
- 14 Glass Jar Base** – Designed with wide base for stability.
- 15 Ice Reservoir Release Button** – Releases ice reservoir from unit.
- 16 Ice Melt Reservoir** – Contains melted ice excess.
- 17 Cord Storage Door** – Covers power cord storage area.

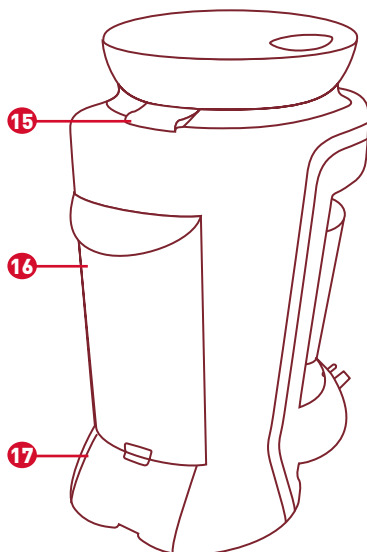
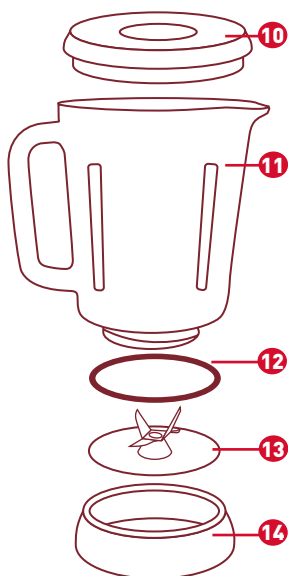

Control Panel

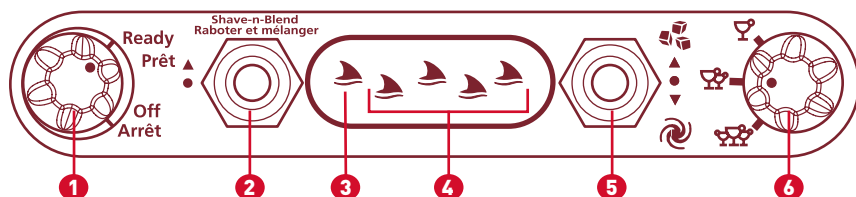

- 1 ON/OFF Rotary Switch** – Turns your unit on and off.
- 2 Shave 'n Blend™ Toggle Switch** – Used to select automatic Shave 'n Blend cycle.
- 3 Power Indicator Light** – Blinks when unit is plugged in and knob is turned to "Ready". Avoid any contact with blades or moveable parts.
- 4 Progress Indicator Lights** – Shows status of Shave 'n Blend cycle.
- 5 Blend Only/Shave Only Toggle Switch** – Used to manually operate ice shaver and blender.
- 6 Number of Drinks Rotary Switch** – used to select 1, 2 or 3 twelve oz. frozen drinks.



MAKING FROZEN DRINKS

1. Place the unit on a clean dry flat surface.
2. Place the Ice Reservoir on the unit front first, then push down firmly on back. Reservoir must click into place.

NOTE: IF ICE RESERVOIR IS NOT SEATED FIRMLY IN PLACE THE UNIT WILL NOT OPERATE.

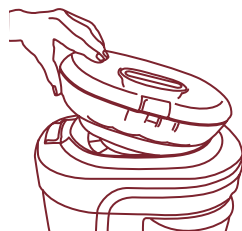

3. Remove the Cord Storage Door by pushing down on the release tab located on the Cord Storage Door. Remove the power cord and plug the unit into a standard 120 Volt wall socket. Replace the cord storage door and position the power cord in the slot below the cord storage release tab.

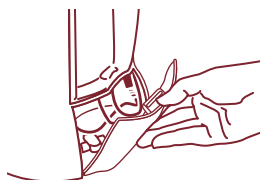

4. Remove the Ice Reservoir Lid using the Release Button located on the top of the Ice Reservoir.

NOTE: NEVER PUT ANYTHING BUT ICE IN THE ICE RESERVOIR.

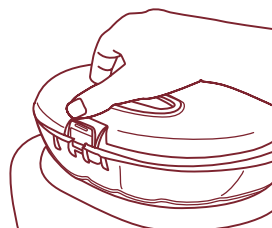

5. Fill the Ice Reservoir with ice cubes.



- Replace the Ice Reservoir Lid and snap closed.
- Lift and remove the Glass Blending Jar. The Ice Chute is spring-loaded and can be pushed up.
- Remove Blending Jar Lid.
- Add appropriate amount of liquid ingredients to the Blending Jar for the number of drinks being made (1, 2 or 3). The glass icons on the Blending Jar show the level of liquid required for 1, 2 or 3 frozen drinks.

NOTE: DO NOT EXCEED THE THREE-GLASS ICON LEVEL OR THE GLASS BLENDING JAR COULD OVERFLOW DURING OPERATION.

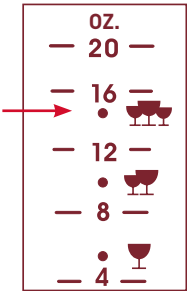

The Best Margarita Recipe

Ingredients	Amount (12 fluid oz drink)					
	1 Drink		2 Drinks		3 Drinks	
	fl oz	ml	fl oz	ml	fl oz	ml
Margaritaville® Gold Tequila	1 1/3	40	2 2/3	80	4	120
Triple Sec	1/3	10	2/3	20	1	30
Lime Juice	2/3	20	1 1/3	40	2	60
Orange Juice	2/3	20	1 1/3	40	2	60
Margaritaville® Margarita Mix	1 1/3	40	2 2/3	80	4	120

- Replace Blending Jar Lid and return Glass Blending Jar to Blending Base by pushing up on the Ice Chute with the Glass Blending Jar and then placing it on the Blending Base.



- Set the Number of Drinks Rotary Switch to correspond to the number of drinks being made.
- Rotate the ON/OFF Rotary Switch on the Control Panel to the “Ready” position.

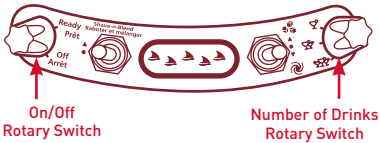

Automated Shave 'n Blend™ Cycle

13. Start the automatic shave and blend cycle by pushing up on the Shave 'n Blend™ Toggle Switch.

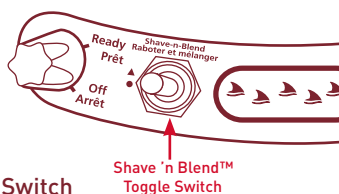

14. The unit will shave ice for the appropriate time (based on the Number of Drinks Rotary Switch setting). The blender will start automatically. The unit will stop at the completion of the cycle.

15. The Power Indicator Light will blink to indicate the unit is ready to make more drinks.

NOTE: DURING THE SHAPE 'N BLEND™ CYCLE THE PROGRESS INDICATOR LIGHTS WILL ILLUMINATE IN A SEQUENCE FROM LEFT TO RIGHT TO INDICATE THE CYCLE PROGRESS.

16. To serve:

- Lift and remove the Blending Jar.
- Remove Blending Jar Lid.
- Pour and enjoy.



NOTE: To remove excess ice from the ice reservoir hold the Shave Only toggle switch in the Shave Only position until the Ice Reservoir is empty. **WARNING: DO NOT PLACE FINGERS IN THE ICE HOPPER THE SHAVING BLADE IS SHARP AND COULD CAUSE INJURY.**

17. Turn off the unit.

18. Periodically check the Ice Melt reservoir and empty as needed.

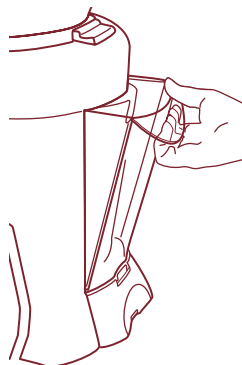

Manual Cycle

To make a thicker drink:

- Hold the “Blend Only/Shave Only” Toggle Switch in the Shave Only position to add more ice to the Blending Jar.
- To stop adding ice, release the toggle switch.
- To mix the newly added ice into the drink, hold the Blend Only/Shave Only Toggle Switch in the blend only position until the desired consistency is achieved. To stop the blending release the toggle switch.

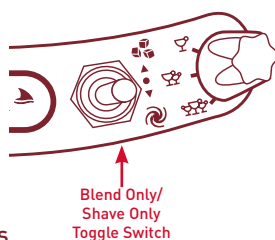

To make a thinner drink:

- Hold the Blend Only/Shave Only Toggle Switch in the Blend Only position until the desired consistency is achieved.
- To stop blending release the toggle switch.

CLEANING AND MAINTENANCE

IMPORTANT: Your Glass Blending Jar, Shaving and Blending Blades are subject to wear during normal use. Always inspect for nicks, chips, or cracks. Always inspect for broken, cracked, or loose blades. If the jar or Shaving and Blending Blades are damaged, do not use. Call our toll-free customer service number, 1-800-667-8623, to obtain replacement parts.

1. Make sure unit is unplugged. Place on a clean dry surface. Turn the unit so the back is facing you. Push down on the Ice Reservoir Release Button. Lift the back of the Ice Reservoir and remove. This will expose the Shaving Paddle and Ice Hopper.

Note the location of the Shaving Blade inside the Ice Hopper.

WARNING: DO NOT PLACE FINGERS INSIDE THE ICE HOPPER NEAR THE SHAVING BLADE. BLADE IS SHARP HANDLE CAREFULLY.

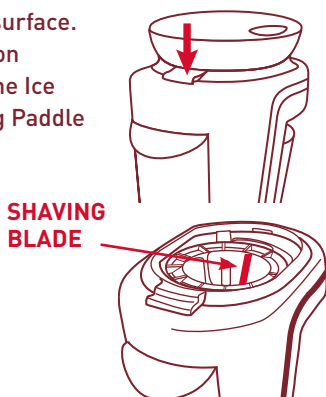

2. To Remove the Shaving Paddle: Press the button located behind the Ice Chute. If the button cannot be pressed, rotate the Shaving Paddle for a half turn and retry.

While pressing the button, rotate the Shaving Paddle counter-clockwise (to the left) by placing fingers in the ridges of the Shaving Paddle and unscrew. This will expose the Ice Hopper and Shaving Blade.

To re-assemble the Shaving Paddle, simply replace it into the threaded insert and rotate clockwise. Hand tighten only.

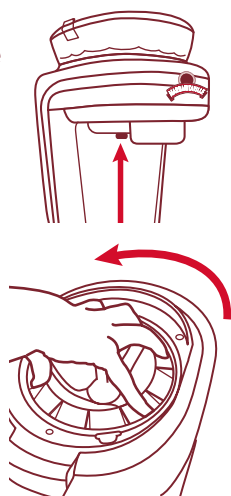

3. Press the two Ice Hopper release catches and lift the Ice Hopper to remove.

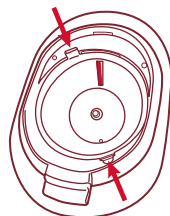

4. Turn the Shaving Blade Assembly Nut counter clockwise (to the left) and remove, then remove the Shaving Blade and store in a safe place.

SHAVING BLADE

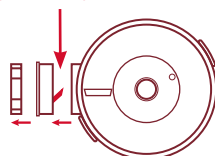

5. Carefully lift the Glass Blending Jar straight up to remove. The Ice Chute is spring-loaded and can be pushed up. If the Blending Jar is not easily removed, rock gently and lift. Do not twist.

6. Turn the Blending Jar upside down and unscrew the Jar Base counter clockwise (to the left). Carefully remove the Blending Blade, and Blending Blade Sealing Ring.

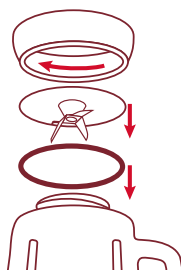

**WARNING: THE BLENDING BLADE IS SHARP.
HANDLE WITH CARE.**

7. To remove the Ice Melt Reservoir hold the unit still and pull straight out on the handle.

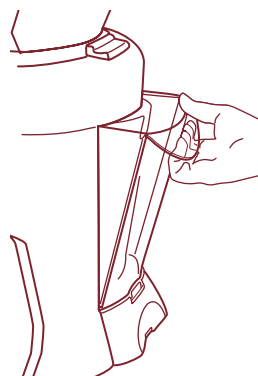

8. The Ice Reservoir Lid, Ice Reservoir, Shaving Paddle, Ice Hopper, Shaving Blade Assembly Nut, Shaving Blade, Blending Jar Lid, Glass Blending Jar, Blending Blade, Blending Blade Sealing Ring, Jar Base and Ice Melt Reservoir can be safely washed in the top rack of your dishwasher. Use only top rack. Failure to do so will result in damage.

9. Use a damp cloth to clean the outside of the unit.

**WARNING: UNPLUG UNIT BEFORE CLEANING. DO NOT USE
SOLVENTS. NEVER IMMERSE THE UNIT IN WATER.**

Troubleshooting

If the Power Indicator Light does not light:

Check that the unit is plugged in and On/Off knob is turned to "Ready".

If liquid leaks from the base of the Glass Blending Jar:

Remove it from the unit and check that the Blending Blade Sealing Ring is properly installed and that the Blending Jar Base is tightened.

If water leaks from the unit: Empty the Ice Melt Reservoir.

If the Glass Blending Jar overflows during the Shave 'n Blend™ cycle:

Check that the liquid level is not above the three glass icons on the Glass Blending Jar.

If the Glass Blending Jar will not sit on the Blending Base:

Remove it from the unit and check for ice on the Blending Base.

WARNING: unplug the unit before removing ice from the Blending Base.

If the shaver does not shave sufficient ice for the liquid in the Glass Blending Jar:

Check that the Number of Drinks Rotary Switch setting corresponds to the amount of liquid in the Blending Jar.

Dos and Don'ts

DO NOT Place fingers into the Glass Blending Jar or Ice Hopper. The blades in this unit are sharp and could cause injury.

DO NOT place Glass Blending Jar onto Blending Base while motor is running. The spinning Blending Base could damage the Glass Blending Jar.

DO NOT twist Glass Blending Jar when removing. Simply lift and remove. Twisting the Glass Blending Jar could loosen the Blending Jar Base causing it to leak.

DO NOT put hot liquid into the Glass Blending Jar. Hot liquids could be ejected during the blending process causing injury.

DO NOT place ice, frozen foods or very cold liquids into a Blending Jar which has come directly from a hot dishwasher. The sudden change in temperature could cause the Blending Jar to crack.

DO NOT place very hot liquids or foods into a Blending Jar that has come directly from the freezer. The sudden change in temperature could cause the Blending Jar to crack.

DO Follow the Cleaning and Maintenance instructions prior to your first use.

DO unplug the unit when not in use.

1-Year Limited Warranty

Sunbeam Products, Inc., doing business as Jarden Consumer Solutions, or if in Canada, Sunbeam Corporation (Canada) Limited doing business as Jarden Consumer Solutions (collectively "JCS") warrants that for a period of one year from the date of purchase, this product will be free from defects in material and workmanship. JCS, at its option, will repair or replace this product or any component of the product found to be defective during the warranty period. Replacement will be made with a new or remanufactured product or component. If the product is no longer available, replacement may be made with a similar product of equal or greater value. This is your exclusive warranty.

This warranty is valid for the original retail purchaser from the date of initial retail purchase and is not transferable. Keep the original sales receipt. Proof of purchase is required to obtain warranty performance. JCS dealers, service centers, or retail stores selling JCS products do not have the right to alter, modify or any way change the terms and conditions of this warranty.

This warranty does not cover normal wear of parts or damage resulting from any of the following: negligent use or misuse of the product, use on improper voltage or current, use contrary to the operating instructions, disassembly, repair or alteration by anyone other than JCS or an authorized Sunbeam service center. Further, the warranty does not cover: Acts of God, such as fire, flood, hurricanes and tornadoes.

What are the limits on JCS's Liability?

JCS shall not be liable for any incidental or consequential damages caused by the breach of any express, implied or statutory warranty or condition.

Except to the extent prohibited by applicable law, any implied warranty or condition of merchantability or fitness for a particular purpose is limited in duration to the duration of the above warranty.

JCS disclaims all other warranties, conditions or representations, express, implied, statutory or otherwise.

JCS shall not be liable for any damages of any kind resulting from the purchase, use or misuse of, or inability to use the product including incidental, special, consequential or similar damages or loss of profits, or for any breach of contract, fundamental or otherwise, or for any claim brought against purchaser by any other party.

Some provinces, states or jurisdictions do not allow the exclusion or limitation of incidental or consequential damages or limitations on how long an implied warranty lasts, so the above limitations or exclusion may not apply to you.

This warranty gives you specific legal rights, and you may also have other rights that vary from province to province, state to state or jurisdiction to jurisdiction.

How To Obtain Warranty Service

In the U.S.A.

If you have any question regarding this warranty or would like to obtain warranty service, please call 1 800-458-8407 and a convenient service center address will be provided to you.

In Canada

If you have any question regarding this warranty or would like to obtain warranty service, please call 1 877 689-2737 and a convenient service center address will be provided to you.

In the U.S.A., this warranty is offered by Sunbeam Products, Inc., doing business as Jarden Consumer Solutions located in Boca Raton, Florida 33431. In Canada, this warranty is offered by Sunbeam Corporation (Canada) Limited, doing business as Jarden Consumer Solutions located at 20B Hereford Street, Brampton, Ontario L6Y 0M1.

**PLEASE DO NOT RETURN THIS PRODUCT TO ANY OF THESE ADDRESSES
OR TO THE PLACE OF PURCHASE.**



DO NOT RETURN THIS PRODUCT TO THE PLACE OF PURCHASE

For product questions:

Sunbeam consumer services

CANADA 1-800-667-8623

U.S.A. 1-877-689-2737

www.margaritavillecargo.com

©2011 Sunbeam Products, Inc., doing business as Jarden Consumer Solutions. All rights reserved.

Margaritaville® is a registered trademark of Margaritaville®.

Printed in China

P. N. 121506

GSC-IC1111