



Karaoke Speaker With Amplifier

GO-400

USER'S MANUAL



Before operating this device, please carefully read the user's manual, and retain for future reference.

Table of Contents

Warnings, Cautions and Others _ _ _ _ _	3
Front Panel Controls & Functions _ _ _ _ _	6
Rear Panel Controls & Functions _ _ _ _ _	7
Connections _ _ _ _ _	8
Specifications _ _ _ _ _	12
Troubleshooting _ _ _ _ _	12

Warnings, Cautions and Others

Mises en garde, précautions et indications diverses



The lightning flash with arrowhead symbol, within an equilateral triangle is intended to alert the user to the presence of uninsulated dangerous voltage within the product's enclosure that may be of sufficient magnitude to constitute a risk of electric shock to persons.



The exclamation point within an equilateral triangle is intended to alert the user to the presence of important operating and maintenance (servicing) instructions in the literature accompanying the appliance.

WARNING

To reduce the risk of fire or electrical shock, do not expose this appliance to rain or moisture.

For Canada/Pour le Canada

THIS DIGITAL APPARATUS DOES NOT EXCEED THE CLASS B LIMITS FOR RADIO NOISE EMISSIONS FORM DIGITAL APPARATUS AS SET OUT IN THE INTERFERENCE-CAUSING EQUIPMENT STANDARD ENTITLED DIGITAL APPARATUS, ICES-003 OF THE DEPARTMENT OF COMMUNICATIONS. CET APPAREIL NUMERIQUE RESPECTE LES LIMITES DE BRUITS RADIO ELECTRIQUES APPLICABLES AUX APPAREILS NUMERIQUES DE CLASSE B PRESCRITES DANS LA NORMESUR LE MATERIEL BROUILLEUR: APPAREILS NUMERIQUES , NMB-003 EDICTEE PAR LE MINISTRE DES COMMUNICATIONS.

Caution

Disconnect the mains plug to shut the power off completely. The POWER is not disconnected from the mains line when the POWER button on the front panel is pressed in.

SAFETY INSTRUCTIONS

1. Read Instructions

All the safety and operating instructions should be read before the product is operated.

2. Retain Instructions

The safety and operating instructions should be retained for future reference.

3. Heed Warnings

All warnings on the product and in the operating instructions should be adhered to.

4. Follow Instructions

All operating and use instructions should be followed.

5. Attachments

Do not use attachments not recommended by the product manufacturer as they may cause hazards.

6. Cleaning

Unplug this product from the wall outlet before cleaning. Do not use liquid cleaners or aerosol cleaners. Use a dry cloth for cleaning.

7. Ventilation

The appliance should be situated so its location does not interfere with its proper ventilation. For example, the appliance should not be situated on a bed, sofa, rug, or similar surface that may block the ventilation slots.

8. Heat

The appliance should be situated away from heat sources such as radiators, heat register, stoves, or other apparatus (including amplifiers) that produce heat.

9. Water and Moisture

Do not use this unit near water. For example, near a bathtub or in a wet basement and the like.

10. Power-cord Protection

Power-supply cords should be routed so that they are not likely to be walked on or pinched by items placed upon or against them, paying particular attention to cords at plugs, convenience receptacles, and point where they exit from the appliance.

11. Lightning

To protect your product from a lightning storm, or when it is left unattended and unused for long periods of time, unplug it from the wall outlet and disconnect the antenna or cable system. This will prevent damage to the product due to lightning and power-line surges.

12. Carts and Stands

The product should be used only with a cart or stand that is recommended by the manufacturer.



12 A. An appliance and cart combination should be moved with care. Quick stops, excessive force and uneven surfaces may cause the appliance and cart combination to overturn.

13. Power Sources

product should be operated only from the type of power source indicated on the marking label. If you are not sure of the type of power supply to your home, consult your product dealer or local power company.

SAFETY INSTRUCTIONS

14. Grounding and Polarization

This product is equipped with a polarized alternating-current line plug (a plug having one blade wider than the other). This plug will fit into the power outlet only one way. This is a safety feature. If you are unable to insert the plug fully into the outlet, try reversing the plug. If the plug should still fail to fit, contact your electrician to replace your obsolete outlet. Do not defeat the safety purpose of the polarized plug.

15. Power Lines

An outside antenna system should not be located in the vicinity of overhead power lines or other electric light or power circuits, or where it can fall into such power lines or circuits. When installing an outside antenna system, extreme care should be taken to keep from touching such power lines or circuits as contact with them might be fatal.

16. Overloading

Do not overload wall outlets, extension cords, or integral convenience receptacles as this can result in a risk of fire or electric shock.

17. Object and Liquid Entry

Never push objects of any kind into this product through openings as they may touch dangerous voltage points or short-out parts that could result in a fire or electric shock. Never spill liquid of any kind on the product.

18. Replacement Parts

When replacement parts are required, be sure the service technician has used replacement parts specified by the manufacturer or have the same characteristics as the original part. Unauthorized substitutions may result in fire, electric shock, or other hazards.

19. Safety Check

Upon completion of any service or repairs to this product, ask the service technician to perform safety checks to determine that the product is in proper operating condition.

20. Damage Requiring Service

Unplug this product from the wall outlet and refer servicing to qualified service personnel under the following conditions:

- A. When the power supply cord or plug is damaged.
- B. If liquid has been spilled, or objects have fallen into the product.
- C. If the product has been exposed to rain or water.
- D. If the product does not operate normally by following the operating instructions. Adjust only those controls that are covered by the operating instructions as an improper adjustment of other controls may result in damage and will often require extensive work by a qualified technician to restore the product to its normal operation.
- E. If the product has been dropped or damaged in any way.
- F. When the product exhibits a distinct change in performance-this indicates a need for service.

22. Servicing

Do not attempt to service it yourself as operating instructions, do not attempt to service it yourself as opening or removing covers may expose you to dangerous voltage or other hazards. Refer all servicing to qualified service personal.

Thank you for purchasing products from V2GO Technology!
V2GO Technology Inc., located in Los Angeles, CA, USA, is one of the world's most innovative manufacturers of quality audio and video electronic products. V2GO is proud of its strong R&D, quality control and production resources that have resulted in a line of products that are technologically advanced and are of superior quality and durability.

Providing quality products and services at a reasonable cost to the user is the basis of V2GO's corporate philosophy. The ability to convert intangible ideas into marketable products is V2GO's unchallenged advantage. V2GO - Making your life a little more fun.

Contact us:

Interested in becoming a retailer or distributor of V2GO products? Contact our sales department at sales@V2GOtech.com

For general information about V2GO products, contact us at customerservice@V2GOtech.com

For Technical Assistance, email us at techsupport@V2GOtech.com

Monday to Friday, 8:30am to 5:30pm PST.

Please visit our website at www.V2GOTECH.com to find additional information about V2GO products and services.



Front Panel Controls & Functions

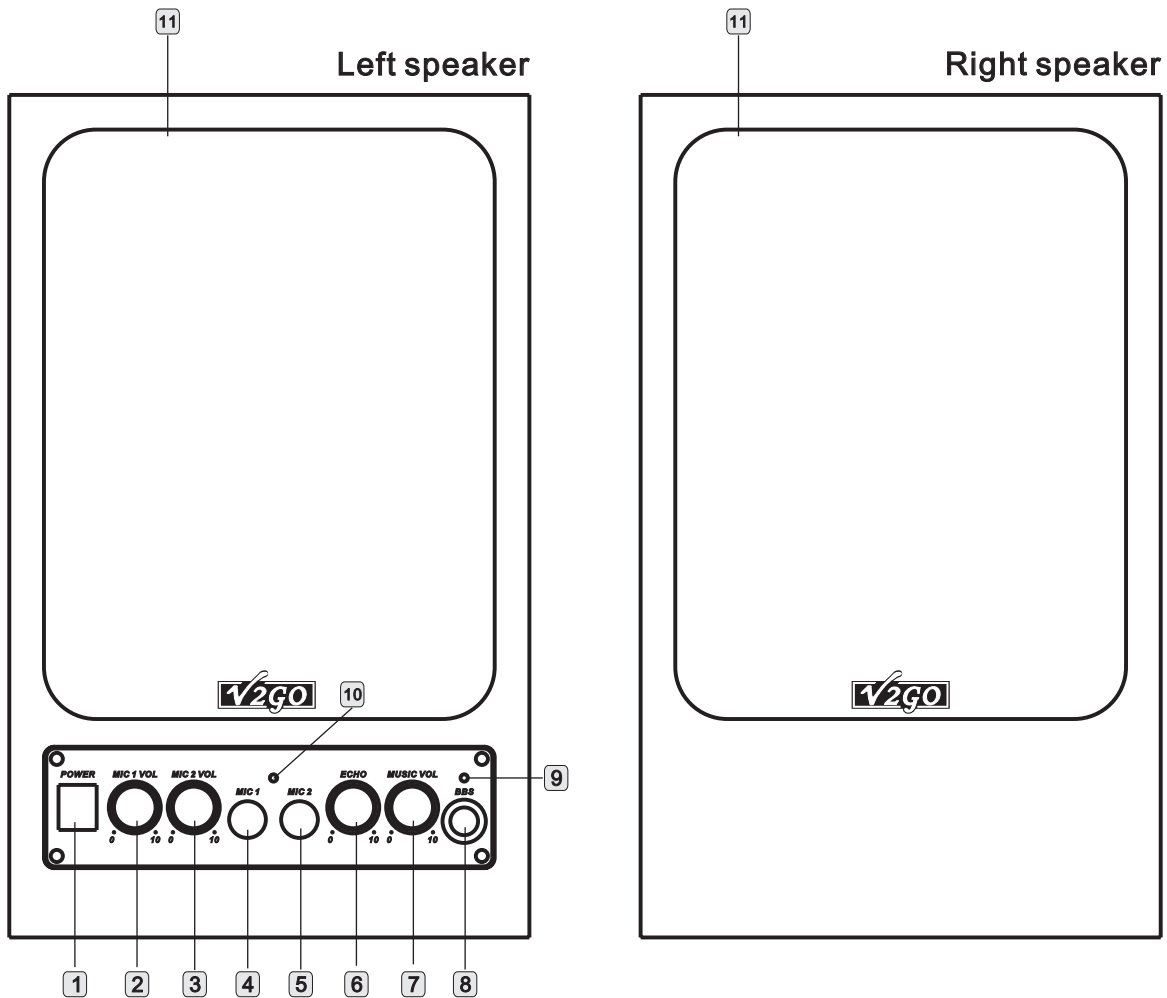

- 1 . POWER SWITCH:**
Turn on/off the speaker.
- 2 . MIC 1 VOLUME:** Control the volume of microphone 1.
- 3 . MIC 2 VOLUME:** Control the volume of microphone 2.
- 4 . MIC 1 INPUT JACK:** Connect microphone 1 (please refer to page 11).
- 5 . MIC 2 INPUT JACK:** Connect microphone 2 (please refer to page 11).
- 6 . ECHO CONTROL:** Control the echo level of the microphones.
- 7 . MUSIC VOLUME:** Control the music volume.
- 8 . BBS SWITCH:** Press this button to get the bbs effect (base enhancement).
- 9 . BBS INDICATOR:** BBS function on when light on.
- 10 . POWER INDICATOR:** Power on when light on.
- 11 . COVER:** Removable cover.

Rear Panel Controls & Functions

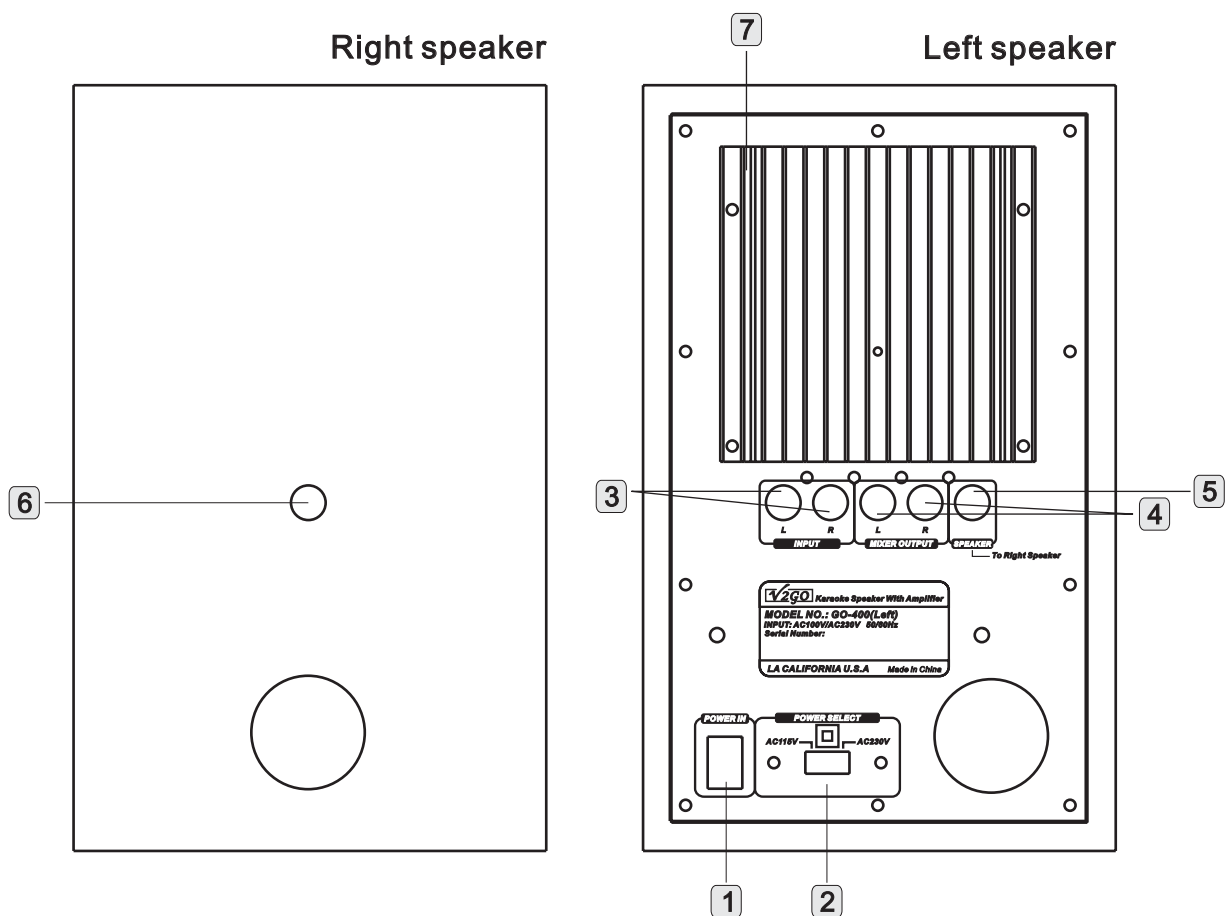

- 1 . **POWER IN PLUG:** AC in.
- 2 . **POWER SELECT:** Switch between AC 115V/230V power input. Be sure to match the voltage of power supply.
- 3 . **L/R INPUT JACKS:** For audio signal input.
- 4 . **L/R MIXER OUTPUT JACKS:** For audio signal output. Can be connected to the audio signal input jacks on a recordable equipment.
- 5 . **SPEAKER OUTPUT JACK:** Connect to Right speaker input jack.
- 6 . **SPEAKER INPUT JACK:** Connect to the left speaker output jack
- 7 . **THERMAL SINK:** Thermal sink helps cool the amplifier inside the speaker

Caution: The thermal heat-sink (#7, in figure above) on the back of the speaker becomes HOT after prolonged speaker use. Please do not touch.

Connections

Part 1 Power Connection

Plugging The Power Cord of The GO-400 Into The AC Outlet

★ **Note:** Before connecting power cord, please make sure the power voltage selector is correctly set for your local power voltage.

! **Warning:** After use, please turn off the GO-400. During periods of prolonged non-operation, it is recommended that you disconnect the power cord.

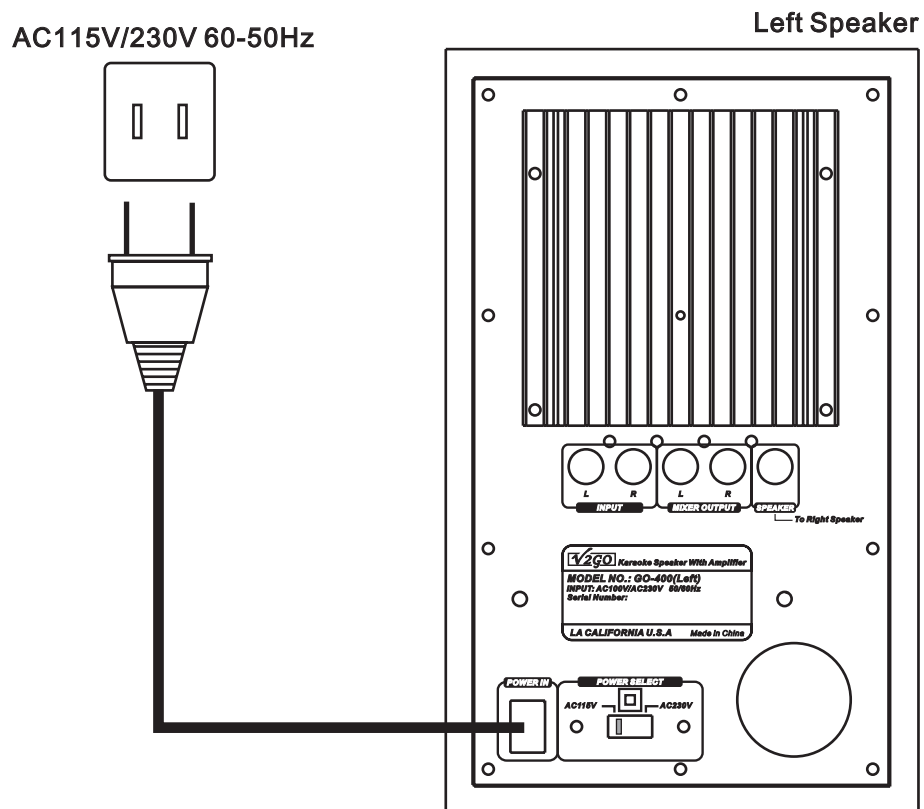

Connections

Part 2: Audio Input Connection

How to input the Audio

1. Connecting to a DVD player.

1.1. Connecting to a DVD player.

Plug one plug end of the cable into the GO-400 input jack and the other end to the DVD audio-out jack

1.2. Connecting the two speakers.

Connect one plug end of the RCA cable to the left speaker's speaker jack and connect the other end to the right speaker's RCA jack.

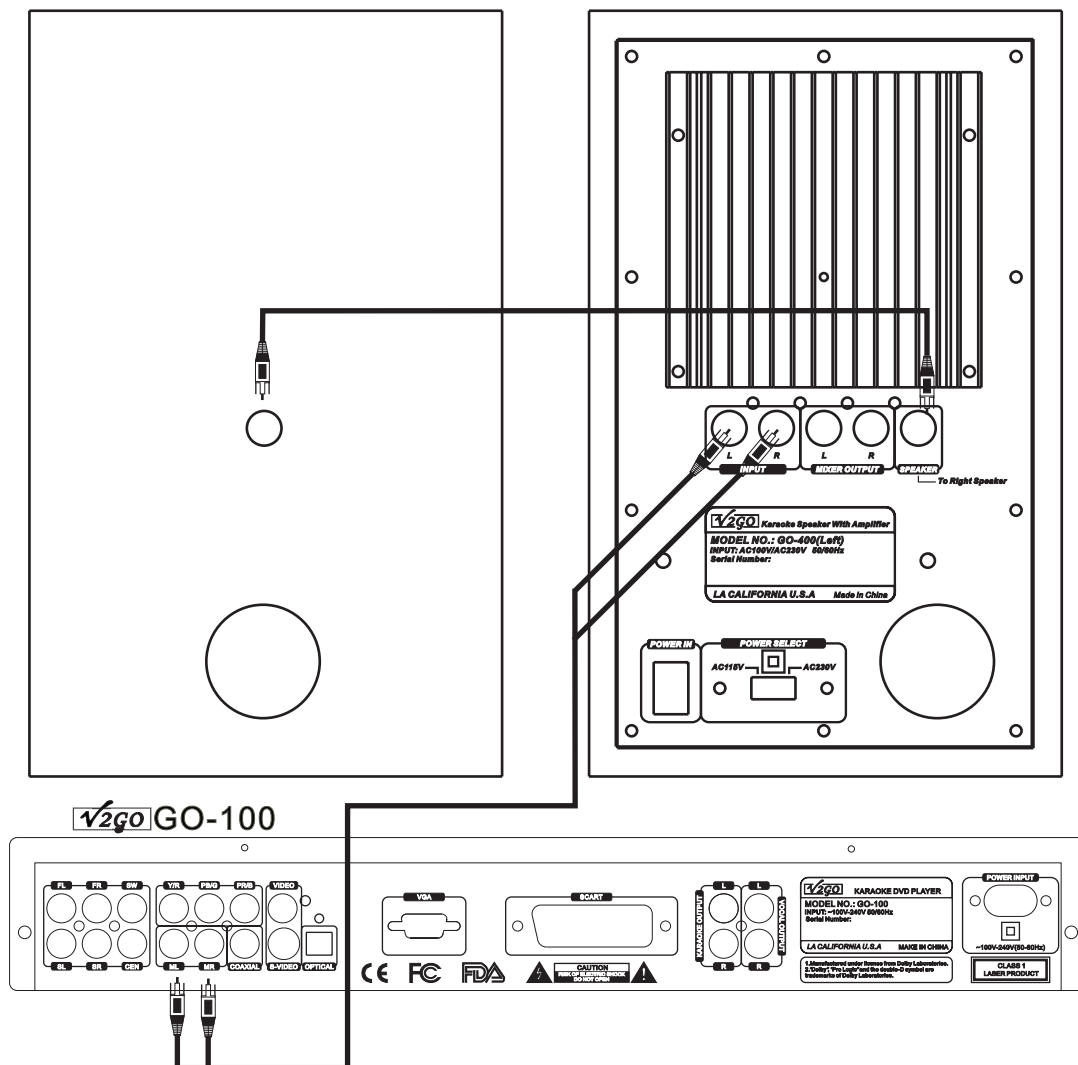

Connections

Part 2: Audio Input Connection

2. Connecting to a PC.

1.1. Connecting to a PC:

Connect the 1/8" plug of cable to the pc audio out jack and connect the RCA plugs on the other end of cable to the input jacks at the back of the left speaker according to the color code.

1.2. Connecting the two speakers.

Connect one end of the RCA cable to the left speaker's speaker jack and connect the other end to the right speaker's RCA jack.

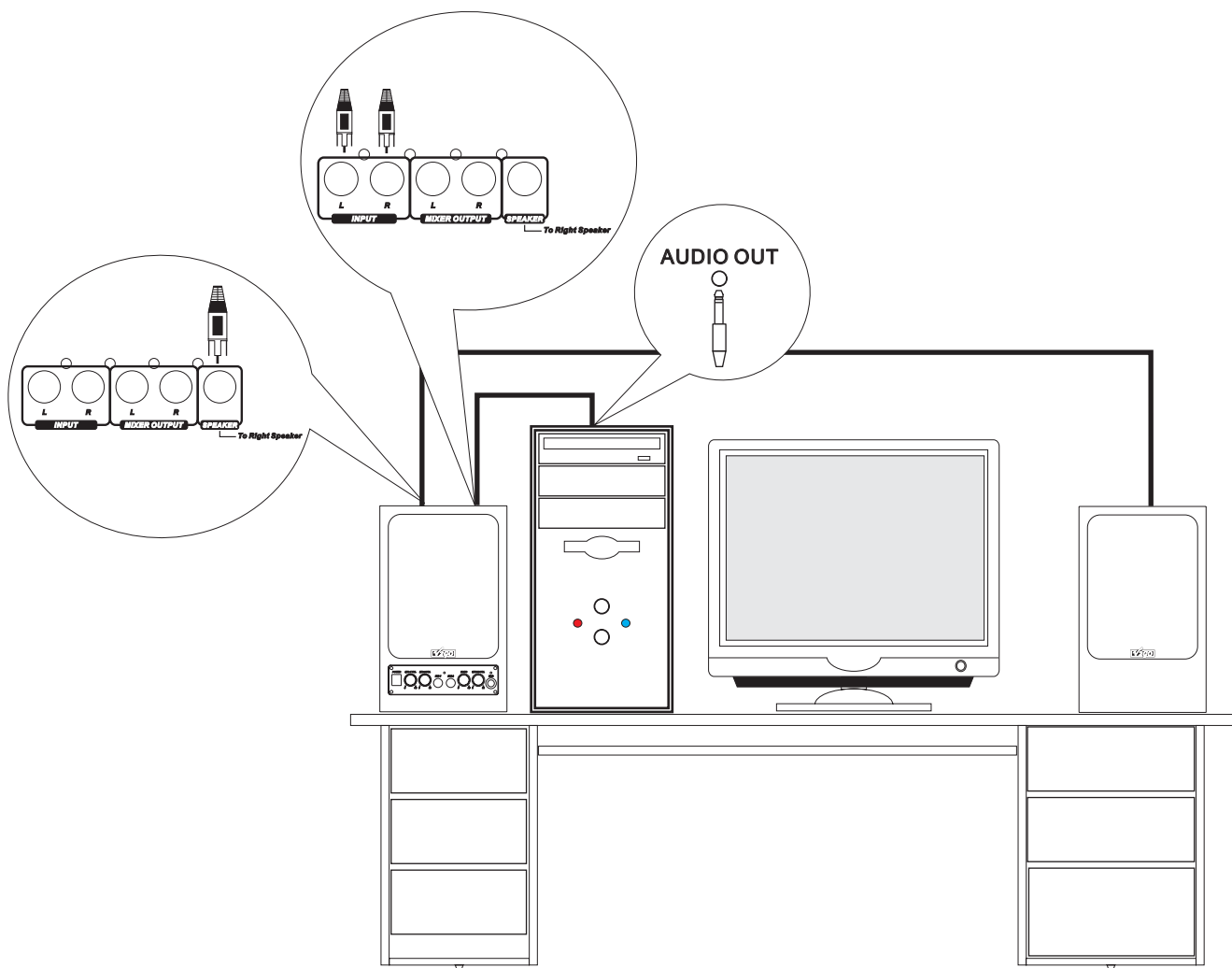

Connections

Part 3: Karaoke Connection

3. Karaoke Connection:

Follow this diagram to easily connect your GO-400 speakers to a karaoke system. Once connected, you'll be able to enjoy many hours of karaoke fun.

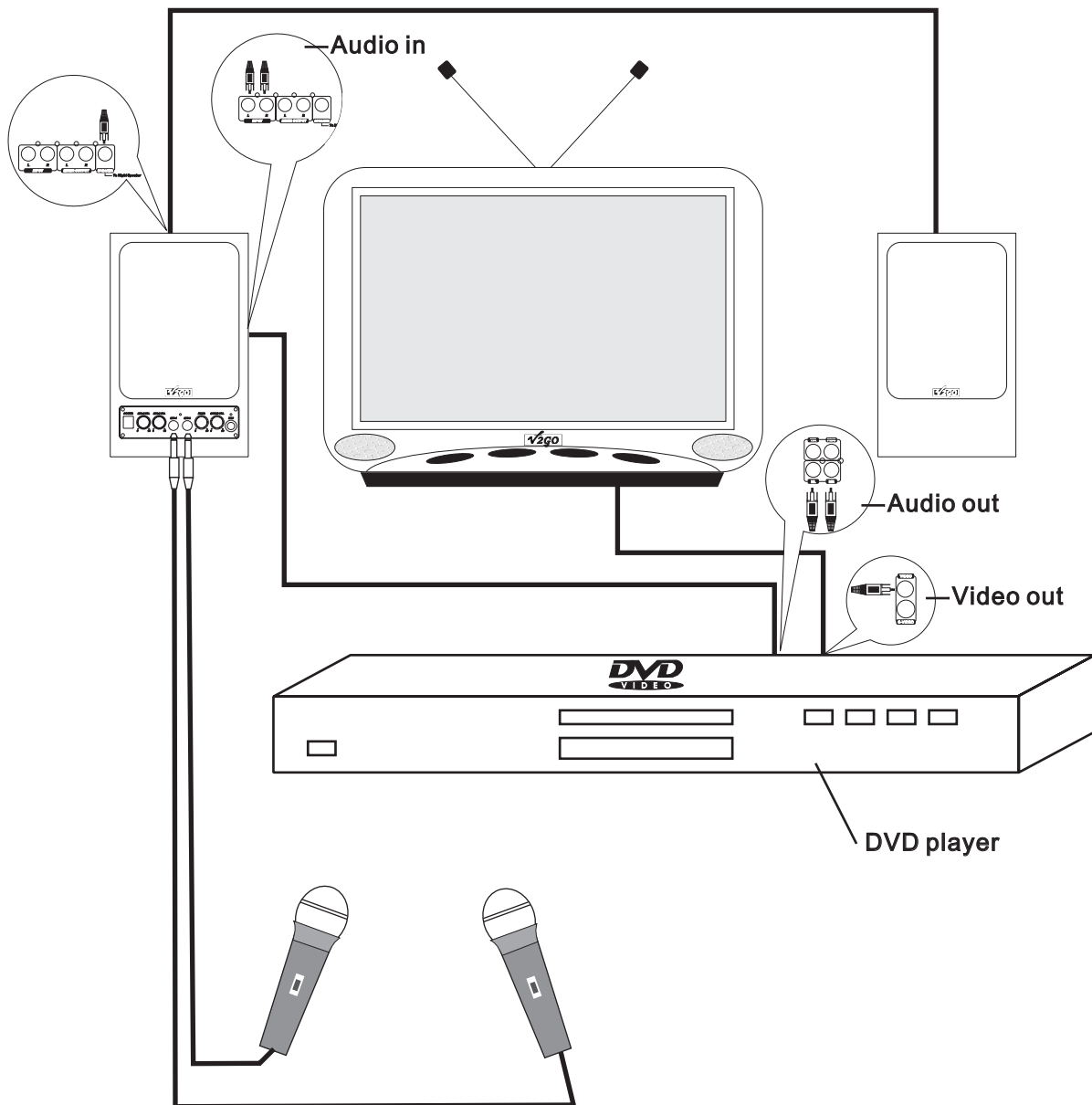

Specifications

Model No.	GO-400
Power requirements	AC115V/230V 50-60Hz
Power consumption	60W/pair
Audio out	15W+15W RMS 1K/6Ω
Karaoke input sensitivity	<20mV
Dimensions	Left speaker:150 2 20 2 43 (5.9"x8.6"x9.6") Right speaker:150 1 80 2 43 (5.9"x7.1"x9.6")
Weight	Left speaker: 3.6KG (8lbs) Right speaker: 2.3KG(5.1lbs)

Troubleshooting

Symptom	Possible Reasons	Solution
No Power	Power cord is not secure, or outlet is not functional	Secure the power cord, check functionality of outlet
No Sound	Check the volume control	Turn up the volume

V2GO Technology Corp.

9528 Rush St#1
South El Monte CA, 91733

Tel: 626-582-8098

Fax: 626-582-8908

Toll free: 1-877-566-V2GO(566-8246)

www.v2gotech.com

