

# Avantree Saturn User Manual

## Bluetooth Audio Transmitter & Receiver 2-in-1

### 1. Product Description

Avantree Saturn is a 2-in-1 Bluetooth receiver and transmitter which incorporates the latest aptX codec for less latency, high audio quality. The Saturn is very simple to use, and can make any audio device Bluetooth enabled. It can be used to enable a phone to transmit music to a home stereo system or just as easily, to allow a CD player or other device to transmit to a Bluetooth speaker system or headphone device. With its compact design and its ability to recharge, this item can be used again and again, whenever or wherever you want to use it.

### 2. Product Overview

- A. Avantree Saturn
- B. 3.5mm to 3.5mm audio cable
- C. RCA audio cable
- D. 3.5mm to RCA audio cable
- E. USB charging cable
- F. Warranty card
- G. User manual
- H. Quick user guide

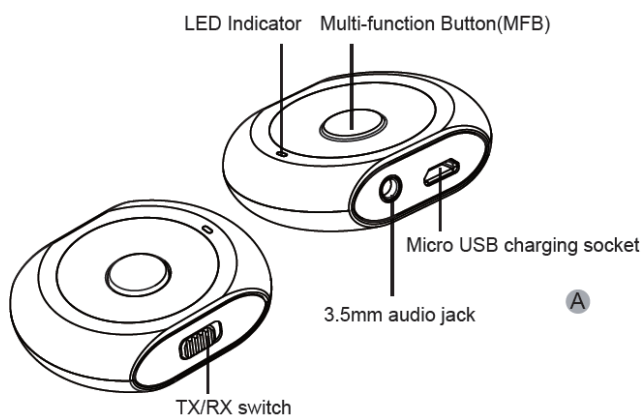

### 3. How to use Saturn as a Transmitter?

Before pairing, please make sure your Bluetooth receiver device supports true stereo audio. (Such as Bluetooth stereo headset Avantree Sacool, Bluetooth speaker Avantree Pluto Air.)

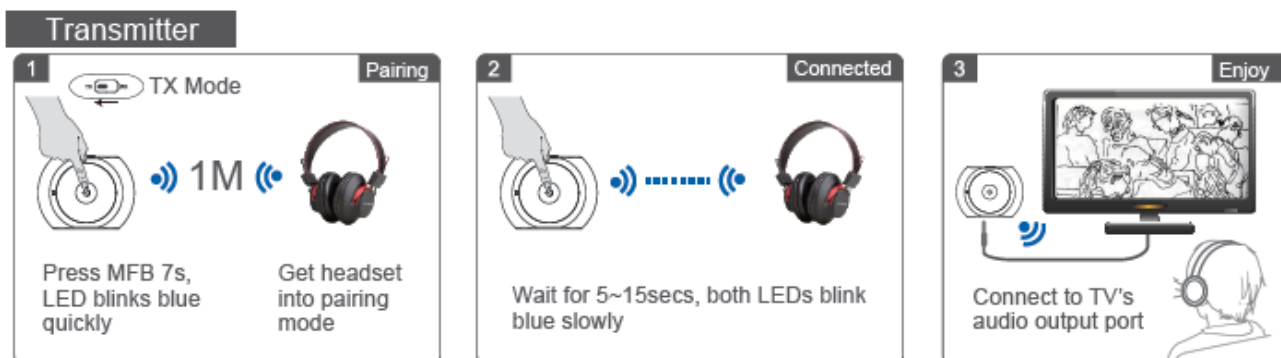

- A. Ensure Saturn is off, then push the switch button to TX mode.
- B. Get Saturn into pairing mode by pressing and holding MFB for around 6-8 seconds until LED flashes blue rapidly.
- C. Get your Bluetooth stereo receiver device into pairing mode at the same time.
- D. Connect Saturn to the audio output port of the audio source such as your TV, iPod etc. via the audio cable.

E. Keep them within 1 meter, wait until both LEDs slows down, which means they are connected.

**NOTE:**

- 1) The pairing mode will last 2 minutes. Saturn will enter standby mode if no devices can be connected with 2 minutes.
- 2) Saturn can pair with stereo Bluetooth receiver devices with PIN code "0000", "1111", "8888" or "1234".
- 3) Please do not change TX or RX mode after powering on Saturn. When you need to pair another device, please turn off the device firstly, then choose the mode you need.

**4. How to use Saturn as a Receiver?**

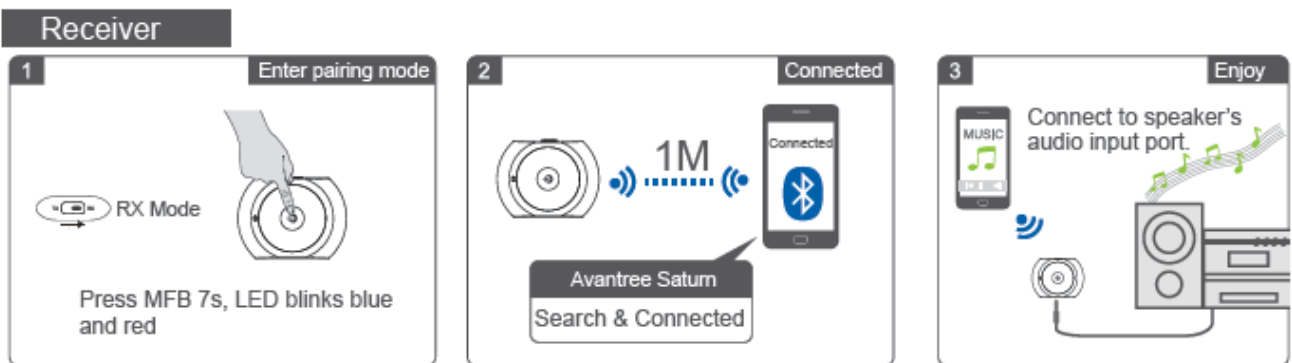

- A. Ensure Saturn is off, then push the switch button to RX mode.
- B. Get Saturn into pairing mode by pressing and holding the MFB button for around 6–8 seconds till Blue and Red LED light blinks quickly and alternatively.
- C. Turn on Bluetooth of your smart-phone, search for "Avantree Saturn", click on your phone to connect. (E.g. iPhone: tap "Settings" → "General" → "Bluetooth" → "On" )
- D. Connect Saturn to the audio input port of home hi-fi stereo system via the audio cable.

**NOTE:**

- 1) The pairing mode will last 2 minutes. The receiver will enter standby mode if no devices can be connected within 2 minutes.
- 2) If pairing failed, please power off Saturn and pair again according to above mentioned procedures.
- 3) Please do not change TX or RX mode after powering on Saturn. When you need to pair another device, please turn off the device first, then choose the mode you need.
- 4) When Saturn is used as a receiver, you may short press MFB once to control pause/play of music.

**5. Power On/Off**

Please ensure Saturn is off, then push the switch button to the mode(TX or RX) which you need.

**Turn On:** Press and hold the MFB button for about 3 seconds until the blue LED is on for 1 second

**Turn Off:** press and hold the MFB button for about 3 seconds until the red LED is on for 1 second, and then go off.

## 6. Reconnection

Once being powered on, Saturn will reconnect with the last connected device automatically within 5 seconds. If not, you may press MFB once to stimulate the process.

### NOTE:

Saturn will automatically power off if no devices can be connected within 5 minutes.

## 7. Get Maximum Stable Range.

Please kindly make sure there is no obstacle (wall corner etc.) between receiver and transmitter; also make the 2 devices at the same side.

### How to get the maximum range

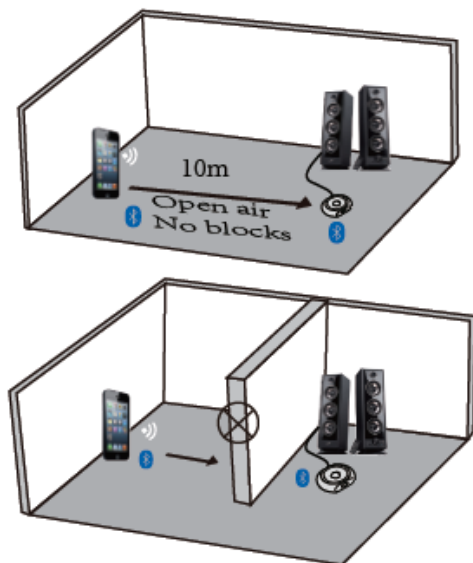

### Best Result

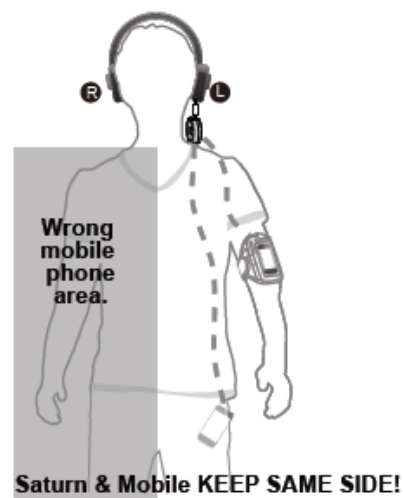

## 8. Charging

When the LED blinks red, you should recharge the device. It normally takes about 3 hours to fully charge the battery. The LED will stay red when charging and will turn off when charging is complete.

### Charging requirement:

You can connect Saturn via the supplied Micro USB cable to your own USB chargers (wall charger/travel charger/car charger, etc.) with 5V/500mA-1A or PC USB port. It's ok to use most mobile phone chargers on the market.

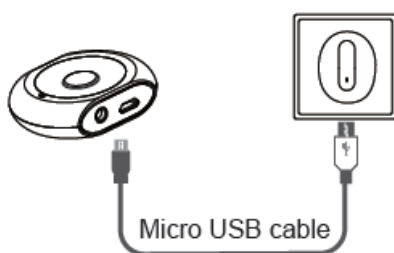

Charge from a wall charger

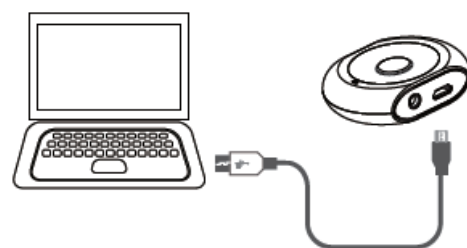

Charge from PC

### NOTE:

- 1) It can be used while charging.
- 2) The USB outputs of some TVs or laptops are unstable. When used while charging, we suggest you connect to a wall charger instead of a USB port.
- 3) If you have not used the device for a few months, LED might not turn red when first charging. It might take 15-35 minutes before the LED turns red.
- 4) We suggest to fully charge the device at least every two months.

## 9. Using 2 Saturns as a Pair

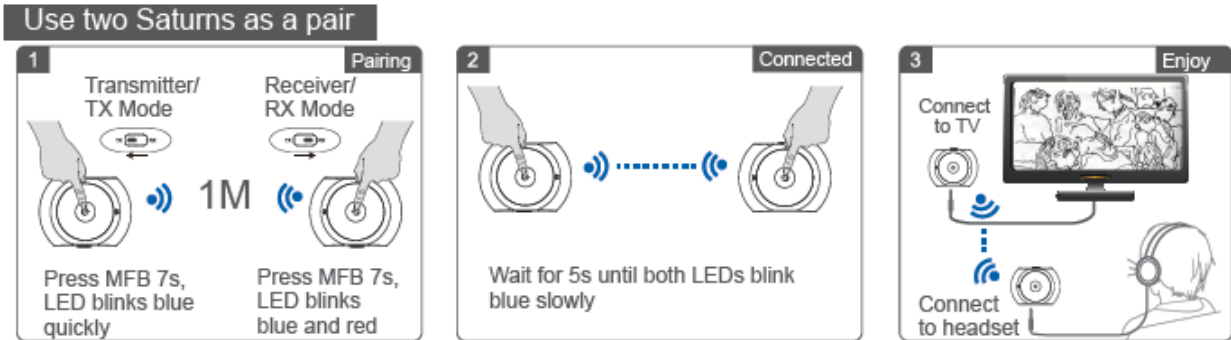

- A. Push one Saturn into TX mode, press and hold MFB button until LED flashes blue rapidly;
- B. Push another Saturn into RX mode, press and hold MFB button until LED flashes red and blue alternatively.
- C. Keep them within 1 meter and wait for around 7 seconds, until the LED begins to flash slowly, which means they are now paired and connected.
- D. Connect the TX one to sound source such as TV, MP3, games, etc. and the other to the receiving item, such as a speaker or headphones.

## 10. Restore Factory Default Settings

You may need to reset Saturn if it is not working as expected. When Saturn is reset to factory default settings, all the paired mobile phone information will be erased.

Ensure Saturn is off, press and hold MFB button for around 10–12 seconds until RED and BLUE LEDs are both on for 1 second. Saturn now has been reset to its original settings. After being powered on again, it will enter pairing mode directly.

## 11. LED Indicator

LED indicator	Status of Saturn
Blue LED flashes rapidly	Pairing mode under TX mode, last for 2 minutes
Blue and red LED blinks alternatively	Pairing mode under RX mode, last for 2 minutes
Blue LED flashes once every 1 second	Standby mode and not connected with a device
Blue LED flashes twice every 5 seconds	Device connected with aptX
Blue LED flashes once every 5 seconds	Device connected with SBC
Red LED blinks	Low power

## 12. Product Specification

- *Bluetooth* V2.1+EDR
- Bluetooth profile supported:A2DP and AVRCP
- Supported codec: aptX, SBC
- Operation Range: Class 2, 10 meters
- TX mode working time: 10 hours
- RX mode working time: 9 hours
- Standby time: up to 400 hours
- Charging time: about 2-3 hours
- Charging input voltage: DC 5V
- Battery: 270mAH rechargeable LI-polymer battery
- Weight: 48.5g
- Size: 50mm(L)x37mm(W)x13mm(H)

**NOTE:**The working and standby times may vary when used with different mobile phones or other compatible Bluetooth devices, usage settings, usage styles and environments.

Dispose of the packaging and this product in accordance with the latest provisions.



FCC ID: WJ5-BTRC201

QDID : B015006

Z-PKMN-TC200X-00V2