

Pulsarlube V Grease Selection Guidelines

Grease Code	Application	Thickener	Base Oil	Description
PL1	Multi Purpose	Lithium Complex	Mineral	High performance NLGI #2 grease
PL2	Heavy Duty	Lithium & Lithium Complex	Mineral	Excellent heavy duty NLGI #2 grease with high viscosity base fluids and additional load carrying capacity
PL3	High Speed	Lithium	Mineral	High performance NLGI #1 grease for high speed applications (over 3,000 rpm or high ON value)
PL4	H1 Food Grade	Aluminum Complex	Mineral	NSF H1 registered NLGI #2 grease for applications where a food grade product is required
PL5	High Temperature	Lithium Complex	Fully Synthetic	High performance NLGI #2 grease with good oxidation stability for high temperature application
PL6	Multi Purpose with MoS ₂	Lithium Complex	Mineral	High performance grease with MoS ₂ for better EP and load carrying capacity
PL7	Low Temperature	Lithium & Lithium Complex	Fully Synthetic	Excellent NLGI #1 grease for extreme low temperature applications

How to Dispose



1. Turn the Pulsarlube V unit off at the end of the dispensing period by pressing the top mode button inside the yellow cap.
2. Dispose of the empty lubricator in a designated area. Comply with local regulation for waste disposal.
3. To avoid any potential injury or hazards, do not tamper with the product.

Shelf Life and Product Warranty

The shelf life of each Pulsarlube V unit is 2 years from the date of production. Product warranty is limited to original defects in material and workmanship and will not cover any collateral damage due to mishandling, abuse and/or any other inappropriate use of this product. Warranty period is 1 year from the date of purchase.

How to Order

KLT500 / PL1
KLT1000 / PL2

Grease Type
Pulsarlube Model# (KLT500: 125cc, KLT1000: 250cc)

Pulsarlube USA, Inc.

4312 Di Paolo Center, Glenview, IL 60025, USA
TEL: 1-847-795-0591 FAX: 1-847-795-0119

www.pulsarlube.com / info@pulsarlube.com

PULSARLUBE V

USER MANUAL

Microprocessor Controlled Single Point Lubricator

Specifications



Specifications	Description
Grease Capacity	125cc / 250cc
Operating Pressure	5kgf/cm ² (70psi)
Operating Temperature	-20°C ~ 55°C (-4°F ~ 131°F)
Product Size	125cc: Ø97mm (3.81") × 134mm (5.27") 250cc: Ø97mm (3.81") × 152mm (5.98")
Weight	125cc: 455g (1.00lb), 250cc: 650g (1.43lb)
Installation Thread Size	3/8" BSPT (NPT Converter Available)
Gas Type	Nitrogen (N ₂) Gas
Available Dispensing Periods	1, 2, 3, 6, 12 months & Purge (P)
Certifications / IP code	Ex ia IIC T4 / IP54
Remote Installation	Up to 1m (3ft) using an 8mm (5/16") O.D. pre-filled lube line

NOTE Technical information is subject to change without prior notice.

Models

PULSARLUBE V125/250cc Grease Lubricator

ISO9001/14001 CE

Before Use

Thank you for purchasing the Pulsarlube V, the microprocessor controlled automatic grease lubricator from Pulsarlube USA, Inc. The Pulsarlube V operates on the principle of inert Nitrogen (N₂) gas generation through the use of an electrolyte and electrical energy. To ensure the safe operation and proper installation of the Pulsarlube V unit, we strongly recommend that you read the following information carefully before use. If you require further information, please contact your local supplier or manufacturer.

Product Details

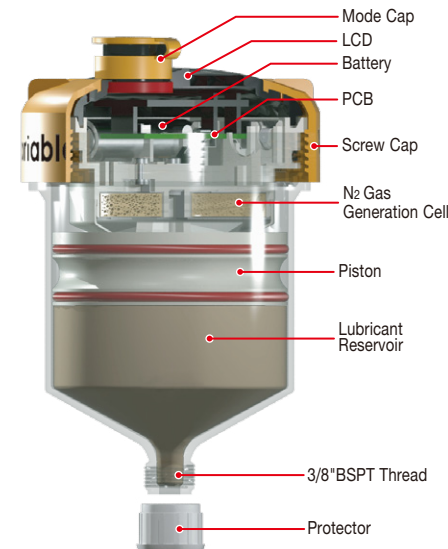

EC Declaration of Conformity

According to ATEX - Directive 94/9/EC

	Description	
Manufacturer	KLT Co., Ltd. 597-2, Geumseung-ri, Tanhyeon-myeon, Paju-Si, Gyeonggi-Do, South Korea	
Product Description	Automatic Single Point Lubricator	
Product Name	Pulsarlube V	
Type	KLT500, KLT1000	
IECEX	Ex ia IIC T4 IECEX KTL 10.0004X -20°C ≤ Ta ≤ +55°C	IEC 60079-0:2007 IEC 60079-11:2006
ATEX	CE 0344 II1G Ex ia IIC T4 KEMA 10ATEX0150 X -20°C ≤ Ta ≤ +55°C	EN 60079-0:2009 EN 60079-11:2007 EN 60079-26:2007
KCs	Ex ia IIC T4 10-KB2BO-0226X -20°C ≤ Ta ≤ +55°C	

Installation Instructions

1



Before installing the Pulsarlube V, remove contaminants around the lube point and ensure a clear passage by purging the lube point with a manual grease gun. If the lube passage is restricted, it may affect the performance of the lubricator. Please use the same or compatible grease as the grease contained in the Pulsarlube V.

⚠ WARNING
The Pulsarlube V is designed as a single point lubricator **ONLY**.
Do not use the Pulsarlube V unit for multi point lubrication.

2



Remove the grease nipple and check for hardened grease at the bearing lube point. If hardened grease exists, clean the lube point before mounting the Pulsarlube V unit on the bearing.

NOTE Refer to the preferred mounting methods and examples on next page.

3



Set dispensing mode

- Open the yellow cap on the top of the Pulsarlube V unit.
- Select the dispensing mode by pressing the mode button inside the yellow cap.
- Each single press of the button advances to the next setting as follows:

1 MONTH
1 Month

2 MONTH
2 Month

3 MONTH
3 Month

6 MONTH
6 Month

12 MONTH
12 Month

P OPER
Purge

OFF

- If the LCD shows one of the above six operating modes, the unit has begun operating.

⚠ WARNING
Do not use the purge function for an extended period of time as the purge mode dispenses a large quantity of grease in a short period of time. After the purge function is used, the mode should be returned to normal operation.

4



Note the installation date and scheduled date of expired lube cycle on the label of the Pulsarlube V for your records.

NOTE LOT Number
Each Pulsarlube V unit has a lot number. Record the number of each unit for maintenance purposes.

5

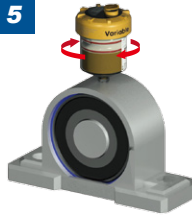

- Close the yellow cap and remove the protector from the output thread.
- Install the Pulsarlube V unit on the lube point.
- Use the waterproof cover over the unit when the Pulsarlube V unit is installed outdoors or in a humid environment.

NOTE The Pulsarlube V has a plastic 3/8" BSPT output thread. Use appropriate adapters if necessary and make sure that adapters are firmly tightened. Do not excessively tighten the Pulsarlube V as it may result in permanent damage to the plastic thread.

Installation Parts



Mounting Bracket Assembly



Extension Tube

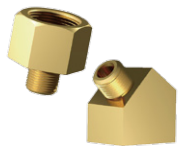

Straight & 45° Reducer



Push-in One-touch Fitting



Empty & Pre-filled Nylon Tubing

Mounting Methods

Direct Mount - Straight & Angle

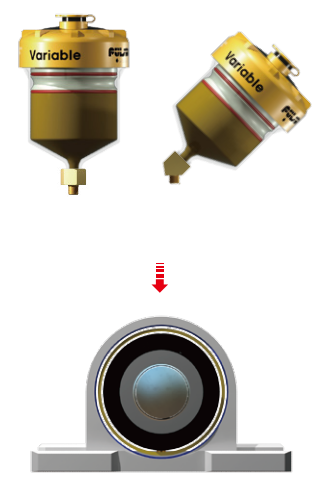

The most common and preferable mounting method is a **Direct Straight Mount**.

Use a 45° or 90° fitting for **Direct Angle Mount** when there are space restrictions.

Direct Mount with Extension - Straight & Angle

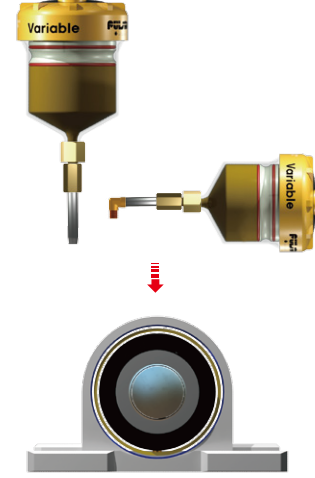

For applications where a straight or a direct angle mount is not available, use a straight, 45°, or 90° fitting with an extension pipe.

When using extension pipes in combination with angle fittings, keep the total length of the mount as short as possible.

Remote Mount (up to 1m(3ft))

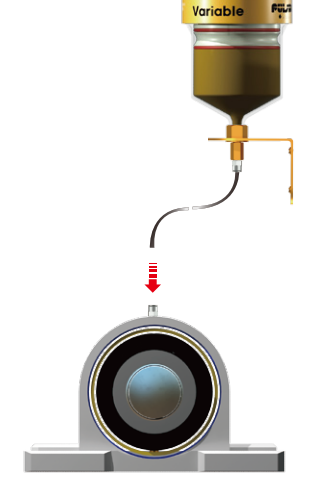

For applications not allowing any direct mounts or extension mounts, remotely mount the unit using an 8mm O.D. (5/16") pre-filled lube line.

⚠ WARNING
Keep the total length of the mount at 1m (3ft) or less.

NOTE For remote installation, make sure lube lines are pre-filled with the same or compatible grease as the grease contained in the unit before installation of the lubricator.

Dispensing Recommendation

In the chart below are general guidelines for bearing lubrication requirements. Requirements may vary with individual bearing types and operating conditions. Testing is recommended for specific applications. Please contact your distributor should you need any assistance in setting proper dispensing rates.

Ball & Roller Bearings

Bearing Shaft Diameter	125cc	Grease Volume	250cc	Grease Volume
121mm(4.75") ~ 305mm(12")			Multiple Units Required*	16.5cc/day
105mm(4.12") ~ 120mm(4.75")			1 Month	8.3cc/day
89mm(3.50") ~ 104mm(4.12")	1 Month	4.2cc/day	2 Month	4.2cc/day
80mm(3.12") ~ 88mm(3.50")	2 Month	2.1cc/day	3 Month	2.8cc/day
64mm(2.50") ~ 79mm(3.12")	3 Month	1.4cc/day	6 Month	1.4cc/day
51mm(2.00") ~ 63mm(2.50")	6 Month	0.7cc/day	12 Month	0.7cc/day
25mm(1.00") ~ 50mm(2.00")	12 Month	0.3cc/day		

* A bearing shaft diameter greater than 120mm (4.75") needs two Pulsarlube V units with the use of a non-return valve. If a bearing has more than two grease nipples, install one Pulsarlube V unit for each grease nipple.