

Operating Instructions



P6X

Table of Contents

1.	General Product Information	4
1.1	Product Description	4
1.2	Article	4
1.3	Scope of Delivery	4
1.4	Range of Use	4
1.5	Product Properties	4
2.	Important Notes on Safe Use	5
2.1	Information Regarding Flashlight Identification	5
2.2	Information Regarding Operating Instructions Identification	5
2.3	Warranty	5
2.4	Completeness	5
2.5	Damages	5
2.6	Purpose of the System	5
2.6.1	Standards and Regulations	5
2.6.2	Intended Use	6
2.6.3	Target Group	6
2.7	Disposal	6
3.	Safety Notes	7
3.1	Safety Notes Structure	7
3.1.1	Risk of Injuries Markings	7
3.1.2	Damage to Property Markings	7
3.1.3	Marking of Additional Information	7
3.2	Additional Pictograms Regarding Safety Notes	7
3.3	Pictograms on the Flashlight	7
3.4	Pictograms on the Packing	7
3.5	Overview of the Key Safety Notes	7
4.	Overview of Terms and Abbreviations	11
5.	Operation	12
5.1	Inserting Batteries (only the boxed version)	12
5.2	Switching the Flashlight On or Off	12
5.3	Quickly Focusing the Flashlight	12
5.4	Using the Lighting Functions	13
5.5	Activating Lighting Programs	13
5.6	Replacing the Batteries/Battery Pack	14
5.7	Attaching the Wrist Strap	15
5.8	Attaching the Belt Bag	15
5.9	Putting the Flashlight into the Belt Bag	15
5.10	Automated Functions	15
5.10.1	Temperature Monitoring	15
5.10.2	Battery State Warning	15
5.11	Cleaning	15
5.12	Tests	16
5.13	Warranty	16
6.	Technical Data	17

Thank you

We are delighted that you have decided in favour of one of our products. products. In these Operating Instructions you will find notes regarding safety and operation to help you to familiarize yourself with your new product.

Carefully read these Operating Instructions prior to using this product. They should be kept and handed over to third parties when passing on the product to third parties.

This also helps to ensure that you obtain maximum benefit from the product, get your questions answered and avoid incorrect operation. Above all, observe the warning and safety instructions and dispose of the flashlight, batteries/battery packs packaging materials properly.

1. General Product Information

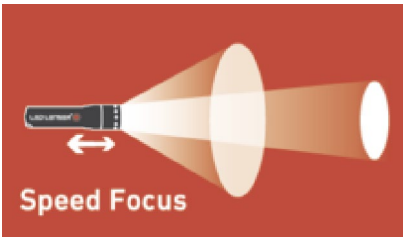
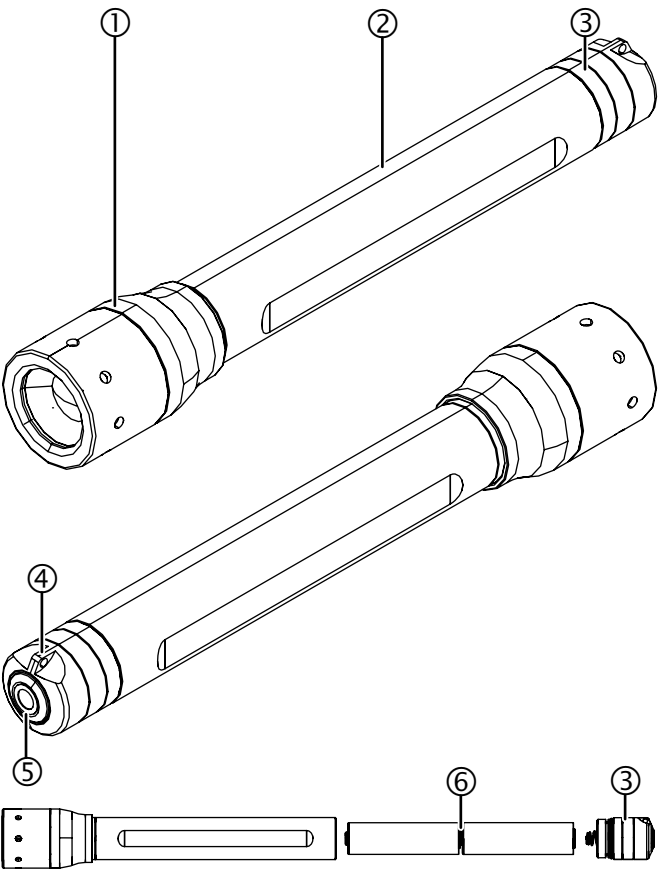

1.1 Product Description

- ① Lamp head can be focused
- ② Battery compartment
- ③ End cap that may be unscrewed
- ④ Fixture for wrist strap
- ⑤ On/Off push button
- ⑥ 2 x AA alkaline batteries

1.2 Article

Designation	Article no
P6X box	9406-X
P6X blister pack	9606-X

1.3 Scope of Delivery

- P6X flashlight,
- box or blister (packaging)
- General safety precautions and warnings,
- P6X quick initial start guide,
- 1 or 2 battery sets with 2 x AA 1.5 V batteries,
- Belt bag,
- Wrist strap.

1.4 Range of Use

Suitable for outdoor use. Protected against spray water from all sides (IPX4).

1.5 Product Properties

- Slim, elegant design,
- Powerful (up to 400 lm) with just 2 x AA batteries,
 - Smart Light Technology (SLT) with
 - 3 different lighting functions (High Power / Power / Low Power),
 - 2 lighting programs,
 - The Advanced Focus System (unlimited transition from homogeneous, circular local light to a sharp, concentrated long-range beam),
 - Speed Focus (single-handed operation of sliding mechanism),
 - Electronic regulation with temperature sensor (overheating protection),
 - Up to 60 hours of glare-free light.

2. Important Notes on Safe Use

Identification	2.1 Information Regarding Flashlight Identification <p>These Operating Instructions are designed exclusively for the flashlights and accessories identified using the following specifications:</p> <p>– Type designation: P6X</p>
	2.2 Information Regarding Operating Instructions Identification <p>All pages are marked as a indication of the currency of the Operating Instructions using the type designation containing the 2-digit version number, release status and country designation(s):</p> <p>– Edition: P6X_V.01 – Status at: 7/31/2014</p> <p>This marking is binding for the validity of the Operating Instructions and should not be removed regardless of the type of publication (printed, data format or in excerpts).</p>
Warranty	2.3 Warranty <p>LED LENSER ensures the safety and proper functioning of the flashlight only under the condition that:</p> <ul style="list-style-type: none">• The flashlight is only used according to the intended purpose and operated and maintained in accordance with the information contained in these Operating Instructions,• Only original spare parts or accessories approved by LED LENSER are used,• The flashlight is not modified in any way. 2.4 Completeness <p>Check the flashlight for completeness and any damage before installation.</p> <ul style="list-style-type: none">• Unpack all components for checking and perform a visual inspection.• The components can be identified using these Operating Instructions. 2.5 Damages <p>Please contact the vendor / distributor in the event of damage or missing items.</p> 2.6 Purpose of the System 2.6.1 Standards and Regulations <p>Flashlight, accessories and Operating Instructions comply with the requirements of following standards and regulations:</p> <ul style="list-style-type: none">• General Product Safety Directive 2001/95/EG / Product Safety Act (GPSG),• Directive 2014/30/EU of the European Parliament and the Council on the Harmonization of the Laws of the Member States on electromagnetic compatibility,• Regulation (EC) No 1907/2006 of the European Parliament and the Council on the Registration, Evaluation, Authorization and Restriction of Chemicals (REACH),

2. Important Notes on Safe Use

- DIN EN 62471:2009 Photobiological safety,
- Directive 2011/65/EU "Restriction of the use of certain hazardous substances (RoHS) in electric and electronic devices" of the European Parliament and the Council,
- IEC 82079-1:2012 - Preparation of instructions for use – Structuring, content and presentation - Part 1: General principles and detailed requirements.

2.6.2 Intended Use

The P6X is a powerful flashlight with a light cone that may be focused. It is designed for use in the dark.

- The flashlight is suitable for continuous operation.
- The flashlight is suitable for outdoor use.
- Any use beyond the above-mentioned conditions is considered to be improper use. The user is liable for any damage resulting from such use.

2.6.3 Target Group

The flashlight is suitable for persons above 14 years of age without any limitations.

Persons with physical or technical limitations and children between 6 and 13 years may only use the flashlight under the supervision of a parent or guardian.

2.7 Disposal



- The flashlight must be disposed of at a suitable place of disposal for recycling electric and electronic equipment according to the country-specific regulations.
- Submit used batteries/battery packs to a local battery collection point or anywhere where batteries/battery packs are sold in accordance with country-specific regulations.

3. Safety Notes

 **DANGER**

 **WARNING**

 **CAUTION**

ATTENTION

NOTE



3.1 Safety Notes Structure

Important notes are marked with pictograms and signal words in these Operating Instructions.

3.1.1 Risk of Injuries Markings

Signal words, such as DANGER, WARNING or CAUTION designate the grading of a potential risk of injuries. The different triangle symbols emphasize the level of risk optically.

DANGER indicates an immediately dangerous situation that, if not avoided, may lead to death or serious injury.

WARNING indicates a potentially dangerous situation that, if not avoided, may lead to death or serious injury.

CAUTION indicates a potentially dangerous situation that, if not avoided, may lead to slight or minor injury.

3.1.2 Damage to Property Markings

ATTENTION indicates a potentially dangerous situation that, if not avoided, may lead to property damage.

3.1.3 Marking of Additional Information

NOTE gives you added information and helpful tips on safe and efficient use of the flashlight.

3.2 Additional Pictograms Regarding Safety Notes

Risk of explosion: warns of explosion of the batteries caused by strong heating.

Risk of glare: warns of glare caused by light beam with high brightness.

Follow the Operating Instructions: refers to compliance with these Operating Instructions.

3.3 Pictograms on the Flashlight

Optical radiation: warns of potential damage to the retina caused by photobiological radiation.

3.4 Pictograms on the Packing

CE marking: confirms conformity with the applicable standards and legal provisions.

3.5 Overview of the Key Safety Notes

- The following safety notes should be read carefully before using the flashlight!
- If the flashlight is passed on to another person, the operating instructions and these precautions and warnings must also be passed on.
- If there are warnings or warning symbols on the item, they should not be removed.

3. Safety Notes

Health risk

WARNING

ACCIDENT/INJURY RISK FOR CHILDREN

Do not permit the flashlight to be operated by children, by persons under the influence of medication or drugs, or by persons with physical or mental disabilities/illnesses, as there is a risk of injury to the eyes and a risk of accidents.

Therefore:

- Do not allow children to play with the flashlight.
- Persons with limitations should only use the device under the supervision or instruction of a responsible person.

WARNING



RISK OF GLARE

The strong glare-effect of the flashlight may, however, cause temporarily limited vision and after-images that may cause irritation, disturbances or accidents.

Therefore:

- Never ever look directly into the beam of light or illuminate the eyes of another person, do not carry out pupil testing.
- Do not point the beam of light at people or animals as they may be dazzled.
- Do not use any optically highly-focused devices to observe the beam of light.
- Do not use multiple flashlights at once as this increases the optical radiation and thus increases the risk of retina damage.
- Commercial users or users in the public services are to be instructed in the applicable laws and regulations.

What to do:

- If a beam of light hits the eyes, deliberately close the eyes and move the head out of the beam of light.

CAUTION

RISK OF INJURY

Do not use flashlight or accessories if they are damaged, since there is a risk of injury.

Therefore:

- Take damaged parts out of operation and replace or have them repaired professionally.

CAUTION



PHOTOBIOLOGICAL SAFETY (EYE SAFETY)

The flashlight is classified in risk group 2 (medium risk) in accordance with standard IEC 62471 and thus extends beyond the “free group”. The risk of damage to the retina caused by optical radiation (blue light from 400 nm to 780 nm) is inherent, yet the thresholds are considerably undercut.

3. Safety Notes

NOTE

ELECTROMAGNETIC COMPATIBILITY

The flashlight meets the requirements of the 2014/30/EC guideline with regard to electromagnetic compatibility.

Modifications / Repairs

⚠ CAUTION

DO NOT MAKE ANY MODIFICATIONS/REPAIRS

Repairs, additions or modifications to the flashlight are not permitted as these may lead to damages to the flashlight or a risk to persons:

Therefore:

- LEDs cannot be replaced.
- Do not open the flashlight unless this is expressly permitted by the operating instructions.
- Never carry out repairs yourself, always take the flashlight to a specialist dealer.

Batteries and battery packs

⚠ WARNING



EXPLOSION OR RISK OF ACID BURNS

Batteries/battery packs can explode as a result of strong heating. Leaking of battery fluid can cause chemical burns.

Therefore:

Do not expose batteries and battery packs ...

- To direct sunlight or great heat over an extended period of time,
- Do not heat them or throw them into the fire and avoid heat buildup in the flashlight by covering it, for instance,
- Do not throw them into water or leave out in the rain,
- Do not swallow them,
- Do not open, damage or short-circuit them,
- Only recharge them if they are labeled accordingly,
- Do not store them within the reach of children,
- Only insert them into the battery compartment in accordance with the displayed markings (+/-),
- Should be removed from the flashlight if you will not be using it for some time or if they are empty.

What to do:

- In the event of leaking batteries, place a cloth underneath and prevent the skin, eyes and mucous membranes from coming into contact with battery fluid. In the event of contact, immediately rinse the affected parts with plenty of clean water and consult a doctor.

ATTENTION

CHANGING THE BATTERY

- Store batteries/battery packs in a clean, dry place between -10 °C and +25 °C.
- Only insert batteries/battery packs in accordance with the markings (+/-).
- If necessary, clean the battery/battery pack and/or flashlight contacts before inserting.

3. Safety Notes

- Never use new and used batteries/battery packs together.
- Only use high-quality batteries of the same type.
- Always change all batteries at the same time.

ATTENTION

RISK OF SHORT-CIRCUITING

In order to avoid the risk of a short-circuit when recharging:

- Do not touch the charging contacts with damp or metal objects.
- If need be, clean the charging contacts.
- Only recharge flashlight/battery packs in dry rooms.

ATTENTION

MALFUNCTIONING OF THE FLASHLIGHT

Always check the flashlight for functionality prior to use and, to be on the safe side, carry a replacement lamp and sufficient replacement batteries with you. If the flashlight does not function or does not function correctly, proceed as follows:

- Check whether the batteries/battery packs have been inserted with the poles (+/-) the correct way round and are fully charged.
- Check the flashlight or battery/battery pack contacts and clean if necessary.

What to do:

- To use all the functions again, insert new batteries or recharge the battery packs.

Disposal / environmental protection

ATTENTION

DISPOSAL/RECYCLING

Flashlights and used batteries/battery packs may not be disposed of in the household or residual waste. They must be disposed of in accordance with national legal requirements.

The materials are recyclable according to their labeling.

Reuse of the materials makes an important contribution toward environmental protection.

Therefore:

- Submit flashlights in to a local collection point for the recycling of electrical and electronic devices.
- Submit used batteries/battery packs to a local battery collection point or anywhere where batteries/battery packs are sold.
- Batteries, lithium batteries in particular, and battery packs may only be disposed of when discharged.
- Separate the packaging materials and dispose of correctly.

4. Overview of Terms and Abbreviations

	The following technical terms / abbreviations are used in these Operating Instructions:
SLT	Smart Light Technology
LED	Short for Light-Emitting Diode
Battery pack	Short for rechargeable battery, i.e. rechargeable energy source

5. Operation

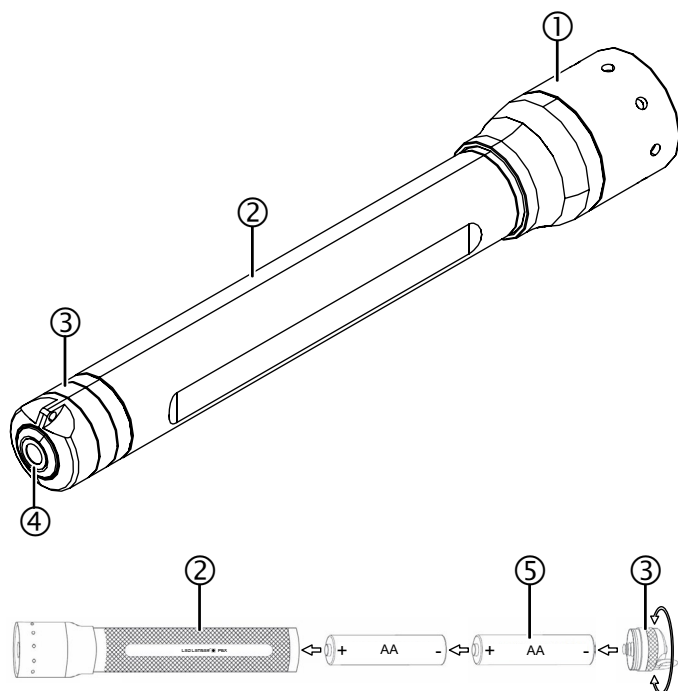

5.1 Inserting Batteries (only the boxed version)

In the "boxed" version of the flashlight, the included batteries must first be inserted. These have already been inserted in the "blister" packaging version.

1. To insert the batteries, unscrew the end cap ③.

⚠ CAUTION



RISK OF EXPLOSION

Always insert the batteries according to the (+/-) markings as there is otherwise a risk of damages or even exploding batteries.

2. Insert the included batteries ⑤ with the plus pole (+) first into the battery compartment ②.
3. Screw the end cap ③ back into place.

5.2 Switching the Flashlight On or Off

The flashlight is operated by pressing the push button on the end cap. The pushbutton can be engaged for constant illumination; just a gentle activation can be used to create flashes, for example, to send signals or warnings.

1. To switch the flashlight on firmly press the On/Off pushbutton ④ in the end cap ③ and engage.
 - The push button engages with an audible "click".
 - The flashlight is now constantly lit.
2. To switch the flashlight off press the On/Off pushbutton ④ in the end cap ③ again and release.
 - The pushbutton unlocks with an audible "click".
 - The flashlight is no longer lit.
3. To create light signals, press the On/Off pushbutton ④ in the end cap gently and, if need be, hold.

5.3 Quickly Focusing the Flashlight

The beam of the flashlight can be focused by sliding the head of the flashlight ① with one hand.

1. Switch flashlight on.
2. Hold the flashlight with the hand and grip the head ① with thumb and index finger.
3. Push the head ① backward/forward until the required beam width has been achieved.

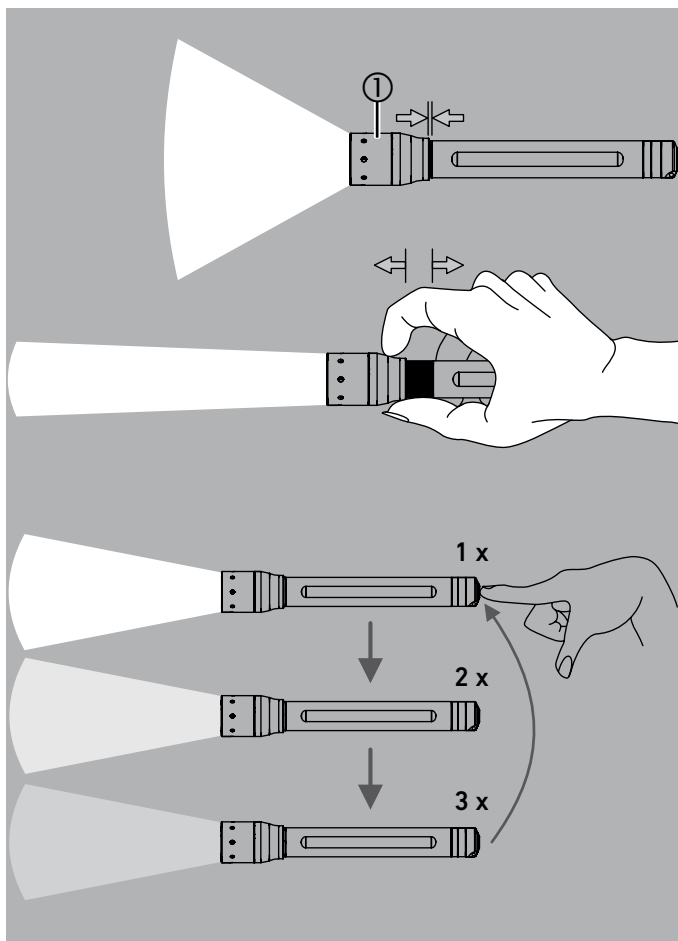

5. Operation

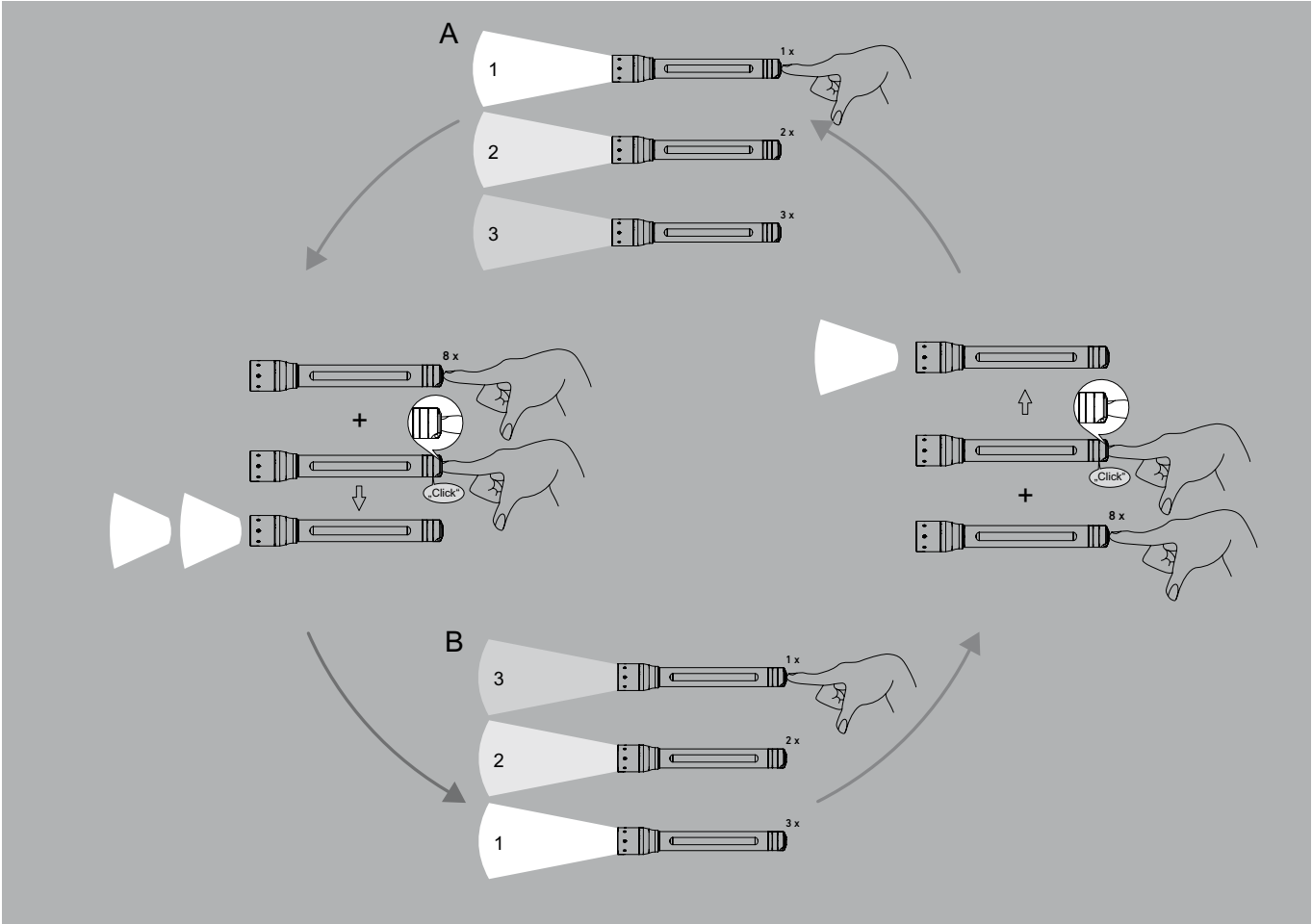

5.4 Using the Lighting Functions

The flashlight offers 3 lighting functions:

- 1 = High Power
- 2 = Power (normal) and
- 3 = Low Power (dimmed).

1. In order to use the lighting functions, either press and engage the On/Off pushbutton ②
 - multiple times or
 - gently press several times and when the desired program has been located, press firmly to engage.
- Each time you press the switch, you activate the next lighting function.
- After more than 3 gentle button pushes, the cycle returns to the beginning.

Press the push button	Light function
1 x	High Power
2 x	Power (normal)
3 x	dimmed light

5.5 Activating Lighting Programs

The flashlight has 2 lighting programs that can be used to determine the sequence of the lighting functions. In the delivered state, program A

5. Operation

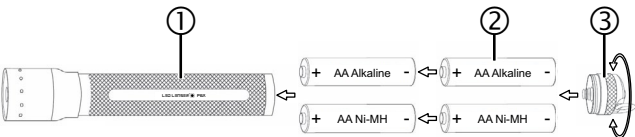

is activated. Use this method to select from the following programs:
Program A

Press the push button	Light function
1 x	High Power
2 x	Power (normal)
3 x	Low Power (dimmed)

Program B

Press the push button	Light function
1 x	Low Power (dimmed)
2 x	Power (normal)
3 x	High Power

1. Switch flashlight off.
2. To change the lighting program, press the On/Off push button 8 times (or more) and then engage.
 - The flashlight switches the lighting program and indicates this by briefly flashing twice.
 - After the flash, the first lighting function for the relevant program will be selected, thus, either High Power or dimmed light will be used.
 - Repeating the process switches back into the other lighting program.

5.6 Replacing the Batteries/Battery Pack

1. To remove the battery pack ② unscrew the end cap ③.
2. Remove the batteries/battery pack ②, dispose of the batteries appropriately and replace, recharge battery packs.

CAUTION



RISK OF EXPLOSION

Always insert batteries/battery packs according to the (+/-) markings as there is otherwise a risk of damaged or even exploding batteries.

3. New batteries/battery packs ② must be inserted with the plus pole (+) first into the battery compartment ①.
4. Screw the end cap ③ back into place.

ATTENTION

USING BATTERIES/BATTERY PACKS

The flashlight may only use 2 x AA batteries (LR6) or 2 x AA NiMH battery packs with 1.5 V.

5. Operation

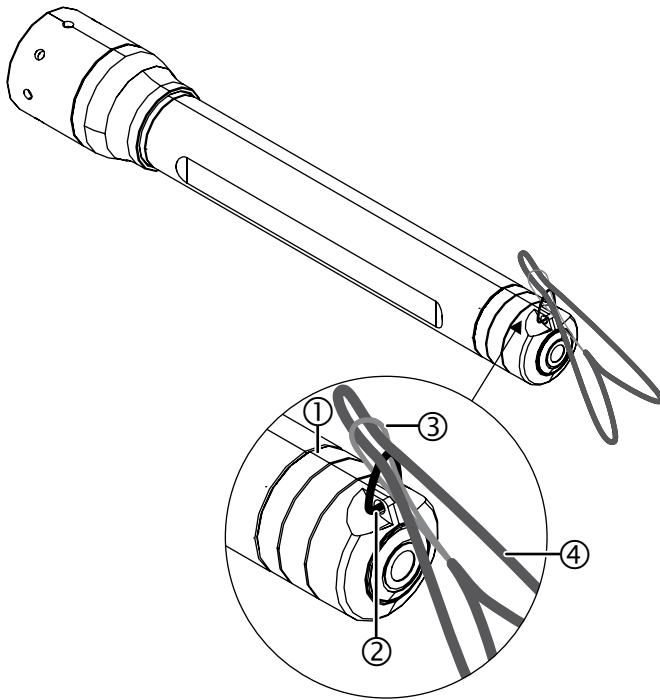

5.7 Attaching the Wrist Strap

The included wrist strap may be attached to the end cap.

1. Feed the thin loop ③ of the wrist strap through the attachment ring ② on the end cap ① of the flashlight.
2. Feed the thick loop ④ through the thin loop ③ and pull the thick loop ④ until the thin loop ③ has tightened on the ring ②.

5.8 Attaching the Belt Bag

The belt bag may be attached using the snap-hook or to a belt up to a width of 80 mm.

1. Open the snap-hook by pushing in and clipping the hook to, for example, the belt.
- or
2. Open the stud on the belt holder.
3. Remove the belt holder (hook and loop fastening)
4. Slide the belt holder behind your belt and secure onto the belt bag again.
5. Secure the belt holder by closing the stud.

5.9 Putting the Flashlight into the Belt Bag

1. Undo the hook and loop of the belt bag.
2. Slide the flashlight with the end cap first into the belt bag as far as it will go.
3. Close the hook and loop of the belt bag.

5.10 Automated Functions

5.10.1 Temperature Monitoring

The P6X is fitted with a temperature monitoring function (electronic regulation with temperature sensor). This prevents the flashlight from overheating when in use. This may result in a reduction in brightness as soon as the function is activated.

- If necessary, switch off the flashlight and allow to cool down.

5.10.2 Battery State Warning

A low charge state of the batteries is signaled by 3 brief flashes of the LED. The flashing is repeated every 15 seconds until the flashlight switches itself off automatically after 10 minutes.

- Change the batteries as described in chapter 5.5.

5.11 Cleaning

The following should be noted for cleaning:

- Clean the flashlight and its accessories only dry using a lint-free cloth.
- If the flashlight comes into contact with salt water, remove the salt water immediately and fully with a lint-free cloth.

5. Operation

ATTENTION

DAMAGE TO SURFACES

Solvents can damage surfaces or decompose materials!

Therefore:

- Do not use any cleaning agents or disinfectants.
- Do not use scouring agents.
- Do not use gasoline, paint thinners or similar products.

ATTENTION

WARRANTY EXEMPTION

No warranty will be assumed for damage resulting from the use of inappropriate cleaning agents/disinfectants.

5.12 Tests

Every product is prone to wear over time. Annually, and prior to each use, check the safety and function of the flashlight as well as the batteries/battery packs.

ATTENTION

Replace and dispose of damaged or old batteries / battery packs.

Do not use defective flashlights or accessory parts and contact vendor / distributor.

5.13 Warranty

Our products are subjected to stringent quality control. Please contact the vendor / distributor in the event that this flashlight does not function according to expectations.

ATTENTION

IMPROPER REPAIRS

The device may only be repaired by an authorized repair shop, otherwise legal warranty will become void.

6. Technical Data

P6X

Parameter value	Value		
LED	1 x High End Power LED		
Length	165 mm		
Weight	115 g		
Batteries	2 x AA LR6 / 2 x NiMH battery packs 1.5 V DC		
Energy tank***	8.4 Wh		
Lighting modes	High Power	Power	Low Power
Luminous flux*	400 lm	100 lm	10 lm
Burning life**	2 hours	6 hours	60 hours
Beam distance*	160 m	80 m	20 m
Water-tightness	IPX4		

* Luminous flux (lumen) or maximum beam distance (in meters) is measured setting given in the table when switching on with a set of fresh alkaline batteries. These are average values which may deviate by +/- 15 % for each individual case according to chip and batteries.

** Average burning life up to a luminous flux of 1 lumen.

*** Calculated value of the capacity in Watt hours (Wh). This applies to the batteries contained in the delivered state of the item.

