

HCP9100

Gas-Powered Air Compressor

User Manual

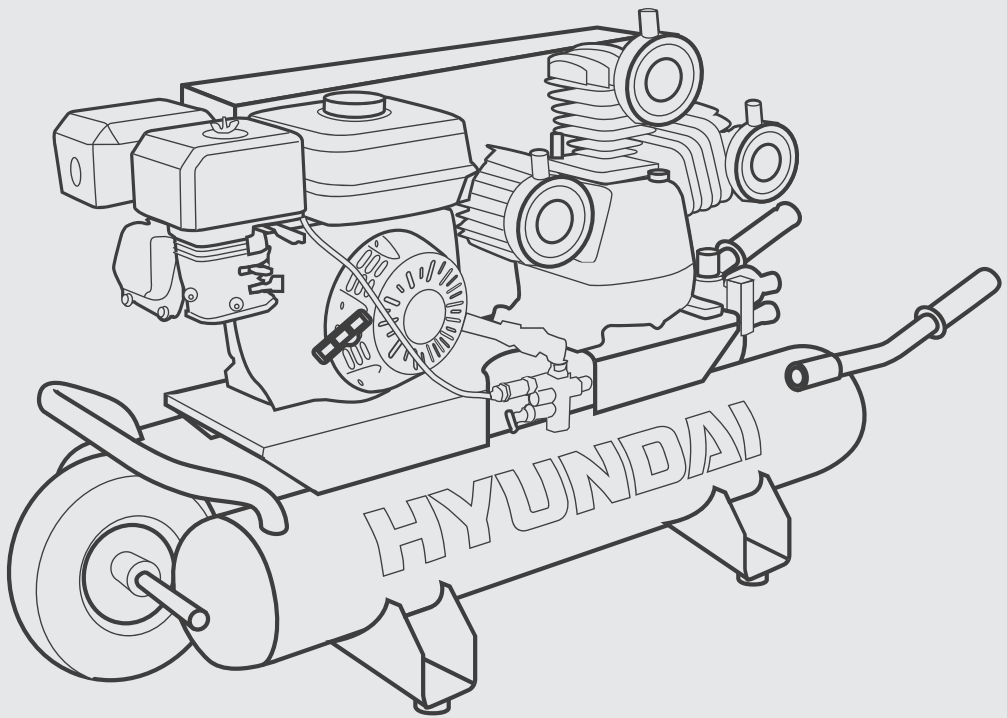

HYUNDAI

POWER EQUIPMENT

©2011 Hyundai Power Equipment. All Rights Reserved.

Licensed by Hyundai Corporation, Korea.

HCP9100-0711-02

COMMERCIAL
series®



Thank you for purchasing this Hyundai Power Equipment Air Compressor.

Please register this product in order to ensure warranty service in the future.

This manual covers the safety, operation and maintenance procedures for the HCP9100.

All information in this publication is based on the latest product information available at the time of print.

Visit www.powerbyhyundai.com for manual updates and operation notices.

No part of this publication may be reproduced without written permission. Please keep this manual together with the Owners Card. Contact Hyundai Power Equipment at the numbers listed on the Owners Card if warranty service is required.

It is important that anyone operating this product read and understand the manual prior to use.



Warranty Information

Warranty service, operation assistance and product support is provided by Midland International Inc., a licensed manufacturer of Hyundai Power Equipment.

www.powerbyhyundai.com

TECHNICAL ASSISTANCE

1-855-706-8475

CUSTOMER SERVICE

1-877-528-3772 (toll-free)

SALES

1-503-534-3684

Component Certifications

This product contains components certified by the following agency:



TABLE OF CONTENTS

1.0 - OPERATION SAFETY	
1.1 - Operation Safety	8
1.2 - Water Safety Guidelines	9
1.3 - Maintenance Safety	9
2.0 - COMPONENTS	
2.1 - Identification	10
2.2 - Assembly	12
2.3 - Adjusting Pressure	15
3.0 - PRE-OPERATION INSPECTION	
3.1 - Engine Oil Check	16
3.2 - Compressor Oil Check	17
3.3 - Fuel Level Check	17
3.4 - Air Filter Check	18
3.5 - Initial Inspection	19
3.6 - Pre-Start Checklist	19
3.7 - Initial Break-In Procedure	19
4.0 - OPERATION	
4.1 - Starting the Air Compressor	20
4.2 - Stopping the Air Compressor	21
5.0 - MAINTENANCE	
5.1 - Importance of Maintenance	22
5.2 - Maintenance Schedule	22
5.3 - General Inspection	23
5.4 - Air Filter Service	23
5.5 - Oil Maintenance	24
5.6 - Spark Plug Service	25
5.7 - Fuel Sediment Cup	26
5.8 - Handling and Storage	27
6.0 - TROUBLESHOOTING	28
7.0 - SPECIFICATIONS	30
WARRANTY	31



SAFETY

1.1 - Operation Safety

- Always perform a pre-operation check before starting the engine.
- Properly clean and maintain the equipment.
- Operate the Air Compressor according to instructions for safe and dependable service.
- Read user manual carefully before operating this product! Failure to do so may result in serious harm to the user and to the equipment.
- Never run in an enclosed area to avoid harm from exhaust emissions of a poisonous carbon monoxide gas.
- Be careful not to touch the exhaust system, compressor pump or discharge tubing during operation due to risk of burns.
- Pay attention to the warning labels. The engine exhaust system will become heated during operation and remain hot immediately after the engine is stopped.
- Gasoline is a highly flammable and explosive liquid. Refuel in a well ventilated area with the engine stopped.
- Do not operate the compressor with the belt guard removed!
- Do not puncture or alter the air tanks in any way.
- When refueling the Air Compressor, keep it away from cigarettes, open flames, smoke and/or sparks.
- Place at least 5 feet away from buildings or other equipment during operation.
- Run on a level surface to avoid fuel spills.
- Do not operate this tool without proper training.
- Keep children, pets and machinery with rotating parts away during operation.
- Do not operate in rain or snow.
- Do not allow any moisture to come in contact with the engine case.
- Do not touch the spark plug while the engine is operating or shortly after the engine has been shut down

1.2 - Water Safety Guidelines

- Keep all protective components in place - do not remove guards or shields from any part of the engine
- Use caution near the engine - do not soak or expose the casing to a constant flow of water
- Do not operate while wearing open-toed shoes

1.3 - Maintenance Safety

- After any maintenance is performed, wash hands immediately using soap and clean water because repeated exposure to lubricant may cause skin irritation.
- Do not clean the filter element with flammable liquids like gasoline because explosion may occur.
- Turn off the engine set before performing any maintenance. Doing so may result in severe personal injury or death.
- Allow the engine to cool down before performing any maintenance.
- Always wear safety glasses when cleaning the engine with air.
- Use rubber gloves when coming into contact with engine oil.
- Always stop the engine before removing the oil filler cap.
- Only qualified maintenance personnel with knowledge of fuels, electricity, and machinery hazards should perform maintenance procedures.



2 - COMPONENTS AND ASSEMBLY

2.1 - Identification of Components

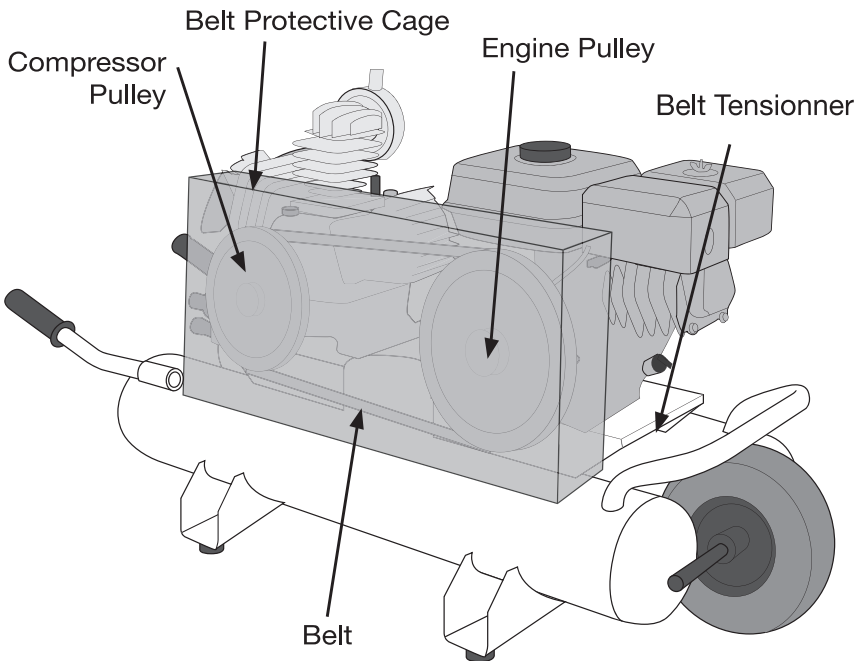
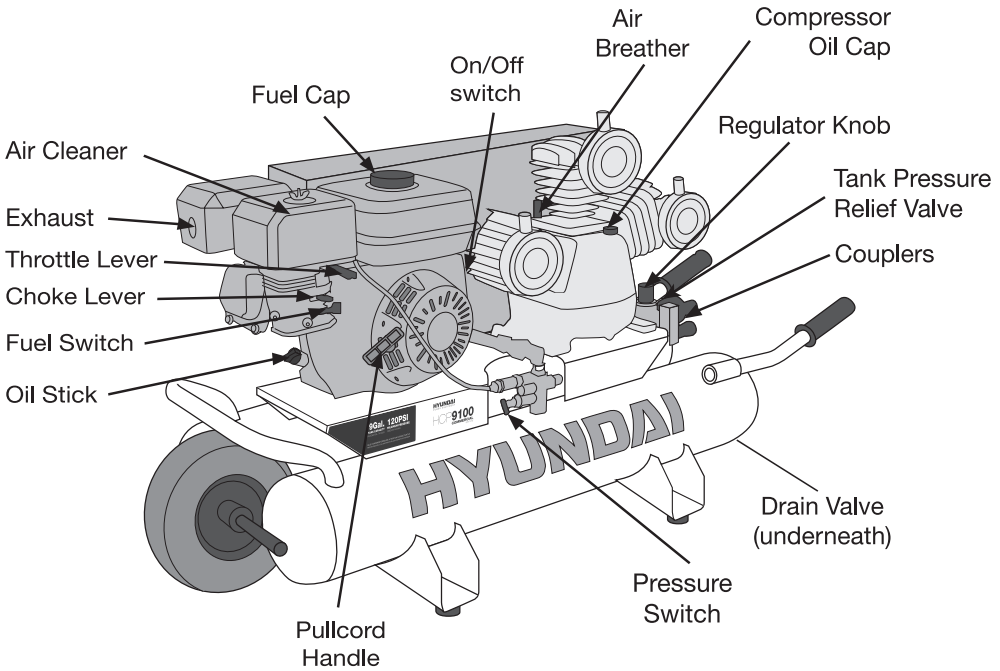

AIR CLEANER MAINTENANCE
 Rinse with detergent solvent and dry. Wash the filter with water every 25 to 30 hours of operation. Wash the filter once every 10 hours of operating under dusty conditions. Immerse the filter into kerosene or engine oil and dry. Do not reuse oil excessive if not reused.

MANTENIMIENTO DEL FILTRO DE AIRE
 Limpieza con un producto solvente de limpieza y seque. Lave el filtro con agua cada 25 a 30 horas de operación. Lave el filtro una vez cada 10 horas de operación en condiciones de mucho polvo. Una vez que está limpio y seco, sumérjelo en aceite de motor. No reutilice el aceite de aceite y reutilice.

INCREASE POWER ← **DECREASE POWER**
AUMENTAR EL PODER ← **DISMINUIR EL PODER**

CLOSE ← **OPEN**
CERRAR ← **ABRIR**

↑ **HOT SURFACE** / **↑** **SUPERFICIE CALIENTE**
KEEP CLEAR / **KEEP AWAY**
MANTENGA LA DISTANCIA
DE LOS OBJETOS QUE PASAN

ON →
OFF ←

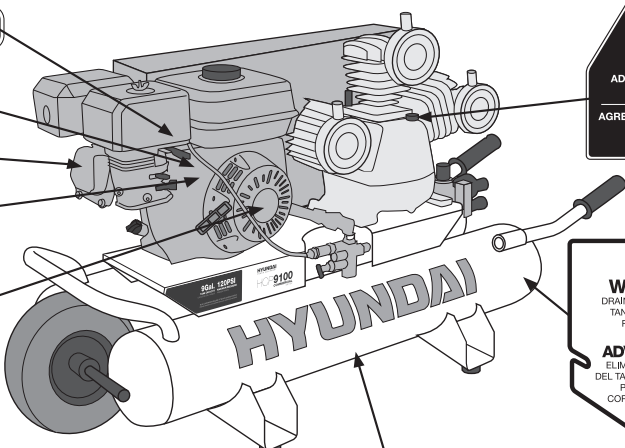

ADD OIL BEFORE USE!
DO NOT OVER-FILL
AGREGUE B EL PETRÓLEO
ANTES DEL USO
NO SATURE

WARNING
DRAIN MOISTURE FROM
TANK EVERY DAY TO
PREVENT TANK
CORROSION
ADVERTENCIA
ELIMINE LA HUMEDAD
DEL TANQUE DIARIAMENTE
PARA EVITAR LA
CORROSIÓN DENTRO
DEL MISMO

WARNING LINE STARTS. AUTOMATICALLY REGULATE POWER SUPPLY & RELEASE AIR PRESSURE RAPID TO COMMENDING SERVICE MODES. ADVERTENCIA AL LINEA SE ENCENDIÓ EL MOTOR. EL EQUIPO AUTOMÁTICAMENTE REGULA EL SUPLENTO DE CORRIENTE Y LIBERA LA PRESIÓN DE AIRE ANTES DE REALIZAR CUALQUIER OPERACIÓN DE MANTENIMIENTO.	OIL LEVEL MAINTAIN CORRECT OIL LEVEL. USE ONLY OIL GRADE SPECIFIED IN THE INSTRUCTION MANUAL. NIVEL DE ACEITE MANTENGA EL NIVEL DE ACEITE ADECUADO. UTILICE SOLO EL ACEITE CON LA GRADUACIÓN INDICADA EN EL MANUAL DE INSTRUCCIONES.	RECEIVER DRAIN TO PREVENT BUILDUP OF CONDENSATION, OPEN DRAIN COCK DAILY. DRENAJE DE RECEPCIÓN PARA EVITAR LA ACUMULACIÓN DE CONDENSACIÓN, ABRA LA LLAVE DE PASO DEL DRENAJE DIARIAMENTE.	AIR INLET FILTER WHEN FILTER BECOMES DIRTY CHECK & REPLACE ELEMENT. REFER TO INSTRUCTION MANUAL. FILTRO DE AIRE INTERIOR CAMBIE EL FILTRO SI SE ENCUENTRA CONTAMINADO O SI SE ENCUENTRA EMPAQUETADO. SIGA LAS INSTRUCCIONES DEL MANUAL.	OPERATING READ INSTRUCTION MANUAL PRIOR TO STARTING UNIT. OPERATES FROM AC MAIN ONLY. OPERAR LEA LAS INSTRUCCIONES DEL MANUAL ANTES DE ENCENDER EL EQUIPO. ESTE EQUIPO SE OPERA SOLO POR LAS TOMAS DE CORRIENTE ALTERNIA.	DANGER ENSURE MAIN OUTLET IS ACCURATELY RATED FOR THE UNIT. DECONNECT AND COVER BEFORE REMOVING ANY COVERS. PELIGRO LEA LAS INSTRUCCIONES DEL MANUAL ANTES DE ENCENDER EL EQUIPO. ESTE EQUIPO SE OPERA SOLO POR LAS TOMAS DE CORRIENTE ALTERNIA.	DANGER AIR DICHARGED FROM THE UNIT IS HOT. SUAPLE FOR HUMAN CONSUMPTION. PELIGRO EL AIRE QUE SE LIBERA DEL EQUIPO NO ES APTO PARA EL CONSUMO HUMANO.
--	---	--	--	--	---	---

ATTENTION! / ATENCION!

- Never add fuel when the engine is running.
- Never add fuel when engine is hot.
- Always add fuel in a well-ventilated area.
- Always clean up fuel spills.

*Nunca añada combustible cuando el motor está funcionando.
 *combustible cuando el motor está caliente.
 *Siempre añada combustible en un área ventilada.
 *Limpiar bien cualquier derrame de combustible.

HCP9100
UNLEADED GASOLINE ONLY
87+ OCTANE + 10% ETHANOL MAX
SOLO GASOLINA SIN PLOMO
3.6L / 1 GAL

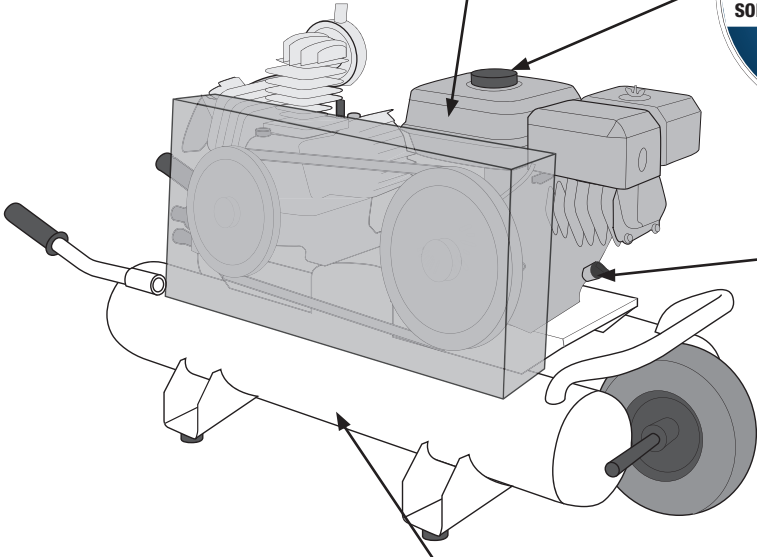

ADD OIL BEFORE USE!
DO NOT OVER-FILL
10W30
AGREGUE EL PETRÓLEO
ANTES DEL USO
NO SATURE

ATTENTION!

Read, understand and follow the safety instructions and warnings provided in the user's manual. Failure to follow the instructions can lead to death, serious injury and equipment damage. Never add fuel when the engine is running. Always turn off the engine and allow the engine to cool down before adding fuel. Always use fuel in a well-ventilated area. Never use fuel in an enclosed area. Overloading the engine in wet or damp conditions can lead to shock or electrocution. Always keep the air compressor and the surface it is on dry. Never touch the end of an air hose while the engine is running. Always stay away from electrical equipment. Never connect to a grounded metal object unless a transfer switch has been installed by a qualified electrician.

Lea, entienda y siga todas las instrucciones de funcionamiento y advertencias que se proporcionan en el manual del usuario. No obedecer las instrucciones puede resultar en la muerte, lesiones graves y daños al equipo. Nunca añada combustible mientras el motor está funcionando. Siempre apague el motor y permita que se enfríe antes de añadir combustible. Siempre use el combustible en un área bien ventilada. Nunca use combustible en un espacio cerrado. Sobrecargar el motor en condiciones húmedas o húmedas puede causar electrocución. Siempre mantenga seco el motor y el lugar donde se encuentre el equipo. Nunca toque el extremo libre de una manguera de aire cuando el motor está funcionando. Siempre mantenga seco el motor y el lugar donde se encuentre el equipo. Nunca conecte a un objeto metálico conectado a tierra a menos que un interruptor de transferencia haya sido instalado por un electricista calificado.

ATENCION!

Lea, entienda y siga todas las instrucciones de funcionamiento y advertencias que se proporcionan en el manual del usuario. No obedecer las instrucciones puede resultar en la muerte, lesiones graves y daños al equipo. Nunca añada combustible mientras el motor está funcionando. Siempre apague el motor y permita que se enfríe antes de añadir combustible. Siempre use el combustible en un área bien ventilada. Nunca use combustible en un espacio cerrado. Sobrecargar el motor en condiciones húmedas o húmedas puede causar electrocución. Siempre mantenga seco el motor y el lugar donde se encuentre el equipo. Nunca toque el extremo libre de una manguera de aire cuando el motor está funcionando. Siempre mantenga seco el motor y el lugar donde se encuentre el equipo. Nunca conecte a un objeto metálico conectado a tierra a menos que un interruptor de transferencia haya sido instalado por un electricista calificado.



2.2 - Assembly

Before using this Air Compressor, make sure that the detachable components have been properly assembled. If any parts show signs of damage or are missing, do not proceed with use. Contact Hyundai Power Equipment to request a replacement immediately.

Do not attempt to assemble or connect any components while the engine is running. Do not force any attachments if you feel excess resistance. Make sure that all connections are secure before proceeding to start the engine and use the Air Compressor.

1. Expand Handles - Twist the handle locks using an allen key or screwdriver. Once loose, extend the telescoping assembly and tighten locks accordingly. Do not overtighten.

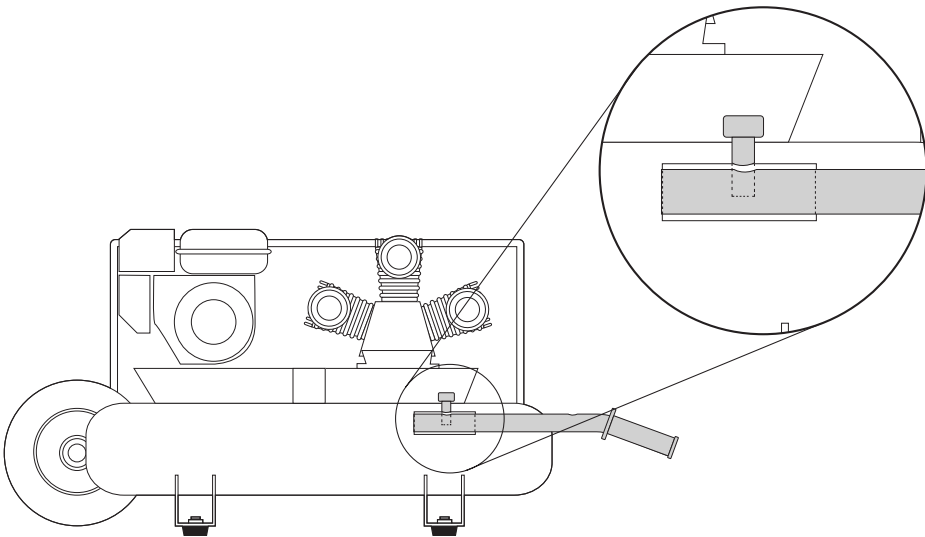

For HCP9100 V.1 air compressors, the locking procedure involves a three-bolt locking system that requires the use of a tool to adjust the handle.

2. Connect Hose to Compressor - Pull back the quick-connector and insert into the base of the outlet. Press firmly into opening and ensure that the quick-connector clicks into place. Repeat when connecting to Air Tool.

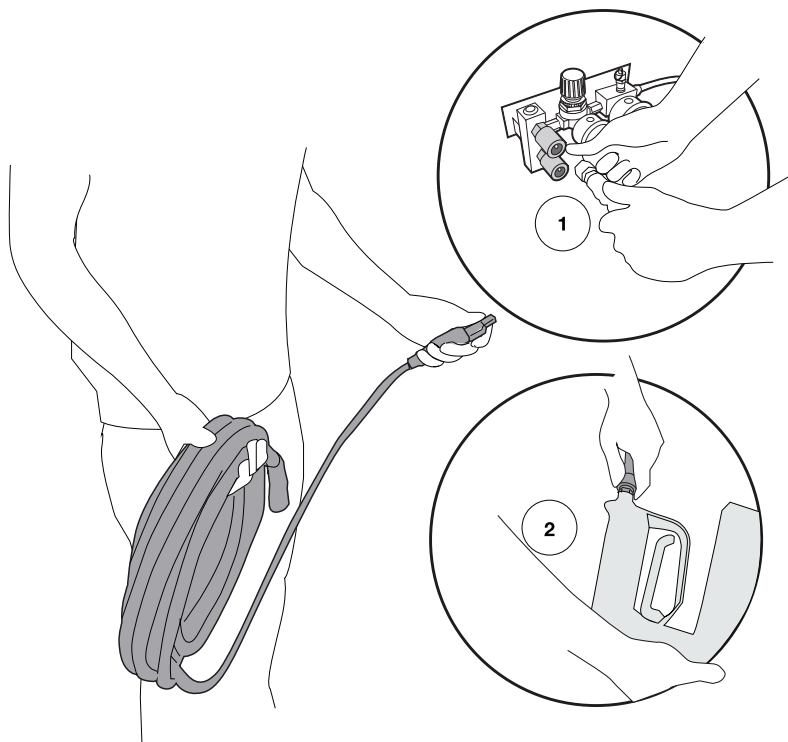

3. Check engine oil (see section 3.1). If necessary, add oil - Open oil inlet located near the recoil starter handle. Remove the dipstick and pour in the supplied oil with a funnel. Do not operate without oil.

Reservoir can hold maximum 20 fl.oz of 10W30 oil - do not over fill.

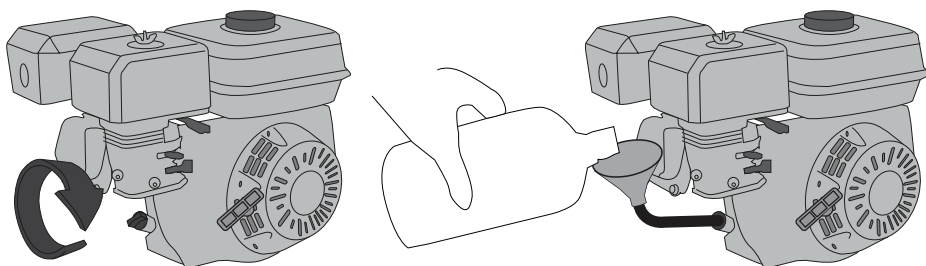

4. Check compressor oil (see section 3.2). If necessary, add oil - Oil inlet is located across from the output opening. Rotate screw and apply oil using a funnel. Do not operate without oil.

Compressor requires 10W30 oil - do not over fill.

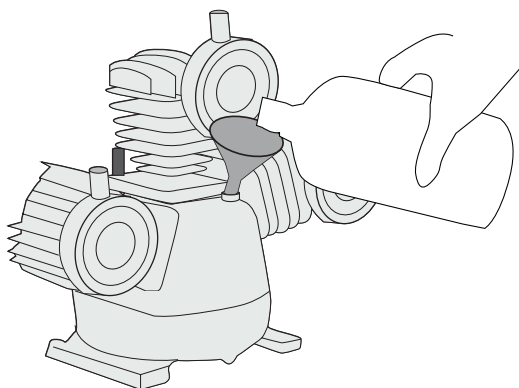
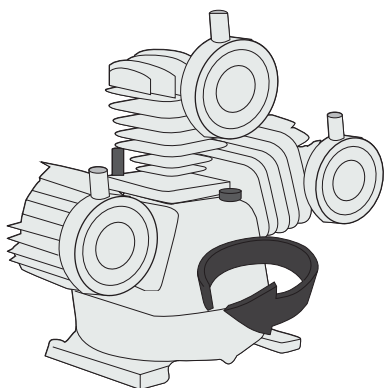

5. Fill Fuel Tank - Remove tank cap and fill tank using a funnel. Immediately wipe any excess fuel and take care not to overfill tank.

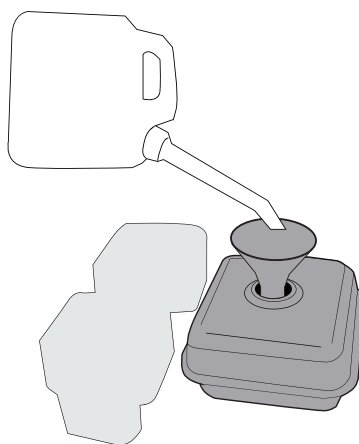
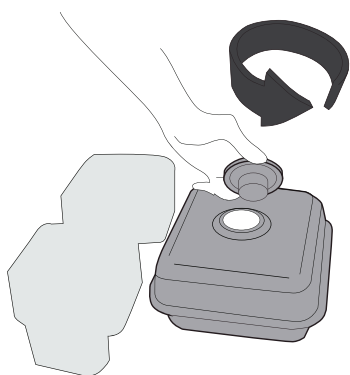

2.3 - Adjusting Pressure

Tank pressure is adjusted at the factory (knob is set fully clockwise). To adjust the pressure before use, twist the protective cap to reveal the Pressure Adjust Ring underneath. Twist the ring to adjust the pressure accordingly. Refer to the tank pressure and output pressure dials to ensure that both are at a safe level. Ensure that the protective cap is twisted back to conceal the pressure adjust ring to prevent unwanted changes in pressure.

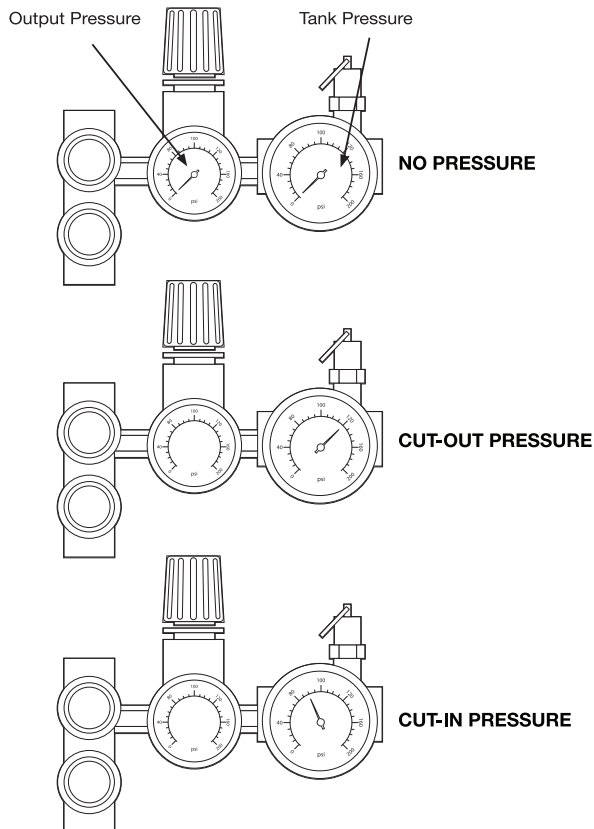
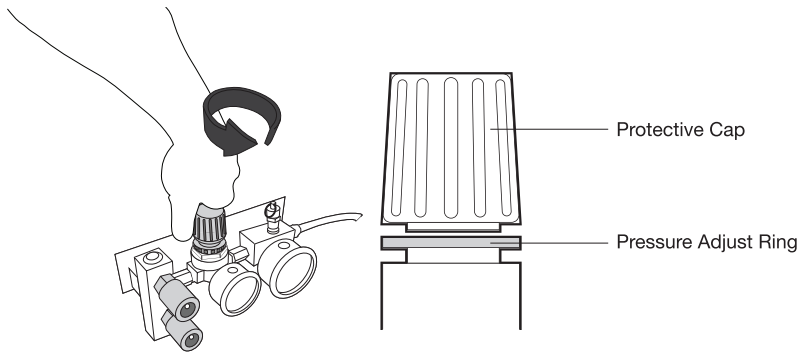

3.0 Pre-Operation

Inspect all components for damage and to ensure that none are missing. If you require a replacement, do not operate this machine until all parts are present and in proper working order.

Do not modify or create accessories for this equipment. Using modified components may result in damage to this equipment and may void the warranty. Contact customer service if you suspect that this equipment has been tampered with.

3.1 - Engine Oil Check

1. Ensure the Air Compressor is on a level surface.
2. Inspect engine oil:
 - Take out the oil filler cap and clean the dipstick.
 - Check the oil level by reinserting the oil filler cap without rotating it.Remove the oil filler cap and examine the oil level. If the oil level is at or below the lower level, refill the oil to the upper limit mark. (10W30)
Reinsert the oil filler cap and tighten securely. (Refer to figure)

Engine oil is a major factor affecting engine performance and service life. Non-detergent or vegetable oils are not recommended.

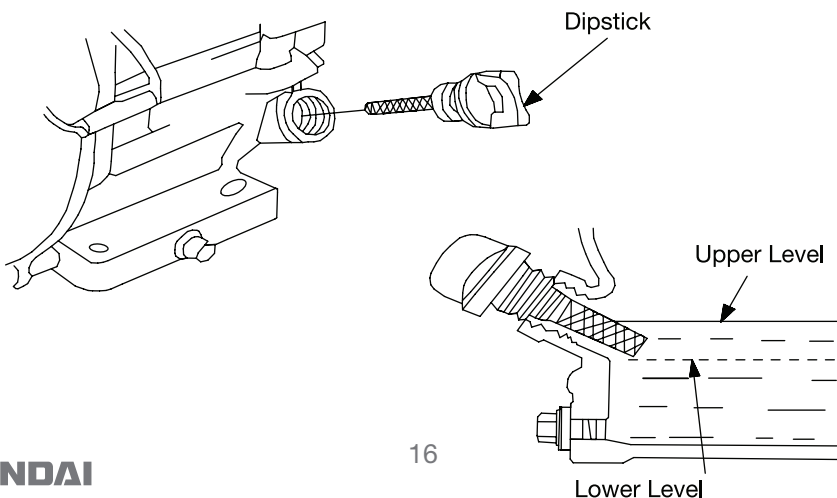

3.2 - Compressor Oil Check

1. Ensure the air compressor is on a level surface.
2. Inspect compressor oil by checking oil level indicator
3. The window should be filled past the midway point indicated by a red dot. If the oil level is below the red dot, add more oil to the pump.

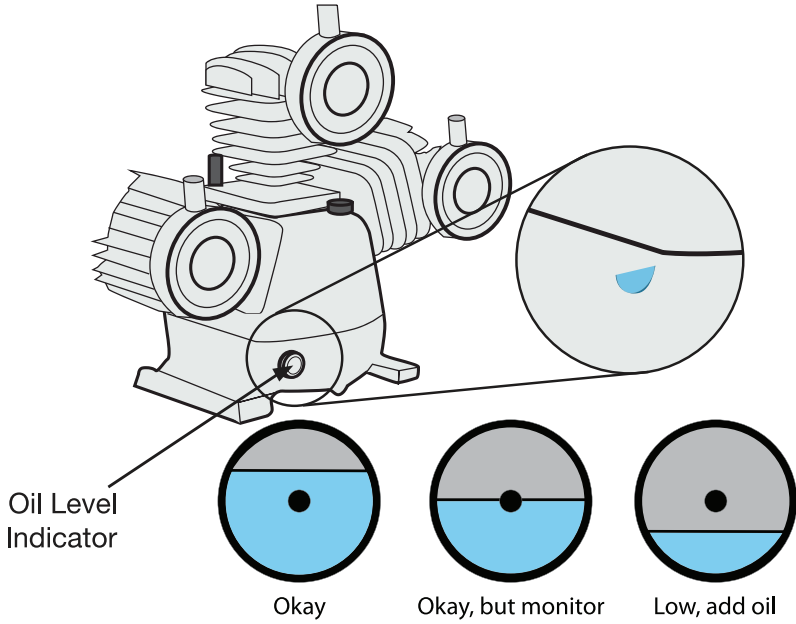

3.3 - Fuel Level Check

1. Check the fuel level by opening the tank and visually inspecting
2. Refuel if level is too low. Tighten the fuel tank cap securely after refilling

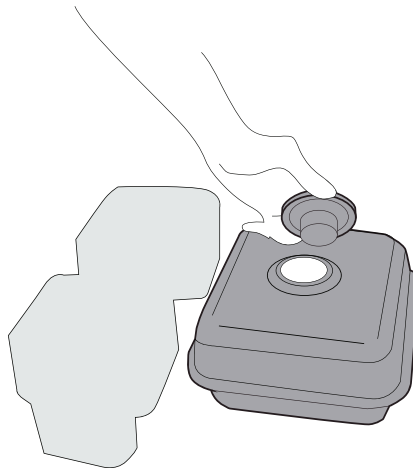

Gasoline is highly flammable and explosive under certain conditions. Refuel in a well-ventilated area with the engine stopped. Do not smoke or allow open flames or sparks in the area where the Air Compressor is being refueled or where gasoline is stored. Do not overfill the tank. Be careful not to spill fuel when refueling. Wipe up any spilled gasoline and let the area dry before starting the engine.

Gasoline substitutes such as gasohol are not recommended. They may be harmful to the fuel system components

3.4 - Check the Air Filter

1. Loosen the knob and remove the air filter cover. Remove the air filter element and observe for cleanliness. (Refer to Fig. 3.2)
2. Clean the air filter element with soap and water or solvent. Squeeze dry and then soak in clean engine oil.
3. Squeeze out all excess oil and reinstall. Replace the element if it is damaged.

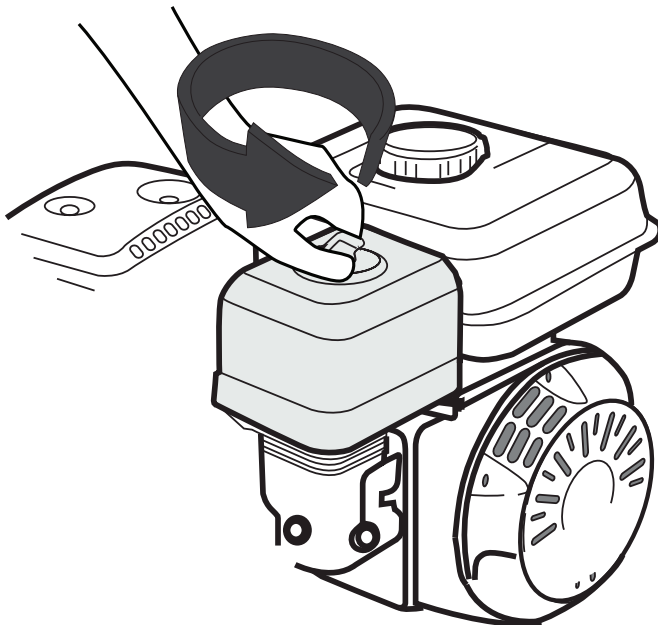

Check the air filter using the maintenance schedule. Always inspect air filter before using the Air Compressor. Clean Air Filter every 3 months or after 50hrs of operation according Section 5.4: Air Filter Service procedure.

3.5 - Initial Inspection

All air compressors have been inspected carefully before leaving the factory. It is possible that poor handling during transport caused some damage to the compressor. Fully inspect the compressor before use.

1. Inspect the entire unit for any concealed and/or visible damage.
2. Make sure any damaged parts are replaced and any mechanical issues are repaired by a qualified and licensed/certified mechanic.

3.6 - Pre-Start Checklist

1. Make sure that the ON/OFF switch is in the OFF position.
2. Make sure that the air tank is fully drained.
3. Make sure that the air tank pressure gauge reads 0 PSI.
4. Make sure that the drain valves are closed.
5. Make sure that all covers and safety guards are properly installed.

3.7 - Initial Break-In Procedure

The following instructions should be followed before the first time the compressor is operated in order to optimize the life of the compressor and to help prevent any damage to the unit.

1. Open the drain valve in order to allow air to escape and prevent pressure from building up inside the tank.
2. Start the engine according to the procedure outlined in the start up procedure.
3. Allow the compressor to run for approximately 15 minutes.
4. Close the drain valve, allowing pressure to build to the cut-out pressure. The compressor will shut off automatically.
5. Use the compressed air in the tank with an approved attachment or allow it to bleed out.



4.0 - OPERATION

4.1 - Starting the Air Compressor

Make sure that the drain valve is OPEN in order to allow air to escape and prevent pressure from building up inside the tank.

RECOIL START METHOD

1. Rotate the fuel valve lever to ON position.
2. If the engine is cold: Pull the choke lever into the CLOSE position.

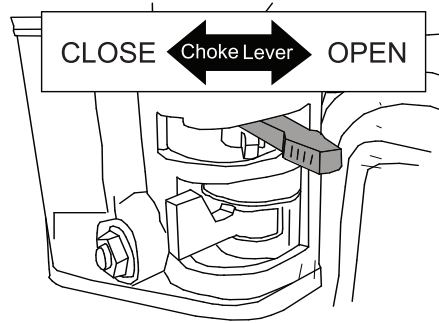
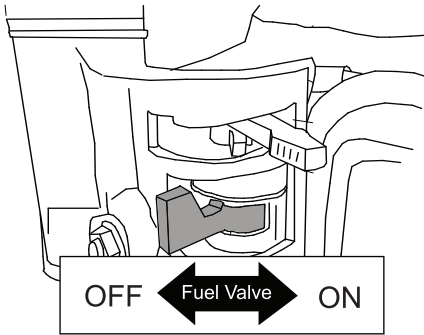

3. Grasp the recoil starter handle and pull it until the engine starts.

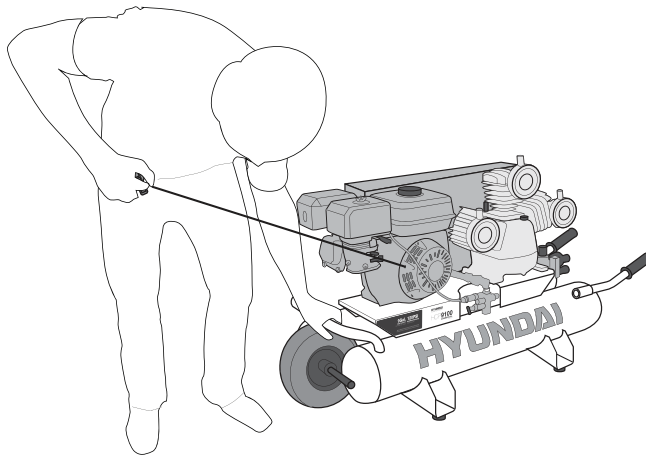

Do not allow the recoil starter to snap back. Return it slowly by hand

4. Push the choke lever to the OPEN position as the engine warms up. The choke is used to provide the proper mixture when the engine is cold. It can be opened and closed manually by moving the choke lever to the closed position to enrich the mixture for cold starting.
5. After 5 minutes, slowly push the throttle lever to the OPEN position. Engine RPMs will increase until engine reaches its stable running speed.

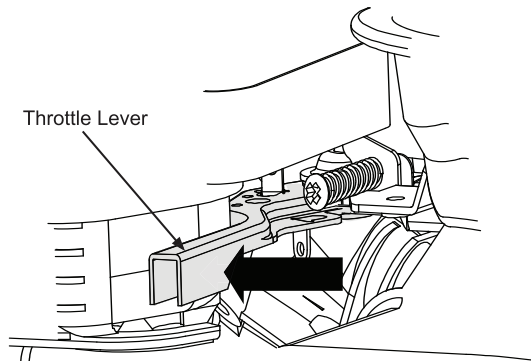

If the engine backfires or does not start repeated attempts, contact customer support and do not attempt to use the Air Compressor.

4.2 - Stopping the Air Compressor

1. Turn the engine switch to the OFF position.
2. Turn the fuel valve lever to the OFF position.
3. When the regulated pressure gauge reads 0 PSI, remove the attached hose and accessory.
4. Drain all air and water from the air tank.
5. Once the tank is fully drained, close the drain valve.
6. Store in a safe, dry, non-freezing area.

5.0 - MAINTENANCE

5.1 - Importance of Maintenance

Proper maintenance ensures safe, economical and trouble-free operation. Improper maintenance may cause the Air Compressor to malfunction and can lead to serious injuries. Contact Hyundai Power Customer Support if you have any maintenance questions.

5.2 - Maintenance Schedule

ITEM	TASK	DAILY	EVERY 20 HOURS	EVERY 50 HOURS	EVERY 100 HOURS	EVERY 300 HOURS
General Inspection		●				
Engine Lubricants	Inspect Oil Level	●				
	Replace		●		●	
Air Filter	Inspection	●				
	Cleaning			●		
Sediment Bowl	Cleaning			●		
Spark Plug	Inspection &Cleaning				●	
	Replacement					●
Valve Clearance	Inspection & Adjusting					●
Combustion Chamber	Inspection & Adjusting					●
Fuel Tank and Strainer	Cleaning					●
Drain condensation in tank		●				
Check for unusual noise/vibration		●				
Check for air leaks		●				
Check safety relief valve		●				
Clean exterior of compressor		●				
Fuel Line	Every two months (replace if necessary)					

5.3 - General Inspection

1. Look for fuel leaks around the fuel tank, fuel hose, fuel valve and carburetor. Close the fuel valve and repair leaks immediately.
2. Look and listen for exhaust leaks while the engine is running. Have all the leaks repaired before continuing operation.
3. Check for dirt and debris and clean as necessary
4. Check the engine oil level and add oil as necessary.

Do not use gasoline or low flash point solvents for cleaning. They are flammable and could explode under certain conditions.

5.4 - Air Filter Service

Using gasoline or other flammable solvents can cause a fire or explosion. Do not operate this product without an air filter.

1. Rotate the knob counterclockwise to release.
2. Lift the air cover to remove from the air filter unit.
3. Remove the foam element.

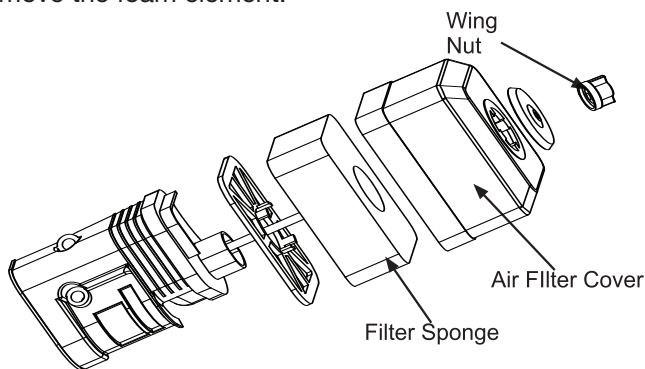

4. If the foam element is dirty, clean it in warm soapy water, rinse, and allow it to dry thoroughly, or clean in non-flammable solvent and allow to dry.

5. Dip the foam element in clean engine oil, then squeeze out all excess oil.
The engine will smoke when started if too much oil is left in the filter.
6. Wipe dirt from the air filter unit and cover using a moist rag.

5.5 - Oil Change and Oil Drainage

*Used motor oil can cause skin irritations if left in long-term contact with skin.
Wash hands thoroughly with soap and water after handling oil.*

Do not dispose of used oil in drains or on soil. Local service shops provide environmentally-friendly disposal methods.

1. Stop the engine and remove oil filler cap.
2. Place a pan under the engine.
3. Remove the oil drain screw and allow the oil to completely drain into the pan.
4. Reinstall drain screw before filling the engine with fresh oil. Do not overfill oil reservoir. Use a funnel to prevent spillage.
5. Reinstall the filler cap and tightly fasten it.

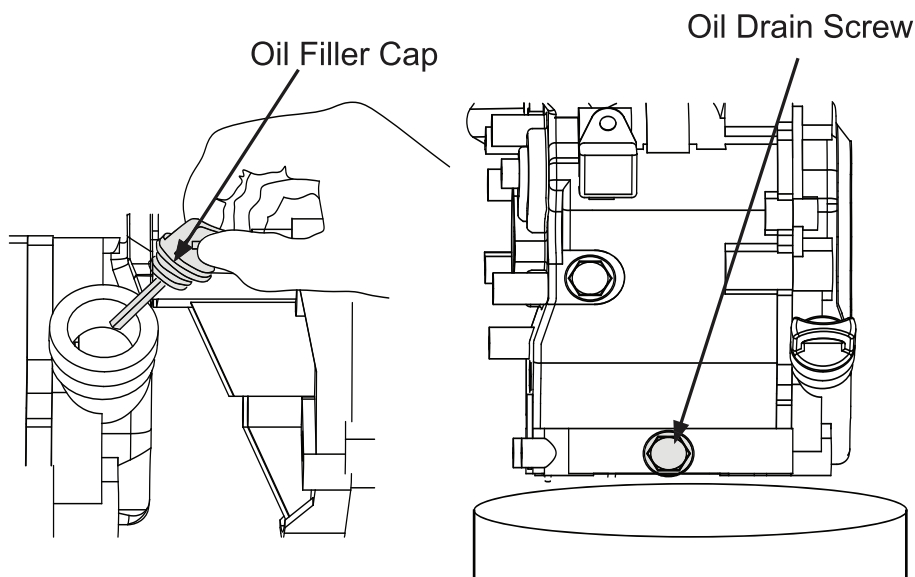

5.6 - Spark Plug Service

Do not rinse spark plug in water. Follow guidelines and be careful not to overtighten the spark plug.

Tighten $\frac{1}{2}$ turn when installing a new spark plug.

Tighten $\frac{1}{4}$ turn when re-installing an old spark plug.

1. Disconnect and remove the spark plug using a wrench.
2. Inspect the spark plug and clean any dirt from the electrodes with a wire brush. If electrodes are worn or show signs of wear, replace spark plug.
3. Measure the electrode gap with a spark plug gauge and adjust as necessary by bending the side electrodes. Ensure that the gap is between 0.7 and 0.9mm
4. Reinsert the plug carefully. Tighten with a spark plug wrench.

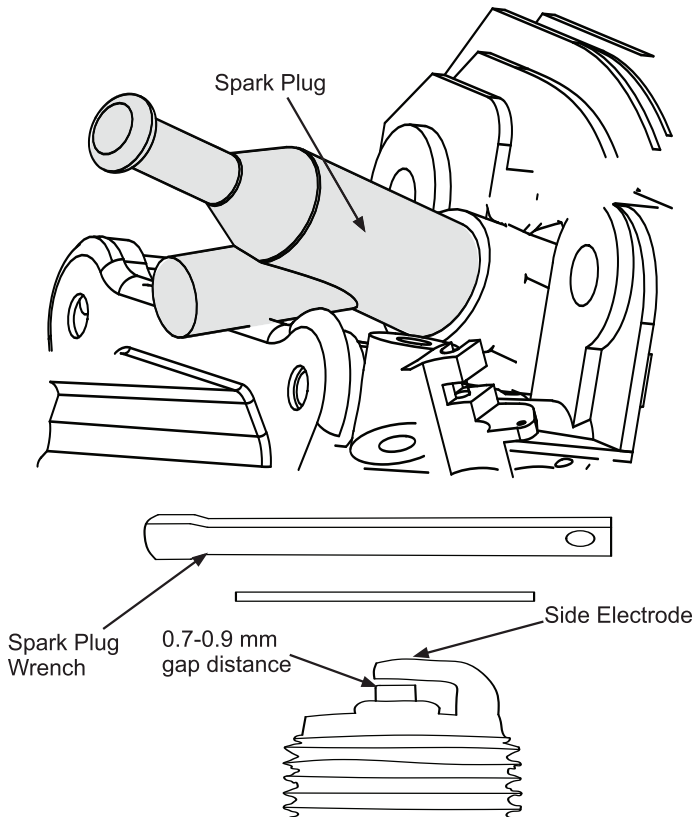

5.7 - Fuel Sediment Cup Service

1. Switch fuel valve to the OFF position.
2. Unscrew the sediment cup using a wrench and remove the O-ring.
3. Wash the cup and O-ring in a non-flammable solvent and dry thoroughly.
4. Place the O-ring in the fuel valve, then attach sediment cup. Tighten securely.
5. Switch the fuel valve to the ON position and check for leaks. Replace O-ring if leakage occurs.

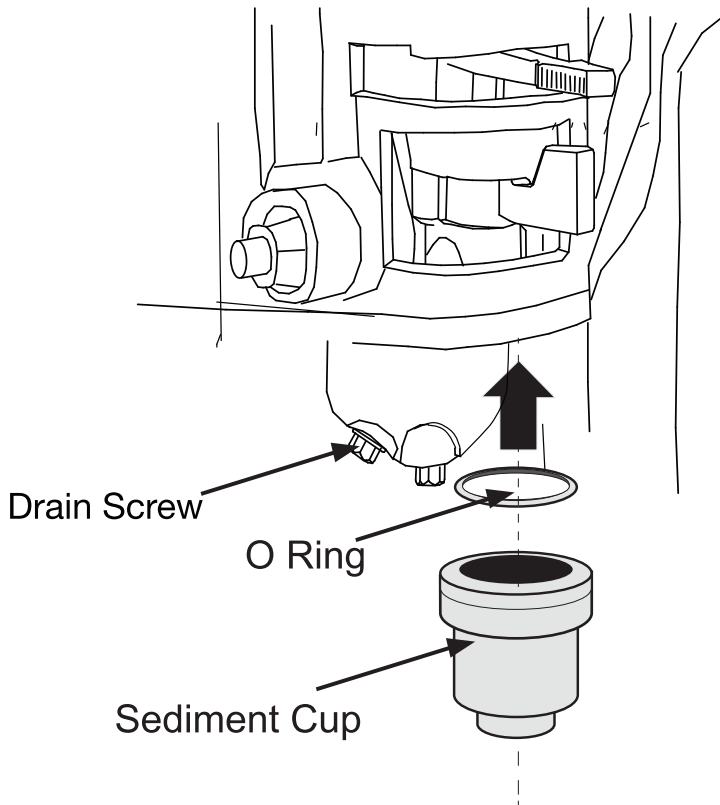

5.8 - Handling and Storage

HANDLING

1. Turn off the engine switch and the fuel valve when transporting the Air Compressor set.
2. Turn off the engine switch and the fuel valve when transporting the Air Compressor.
3. Keep the Air Compressor at a level position in order to prevent fuel spills.

STORAGE:

Before storing the Air Compressor set for an extended period:

1. Ensure that the storage area is free of excessive humidity and dust.
2. Drain the fuel tank and the carburetor.

DRAINING THE FUEL TANK

1. Turn the engine switch off.
2. Remove the fuel tank cap and the debris screen under the cap.
3. Empty the fuel tank using a siphon and an approved gasoline container.

DRAINING THE CARBURETOR

1. Turn the engine switch OFF.
2. Turn the fuel valve ON.
3. Position a suitable container under the carburetor drain screw to catch fuel; loosen the screw.
4. Allow fuel to drain completely into container.
5. Retighten drain screw.



6.0 - TROUBLESHOOTING

Common issues can be fixed by following the instructions in this guide. If the unit will not function after following these instructions, contact technical support before attempting to use or repair the product.

ISSUE	CAUSE	ACTION
Engine cranks slowly	Engine oil is too heavy	Replace with recommended oil
	Load is connected	Disconnect load while starting
Engine is not starting	No fuel	Refill fuel tank
	Fuel valve is closed	Fully open fuel valve
	Fouled spark plug	Remove, clean or replace spark plug
Black exhaust	Not enough oil	Add more oil
	Choke stuck in closed position	Open choke
	Dirty air filter	Clean air filter
Engine stops	Rich fuel mixture	Contact customer service
	No fuel	Refill fuel tank
Engine has difficulty idling	Not enough oil	Add more oil
	Loose spark plug cable	Reconnect or repair cable
	Faulty spark plug	Remove, clean or replace spark plug
	Air Compressor set not level	Move Air Compressor to a level surface
Compressor does not supply enough pressure to operate	Dirty fuel filter	Replace the filter
	Air leak in safety valve	Check valve manually – pull upward on rings. If condition persists, replace valve
	Restricted air filter	Clean or replace air filter
Excessive tank pressure; Safety relief valve releasing	Defective check valves	Contact customer service
	Defective pressure switch or improper adjustment	Check for proper adjustment and if problem persists, contact customer service
Moisture in discharged compressed air	Condensation in air tank caused by humidity	Drain tank and relocate the compressor
	Compressor located in damp or humid area	Purchase In-Line air filter system
Compressor does not come up to speed	Defective pump	Contact Hyundai Power Customer Service
	Defective pressure switch	Replace the pressure switch
Compressor runs excessively hot	High duty cycles	Run compressor for lighter cycles
	Compressor unit cannot supply enough air	If accessory's required CFM is higher than pressure supply, larger compressor is required
	Extremely dusty atmosphere	Relocate the compressor

ISSUE	CAUSE	ACTION
Excessive noise/ vibration during operation	Check valve is loose or broken Defective pump	Replace check valve Contact Hyundai Power Customer Service
Excessive start- ing and stopping	Hose, hose connections, or attached accessory leaks	Check for leaks and replace if necessary
	Condensation in air tank, high humid- ity	Drain tank
	Fittings are not tight enough	Tighten any loose fittings
	Defective pressure switch	Replace defective switch
	Rusted or damaged air tank	Replace tank immediately. Do not attempt to repair the tank
Air leaks	Fittings not tight enough	Tighten any loose fittings
	Air leaks at hose or accessory	Check for leaks and replace if necessary
	Rusted or damaged tank	Replace tank immediately. Do not attempt to repair the tank



SPECIFICATIONS

HCP9100

AIR COMPRESSOR	Maximum Pressure	120PSI
	Tank Capacity	9 Gal.
	CFM	18.5 (PAD@1090RPM), 13.7 (FAD@1090RPM)
	Pump	65x48x3 (Bore x Stroke x Cylinders)
	Cut In/Cut Out Pressure	6ba. or 90PSI / 8ba. or 120PSI
	Pump Up Time	0-120PSI: 38.5 Seconds
	Recovery Time	90-120PSI: 8.5 Seconds
	Oil capacity	12 fl.oz. (10W30)
ENGINE	Type	7 HP, Single Cylinder, forced air cooling, 4-stroke, OHV 25 deg tilt
	Displacement (cm ³)	208cc
	Ignition mode	Non-contact transistor
	Starting mode	Recoil Start
	Fuel tank capacity (Gal)	1
	Oil capacity	20 fl.oz. (10W30)
	Fuel Type	Unleaded gasoline, propane
	Running Volume	67dB (at 7m)
	Running Time Per Tank (hours)	7
BOX	L x W x H	41x23x27"
	Dry Weight	247lbs

Warranty

Midland International Inc.
26 Huddersfield Rd. Unit #2
Etobicoke, Ontario Canada
M9W 5Z6

This warranty is limited to the listed Hyundai Power Equipment products when distributed by Cobalt Power Inc.

These products are warranted to be free of defects in materials and workmanship from the original date of purchase according to the schedules defined in this warranty document. This limited warranty guarantees that any defective parts will be repaired or replaced, at the warrantor's discretion, at no cost, including diagnosis and replacement parts.

3 YEAR LIMITED WARRANTY:

The limited warranty coverage is continual from the initial date of purchase and does not restart at any time under any circumstances. This limited warranty is valid only when the equipment receives all necessary preventative maintenance, as described in the Hyundai User Manual. The repair or replacement will take place within a reasonable period of time during normal business hours.

LABOR WARRANTY CLAIM PROCEDURE:

The product must be purchased in the United States or Canada from Cobalt Power Inc., via an authorized channel of distribution. This limited warranty applies to the first purchaser and each subsequent registered owner during the applicable warranty time period.

What MIDLAND INTERNATIONAL INC. will Repair or Replace Under Limited Warranty:

MIDLAND INTERNATIONAL INC. will repair or replace, at its opinion, any part that is proven to be defective in material or workmanship under the normal use during the applicable warranty time period. Warranty repairs and replacements will be made without charge for parts, accessories, or labor during the first 12 months after original purchase. The remaining 24 months of warranty are parts only. Anything replaced under warranty becomes the property of MIDLAND INTERNATIONAL INC. All parts replaced under warranty will be considered as part of the original product, and any warranty on those parts will expire coincident with the original product warranty.

Warranty service must be performed by a Hyundai-authorized service dealer. If you feel your equipment is malfunctioning due to a defect, simply contact our customer support center for technical advice, to file a warranty claim or for general information.



BEFORE WARRANTY WORK CAN BEGIN

To obtain warranty service, contact our customer support center:

Toll Free: 1-877-528-3772

Email: support@hyundaipower.ca

Online: www.powerbyhyundai.com or www.hyundaipower.ca

LIMITATIONS OF REMEDIES AND DISCLAIMERS

THE FOREGOING LIMITED WARRANTY IS EXCLUSIVE OF AND IN LIEU OF ALL OTHER WARRANTIES OF MERCHANTABILITY, FITNESS FOR A PARTICULAR PURPOSE, AND OF ANY OTHER WARRANTY, WHETHER EXPRESSED OR IMPLIED.

Midland International Inc. disclaims any responsibility for any indirect, incidental or consequential loss or damage caused by any defects in material or workmanship.

All expenses incurred in maintaining parts shall be incurred by the purchaser. This warranty coverage does not include parts affected by accident and/or collision, corrosion or rust, normal wear, use in an application for which the product was not intended, service from an unauthorized service dealer, or any other misuse, neglect, incorporation or use of unsuitable attachments and/or parts. Under this warranty, the warrantor is not obligated to bear any transportation fees of any product to/from an authorized service dealer. Unauthorized alteration, installation, or any cause other than defects in material or workmanship of the product will not be covered under this warranty.

Some states do not allow limitations on how long an implied warranty lasts and/or do not allow the exclusion or limitation of incidental or consequential damages, so the above exclusions and limitations may not apply to you. This warranty gives you specific legal rights, and you may also have other rights which vary from state to state.

NOT COVERED BY THIS LIMITED WARRANTY:

1. Normal wear and tear, such as but not limited to fading of painted or plated surfaces, sheet peeling and other natural deterioration.
2. Damage caused by a lack of maintenance as described in the Hyundai User Manual.
3. Consumable parts: Hyundai does not warrant deterioration of the following unless needed as a part for another warranted repair: Spark plugs, fuel filters, air cleaner elements, clutch discs, tires, wheel bearings, starter ropes, cables, belts, oil and grease.
4. Damage caused by accidental or improper installation or storage.
5. Exposure of the product to chemical agents, bird droppings, sea water, sea breeze or salt.
6. Improper repair or maintenance.
7. Damage caused by water ingestion, submersion, or external water damage except for HCP653 (Trash Pump) and HCP3000 (Pressure Washer).
8. Damage or non-performance caused by operation of the generators set in a marine application.
9. Operating methods other than those indicated in the owners manual.
10. Damage caused by operation with improper pressure, conditions, or modifications contrary to published specifications.

11. Items not supplied by Hyundai, such as, but not limited to, external wiring, filters, etc.
12. The use of non-genuine Hyundai parts and accessories.
13. Repairs made during the warranty period without first obtaining a case number form Hyundai.

PRODUCT REGISTRATIONS

Product registration is required for all product support and warranty coverage. The purchaser must also provide the original proof of purchase. The owner’s registration, found with the user manual, must be completed and mailed. You can also register online at www.powerbyhyundai.com or www.hyundaipower.ca. You should keep your receipt or invoice as proof of purchase.

Product covered by warranty	Length of warranty from date of original purchase	
	LABOR	PARTS
Pro Power Series Generators: Model No: HCP6500D, Diesel Power Generator	12 Months	36 Months
Model No: HCP9000, Dual-Fuel Generator	12 Months	36 Months
Model No: HCP9100, Gas-Powered Air Compressor	12 Months	36 Months
Model No: HCP3000, Gas-Powered Pressure Washer	12 Months	36 Months
Model No: HCP653, Gas-Powered Water Trash	12 Months	36 Months

ACCESSORIES AND REPLACEMENT PARTS

3 YEAR LIMITED PARTS AND ACCESSORIES WARRANTY

This limited warranty defines the accessories and replacement parts warranty and is limited to Hyundai Power Equipment products when distributed by Cobalt Power Inc.

The accessories and replacement parts must be purchased from COBALT POWER INC. in the United States or Canada. Parts and Accessories must be purchased for installation on original Hyundai equipment or engines to be eligible for warranty coverage. Installing parts and accessories on non-Hyundai products or engines voids the warranty.

Midland International Inc. will repair or replace, at its option, any Hyundai Power Equipment accessories or replacement parts that are proven to be defective in material or workmanship under normal use during the applicable warranty time period. Anything replaced under warranty becomes the property of Midland International Inc. All parts replaced under warranty will be considered as part of the original product, and any warranty on those parts will expire coincident with the original product warranty.

PARTS AND ACCESSORIES WARRANTY CLAIM PROCEDURE

Original accessories and replacement parts that are proven to be defective in material or workmanship under the normal use will be repaired or replaced under warranty without charge if determined to be defective within the first thirty-six months form the original date of purchase. After one year from the original date of purchase, labor costs will be the responsibility of the purchaser. If installed by anyone else, acces-



series and replacement parts will be repaired or replaced under warranty without charge for parts, but any labor charges will be the responsibility of the purchaser.

EXCLUSIONS

The same exclusions listed above for labor apply to this warranty. This warranty does not extend to accessories, or parts, affected or damaged by collision, normal wear, use in an application for which the product was not designed or any other misuse, neglect, incorporation or use of unsuitable attachments or parts, unauthorized alteration, improper installation, or any causes other than defects in material or workmanship of the product. Installing non-Hyundai Parts and Accessories voids this warranty.

DISCLAIMER OF CONSEQUENTIAL DAMAGE AND LIMITATION OF IMPLIED WARRANTIES:

MIDLAND INTERNATIONAL INC. disclaims any responsibility for loss of time or use of the product, or the power equipment on which the product is installed, transportation, commercial loss, or any other incidental or consequential damage. Any implied warranties are limited to the duration of this written warranty. Some states do not allow limitations on how long an implied warranty lasts and/or do not allow the exclusion or limitation of incidental or consequential damages, so the above exclusions and limitations may not apply to you. This warranty gives you specific legal rights, and you may also have other rights, which vary from state to state.

TO OBTAIN WARRANTY SERVICE FOR PARTS OR ACCESSORIES:

You must, at your expense, take the Hyundai Power Equipment accessory, or replacement part, or the Hyundai Power Equipment product on which the accessory or replacement part is installed, and proof of purchase to any authorized Hyundai Power Equipment dealer, distributor or distributor's dealer in the United States or Canada during the dealer's or distributor's normal business hours. If you are unable to obtain warranty service or are dissatisfied with the warranty service you receive, take the following steps:

First, contact the owner of the service location involved; normally this will resolve the problem. Second, if the issue is not resolved, contact:

Hyundai Power Equipment Customer Support Center

Toll Free: 1-877-528-3772

E-mail: support@hyundaipower.ca

Online: www.powerbyhyundai.com or www.hyundaipower.ca

