



THE INSTANT 12V AUTOMATIC IMPACT WRENCH

# Operation Manual



## FEATURES

**1** No Assembly. Versatile and portable.

**2** 12V Plugs into Cigarette lighter

**3** Power Indicator Light

**4** Adjustable Brite Light illuminates the work area.

**5** Tighten/Loosen toggle control

**6** High-density, impact-resistant casing

**7** Ergonomic, comfort grip

**8** Interchangeable Sockets to fit majority of cars.

## Safety Precautions / Troubleshooting



### DANGER- Risk of Injury



**Read the following safety instructions very carefully.**

Reading and understanding these cautions will allow you to reduce the risk of causing damage to your InstaWRENCH, your surroundings, and yourself.

### WARNINGS and SAFETY PRECAUTIONS

Read and follow ALL the instructions.

- All instructions in this manual should be read and thoroughly understood. If the user's native language is anything other than English, then the user should have the manual read to him/her and discussed, in the user's native language.
- Failure to follow these instructions and safety warnings on the product can result in property damage, personal injury, or death.
- Wear protective goggles and gloves while using InstaWRENCH™.
- NEVER get beneath a vehicle that is supported by any car jack.
- Visually inspect the InstaWRENCH before each use. Do not use if you see anything abnormal such as cracks, damage, missing parts, or excessive wear. Do NOT use power cord if it is frayed, damaged, or has kinks in it. If you see abnormalities, call the Customer Service Number Listed in this manual.
- Do NOT alter or repair InstaWRENCH in any way. Do NOT modify the wiring in any way. Instead, call the Customer Service Number Listed on the front of this manual. Any alterations to the InstaWRENCH or any of its components is dangerous and will void the warranty.
- Use only adapters and attachments supplied by the manufacturer. Use of other adapters or attachments will void the warranty.
- Be careful not to leave the power cord in a location where someone could trip on it.
- Use only your Vehicle's 12V cigarette-lighter socket as a power source.
- Follow the tire changing instructions that are described in the vehicle-owner's manual.

### Troubleshooting

If you have problems with the InstaWRENCH™, read these helpful hints and if you still have problems, call the Customer Service number listed in this manual.

#### Wrench will not work.

- Check that your car's cigarette lighter is getting power. Use the cigarette lighter and make sure it heats up. If it does not check your car's fuses and change the cigarette lighter fuse if necessary.
- Make sure that the Wrench is plugged in to the cigarette lighter socket correctly. The green indicator light on the InstaWRENCH plug indicates that you have a good connection. If light does not illuminate. Reset the plug in the socket until the green indicator light comes on.
- Check that power is reaching the wrench by switching on the light. If the light does not switch on then you are not getting power. Reset the plug in the 12V DC power socket. Also check the car's cigarette lighter fuse this may need changing.
- If the wrench still will not work, you may have a flat car battery. Turn on the car ignition and try the InstaWRENCH again. If the wrench will not work while the car is running, then call Customer Service.
- Make sure your car's power system has no problems by testing the InstaWRENCH in another car. If InstaJack works in a separate car then your car's power is faulty.

#### Checking and changing InstaWRENCH fuse.

- To check the InstaWRENCH fuse, remove the tip of the Cigarette Lighter Power Plug.
- Remove fuse.
- If the internal wire is broken or burnt, replace it with 15 amp fuse which can be obtained from any autoparts store or supermarket car section.



#### Visually inspect the InstaWRENCH.

Do not use if you see anything abnormal such as cracks, damage, missing parts, or excessive wear. Do NOT use power cord if it is frayed, damaged, or has kinks in it. If you see abnormalities, call the Customer Service Number Listed in this manual.

Do NOT alter or repair InstaWRENCH in any way. Do NOT modify the wiring in any way. Instead, call the Customer Service Number Listed on the front of this manual. Any alterations to the InstaWRENCH or any of its components is dangerous and will void the warranty.



# Instructions for Use

**Never use the vehicle's 12V power socket to operate two motorized tools at the same time. It will overload the fuses!**



Before changing a wheel using the InstaWRENCH, read and follow the tire-changing instructions that are described in your Vehicle-Owner's Manual.

## Preparing your vehicle for InstaWRENCH™

If your car has not had the tires changed for a long time, it is possible that the lug nuts may have rusted to the wheel bolts. The first time you try to remove a lug nut, it is possible that the nut will be so stiff that the InstaWRENCH™ cannot break the lug nut open. In this case, for the first time only, you may need to manually undo the lug nuts. After this first time, put a small amount of grease on the threads inside of all the lug nuts before replacing them. This will help prevent future rusting or sticking. Use InstaWRENCH™ to tighten the lug nuts, and then use InstaWrench frequently, at least once a year to loosen the nuts and retighten them. Then if you ever have an emergency, you will be certain to have an easy job of changing a tire in the field.

## InstaWRENCH™ instructions

**1** Plug the InstaWRENCH into the 12V cigarette lighter socket of the vehicle. The green light on the wrench socket indicates that you have a good connection. If light does not illuminate. Reset the plug in the socket until the green indicator light comes on.

**2** Select the correct InstaWRENCH™ Socket that fits the lug nuts on your car. Attach this socket firmly to the InstaWRENCH.



Note: When changing a tire, 1) partially loosen the lug nuts while the vehicle has all wheels on the ground, 2) raise the wheel completely off the floor with a car jack, 3) finish removing all the lug nuts.

**3 To Loosen:** Place the socket carefully over a lug nut. Hold the InstaWRENCH firmly with both hands and press the InstaWRENCH "Loosen" control. Keep holding the wrench and keep pressing the "loosen" control until the lug nut begins to loosen. A repetitive, loud cracking noise will be heard as the wrench impacts the lug nut. This is normal. If you have problems cracking a lug nut, refer to the section at the top of this page called "Preparing your vehicle for InstaWRENCH™".

**4** Using the tire-changing instructions as described in your Vehicle-Owner's Manual, use a car jack to raise the car wheel off the floor and replace the wheel with the spare wheel.

- Use the InstaWRENCH™ to completely remove the lug nuts.
- Replace the tire as described in your Vehicle-Owner's Manual.

**5** Replace the lug nuts. Hand-tighten them for a few turns to prevent cross-threading. Tighten them with the InstaWRENCH™ in the order described in your Vehicle-Owner's Manual.

- **To Tighten:** Place the socket carefully over a lug nut. Hold the InstaWRENCH firmly in both hands and press the InstaWRENCH "Tighten" control. Keep holding the wrench and keep pressing the "loosen" control until the lug nut is tight and a repetitive, loud cracking noise is heard as the wrench impacts the lug nut. This is normal. Wait until you hear about 4-5 cracks then the nut is tight enough. Do not over-tighten the nuts or you may strip the threads.

- When all lug nuts are replaced and tightened, use a car jack to lower the vehicle to the floor.



To make sure all lug nuts are tight:- After all the wheels are on the floor, tighten all the lug nuts once again using InstaWRENCH™. Do not over-tighten the nuts or you may strip the threads.

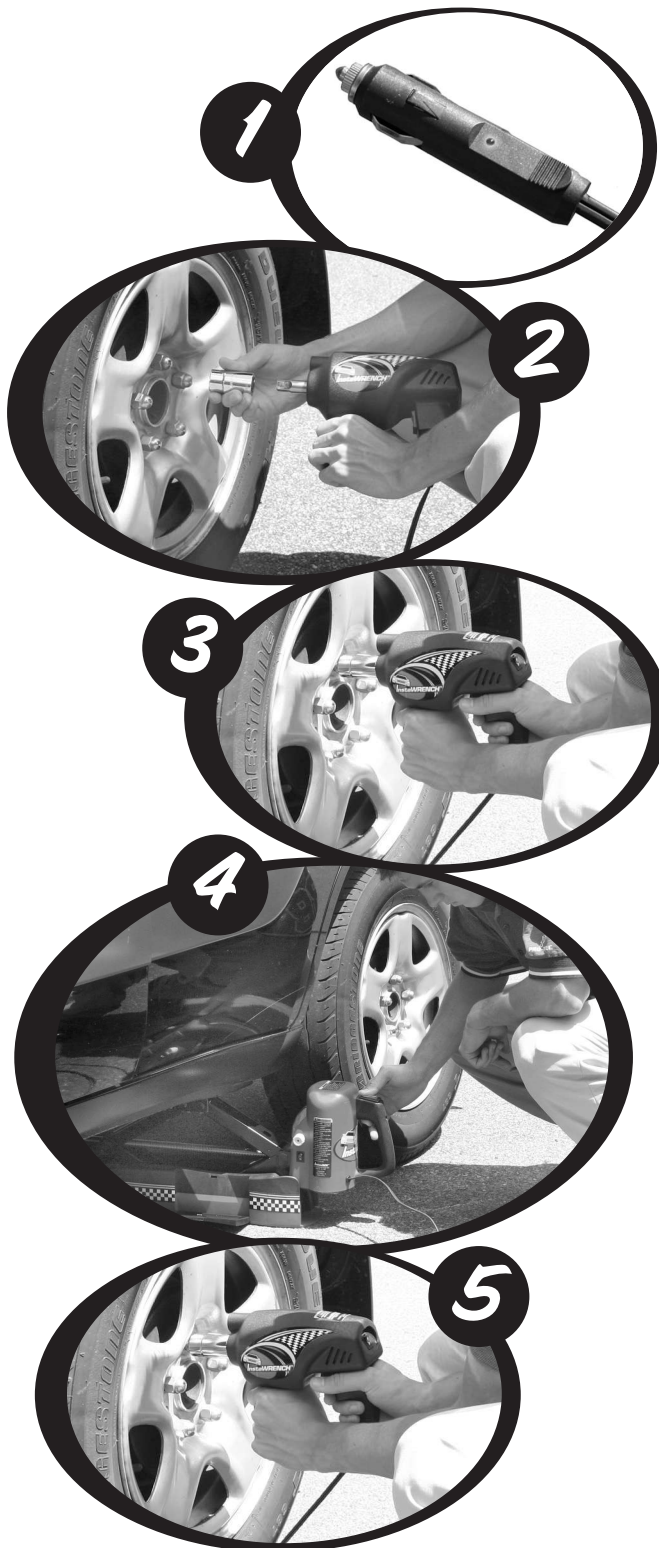

## SPECIFICATIONS

**Wrench Dimensions:**  
9.06" x 6.5" x 3.9"  
23 x 16.5 x 9.9 cm

**Weight:**  
1.39 Kg. (3 lb)

**Power:**  
12V DC from vehicle  
cigarette lighter socket.

**Current:**  
15 Amp max  
15 Amp fuse installed

**Power Cable:**  
14.76 ft = ( 4.5 M)  
Reaches all car wheels.

**Max. Torque:**  
250 ft.-lbs / 350 M-Kg

**Socket sizes:**  
11/16" and 3/4"  
(17mm and 19mm)  
13/16" and 7/8"  
(21mm and 23mm)

**Customer Service: 1-866-916-8188**

If you have any problems, please email or call our Customer Service team, 9am to 5pm EST or e-mail them, [info@csauscorp.com](mailto:info@csauscorp.com)

Return Policy. Do not return product to store. If you have any problems, call this customer service number for instructions.

(USA) CSA (US) CORP  
16801 E Gale Ave. Unit E,  
City of Industry, CA 91745

(Canada) CSA (US) CORP  
202-30 Royal Crest Court,  
Markham, ON L3R 9W8

