

IN-DASH MP3 / CD PLAYER



 **Bluetooth®**

PA5600BT

INSTRUCTION MANUAL

TROUBLESHOOTING

Installation..... 02
 Additional information..... 04
 General operations..... 05
 Clock adjustment..... 08
 Radio operations..... 10
 CD operations..... 11
 MP3 operations..... 11
 Bluetooth..... 13
 Remote operations..... 14
 Specification..... 16
 Before playing discs..... 17
 Troubleshooting..... 18

Before going through the check list, please be sure to check all wiring connections. If any of the problems exist after completing the troubleshooting below, please be sure to consult your nearest service dealer.

Symptom	Causes	Solution
No Power	The vehicles ignition key has not be switched on.	If the power supply is properly connected to the car accessory terminal, switch the ignition key to ACC
	The fuse is blown	Locate fuse and replace with one of equal value.
CD Cannot Be Loaded or Ejected	A CD is already inside the player slot	Remove the CD from the player and insert the new one
	Inserting the CD in reverse direction	Insert the CD with the label facing up
	The CD is extremely dirty or defective.	Clean the CD or try to play a new one
	Temperature inside the car is too high	Cool off until the ambient temperature return to normal
	Condensation	Leave the player off for an hour or so and try again
No Sound	Volume is at minimum	Adjust volume to desired level
	Wiring is not properly connected	Check wiring connection
Sound Skipping	The installation angle is more than 30°	Adjust the installation angle to less than 30°
	CD is extremely dirty or scratched	Clean the CD or try to play a new one
The Operation Keys Do Not Work	The built-in microcomputer is not operating properly due to Interference	Press the RESET button or reinstall the front panel properly
The Radio or Automatic Selection Does Not Work	The antenna cable is not connected correctly	Connect the antenna cable correctly
	The signals are too weak	Select the station manually

BEFORE PLAYING DISCS

Cleaning the CD

Before playing a CD, wipe it off with a clean, dust-free cleaning cloth. Wipe the disc in the direction of the arrow.

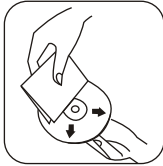

Always insert the CD with the label side facing upwards. If the CD is inserted with the printed side facing downwards, the device may be damaged.



Note: If there is already a CD in the CD slot, do not try to insert a second CD. This may damage the device. Always hold CDs by the edge. In order to keep the CD clean do not touch the surface. Pull out the CD as follows.

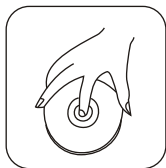

Do not attach any sticker or adhesive tape on the CD.
Do not expose the CD to direct sunlight or sources of heating.
Do not leave CDs in a car if it parked in direct sunlight

INSTALLATION

PRECAUTIONS

Choose the mounting location where the unit will not interfere with the normal driving function of the driver.

Before finally installing the unit, connect the wiring temporarily and make sure it is all connected correctly and the unit and the system work properly.

Use only the parts included with the unit to ensure proper installation. The use of unauthorized parts can cause malfunctions.

Consult with your nearest dealer if installation requires the drilling of holes or other modifications of the vehicle.

Install the unit where it does not get in the driver's way and cannot injure the passenger if there is a sudden stop.

If installation angle exceeds 30 from horizontal, the unit might not give its optimum performance.

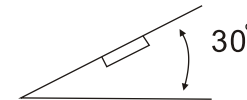

Avoid installing the unit where it would be subject to high temperature, such as from direct sunlight, or from hot air, from the heater, or where it would be subject to dust, dirt or excessive vibration. Do not expose this equipments to rain or moisture.

DIN FRONT-MOUNT (Method A)

Installing the unit

1. Dashboard

2. Sleeve
After inserting the sleeve into the dashboard, select the appropriate tab according to the thickness of the dashboard material and bend them inwards to secure the holder in place.

3. Screw

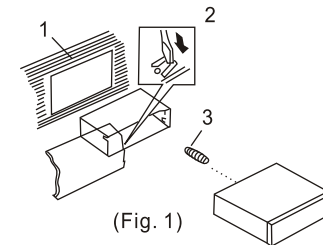

INSTALLATION

SPECIFICATION

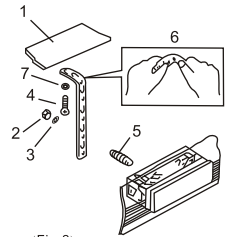

(Fig. 2)

1. Dashboard
2. Nut (5mm)
3. Spring Washer
4. Screw (5 x 25mm)
5. Strap
6. Strap
7. Plain Washer

Be sure to use the strap to secure the back of the unit in place. The strap can be bent by hand to the desired angle.

7. Plain Washer

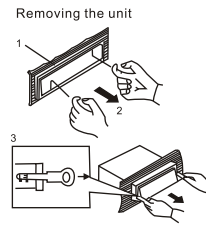

(Fig. 3)

1. Frame
2. Insert fingers into the groove in the front of frame and pull out to remove the frame. (When reattaching the frame, point the side with a groove downwards and attach it.)
3. Lever
Insert the levers supplied with the unit into the grooves at both sides of the unit and shown in figure until they click. Pulling the levers makes possible to remove the unit from the dashboard.

DIN REAR-MOUNT (Method B)

Fastening the unit to the factory radio mounting bracket:

1. Select a position where the screw holes of the bracket and the screw holes of the main unit become aligned (are fitted), and tighten the screws at 2 places on each side. Use either truss screws (5 x 5mm) or flush surface screws (4 x 5mm)
2. Screw
3. Dashboard or Console

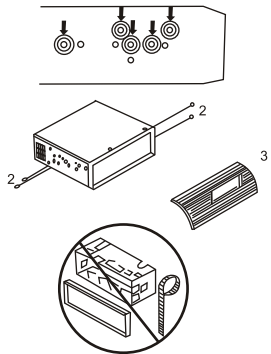

General

Power Supply Requirements:	DC 14.4V "—", Negative Ground
Load Impedance:	4 ohms
Maximum Output Power:	35W x 4 (CH)
Chassis Dimensions:	178 x 163 x 50mm (W x D x H)
Current Drain:	15A

Tone Controls

Bass (at 100Hz):	+10dB / -10dB
Treble (at 10K):	+10dB / -10dB

CD Player

Signal to Noise Ratio:	More than 60dB
Channel Separation:	More than 60dB
Frequency Response:	20Hz - 20KHz

FM Radio

Frequency Coverage (MHz):	87.5 - 107.9MHz
IF :	10.7MHz
Sensitivity (S/N-30dB):	12dBu
Stereo Separation:	>30dB

AM Radio

Frequency Coverage (KHz):	530 - 1710KHz
IF :	450KHz
Sensitivity (S/N-20dB):	<42dBu

Specifications subject to change without notice

REMOTE CONTROL LAYOUT

Replacing the Battery

When the functionality of the remote control becomes intermittent, replace the battery with a new CR2025. Be sure to identify the correct polarity when placing in the battery holder.

1. Pull out Battery Holder while pressing the stopper

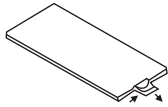

2. Put the button type battery (+) mark upward into the Battery Holder.

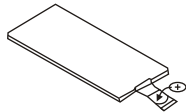

3. Insert the Battery Holder into the Remote control

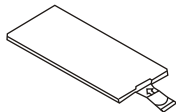

ADDITIONAL INFORMATION

WIRE CONNECTION DIAGRAM

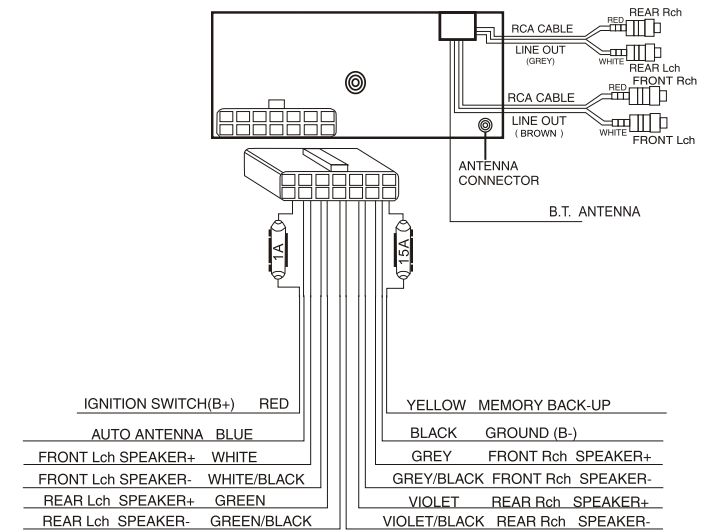

HOW TO INSTALL AND REMOVE THE FRONT PANEL

INSTALLING THE FRONT PANEL

To install the front panel, carefully insert the right side into the notches of the main unit. Then, firmly press down on the left side until the latch engages. Removal of the faceplate is done by pressing the 'release' button and pulling it towards you.

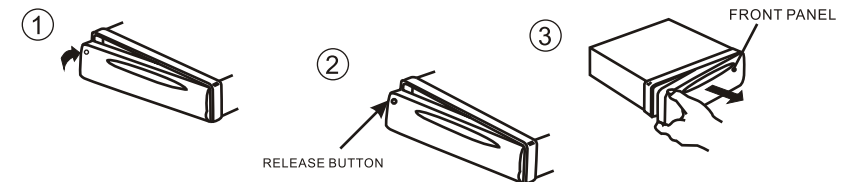

INSERTING THE SD CARD

The SD card is inserted with the notched corner to the right side when facing upwards. Press firmly and release to engage the locking mechanism.

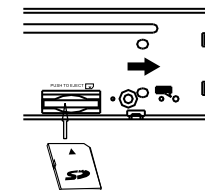

GENERAL OPERATIONS

FRONT PANEL LAYOUT

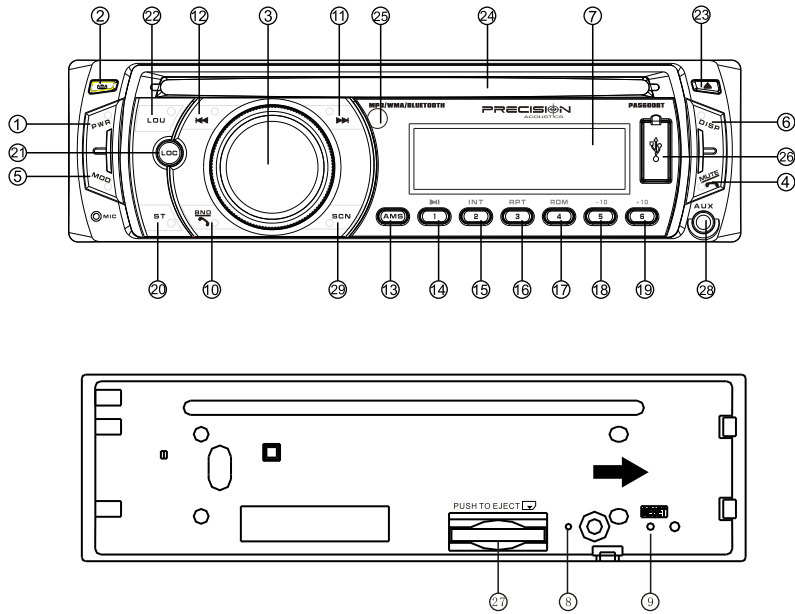

- | | |
|------------------------------------|------------------------------|
| 1. Power Button | 15. Intro & Preset Button 2 |
| 2. Release Button | 16. Repeat & Preset Button 3 |
| 3. Volume/ Sel Button | 17. Random & Preset Button 4 |
| 4. Mute/ Button | 18. Preset Button 5 |
| 5. Mode switch | 19. Preset Button 6 |
| 6. Display Button | 20. ST/MO Button |
| 7. LCD Display | 21. LOC/DX Button |
| 8. Flashing LED | 22. Loudness Button |
| 9. Reset Button | 23. Eject knob |
| 10. Band/ switch | 24. CD Slot |
| 11. Tune Seek&Track forward Button | 25. Remote Control Sensor |
| 12. Tune Seek&Track reverse Button | 26. USB connector |
| 13. Automatically memory storing | 27. SD/MMC Slot |
| 14. Play / Pause & Preset Button 1 | 28. AUX IN JACK |
| | 29. SCN Button |

REMOTE CONTROL LAYOUT

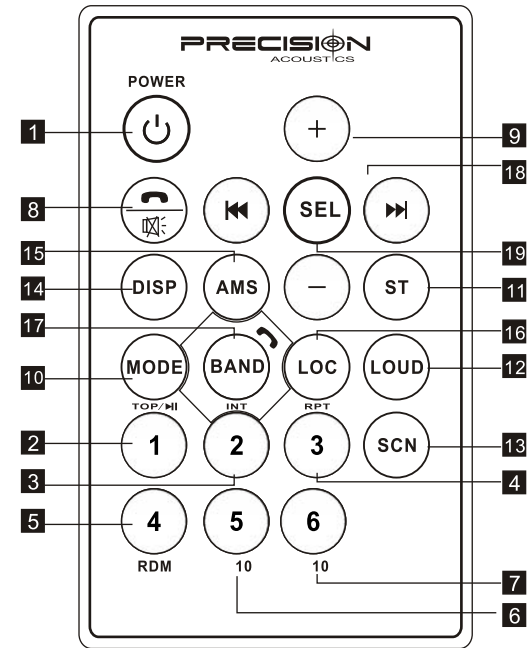

- | | |
|-----------------------------------|--|
| 1. Power Button | 10. Mode Switch |
| 2. Pause/play/ Preset Button1 | 11. ST/MO Button |
| 3. Intro/Preset Button2 | 12. Loudness Button |
| 4. Repeat Playing/ Preset Button3 | 13. Scan Button |
| 5. Random/ Preset Button4 | 14. Display Button |
| 6. Preset Button5 | 15. APS/AMS Button |
| 7. Preset Button6 | 16. LOC/DX Button |
| 8. Mute/ Button | 17. Band/ Switch |
| 9. Volume Control | 18. Tuning/Selecting Tracks/ F.F / F.R |
| | 19. Select Button |

BLUETOOTH

1. Pairing your phone

Turn the radio on, and activate your phone's Bluetooth function. Some phones will automatically search for devices, while others have to be prompted to do so. Please consult with your phone's manual on 'pairing'. Upon locating the "car radio", you will be asked to enter the password "8888". Once paired, some phones require that you manually connect to the other device. Doing so will stop the Bluetooth icon (ⓑ) from blinking on the radio display.

Note: Only phones with Bluetooth protocols HSP, HFP, A2DP and AVRCP are supported.

2. Handsfree calling

Once paired with your phone, you can make handsfree calls through this car radio. Incoming calls will be heard through the car speakers, and the phone number will be shown on the radio display.

- Press the BAND button once to accept the call. Speak freely through the built-in microphone on the faceplate.
- Press MUTE once to reject an incoming call.
- Press MUTE once to end a call.

3. Advance Audio Distribution Profile (A2DP)

Phones outfitted with A2DP Bluetooth profile will allow music to stream wirelessly to this car radio. Once the song has been chosen on your phone, press the "◀" and "▶" buttons to track up and down.

4. Phone call memory

The Bluetooth system in this radio will automatically store up to 10 incoming phone numbers.

- Press the MUTE button for a few seconds to enter the phone book database, and continue to press to cycle between Received, Missed and Rejected.
- Use the Volume knob to look up the phone number.
- Press BAND once to activate the call out function once the number is found.

5. Manual Bluetooth connection

Use the BAND button to manually connect and disconnect your Bluetooth pairing. You can do this when on a call if you require a private conversation on the phone. Press and hold the Band button and wait for CONNECT to display.

6. Accessing Bluetooth settings - Auto Answer, Talk Volume

Press and hold the MUTE button for 3 seconds, and the momentary press will cycle between the various settings to adjust Auto Answer and Talk Volume. Use the Volume knob to choose between the available settings.

Note: Each mobile phone will respond to these functions differently. It is important to consult with the manufacturer's manual to understand the operations of the Bluetooth function. We do not guarantee that all functions offered by this radio will be compatible with your phone.

GENERAL OPERATIONS

GENERAL OPERATIONS

ON/OFF

Press POWER button (1) to turn on the unit. Press it again to turn off.

FRONT PANEL RELEASE

Press REL button (2) to detach the removable front panel

SOUND ADJUSTMENT

Press and hold Volume knob (3) for 3 seconds to enter audio settings.

A). Press SEL button (3) will change in the following order.

Option:

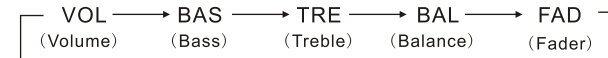

VOLUME

Adjust volume level by using VOL/SEL (3) knob.

Note: The unit is initially set to volume mode.

BASS

Press VOL/SEL button(3) one time. Adjust bass level by using VOL/SEL(3)Knob.

TREBLE

Press VOL/SEL button(3) two times. Adjust treble level by using VOL/SEL(3) Knob

BALANCE

Press VOL/SEL button(3) three times. Adjust sound balance between left and right speakers by using VOL/SEL(3)Knob .

FADER

Press SEL button(3) four times. Adjust sound balance between front and rear speakers by using VOL/SEL(3)Knob.

MUTE

Press MUTE button (4) to mute down the sound. Press it again to release this mode and recover previous volume level.

SETTINGS MENU

Press and hold the Volume button (3) for several seconds to enter the Settings menu, and continue to press to cycle between the various settings below.

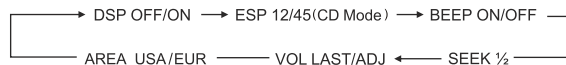

DSP - Digital Sound Processor

When in DSP mode, use the Volume button to cycle between Flat, Classic, Pop and Rock.

ESP - Electronic Shock Protection

When in ESP mode, use the Volume button to cycle between 12 or 45 seconds of electronic shock protection.

BEEP - On/Off

When in BEEP mode, use the Volume button to cycle between ON or OFF for key tone during use.

VOL LAST - Volume Adjustment

When in VOL mode, use the Volume button to cycle between the VOL LAST and VOL ADJ.

VOL LAST - radio powers on at the last known volume level

VOLADJ - radio powers on at a user selected volume level. Press the volume button to select your desired volume level.

SEEK - Auto and Manual

When in SEEK mode, use the Volume button to cycle between seek 1 and 2.

Seek 1 - scans to the next station automatically.

Seek 2 - scans to the next station manually.

AREA - USA and Europe

When in AREA mode, use the Volume button to cycle between USA and European tuning modes.

File search mode:

1. Press AMS (13) button twice, the " FILE SCH " will show on the display.
2. Press VOL/SEL button (3) once to enter the " FILE SCH " mode.
3. When in the " FILE SCH " mode,
 - By turning the VOL/SEL button (3) to show files on the display
 - By pressing the VOL/SEL button (3) to select file
4. When get into the FILE,
 - By turning the VOL/SEL button(3) to show songs on the display
 - By pressing the VOL/SEL button(3) to select your favorite song.

Character search mode:

1. Press AMS (13) button 3 times, the " CHAR SCH " will show on the display.
2. Press VOL/SEL button (3) once to enter to the " CHAR SCH " mode.
3. When get in to the " CHAR SCH " mode,
 - By turing the VOL/SEL button(3) to show characters and numbers.
 - By pressing the VOL/SEL button(3) to select characters and numbers.
4. When characters or numbers are selected,press and hold the song will show on the display,press again to play the song.

** Character supported **

- English Capital Letters: A-Z
- Numbers: 0-9

CD/ MP3 OPERATIONS

TRACK SELECTION

While playing back from CD/SD/USB, use the track up (12) or track down (13) buttons to move between previous and next songs. The track number is indicated on the display.

Press and hold these buttons to rewind or fast forward through the track. The song begins to play again once the button is released.

TRACK SEARCH MODE

1. Press AMS(13) button once, the " TRK SCH " will show on the display.
2. Press VOL/SEL button (3) once to enter the " TRK SCH " mode. Then the LCD displays first track number "001". rotate VOL/SEL button(3) to select 1st digit.
3. Then press VOL/SEL button (3) once to enter select 2nd digit number rotate VOL/SEL button (3) once again to select third digit number when the 2nd digit number was selected.
4. Finally press VOL/SEL button (3) more than 1 second the track number which you have selected will play immediately.
5. VOL/SEL knob (3) perform to shift 1st digit from 1-9 loop rotation. Then the 2nd and 3th digit is shifted from 1-9 as loop rotation.

EJECT

Press the eject button (23) to stop CD playback and eject the disc.

GENERAL OPERATIONS

SOURCE MODE

Press the MODE button (5) to cycle between the available sources:

Tuner - FM/AM

CD - a disc must be inserted to enter this mode.

Memory Card (SD) - flash card must be inserted to enter this mode.

USB - flash memory must be inserted to enter this mode.

AUX - auxiliary audio devices

Bluetooth - phone must be paired to enter this mode.

CLOCK AND SETTING TIME

Press the DISP button (6) to cycle between the main screen and clock. By pressing once, the time will be displayed for 5 seconds and switch back to the main screen.

Set the clock by pressing DISP for more than 1 second. The time will start flashing, indicating that it can be changed. Use the volume knob to adjust hour and minute, by turning to the left and right.

FLASHING LED

The radio has been outfitted with a flashing security light when the faceplate is removed from the unit.

RESET

A reset button has been located on the main unit, and is visible without the faceplate in place. Use a ball-point pen or small metal object to depress the switch momentarily.

The reset button should be pressed under the following instances:

- after initial installation and all wiring is completed
- the faceplate controls do not respond when buttons are pressed
- error message is displayed

Note: If the reset button does not correct your issue, please consult your local dealer for assistance.

RADIO OPERATIONS

MO/ST SELECTOR

Press MONO (20) button to select between Mono and Stereo FM tuner modes.

LOC/DX SELECTOR

Press LOC (21) button to select between Local and DX (distant) tuning modes. The LOCAL setting will seek to local stations with strong signal reception only, while DX will capture all available radio stations.

LOUDNESS ON/OFF

Press LOU (22) button to activate the loudness function. Doing so will boost both low and high frequencies in your music playback.

SCAN

Press SCN (22) button to automatically scan the available radio station in your area with a clean signal. At each station, the tuner will stop and playback for 5 seconds. Press the scan button again once you find a desired station.

BAND SELECTION

Press the BAND button (10) to select between FM and AM frequencies. This radio has been outfitted with three FM preset banks, and two AM preset banks.

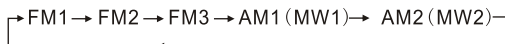

STATION SELECTION

Press TUNE/SEEK/TRACK FORWARD button (11) or TUNE/SEEK/TRACK REVERSE button (12) shortly for manual tuning function.

Press for several seconds the automatic tuning mode (SEEK mode) is selected.

RADIO/CD OPERATIONS

AUTOMATIC STATION STORING & PRESET SCANNING

Automatic Memory Storing

-Press and hold the AMS button (13) until the radio begins to search through the band of all available stations. Once the cycle is complete, the tuner will automatically store the 6 strongest stations into available presets.

Preset Scanning

-Press the AMS button (13) until the radio begins to search through the preset memory. Once the desired station is found, press again to stop the scan mode.

MANUAL STATION STORING

Presets 1 thru 6

-Tune to the desired frequency, and press and hold the desired preset button to program this station. A beep sound will confirm the setting.

-Each FM and AM bank can store unique radio stations in memory.

CD/MP3/SD/USB

Play/Pause

Press button (14) to initiate the PLAY and PAUSE functions during playback mode.

INT - Intro

Press the INT button (15) to initiate the INTRO function during playback mode. The first 10 seconds of each track is played until it reaches the last track.

RPT - Repeat

Press preset button (16): CDP mode : REPEAT ON / OFF is activated.

When REPEAT ON, RPT INDICATOR comes on and repeats the existing track.

During a REPEAT, DISC- RPT INDICATOR comes on and repeats the current CD.

RDM - Random

Press preset button (17): During RANDOM ON, RDM INDICATOR is turned on.

-10 / +10 - Multiple Track UP/DOWN

When playing music from your flash memory, and there are a high number of tracks, use buttons (18, 19) to jump 10 tracks UP or DOWN