

12. Maintenance and Cleaning

The following points have to be considered during the inspection:

- 1) All screws for installing the devices or parts of the device have to be tightly connected and must not be corroded.
- 2) There must not be any deformations on the housing, color lenses, fixations and installation spots (ceiling, suspension, trussing).
- 3) Mechanically moved parts must not show any traces of wearing and must not rotate with unbalances.
- 4) The electric power supply cables must not show any damage, material fatigue or sediments.

Further instructions depending on the installation spot and usage have to be adhered by a skilled installer and any safety problems have to be removed.



CAUTION!

Disconnect from mains before starting maintenance operation.

In order to make the lights in good condition and extend the life time, we suggest a regular cleaning to the lights.

- 1) Clean the inside and outside lens each week to avoid the weakness of the lights due to accumulation of dust.
- 2) Clean the fan each week.
- 3) A detailed electric check by approved electrical engineer each three month, make sure that the circuit contacts are in good condition, prevent the poor contact of circuit from overheating.

We recommend a frequent cleaning of the device. Please use a moist, lint- free cloth. Never use alcohol or solvents.

There are no serviceable parts inside the device. Please refer to the instructions under "Installation instructions".

Should you need any spare parts, please order genuine parts from your local dealer.



LED Zoom Par

SI-051

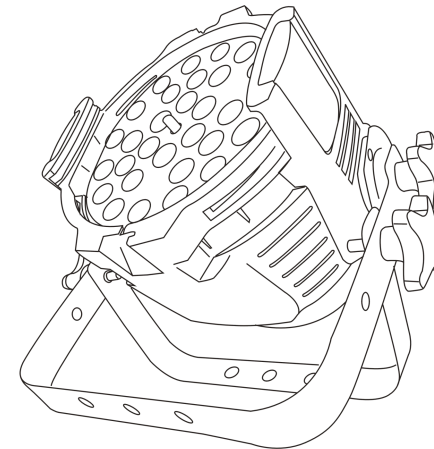

User Manual

KEEP THIS MANUAL FOR FUTURE NEEDS

1. Unpacking

Thank you for Color Imagination's LED Zoom Par. For your own safety, please read this manual before installing the device. This manual covers the important information on installation and applications. Please install and operate the fixture with following instructions. Meanwhile, please keep this manual well for future needs.

Color Imagination's LED Zoom Par features motorized zoom function with beam angle adjustable from 10° to 60°. The fixture is designed and manufactured strictly following CE standards, complying with international standard DMX512 protocol. It's available independently controlled and linkable with each other for operation. And it is applicable for large-scale live performances, theater, studio, nightclubs and discos.

SI-030 adopts 30PCS tricolor 3W LEDs which features high brightness, stability and outstanding color mixing. Please carefully dispack it when you receive the fixture and check whether it is damaged during the transportation. And please check whether the following items are included inside the box:

LED Zoom Par-----one	Signal Cable-----one
User Manual-----one	

10. Key Features

- 60000 to 100000 hours lifespan and low power consumption
- Die cast aluminum
- PWM technology for driving electronics
- Multi-Colors
- Color Strobe
- Electronic Dimming 0-100%
- Electronic zooming for 10° to 60°
- Automatic operation with built-in programs
- DMX512 controllable
- Master/Slave operation
- Sound activation
- 2 x 16 LCD operation menu with function buttons
- Daisy chain units together in DMX Mode
- 3-pin (default) or 5-pin XLR connectors available
- Entire casing as heat sink plus noiseless fan
- 40° max environment temperature
- 60° max par light temperature
- TO.8A fuse

11. Technical Specifications

- Input Voltage: AC 90~260V, 50/60Hz
- LED Quantities: 30PCS High Power Tri Color Edison LEDs (3W)
- Control Signal: DMX512, master-slave and sound activated or auto operation
- Control Channel: 9 DMX Channels
- Power Consumption: 110W
- Dimensions: 324x220x262.4mm
- Packing Dimensions: 305x 305x 280mm
- Net Weight: 5.5kg
- Gross Weight: 6kg

9. Overall Dimension

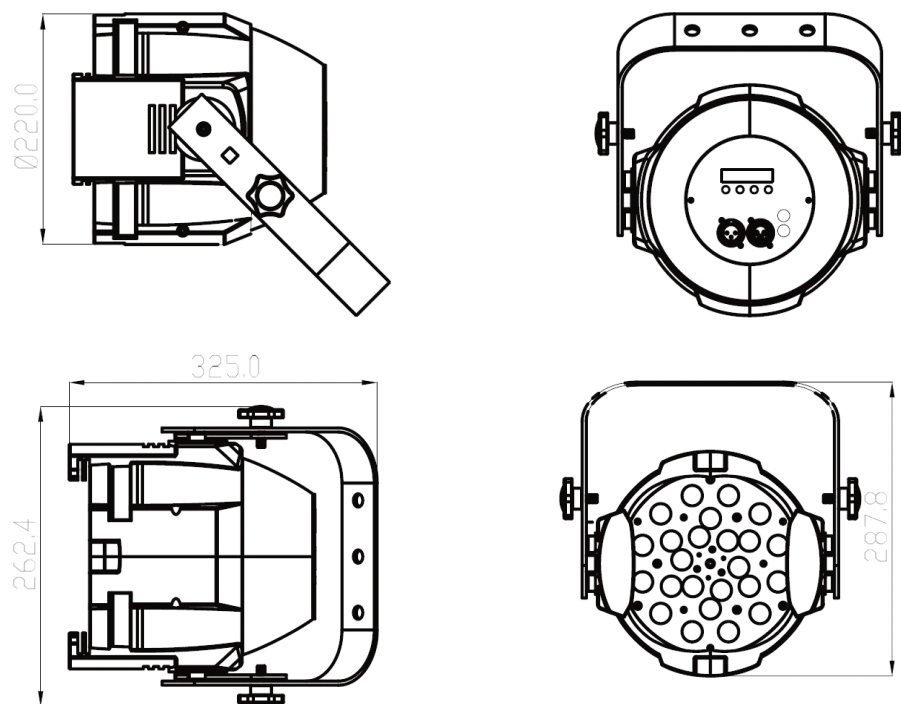

2. Safety Instructions



CAUTION!

Be careful with your operations. With a dangerous voltage you can suffer a dangerous electric shock when touching wires!

This device has left the factory in perfect condition. In order to maintain this condition and to ensure a safe operation, it is absolutely necessary for the user to follow the safety instructions and warning notes written in this user manual.



Important:

Damages caused by the disregard of this user manual are not subject to warranty. The dealer will not accept liability for any resulting defects or problems.

If the device has been exposed to temperature changes due to environmental changes, do not switch it on immediately. The arising condensation could damage the device. Leave the device switched off until it has reached room temperature.

This device falls under protection-class I. Therefore it is essential that the device be earthed.

The electric connection must carry out by qualified person.

The device shall only be used with rate voltage and frequency.

Make sure that the available voltage is not higher than stated at the end of this manual.

Make sure the power cord is never crimped or damaged by sharp edges. If this would be the case, replacement of the cable must be done by an authorized dealer.

Always disconnect from the mains, when the device is not in use or before cleaning it. Only handle the power cord by the plug. Never pull out the plug by tugging the power cord.

During initial start-up some smoke or smell may arise. This is a normal process and does not necessarily mean that the device is defective, it should decrease gradually.

Please don't project the beam onto combustible substances.

Fixtures cannot be installed on combustible substances, keep more than 50cm distance with wall for smooth air flow, so there should be no shelter for fans and ventilation for heat radiation.

If the external flexible cable or cord of this luminaire is damaged, it shall be exclusively replaced by the manufacturer or his service agent or a similar qualified person in order to avoid a hazard.

3. Operation Instructions

- The LED Zoom Par is for beam effect for onsite decoration purpose.
- Don't turn on the fixture if it's been through severe temperature difference like after transportation because it might damage the light due to the environment changes. So make sure to operate the fixture until it is in normal temperature.
- This light should be keep away from strong shaking during any transportation or movement.
- Don't pull up the light by only the head, or it might cause damages to the mechanical parts.
- Don't expose the fixture in overheat, moisture or environment with too much dust when installing it. And don't lay any power cables on the floor. Or it might cause electronic shock to the people.
- Make sure the installation place is in good safety condition before installing the fixture.
- Make sure to put the safety chain and check whether the screws are screwed properly when installing the fixture.
- Make sure the lens are in good condition. It's recommended to replace the units if there are any damages or severe scratch.
- Make sure the fixture is operated by qualified personnel who knows the fixture before using.
- Keep the original packages if any second shipment is needed.
- Don't try to change the fixtures without any instruction by the manufacturer or the appointed repairing agencies.
- It is not in warranty range if there are any malfunctions from not following the user manual to operate or any illegal operation, like shock short circuit, electronic shock, lamp broke, etc.

8.DMX Channels

Chanel	Function	Values	Description
1	Zoom	0-255	Zoom from 10° to 60°
2	Speed	0-255	Zoom speed from fast to slow
3	Dimmer	0-255	Dimmer from 0-100%
4	Red	0-255	Red from 0-100%
5	Green	0-255	Green from 0-100%
6	Blue	0-255	Blue from 0-100%
7	Macro	0-255	19 Preset colors and 3 built-in programs
8	Strobe Speed	0-255	Strobe and built-in program speed from fast to slow
9	Reset	0-199	Empty
		200-220	Reset after 3 seconds
		221-255	Empty

7. Control Modes

A. Auto Mode

For this mode, the users can select color and zoom macro for desired effect.

1. Press MODE and select "Auto".
2. Press ENTER to access "Color" or "Zoom".
3. Use UP/DOWN to select desired effect.

B. Sound Mode

For this mode, the zoom par runs to the beat of music.

1. Press MODE and select "Sound".
2. Press ENTER to access sound programs.
3. Use UP/DOWN to select sound programs.
4. Press ENTER and use UP/DOWN to set sound sensitivity level.

C. Manual Mode

For this mode, the users can manually adjust zoom and each color of red, green, blue.

Press MODE and select "Zoom".

Press ENTER to access color or zoom.

Use UP/DOWN to adjust parameter of color or zoom.

D. DMX Mode

For this mode, the zoom par functions on 9 DMX channels.

1. Press MODE and select :DMX".
2. Press ENTER to access DMX address.
3. Use UP/DOWN to set the start address of the par.

4. Mounting and Installation

Cautions: For added protection mount the fixtures in areas outside walking paths, seating areas, or in areas where the fixture might be reached by unauthorized personnel.

Before mounting the fixture to any surface, make sure that the installation area can hold a

minimum point load of 10 times the device's weight.

Fixture installation must always be secured with a secondary safety attachment, such as an appropriate safety cable.

Never stand directly below the device when mounting, removing, or servicing the fixture.

from a ceiling, or set on a flat level surface (see illustration below). Be sure this fixture is kept at least 0.5m (1.5 ft) away from any flammable materials (decoration etc.).

Always use and install the supplied safety cable as a safety measure to prevent accidental damage and/or injury in the event the clamp fails.

Mounting points: Overhead mounting requires extensive experience, including amongst others calculating working load limits, a fine knowledge of the installation material being used, and periodic safety inspection of all installation material and the fixture. If you lack these qualifications, do not attempt the installation yourself. Improper installation can result in bodily injury.

Be sure to complete all rigging and installation procedures before connecting the main power cord to the appropriate wall outlet.

Mounting: The LED Zoom Par provides a unique mounting bracket assembly. Please use the qualified light hook hanging it to the truss or use the screws to fix it to the ceiling or any application areas. Then add a safety chain to the lights to ensure the safety of handling.

5. DMX-512 control connections

Connect the provided XLR cable to the female 3-pin XLR output of your controller and the other side to the male 3-pin XLR input of the LED Zoom Par. You can chain multiple Zoom Pars together through serial linking. The cable needed should be two core, screened cable with XLR input and output connectors.

Please refer to the diagram below.

DMX-512 connection with DMX terminator

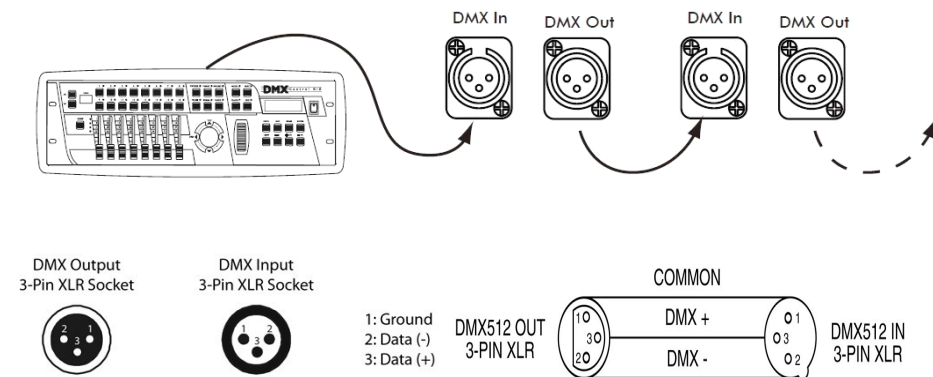

For installations where the DMX cable has to run a long distance or is in an electrically noisy environment, such as in a discotheque, it is recommended to use a DMX terminator. This helps in preventing corruption of the digital control signal by electrical noise. The DMX terminator is simply an XLR plug with a 120 Ω resistor connected between pins 2 and 3, which is then plugged into the output XLR socket of the last fixture in the chain. Please see illustrations below.

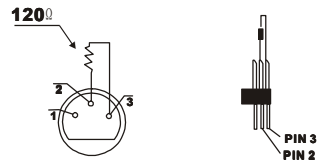

6. Menu Operations

