



Assembly Guide

VISION  FITNESS®

R2100 AND R2000
SEMI-RECUMBENT FITNESS BIKES

Assembly Guide

R2100 AND R2000 SEMI-RECUMBENT FITNESS BIKES

To avoid possible damage to this Fitness Bike, please follow these assembly steps in the correct order. Before proceeding, find your new Fitness Bike's serial number located on the front axle tube, and enter here:

Refer to this number when calling for service, and enter this serial number on your Warranty Card and in your own records. Be sure to read your Owner's Guide before using your new Fitness Bike.

If any parts, hardware or tools are missing, please call 1.800.335.4348, Extension 12

NOTE: It is recommended that you apply grease to the threads of each screw as you assemble your Fitness Bike to prevent loosening and noise. Also, during each assembly step, ensure that ALL screws are in place and partially threaded in before completely tightening any ONE screw.

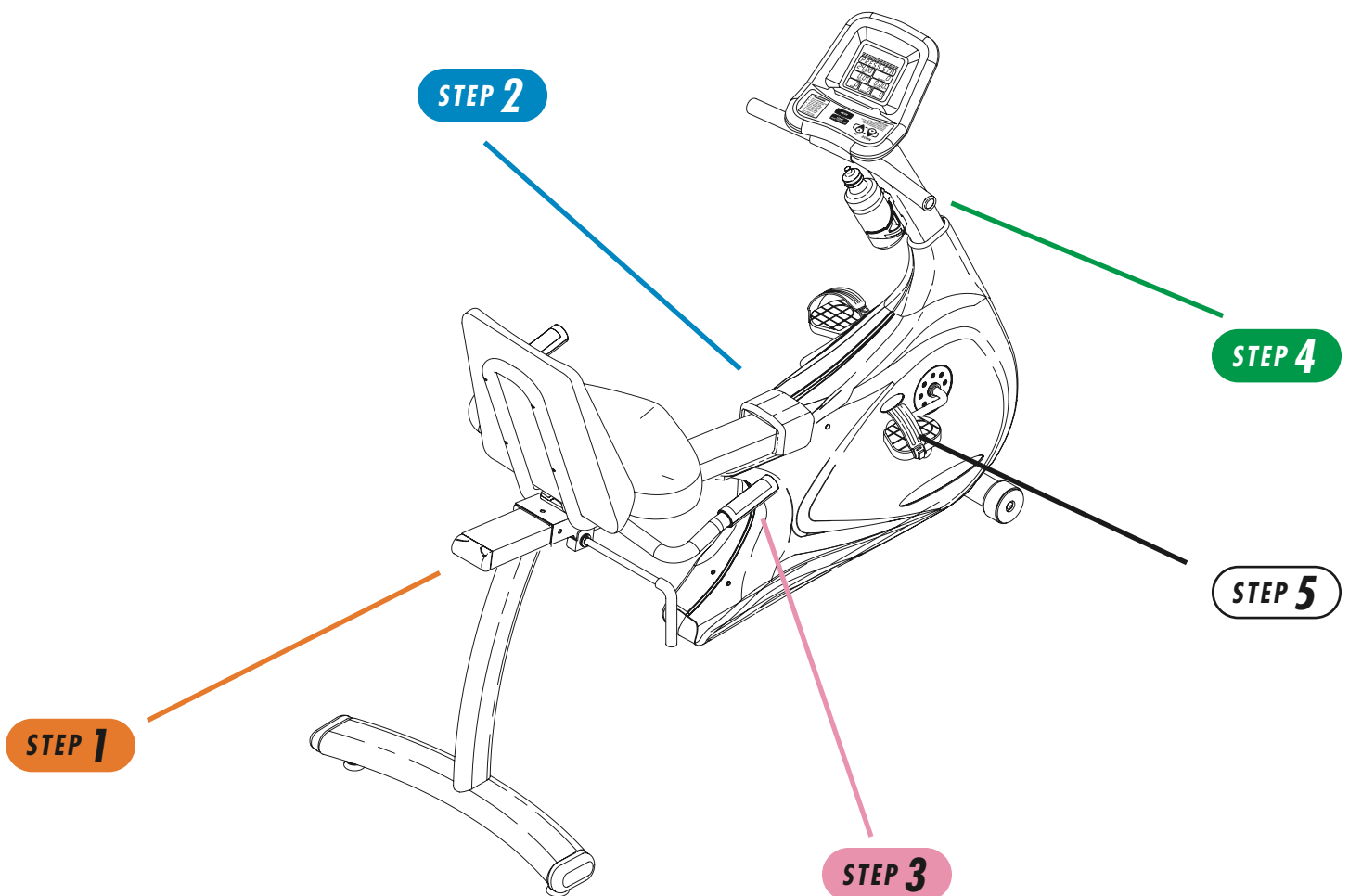

TOOLS & PARTS INCLUDED

5mm T-Shaped Wrench

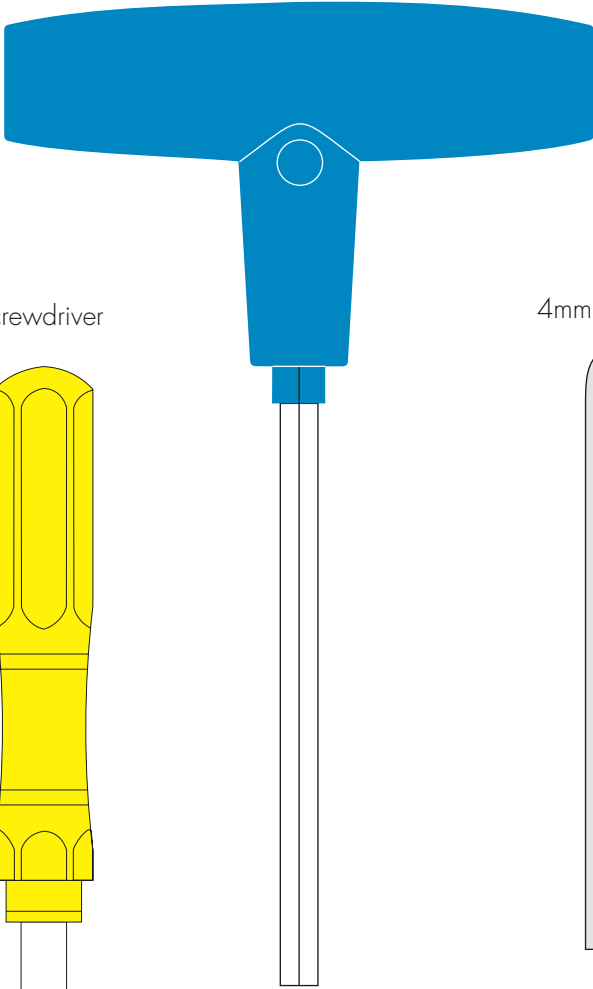

15mm Pedal Wrench

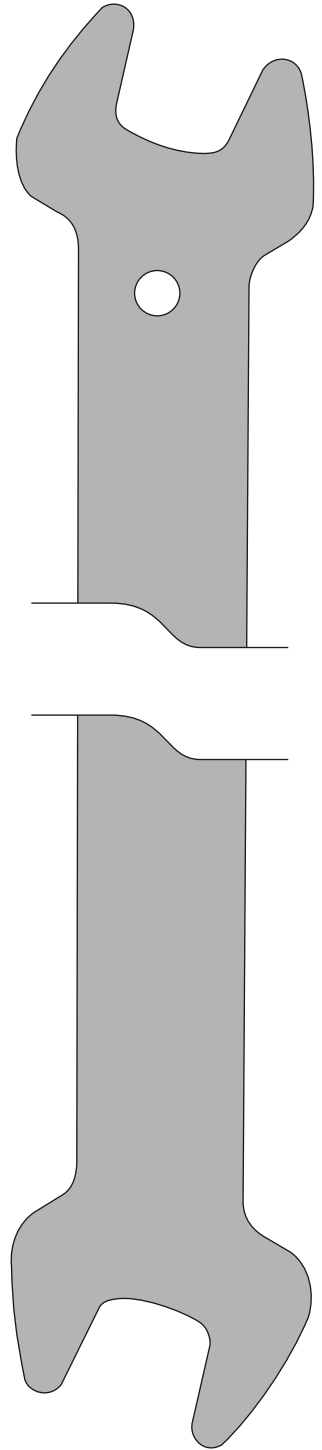

Screwdriver

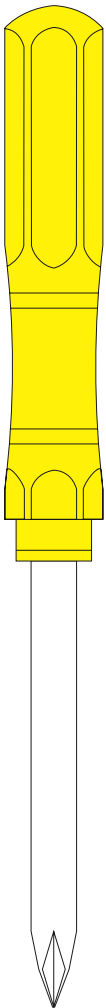

4mm L-Shaped Wrench

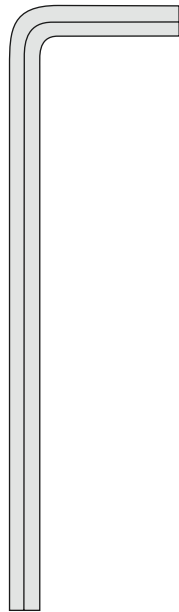

5mm L-Shaped Wrench

PARTS BOX

- Console Mast Cover
- Pedals
- Seat Rail Cover
- Tension Knob and bracket
(R2000 ONLY)
- Water Bottle & Cage
- Water Bottle Bracket
(R2000 ONLY)
- Power Supply
(R2100 ONLY)
- Color-coded Hardware Bags
- Owner's Guide
- Assembly Guide
- Warranty Card

HARDWARE INCLUDED

ORANGE BAG

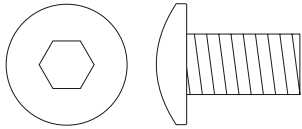

M8 x 15L Screw
Quantity: 4

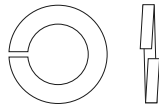

M8 Lockwasher
Quantity: 4

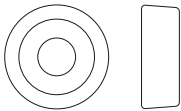

Rubber Stopper
Quantity: 1

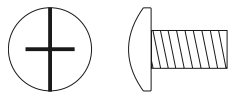

M5 x 10L Screws
Quantity: 1

PINK BAG

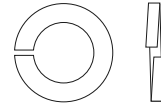

M8 Lockwasher
Quantity: 4

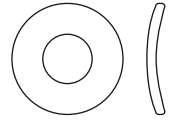

M6 Arc Washer
Quantity: 8

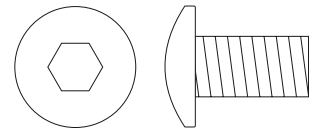

M8 x 15L Screw
Quantity: 4

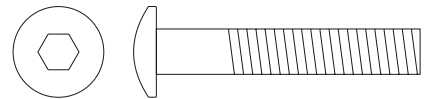

M6 x 35L Screws
Quantity: 8

BLUE BAG

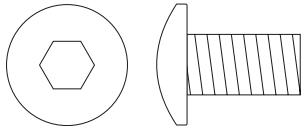

M8 x 15L Screw
Quantity: 3

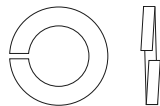

M8 Lockwasher
Quantity: 3

GREEN BAG

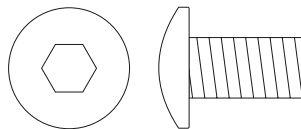

M8 x 15L Screws
Quantity: 5



M5x35L CapScrew
Quantity: 2
(R2000 ONLY)

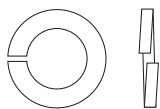

M8 Lockwashers
Quantity: 4



M5 x 65L Screw
Quantity: 1
(R2000 ONLY)

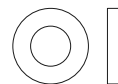
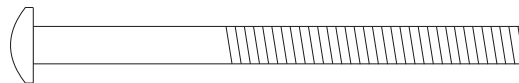

M5 Washer
Quantity: 1
(R2000 ONLY)

STEP 1**ORANGE BAG**

- Attach the rear support to the seat rail with four screws (M8x15) and four lock washers (M8). Tighten with the 5mm T-shaped wrench.
- Slide the seat frame onto the seat rail. Make sure the flat side of the clamp block rests against the bottom of the seat rail.
- Insert the heart rate wires located under the seat frame through the hole on the bottom of the seat rail and push them toward the front of the rail. Take the end of the heart rate wires that runs through the seat rail and insert them through the hole in the bracket at the end of the rail. Snap the wire grip around the end of the heart rate wires and slide it into place on the bracket.
- Attach the rubber stopper to the bottom of the seat rail with the (M5x10) screw.

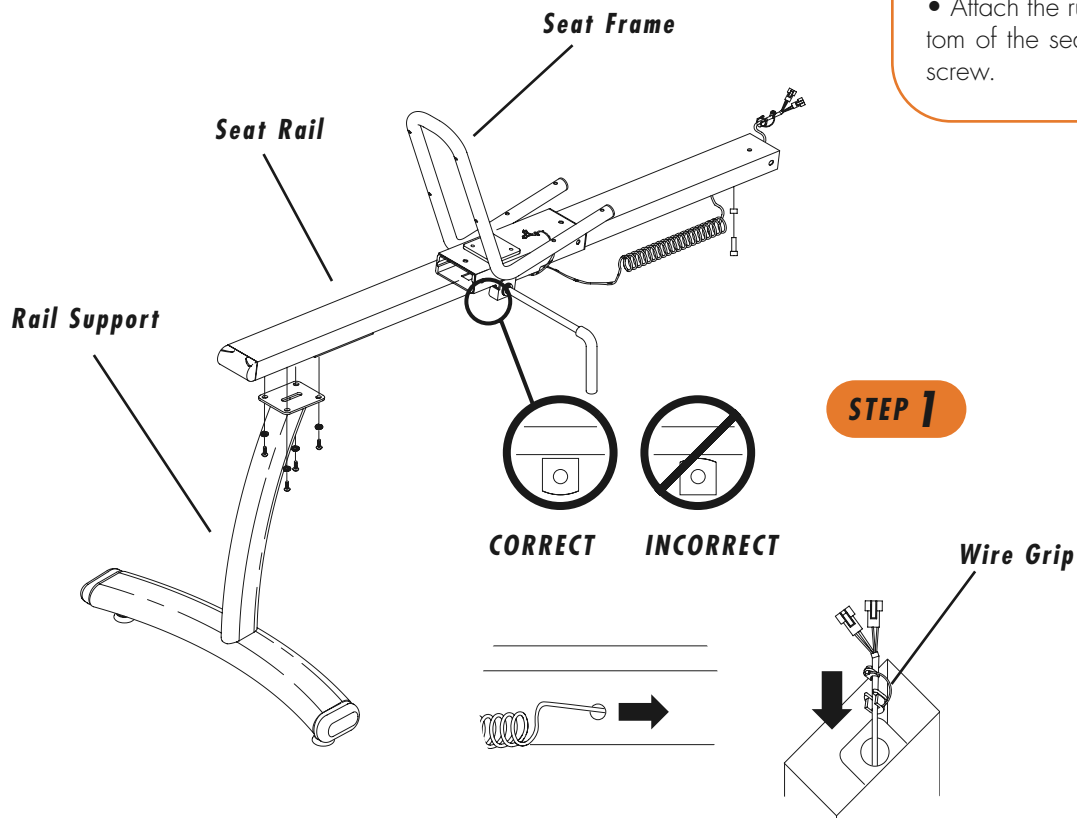

STEP 2

BLUE BAG

- Slide the seat rail sleeve onto the seat rail.
- Connect the heart rate wires coming from the seat rail to the heart rate wires coming from the seat frame bracket. Tuck the excess wire under the seat frame bracket.
- Slide the seat rail onto the seat rail bracket. Secure with three screws (M8x15) and three lock washers (M8). Tighten with the 5mm T-shaped wrench.
- Slide the seat rail sleeve into position at the front of the seat rail.

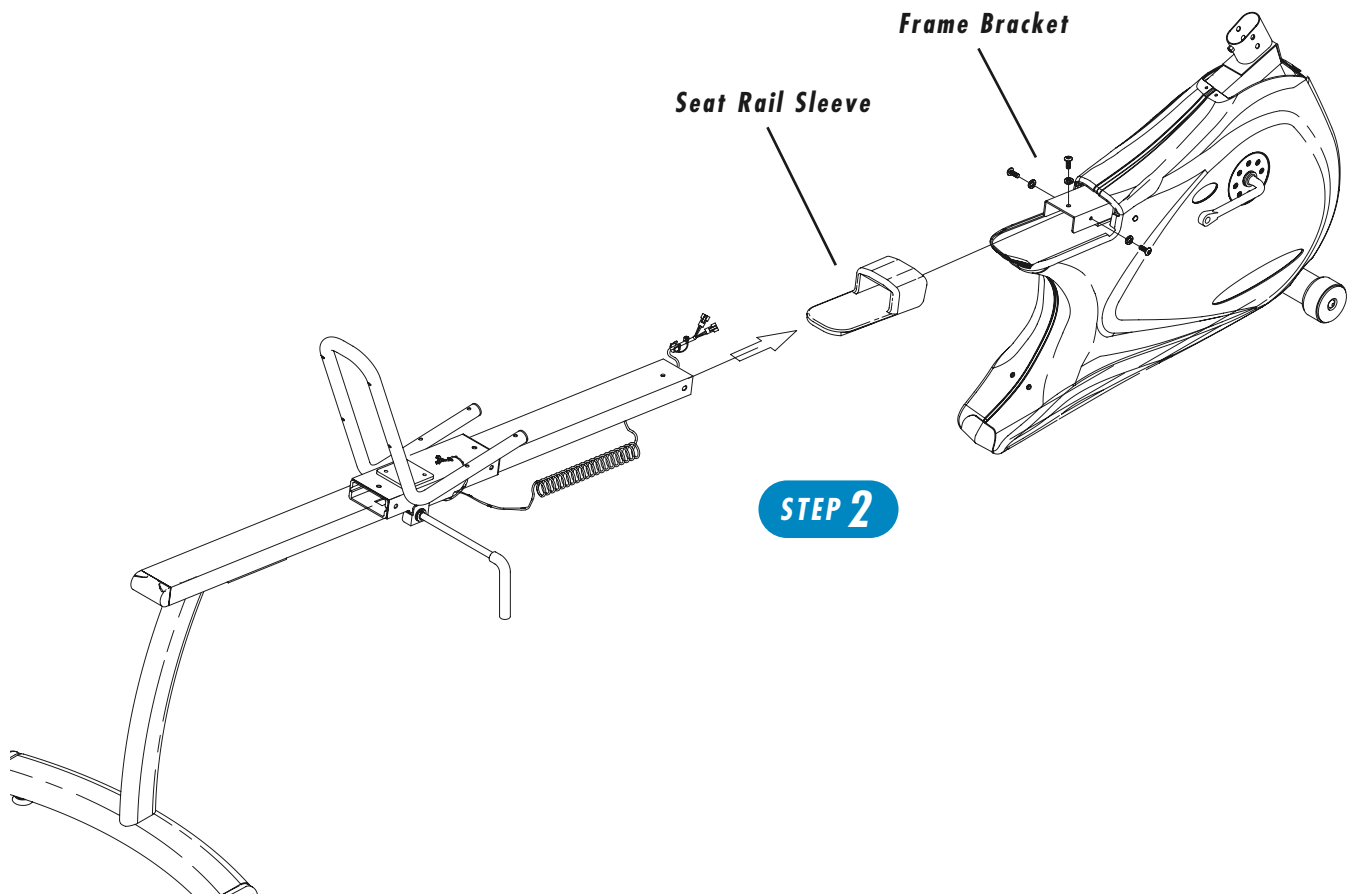

STEP 3

PINK BAG

- With four screws (M8x15) and four lock washers (M8) attach the seat handlebar to the seat frame.
- Connect the heart rate wires coming from the seat handlebar to the heart rate wires on the seat frame.
- Mount the backrest and the seat cushion to the seat frame using eight screws (M6x35) and eight arc washers (M6). Tighten with the 4mm L-shaped wrench.

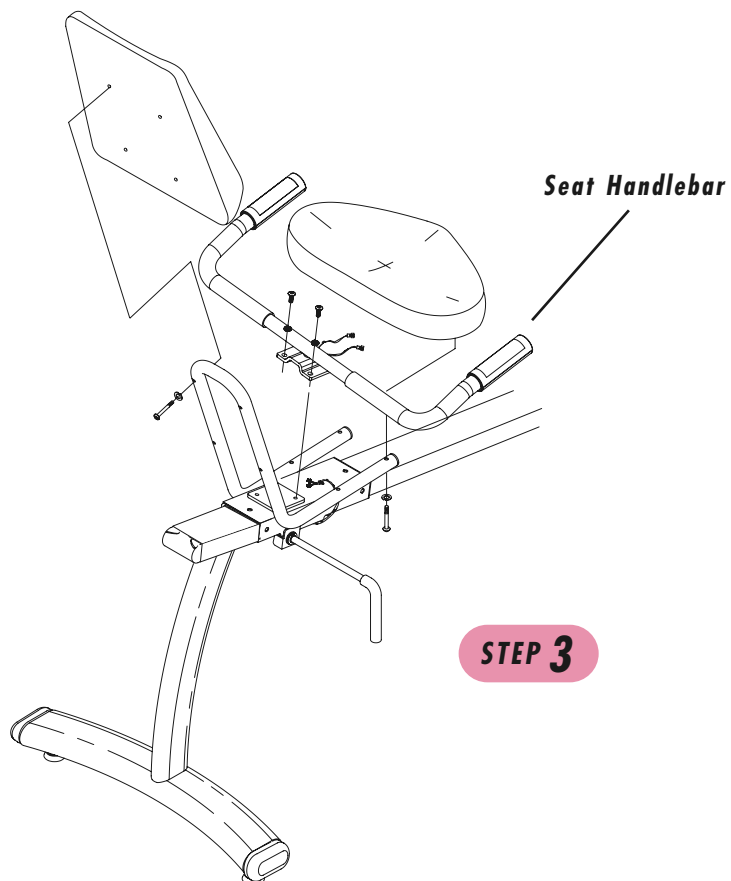

STEP 3

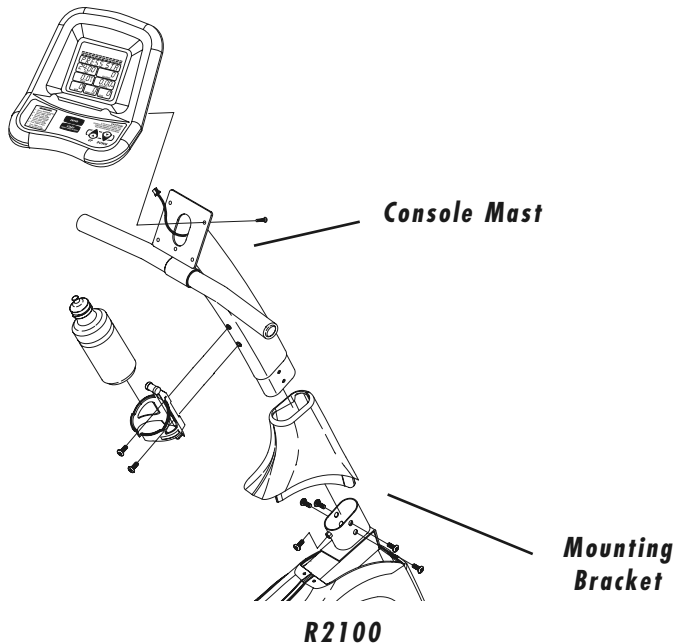
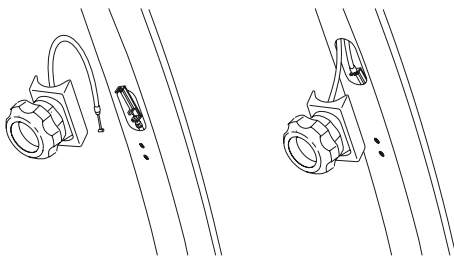
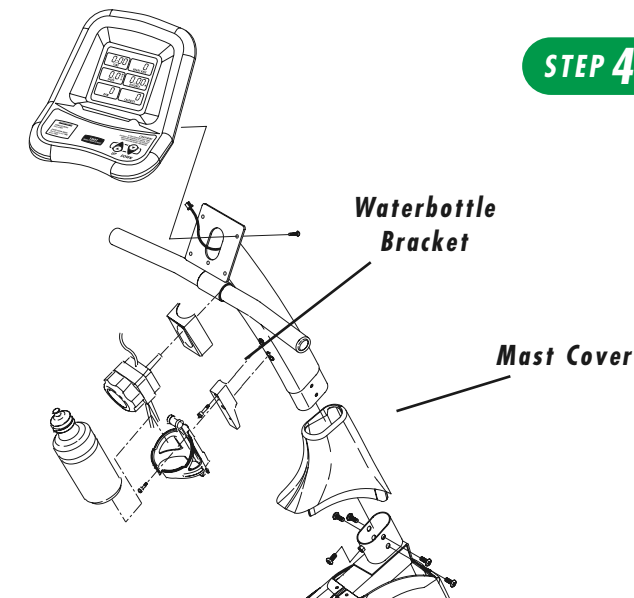
STEP 4**GREEN BAG****STEP 4**

- Slide the mast cover onto the console mast.

- With the included wire tie, pull the console cable, or sensor wire, and heart rate wires, through the console mast. Place the console mast into the console mast mounting bracket. Secure the mast to the bracket with five screws (M8x1.5L) and four lock washers (M8) and tighten with the 5mm T-shaped wrench. **NOTE:** The screw facing the seat does not use a lock washer. Tighten this screw until snug. Slide the console mast cover down over the screw heads.

- **R2000 ONLY:** Turn the tension knob to level 16. Direct the cable on the tension knob through the tension knob bracket. Attach the cable to the tension cable located in the console mast. Secure the tension knob to the console mast with the washer (M5) and screw (M5x6.5L). Tighten with the screwdriver.

- Remove the four screws from the back of the console. Plug the wire harness and heart rate wires into the console. Mount the console onto the console mast with the four screws.

- **R2000 ONLY:** Insert the two AA batteries into the console.

- Remove the two M5x1.5L Screws from the water bottle cage holes on the console mast.

- **R2000 ONLY:** Secure the water bottle bracket to the console mast with the 4mm L-shaped wrench and two cap screws (M5x3.5L). Attach the water bottle cage to the bracket with two screws (M5x1.5L) using the screwdriver. Insert the water bottle into the cage.

- **R2100 ONLY:** Attach the water bottle cage to the console mast with two screws (M5x1.5L) using the screwdriver. Insert the water bottle into the cage.

STEP 5

PEDALS

- Attach the left and right pedals to the left and right crank arms, tighten using the 15mm pedal wrench.

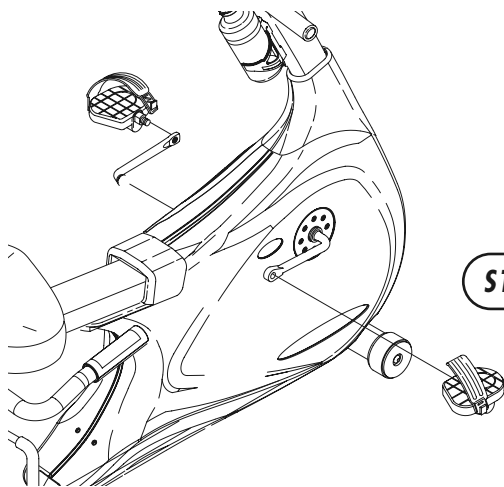

STEP 5

VISION  FITNESS®

500 South CP Avenue • P.O. Box 280 • Lake Mills, WI 53551
toll free 1.800.335.4348 • phone 1.920.648.4090 • fax 1.920.648.3373
www.visionfitness.com

©2004 Vision Fitness. All Rights Reserved. 5.05 Part #Z20RB104-AG
AG18.17PRD
REV5