

# GL7000 Display Module USER'S MANUAL

Thank you very much for buying this GRAPHTEC product.

This product is a display module for recording.  
Please use it by installing it on the main module.

These directions describe preparations and cautions before measurement.

**For the details concerning operation procedures etc., read the User's manual recorded on the CD-ROM (included with the main module)**

## Confirmation of the exterior

After opening the package, please confirm that there are no problems (scratches and dirt) on the exterior before use.

## Confirmation of the attached items.

- Instruction manual (this book): 1
- Tilting table: 1 module
- Monitor connection cable (40 cm): 1 pc.
- Screws (M4x6): 3 pcs.
- Ground cable: 1 pc.
- Flat Head Screws (M4 x 10) 2 pcs. (Spare)

If by any chance faults are found, please contact the store where you bought the item.

\* Please note that items mentioned in this book may change without prior notice.

## 1 Part Names

### Explanation of the module's part names and functions.

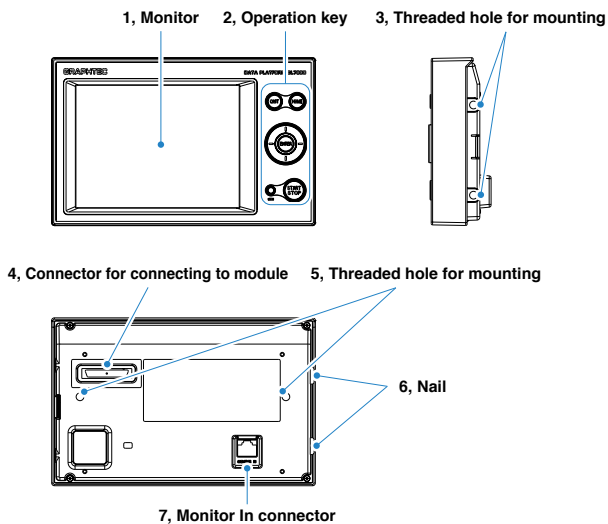

1, Monitor

2, Operation key

3, Threaded hole for mounting... Threaded hole for fixing to the main module

4, Connector for connecting to module.. Connector for connecting to the main module

5, Threaded hole for mounting.. Threaded hole for fixing to the tilting table (M4 Approx depth 5 mm)

6, Nail..... Threaded hole for fixing to the tilting table (2 places)

7, Monitor In connector..... Connector for use when extending cables, and when using the tilting table

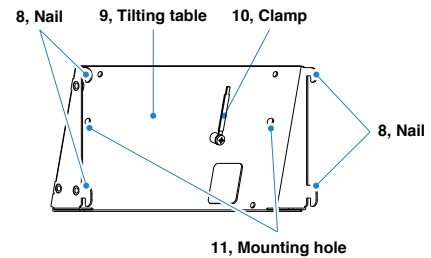

8, Nail..... Nails for fixing to the main module (4 places)

9, Tilting table

10, Clamp..... Clamp for binding the monitor connection cable

11, Mounting hole..... Threaded hole for fixing to the display module

## 2 How to Install Module

This explains how to attach the module to the main module.

**CAUTION** When installing or removing the module, please make sure that the power is off.

The display module has 3 basic positions.

**A. When the main module is attached...** fitting to the main module.

**B. When using the tilting table...** Use the tilting table (at a 15° tilt angle) to fit to the main module.

**C. When extending cables...** Use a commercially available LAN cable, and attach to a place separated from the display module on the main module.

### A. This explains how to install when attaching the main module.

1, Remove fixation screws from the main module (2 places on the side)

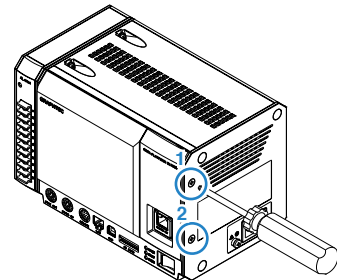

2, Pull the nail on the upper-right side of the face cover, and remove the face cover.

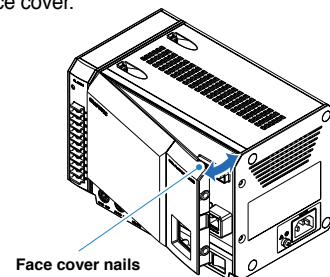

3, Join the nails on the back of the display module with the inset part of the main module, and push it in.

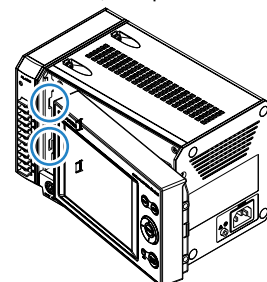

- 4, Join the display module with the module connector, and insert into the main module.

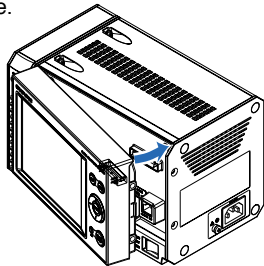

- 5, Attach the fixation screws of the main module (2 places on the side).

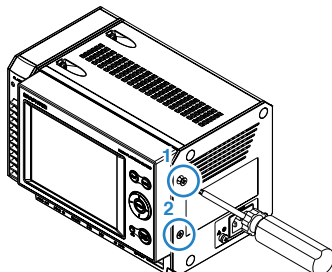

During installation, a 4kgf.cm screw tightening torque is recommended.

#### B. This explains how to attach the tilting table for use.

(After the main module's face cover is removed)

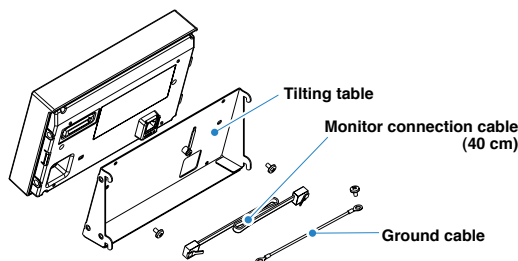

- 1, Install by binding the monitor connection cable with the clamp on the tilting table.

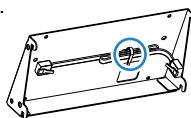

Bind so that there is approx. 25 cm between the monitor connection cable and the connector.

- 2, Attach the display module to the tilting table with the attached fixation screws (2 places).

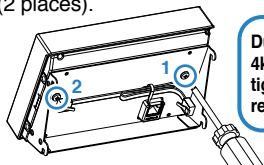

During installation, a 4kgf.cm screw tightening torque is recommended.

- 3, Connect the connector of the monitor connection cable to the monitor in connector of the display module.

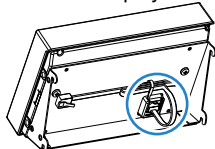

- 4, Connect the monitor connection cable to the monitor out connector of the main module and attach the 4 point nails on the tilting table by fixing them to inset part of the main module (4 places).

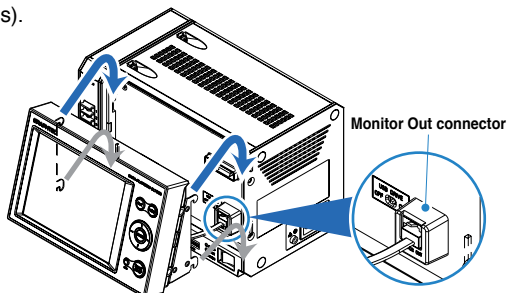

- 5, Attach the fixation screws on the main module (2 places on the side).

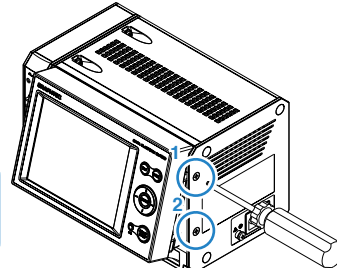

During installation, a 4kgf.cm screw tightening torque is recommended.

- 6, Attach the ground cable to the main module (GND terminal) with the fixation screws attached to the tilting table.

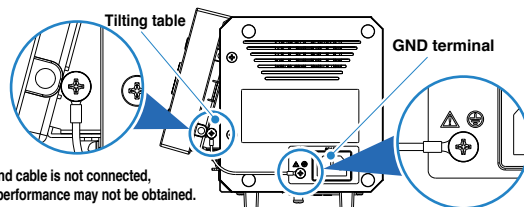

\* If the ground cable is not connected, sufficient performance may not be obtained.

#### C. This explains installation when extending cables.

(After the main module's face cover is mounted)

- 1, Connect the monitor out contact on the main module and the monitor in contact on the display module with a commercially available LAN cable.

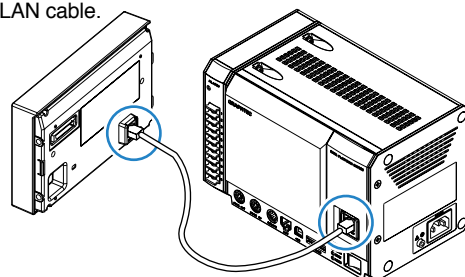

#### Please note the specifications of the LAN cable you use.

[LAN Cable specifications]

• Type: Straight cable • Category: CAT5 or above • Cable length: 10 m or less

#### CAUTION

- Please use the display module fixed to a board, etc.
- Please do not connect a LAN cable with the monitor in connector of the display module and the LAN connector of the GL7000 main module.

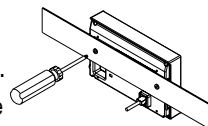

## 3 Specifications

#### GL7-DISP (Display Module) Specifications

Item	Contents
Display device	5.7" TFT color liquid crystal display (VGA: 640 x 480)
Operating portion	Capacitive touch-panel and key shared use * Almost all operations can be performed by either the touch-panel or the keys.
touch-panel	Input method: Finger Operating life: Approx. 50,000,000 times * It depends on the status of use, etc.
Display characters	Japanese, English, French, German, Chinese, and Korean
Backlight	Screen saver function (10, 30 sec.; 1, 2, 5, 10, 30, 60 min.)
Backlight life	50,000 hours (when brightness has decreased to 40%), changes according to use environment
Display screen	Waveform + digital screen, full waveform screen, digital + operation screen, X-Y display * CH number and display CH are designated for when the display of the digital + operation screen is digitally enlarged
Connection cable (For cable extension)	LAN cable (straight, CAT5 and above, cable length 10 m or less) * Please purchase a commercially available product
Accessories	Tilting table 1 module Monitor connection cable (40 cm) 1 pc. Screws (M4 x 6) 3 pcs. Flat Head Screws (M4 x 10) 2 pcs. (Spare) Ground cable 1 pc.
External dimensions [WxDxH] (approximate)	187 x 34.5 x 119 mm (Not including protruding parts)
Weight	530g (Not including the tilting table)

Since the touch-panel in this module is a capacitive touch-panel, it does not respond by touching it with a pen.

- \* Please note that if the touch-panel is operated with an object with a sharp edge, it may scratch and damage the touch-panel.
- \* Do not touch when your hands are wet.