



pure indoor living

**HEATER**  
*WITH ADJUSTABLE  
THERMOSTAT*



\* Fan-Forced Heaters may appear with a different grill design

**NOTE:** A Phillips screwdriver is required for assembly.

## **Instruction Leaflet**

Read instructions before operating. Retain for future reference.

 Questions? Comments? Call 1-800-253-2764 in North America.

# PLEASE READ AND SAVE THESE IMPORTANT SAFETY INSTRUCTIONS

When using electrical appliances, basic safety precautions should always be followed to reduce the risk of fire, electric shock, and injury to persons, including the following:

1. Read all instructions before using the appliance.
2. To avoid fire or shock hazard, plug the appliance directly into a 120V AC electrical outlet.
3. The heater is hot when in use. To avoid burns, DO NOT let bare skin touch hot surfaces. If provided, use handles when moving this heater. Keep combustible materials, such as furniture, pillows, bedding, papers, clothes, and curtains at least 3 ft (0.9 m) from the front of the heater and keep them away from the sides and rear.
4. DO NOT run cord under carpeting. DO NOT cover cord with throw rugs, runners, or the like. Arrange cord away from traffic area and where it will not be tripped over.
5. This heater is not intended for use in bathrooms, laundry areas and similar indoor location. NEVER locate heater where it may fall into a bathtub or other water container.
6. Extreme caution is necessary when any heater is used by, or near children or invalids, and whenever the heater is left operating and unattended.
7. Always unplug the heater when not in use.
8. When unplugging, be sure to pull by the plug and not the cord.
9. DO NOT insert or allow foreign objects to enter any ventilation or exhaust opening as this may cause an electric shock or fire, or damage the heater.
10. DO NOT operate heater with a damaged cord or plug, or after the heater malfunctions, has been dropped or damaged in any manner. Return appliance to manufacturer for examination, electrical or mechanical adjustment, or repair.
11. A heater has hot and arcing or sparking parts inside. DO NOT use it in areas where gasoline, paint, or flammable liquids are used or stored.
12. Use appliance only for intended household use as described in this manual. Any other use not recommended by the manufacturer may cause fire, electric shock, or injury to persons. The use of attachments not recommended or sold by the manufacturer may cause hazards.
13. DO NOT use outdoors.
14. To prevent a possible fire, DO NOT block air intakes or exhaust in any manner. DO NOT use on soft surfaces, like a bed, where openings may become blocked.
15. To disconnect heater, turn controls to OFF, then remove plug from outlet.
16. Avoid the use of an extension cord because the extension cord may overheat and cause a risk of fire. However, if you have to use an extension cord, the cord shall be No. 14 AWG minimum size and rated not less than 1875 watts.
17. If the heater will not operate, see specific instructions on Auto Safety Shut-off.
18. DO NOT attempt to repair or adjust any electrical or mechanical functions on this unit. Doing so will void your warranty. The inside of the unit contains no user serviceable parts. All servicing should be performed by qualified personnel only.
19. Discontinue use if plug or outlet is hot. It is recommended that the outlet be replaced if plug or outlet is hot to touch.
20. **CAUTION:** In order to avoid a hazard due to inadvertent resetting of the thermal cutout, this appliance must not be supplied through an external switching device, such as a timer, or connected to a circuit that is regularly switched on and off by the utility.
21. **WARNING:** In order to avoid overheating, do not cover the heater.
22. **WARNING:** This heater is not equipped with a

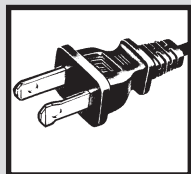

**THIS APPLIANCE HAS A POLARIZED PLUG (one blade is wider than the other). To reduce the risk of electric shock, this plug is intended to fit in a polarized outlet only one way. If the plug does not fit fully in the outlet, reverse the plug. If it still does not fit, contact a qualified electrician to install the proper outlet.**

**DO NOT ATTEMPT TO MODIFY THIS PLUG OR DEFEAT THIS SAFETY FEATURE IN ANY WAY.**

# ASSEMBLY INSTRUCTIONS

device to control the room temperature. Do not use this heater in small rooms when they are occupied by persons not capable of leaving the room on their own, unless constant supervision is provided.

## PLEASE READ AND SAVE THESE IMPORTANT SAFETY INSTRUCTIONS

### TECHNICAL SPECIFICATIONS

- Amps: 12.5
- Wattage: 1500W (+5% -10%)
- Working voltage: 120V AC/60Hz

**NOTE:** Low Heat setting may be 1000W on some models.

### ASSEMBLY INSTRUCTIONS (IF REQUIRED)

**NOTE:** A Phillips screwdriver is required for assembly. Unpack your heater from box, being careful to remove all parts from plastic bags and remaining packaging. Please save the carton for off-season storage.

Some models are packed with separate base and pedestal in the box. Carefully remove all parts from plastic bags. To prevent scratches, place all parts onto a cloth before assembly. Follow the below instructions for Pedestal/Base assembly:

**Pedestal Assembly** (if no pedestal is included in this model, move to Base Assembly)

**Step 1:** Run the power cord through the center of the assembled pedestal. Snap pedestal into the bottom of the heater housing. Refer to Figure 1, 2.

Figure 1

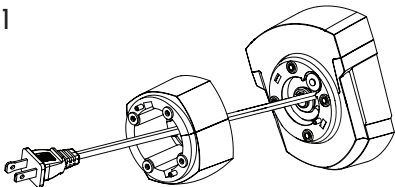

Figure 2

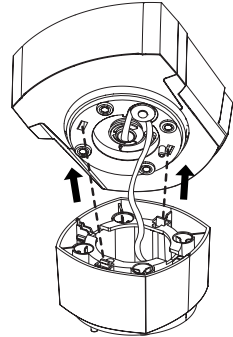

Figure 3

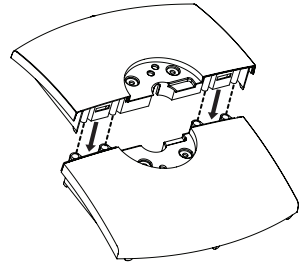

Figure 4

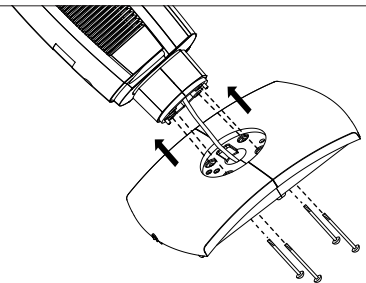
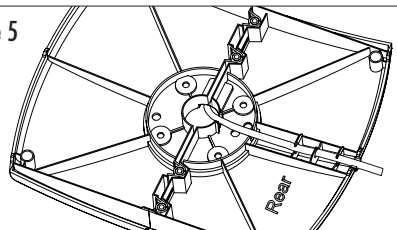

Figure 5



# FEATURES - OPERATIONS

## Base Assembly

- Step 1:** If the base is in two halves, snap them together by sliding slots of one base half into slots of second base half. Refer to Figure 3.
- Step 2:** Run the power cord through the center of the assembled base. To assemble the base to the unit (either one or two-piece base) first make sure the side marked "Rear" is facing the back of the heater. Line up holes of the base with holes on bottom of pedestal (or heater housing if no pedestal is included), and secure with 4 provided screws. Refer to Figure 4.
- Step 3:** Lace the power cord through the cord minders on the underside of the base. Refer to Figure 5.
- Step 4:** Turn the heater right side up and place on a flat level surface prior to beginning operation.

## OPERATING INSTRUCTIONS

1. Make sure the unit is in the OFF (○) position before plugging the heater into the outlet.
2. Place heater on a firm, level surface.
3. Plug heater into a standard outlet. Once plugged in, the Power Light will illuminate.

**NOTE:** Remove the plastic film from the control panel before using (if included).

**NOTE:** Avoid overloading your circuit by not using other high wattage appliances in the same outlet. At 1500 watts, this unit draws 12.5 Amps.

## Mode Control

Turn the Mode Control to the desired setting:

### ○ - Off Mode

If you want to shut off the heater at any time during operation, turn the Mode Control to Off (○) position. Power Light will remain lit until the heater is unplugged.

### 🌀 - Fan only Setting

Heater will run at fan-only operation without heat output.

### 1 - LOW Heat

The heater will run continuously at 750W.

### 2 - HIGH Heat

The heater will run continuously at 1500W.

**NOTE:** To start the heater operation, make sure the Thermostat Control is turned fully clockwise to the highest position.

### 🌡️ Thermostat Control

1. Before setting the thermostat, allow heater to operate and warm up the room. Set the thermostat to the highest setting to start the heater.
2. When the desired temperature comfort level is reached, lower the thermostat setting until the fan/heater stops operating. This is done by moving the Thermostat Control counter-clockwise.
3. The thermostat will now automatically maintain the pre-set temperature level by turning the heater ON and OFF.

**NOTE:** It is normal for the heater to cycle ON and OFF as it maintains the preset temperature. To prevent the unit from cycling, turn the thermostat control clockwise to the highest setting or operate in manual mode at either High (2) or Low (1) setting.

### 🌡️ - FrostProtect™ setting

Turn the Thermostat Control to the FrostProtect™ (🌡️) setting, the heater will turn on automatically if the temperature goes below 5° C.

**CAUTION:** FRONT GRILL IS HOT WHEN UNIT IS IN OPERATION.

Figure 6 CONTROL PANEL

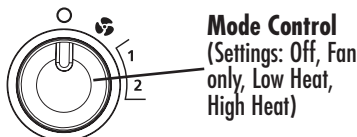

**Mode Control**  
(Settings: Off, Fan only, Low Heat, High Heat)



**Thermostat Control**  
with FrostProtect™  
Setting

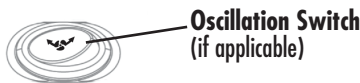

**Oscillation Switch**  
(if applicable)

# CLEANING / MAINTENANCE AUTO SAFETY SHUT-OFF

## For models with Oscillation

### Oscillation

Press the Oscillation Switch (  ) to activate or stop oscillation feature.

**NOTE:** Please do not manually turn the heater on the base. It is designed to turn only by motorized oscillation.

---

## CLEANING/MAINTENANCE

Always unplug the heater before cleaning and allow the heater to cool down.

1. Clean the unit with a soft cloth moistened with a mild soap solution.
2. NEVER use abrasive or flammable solvents to clean the unit.
3. After cleaning, be sure to completely dry the unit with a cloth or towel.
4. Store heater in a cool, dry location.
5. It is recommended that you store the unit in its original carton.  
**TIP:** Over time, dust may accumulate on the front grills. This can be removed by wiping the unit with a damp cloth.

---

## AUTO SAFETY SHUT-OFF

This heater is equipped with a technologically-advanced safety system that requires the user to reset the heater if there is a potential overheat situation. When a potential overheat temperature is reached, the system will automatically shut the heater off. It can only resume operation when the user resets the unit.

### To Reset the Heater:

1. Turn Mode Control to OFF (  ) and Thermostat Control fully clockwise to the highest position.
2. Unplug unit, wait 30 minutes.
3. Plug in and turn ON.

## FOR MODELS WITH TIP OVER PROTECTION

### Tip Over Shut-Off:

When the unit is accidentally knocked over, it will instantly shut off. The unit may also shut off if it is moved or bumped. To reset, simply place the heater in an upright position and it will operate normally.

**NOTE:** If unit does not turn on when placed in the upright position, turn the Mode Control to the desired heat setting and heater will resume operation.

---

## TROUBLESHOOTING

### General Information:

**Environmental Factors** - There are a number of factors that will affect your desired comfort level. These factors can include insulation, open or drafty doors and windows, and outside temperature. Please check and take action if any of these potential problems are affecting your heaters ability to adequately warm your room.

**Supplemental Heat** - Portable electric heaters are intended for supplemental heating of rooms to heat the room your in and turn down the central heat thermostat. They are not intended to replace central heating systems.

**Do NOT attempt to repair or adjust any electrical or mechanical functions on this heater. Doing so will void warranty. The inside of the heater contains no user serviceable parts. All servicing should be performed by qualified personnel only.**

---

If you have any questions regarding your product or would like to learn more about other Bionaire® products, please contact our Consumer Service Department at 1-800-253-2764 or visit our website at [www.bionairecanada.com](http://www.bionairecanada.com). For inquiries regarding recycling and proper disposal of this product, please contact your local waste management facility.

# TROUBLESHOOTING

## Troubleshooting for your Heater

Trouble	Probable Cause	Solution
<ul style="list-style-type: none"> <li>Heater Does Not Turn On.</li> </ul>	<ul style="list-style-type: none"> <li>Tip-over switch engaged (only applicable on models with tip-over protection).</li> <li>Manual user reset is activated.</li> <li>Not plugged in properly.</li> <li>Electrical outlet does not hold plug in securely.</li> <li>Thermostat set too low.</li> <li>Obstruction causing the heater not to operate.</li> <li>Circuit breaker trips.</li> </ul>	<ul style="list-style-type: none"> <li>Set heater upright on a level surface.</li> <li>Follow reset instructions listed in this manual.</li> <li>Ensure plug is properly inserted. Make sure electrical outlet and circuit breaker are working.</li> <li>Have outlet replaced by a licensed electrician.</li> <li>Turn Thermostat Control clockwise until the heater restarts.</li> <li>Unplug the heater and remove all obstructions. Position your heater 36" (0.9m) away from all objects.</li> <li>Make sure no other high wattage appliances are operating on the same circuit and reset breaker if needed.</li> </ul>
<ul style="list-style-type: none"> <li>Not Enough Heat.</li> </ul>	<ul style="list-style-type: none"> <li>Heater is in Low Heat or 1 setting.</li> <li>Thermostat set too low.</li> </ul>	<ul style="list-style-type: none"> <li>Change setting to 2 (High Heat).</li> <li>Turn Thermostat Control clockwise until the heater restarts.</li> </ul>
<ul style="list-style-type: none"> <li>Heater Cycles ON and OFF Frequently.</li> </ul>	<ul style="list-style-type: none"> <li>The thermostat automatically turns the heater on and off to maintain selected comfort level.</li> </ul>	<ul style="list-style-type: none"> <li>To make this occur less frequently adjust the thermostat control clockwise to the highest setting.</li> </ul>
<ul style="list-style-type: none"> <li>Heater is Blowing Cold Air.</li> </ul>	<ul style="list-style-type: none"> <li>Mode Control is set to Fan only setting.</li> </ul>	<ul style="list-style-type: none"> <li>Turn Mode Control to the 1 (Low Heat) or 2 (High Heat) setting.</li> </ul>
<ul style="list-style-type: none"> <li>Fan Speed Doesn't Change.</li> </ul>	<ul style="list-style-type: none"> <li>High Heat and Low Heat settings control the heat output of the heater and not the fan speed. Fan runs at the same speed on all settings.</li> </ul>	<ul style="list-style-type: none"> <li>Run heater in the 2 setting (High Heat) for maximum heat output.</li> </ul>
<ul style="list-style-type: none"> <li>Unexpected Noise.</li> </ul>	<ul style="list-style-type: none"> <li>You may hear a popping or crackling sound as the heater heats up. This is normal and safe operation. Once the heater heats up, the crackling sound will go away.</li> </ul>	<ul style="list-style-type: none"> <li>If the noise persists call Bonaire at 1-800-253-2764.</li> </ul>
<ul style="list-style-type: none"> <li>Unexpected Smell.</li> </ul>	<ul style="list-style-type: none"> <li>There may be an odor or vapor coming from the heater the first time you use it or after prolonged or seasonal storage.</li> </ul>	<ul style="list-style-type: none"> <li>This is normal and is the result of dust or other debris accumulating on the heating element. Make sure the heater is in a well ventilated area and continue running until the odor or vapor goes away.</li> </ul>

# WARRANTY INFORMATION

In the U.S.A., this warranty is offered by Sunbeam Products, Inc. doing business as Jarden Consumer Solutions located in Boca Raton, Florida 33431. In Canada, this warranty is offered by Sunbeam Corporation (Canada) Limited doing business as Jarden Consumer Solutions, located at 20 B Hereford Street, Brampton, Ontario L6Y 0M1. If you have any other problem or claim in connection with this product, please write our Consumer Service Department. **PLEASE DO NOT RETURN THIS PRODUCT TO ANY OF THESE ADDRESSES OR TO THE PLACE OF PURCHASE.**

© 2014 Sunbeam Products, Inc. doing business as Jarden Consumer Solutions. All rights reserved. Imported and distributed by Sunbeam Corporation (Canada) Limited doing business as Jarden Consumer Solutions, 20B Hereford Street, Brampton, Ontario L6Y 0M1.

Printed In China

# WARRANTY INFORMATION

## 1 YEAR LIMITED WARRANTY

Sunbeam Products, Inc. doing business as Jarden Consumer Solutions or if in Canada, Sunbeam Corporation (Canada) Limited doing business as Jarden Consumer Solutions (collectively "JCS") warrants that for a period of one year from the date of purchase, this product will be free from defects in material and workmanship. JCS, at its option, will repair or replace this product or any component of the product found to be defective during the warranty period.

Replacement will be made with a new or remanufactured product or component. If the product is no longer available, replacement may be made with a similar product of equal or greater value. This is your exclusive warranty. Do NOT attempt to repair or adjust any electrical or mechanical functions on this product. Doing so will void this warranty.

This warranty is valid for the original retail purchaser from the date of initial retail purchase and is not transferable. Keep the original sales receipt. Proof of purchase is required to obtain warranty performance. JCS dealers, service centers, or retail stores selling JCS products do not have the right to alter, modify or any way change the terms and conditions of this warranty.

This warranty does not cover normal wear of parts or damage resulting from any of the following: negligent use or misuse of the product, use on improper voltage or current, use contrary to the operating instructions, disassembly, repair or alteration by anyone other than JCS or an authorized JCS service center. Further, the warranty does not cover: Acts of God, such as fire, flood, hurricanes and tornadoes.

### **What are the limits on JCS's Liability?**

JCS shall not be liable for any incidental or consequential damages caused by the breach of any express, implied or statutory warranty or condition.

Except to the extent prohibited by applicable law, any implied warranty or condition of merchantability or fitness for a particular purpose is limited in duration to the duration of the above warranty.

JCS disclaims all other warranties, conditions or representations, express, implied, statutory or otherwise.

JCS shall not be liable for any damages of any kind resulting from the purchase, use or misuse of, or inability to use the product including incidental, special, consequential or similar damages or loss of profits, or for any breach of contract, fundamental or otherwise, or for any claim brought against purchaser by any other party.

Some provinces, states or jurisdictions do not allow the exclusion or limitation of incidental or consequential damages or limitations on how long an implied warranty lasts, so the above limitations or exclusion may not apply to you.

This warranty gives you specific legal rights, and you may also have other rights that vary from province to province, state to state or jurisdiction to jurisdiction.

### **How to Obtain Warranty Service**

#### In the U.S.A.

If you have any question regarding this warranty or would like to obtain warranty service, please call 1-800-253-2764 and a convenient service center address will be provided to you.

#### In Canada

If you have any question regarding this warranty or would like to obtain warranty service, please call 1-800-253-2764 and a convenient service center address will be provided to you.