

## Shroud Support Instructions

Service Kit: GK62-00002-0023

1. Remove the Main Shrouds.

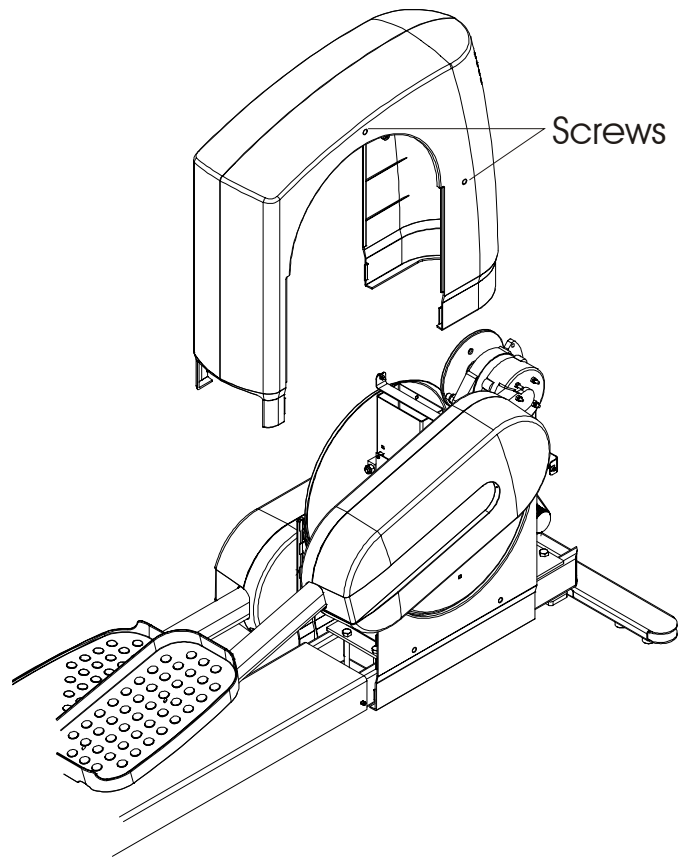

2. Place two pieces of Protective Trim on bracket.

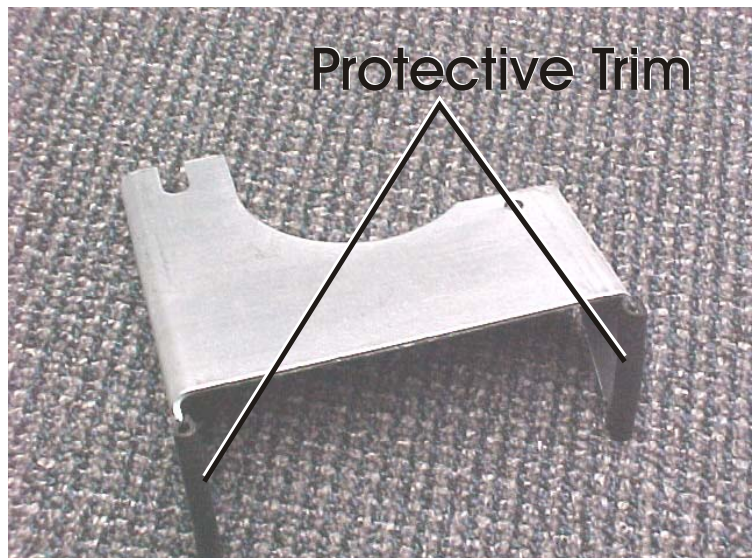

3. Loosen the Alternator Mounting Bolt.

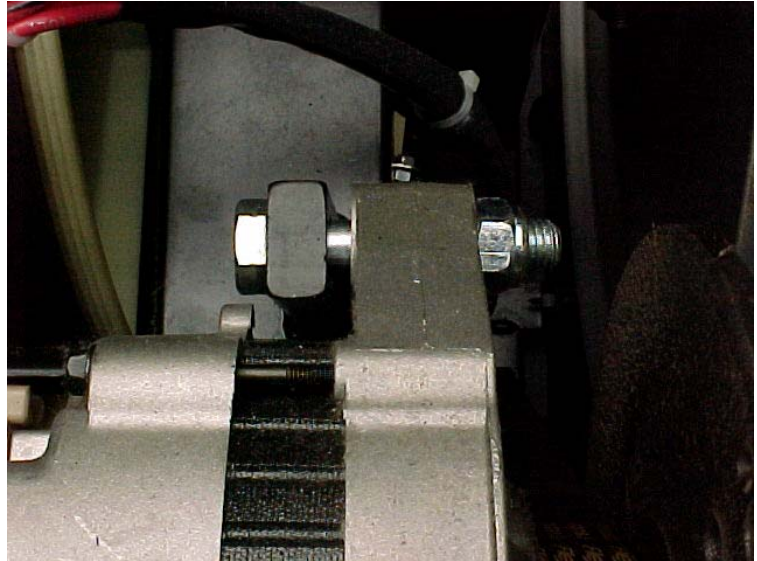

4. Use the 5/16 hex bolt supplied in the kit and with the existing Alternator Mounting bolt, fasten the Shroud Support Bracket to Alternator and tighten the bolts.

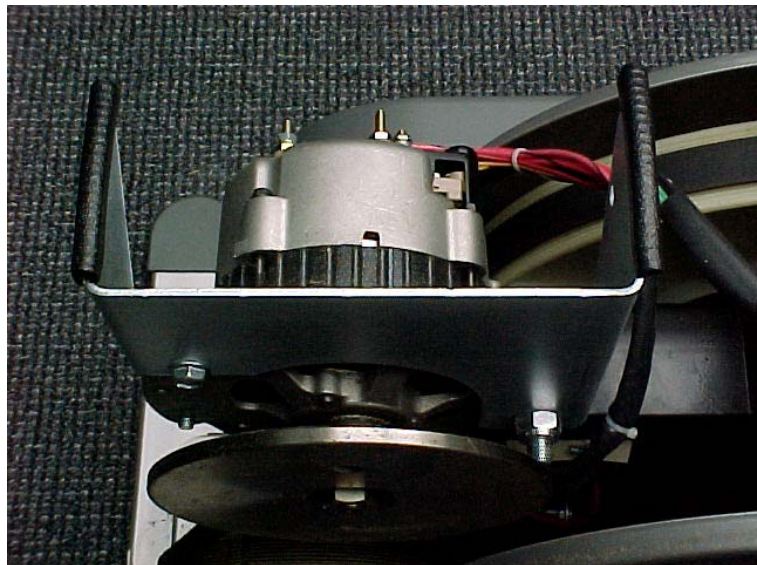

Use top  
hole on  
Alternator  
to mount  
Support  
Bracket



5. Clean inside surface of shrouds around each set of locking tabs using the Wet Pad portion (Alcohol wipe), and then open the Dry Pad portion to wipe the area dry.



6. Install the adhesive tape around each locking tab as shown.
7. Re-install the Main Shrouds.

