

LENOXX

MODEL: BT9377

USER MANUAL





WARNING: TO AVOID THE DANGER OF FIRE OR ELECTRIC SHOCK, DO NOT EXPOSE THIS APPLIANCE TO RAIN OR MOISTURE. NEVER OPEN THE CABINET, AS DANGEROUS HIGH VOLTAGES ARE CONTAINED INSIDE. ONLY A QUALIFIED SERVICE TECHNICIAN SHOULD ATTEMPT TO OPEN THE CABINET.

CAUTION:

This equipment generates, uses and can radiate radio frequency energy, if not installed and used in accordance with the instructions, may cause harmful interference to radio communication. However, this is no guarantee that interference will not occur in a particular installation. If this equipment does cause harmful interference to radio or television reception, which can be determined by turning the equipment off and on, the user is encouraged to try to correct the interference by one of the following measures;

- Reorient or relocate the receiving antenna
- Increase the separation between the equipment and receiver
- Connect the equipment in to an outlet on a circuit different from that to which the receiver is connected
- Consult the dealer or an experienced radio/TV technician for help

PROTECT YOURSELF!

Record the model and serial numbers for this unit while it is easy to see them. These numbers are located on the back of the unit's cabinet. Retain this information for future reference.

Retain this information for future reference.

CAUTION RISK OF ELECTRIC SHOCK DO NOT OPEN

CAUTION: TO REDUCE THE RISK OF ELECTRIC SHOCK, DO NOT REMOVE COVER (OR BACK).

THERE ARE NO USER SERVICEABLE PARTS INSIDE. REFER SERVICING TO QUALIFIED SERVICE PERSONNEL

Charging function: Equipment charging time of 8 hours

Max run time on a full charge: 2 – 3 hours depending on the volume of the unit. The louder the unit/use of flashing lights will use more battery power then use with lower volume and no flashing lights.

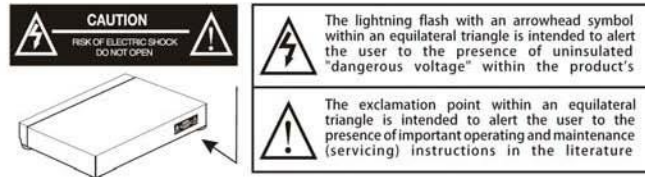

WARNING: DO NOT EXPOSE THIS APPLIANCE TO RAIN OR MOISTURE, DUE TO THE HIGH RISK OF FIRE OR ELECTRIC SHOCK, DO NOT OPEN THE CABINET. DANGEROUS HIGH VOLTAGES ARE PRESENT INSIDE THE ENCLOSURE. ONLY QUALIFIED SERVICE PERSONNEL SHOULD ATTEMPT THIS.

Portable speakers

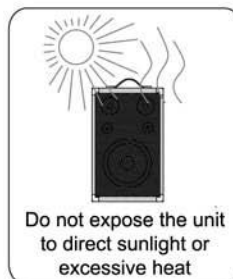
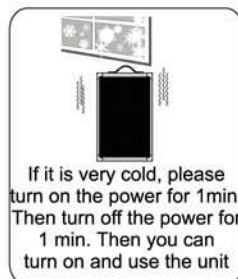
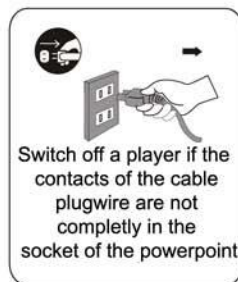
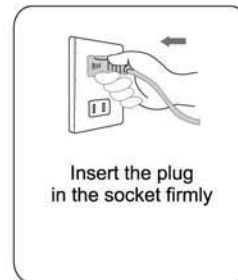
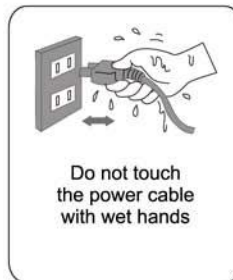
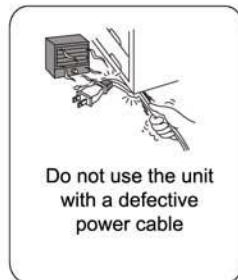

PAGE 4

This item is portable speaker system, with USB/SD card play function, AUX in, FM radio, Bluetooth. It includes 1 x wireless microphone, a built in 12V/8ah rechargeable battery and wheels and carry handle for easy transportation.

Products Features:

Power input: 188

WSensitivity: 700MV

Frequency range: 62-16KHz

Voltage range: 100-240V AC 50HZ

You have the choice to operate the unit on AC or DC power. Please use the switch at the front of the unit to select AC or DC operation. Before using DC operation, please ensure the battery is charged.

FLASHING LIGHTS: This unit features flashing lights which will come on when the music volume level is turned higher. The louder the music the brighter and more the lights will flash. Please note: the louder the music and flashing lights combined will use more battery then lower music volume and no flashing lights.

USB/SD CARD: connect the USB flash stick or insert an SD card into the card slot. Use the mode button on the unit or remote control to change the mode to USB/CARD mode. When the correct mode has been selected, you can then use the backward, play/pause and forward controls on the unit/remote control for music playback.

AUX: To connect an AUX in device such as an MP3 player/mobile phone using it's earphone socket, connect it to the AUX IN port at the rear of the unit using the 3.5mm AUX in lead which is included.

To connect an AUX in device (EG: DVD player) to the back of the unit, using an RCA lead which is not included.

Use the mode button on the unit or remote control to change the mode to AUX mode. When the correct mode has been selected, you can then use the backward, play/pause and forward controls on the unit/remote control for music playback.

AUX in port on the front of the unit: use with a 3.5mm AUX in lead with a 3.5mm jack on each end – not included.

FM RADIO: Use the mode button on the unit or remote control to change the mode to FM mode.

Hold the PP/SCAN button on the remote control, it will auto search though all FM radio stations and auto store the FM radio station in range.

The unit can store a maximum of 30 stations; the number stored will depend on the quantity available in range.

Press the PREV and NEXT buttons on the remote control to change the stations which have been auto stored.

The numerical buttons on the remote control can be used to select a stored radio station to play.

BLUETOOTH: Use the mode button on the unit or remote control to change the mode to USB/CARD mode.

Access your devices Bluetooth settings and pair your device to the unit. The Bluetooth pair name is "BK03"

When the correct mode has been selected, you can then use the backward, play/pause and forward controls on the unit/remote control for music playback.

ADJUSTMENT:

VOLUME: You can adjust the volume on the unit using the VOLUME knob on the unit or the VOL+ and VOL- buttons on the remote control.

GRAPHIC EQUALISER: use the controls to adjust the equalizer during music playback.

EQ: You can adjust the equalizer on the unit using the EQ button on the unit or remote control. There are 5 different EQ effects.

Press the EQ button repeatedly to change between the effects.

MICROPHONE EFFECT: use the MIC ECHO and MIC VOLUME controls on the unit to adjust the mic volume and echo when using a connected or wireless microphone.

GUITAR EFFECT: use the GUITAR VOL control on the unit to adjust the guitar volume when using the guitar input.

BASS AND TREBLE: use the bass and treble controls on the unit to adjust the bass and treble during music playback.

Frontpanel:

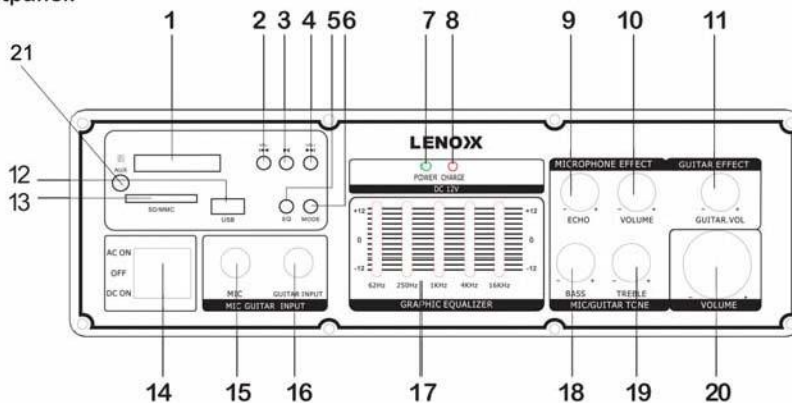

- | | |
|--|------------------------------|
| 1.LED DISPLAY | 11,Guitar volume adjust ment |
| 2,MP3 backward button | 12,USB slot |
| 3,MP3 pause/play button | 13,CARD slot(SD/MMC) |
| 4,MP3 forward button | 14,power switch |
| 5,E Q BUTTON | 15,MIC input |
| 6,MODE (USB/CARD/FM/AUX/BT/switch)button | 16.Guitar input |
| 7,power light | 17,E Q volume adjust ment |
| 8,charge light | 18,bass adjust ment |
| 9,MIKE echo adjust ment | 19,treble adjustment |
| 10,MIKE volume adjust ment | 20,Main volume adjust ment |
| | 21, AUX in port |

Remote control

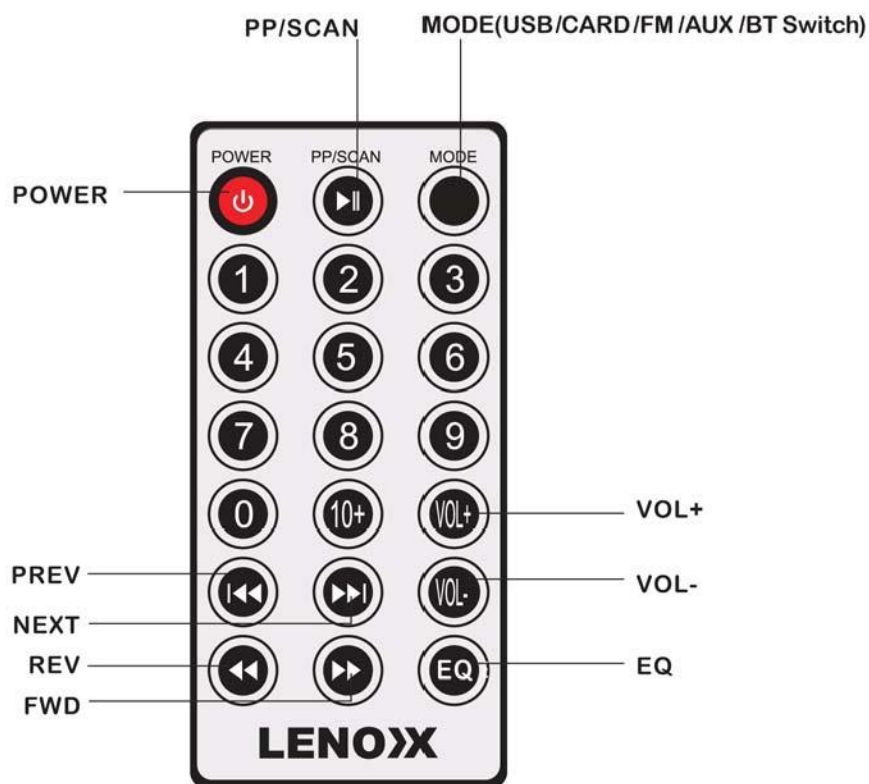

Battery installation

Remove the cover of the battery compartment of the remote control according to the diagram on the right.

Step 1: Press the ridged area rightward.

Step 2: At the same time, pull the battery tray out.

Step 3: Place a CR2025 lithium battery on the tray with the positive side facing upward.

Step 4: Replace the cover.

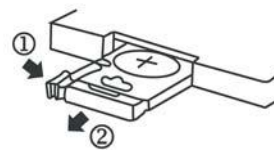

Remote control

Back panel silk screen:

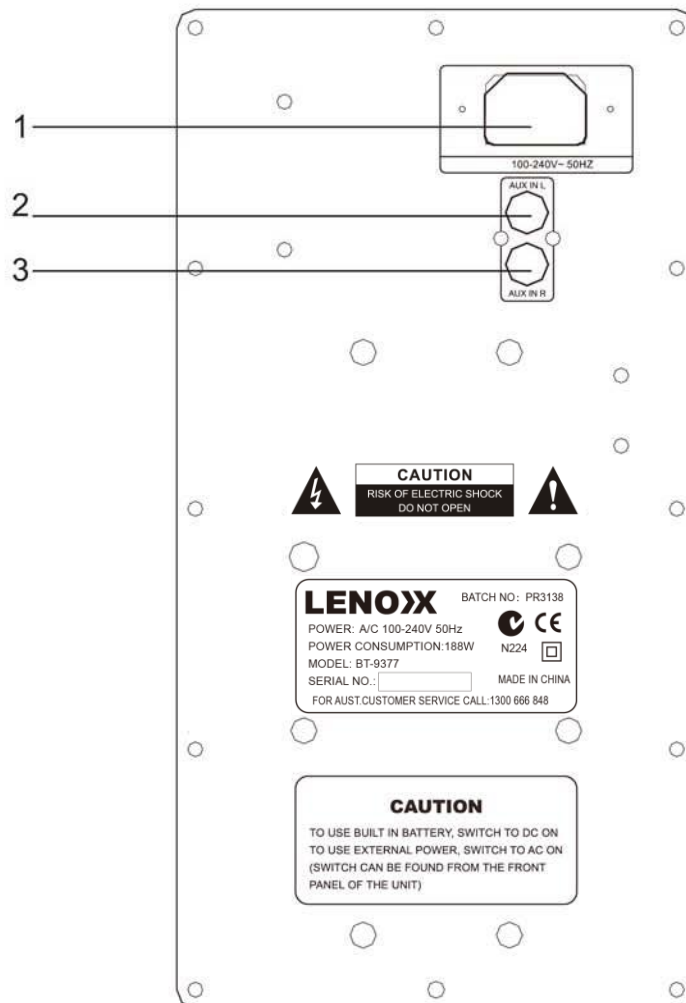

1. AC power in
2. AUX in external audio input L
3. AUX in external audio input R

Accessories included:

- 1 x wireless microphone
- 1 x remote control
- 1 x 12V/8ah rechargeable battery fitted inside the unit
- 1 x AUX in lead

LENOXX

Lenoxx Electronics Aust. Pty Ltd
Importers and Wholesalers of Electronics and toys
6 Oban court, Laverton North. Victoria. 3026
ABN: 97 844 321 851
PH: 03 9267 2100
FAX: 03 9267 2199
For service call: 1300 666 848
Email: lenoxx@lenoxx.com.au
www.lenoxx.com.au