

SANYO Service Corporation

Basement, Solid House Building
2285 Don Chino Roces, Avenue, Ext.
Makati City, Philippines
Tel. No.: (632) 8921493
Tel./Fax No.: (632) 8921260
Website: www.sanyo.com.ph

PLACE
STAMP
HERE

Note: Please enclose clearly the address of the nearest service center at your area

<p>*Quezon City Sanyo Service Corporation, Quezon City Branch 137-A Roosevelt Avenue, SFDM, Quezon City Tel. No. (02) 414-9647/032-374-1349</p>	<p>*Dagupan Sanyo Service Corporation, Dagupan Branch #1 Pinkie's Bldg. Zamora cor. Gomez St., Dagupan City, Pangasinan Tel./Fax (075) 522-0254</p>	<p>*San Fernando Sanyo Service Corporation, San Fernando Branch CER-HL, Subd. Mc Arthur Highway San Fernando City, Pampanga Tel./Fax: (045) 860-4252</p>	
<p>*San Pablo Sanyo Service Corporation, San Pablo Branch 175C Brgy. San Rafael, San Pablo City, Laguna Tel./Fax: (049) 562-0666</p>	<p>*Naga Sanyo Service Corporation, Naga Branch Door #8 Bldg. I Puritan Land Dev't Corp. Branch Ave. (formerly Diversion Road) Naga City Tel. No. (054) 472-3650 Fax No. (054) 811-1601</p>	<p>*Cebu Sanyo Service Corporation, Cebu Branch PO 238 Lopez Jaena St., Tipolo Manduae City Cebu City Tel. No. (052) 346-8048 Fax No. (052) 346-0471</p>	<p>*Iloilo Sanyo Service Corporation, Iloilo Branch D'Appliance Arcade, South Fundidor Molo, Iloilo City Tel. No. (033) 336-8698 Tel. / Fax (033) 337-1313</p>
<p>*Tacloban Sanyo Service Corporation, Tacloban Branch #35 T. Claudio St., Tacloban City Tel./Fax (053) 321-6212</p>	<p>*Davao Sanyo Service Corporation, Davao Branch San Juan Realty Bldg., KM7, Laming, Davao City Tel. No. (082) 300-6586 Tel. / Fax (082) 300-8381</p>	<p>*Cagayan De Oro Sanyo Service Corporation, Cagayan De Oro Branch Door 1, True Value Bldg., Lapasan St., Cagayan De Oro City Tel. No. (088) 231-4628 / Tel. / Fax (08822) 7244-82</p>	

DETACH AND RETAIN THIS PORTION - RETURN ABOVE

SANYO Service Corporation

Basement, Solid House Building 2285 Don Chino Roces, Avenue, Ext. Makati City, Philippines
Call center : (632) 8921493 Fax No. : (632) 8921260
Website: www. sanyo. com. ph

Warranty Exclusion

- Frames and plastic parts damage caused by improper handling of the buyer.
- Transportation to and from the service center and installation are excluded and shall be the responsibility of the customer.
- The warranty does not cover accident, fire, flood and other acts of God, from use with voltages beyond the allowable voltage range of 187-250 V, damage caused by misuse or failure to follow instruction stated in the user's manual, improper handling or force majeure, improper installation, unauthorized repairs and units which have been repaired or tampered with by persons other than the SANYO Service Corporation's authorized technicians.
- This warranty is valid only on the product purchased and used in the Philippines.
- This warranty is neither assignable nor transferable.

Owner's Copy

CLEANING THE FROST

INSTRUCTIONS FOR DEFROST

For the most efficient operation of refrigerator with the minimum electric energy consumption, defrost freezing compartment whenever evaporator is frosted/iced about 5 mm (1/4 inch) thick. During defrosting, Tray chiller must be in place to catch melted water and frozen foods and/or ice cube trays must be removed from freezing compartment.

REMOVING THE FROST

- Clean the outer parts, the inside parts and all accessories with water, then rub them with soft clothes until dry.
- After the melting process has finished, drain the water on the tray chiller which is located under the evaporator, and clean it.
- Reinstall all accessories that have been cleaned into their own places.

NOTICE

- When defrosting, make sure that the tray chiller placed at the right position, so the melting ice will not flood into the room.

- Do not use sharp tools object made of steel like a knife or a screwdriver to clean the evaporator in the freezer room because they may damage the refrigerator.

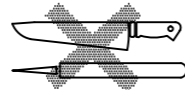

- Clean the frost clinging to the evaporator (it must always be clean) so that it will not disturb the performance of the freezer.

NOTICE

When the unit is switched off, you have to wait 5 minutes before turning it on again because this unit is equipped with Special Thermostat Control Device (PTC). The unit will not work if you try it before 5 minutes.

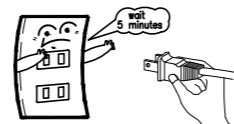

-8-

MAINTENANCE

INSTRUCTIONS FOR MAINTENANCE

To make the operation of the refrigerator always in a clean situation, regular cleaning should be done.

NOTICE Remove the power cord carefully as sometimes it may cause electric shock.

- Use soft clothes, sponge for cleaning.
- It will be better if we use warm clothes or warm water which is usually used for washing the dishes. Clean especially the very dirty parts.
- After cleaning it with warm water and dishwashing sponge, dry it with soaked clothes and dry the refrigerator.

NOTICE

- The followings must not be used :
The items like detergent powder, gasoline, thinner alcohol, hot water, acid, palm fiber, brush, etc.
They may scratch the paint surface and damage the plastic materials.

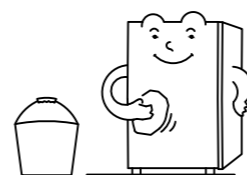

LAMP REPLACEMENT

No need to remove cover lamp In lamp replacement. If the illuminating does not work properly, in case of the replacement lamp is need, it will be better if it replaced by Sanyo service centers or similarly qualified person in order to avoid a hazard.

PROCEDURE :

- Open the door evap, by pushing out the lower pin until it off, using (-) screwdriver.
- Take off the screw on the lower left and right side of frame evap.
- Remove the frame evap by pushing it to the back, pull it down slowly until the upper pin off, then pull it slowly to the front.
- Take off the lamp on the right side by turning it clock wise.
- Change the bulb with 240 V 10W 12E characteristic.
- Put back the frame evap by following the procedure above in otherwise.

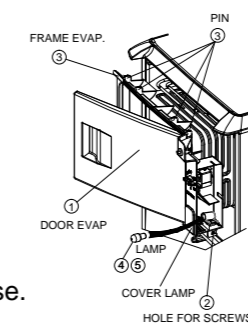

Notice : Make sure the 1,2,3 procedure are being done correctly.

WHEN REPLACING THE INSIDE LAMP

- NOTICE**
- Before replacing the lamp, unplug the power cord.
 - It may cause electric shock.

-9-

AT THIS CONDITIONS

WHEN EXPERIENCING A POWER FAILURE

- Try to open and close the door as few as possible.
- Put ice cubes on the food refrigerated.

POWER CORD DAMAGE

- If the supply cord is damaged, it must be replaced by the serviceman, or similarly qualified person in order to avoid hazard.

WHEN THE REFRIGERATOR IS NOT IN USE FOR A LONG TIME

- CAUTION**
- Always unplug the power cord.
 - Deteriorated insulation may cause electric shock fire or short circuit.

- When the inside part has been cleaned, open the door for 2 or 3 hours and let them dry (to prevent bad smell).

WHEN MOVING OR LIFTING THE REFRIGERATOR

- Unplug the power cord.
- Remove the food ; drain the water on the tray chiller.

- CAUTION**
- Lift the refrigerator properly at the up-rear and front-bottom parts of the refrigerator by 2 persons. Slippery hands may cause wound.

WHEN MOVING

- When the refrigerator is lifted to the truck, do not slant it because it will be damaged.
- After the refrigerator has been moved, wait about 20-30 minutes before it is operated.

WHEN DISCARDING THE REFRIGERATOR

- CAUTION**
- To make the door can not be closed, remove the door packing.
 - Do not discard it in the playground.
 - It is dangerous if the children go into the refrigerator and trapped inside.
 - The insulation blowing gas use in this appliance is flame - able, so do not dispose in a place where there is flame to avoid accidents and fire.

-10-

PUBLIC INFORMATION

Hot-line design

With the refrigerator in operation, it is possible that the housing will feel warm at the front edges. This does not indicate trouble. It is attributable to the hot-line design adopted for this refrigerator which consists of piping hot gas from the (motor-driven) compressor along the front edges of the housing and the center partition to prevent dewing. This has nothing to do with the storage temperature inside. (The broken line indicates the hot-line)

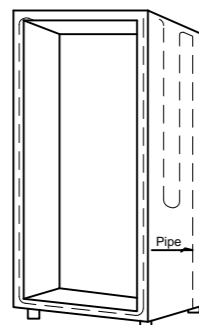

Moisture develops on the cabinet

If hot muggy days continue for sometime or if not installed in an appropriate place, moisture may develop. This is the same principle as water developing around a cold glass of water. It is not an abnormal condition. wipe off with a dry cloth.

A period to vacation

If you plan for a long vacation, it is advisable not to operate the refrigerator. Unplug the power cord, remove all food stuff, clean the interior and let the refrigerator open to prevent bad smell.

Power failure

Mostly power failure occurred in one or two hours, this will not affect temperature in refrigerator as long as you lessen door opening. Putting of ice is suitable in maintaining cold temperatures inside the refrigerator.

-11-

SPECIAL INFORMATION

SPECIFICATIONS

MODEL	SR-S155SBP-H
Internal Volume	126 l
Insulation Blowing Gas	Cyclopentane
Refrigerant	HFC-134a
Refrigerant Charge	55 g
Voltage	230 Va.c.
Frequency	60 Hz
Current	0.61 A
Power Input	70 Watt
Net Weight	23.5 kg
Class	T
Rated Maximum Input of Lamp	10 W

TIPS

The following may decrease / economize the energy consumption :

- Do not open or close the door frequently.
- Do not store too many foods or drinks (full).
- Avoid placing the refrigerator next to heat sources or being exposed to direct sunlight.
- When opening or closing the door, do it quickly and briefly.
- Avoid putting hot foods or hot drinks to the refrigerator.
- Avoid positioning the temperature controller to the maximum position (Number 6 - 7).

-12-

TROUBLESHOOTING

(BEFORE CALLING UP SANYO SERVICE CENTERS)

When your refrigerator does not work properly or has been used for a long time, before calling up the serviceman, check several possible causes as follow :

PROBLEMS	POSSIBLE CAUSES AND SOLUTIONS
The refrigerator doesn't work or totally not cool	<ul style="list-style-type: none"> Is there any problem with the power supply? Is the fuse broken? Does the plug connect properly to the socket?
The refrigerator is Not so cool	<ul style="list-style-type: none"> The temperature is NOT set into an appropriate position. The refrigerator is attached to the wall or next to heat sources. Is there something hot stored in the refrigerator ? The refrigerator door does not close tightly. The refrigerator opens too long. Too many foods are kept in the refrigerator. The evaporator is filled up with too much frost.
The sound of the refrigerator is abnormal	<ul style="list-style-type: none"> The refrigerator is placed on weak or uneven floor. Something is left at the back side of the refrigerator. The things stored in the refrigerator are too close to each other.
There is condensation on the frame surface or drops of water in the refrigerator	<ul style="list-style-type: none"> Is refrigerator placed in a wet or damp surface? Is the door not tightly closed or there is a gap in it? Is there any hot food or food containing water which is not properly wrapped?
The electric current creeps outside the body of the refrigerator	<ul style="list-style-type: none"> Is there any un-shelled power cord cable? There is an electrical induction effect so that the refrigerator should have a ground cable.

NOTICE

Do not allow unauthorized service officer to repair the refrigerator as it may cause fire. Even though it works normally, you may hurt yourself.



SANYO
SANYO Electric Co., Ltd.
Made in Indonesia

6MP6P10010205

-13-

SANYO Service Centers



LIST OF SANYO SERVICE CORPORATION NATIONWIDE

METRO MANILA

***Head Office**
Sanyo Service Corporation (Head Office)
Basement, Solid House Building 2285 Don Chino Roces Ave., Ext. Metro Manila
Tel. No. (02) 892-1493
Tel./Fax No. (02) 892-1260

***Quezon City Branch**
Sanyo Service Corporation, Quezon City Branch
137-A Roosevelt Avenue, SFDM, Quezon City
Tel. No. (02) 414-9647
Tel. No. (02) 374-1349

LUZON

***Dagupan City Branch**
Sanyo Service Corporation, Dagupan Branch
No. 3 Pinkie's Bldg. Zamora cor. Gomez St., Dagupan City, Pangasinan
Tel./Fax (075) 522-0254

***San Fernando Branch**
Sanyo Service Corporation, San Fernando Branch
CER-HL, Subd. Mc Arthur Highway
San Fernando City, Pampanga
Tel./Fax: (045) 860-4252

***San Pablo City Branch**
Sanyo Service Corporation, San Pablo Branch
175C Brgy. San Rafael, San Pablo City, Laguna
Tel./Fax: (049) 562-0666

***Naga City Branch**
Sanyo Service Corporation, Naga Branch
Door #8 Bldg. I Puritan Land Dev't Corp. Roxas Ave.
(Diversion Road)
Tel. : (054) 472-3650
Fax. : (054) 811-1601

VISAYAS

***Cebu Branch**
Sanyo Service Corporation, Cebu Branch
PO 238 Lopez Jaena St., Tipolo Manduae City
Tel. No. (032) 346-8048
Fax No. (032) 346-0471

***Iloilo Branch**
Sanyo Service Corporation, Iloilo Branch
D'Appliance Arcade, South Fundidor Molo, Iloilo City
Tel. No. (033) 336-8698
Tel./Fax (033) 337-1313

***Tacloban City Branch**
Sanyo Service Corporation, Tacloban Branch
No. 35 T. Claudio St., Tacloban City
Tel./Fax (053) 321-6212

MINDANAO

***Davao**
Sanyo Service Corporation, Davao Branch
San Juan Realty Bldg., KM7, Laming, Davao City
Tel. No. (082) 300-6586 Tel./Fax (082) 300-8381

***Cagayan De Oro City Branch**
Sanyo Service Corporation, Cagayan De Oro Branch
Door 1, True Value Bldg., Lapasan St.,
Cagayan De Oro City
Tel. No. (088) 231-4628 Tel./Fax (08822) 7244-82

SANYO

SANYO (Philippines), Inc.
Basement Solid House Building
2285 Don Chino Roces, Avenue, Ext.
Makati City, Philippines
Website: www.sanyo.com.ph