

NEC MultiSync® EX Series

Ultra-slim, LED-backlit desktop LCD monitors ideal for corporate environments



Maximize the space and eco-friendliness of your work environment. The NEC MultiSync EX Series, featuring ultra-slim, full HD LCD monitors, sets the bar for “green” displays. The 23” MultiSync EX231W and EX231Wp feature a handful of components that lower total cost of ownership by saving energy, tracking carbon footprint emissions and minimizing packaging. In addition, these are our lightest, thinnest and most ergonomically designed models to date; and boast outstanding screen performance and advanced display technologies to optimize your desktop computing productivity.

It’s easy to be green. The MultiSync EX Series uses LED backlighting, which optimizes energy efficiency. Compared to conventional LCDs, these models consume up to less power overall, radiate less heat, use less packaging, weigh less, utilize recycled plastics in their production and are free of hazardous materials such as mercury and arsenic. Other eco-friendly benefits include ECO Mode™ and auto brightness for further energy savings, a resettable carbon footprint meter for tracking the conservation of green gas emissions, and a significant reduction in packaging materials.



The EX Series’ human and ambient light sensors (L) automatically detect your work conditions to determine the proper display brightness, thereby conserving power (up to 94%). Touch-sensitive OSD® controls (R) are integrated into the bezel, making display adjustments easier than ever.

Features & Benefits

Minimalist design, featuring an ultra-thin bezel width (14.6mm) and depth (16.4mm), puts the focus on the screen vs. the cabinet

LED backlight technology provides for industry-leading low power consumption and less hazardous materials

Height-adjust, pivot, tilt and swivel capabilities add flexibility and comfort to your viewing preferences

XtraView® technology provides for some of the widest viewing angles available

Human sensor monitors the presence of a user in front of the display and can go into power saving mode if the user leaves

Ambient light sensor minimizes power consumption by automatically adjusting the brightness to the optimal setting depending on ambient lighting, screen content or both

ECO Mode allows you to manually adjust the display’s brightness to two preset settings, saving more power and reducing your energy costs

Intelligent Power Manager (IPM) system and off timer provide innovative power-saving methods and reduce CO₂ emissions by shifting to a lower power consumption level or automatically powering down when the monitor is on but not in use

Carbon footprint meter helps track and calculate the conservation of green gas emissions via OSD and NaViSet™ Administrator

6-preset Dynamic Video Mode enhances video and images with real-time optimization of brightness, color and contrast

Compact packaging helps reduce paper usage, shipping costs and waste

EPEAT Gold compliance ensures the displays reduce hazardous waste and electricity usage, resulting in lower energy costs and increased protection for the environment

ENERGY STAR 5.0 compliance reduces electrical costs and lowers total cost of ownership

The MultiSync EX Series features a 4-way ergonomic stand with capabilities of pivot (A), height-adjustment (up to 110mm) (B), tilt (C) and swivel (D), allowing you to create an ideal ergonomic display orientation for maximum viewing comfort.

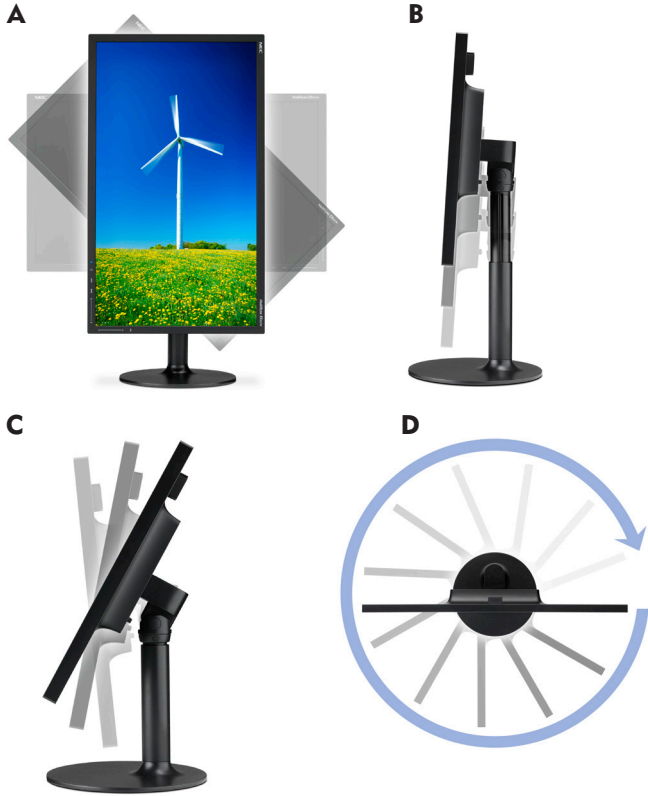

For simple transport, a quick release lever (E) allows you to quickly and easily remove the display from the stand, while the built-in recessed handle (F) helps avoid damage to the bezel and screen while carrying.

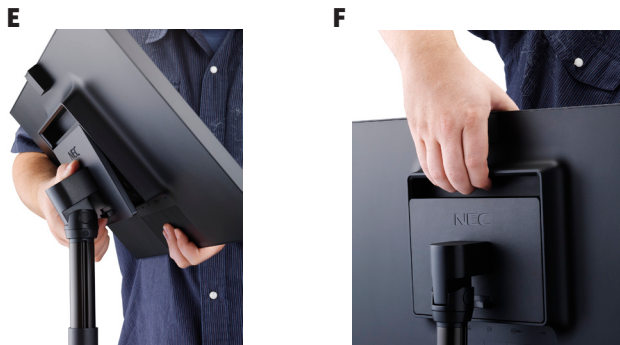

A top-mounted USB pass-through (G) allows for the easy addition of a webcam, microphone or other peripherals. The input panel (H) includes a second USB pass-through as well as a mini-AC adapter, and DisplayPort and DVI-I connections.

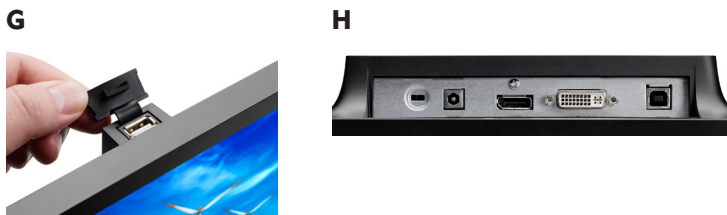

MODEL	EX231W	EX231Wp
LCD MODULE		
Viewable Size (Diagonal)	23"	
Aspect Ratio	16:9	
Panel Technology	TN	PVA
Native Resolution	1920 x 1080	
Pixel Pitch	0.265mm	
Pixels Per Inch	96	
Brightness (Typical)	250 cd/m ²	
Contrast Ratio (Typical)	1000:1	3000:1
Viewing Angle (Typical)	170° Vert., 176° Hor. (85U/85D/88L/88R) (CR > 5)	178° Vert., 178° Hor. (89U/89D/89L/89R) (CR > 5)
Response Time (Typical)	Rapid Response (5ms)	
Display Colors	More than 16.7 million	
SYNCHRONIZATION RANGE		
Horizontal	31.5-83 KHz	
Vertical	56-75 Hz	
INPUT SIGNAL		
Video	Analog 0.7 Vp-p / 75 Ohms	
Sync	Separate Sync: TTL Level (positive/negative)	
INPUTS		
DVI-I and DisplayPort		
ADDITIONAL FEATURES		
Auto brightness with ambient light sensor; Human sensor; USB pass-through; ECO Mode; Carbon footprint meter; Resettable cost meter; Integral power meter; Off timer; Ultra-thin frame; Tilt; Swivel; Pivot; Height-adjustable stand; Quick release stand; Carrying handle; Rapid Response; Ambix; XtraView; Touch-sensitive OSD user controls; NaViSet software; Cable management; VESA mount; HDMI-capable via DVI adapter; HDCP; DDC/CI; No Touch Auto Adjust; Plug and Play (VESA DDC 2B); VESA DPMS power management; Dynamic Video Mode; 6-preset color control system (EX231Wp); Digital smoothing; Digital controls		
POWER		
Voltage Rating	AC 100-120V / AC 220-240V	
Power Consumption (Typical)	31W	27W
Power Consumption (Savings Mode)	0.37W	
PHYSICAL SPECIFICATIONS		
Dimensions (with stand; WxHxD)	21.3 x 15.8-20.1 x 8.5 in. / 540.2 x 401.3-511.3 x 215mm	
Dimensions (without stand; WxHxD)	21.3 x 12.5 x 1.9 in. / 540.2 x 318.3 x 47.7mm	
Weight (with stand)	9.3 lbs. / 4.2 kg	
Weight (without stand)	6.2 lbs. / 2.8 kg	
VESA Hole Configuration	100 x 100mm	
ENVIRONMENTAL CONDITIONS		
Operating Temperature	5 - 35°C / 41 - 95°F	
Operating Humidity	20 - 80%	
Operating Altitude	2000m / 6562 ft.	
Storage Temperature	-10 - 60°C / 14 - 140°F	
Storage Humidity	10 - 85%	
Storage Altitude	12,192m / 40,000 ft.	
ACCESSORIES		
Included	Setup sheet; User manual; Power cord; DVI cable; USB cable; Audio cable	

Contact your representative for details.



MultiSync and XtraView are registered trademarks and ECO Mode and Rapid Response are trademarks of NEC Display Solutions. All other brand or product names are trademarks or registered trademarks of their respective holders. Product specifications subject to change. 5/11 ver. 1.

©2011 NEC Display Solutions of America, Inc. All rights reserved.

NEC Display Solutions
 500 Park Boulevard, Suite 1100
 Itasca, IL 60143
 866-NEC-MORE

