

## Film Scanner FS50

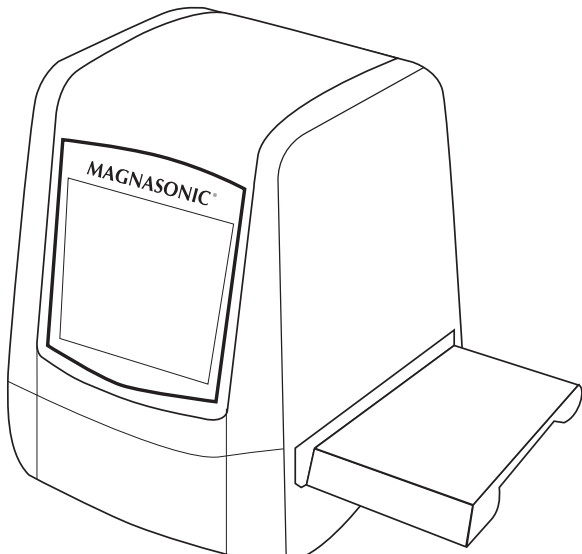

Thank you for your purchase of this Magnasonic product. Please read this instruction manual carefully before using product to ensure proper use. Keep this manual in a safe place for future reference.

## IMPORTANT SAFETY INFORMATION

### RETAIN THIS MANUAL FOR FUTURE REFERENCE

1. Read these instructions.
2. Keep these instructions.
3. Read all warnings.
4. Follow all instructions.
5. Do not use this product near water.
6. Clean only with a dry cloth.
7. Clean the screen only with a dry cloth, moistened slightly if needed. Do not clean the inside of this product.
8. Check that the power voltage stated on the rating label corresponds to your local electricity supply.
9. Do not block any ventilation openings. Install in accordance with the manufacturer's instructions.
10. Do not place this product near any heat sources such as radiators, heat registers, stoves or other apparatus (including amplifiers) that produce heat.
11. Do not immerse this product, the power cord or any accessories in water or any other liquid.
12. Unplug the power adapter from the wall when the product is unused for a long period of time and during thunderstorms.
13. Only use attachments / accessories specified by the manufacturer.
14. Unwind and straighten the power cord before use.
15. **Damage Requiring Service**  
Unplug the power cord and refer servicing to qualified service professional under the following conditions:
  - A. If liquid has been spilled on or into the product.
  - B. If the product has been exposed to rain, water, or other liquids.
  - C. If the product does not operate normally by following the operating instructions. Adjust only those controls that are covered by the operating instructions. Improper adjustment of other controls may result in damage and will often require extensive work by a qualified technician to restore the product to its normal operation.
  - D. If the product has been dropped or damaged in any way.
  - E. When the product exhibits a distinct change in performance. This may indicate a need for service.
16. **Serviceing**  
Do not attempt to service this product yourself as opening or removing covers may expose you to dangerous voltages or other hazards. Refer all servicing to a qualified service professional.
17. **Replacement Parts**  
When replacement parts are required, be sure the service technician has used replacement parts specified by the manufacturer, or have the same characteristics as the original parts. Unauthorized substitutions may result in fire, electric shock, or other hazards.
18. **Safety Check**  
Upon completion of any service or repairs to this product, ask the service technician to perform safety checks to determine that the product is in proper operating condition.
19. Caution marking is located at the back of apparatus.
20. The marking information is located on the bottom of apparatus.
21. Do not disassemble this product.
22. Stop using if there are any unusual problems with the scanner, such as smoke or an unusual smell, while using.
23. Do not clean the scanner with alcohol, gasoline, diluent and other organic solvent.
24. Please use films of standard size.
25. **Cleaning:** Please make sure the scanner is clean before using.
26. To save energy, the scanner will automatically shut down after 30 minutes of inactivity. Press the power button to turn back on.

## Table of Contents

<b>Important Safety Information .....</b>	<b>2</b>
<b>Retain This Manual For Future Reference .....</b>	<b>2</b>
<b>Foreword .....</b>	<b>4</b>
<b>Maintenance Matters .....</b>	<b>4</b>
<b>What's Included.....</b>	<b>4</b>
<b>Slide And Negative Holder Loading Method.....</b>	<b>5</b>
Loading Negatives .....	5
Install The Negative Method.....	6
Menu .....	7
Capture Picture .....	7
Operation Guide .....	9
How To Playback Captured Picture.....	10
Setting Language .....	11
Formatting.....	12
Connect To Computer .....	12
<b>Product Specification.....</b>	<b>13</b>
<b>Declaration .....</b>	<b>13</b>

## Foreword

Thank you for purchasing this product. Read this manual carefully before use, and save the instructions for future reference. Please use this product properly.

We reserve the right to change models, configuration, or specifications without notice or liability. Product may not be exactly as shown.

### Note:

*Do not disassemble this product by yourself.*

- **High temperature:** the product should be kept away from heat sources such as radiators/heaters.
- **Clean:** please keep the product clean before using it, so that the image clearly shows.
- **Non-use period:** when the product is not in use for a long period of time, remove the USB cable from your computer.
- **Scanning medium:** please use the standard film size, when scanning film.

## What's Included

- USB cable \* 1
- Negative holder \* 1
- Positive holder \* 1
- AC / DC adapter \* 1
- User Manual \* 1
- Cleaning brush \* 1
- TV cable \* 1
- 110 Film holder \* 1
- Super 8 holder \* 1

## Slide and Negative Holder Loading Method

### Loading Negatives

1. Hold up the negative toward the light.
2. Face the right side of the negative to yourself.
3. Take out negative holder out.
4. Let the side with "OPEN" face yourself, and let the side with "◀" logo face down.
5. Open the negative holder, then place negative into the holder.
6. Insert the negative holder into the slot on the right side of the film.

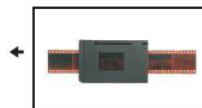
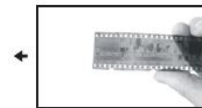

## Install The negative method

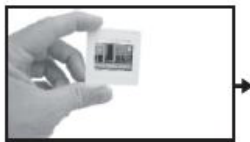

1. Hold up the slide toward the light.
2. Face the right side of the slide to yourself.
3. Take the slide holder out.
4. Let the side with "OPEN" logo face yourself, and let the side with "◀" logo face down.
5. Open the slide holder, then place slides into the holder (film can also be loaded as a strip into the slide holder).
6. Close the slide holder and press the edges so that it locks in place.
7. Insert the slide holder into the slot on the right side of the film scanner as shown.



Handle films with care to avoid scratches or finger prints (for the best results use cotton gloves when handling films) It is recommended to use compressed cotton to remove any dust on the films.

## Guide

### Menu



- |   |   |
|---|---|
| ① | ⑤ |
| ② | ⑥ |
| ③ | ⑦ |
| ④ |   |
- ① Film Type                      ⑤ Format  
② Resolution                    ⑥ USB MSDC  
③ Capture                        ⑦ Language  
④ Playback



### Capture Picture

1. Before scanning please make sure the inner backlight panel is clean.

#### Note:

You can use the provided brush to clean the screen.



2. In the Main Menu mode press **OK/ENTER** to enter capture mode. Then press **MODE** then press **OK/ENTER** to capture the picture.

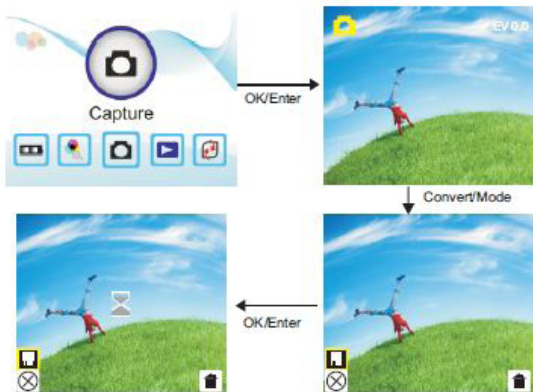

Before pressing **OK/ENTER** to capture picture, press the left button to mirror and press right button to flip the current picture. Press **OK/ENTER** button to set Exposure. Press the **CONVERT/MODE** button again back to main menu.

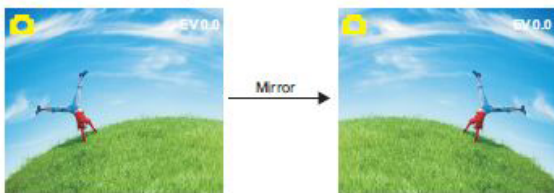

3. Press the left or right key, to Flip the image horizontally.





4. Press the right key, to flip the image vertically.



5. Press **OK/ENTER** to set exposure compensation

### Operation Guide

In the Main Menu, press , until you see . Then press **OK/ENTER**. You can choose **Negative** 110, 135, or 126KPK. You can choose **Slide**, 110, 135, 126KPK, Super8. You can also choose **B&W**, 110, 135, 126KPK.



## How to playback captured picture

In the Main Menu, press **OK/ENTER**, until you see . Press **OK/ENTER** the picture auto-playback mode press again to stop auto playback or you can view captured pictures manually by pressing , then pressing **OK/ENTER** again to enter picture editing mode. You can rotate, delete, and save images. Press "HOME" to get back to the Main Menu.

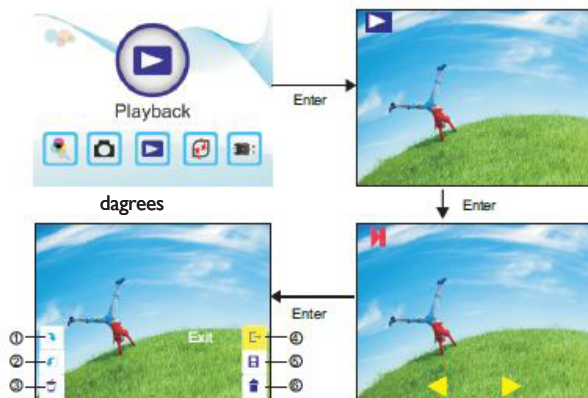

- The current picture rotates 90 degrees clockwise
- The current picture rotates 90 degrees counterclockwise
- Deleting the current image from memory card
- Exit the sub-mode edit mode, back
- Saving the current edit image
- Exit sub-menu edit mode, back to scan

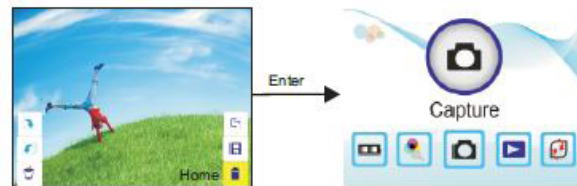

## Setting Language

Under the Main Menu mode press until you see . Then press **OK/ENTER** to chose a language. Then press and **OK/ENTER** to choose one of following 8 languages: English, French, Spanish, Simplified Chinese, Traditional Chinese, Japanese, German or Italian.





## Changing Resolution

Under the Main Menu mode, press until you see . Then press **OK/ENTER** to enter into Resolution Mode. You can choose 14M or 22M (interpolation).



## Formatting

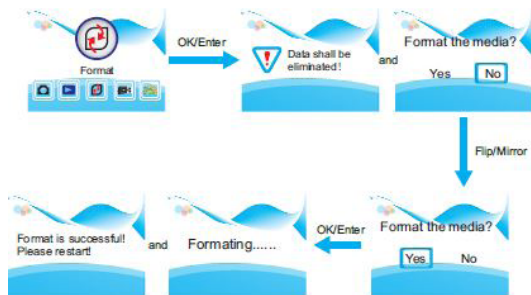

In the Main Menu, press  until you see , press **OK/ENTER** button to enter.



### Note:

After using this function, all information in the Micro SD card will be deleted.

## Connect to computer

Under the Main Menu mode   press until your see . Then press **OK/ENTER**. After successful connecting to computer, you can view and edit captured pictures.



## Product Specification

Function	Film scanner/USB MSDC
Interface	USB2.0
Image Sensor	14.0 Mega pixel, 4416*3312, 1/2.33" CMOS sensor
Display	Color 2.4TFT LCD
Exposure Control	Automatic / Manual (-2.0 EV~ +2.0EV)
White Balance	Automatic
Resolution	14.0 Mega pixels/ 22Mega pixels (Interpolation)
Film type	135 Film(36*24mm), 126KPK Film(27*27mm), Monochrome,Slide 110 Film(17*13mm), Super8 Film(4.01*5.79mm),
Picture Effects	B&W,Slides,Negatives
File format	Picture JPEG
TV-OUT type	NTSC/PAL
Built-in memory	128M
External memory card	SD card up to 32GB
Power Supply	DC 5V Adapter/ USB Port
Language	English/French/Spanish/Simplified Chinese/ Traditional Chinese/Japanese/German/Italian
Product Size	L87XW86.5XH102.5mm
Weight	250g

## Declaration

\*We reserve the right to change models, configuration, or specifications without notice or liability. Product may not be exactly as shown.

**NOTES**

**NOTES**



**[magnasonic.com](http://magnasonic.com)**