

BODY COMPOSITION ANALYZER

InBody230 Install Manual

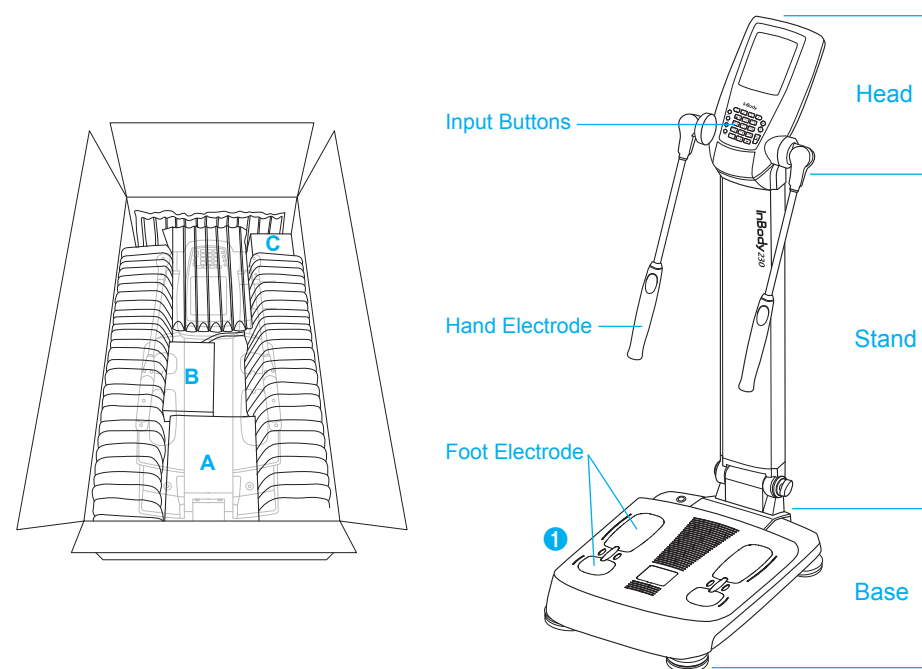

Contents of the Box

Basic

- 1 InBody230
- 2 Install Manual 1EA
- 3 User's Manual CD 1EA
- 4 Warranty
- 5 Adapter 1EA(DC 12V, 3.4A)
- 6 Power Cable 1EA

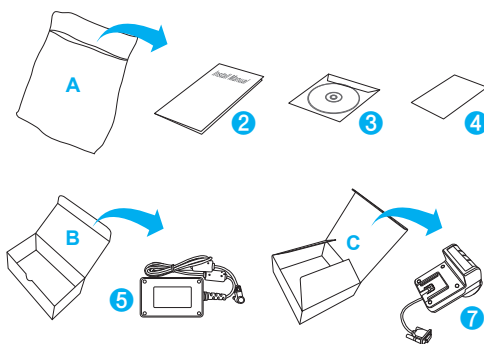

Optional

- 7 Thermal printer
- 8 SD400 Set
- 9 Result Sheet
- 10 Carrying Bag
- 11 InBody Tissue

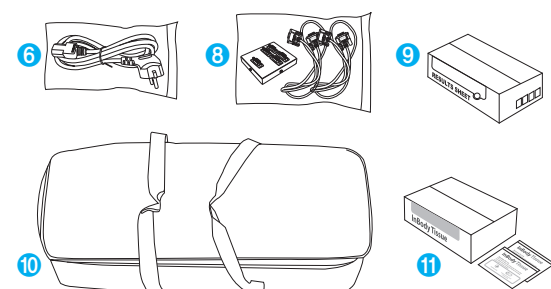

NOTE Please keep the packaging for future events of repacking InBody230 and sending it for servicing or otherwise transporting InBody230 elsewhere.

1. If you use the InBody230 on a carpet, static electricity may cause serious damage to the electronic components. If the InBody230 is to be installed on a carpet, use antistatic mats below the InBody230. Use InBody tissue to wipe feet and hands before the measurement starts.
2. Do not wipe the base and hand electrode with cleaning liquids. If cleaning liquids enter into InBody230, it may cause corrosion or electric shock by short circuit. For cleaning of the InBody230, please use InBody tissue, which also has antibacterial functionality.
3. Do not dismantle InBody230. Internal parts are not for customer use and may cause electric shock. If InBody230 is dismantled, the warranty is void, and service costs will be charged.

Installation

1. After opening the product box, please remove the accessories box and the center Air-cell cushion that is covering the InBody.

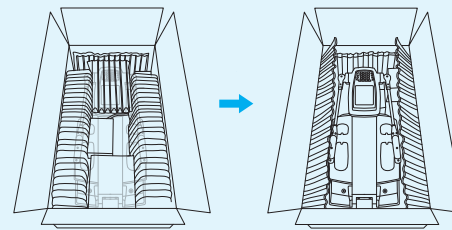

2. Carefully remove the InBody from the box and place the InBody230 horizontal to the ground. Raise the stand, lift the head, and slightly spread the arms.

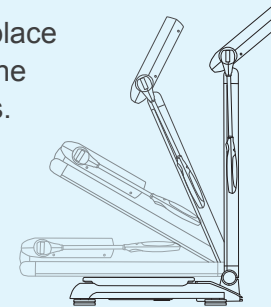

3. If the air bubble is not in the center of the level indicator, tighten or loosen the leveling screws(4EA) on the foot plate to adjust the level of InBody230. InBody230 must be leveled properly for accurate weight measurement.

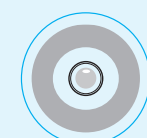

<Leveled state>

Level Indicator

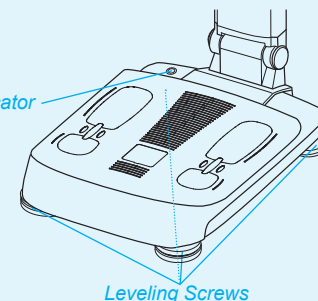

Leveling Screws

4. Plug the power adapter cable into the InBody230.

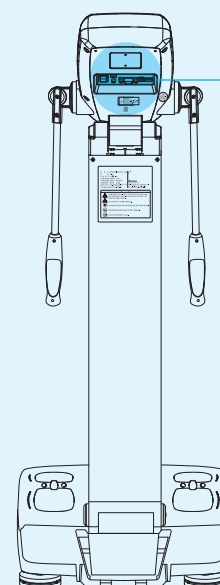

<Rear view of InBody230>

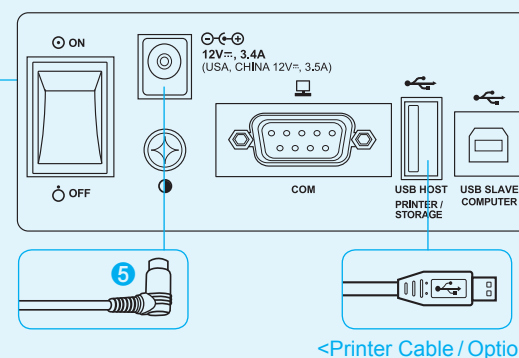

<Printer Cable / Option>

- * Make sure the power cord is firmly plugged into the power adapter.
- * Please plug the power cord and the printer power cord to an electrical outlet. A surge protector is highly recommended.

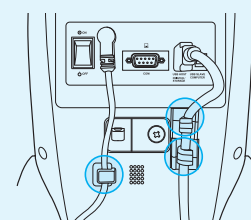
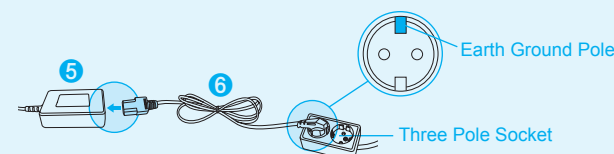

- * Please use the device after properly connecting the power and printer cables to the appropriate matching port.



Failure to connect the device to a properly grounded outlet may result in damage to the device, inaccurate measurement and/or inappropriate operation due to possible electrical surges.



Do not plug the device to a shared power source with any other electrical devices such as a treadmill, refrigerator, air conditioning unit, microwave or RF medical diathermies that can be affected by electromagnetic interference. It may result in inaccurate measurements.

Measurement

1. Turn on the InBody230 and keep the power on until the home screen initializes. It will take 15 seconds. During the warming, do not touch the base.

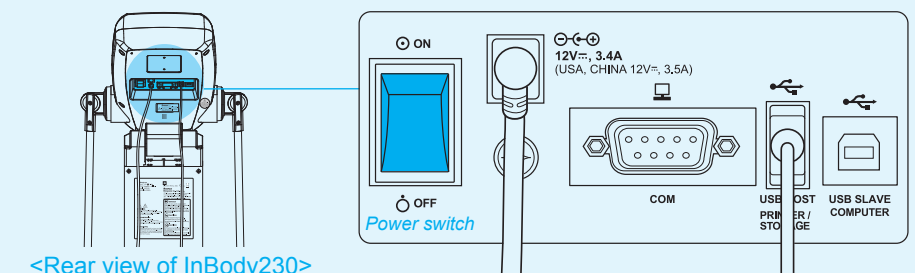

<Rear view of InBody230>

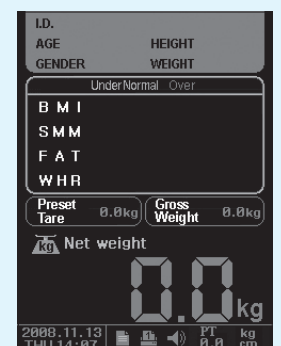
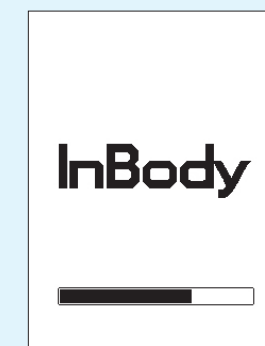

2. Step on the foot plate and measure weight.

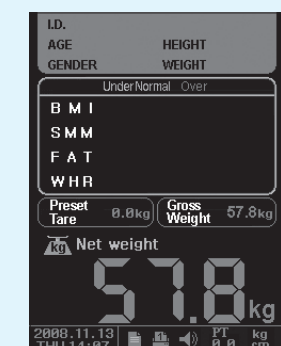

3. Enter your personal information and press "ENTER" button.

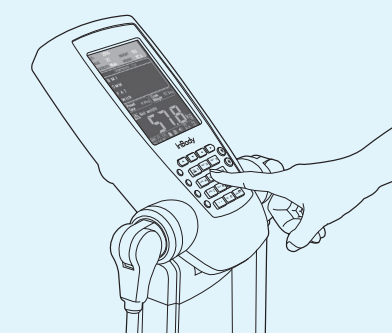

4. Grab the hand electrode and hold your arms slightly away from the torso.



5. Remain still during measurement and the test takes about 30 seconds.

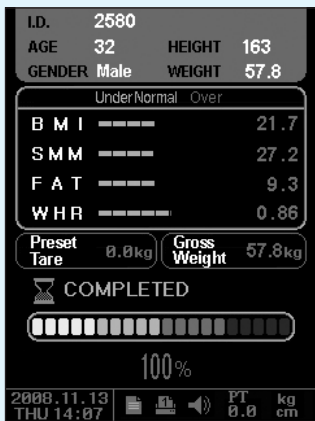
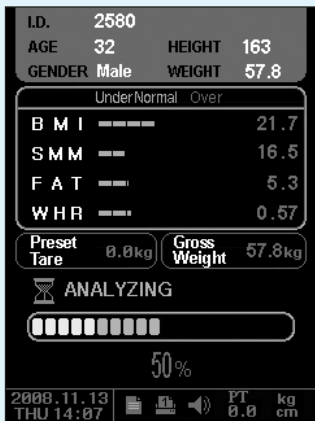

Proper Posture

Proper posture is essential to achieve reliable results and high reproducibility. Do not talk or move during the InBody test.

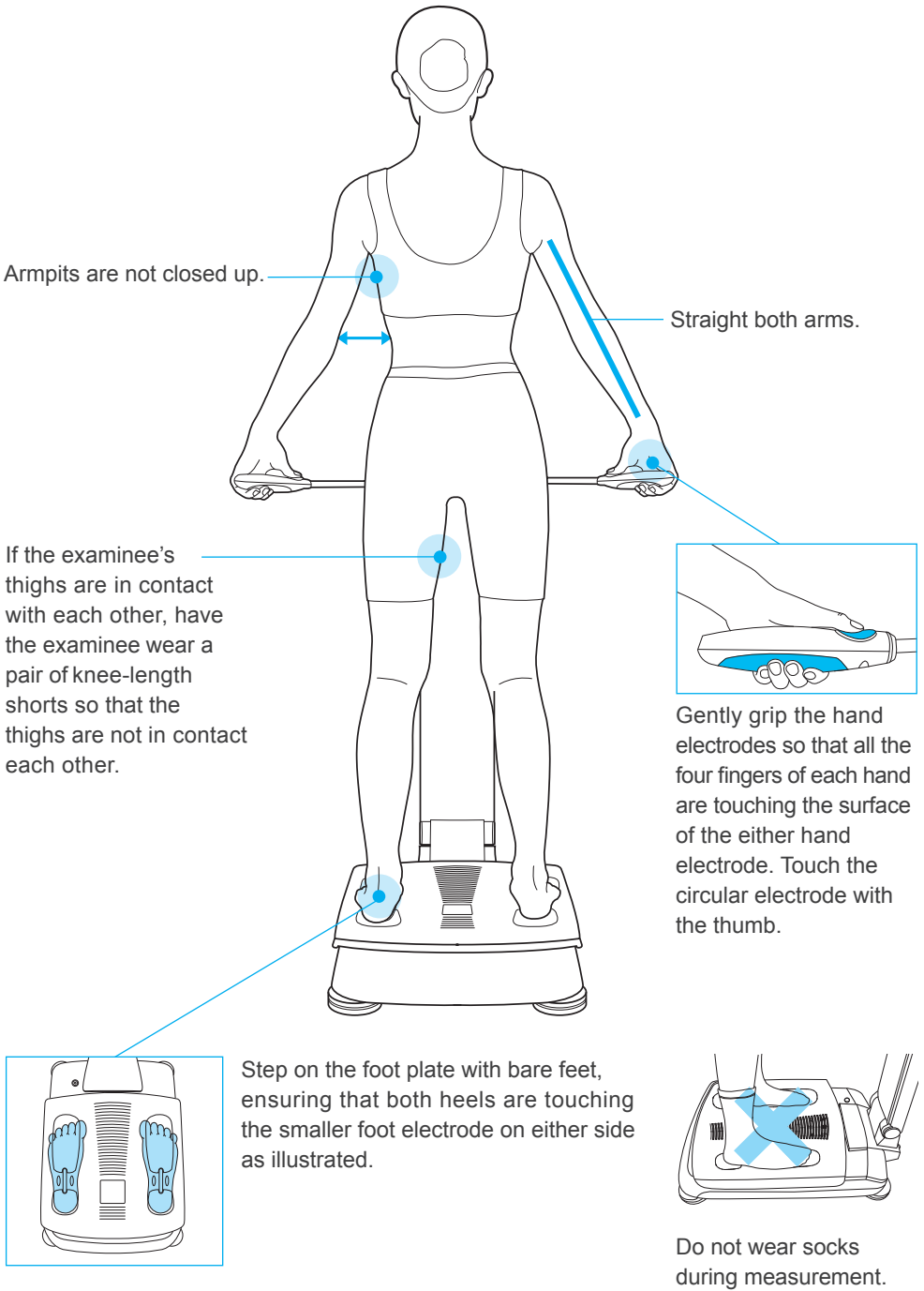

FAQs

Q1. I do not know how to configure the settings.
A. Use the left right buttons (◀, ▶) or number to select a category among Region, Printer, Result, Other and Interface. Then the selected item's sub-categories are displayed on the screen.

Q2. Can I use my printer?
A. There is a list of compatible printers. Please contact BIOSPACE or the local distributor.

Q3. I do not know why error messages are shown on the LCD.
A. The InBody230 displays an error message to alert the operator of problems and to recommend the correct action.

- Turn the InBody230 off and on again after removing the objects from the foot plate.
- If entered subject data are beyond acceptable ranges, this error message appears.
- A subject should wipe his/her soles and palms with wet tissue and try again.

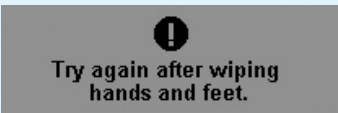
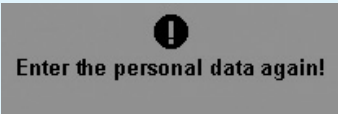
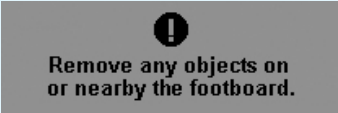

Q4. Where can I buy printer paper and other optional devices?
A. Please contact BIOSPACE or the local distributor.

Q5. How do I know the measurement taken is correct?
A. After taking the measurement, check the impedance at the bottom of the results sheet printed. The impedance value must decrease in the arrow direction.

Impedance

Z	RA	LA	TR	RL	LL
200k	476.8	514.6	31.7	324.0	324.7
100k	439.3	477.0	28.3	296.2	297.0

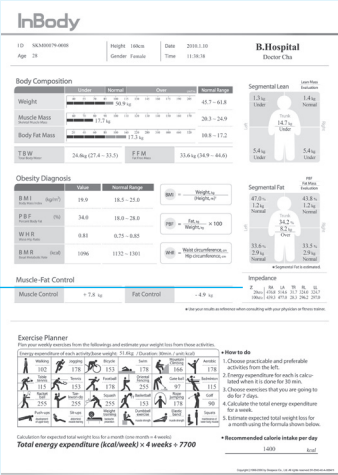

Cautions before Measurement

Do not use this equipment in combination with the following electronic medical devices.

- Medical devices, such as a pacemaker.
- Electronic life support systems, such as an artificial heart/lung.
- Portable electronic medical devices, such as an electrocardiograph.

Callouses on the palm or sole or particularly dry hands and feet may lead to difficulties in measuring. If this is the case, please wipe the palm and sole with an InBody Tissue before testing.

NOTE If you are using a printer, a result sheet will be printed automatically.

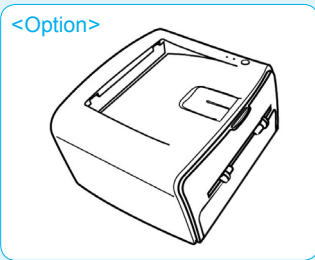

Q6. How do I clean hand/foot electrode?
A. For cleaning of hand/foot electrode, please use InBody tissue, which also has antibacterial functionality.

BIOSPACE
For any problems with InBody230 or for any clinical information, contact:
BIOSPACE Co., Ltd. [HEAD OFFICE]
InBody Bldg., 54, Nonhyeon-ro 2-gil, Gangnam-gu, Seoul 135-960 KOREA
TEL: +82-2-501-3939 FAX: +82-2-578-2716
Website: http://www.inbody.com E-mail: info@inbody.com

For more information on the functions of InBody230 and descriptions on the thermal results sheet items, see the user's manual CD included.
For purpose of improvement, specifications and design are subject to change without notice.