



# Instruction for use

& installation instructions

miniBar

HiPro 3000

HiPro 4000

HiPro 6000

HiPro Vision



Dometic absorption refrigerators for hotels & offices

*English*

MBA 10/2011



Type H20 / 60  
821 2660-51

Record for future reference:

Model number	.....
Product number	.....
Serial number	.....

**N 1-1**





**HiPro 3000  
HiPro 4000  
HiPro 6000**



**HiPro 4000      OPTION**



**HiPro Vision**

**HiPro**

**HiPro** *VISION*

## Table of contents

<b>1.0</b>	<b>General</b>	<b>4</b>
1.1	Introduction	4
1.2	Guide to these operating instructions	4
1.3	Copyright protection	4
1.4	Explanation of symbols used in this manual	4
1.5	Warranty	5
1.6	Limitation of liability	5
1.7	Customer services	5
1.8	Spare parts	6
1.9	Environmental notices	6
1.9.1	Disposal	6
1.9.2	Energy-saving tips	6
1.10	Declaration of conformity	6
<b>2.0</b>	<b>Safety instructions</b>	<b>7</b>
2.1	Application according to regulations	7
2.2	User's responsibility	7
2.3	Protection of children when disposing of the equipment	7
2.4	Working upon and checking the miniBar	7
2.5	Information on coolant	7
<b>3.0</b>	<b>Installation</b>	<b>8</b>
3.1	Unpacking	8
3.2	Installation	8
3.3	Securing	9
3.4	Connecting the device to the electricity supply	10
3.4.1	Plug connection (UK only)	10
3.5	Installing and changing the sliding hinge	11
3.6	Changing the doorhang	12
3.7	Decor panel	13
3.7.1	Measurements of decor panel	13
3.7.2	Changing the decor panel	13
3.8	Technical data	14
<b>4.0</b>	<b>Operating instructions</b>	<b>15</b>
4.1	Cleaning	15
4.2	Initial operation	15
4.3	Temperature control	15
4.4	Automatic defrost function	15
4.5	Leakage detection	16
4.6	Positioning of the storage rack and shelf	16
4.7	Interior light	17
4.8	Automatic door control	17
4.9	Remote control	17
4.10	Troubleshooting	18

## 1.0 General

### 1.1 Introduction

You have made an excellent choice in selecting the **Dometic** Absorption miniBar. We are sure that you will be satisfied with your new miniBar in all respects. The miniBar, which works silently, meets high quality standards and guarantees the efficient utilisation of resources and energy throughout its entire life cycle, during manufacture, in use and when being disposed of.

### 1.2 Guide to these operating instructions

**Before you start using the miniBar, please read the operating instructions carefully.**

These instructions provide you with the necessary guidance for the proper use of your miniBar. **Observe in particular the safety instructions.** Observation of the instructions and handling recommendations is important for dealing with the miniBar safely and for protecting you from injury and the miniBar from damage. You must understand what you have read before you carry out a task.

**Keep these instructions in a safe place close to the miniBar so they may be referred to at any time**

### 1.3 Copyright protection

The information, texts and illustrations in these instructions are copyright protected and are subject to industrial property rights.

No part of these instructions may be reproduced, copied or utilised in any other way without written authorisation by Dometic GmbH, Siegen.

### 1.4 Explanation of symbols used in this manual

#### Warning notices

Warning notices are identified by symbols. A supplementary text gives you an explanation of the degree of danger.

**Observe these warning notices rigorously. You will thus protect yourself and other people from injury, and the appliance from damage.**



**WARNING!**

**WARNING** indicates a potentially hazardous situation which, if not avoided, could result in death or serious injury.



**CAUTION!**

**CAUTION** indicates a potentially hazardous situation which, if not avoided, may result in minor or moderate injury.

**CAUTION!**

**CAUTION** (used without the safety alert symbol) indicates a potentially hazardous situation which, if not avoided, may result in damage to the appliance.

## Information



**INFORMATION** gives you supplementary and useful guidance when dealing with your miniBar.

## Environmental Tips



**ENVIRONMENTAL TIPS** gives you useful guidance for saving energy and disposal of the appliance.

## 1.5 Warranty

Warranty arrangements are in accordance with EC Directive 44/1999/CE and the normal conditions applicable for the country concerned. For warranty or other maintenance, please contact our customer services department. Any damage due to improper use is not covered by the warranty. The warranty does not cover any modifications to the appliance or the use of **non-original Dometic parts**. The warranty does not apply if the installation and operating instructions are not adhered to and no liability shall be entertained.

## 1.6 Limitation of liability

All information and guidance in these operating instructions were prepared after taking into consideration the applicable standards and regulations as well as the current state of the art. **Dometic** reserves the right to make changes at any time which are deemed to be in the interest of improving the product and safety.

**Dometic** will assume no liability for damage in the case of :

- non-observation of the operating instructions
- application not in accordance with the regulations or provisions
- use of non-original spare parts
- modifications and interferences to the appliance
- effect of environmental influences, such as
  - temperature fluctuations
  - humidity

## 1.7 Customer services

Find your authorised customer service centre from **www.dometic.com**. When contacting Dometic Customer Services, please state the model, product number and serial number together with the MLC code, if applicable. You will find this information on the rating plate inside the miniBar. We recommend that you note this data in the field provided on the front page of this operation manual.

## 1.8 Spare parts

Parts can be ordered throughout Europe from our customer services.

Always give the model and product number when you contact the customer service! You will find this information on the rating plate inside the miniBar.

## 1.9 Environmental notices



Ammonia (a natural compound of hydrogen and nitrogen) is used in the cooling unit as a coolant. Non-ozone-hazardous cyclopentane is used as a propellant for manufacturing PU foam insulation.

### 1.9.1 Disposal

In order to ensure that the recyclable packaging materials are re-used, they should be sent to the customary local collection system. The appliance should be transferred to a suitable waste disposal company that will ensure re-use of the recyclable components and proper disposal of the rest. For eco-friendly draining of the coolant from all absorber refrigeration units, a suitable disposal plant should be used.

Appliances bearing this symbol must be deposited at the designated local reception point for the disposal of electrical and electronic equipment.



It is not permitted that this product be disposed of by way of the normal household refuse collection system.

Dometic refrigerators bear this symbol on the data plate to be found in the interior of the unit.

### 1.9.2 Energy-saving tips

- Do not expose the miniBar to direct sunlight or any other heat source (e.g. heater).
- Ensure that air circulation of the refrigeration unit is not obstructed.

- Run the miniBar for about 12 hours **before** filling it.
- Arrange the shelves evenly spread in the compartment to achieve the most efficient use of energy.
- Where possible, always store precooled and packed products.
- Do not overfill the storage grids and compartments to prevent obstructing the internal air circulation.
- Maintain a clearance of approx. 5-10 mm between chilled products and post-evaporator ("cooling fins").
- Only open the miniBar door for a short period of time when removing products.
- Set room temperature to approx. 20 °C (higher room temperatures increase the energy consumption of the miniBar).
- Ventilate room regularly. Increased energy consumption in rooms without air exchange.
- Select "12°C" temperature setting (point 4.3).
- **Observe installation instructions (point 3.2).**

## 1.10 Declaration of conformity

<b>DECLARATION OF CONFORMITY</b>	
according to	
Low Voltage Directive 73/23/EEC and the Amendment to LVD 90/683/EEC, 2006/95/EC EMC Directive 89/336/EEC, 2004/108/EC CE Marking Directive 93/68/EEC RoHS Directive 2002/95/EC	
Type of equipment Brand Name Type family Manufacturer's (Factory) name address telephone no telefax no	Absorption Refrigerator DOMETIC H 20/60 DOMETIC GmbH In der Steinwiese 16, D-57074 Siegen INT+49 - 271 692 0 INT+49 - 271 692 304
The following harmonized standards or technical specifications (designations) which comply with good engineering practice in safety matters in force within the EEA have been practiced:	
EN 60335-1:2002+A11+A12+A1+A2, (IEC 60335-1: 2001+A1+A2), EN 60335-2-24:2003+A1+A2+A11 (IEC 60335-2-24: 2002+A1+A2) EN 61000-3-2:95, A1, A2, A14      EN 61000-3-3:95, A1, EN 50366:2003+A1 EN 55014-1:00, A1, A2                      EN 55014-2:97, A1	
The equipment conforms completely with the above stated harmonized standards or technical specifications.	
By signing this document, the undersigned declares as manufacturer, or the manufacturer's authorized representative established within the EEA, that the equipment in question complies with the requirements stated above.	
Date	Signature
2010.01.07	 Dr. Michael Fritag
	Position
	General Manager

## 2.0 Safety instructions

### 2.1 Application according to regulations

This miniBar is intended for free-standing installation (miniBar with unit cover) or installation in furniture (miniBar without unit cover).

Only use the miniBar for chilling and storing closed drinks and snacks. Do not keep any perishable foodstuffs in the miniBar.



#### **WARNING!**

The miniBar is not suitable for the proper storage of medication. Please observe in addition the instructions in the medication package inserts.

### 2.2 User's responsibility

Anyone operating the miniBar must be familiar with the safe handling and understand the advice in these operating instructions.

### 2.3 Protection of children when disposing of the equipment



#### **WARNING!**

When disposing of the miniBar, detach the miniBar door and leave the storage racks in the miniBar. In this way inadvertent entrapment and suffocation is prevented.

### 2.4 Working upon and checking the miniBar



#### **WARNING!**

**Work on electrical facilities must be carried out by authorised personnel only. Substantial damage to property and/or injury to persons can arise through unprofessional procedures.**



#### **WARNING!**

**Never open the absorber cooling unit! It is under high pressure.**

**There is a danger of injury!**

### 2.5 Information on coolant

Ammonia is used as a coolant.

This is a natural compound also used in household cleaning agents (1 litre of Salmiak cleaner contains up to 200g of ammonia - about twice as much as is used in the miniBar). Sodium chromate is used for corrosion protection (1.8% by weight of the solvent).

In the event of leakage (easily identifiable from the strong odour), proceed as follows:

- Switch off the appliance.
- Air the room thoroughly.
- Inform authorised customer services.



**For the safety of hotel guests and personnel it was ascertained in an expert's report that no impairment of health exists when the coolant is discharged**

### 3.0 Installation

#### 3.1 Unpacking

Check during unpacking that the device is defect-free.

- Report transport damage to the transport company immediately.
- Check that the voltage noted on the model label corresponds to the mains voltage.

Depending on the model, the following parts can be found in the miniBar:

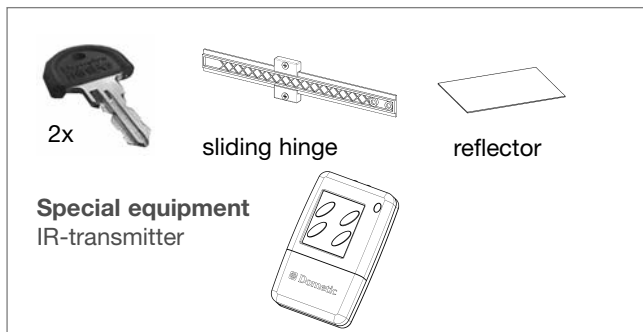

Fig. 1

#### 3.2 Installation

**CAUTION!**

Please follow the installation details below carefully. Guarantee is valid for products installed as described only.

- The miniBar must be level both directions.
- There should be 20mm clearance to the wall.
- Ventilation must be provided as shown in alternatives 1, 2, 3 or 4.
- Only the entire cooling unit must project into the duct as shown

- Air passing through the duct must not be preheated by any source of heat.
- Ventilation grills, if used, must have openings of at least 200cm<sup>2</sup> each.

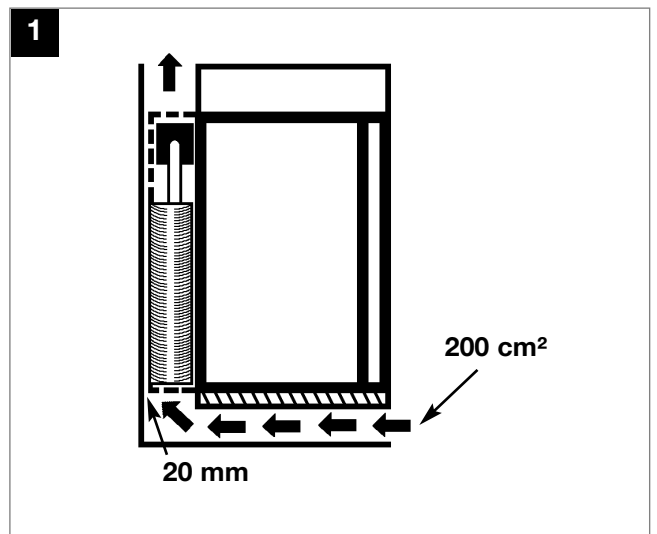

Fig. 2

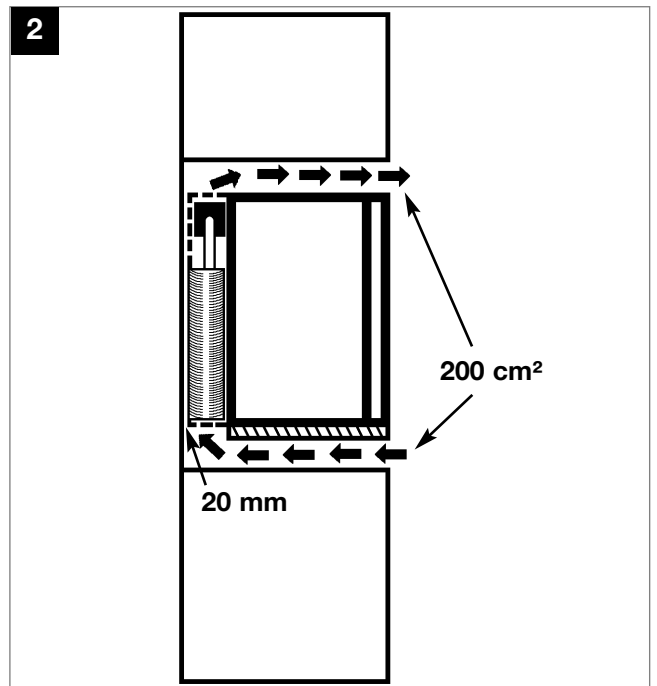

Fig. 3



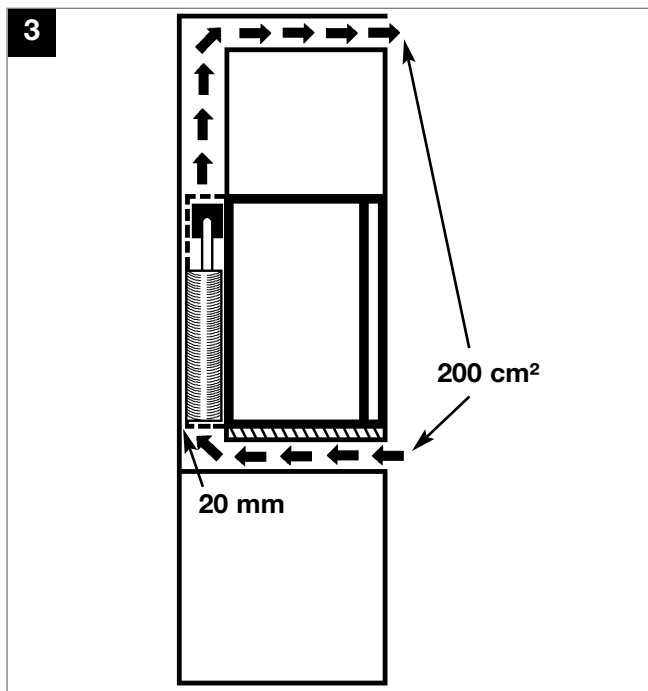

Fig. 4

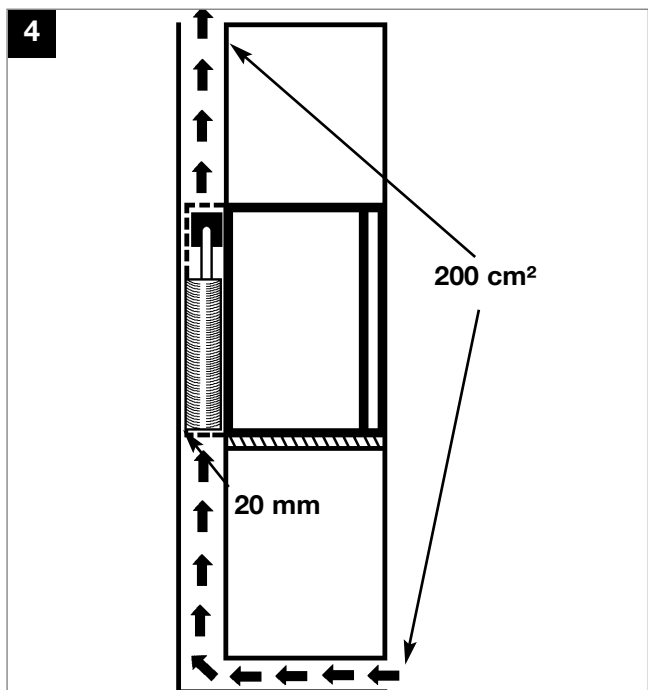

Fig. 5

**CAUTION!**

The mains plug/socket must be freely accessible once the miniBar has been installed.

**3.3 Securing**

When being built into a cupboard or a recess, the miniBar must be positioned in such a manner that both hinges/feet of the unit lie flush. The miniBar is then (see Figures a, b) screwed, at its hinges, to the piece of furniture in question. In the case of units with 8mm feet and with LED option for the door opening control, the reflector delivered with the unit must also be installed in the manner shown in Figure 6.

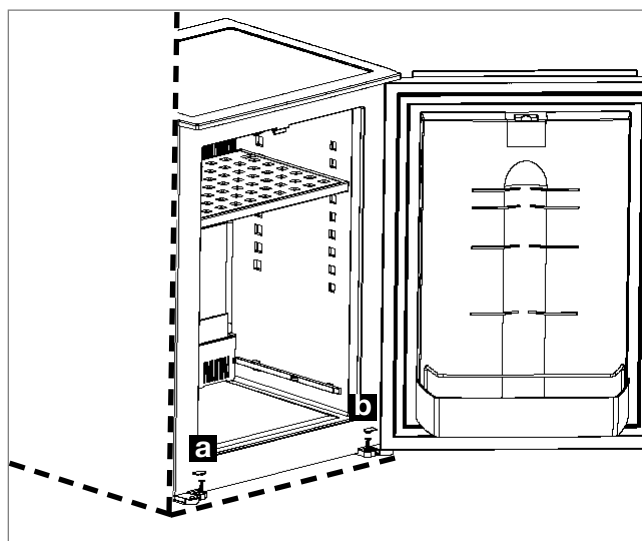
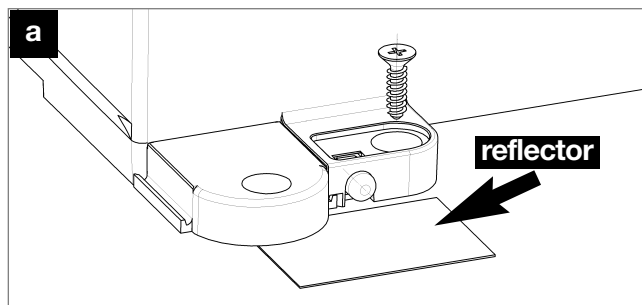
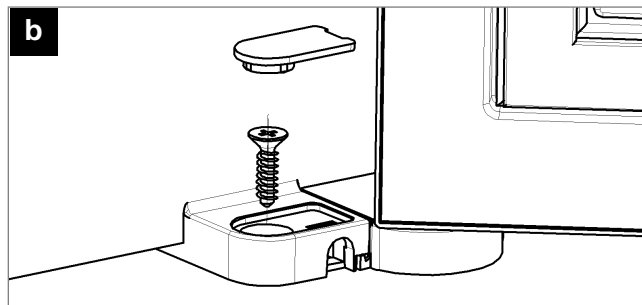

Fig. 6



Stick on supplied reflector.

Fig. 7



Drive in the screws and place the caps on.

Fig. 8

### 3.4 Connecting the device to the electricity supply

- The device must be connected to a properly earthed socket in line with the relevant valid country regulations.
- The mains plug/socket must be freely accessible.
- Check prior to initial operation that the voltage noted on the model label corresponds to the mains voltage. If this is not the case, do not connect the device and contact your dealer!
- If the connection cable is damaged it must be replaced by the Customer Service at Dometic, or by respectively qualified personnel, in order to prevent any hazards.

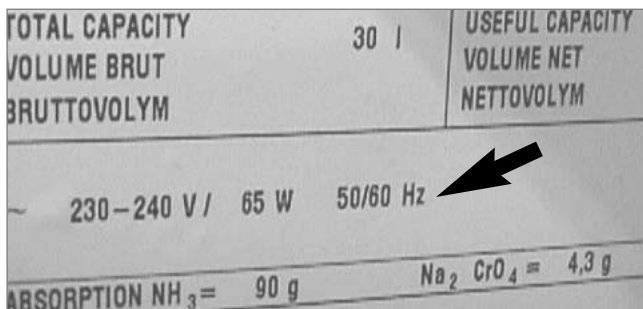

Fig. 9

**CAUTION!**

The mains plug/socket must be freely accessible once the miniBar has been installed.



**CAUTION!**

If the connection cable is damaged it must be replaced by the Customer Service at Dometic, or by respectively qualified personnel, in order to prevent any hazards.

**FOR UK ONLY!**

#### 3.4.1 Plug connection (UK only)

If a 3-pin plug is used, it should be fitted with a 3 amp fuse, with other plug types, the circuit should contain a 5 amp fuse.

Warning - This appliance must be earthed.

**WARNING!**

**This appliance must be earthed.**

The wires in the mains lead of this appliance are coloured in accordance with the following code:

- GREEN and YELLOW : EARTH
- BLUE : NEUTRAL
- BROWN : LIVE

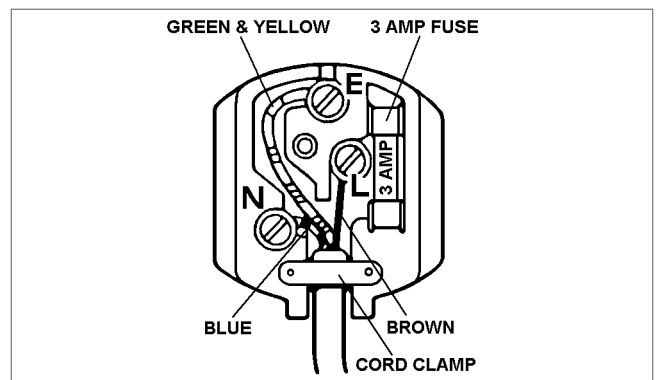

Fig. 10

As the colours of the wires in the mains lead may not correspond with the coloured markings identifying the terminals in your plug, proceed as follows.

- Connect the GREEN and YELLOW coloured wire to the plug terminal marked letter E or earth symbol or coloured green or green and yellow.
- Connect the BROWN coloured wire to the plug terminal marked letter L or coloured red.
- Connect the BLUE coloured wire to the plug terminal marked letter N or coloured black.

#### Moulded-On Plug Version :

The mains lead is fitted with a non-rewirable moulded-on plug containing a 3 amp fuse. If the fuse requires replacing at any time, the fuse

cover/carrier should be removed using a small screwdriver to level out. The old fuse should be replaced by a 3 amp ASTA approved BS1362 fuse and the fuse cover/carrier must be refitted before the plug is used again.

If the fuse cover-carrier is lost, a replacement can be obtained from the Dometic Service Centers.

The fuse cover/carrier must be of the same colour as that of the coloured insert in the base of the plug. In no circumstances must the plug be used without a correct fuse cover/carrier fitted.

If the plug supplied on the mains lead is not suitable for the socket in your home, it should be cut off and disposed of safely, or destroyed, to avoid any possible shock hazard resulting from the plug being inserted into a 13 amp socket elsewhere in the use. A suitable replacement plug should then be fitted as given above.

### 3.5 Installing and changing the sliding hinge

#### Distance to cupboard door (Fig. 11, 12)

- When closed, the cabinet door must not abut the cabinet frame (clearance 1-2 mm), otherwise the miniBar door does not close tightly.
- There must be a distance of 6-8mm between the cupboard door and the miniBar.

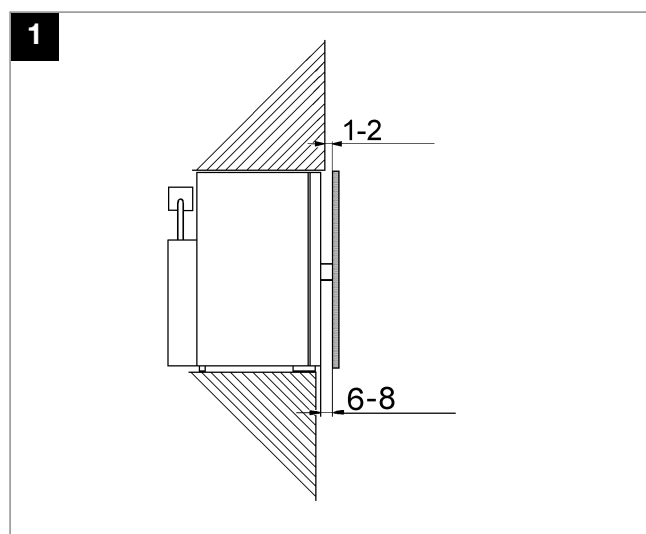

Fig. 11

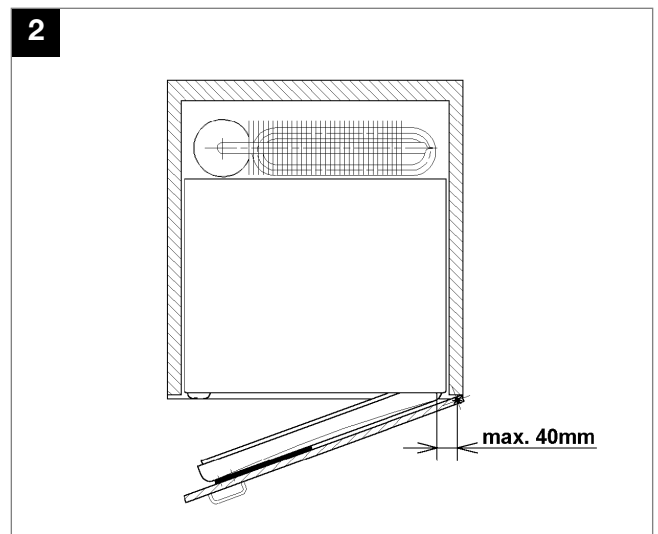

Fig. 12

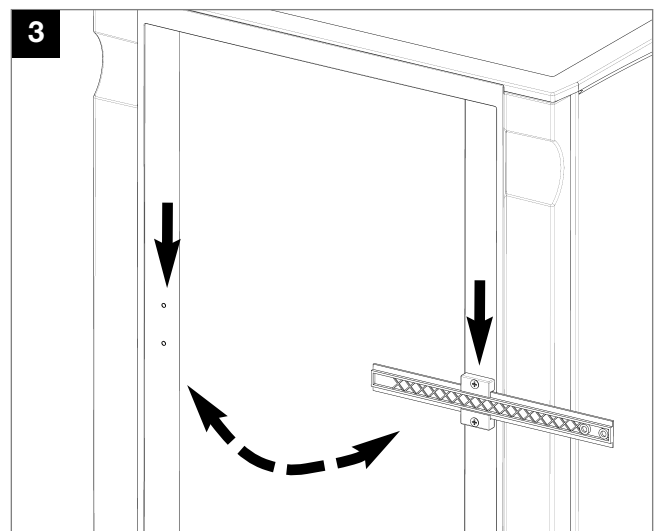

Fig. 13

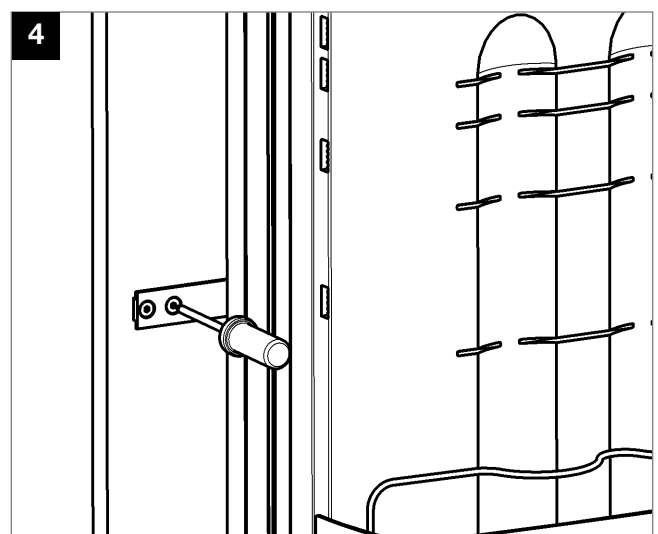

Fig. 14

### 3.6 Changing the doorhang



The (optional) **LED** of the door-opening control is placed always opposite the hanging side.

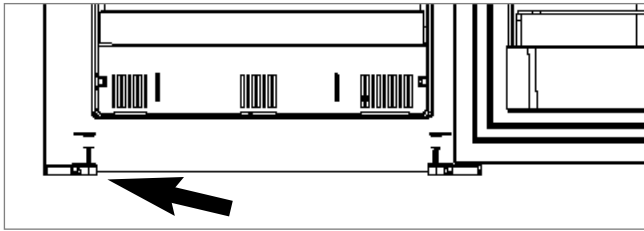

Fig. 15

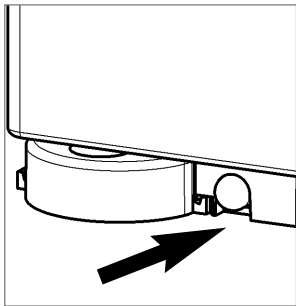

Fig. 16

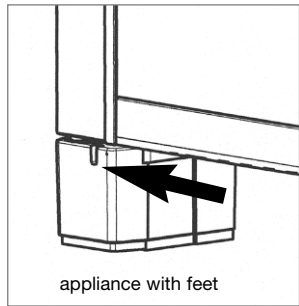

Fig. 17

If the miniBar is equipped with the LED first carry out steps 1. - 5. :

Pull out LED, lay the cable into the cable routing and insert the LED at the opposite side.

(4. + 5. = appliance with feet)

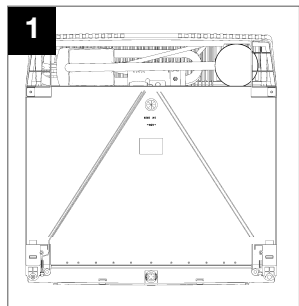

Fig. 18

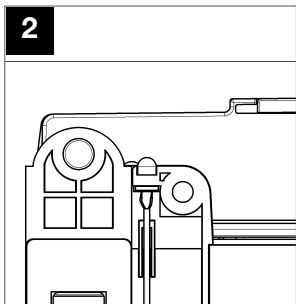

Fig. 19

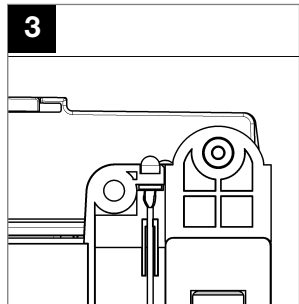

Fig. 20

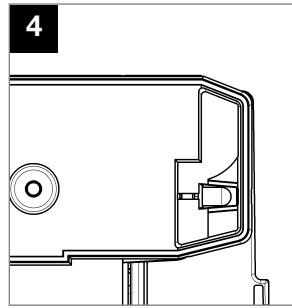

Fig. 21

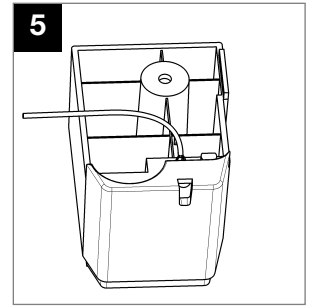

Fig. 22

Pull the lower hinges forwards, pull out the door with the hinge.

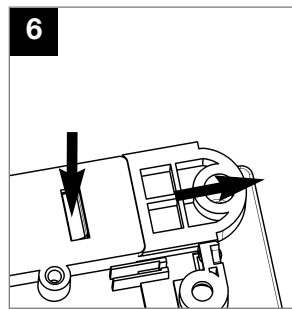

Fig. 23

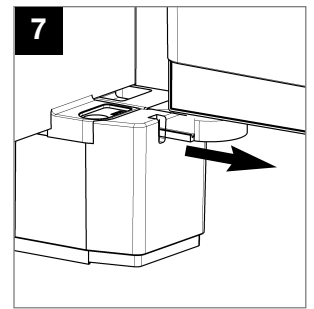

Fig. 24

Remove the upper hinge pin and insert on the other side, change the lower pin in the door. Then push the door in together with the lower hinge.

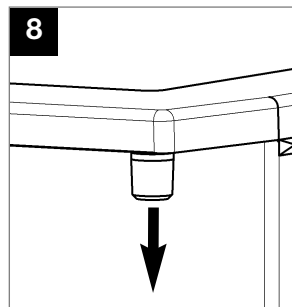

Fig. 25

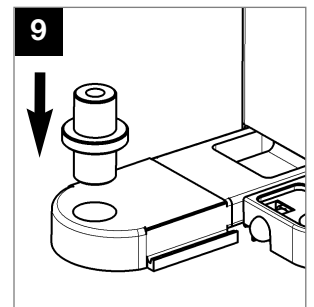

Fig. 26

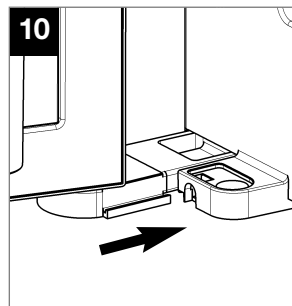

Fig. 27

### 3.7 Decor panel

#### 3.7.1 Measurements of decor panel

	H	x W	x D (mm)
HiPro 3000	492	x 294,5	x 2 (max)
HiPro 4000	524	x 311,5	x 2 (max)
HiPro 6000	533	x 376,5	x 2 (max)

#### Hole for door lock (a)

diameter  $\varnothing$  23,5 mm  
 distance from the edge (h) 62 mm

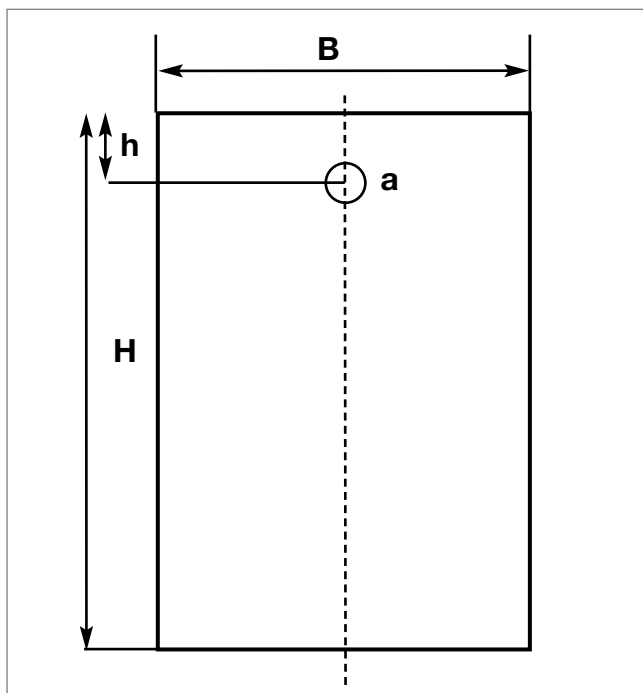

Fig. 28

#### 3.7.2 Changing the decor panel

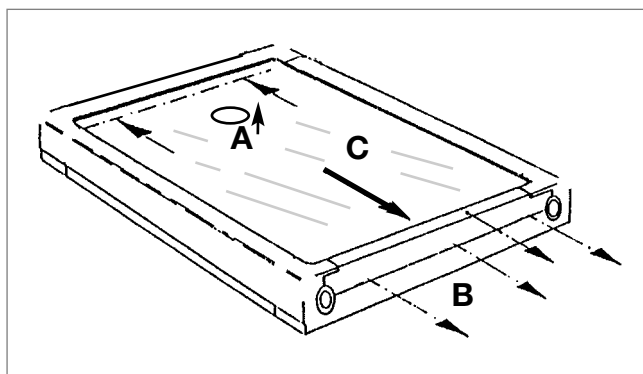

Fig. 29

- Detach the lower door hinge and pull the door out (see also "3.6").
- Remove the holder for the lock (A) (mounted).
- Detach the lower frame section (B) (not screwed) and remove.
- Slightly bend the decorative panel (C) and pull it out of the door frame.
- Push in a new decorative panel with the upper edge running exactly parallel to the upper part of the frame. Place the frame section (B) on and press firmly (clip in).
- Place the door onto the lower hinge, insert the hinge pin into the top of the door, push the door with the hinge into the hinge receptacle at the bottom and allow the hinge to notch. Insert the hinge pin in the door, push in the door and let the hinge click in.



#### Remark (devices without doorlock):

- Additional installation of a door lock is possible (available from Dometic)
- In the door the position for the opening is prepared.
- Drill the hole in accordance to the drawing above.

### 3.8 Technical data

#### HiPro 3000

<b>Casing</b>	Plastic
<b>Gross contents (litres)</b>	27
<b>Dimensions (mm)</b> <b>(H x W x D)</b>	527 x 388 x 418
<b>Electrical rating (W)</b>	65
<b>Power consumption</b> <b>kWh / 24h*</b>	0,568*
<b>Net weight (kg)</b>	12
<b>Assembly</b>	x

#### HiPro 4000

<b>Casing</b>	Plastic
<b>Gross contents (litres)</b>	36
<b>Dimensions (mm)</b> <b>(H x W x D)</b>	559 x 405 x 452
<b>Electrical rating (W)</b>	65
<b>Power consumption</b> <b>kWh / 24h*</b>	0,649*
<b>Net weight (kg)</b>	13,5
<b>Assembly</b>	x

*with cooling unit cover + feet*

<b>Dimensions (mm)</b> <b>(H x W x D)</b>	601 x 405 x 472
<b>Net weight (kg)</b>	14,5
<b>freestanding</b>	x

#### HiPro 6000

<b>Casing</b>	Plastic
<b>Gross contents (litres)</b>	50
<b>Dimensions (mm)</b> <b>(H x W x D)</b>	568 x 490 x 474,5
<b>Electrical rating (W)</b>	80
<b>Power consumption</b> <b>kWh / 24h*</b>	0,695*
<b>Net weight (kg)</b>	17
<b>Assembly</b>	x

#### HiPro Vision

<b>Casing</b>	Plastic
<b>Gross contents (litres)</b>	36
<b>Dimensions (mm)</b> <b>(H x W x D)</b>	559 x 405 x 465
<b>Electrical rating (W)</b>	65
<b>Power consumption</b> <b>kWh / 24h*</b>	0,739*
<b>Net weight (kg)</b>	13,5
<b>Assembly</b>	x
<b>freestanding</b>	x

\*The energy consumption is measured at 12°C at 25°C environment temperature ( cellar ) .

## 4.0 Operating instructions

### 4.1 Cleaning

Before operating the miniBar, we recommend you clean it both inside and outside.

- Use a soft cloth, lukewarm water and a mild detergent.
- Following this, wash out the miniBar using clean water and dry thoroughly.
- At annual intervals, remove dust from fridge aggregate using a brush or soft cloth.

**CAUTION!**

To prevent material damage :

- Do not use soap or detergents which are harsh, coarse or which contain soda .
- Keep the door seal free from oil and grease.
- The cylinder locks have been lubricated in the factory to be long-lasting.

### 4.2 Initial operation

- The device must be plugged into a properly earthed socket.
- The miniBar starts automatically with a self test. If the electronics do not detect any fault, the LED for the interior lighting illuminates for 2 seconds after approximately 10 seconds.
- If a fault is detected, the illumination changes to a continuous flashing light. If this occurs, please consult your authorised Customer Service
- The miniBar achieves its operating temperature after several hours.

### 4.3 Temperature control

The miniBar is equipped with completely automatic, electronic temperature control. Using an optional remote control, the **default setting** can be changed from **5 °C** to 3 °C, 7 °C or 12 °C (maximum ambient temperature 25 °C).

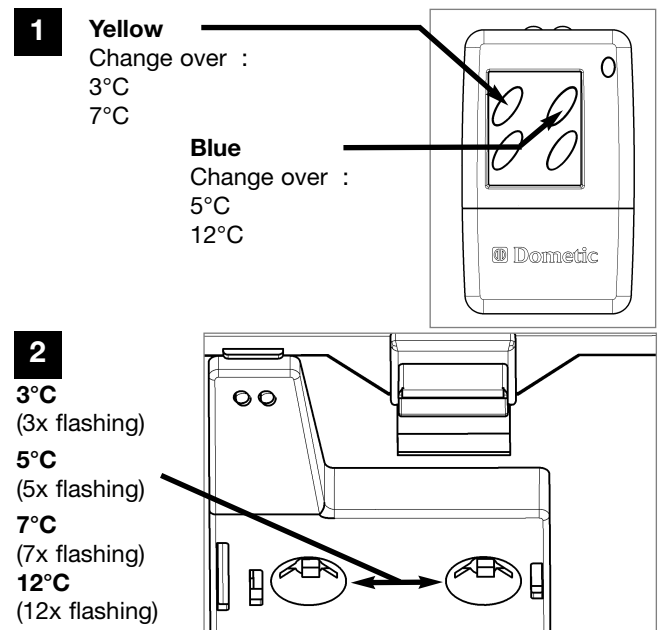

Fig. 30



The energy-saving effect is highest when the 12°C preset is selected (internal temperature range 8 °C to 14 °C).

If you select a lower (colder) temperature setting, the energy consumption increases.

Observe the instructions in "1.9.2 Energy-saving tips".



**WARNING!**

**The miniBar is not suitable for storing perishable foodstuffs.**

### 4.4 Automatic defrost function

- The first defrosting phase commences 39 hours after the initial operation and lasts for two hours.
- After this, the device operates for 22 hours at a time, followed by a defrosting period of 2 hours.

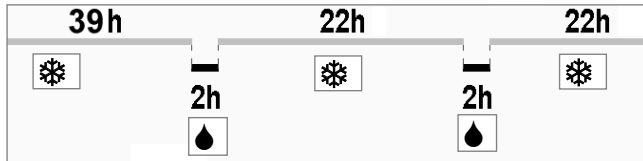

Fig. 31

**CAUTION!**

The ice layer must never be removed using force, nor must the defrosting process ever be accelerated using a heater!



### 4.5 Leakage detection

The electronics carry out a leakage test after every defrosting period (every 24 hrs) by measuring the temperature at the evaporator by means of a second sensor. If the electronics detect a leak, the miniBar is automatically switched off. The LED for the interior lighting changes after approx. 10 secs. to a continuous flashing. (The LED of the door-opening control flashes synchronously, if available.)

**Please contact the authorized Dometic Service if a failure occurs.**



HiPro miniBars, which are designed for use on sea vessels, are equipped with a bimetal sensor switch instead! Malfunction of the cooling unit is not shown via the LEDs.

### 4.6 Positioning of the storage rack and shelf

- Pull out the storage rack until it is blocked.
- Press in the lock of both running rails.
- Remove storage rack and running rails and place it at the desired position.
- Remove storage rack and running rails and place it at the desired position. After clicking in the the storage rack it is secured against pulling out completely again.

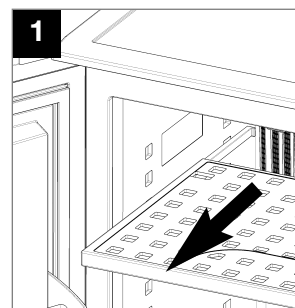

Fig. 32

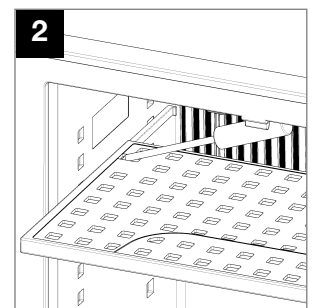

Fig. 33

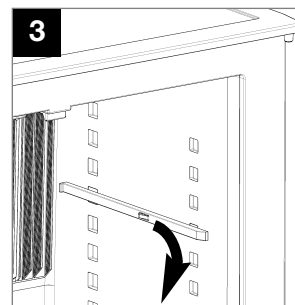

Fig. 34

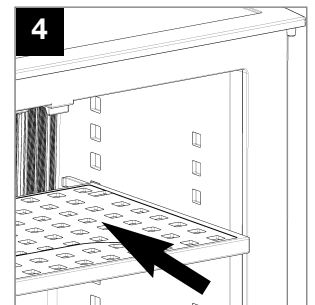

Fig. 35

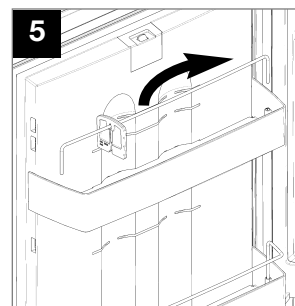

Fig. 36

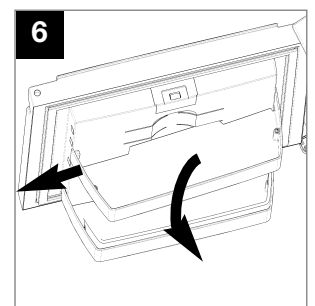

Fig. 37

- (5 / 6) To fit the storage shelf, the reverse order applies.



### 4.7 Interior light

Two LEDs **1** light the cooling compartment whilst the door is opened.  
Two sensors **2** control the LEDs and the (optional) door control as well.

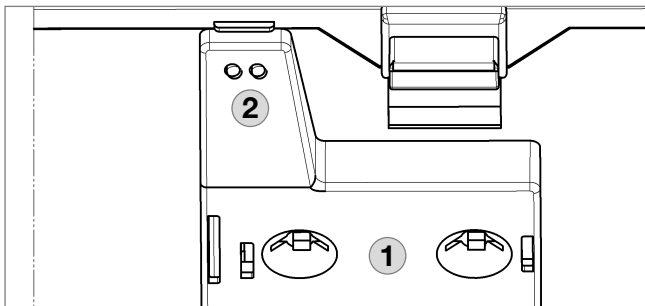

Fig. 38

### 4.8 Automatic Door Control [ADC] (optional)

The LED **1** placed at the bottom edge of the miniBar indicates whether the miniBar door has been opened.

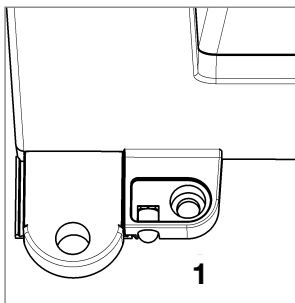

Fig. 39

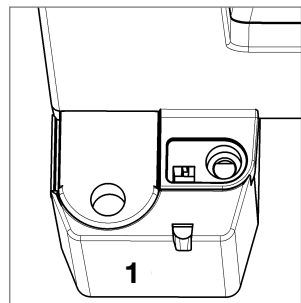

Fig. 40

1. Open the miniBar, check its contents and - if applicable- stock it up again.
2. Reset the door control sensor by means of an IR-transmitter (RED-DOT-RESET) **2**.
3. Close the miniBar.

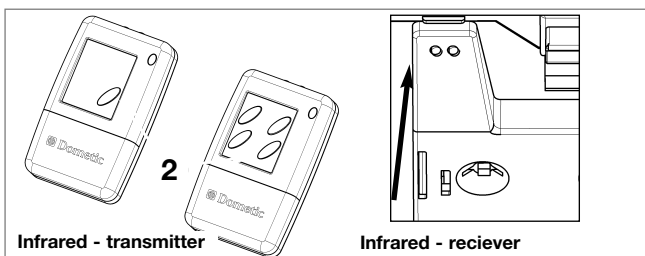

Fig. 41

### 4.9 Remote control

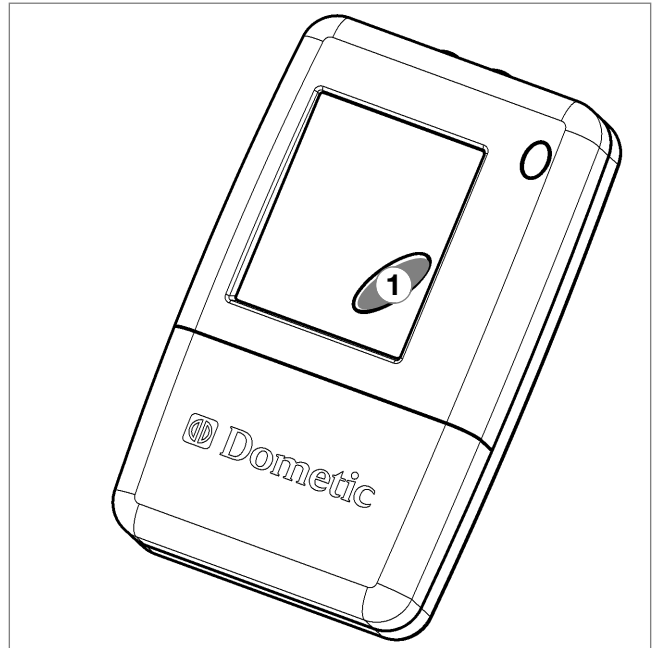

Fig. 42

#### Type 1

- 1** Red = Red Dot Reset (reset door opening)

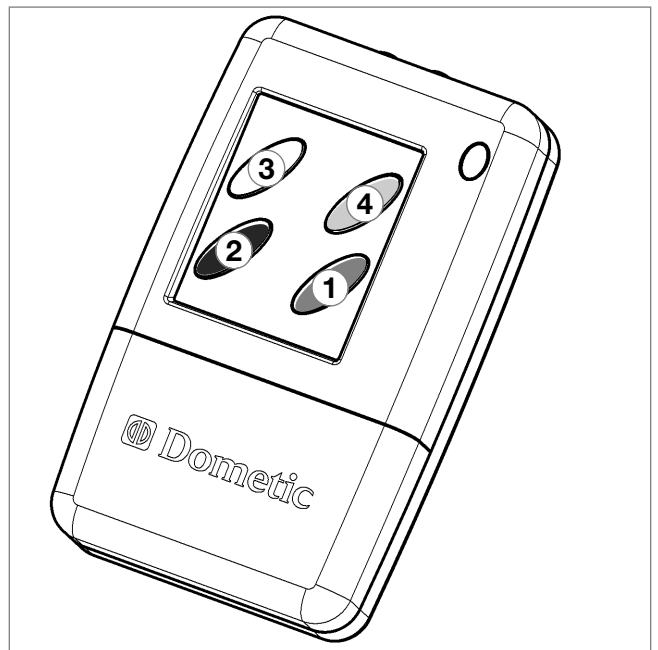

Fig. 43

#### Type 2

- 1** Red = Red Dot Reset (door opening, press once)
- 2** Black = Reset cooling unit (press once)
- 3** Yellow = Change over temperature 3°C / 7°C
- 4** Blau = Change over temperature 5°C / 12°C

## 4.10 Troubleshooting

<b>Failure : No cooling (the aggregate at the back of the device is cold).</b>		
Possible Cause	Self Help	Authorised Service
a.) The device plug is not plugged in.	a.) Plug in device plug.	
b.) No voltage in socket.	b.) Check main fuse.	
c.) The electronics or the sensor is faulty. Does the LED flash ?		c.) Install new electronics or sensor.
d.) Defective heating element.		d.) Install new heating element.
e.) The device is in its defrosting phase.	e.) See operating instruction 4.4.	
<b>Failure : No cooling (the aggregate is warm).</b>		
Possible Cause	Self Help	Authorised Service
a.) The device is not level. Leakage test ?	a.) Level the device using a spirit level.	
b.) The device was only switched on a short while ago.	b.) Switch on the device and let it run for 5-6 hours.	
c.) Defective cooling unit.		c.) Exchange device.
<b>Failure : Poor cooling performance.</b>		
Possible Cause	Self Help	Authorised Service
a.) The cooling aggregate is not sufficiently ventilated.	a.) Check that the ventilation grids are not covered. Check that device has been installed properly (installation instruction 3.2).	
b.) The device is exposed to direct sunlight.	b.) Follow installation instruction 3.2.	
c.) The fridge door does not close tightly	c.) Check installation in line 3.2.	c.) Install new doorseal, if necessary.
d.) The fridge was stocked a short while ago.	d.) Check fridge after 5-6 hours for proper cooling function.	
<b>Failure : Frost formation in fridge.</b>		
Possible Cause	Self Help	Authorised Service
a.) The fridge door does not close tightly.	a.) Check installation is in line with 3.2.	a.) Install new doorseal, if necessary.

# Produktdatenblatt Product Data Sheet

miniBar



[www.dometic.com](http://www.dometic.com)

Fabrik / Factory : **Dometic GmbH  
In der Steinwiese 16  
D-57074 Siegen (Germany)**

Modelle / Models : **HiPro 3000, HiPro 4000, HiPro 6000, HiPro Vision**

Typenklasse / Type family : **H 20/60**

Produktdaten / Product data :

	<b>HiPro 3000</b>	<b>HiPro 4000</b>	<b>HiPro 6000</b>	<b>HiPro Vision</b>
Kategorie / Category :	<b>2 (Kellerfach)</b>	<b>2 (cellar compartment)</b>	<b>2</b>	<b>2</b>
Energieeffizienzklasse / Energy efficiency index :	<b>C</b>	<b>C</b>	<b>D</b>	<b>D</b>
Energieverbrauch (kWh/annum) / Energy consumption (kWh/annum) :	<b>207</b>	<b>237</b>	<b>254</b>	<b>270</b>
Nutzzinhalt / Usable capacity :	<b>26 Ltr.</b>	<b>34 Ltr.</b>	<b>48 Ltr.</b>	<b>34 Ltr.</b>
Klimaklasse / Climate class :	<b>SN</b>	<b>SN</b>	<b>SN</b>	<b>SN</b>
Umgebungstemperatur / Ambient temperature :	<b>min. +10°C max. +32°C</b>	<b>min. +10°C max. +32°C</b>	<b>min. +10°C max. +32°C</b>	<b>min. +10°C max. +32°C</b>
Schallemissionen / Noise emission :	<b>0 dB</b>	<b>0 dB</b>	<b>0 dB</b>	<b>0 dB</b>
Einbaugerät / built-in appliance :	<b>X</b>	<b>X</b>	<b>X</b>	<b>X</b>



**miniBar**





