



LEGENDARY
INNOVATION

OWNER'S MANUAL



Index

Index	2	Mounting Hunter Elite Quiver	16
Safety Instructions	3	Cocking the Summit, Legacy and TRT	17
Summit HD 150 Assembly	5	Loading, Shooting, and Unloading	18
Summit HD Peep/Pin Assembly	6	Arrow Safety and Selection	19
Vision 175 Assembly	7	Dial-A-Range Instructions	20
Vision 175 Care and Maintenance	8-9	Mult-A-Range Instructions /Warranty	21
Cocking the Vision 175	10	Red Dot Instructions /Warranty	22
Legacy Assembly and Maintenance	11-13	String and Cable Chart	23
TRT Ultra-Lite Express Assembly	14	Arrow Ballistics Chart	24
TRT Forearm Adjustment and Recoil Pads	15	International Distributors	24-25
		Limited Lifetime Operational Warranty	26

BEFORE YOU BEGIN ASSEMBLY OR SHOOTING, READ THIS MANUAL THOROUGHLY. ALSO READ HORTON'S MAINTENANCE OR WARRANTY RETURN POLICY THAT IS ON THE LAST PAGE OF THIS MANUAL.

CONGRATULATIONS! You are now the owner of one of the finest crossbows ever designed. Your new Horton crossbow is one of the most accurate and dependable production crossbows known to the shooting industry. All Horton crossbows are manufactured as high quality, precision sporting arms. They utilize the latest materials and manufacturing processes to ensure their dependability and safety. With reasonable care, your new Horton crossbow will provide you with years of pleasure and dependable service.

This manual provides proper crossbow working knowledge and instruction. Without this knowledge and instruction, you could damage your crossbow or cause injury to yourself and / or others. When you have read this manual thoroughly and understand it completely, be sure to save it for future reference.

Every effort has been made to ensure that all product photographs and descriptions in this manual are accurate. However, due to our continual effort to provide you with the best products possible, changes in materials or design may result before a new manual can be updated. Horton Archery, LLC reserves the right to modify or change product specifications and information contained in this manual without notice.

Horton Archery, LLC shall not be liable for technical or editorial omissions or mistakes in this manual nor shall it be liable for incidental or consequential damage resulting from your use of the information contained in this manual.

This manual contains confidential and proprietary information and is copyrighted. All rights reserved. No part of this manual may be photocopied or reproduced in any form without prior written consent of Horton Archery, LLC.

Note: If any part of this manual is unclear, or poses any doubt, contact Horton Customer Service or your local Horton dealer for clarification.

CONSULT WITH YOUR LOCAL AND STATE LAW ENFORCEMENT AND WILDLIFE AGENCIES REGARDING CURRENT CROSSBOW REGULATIONS.

Also, please visit our website at www.hortonarchery.com and register to join the Horton family of crossbow hunters. Benefits of registration include current information regarding products, performance, hunting tips and advice, connection with other crossbow hunters through Horton's interactive Crossbow Forum, Horton's e-newsletter, and a place to share your favorite hunting stories and pictures.



Safety Instructions

The fifteen safety tips below provide important information to understand and follow. Take note however, this is only a partial listing of safe practices. We recommend you consider enrolling in a hunter/shooting safety course and study the “Today’s Crossbow” safety curriculum included with your crossbow purchase. There is no such thing as being “too safe”.

- 1 **Caution:** When firing your crossbow, be sure to keep your fingers and thumb below the travel path of the bow string and cables. Failure to do so could result in serious injury.
- 2 **Always remember to treat your crossbow with the same respect as any sporting arm.** Your crossbow is a very powerful weapon and can be dangerous and deadly if mishandled.
- 3 **Always point your crossbow in a safe direction.** Never, under any circumstances, point your crossbow at anything you do not intend to shoot.
- 4 **Always check your crossbow thoroughly for worn, damaged, loose, or missing parts prior to shooting.** This will help you avoid malfunctions and prevent possible injuries.
- 5 **Never leave your crossbow exposed to extreme heat,** such as in an enclosed automobile, automobile trunk, or in an enclosed truck cap on a hot day.
- 6 **Never transport your crossbow in the cocked position.**
- 7 **Never shoot your crossbow without an arrow (dry fire).** Shooting your crossbow without an arrow not only voids the warranty but could also damage the crossbow and possibly cause bodily injury. Always load the crossbow with an arrow or a Horton de-cocking arrow before shooting.
- 8 **Never cock or load your crossbow until you are ready to shoot and are sure of your target.** While hunting, keep in mind that many hunters dress in camouflage clothing and are difficult to identify.
- 9 **Never release the safety until you are ready to fire.** Do not attempt to delete or alter the safety or trigger mechanism in any way. This will not only void the warranty but could also result in severe bodily injury and possible death.
- 10 **DO NOT walk with your crossbow cocked and loaded.**
- 11 **Never, under any circumstances, shoot your crossbow while behind or directly alongside others.** If the crossbow was to malfunction, injuries may result to those who are standing directly alongside the crossbow.
- 12 **ONLY use arrows recommended by Horton for use in your particular crossbow model.** Shooting arrows of improper length, weight, materials, diameter or design is a dangerous practice that could damage your crossbow or cause serious injury.
- 13 Crossbow hunting is often conducted from a treestand. Consult your hunter safety course materials for complete treestand safety information. When stalking or still-hunting, **NEVER** load an arrow into the crossbow until the game is identified and you are ready to shoot.
- 14 Each year, many archery hunters injure themselves by improper handling of their razor sharp hunting arrows. **BE CAREFUL.** Always use a quiver which completely shields the broadheads when shooting or transporting the crossbow.
- 15 **Before shooting, be sure the crossbow limbs are clear from striking any obstruction.** Should this occur, accuracy of the arrow will be greatly affected and could result in damage to the crossbow and / or injury to the shooter and others.





HORTON

ARCHERY
LEGENDARY INNOVATION.

CHOOSE YOUR BOW



SUMMIT HD 150
PAGE 5



VISION 175
PAGE 7



LEGACY HD 175
PAGE 11



LEGACY CS 225
PAGE 11



TEAM REALTREE ULTRA-LITE EXPRESS
PAGE 14



Summit HD 150 Package Contents

(Sighting systems will vary by crossbow model)



Hardware Included



Included in the crossbow package are the following items:

- Stock Assembly with Sight Unit (i.e. Red Dot or Peep/Pin)
- Front End Assembly (3 Year Warranty Limbs)
- Cocking Stirrup
- Assorted screws, bolts and washers
- Rail Lube

Tools needed for assembly:

- 3/16" hex key (provided)
- Phillips screw driver
- 1/8" hex key

Assembly Instructions for Summit HD 150

1. Holding the bow unit in one hand and the stock in the other, position the bow string on top of the barrel.

2. Insert the cables into the cable slot. NOTE: It may be necessary to apply a small amount of downward pressure to the cables in order to align the cables with the cable slot. Models without metal barrels do not use a cable saver.

3. As shown in image 1, move the bow unit toward the barrel, allowing the string and cables to slide rearward. The cables should be in the cable slot and the string should be resting on top of the barrel.

4. Slide the bow unit toward the stock until the riser fully seats into the barrel. See image 2.

5. As shown in image 3, install 1" long 5/16 - 18 front end mounting bolt (E-1) with 3/4" diameter washer (A-1) and tighten until snug. Attach the steel foot stirrup by placing each leg fully into the hexagon shaped holes provided in the riser. The loop bend in the center of the stirrup should be positioned down or away from the flight groove as shown in image 4. Slide the stirrup legs back into the riser fully until they stop. On the bottom of the riser, install the two Allen head stirrup set screws (B) and tighten firmly.

Now that the bow is assembled, go to page 17 to read how to cock the bow.

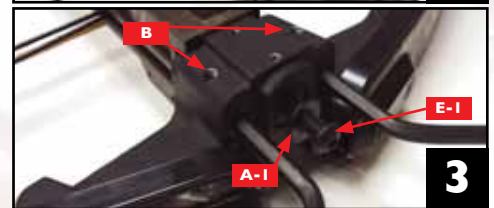



Summit HD 150 Peep and Pin Assembly and Sight-In

The following information will instruct you on how to sight-in your crossbow using the Rear Peep and Front Pin sights. If you are utilizing a scope or other form of optics, disregard this section and proceed to Page 20, the “Dial-A-Range” section of this manual.

MOUNTING

1. Place the front sight blade on the front left end of the barrel. Align the two holes in the sight blade with the two holes on the left side of the barrel. See image 1.
2. Insert the two 1” long #10 pan head wood screws (A-2) through the holes in the sight blade and tighten firmly using a Phillips screwdriver. See image 2.
3. Position the Front Sight Pin 5/8” (A-1) down from the top of the sight blade vertically and set the ball tip of the pin over the center of the barrel horizontally. See image 2.

SIGHTING IN

Before you begin, place the Dial-A-Range in the “0” position. All adjustments will be made to the Front Sight Pin only.

MOVING THE SIGHT PIN

UP will cause the arrow to impact lower.
DOWN will cause the arrow to impact higher.
LEFT will cause the arrow to impact right.
RIGHT will cause the arrow to impact left.

Moving the pin 1/4” will change the point of impact approximately 9” at a distance of 20 yards. Additional sight pins may be added for longer ranges, typically 30 and 40 yards.

Shoot several arrows to determine a “group” and make any small changes necessary to zero in a given distance.

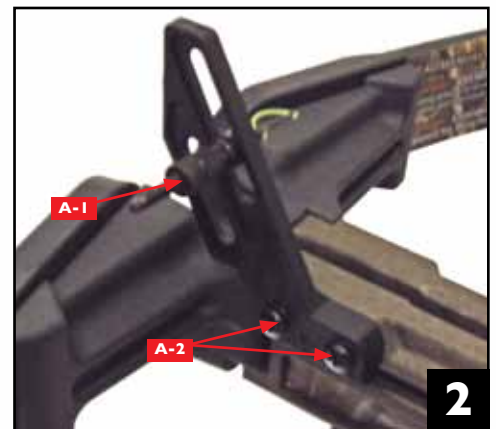
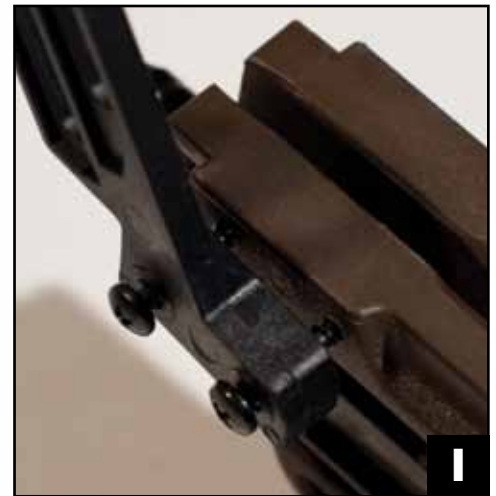



Vision 175 Package Contents

(Sighting systems will vary by crossbow model)



Hardware Included



Included in the crossbow package are the following items:

- Stock Assembly
- Front End Assembly (Lifetime Warranty Limbs)
- Cocking Stirrup
- Foot Stirrup Mounting Bolt and Flat Washer
- Rail Lube
- Optic (Scope and Rings or Red Dot)
- Quiver and Quiver Hardware Package
- 3 Arrows
- Service / Maintenance Cable
- Cable Saver (Installed on cables)

Tools needed for assembly:

- 3/16" hex key (provided)

Assembly Instructions for Vision 175

1. As shown in image 1, unscrew foot stirrup mounting bolt (E-1). Remove the bolt and the rectangular washer (A-1) from the front of the barrel using the provided hex wrench.

2. Align the stirrup to the front of the barrel. Place the flat rectangular washer on the stirrup and align the hole in the washer with the hole at the end of the barrel. Using the provided hex wrench, tighten the 3/4" long 5/16 - 18 mounting bolt into the front barrel through the washer and stirrup. Make sure the bolt is fully tightened. See image 2.

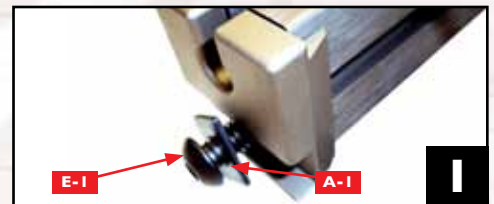



Vision 175 Care and Maintenance

Your Vision 175 crossbow is a high quality, precision sporting arm which requires occasional care to maintain top performance.

Prior to every outing or shooting session, perform an overall safety check on string, cables, wheels, limbs, and fasteners. To prolong their life and effectiveness, strings and cables should be treated with string wax frequently. **DO NOT** apply wax to center served portion of the bowstring as this may cause a wax build-up in the trigger mechanism. This could lead to a malfunction, especially in very cold conditions. Instead of wax, apply Horton Rail Lubricant® every 20 shots to reduce friction between the barrel and string.

Keep steel components lightly coated with a high quality gun oil to prevent rust and keep the exterior clean and dry. Store your Vision 175 so that it is never exposed to

extreme temperatures. This could damage the bow limbs, cables and / or string. Do not store the crossbow in a closed area such as a car trunk or an enclosed truck cap.

When your string or cables show signs of excessive wear or display a broken strand, replace the immediately.

The Vision 175's unique reversed limb configuration prohibits the use of a conventional archery bow press for service. For quick "in the field" string and cable changes, a portable "service cable" has been included in your Vision package. It is important to note that the service cable will work only if the string and cables of the Vision 175 are intact. The assistance of a helper is required to change strings and cables using the service cable. If the bowstring or cables have completely broken, the use of an AC860 Vision Shop Press will be required.

Using the Vision 175 Service Cable

1. Place one loop of the service cable on the service stud. See image 1. Pass the opposite end of the service cable through the barrel cable slot and attach to the service stud on the other wheel. See image 2.

2. Place your foot securely through the cocking stirrup. Place the center of the cocking strap into the recessed groove provided in the rear of the sight bridge. With both hands, carry the cocking sled over the scope and place it centered on the flight deck, attaching the string hooks of the sled to the bowstring. Pull string back evenly, moving the bowstring back to approximately the front of the sight bridge and **HOLD IN THAT POSITION. DO NOT FULLY COCK THE CROSSBOW.**

3. While holding, have the helper attach the opposite loop of the service cable to the service stud of the opposing cable anchor. See image 2.

4 Let the bowstring down gently. The service cable will hold the bow slightly compressed, creating slack in the cables and string. They now may be easily removed, serviced or replaced. See image 3.

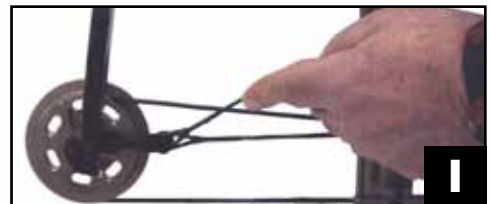

Replacing the Vision 175 Cocking Mechanism Rope

You will need 50" of 750lb tensile strength spectra cord or equivalent.

1. Lap over approximately 6" of cord on one end. See image 1.
2. Thread the looped portion of the cord through the small loop of the handle. See image 2.
3. Tie the looped portion of the cord to the remainder of the cord in a half hitch around the small portion of the handle. See image 3.
4. Thread the long portion of the handle through the loop of the cord. See image 4.
5. Pull handle completely through the loop of the cord and pull looped cord off the end of the handle. See image 5.
6. Pull on end of cord and handle to cinch knot and complete one end. See image 6 and 7.
7. Thread cord through cocking sled and repeat the entire process on the opposite side. The finished product should look like image 8.

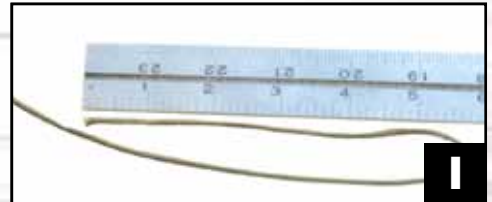

Cocking the Vision 175

Do not cock or load the Vision 175 unless you are in a safe and spacious range area and in a position to safely shoot. Always identify your target prior to shooting.

Important: Because the Vision 175 creates an extremely acute angle of the bowstring to the barrel when cocked, it is essential to utilize the cocking strap included with the Vision 175. Cocking the Vision 175 in a conventional manner will result in severe pinching of your fingers against the crossbow barrel.

1. Before cocking, place the trigger safety into the “Fire” position. The safety will automatically engage when cocking is complete.

2. Place the center of the cocking strap into the recessed groove provided in the rear of the sight bridge. See image 1.

3. With both hands, carry the cocking sled over the scope and place it centered on the flight deck, attaching the string hooks of the sled to the bowstring. See images 2 and 3.

4. Place your foot securely through the cocking stirrup of the Vision 175 and place both hands fully through the wrist straps of the cocking strap.

5. With the cocking sled positioned flat on the barrel’s surface, pull back evenly and slowly with both hands (See image 4), parallel to barrel, moving the bowstring and sled under the arrow retention spring. See image 5.

6. When fully drawn, relax your pull slightly to ensure that the trigger latch has captured the bowstring. If the string is not held securely, let the string down gently. Repeat steps 1-5. The string is now latched into the trigger housing.

When properly cocked, the trigger safety automatically engages and the safety lever will move to the “Safe” position. After cocking, visually check to see if this has occurred. Never assume the safety is on.

Since a trigger mechanism and safety are mechanical devices, they can be subject to failure. Always keep a cocked and loaded crossbow pointed in a safe direction.



Legacy HD 175 Package Contents

(Sighting systems will vary by crossbow model)



Hardware Included



Included in the crossbow package are the following items:

- Stock Assembly
- Front End Assembly with 35 3/4" String (Lifetime Warranty Limbs)
- Cocking Stirrup
- Front End Mounting Bolt and Flat Washer
- Rail Lube
- 43 3/4" Slave String (not pictured)
- Optic (Scope and Rings or Red Dot)
- Quiver and Quiver Hardware Package
- 3 Arrows

Tools needed for assembly:

- 3/16" hex key (provided)

Legacy CS 225 Package Contents

(Sighting systems will vary by crossbow model)



Hardware Included



Included in the crossbow package are the following items:

- Stock Assembly
- Front End Assembly with 35 3/4" String (Lifetime Warranty Limbs)
- Cocking Stirrup
- Front End Mounting Bolt and Flat Washer
- Rail Lube
- 46 1/2" Slave String (not pictured)
- Optic (Scope and Rings or Red Dot)
- Quiver and Quiver Hardware Package
- 3 Arrows

Tools needed for assembly:

- 3/16" hex key (provided)



Assembly Instructions for the Legacy Bows

1. Holding the bow unit in one hand and the stock in the other, position the bow-string on top of the barrel and slide riser onto riser rod. See image 1.

2. As shown in image 2, install 1" long 5/16 - 18 front end mounting bolt (E-1) through the stirrup and the round flat washer (A-1). Screw the front end mounting bolt into the end of the riser hole. Tighten the front end mounting bolt with 5/16" Allen wrench until tight.

Now that the bow is assembled, go to Page 17 to read how to cock the bow.

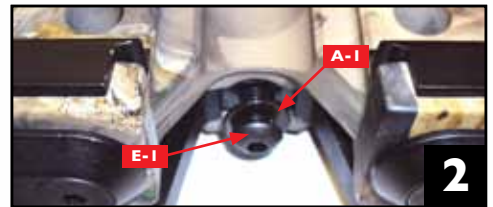

Legacy Recurve String Removal

STRING REMOVAL

1. Place the loops of the slave string OVER the standard string and onto the **second** string groove at the end of both limb tips. See image 1. Cock the crossbow with the slave string. The standard string will now be slack.

2. After twisting the new standard string 10 times in the same direction as the center serving is wrapped, place both looped ends of the string over the limb tips. Slide the looped end of the standard string through the looped end of the slave string. See image 1. Make sure the new string is placed in the limb tip groove closest to the end of the limb tip.

3. Place your foot securely in the cocking stirrup. Grasp the slave string firmly with one hand near the trigger mechanism. With the other hand, simultaneously move the safety to the "Fire" position and press the trigger gently allowing the standard string to move forward, relaxing the bow. The slave string may now be easily removed.

CAUTION: WHEN PERFORMING STEP 3, BE SURE TO HAVE A SECURE GRIP ON THE SLAVE STRING AS YOU WILL EXPERIENCE A SUDDEN, BUT MANAGEABLE, DOWNWARD PULL.

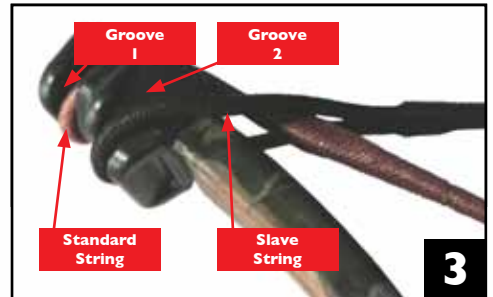

Legacy HD 175 / CS 225 String Changing and Maintenance

The factory installed bow string is set to provide the proper brace height of 2 1/2" - 3". The brace height is measured from where the barrel meets the riser to the string. See image 1. New replacement strings may have more than 3" of brace height until the string is shot several times. During the course of shooting, the string will stretch slightly, requiring additional twists to be added to the bow string. To adjust the brace height, the string will need to be removed in accordance with string removal instructions on Page 12. It is necessary to twist the string to increase the brace height or untwisting the string to decrease the brace height. Reinstall in accordance with string installation procedures below.

STRING INSTALLATION

1. When installing a new replacement bowstring, first twist the string several times in the same direction the center serving is wrapped. This will help hold the center serving tighter during shooting.

2. Place the looped ends of the slave string, which is longer than the standard string, OVER the standard string's looped ends and into the **second** limb tip groove from the end of the limb tip. See image 2. A small amount of tension will be necessary to keep the loops in place on the limb tip. Cock the crossbow with the slave string. Slave string lengths: Legacy 175# draw 43.5" - Legacy 225# draw 46.75"

3. With the crossbow cocked using the slave string, the standard string should easily slip off the limb tip. If the standard string can not be easily removed at this time, the slave string must be removed and made shorter by twisting it an additional 10 times. The slave string will need to be removed in accordance with string removal instructions on Page 12. With the slave string shortened by adding 10 additional twists, place it back on the limb tips and cock the crossbow again. The standard string should now be easily removed. If not, additional twisting of the slave string will be required until the standard string can be easily removed.

4. To install the standard string, see Page 12.

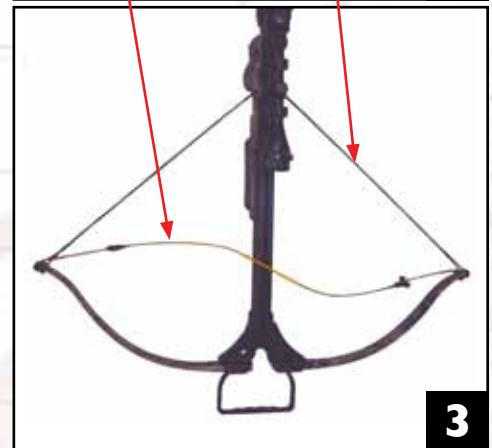
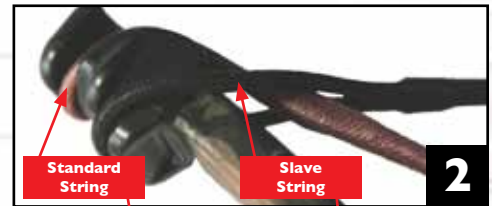
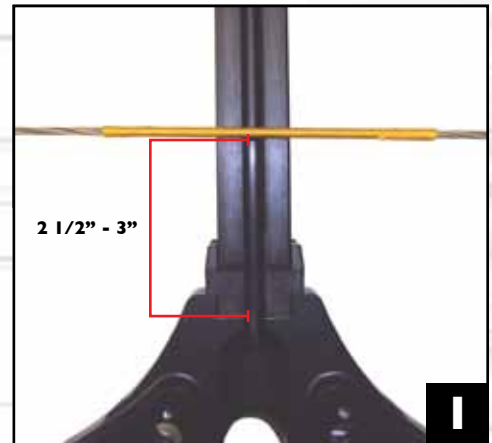



Team Realtree Ultra-Lite Express Package Contents

(Sighting systems will vary by crossbow model)



Included in the crossbow package are the following items:

- Stock Assembly
- Front End Assembly (3 Year Warranty Limbs)
- Cocking Stirrup
- Foot Stirrup Mounting Bolt and Flat Washer
- Rail Lube
- Optic (Scope and Rings or Red Dot)
- Quiver and Quiver Hardware Package
- 3 Arrows
- Cable Saver (Installed on cables)

Hardware Included



Tools needed for assembly:

- 3/16" hex key (provided)

Assembly Instructions for Team Realtree Ultra-Lite Express

1. Apply a very small amount of rail lube on the concave side of the polymer sable saver. The cable saver should be already located on the crossbow cables. Position the cable saver in the center of the cables with the concave side up.

2. Holding the bow unit in one hand and the stock in the other, position the bow string on the front and top of the barrel. See image 1. A small amount of downward pressure on the cables may be needed in order to align the cable saver with the front of the sable saver slot in the barrel.

3. After the cable saver is in the cable saver slot, slide the bow unit backward toward the stock until the riser fully seats onto the barrel. See image 2.

4. Position the cocking stirrup on the front of the riser, aligning the hole in the stirrup with the hole in the riser. See image 2. Place the cocking stirrup spacer onto the foot stirrup, making sure the hole in the spacer aligns with the hole in the stirrup. Insert the 1 1/4" long 5/16 - 18 mounting bolt through the hole in the cocking stirrup spacer and cocking stirrup and tighten until snug using the provided hex wrench. See image 3.

Now that the bow is assembled, go to Page 17 to read how to cock the bow.



Team Realtree Ultra-Lite Express Forearm Adjustment

The forearm of the TRT is designed to allow you to adjust the length of reach. The hand swell can be in the forward position (see image 1) or can be turned around so the hand swell is in the reverse position. The forearm is secured to the barrel with one 1" long and one 1 1/4" long Allen headed 10x24 machine bolts. By removing these two bolts, you may adjust the position of the forearm to a location that gives you the most comfortable shooting position. See image 2. Be sure when you replace the two 10x24 bolts into the threaded holes located on the bottom of the barrel that you do not over tighten the bolts. The forearm has been designed to be very wide and to extend down from the barrel to help insure shooters fingers or thumb is below the travel path of the string.

CAUTION: FAILURE TO INSURE YOUR FINGERS ARE BELOW THE TRAVEL PATH OF THE STRING WILL LIKELY RESULT IN INJURY TO THE SHOOTER.



Team Realtree Ultra-Lite Express Butt Stock Adjustment

The TRT stock is factory equipped with the medium length 1 1/4" long recoil pad. This will provide a 13 1/2" length of pull. The unique slide off ball detent recoil pad can quickly be changed to either the optional shooter 3/4" long pad or the 1 3/4" long recoil pad. See image 1. Changing the recoil pad is accomplished by pushing downward on the top of the recoil pad to release the pad from the ball detent locking system. See image 2. Replace the selected recoil pad by aligning the slide on the butt stock with the slide grooves on the recoil pad. Push the recoil pad upward until the ball detent lock locks the recoil pad in place.





Mounting Instructions for the Hunter Elite Crossbow Quiver

1. Install the quiver mounting plate (A) to the bottom of the riser using two of the four provided machined screws, using a 1/8" Allen head hex key.

2. Attach the quiver block (B) to the mounting bracket (A) as shown, using the two remaining machined screws. The opening in the quiver block may be placed with the opening to either the right or left side of the crossbow. The direction the quiver block is placed will determine if the quiver is placed in a left handed or right handed direction. The quiver block should be installed so the oval end of the top and bottom arrow spreaders (the ends with no arrow slot) are facing the cocking stirrup. Placing the quiver in this position will give the needed clearance so the user's foot does not hit an arrow in the quiver. By design the quiver hood does NOT contain foam that would dull the cutting blades of the broadheads.

3. Attach your quiver to the quiver base (B) by moving locking lever (C) to open the "Release" position. Insert the quiver dovetail (D) fully into the slot of the quiver base. Pivot the locking lever (C) to lock the quiver to the quiver base.

4. The top and bottom arrow spreaders each have three oval arrow holding slots. An arrow is held in the quiver by first placing the point of the arrow inside the quiver hood and then pressing the arrow into a slot of the top arrow spreader and then pressing the bottom of the arrow in the matching slot of the bottom arrow spreader.

Note: Team Realtree Ultra-Lite Express does not require mounting plate (A)

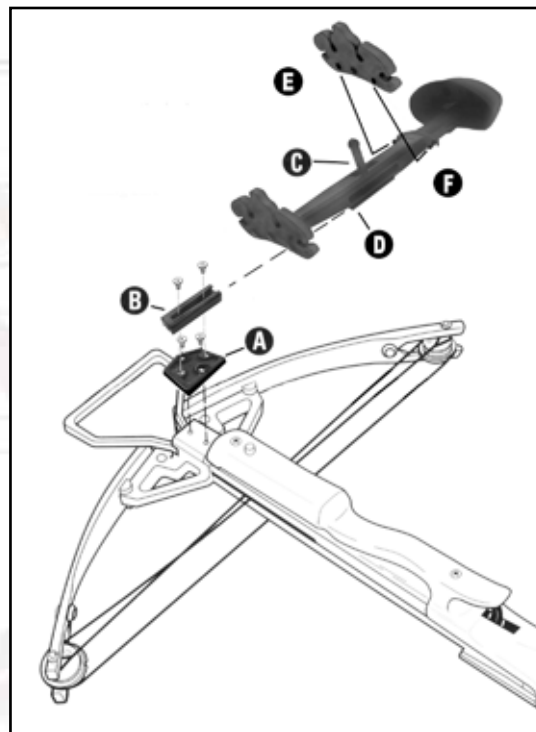



Cocking the Summit, Legacy, and TRT

DO NOT cock or load your crossbow unless you have read this entire owners manual. You also need to be in a safe and spacious range area and in a position to safely shoot. ALWAYS identify your target prior to shooting.

1. Before cocking, place the safety into the “Fire” position. See image 2. The safety will automatically engage after cocking. See image 1.

2. Place your foot securely through the foot stirrup. Reach over the stock and firmly grasp the string on both sides of the barrel. See image 3. Use your thumbs as guides along the sides of the barrel to automatically center the string during cocking. Failure to squarely cock the crossbow will cause inconsistent left to right accuracy.

3. With the safety in the “Fire” position, pull the string back under the arrow retention spring (see image 4) toward the rear of the sight bridge until the safety bar moves from the “Fire” position into the “Safe” position. After drawing, relax your hand tension slightly to ensure that the string has been captured by the trigger latch. DO NOT let go of the string completely. If the string is not held securely, let the string down gently. Repeat steps 1-3. The string is now latched into the trigger housing.

4. When properly cocked, the trigger safety automatically engages and the safety lever moves to the “Safe” position. However, after cocking, check that the safety has moved completely to the safe position by pushing the safety bar toward the “Safe” position. **NEVER ASSUME THE SAFETY IS ON.**



Loading, Shooting, and Unloading



Use of eye protection is recommended when shooting.

LOADING AND SHOOTING

1. With your crossbow pointed safely down range, place a Horton recommended size arrow, with odd colored fletching down in the flight groove. This will align the concave shape of the moon nock driver with the bow string. Slide the arrow backward toward the trigger assembly, under the arrow retention spring, until the arrow is pressed fully against the string. See image 1. **THE CROSSBOW IS NOW LOADED. HANDLE WITH EXTREME CAUTION.**

2. While still pointed safely down range, shoulder the crossbow, placing your front hand comfortably on the forearm of the stock with your fingers and thumb positioned below the travel path of cables and string. See image 3. Keep your aiming eye at least 2 1/2" away from the rear peep to avoid scope recoil. See image 2.



3. Remove the safety by pushing the safety lever forward to the "Fire" position. Take careful aim and squeeze the trigger smoothly to fire.

UNLOADING

Horton recommends that the safest way for one person to uncock his crossbow is to load a Horton de-cocking arrow and discharge the arrow into the ground. Be careful when firing into the ground that the area is free from rocks and other debris that may damage the arrow or cause it to ricochet.

REMEMBER: NEVER DRY FIRE YOUR CROSSBOW. SHOOTING WITHOUT A HORTON DE-COCKING ARROW WILL DAMAGE THE CROSSBOW AND MAY RESULT IN BODILY INJURY.

SHOOTING TIPS

When shooting, relax and hold the crossbow firmly but comfortably.

Your "off hand" accuracy will be greatly enhanced if you hold still and keep aiming until the arrow reaches its mark. The shooter must not move the crossbow to try to see the arrow while in flight.

Do not "cant" the crossbow. Keeping the limbs parallel to the horizon will significantly improve your accuracy.



Arrow Safety and Selection

Horton Archery has conducted extensive research and performed hundreds of hours of both bench and field testing to develop the most accurate and dependable crossbow arrows available.

1 ONLY use arrows recommended by Horton for use in your particular crossbow model. Shooting arrows of improper length, weight, materials, diameter or design is a

dangerous practice that could damage your crossbow or cause serious injury. Also, always check your arrows for cracks or damage before shooting.

2 Any deviation from the recommended Horton arrow will void your warranty. Arrow deviation may also damage the crossbow and result in injuries to the shooter and / or others.

Care and Maintenance

Your Horton crossbow is a quality, precision sporting weapon which requires occasional maintenance to ensure top performance. Prior to every outing, it is recommended that an overall safety check of cables, wheels, strings, arrows and screws be conducted.

1. Always maintain your crossbow string and cables. String and cable changes should be made each season or more often if needed. Horton crossbow string wax should be used frequently on unserved strands of the bow string to prolong its life. See image 1. In the event your string or cables have frayed, shows signs of excessive wear or strands

broken, replace them immediately. Installation of strings and cables MUST be performed using a crossbow bow press or serviced by a local dealer.

NEVER USE STRING WAX ON THE CENTER SERVING.

2. To reduce friction, increase arrow speed and greatly increase string life, apply a very light coat of Rail Lubricant™ over the entire length of the top of the barrel approximately every 25 shots. See image 2.



Recommended Arrows

For best arrow flight, there are many factors that must be considered to achieve the most accurate arrow performance from your crossbow. Horton aluminum arrows have been tested considering the grade of the aluminum alloy used. Carbon arrows are evaluated for how much of the arrow is carbon fiber, fiberglass filler or epoxy. Other factors such as mass weight, spine and front of center (FOC) balance point are also considered. It has been found that the optimum FOC for a crossbow arrow is about 12% compared to around 9% for an arrow used in a vertical bow. The FOC is critical to achieve the best broadhead groups to assure perfect shot placement. For this reason, Horton's MX and Bone Collector™ arrows utilize custom weighted inserts to achieve perfect balance.

For these reasons, all crossbow arrows are NOT the same. Select the correct arrow for your crossbow and demand a Horton arrow.

Sighting In Using a Dial-A-Range

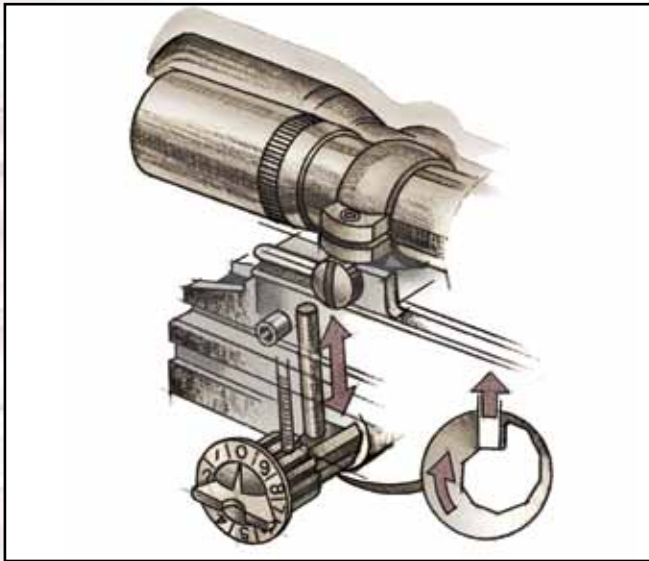

The Dial-A-Range is an internal, gross elevation adjustment feature that contains 10 positive click reference stops that will compensate for trajectory at varying yardages.

The exclusive ambidextrous feature delivers precision arrow placement at random yardages and reduces the need for sight hold-over and hold-under found typical to most other crossbow sighting systems. The Dial-A-Range allows for simple, quick, and quiet sight adjustment. Simply turn the Dial-A-Range knob to the predetermined setting. The built-in positioning system ensures accurate repeatability and will not move during recoil.

Although the Dial-A-Range may be used with the standard Rear Peep and Front Pin system, its full potential is realized when used in conjunction with a scope or red dot type sight.

After mounting your scope and rings according to the manufacturer's instructions, remove the elevation and windage turret caps from your scope. With a coin, set the elevation adjustment in the middle of its ranges. This is accomplished by turning the elevation adjustment clockwise until it stops. Then, reverse 3 1/2 complete turns. This procedure will enable you to move the point of impact approximately 4" up or down as needed during your final 20 yard sight in.

Next, proceed to the target range. For best results, utilize a bench rest to eliminate most human error when shooting. Be sure the rest does not interfere with the limbs, cables,

or string of the crossbow. Be sure your range is located in a safe and spacious area and that you have a suitable target and backdrop designed for use with a crossbow.

With your crossbow safely cocked, loaded and pointed down range, shoot one arrow with the Dial-A-Range in the "0" setting, one at the "1" setting and one at the "2" setting at a distance of 10 yards. Each arrow will impact approximately 4"-6" apart depending on your crossbow model.

Using a Dial-A-Range setting that was closest to the bullseye, shoot a group of three arrows and adjust the left or right windage setting accordingly until the group of arrows impact directly above or below the bullseye.

Remember, 10 clicks = 1/4" of movement at 10 yards.

Next, move to a distance of 20 yards. Shoot another three arrow group. Use the internal scope elevation adjustments to raise or lower the group to dead zero. (5 clicks = 1/4" of movement at 20 yards). Your sighting-in procedure is now complete.

You now can confirm the distance that each setting represents. Raise the Dial-A-Range setting one number and step back until your impact point is on target (approximately 30 yards). Repeat again, advance the setting by one number at approximately 40 yards. Although you can continue to shoot at longer distances with higher Dial-A-Range settings, this is the longest setting necessary for a hunting situation. Horton does NOT recommend attempting any shot at big game in excess of 40 yards.

Remember, no two bows are alike. Arrow weight, bow weight, point weight and style, and type of fletching all affect trajectory. Generally, one number up or down on the Dial-A-Range will equal 8-10 yards of trajectory.

Multi-A-Range Scope Instructions



MOUNTING

1. Attach the scope rings to the dovetail scope mount and securely fasten. **DO NOT** over tighten.
2. Remove the top half of both rings and position the scope in the lower portion of the rings. Fasten the top half of the rings back onto the lower half of the ring, over the scope tube. Do not completely tighten the rings at this time.
3. Before tightening the scope rings, slide the scope forward as far as the rings will allow and sight through the scope with the crossbow shouldered. Looking through the scope, slowly slide the scope backward just until you can see the full field of view. This is the best position to assure maximum eye relief.

WARNING: Crossbows recoil when shot. A scope's eyepiece may cause injury to a shooter's eye or eyebrow if the relief is mounted too close to the shooter's eye. In addition, shooting at an uphill angle or other positions can increase the hazard by shortening the eye relief. For this reason, we recommend mounting for maximum eye relief. Always make sure the crossbow is correctly and firmly shouldered when firing.

4. Being careful not to change the eye relief position, rotate the scope until the elevation adjustment knob is positioned at top-center, the Horton logo on the left side and the windage adjustment knob on the right. Check that the horizontal crosshair is parallel with the crossbow string while the vertical crosshair is aligned with the vertical axis of the crossbow. When you are satisfied that everything is squared up, tighten the scope ring screws evenly and firmly. **DO NOT** over tighten.



FOCUSING

When looking through the scope, the reticle should appear very sharp and solid black. If it does not, your scope needs to be focused for your eyes. If another shooter uses your scope, he / she should refocus the scope for his / her eye. Once the scope is focused, all objects sighted from 10

yards to infinity will appear equally sharp. There is no need to adjust focus for different distances.

1. To change the focus, it will be necessary to adjust the eyepiece lens assembly. The best way to accomplish this is to grasp the eyepiece with your hand and back it away from the eyepiece locking ring before loosening the eyepiece locking ring. See image 1.

2. Turn the eyepiece out, counterclockwise. Several turns will be needed to achieve any measurable effect on the focus because the eyepiece threads are very fine.

CAUTION: Do not remove or unscrew the eyepiece from the scope tube. If the eyepiece is totally removed, you will destroy the fog-proof seal.

3. Look through the scope at a bright background such as the sky or a well lighted wall. Turn the eyepiece clockwise until the reticle comes into focus. When satisfied with your focus adjustment, lock the eyepiece in place by turning the locking ring up tight against the eyepiece.

TWO YEAR WARRANTY

Horton's Multiple Reticle crossbow scope is covered by a 2 year warranty. This warranty is granted to the original owner of the crossbow scope and is not transferable. Warranty obligation is limited to the repair and replacement of any part or parts returned to Horton Archery LLC and which are determined by Horton to adversely affect the satisfactory operation of the scope in the stated warranty period.



Red Dot Sight Instructions

MOUNTING

Horton's 3 dot red dot optics are made with two different mounting bases.

The universal style model red dot can be used on any crossbow that is equipped with a standard 7/8" Weaver style base. See image 1. Horton's red dots that are equipped with the integral mounting base can ONLY be used on Horton crossbows. See image 2.

Activate the illuminated dots (dot) by turning the rheostat knob (battery compartment) clockwise. The lowest numbers on the knob represent the dimmest settings. Higher numbers increase brightness. "0" position is "OFF". On LiteRite models, the "A" setting indicates the unit is in the "Auto" mode. The sight will adjust brightness settings based upon the amount of available light.

HINT: While hunting, use the lowest illumination setting possible that produces clear dot visibility. Too high of a setting will cause the dots to blur.

SIGHTING IN

Proceed to the range and follow the instructions on page 20 of this manual. For 3-dot models, elevations are made to the top dot only for 20 yard range. After "zeroing" is complete, the second dot will impact at approximately 30 yards and the bottom dot will impact at approximately 40 yards (+/-). Exact impact will vary depending upon poundage, arrow weight, speed, fletching style and other factors.

BATTERY INFORMATION

To install, unscrew the battery compartment cover (B) and insert the battery positive (+) side up. Replace the cover. If the illuminated reticle dims or does not light, replace the 3-Volt Lithium Battery, type 2032.

ONE YEAR LIMITED WARRANTY

Horton Archery, LLC will warranty its red dot optics against defects in material and workmanship for a period of one year from date of purchase. Horton reserves the right to repair or replace the product at its discretion. Refer to the instructions on the back cover of this manual for service or warranty assistance during the warranty period.

To see the full line of Horton specialty optics, visit www.hortonarchery.com.



7/8" Weaver Style



Integral Style



25mm Single Dot



Multi-A-Range 3 Dot



LiteRite 3 Dot

Usage:

- A. Rear Lens
- B. Battery Compartment / Rheostat Knob
- C. Elevation Adjustment
- D. Front Lens
- E. LiteRite™ Eye



HOW TO USE THIS CHART AND COLOR CODE SYSTEM

The strings and cables are identified by model number and color code. The selections can also be found on the left side of the limb back on all newer bow models.

REPLACEMENT STRINGS

Select models of strings have been manufactured with color coded end servings (the loop end) corresponding to a bow model listed in the chart.

REPLACEMENT CABLES

In several selections, the string and cable colors will match. However, there are some variations in the color codes. Be certain to use the charts and the model number for verifications. (For example: ST071 / White Cable).

Note: All previous “tear drop” cable systems are obsolete and should be upgraded to an ICAD equivalent. To convert Bracketed models, use item #ST108. To convert Split Limb (SL) models, use item #ST109. These kits include a complete wheel, cable and string assembly upgrade.

Non-Bracketed Compound Crossbow Models	String/Color	Cable/Color
Vision 175	ST860 (none) - 31 1/2”	ST861 (none)
Summit HD 150	ST019 Black - 33 3/4”	ST009 Black
Team Realtree HD 175 - Hybrid	ST140 Red - 34 3/4”	ST071 White
Recurve Bow Models	String	
Legacy HD 175	ST030 - Slave String: ST037	N/A
Legacy CS 225	ST030 - Slave String: ST031	N/A



Arrow Ballistics Chart

20" Aluminum - 100 Grain Point
Total Arrow Weight - 438 Grains

F.P.S. - FT/LBS	10 Yards	20 Yards	30 Yards	40 Yards
275 / 73.5	-2"	-10"	-22"	-39"
300 / 87.5	-2"	-8"	-18"	-34"
325 / 102.7	-2"	-7"	-16"	-29"
350 / 119.1	-1"	-6"	-14"	-25"

International Distributors

Dear Valued Customer,

If your crossbow purchase was made outside the USA, please contact the Horton Distributor in your country for warranty and service. If a distributor is not listed in your country, contact the Horton Distributor nearest you.

AUSTRALIA

Alcock & Pierce Pty. Ltd.
642 Elizabeth Street
63-71 Bayfield Road East
Melbourne, 3000 Victoria
Australia
Tel: +61-(03) 9347 8044
Fax: +61-(03) 9347 4168
E-mail: rb@alcockandpierce.com.au
Website: <http://alcockandpierce.com.au>

BELGIUM

SSA Sporting Goods Co.
Neringstraat 2
8370 Blankenberge
Belgium
Tel: +32 (0)50 427240
Fax: +32 (0)50 427245
E-mail: info@ssa-archery.be

CANADA

Monsens Sporting Goods Ltd.
619 The Queensway
Peterborough, Ontario K9J 7B1
Canada
Tel: 705-748-6811
Tel: 705-748-5090
E-mail: sales@monsens.ca

FINLAND

Tera-Asekeskus, Ltd.
J&P Raunion Automaatit Oy
Keskustie 9-11
05400 Jokela
Finland
Tel: +358 9 417 2900
E-mail: info@teraasekeskus.com
Website: <http://www.teraasekeskus.com>

FRANCE

Unifrance Services
ZE de Recoux
16800 Soyaux
France
Tel: +33 (0) 5.45.69.09.09
Fax: +33 (0) 5.45.68.73.37
E-mail: unifrance@unifrance.fr

GERMANY

BLACK FLASH Archery GmbH
Saalfelder Str. 1
D-07333 Unterwellenborn / KOENITZ
Germany
Tel: +49 (0) 36 732-20 89 0
Fax: +49 (0) 36 732-20 89 13
E-mail: mail@BLACK-FLASH-ARCHERY.de



International Distributors

HUNGARY

Magnum Vadasz es Hajos Ltd.
H-1095 Budapest
Soroksari u. 164.
Hungary
Tel: +36 1 280-8311
E-mail: magnumbp@magnum90.hu

ITALY

Bignami S.p.A
Via Lahn, 1
39040 Ora / Auer (BZ)
Italy
Tel: +39-0471-803000
Fax: +39-0471-810899
E-mail: email@bigarchery.it
Website: <http://www.bigarchery.com>

NEW ZEALAND

NZAP (New Zealand Archery Products)
23A Packham Crescent
Stoke, Nelson 7011
New Zealand
Tel: +64 3 538 0511
Fax: +64 3 538 0512
E-mail: info@nzap.co.nz
Website: <http://www.nzap.co.nz>

SWITZERLAND

Strebel Bogensport AG
Grabenhofstr. 16
CH-6010 Kriens-Luzern
Switzerland
Tel: +41 41 210 18 28
Fax: +41 41 210 63 22
E-mail: info@strebel-bogensport.ch
Website: <http://www.strebel-bogensport.ch>



Limited Lifetime Operational Warranty

Horton Archery's products are covered by a Limited Lifetime Warranty.* Components warranted for lifetime of the original owner are the crossbow's trigger, wheels or cams, stock, sight bridge, dovetail and cocking stirrup. Limbs are covered by either a three (3) year warranty or a lifetime warranty for the original owner. The limb warranty for each model crossbow is listed in the owner's manual in the "Package Contents" section. Further limb warranty information is available in Horton Archery's product catalog and on Horton's website at www.hortonarchery.com.

*Horton Archery, for any reason, including but not limited to the availability of parts and / or camo pattern reserves the right to make substitutions on warranty coverage.

Warranty is limited and does not include the replacement of string and cables. Horton Archery's warranty obligation is limited to the repair or replacement of product(s) that are determined by Horton Archery to not be functioning adequately. This warranty applies to the original owner of the bow and is non-transferable.

The original owner must complete the product warranty card within 30 days of purchase date to validate the warranty. Please note that products can be registered online at www.hortonarchery.com/warranty-form.php or by returning the warranty card provided.

Horton Archery reserves the right to require proof of purchase to support warranty claims. We assume no liability for any incidental or consequential damages or incidental expenses. Some states do not allow such exclusions therefore, this limitation may not apply to certain customers. Warranty is not to be made or authorized by any of our dealers, distributors or representatives other than those specifically retained by Horton Archery. Any attempt to alter, dismantle or change the standard specifications of the bow, other than specified in the instruction booklet, will void this warranty.

SERVICE AND WARRANTY RETURN PROCEDURE

To file a warranty claim or to have maintenance work performed on your crossbow, you **must** obtain a Return Merchandise Authorization (RMA) number by either contacting Customer Service at 330-474-5710 or by completing the form online at www.hortonarchery.com/rma-form.php. When returning the product(s), the RMA number must be marked on the outside of the package. Include the defective product with brief description of the problem and return to:

Horton Archery, LLC
4430 Crystal Parkway
Kent, Ohio 44240

HORTON HAS THE RIGHT TO REFUSE ANY RETURNED PRODUCT IF THERE IS NO RMA WRITTEN ON THE OUTSIDE OF THE BOX.

To avoid delays, customers should include their phone number, physical street address and Return Merchandise Authorization number.

The product is to be returned to Horton Archery at the customer's expense, and we recommend insuring the shipment and obtaining a tracking order. Once repaired, Horton Archery will return only warranty product to the customer at the company's expense. Non-warranty repairs will be returned at the customer's expense.

Horton Archery, LLC
4430 Crystal Parkway
Kent, Ohio 44240

(330) 474-5710
www.hortonarchery.com