

kogan

KAVAC20TRBA

USER MANUAL



IMPORTANT SAFETY INSTRUCTIONS

When using an electrical appliance, basic precautions should always be followed, including the following:

READ ALL INSTRUCTIONS BEFORE USING THIS APPLIANCE

WARNING - To reduce the risk of fire, electric shock, or injury:

1. Do not leave vacuum cleaner when plugged in. Unplug from outlet when not using and before servicing.
2. To reduce the risk of electric shock, do not use outdoors or on wet surfaces.
3. Use only as described in this manual. Use only manufacturers recommended attachments.
4. Do not use with damaged cord or plug. If vacuum cleaner is not working as it should, has been dropped, damaged, left outdoors, or dropped into water, return it to a service centre.
5. Do not pull cord, use cord as a handle, close door on cord, or pull cord around sharp edges or corners. Do not run vacuum cleaner over cord. Keep cord away from heated surfaces.
6. Do not unplug by pulling on cord. To unplug, grasp the plug, not the cord.
7. Do not handle plug or vacuum cleaner with wet hands.
8. Do not put any object into openings. Do not use with any opening blocked. Keep free of dust, lint, hair and anything that may reduce airflow.
9. Keep hair, loose clothing, fingers and all parts of body away from openings and moving parts.
10. Turn all controls off before unplugging.
11. Use extra care when cleaning on stairs.
12. Do not use to pick up flammable or combustible liquids, such as gasoline, or use in areas where they may be present
13. Hold plug when rewinding onto cord reel. Do not allow plug to whip when rewinding.
14. Unplug before connecting the hose
15. Do not pick up anything that is burning or smoking, such as cigarettes, matches or hot ashes.
16. Do not use without dust bag and/or filter in place.
17. If the supply cord is damaged, it must be replaced by the manufacturer or its service agent or a similarly qualified person in order to avoid a hazard.

COMPONENTS AND EQUIPMENT

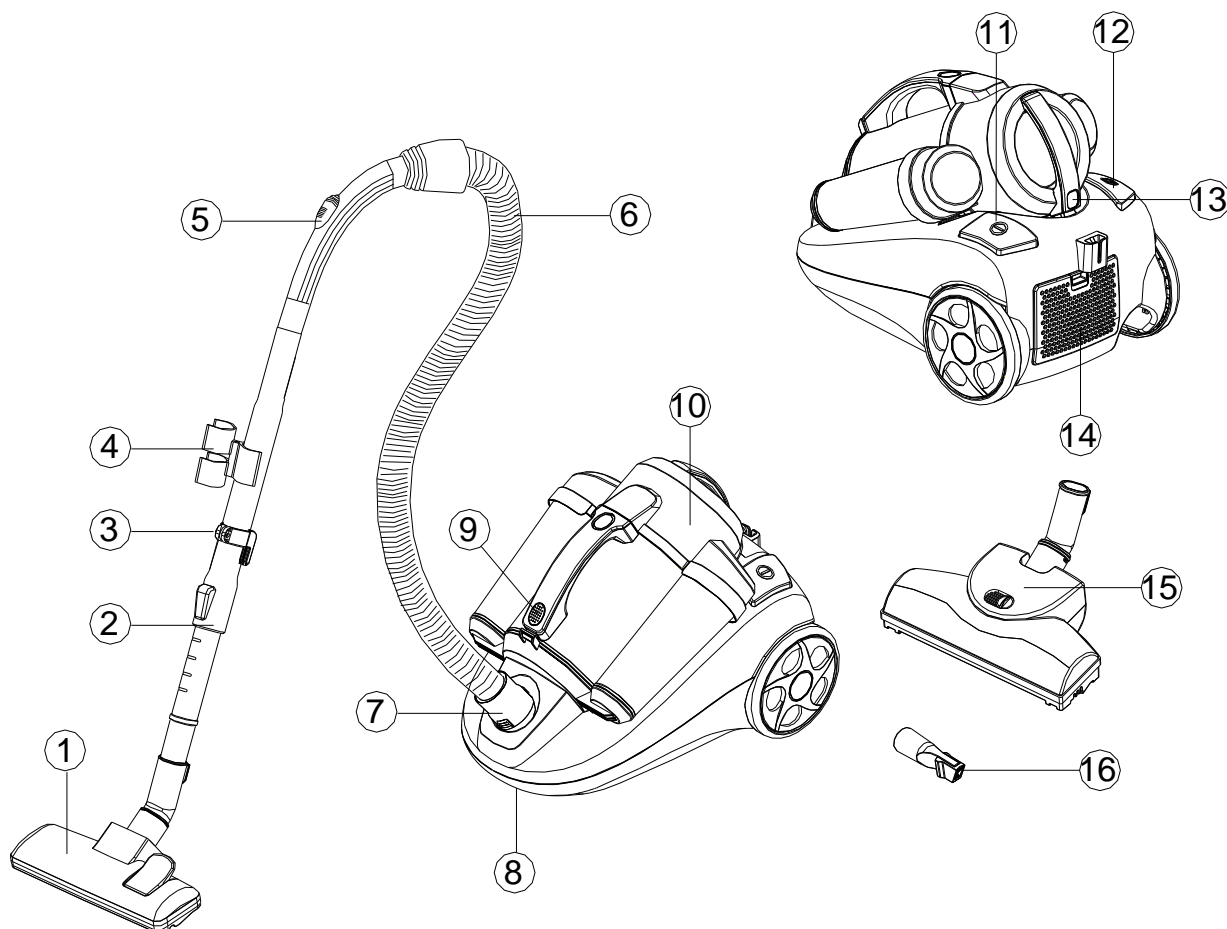

1. Floor Nozzle
2. Telescopic Tube
3. Parking Fixture
4. Storage Clip
5. Air Slide
6. Suction Hose
7. Suction Hose Connection
8. Carrying Handle
9. Dust release Button
10. Dust Container
11. ON/OFF Button
12. Cord rewind Button
13. Dust container Release Button
14. Exhaust Cover
15. Turbo Brush
16. Crevice Nozzle

PREVENTION

Switch off the vacuum cleaner immediately if the air intakes, the floor brushes or the telescopes tube becomes blocked. Before starting the vacuum cleaner up again remove the substance causing the blockage:

1. Never use the vacuum cleaner in the immediate vicinity of hot bodies and do not suck up hot objects such as cigarette ends or ashes.

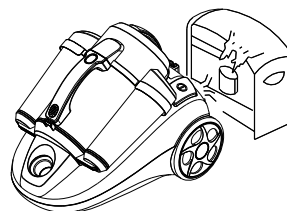

2. Only place the plug in the socket when your hands are dry.

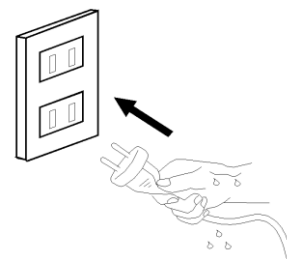

3. Please remove large or sharp objects from the floor before using the vacuum cleaner to avoid any possible damage to it.

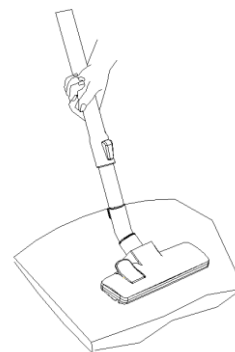

4. Do not pull by the mains cable when pulling out the plug.

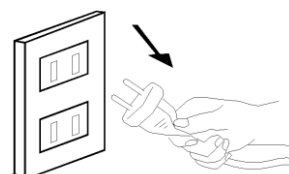

PREPARING THE VACUUM CLEANER

1. Fit the hose on the vacuum cleaner by inserting the rotating hose connection into the vacuum cleaner until you hear a click. To remove the hose, press the button at the side of the hose connection and pull it out.

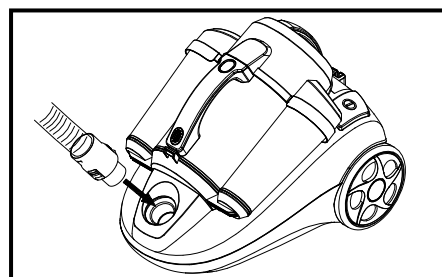

2. Assembling the telescope tube and accessories

2.1: Fit the telescopic tube into the other end of the hose.

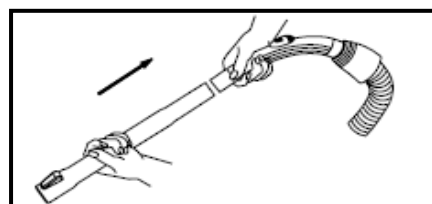

2.2: Adjust the length of the telescopic tube by pushing the locking mechanism down and pulling the bottom section of the tube to a suitable length. When parking, shorten the tube as far as possible.

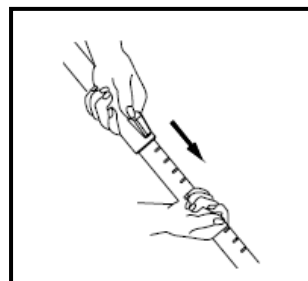

2.3: Fit the floor brush into the telescope tube.

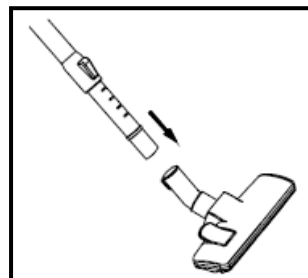

Floor Nozzle

The floor nozzle has two settings. When cleaning hard surfaces (parquet flooring, flooring tiles, etc.), the nozzle brushes should be extended. When cleaning carpets and mats, the brushes should be retracted into the nozzle. Press the brush change button to switch between the two settings.

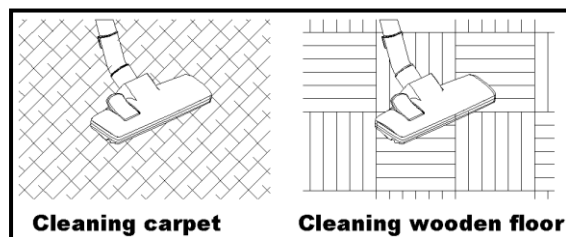

Joint nozzle

For radiators, corners, skirtings, etc.

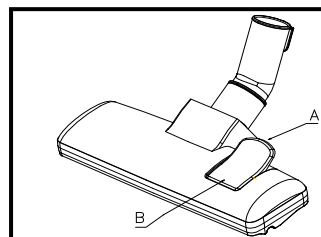
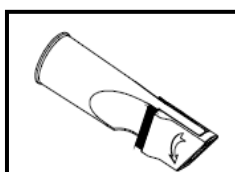



USE

Vacuum cleaning

1. Before using the device first roll out a sufficient length of electric cable and plug into the mains socket. The yellow mark on the electric cable is the maximum length that must not be exceeded.

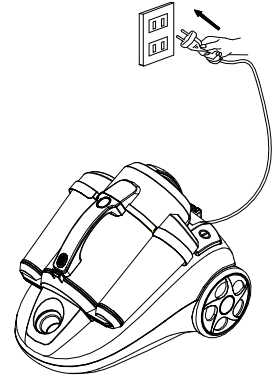
To switch on the device press the foot pedal button  on the casing with your foot



2. To rewind the power cable, press the button  with hand or foot and guide the cable with the other hand to ensure that it does not whip causing damage.

Emptying dust container

Empty the dust container at the latest when the sucked in quantity of dirt in the dust container has reached the “MAX” mark.

1. Switch off the vacuum cleaner and disconnect the plug from the mains.
2. Release the dust container by pressing down the release button.
3. Lift the dust container forwards out of the cylinder vacuum cleaner.
4. When emptying the dust container, hold it low over a dustbin.
5. Press the open button. The base opens and the dust runs into the dustbin.
6. Carefully knock the remaining dust loose.
7. Close the base.
8. Place the dust container onto the cylinder vacuum cleaner.
9. Check whether the dust container is securely seated.

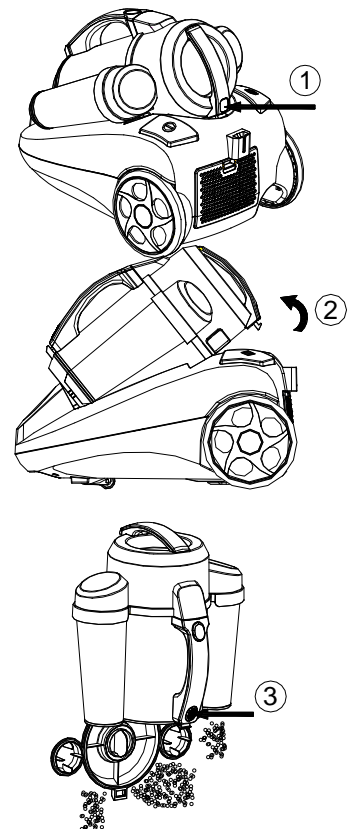

Cleaning the motor filter

1. Turn off and unplug cleaner.
2. Remove the dust container.
3. Release the filter cover and remove it.
4. Hold the protective motor filter together with the holder over a dustbin. Only then should you separate both parts from each other. For a rough clean, gently knock both parts over a dustbin.
5. Insert the dry protective motor filter back into its holder.
6. Place protective motor filter together with the holder back into its receptacle.
7. Replace the filter cover by hooking it precisely from above first. the engage the lock by pressing it until audibly clicks into place.
8. Place the dust container onto the cylinder vacuum cleaner.
9. Check whether the dust container is securely seated.

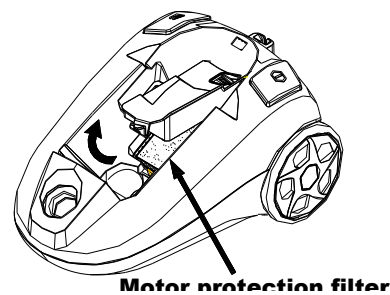

IMPORTANT! Never use the vacuum cleaner without a motor filter.

Cleaning the exhaust air filter

The exhaust air filter cleans the air a final time before it leaves the vacuum cleaner. You can clean the exhaust air filter as follows:

1. Switch off the vacuum cleaner and disconnect the plug from the mains.
2. Open the exhaust air grill (this is at the rear of the vacuum cleaner.)
3. The exhaust air filter is visible when the grill has been opened.
4. Rinse the filter under cold running water and allow to dry.
5. Put the exhaust air filter back into place (or replace with a new one) and place in the grill.
6. Close the exhaust air filter grill.

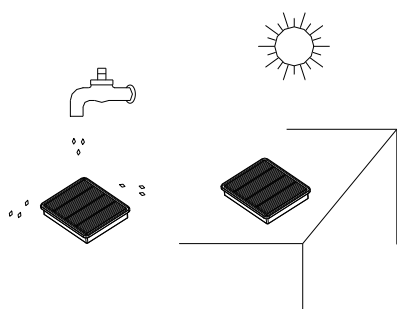
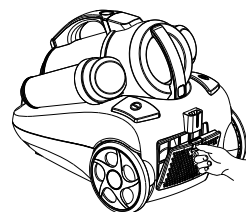

Transport and Storage

1. You can lift and carry the vacuum cleaner using the carrying handle. Never pull or lift the vacuum cleaner by the cord.
2. Before putting the vacuum away, rewind the cord. Switch off the socket, unplug, and press the cord rewind button until the cord is fully rewound.
3. To save space, the vacuum can be stored upright on its end cover. The telescopic tube can be hung on the vacuum cleaner by inserting the parking fixture into the vertical parking holder.

Cleaning

Clean the vacuum cleaner by wiping it with a damp cloth.

You must not use any form of strong, solvent or abrasive cleaning agent.

Environmental tips

Once any electronic product is no longer functional, it should be disposed of in such a way as to cause minimum environmental impact, in accordance with the regulations of your local authority. In most cases you can take such products to your local recycling station.

