



# **AVer Rugged Bullet type Camera**

## **Installation Guide**



# **Table of Contents**

<b>IMPORTANT SAFEGUARD.....</b>	<b>1</b>
<b>PACKAGE CONTENTS .....</b>	<b>2</b>
<b>THE FOLLOWING ITEMS ARE INCLUDED IN THE PACKAGE. ....</b>	<b>2</b>
<b>OPTIONAL ACCESSORIES .....</b>	<b>2</b>
<b>RUGGED BULLET IP CAMERA PARTS .....</b>	<b>3</b>
<b>MOUNTING THE IP CAMERA.....</b>	<b>4</b>
DEPLOYING NETWORK .....	4
Network Connection via Ethernet Switch .....	4
Power over Ethernet Connection .....	5
CONNECTING EXTERNAL DEVICES TO I/O TERMINAL BLOCK .....	6
POWER LED.....	6
INTERNAL CONNECTION DIAGRAM OF DI/DO .....	6
MOUNTING THE IP CAMERA .....	7
FOCUSING THE IP CAMERA WITH BNC MONITOR .....	9
INSERT MICROSD CARD TO SYSTEM.....	10
<b>HARDWARE RESET .....</b>	<b>11</b>
<b>TECHNICAL SPECIFICATIONS .....</b>	<b>12</b>
FB2028-T1 (E)/FB2028-T2 (E)/FB2028-TM (E) .....	12
FB3028-RT1 (E)/FB3028-RT2 (E)/FB3028-RTM (E).....	16
<b>COPYRIGHT .....</b>	<b>20</b>
<b>NOTICE.....</b>	<b>20</b>
<b>WARNING .....</b>	<b>20</b>
<b>GOVERNING LAW AND YOUR RIGHTS .....</b>	<b>22</b>

## Important Safeguard

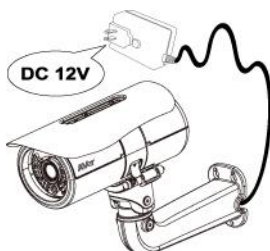

Do not use power supply with different voltage other than DC12V/PoE.

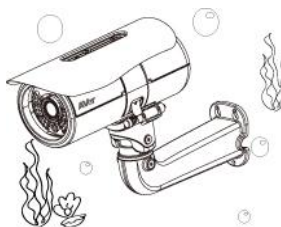

Do not submerge the unit in the water.



Unplug the power of this unit as soon as smoke or unusual odor is detected.



Unplug the power supply before cleaning. Use only a lens cleaning cloth and never use benzene, thinner, or other solvent for cleaning.

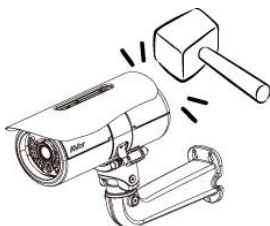

Do not attempt to service this unit by yourself. Always refer all servicing to qualified service personnel.



Do not place the unit in unsteady surface and also do not drop the unit.

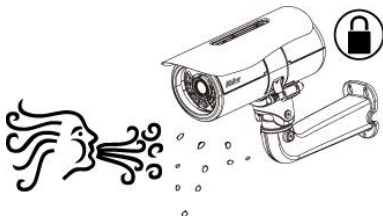

Keep the IP camera housing close and prevent the dust from getting in the housing.

# Package Contents

The following items are included in the package.

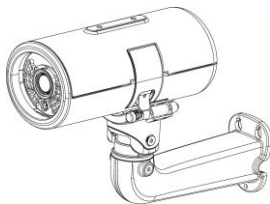

Aver rugged bullet type camera



Software & Manual CD

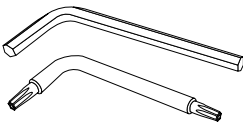

2 L-type Wrenches

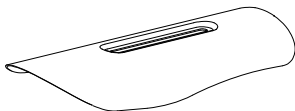

Sun Shield

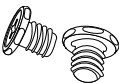

2 Sun Shield Bolts



Torx Pin Head Bolt

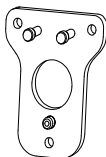

Wall Mount Bracket

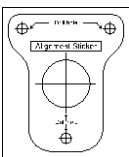

Alignment Sticker



3 Screws



3 Washers

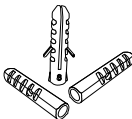

3 Plastic Anchors



Hex Socket Cap Bolt

# Optional Accessories

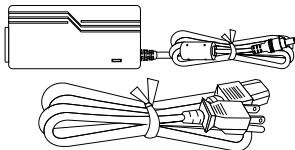

Power Adapter (12V, 4A) and Power cord

\* The power adapter will vary depending on the standard power outlet of the country where it is sold. Depending on your package the power adapter maybe included.

## Rugged Bullet IP Camera Parts

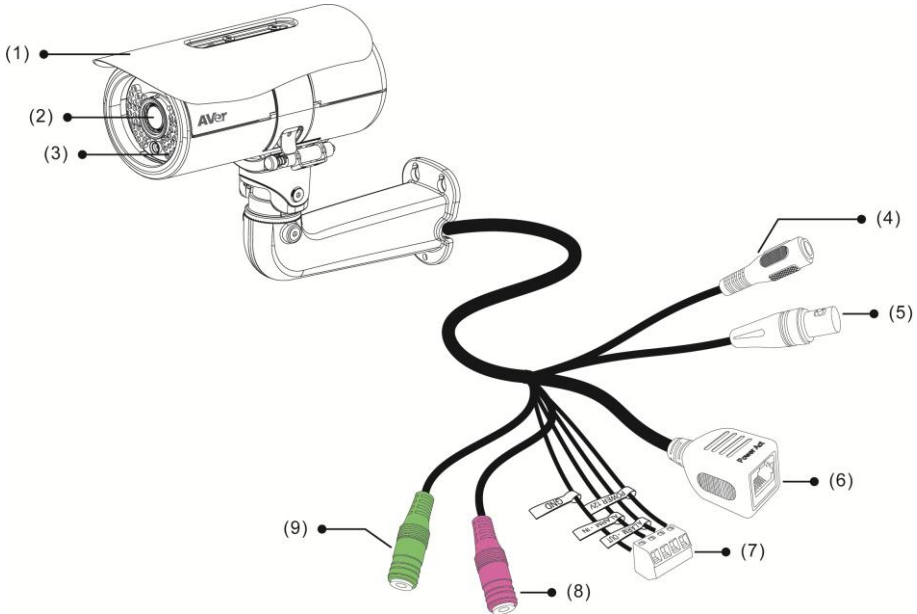

No.	Function	No.	Function
(1)	Sun Shield	(6)	BNC Jack (Video Out)
(2)	Camera Lens	(7)	RJ45 Ethernet Jack
(3)	Light Sensor	(8)	I/O Terminal Block
(4)	Latch	(9)	Phone Jack (Audio In)
(5)	Power Jack	(10)	Phone Jack (Audio Out)

## Mounting the IP Camera

This section provides useful tips on how to adjust the IP camera to meet your needs.

### Deploying Network

#### Network Connection via Ethernet Switch

- Connect the RJ45 cable from the Ethernet switch to RJ45 Ethernet jack of camera

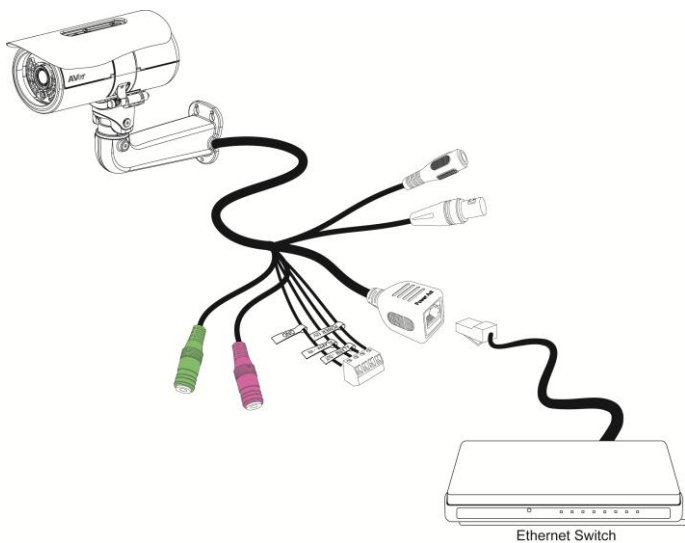

- Connect the power adapter to power jack of camera.

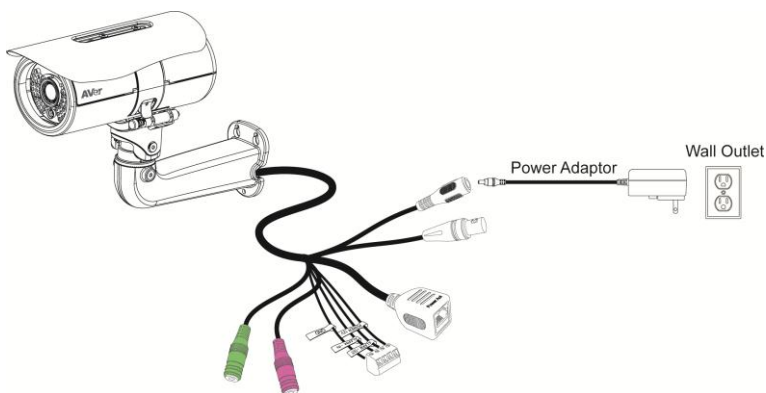

## **Power over Ethernet Connection**

Rugged bullet type camera is fully complies with PoE standard. It allows you to use PoE enabled switch or PoE injector to transmit data and power thru single Ethernet cable.

### ■ PoE Enabled Switch Connection Diagram

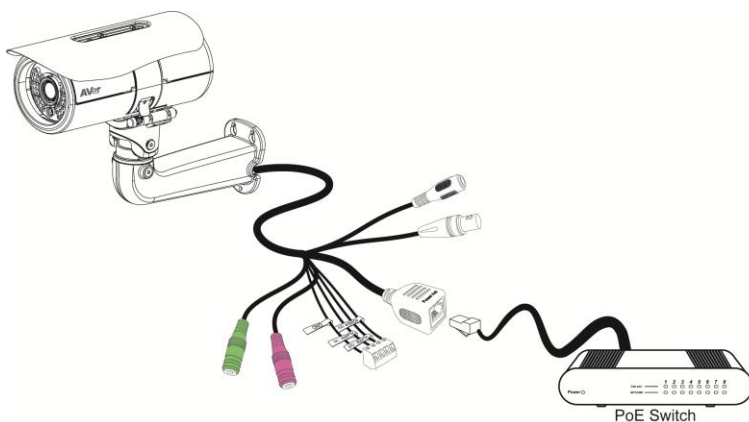

### ■ PoE Injector Connection Diagram

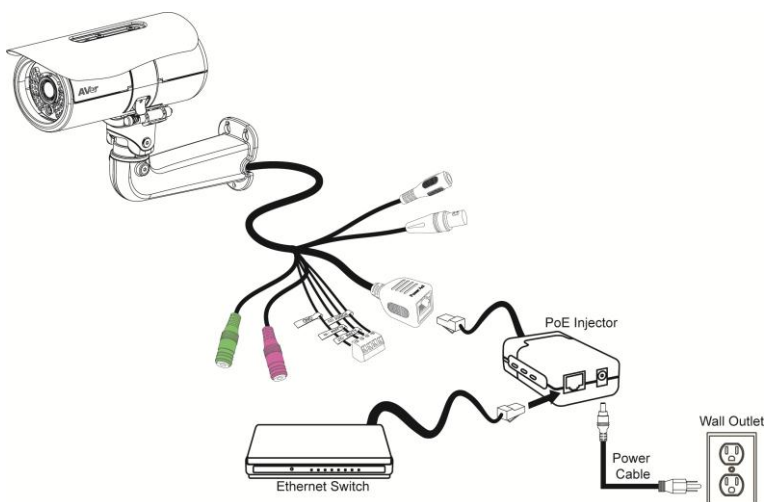

## Connecting External Devices to I/O Terminal Block

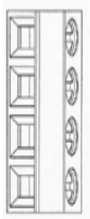

- 1 Power 12V
- 2 Digital output
- 3 Digital input
- 4 Ground

No.	Function
(1)	Power 12V
(2)	Digital Output
(3)	Digital Input
(4)	Ground

**[Note]** Maximum power output is 12V/100mA

## Power LED

LED	Status
Steady Red	Heating
Blinking Green	System working
Steady Green	Booting
	Firmware updating
No Light	Power off

## Internal Connection Diagram of DI/DO

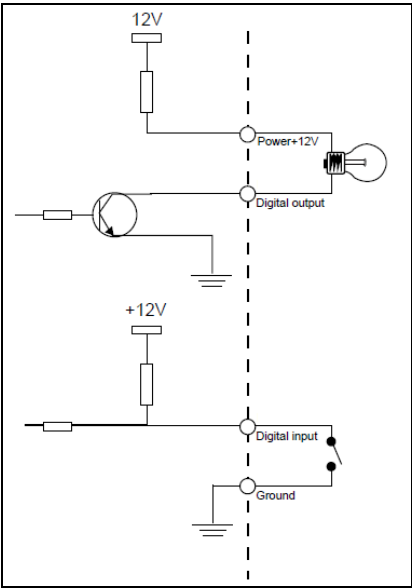



## Mounting the IP Camera

1. Use the supplied 2 sun shield bolts and secure the sun shield on the IP camera.
2. Place the sticker on the wall surface. Then spot the mark and drill the 4 holes indicated on the sticker. It's not necessary to drill the biggest hole if you are going to run the wire on the side.
3. Insert the 3 plastic anchors in the wall. Place the washer on the 3 screws and secure the mounting bracket on the wall.
4. Hook the IP Camera and use the hex socket cap bolt to secure the IP camera on the mount bracket.

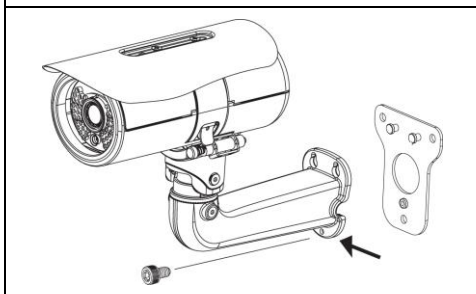
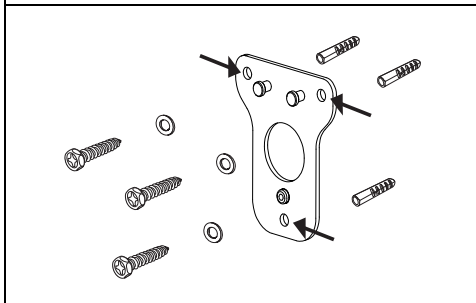
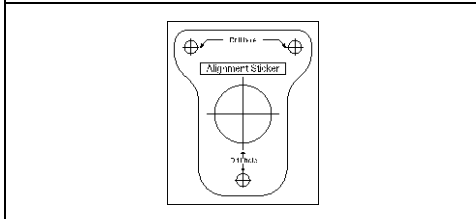
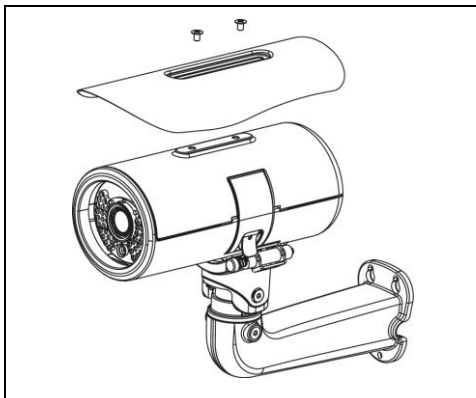

5. After adjusting the focus and zoom control, use the torx pin head bolt to secure the IP camera from being tampered.

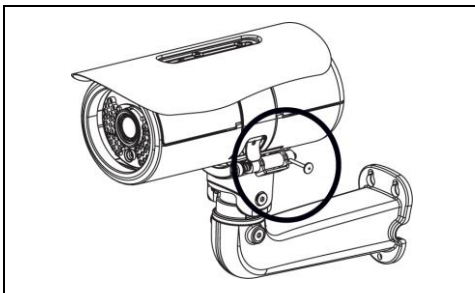

## Focusing the IP Camera with BNC Monitor

The IP camera is supported with BNC analog video out jack which allows you to connect an analog display devices such as an LCD BNC monitor for you to adjust the camera focus and zoom.

1. Connect the LCD BNC monitor to the BNC jack.

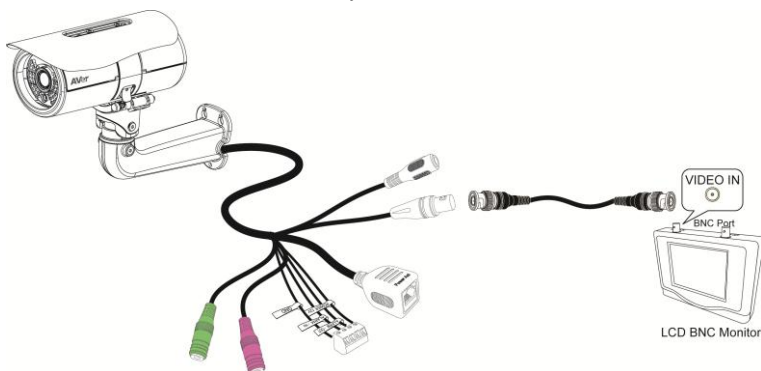

2. Open up the IP camera case.

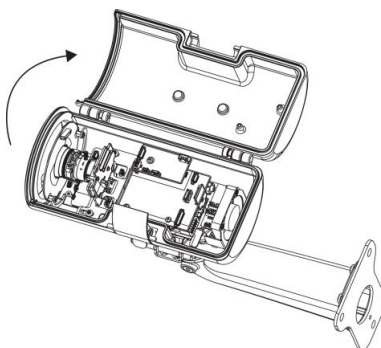

3. Slightly loosen the focus and zoom control knobs and adjust the focus and zoom range. Slightly tighten the focus and zoom knobs once you are done adjusting.

Focus Knob & Control

Zoom Knob & Control

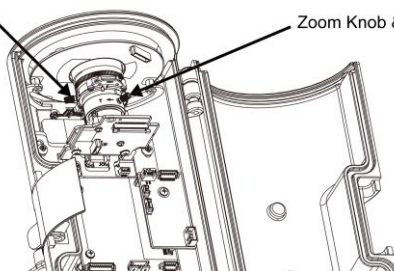

## Insert microSD Card to System

1. Open up the IP camera case.

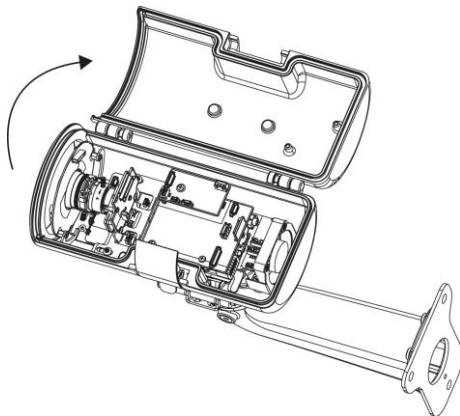

2. Insert microSD card

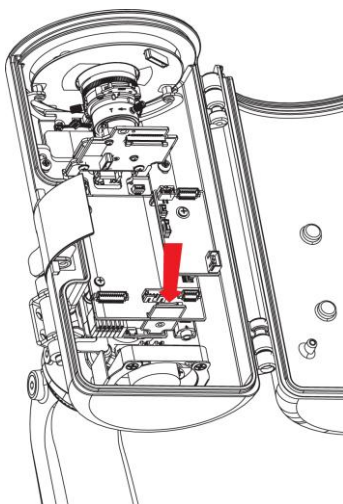

**[Note]** We recommend to use industrial grade microSD card (support operating temp from -40°C to 85°C) for extreme temperature condition.

## Hardware Reset

1. Open the IP camera case.

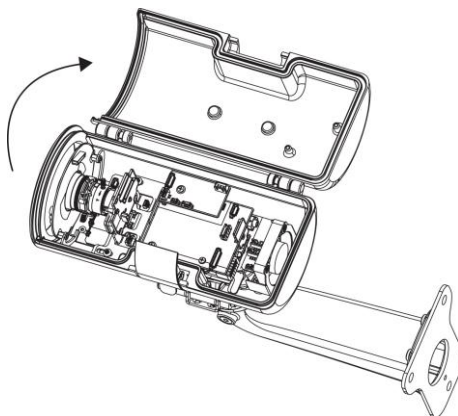

2. Short PJ1 pins around 10 seconds.



### **WARNING!!**

This will cause all the configuration settings back to factory default.

# Technical Specifications

FB2028-T1 (E)

FB2028-T2 (E)

FB2028-TM (E)

Model	FB2028-T1 (E)	FB2028-T2 (E)	FB2028-TM (E)
Lens spec.	CBC AG3Z0312LMRP-N	CBC AG2.3Z1016LMRP-N	CBC AGP3Z0312LMRP-E111T51
Lens type	Vari-focal Lens (Board mount, M19)		
F/no	F/1.2	F/1.6	F/1.2
Iris type	DC Iris		
Focal length	f3~9mm	f10~23mm	f3~9mm
View Angle	H 90.6°(W)~41.9°(T) V 51.5°(W)~24.5°(T)	H 27°(W)~14.8°(T) V 15°(W)~8.3°(T)	H 90.6°(W)~41.9°(T) V 51.5°(W)~24.5°(T)
MFZ Support	N/A	N/A	Yes
Camera image			
Min. illumination	0.2 Lux in day mode (IR off)	0.3 Lux in day mode (IR off)	0.2 Lux in day mode (IR off)
	0.03 Lux in night mode (IR off)	0.04 Lux in night mode (IR off)	0.03 Lux in night mode (IR off)
	0 Lux in night mode (IR on)	0 Lux in night mode (IR on)	0 Lux in night mode (IR on)
Built-in LED	Yes		
IR distance	30m	50m(DC In only)	30m
Built-in mechanical ICR	Yes		
Auto IRIS	Yes		
Video			
Compression	H.264/MPEG-4/MJPEG		
Max. resolution	1920 x 1080		
Frame rate	1920 x 1080 @ 30fps		
H.264/MPEG-4 bit rate mode	VBR, 5 levels CBR, 64/128/512/768Kbps & 1/2/3/4/6/8/10/12Mbps		
MJPEG quality	5 levels		
Regional of Interest	Yes		
Smart Stream	Yes, 5 windows		

Model	FB2028-T1 (E)	FB2028-T2 (E)	FB2028-TM (E)
Video			
Image orientation	mirror, flip		
Motion Detection zones	3		
Privacy mask areas	3		
BLC	Yes		
D-WDR	Yes		
De-noise	2D/3D		
Day & night function	Auto/Manual/Schedule		
ePTZ	Yes		
Corridor Mode	Yes		
Cross Detection	Yes		
Audio			
Encoder	G.711 (μ-law)/G.726 (bit rate 16K~64bps) /AAC audio compression		
Streaming	2-ways audio		
Microphone	External microphone input		
Network			
Protocols	CP/IP (IPv4/IPv6), HTTP, HTTPS, UPnP, SMTP, FTP, DHCP, NTP, DDNS, PPPoE, Samba, QoS, SNMP(V1/V2c/V3), 802.1X		
Ethernet	10/100 Base-T, RJ45 connector		
ONVIF	V2.X (Profile S), conformance test V12.06		
Security	Password protection/IP Filter		
Users	up to 10 users simultaneously		

Model	FB2028-T1 (E)	FB2028-T2 (E)	FB2028-TM (E)
Event			
Profiles	32 sets		
Triggers	Alarm Interval, Motion Detection Region, Digital Input, SD Card, Network		
Actions	Trigger: Digital Output, Alarm Audio		
	Send out video clip: FTP, NAS, SD card		
	Send out snapshot / log: FTP, NAS, SD card, mail		
Interface			
Digital input/output	1/1		
BNC Video output	Yes		
Built-in storage option	Micro SDHC & SDXC card (64GB max.)		
External microphone input	Yes		
External Audio output	Yes		
General			
Power supply	DC 12V(4A)/PoE		
Power consumption	<b>PoE (TYP.):</b>	<b>PoE (TYP.):</b>	<b>PoE (TYP.):</b>
	6.7W (LED/Heater off)	6.7W (LED/Heater off)	6.7W (LED/Heater off)
	10.0W (LED on, Heater off)	10.0W (LED on, Heater off)	10.0W (LED on, Heater off)
	22.0W (LED off, Heater on)	23.9W (LED off, Heater on)	22.5W (LED off, Heater on)
	23.1W (LED/Heater on)	24.3W (LED/Heater on)	23.6W (LED/Heater on)
	<b>DC-IN (TYP.)</b>	<b>DC-IN (TYP.):</b>	<b>DC-IN (TYP.):</b>
	5.7W (LED/Heater off)	5.7W (LED/Heater off)	5.7W (LED/Heater off)
	8.5W (LED on, Heater off)	13.5W (LED on, Heater off)	8.5W (LED on, Heater off)
	33.8W (LED off, Heter on)	34.7W (LED off, Heter on)	34.3W (LED off, Heter on)
	35.8W (LED/Hearer on)	41.1W (LED/Hearer on)	36.3W (LED/Hearer on)
PoE	PoE Class 4 (IEEE802.3at)		
Dimensions	265.2mm x 114.5 mm x 111mm(L x H x W) w/o bracket		
Net weight	2180g		



Model	FB2028-T1 (E)	FB2028-T2 (E)	FB2028-TM (E)
General			
Temperature and humidity	PoE		
	-25°C~60°C, 20%~90% Cold Start		
	-40°C~60°C, 20%~90% Operating		
	12V/4A DC-In		
	-25°C~60°C, 20%~90% Cold Start		
	-60°C~60°C, 20%~90% Operating		
IP Rating	IP68		
Software Requirement			
OS	Windows® XP/7/8		
Browser	IE 8/9/10/11 (Full Function), Chrome Firefox and Safari (Basic Function)		
Firmware remote upgrade	Yes (via HTTP)		
Bundled Software			
ExpressGO	free up to 32CH		
IPCAM Utility	Yes		
SecureCenter	Yes		
Warranty			
Main body	3 years		
Accessories	1 year		

## ■ FB3028-RT1 (E)/FB3028-RT2 (E)/FB3028-RTM (E)

Model	FB3028-RT1 (E)	FB3028-RT2 (E)	FB3028-RTM (E)
Lens spec.	CBC AG3Z0312LMRP-N	CBC AGP3Z0312LMRP -E111T51	CBC AGP3Z0312LMRP
Lens type	vari-focal Lens (Board mount, M19)		
F/no	F/1.2	F/1.6	F/1.2
Iris type	DC Iris		
Focal length	f3~9mm	f10~23mm	f3~9mm
View Angle	H 73.2°(W)~35°(T) V 51.5°(W)~24.5°(T)	H 22.8°(W)~12.4°(T) V 17°(W)~9.3°(T)	H 73.2°(W)~35°(T) V 51.5°(W)~24.5°(T)
MFZ Support	N/A	N/A	Yes
Camera image			
Min. illumination	0.8 Lux in day mode (IR off)	1.2 Lux in day mode (IR off)	0.8 Lux in day mode (IR off)
	0.1 Lux in night mode (IR off)	0.15 Lux in night mode (IR off)	0.1 Lux in night mode (IR off)
	0 Lux in night mode (IR on)	0 Lux in night mode (IR on)	0 Lux in night mode (IR on)
Built-in LED	Yes		
IR distance	25m	50m(DC In only)	25m
Built-in mechanical ICR	Yes		
Auto IRIS	Yes		
Video			
Compression	H.264/MPEG-4/MJPEG		
Max. resolution	2048 x 1536		
Frame rate	2048 x 1536 @ 20fps (Wide Angle) 1920 x 1080 @ 30fps (Normal mode)		
H.264/MPEG-4 bit rate mode	VBR, 5 levels CBR, 64/128/512/768Kbps & 1/2/3/4/6/8/10/12Mbps		
MJPEG quality	5 levels		
Regional of Interest	Yes		

Model	FB3028-RT1 (E)	FB3028-RT2 (E)	FB3028-RTM (E)
Video			
Smart Stream	Yes, 5 windows		
Image orientation	mirror, flip		
Motion Detection zones	3		
Privacy mask areas	3		
BLC	Yes		
Sensor-WDR	Yes		
De-noise	2D/3D		
Day & night function	Auto/Manual/Schedule		
ePTZ	Yes		
Corridor Mode	Yes		
Cross Detection	Yes		
Audio			
Encoder	G.711 (μ-law)/G.726 (bit rate 16K~64bps) /AAC audio compression		
Streaming	2-ways audio		
Microphone	External microphone input		
Network			
Protocols	TCP/IP (IPv4/IPv6), HTTP, HTTPS, UPnP, SMTP, FTP, DHCP, NTP, DDNS, PPPoE, Samba, QoS, SNMP(V1/V2c/V3), 802.1X		
Ethernet	10/100 Base-T, RJ45 connector		
ONVIF	V2.X (Profile S), conformance test V12.06		
Security	Password protection/IP Filter		
Users	up to 10 users simultaneously		

Model	FB3028-RT1 (E)	FB3028-RT2 (E)	FB3028-RTM (E)
Event			
Profiles	32 sets		
Triggers	Alarm Interval, Motion Detection Region, Digital Input, SD Card, Network		
Actions	Trigger: Digital Output, Alarm Audio		
	Send out video clip: FTP, NAS, SD card		
	Send out snapshot / log: FTP, NAS, SD card, mail		
Interface			
Digital input/output	1/1		
BNC Video output	Yes		
Built-in storage option	Micro SDHC & SDXC card (64GB max.)		
External microphone input	Yes		
External Audio output	Yes		
General			
Power supply	DC 12V(4A)/PoE		
Power consumption	PoE (TYP.):	PoE (TYP.):	PoE (TYP.):
	6.7W (LED/Heater off)	6.7W (LED/Heater off)	6.7W (LED/Heater off)
	10.0W (LED on, Heater off)	10.0W (LED on, Heater off)	10.0W (LED on, Heater off)
	22.0W (LED off, Heater on)	23.9W (LED off, Heater on)	22.5W (LED off, Heater on)
	23.1W (LED/Heater on)	24.3W (LED/Heater on)	23.6W (LED/Heater on)
	DC-IN (TYP.)	DC-IN (TYP.)	DC-IN (TYP.)
	5.7W (LED/Heater off)	5.7W (LED/Heater off)	5.7W (LED/Heater off)
	8.5W (LED on, Heater off)	13.5W (LED on, Heater off)	8.5W (LED on, Heater off)
	33.8W (LED off, Heter on)	34.7W (LED off, Heter on)	34.3W (LED off, Heter on)
	35.8W (LED/Hearer on)	41.1W (LED/Hearer on)	36.3W (LED/Hearer on)
PoE	PoE Class 4 (IEEE802.3at)		
Dimensions	265.2mm x 114.5 mm x 111mm(L x H x W)		

Model	FB3028-RT1 (E)	FB3028-RT2 (E)	FB3028-RTM (E)
General			
Net weight	2180g		
Temperature and humidity	PoE		
	-25°C~60°C, 20%~90% Cold Start		
	-40°C~60°C, 20%~90% Operating		
	12V/4A DC-In		
	-25°C~60°C, 20%~90% Cold Start		
	-60°C~60°C, 20%~90% Operating		
IP Rating	IP68		
Software Requirement			
OS	Windows® XP/7/8		
Browser	IE 8/9/10/11 (Full Function), Chrome, Firefox and Safari (Basic Function)		
Firmware remote upgrade	Yes (via HTTP)		
Bundled Software			
ExpressGO	free up to 32CH		
IPCAM Utility	Yes		
SecureCenter	Yes		
Warranty			
Main body	3 years		
Accessories	1 year		

## **COPYRIGHT**

© 2014 AVer Information Inc. All rights reserved.

All rights of this object belong to AVer Information Inc. Reproduced or transmitted in any form or by any means without the prior written permission of AVer Information Inc. is prohibited. All information or specifications are subject to change without prior notice. "AVer" is a trademark owned by AVer Information Inc. Other trademarks used herein for description purpose only belong to each of their companies.

## **NOTICE**

SPECIFICATIONS ARE SUBJECT TO CHANGE WITHOUT PRIOR NOTICE. THE INFORMATION CONTAINED HEREIN IS TO BE CONSIDERED FOR REFERENCE ONLY.

## **WARNING**

TO REDUCE RISK OF FIRE OR ELECTRIC SHOCK, DO NOT EXPOSE THIS APPLIANCE TO RAIN OR MOISTURE. WARRANTY VOID FOR ANY UNAUTHORIZED PRODUCT MODIFICATION.



THE MARK OF CROSSED-OUT WHEELED BIN INDICATES THAT THIS PRODUCT MUST NOT BE DISPOSED OF WITH YOUR OTHER HOUSEHOLD WASTE. INSTEAD, YOU NEED TO DISPOSE OF THE WASTE EQUIPMENT BY HANDING IT OVER TO A DESIGNATED COLLECTION POINT FOR THE RECYCLING OF WASTE ELECTRICAL AND ELECTRONIC EQUIPMENT. FOR MORE INFORMATION ABOUT WHERE TO DROP OFF YOUR WASTE EQUIPMENT FOR RECYCLING, PLEASE CONTACT YOUR HOUSEHOLD WASTE DISPOSAL SERVICE OR THE SHOP WHERE YOU PURCHASED THE PRODUCT.

## **Limited Warranty**

AVer Information, Inc. ("AVer") warrants that the applicable product ("Product") substantially conforms to AVer's documentation for the product and that its manufacture and components are free of defects in material and workmanship under normal use. "You" as used in this agreement means you individually or the business entity on whose behalf you use or install the product, as applicable. This limited warranty extends only to You as the original purchaser. Except for the foregoing, the Product is provided "AS IS." In no event does AVer warrant that You will be able to operate the Product without problems or interruptions, or that the Product is suitable for your purposes. Your exclusive remedy and the entire liability of AVer under this paragraph shall be, at AVer's option, the repair or replacement of the Product with the same or a comparable product. This warranty does not apply to (a) any Product on which the serial number has been defaced, modified, or removed, or (b) cartons, cases, batteries, cabinets, tapes, or accessories used with this product. This warranty does not apply to any Product that has suffered damage, deterioration or malfunction due to (a) accident, abuse, misuse, neglect, fire, water, lightning, or other acts of nature, commercial or industrial use, unauthorized product modification or failure to follow instructions included with the Product, (b) misapplication of service by someone other than the manufacturer's representative, (c) any shipment damages (such claims must be made with the carrier), or (d) any other causes that do not relate to a Product defect. The Warranty Period of any repaired or replaced Product shall be the longer of (a) the original Warranty Period or (b) thirty (30) days from the date of delivery of the repaired or replaced product.

## **Limitations of Warranty**

AVer makes no warranties to any third party. You are responsible for all claims, damages, settlements, expenses, and attorneys' fees with respect to claims made against You as a result of Your use or misuse of the Product. This warranty applies only if the Product is installed, operated, maintained, and used in accordance with AVer specifications. Specifically, the warranties do not extend to any failure caused by (i) accident, unusual physical, electrical, or electromagnetic stress, neglect or misuse, (ii) fluctuations in electrical power beyond AVer specifications, (iii) use of the Product with any accessories or options not furnished by AVer or its authorized agents, or (iv) installation, alteration, or repair of the Product by anyone other than AVer or its authorized agents.

## **Disclaimer of Warranty**

EXCEPT AS EXPRESSLY PROVIDED OTHERWISE HEREIN AND TO THE MAXIMUM EXTENT PERMITTED BY APPLICABLE LAW, AVER DISCLAIMS ALL OTHER WARRANTIES WITH RESPECT TO THE PRODUCT, WHETHER EXPRESS, IMPLIED, STATUTORY OR OTHERWISE, INCLUDING WITHOUT LIMITATION, SATISFACTORY QUALITY, COURSE OF DEALING, TRADE USAGE OR PRACTICE OR THE IMPLIED WARRANTIES OF MERCHANTABILITY, FITNESS FOR A PARTICULAR PURPOSE OR NONINFRINGEMENT OF THIRD PARTY RIGHTS.

## **Limitation of Liability**

IN NO EVENT SHALL AVER BE LIABLE FOR INDIRECT, INCIDENTAL, SPECIAL, EXEMPLARY, PUNITIVE, OR CONSEQUENTIAL DAMAGES OF ANY NATURE INCLUDING, BUT NOT LIMITED TO, LOSS OF PROFITS, DATA, REVENUE, PRODUCTION, OR USE, BUSINESS INTERRUPTION, OR PROCUREMENT OF SUBSTITUTE GOODS OR SERVICES ARISING OUT OF OR IN CONNECTION WITH THIS LIMITED WARRANTY, OR THE USE OR PERFORMANCE OF ANY PRODUCT, WHETHER BASED ON CONTRACT OR TORT, INCLUDING NEGLIGENCE, OR ANY OTHER LEGAL THEORY, EVEN IF AVER HAS ADVISED OF THE POSSIBILITY OF SUCH DAMAGES. AVER'S TOTAL, AGGREGATE LIABILITY FOR DAMAGES OF ANY NATURE, REGARDLESS OF FORM OF ACTION, SHALL IN NO EVENT EXCEED THE AMOUNT PAID BY YOU TO AVER FOR THE SPECIFIC PRODUCT UPON WHICH LIABILITY IS BASED.

**Governing Law and Your Rights**

This warranty gives you specific legal rights; You may also have other rights granted under state law. These rights vary from state to state.