

# OPERATING AND USERS MANUAL

EN

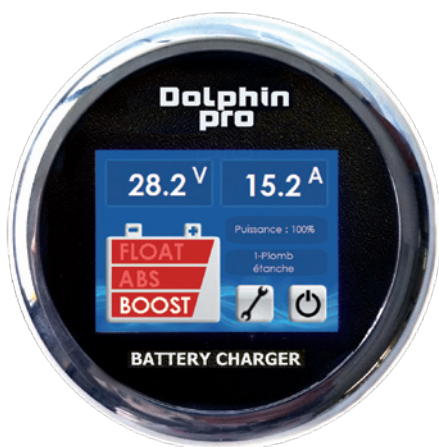

## TOUCH VIEW

Battery charger  
controller

Accessory for  
DOLPHIN Pro charger





**TO PREVENT ANY RISK OF ELECTRIC SHOCK OR FIRE, READ THIS MANUAL CAREFULLY BEFORE INSTALLING THE DEVICE.**

In the event of any problems or unclear points, please contact Reya.

This equipment is not designed for use by people (including children) with diminished physical, sensory or mental capacities or people without experience or knowledge of such equipment, unless they have received instructions in the use of the equipment from a person responsible for their safety or are under the supervision of such a person. Ensure that children are supervised to avoid them playing with the device.

This equipment contains components that may cause electric arcs or sparks, when connecting cables for example. To prevent any risk of fire or explosion, do not install this equipment close to inflammable materials, liquids or gases.

#### **Precautions for installation.**



To prevent any risk of irreversible damage to the equipment, ensure that you follow the recommendations below scrupulously.

- ▶ This device must not be exposed to dripping water, splashes or dust of any nature.
- ▶ In no sense is this device a toy.
- ▶ It should not be left in the hands of a child.

#### **Precautions for connection.**



To prevent any risk of electric shock or irreversible damage to the equipment, ensure that you follow the recommendations below.

The installation to which the device is connected must conform to applicable standards.

To prevent undesirable heating, ensure that cable cross-sections are correct and that connectors are properly tightened.

#### **Precautions when switching on.**



To prevent any risk of electric shock when switching on or during operation, you should comply strictly with the following instructions.

The product should not be disassembled under any circumstances.

This device complies with the applicable regulations governing transmitted interference and immunity from external disturbances.

TOUCHVIEW-01

TOUCHVIEW-01

## ON RECEIPT OF THE PRODUCT

### Contents of the packaging

Please check the contents of the package when opening:



► TouchView box with colour touch screen



► Chrome bezel



► Connection cable (3 m)



► Bag of fixing screws

► User manual

## GENERAL CHARACTERISTICS

TouchView is an accessory used to supervise and control the DOLPHIN PRO range of 12V and 24V chargers.

TouchView is simple to connect; it is supplied directly from the charger.

TouchView may be used remotely (in the cab for example), to view the charging status from a distance.

TouchView has a non-volatile memory allowing configuration settings to be stored, even when there is no power, when it is reactivated.

Its intuitive navigation allows the user to become familiar with it very quickly.

## QUICK INSTALLATION GUIDE

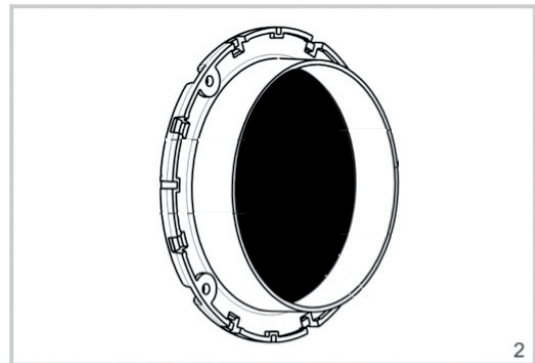
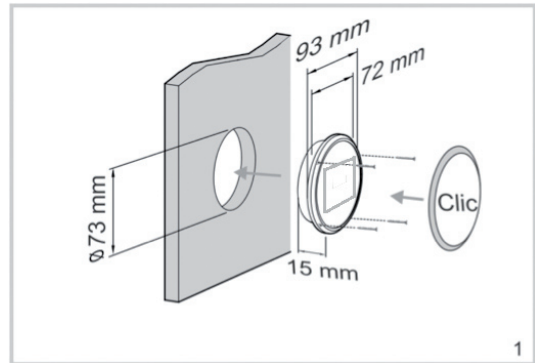

Clipping on the bezel

Position the bezel  
Press firmly



Unclipping the bezel

Use a tool (screwdriver) as a lever



Do not push against the screen



TERMINAL CONNECTIONS

Wiring	No
Supply + (8 to 16V)	1
CAN H	2
CAN L	3
0V	4

Connection cable between the charger and TouchView:

Wiring	
Yellow	Supply +
Green	CAN H
Red	CAN L
Black	0V

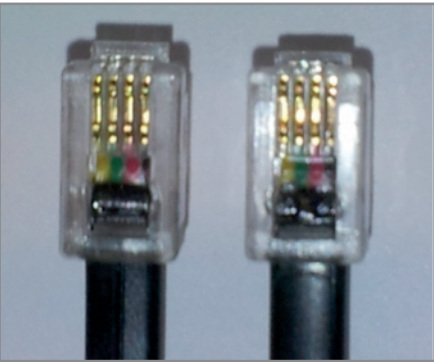

PRECAUTIONS TO TAKE WHEN INSTALLING

Any connection error could result in irreversible damage to the equipment.

You should, therefore, give this aspect particular attention.

# TECHNICAL SPECIFICATIONS





TOUCHVIEW-01

## Technical specifications

POWER SUPPLY	
Supply voltage	12V dc (8 to 16V)
Consumption	150 mA approx. at maximum brightness and 50mA with the screen turned off
DISPLAY	
Type of display	2.4 inch TFT screen with 320x240 pixel resolution and adjustable backlight
Parameter selection	Touch screen
SCREEN PARAMETERS	
Languages	Choice of five languages English, French, Italian, Spanish, German
Screen background	Configurable: three available colours
Screen brightness	Adjustable
CHARGER PARAMETERS DISPLAY	
Charger output voltage	Measurement accuracy $\pm 1\%$
Charger current	Measurement accuracy $\pm 1\%$
Charging phases	Boost, Abs, Float
Current cycle charging time	Hours: Minutes
Selected charging cycle type	10 different types
Battery temperature	-10°C to +100°C (measurement accuracy $\pm 2\%$ )
Charger temperature	-10°C to +100°C (measurement accuracy $\pm 2\%$ )
CONFIGURATION PARAMETERS	
Charger maximum power	Four levels: 30%, 50%, 70%, 100%
Relay output polarity	Default to on or off
Activation / Deactivation of the charger	Switching the charger on or off

# TECHNICAL SPECIFICATIONS EN

TOUCHVIEW-01

PICTOGRAM ALARM FUNCTIONS	
Battery or electronics temperature fault	
Charger supply voltage fault	
Fuse fault	
Charger output voltage fault	
CAN bus fault	
GENERAL	
Operating temperature	-10°C to +50°C
Storage temperature	-20°C to +70°C
Relative humidity	10% to 70% condensation free
Electronics	Resin tropicalised
Presentation	Flush-mounting device, 93 mm diameter
Flush mounting	72 mm dia. (use a 73 mm hole saw) depth 15 mm
Fixing	Four screws supplied
Overall dimensions (width x height x depth)	93 mm dia. x 23 mm
Weight	< 500 g
Connection	RJ9 connector

USE

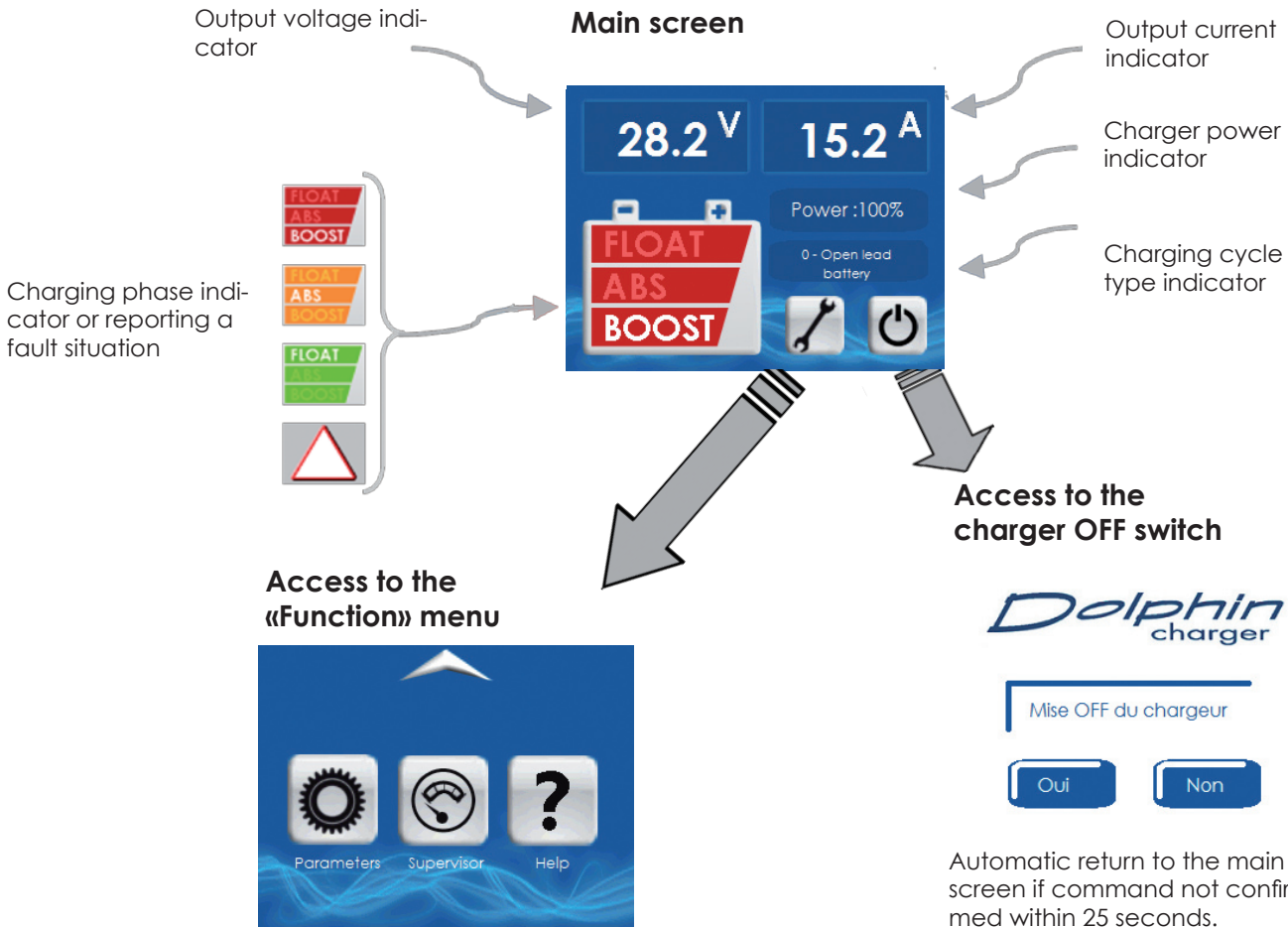
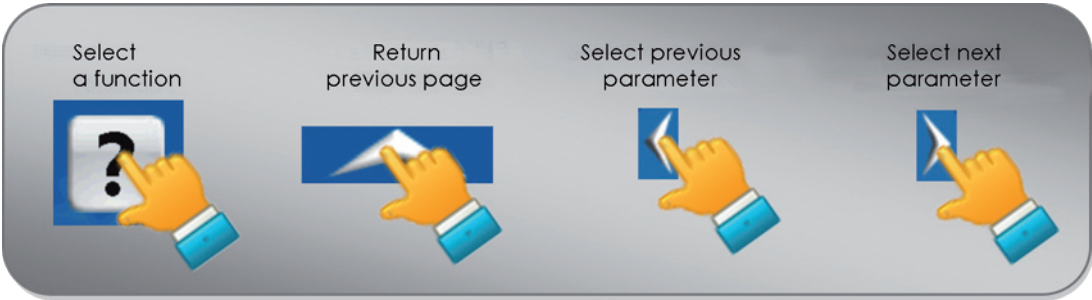

## Functions menu

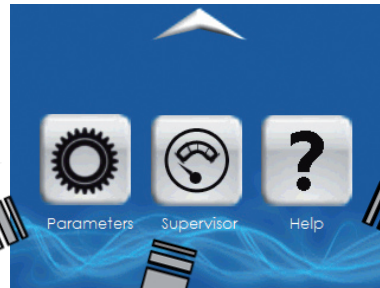

## Set-up menu

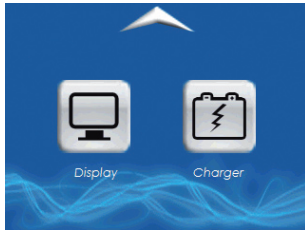

## Screen set-up

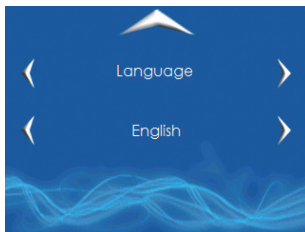

Configurable screen parameters:

- Language
- Unit
- Display
- Screen background
- Brightness

## Charger set-up

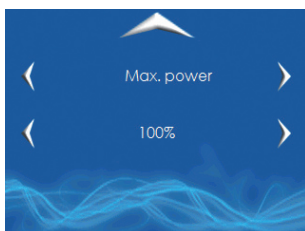

Configurable charger parameters:

- Max. power
- Alarm relay polarity

## Supervisor menu

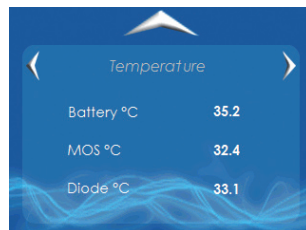

Temperature display:

- Battery
- Charger MOS
- Charger diode

Charging information display:

- Current charging cycle time
  - Charging phase (Boost, Equal, Float)
  - Power (30% – 50% – 70% – 100%)
  - Charging cycle type
- 0-Open lead  
1-Sealed lead  
2-Calcium lead  
3-Delphi  
4-Optima  
5-Wet lead winter storage  
6-Sealed lead winter storage  
7-Gel and AGM  
8-Power supply  
9-LiFeSo4+BMS

## Help menu

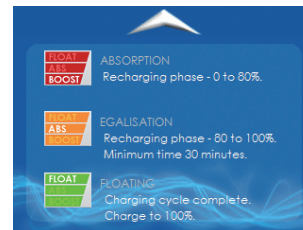
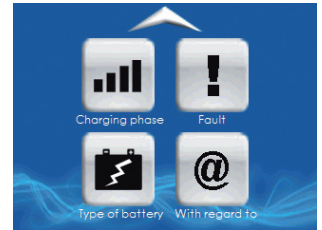

Description of the charging phases.

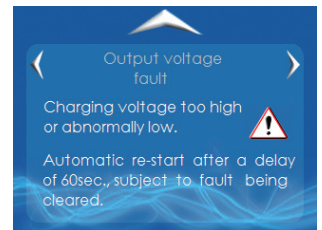

Description of the different charger faults and conditions for clearing them.

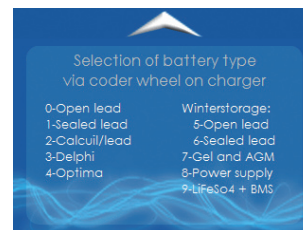

Description of how to select the type of charging cycle.



## Warranty

**TO AVOID ANY RISK OF INCORRECT USE OF THE EQUIPMENT, READ CAREFULLY THE LIST OF EVENTS OR POTENTIAL FAULTS NOT COVERED BY THE PRODUCT WARRANTY**

- ▶ Pressing on the screen when fitting or removing the product could damage it (crack the screen).
- ▶ Dropping the device could irreversibly distort the enclosure or smash the touch screen or certain electronic components.
- ▶ Modifying the enclosure (drilling extra holes in it in particular) could cause mechanical stress on the screen or electronics.
- ▶ Water splashes or drips inside the device could cause irreversible damage to the electronics.
- ▶ Powering the set-up from an unsuitable source (as a general rule, a supply voltage outside the specification). Risk of irreversible damage to the equipment.

## Precautions when scrapping

This device contains electronic components and materials that must be recycled at the end of the product's life for environmental reasons.

All devices at the end of their life must therefore be either returned to the local distributor or to a specialist electronic equipment recycling company.

## EC conformity

This device conforms to current European standards and is CE marked. Its certificate of conformity is available upon request.



For further information or assistance,  
please contact:

**REYA SAS**

2599 Route de la Fènerie  
06580 Pégomas  
FRANCE

Tél : (33) 0 493 904 700

Fax : (33)0 493 902 440

e-mail : [export@reya.com](mailto:export@reya.com)

**[www.reya.com](http://www.reya.com)**