



Harley Benton

CE-100
effects pedal

Musikhaus Thomann
Thomann GmbH
Hans-Thomann-Straße 1
96138 Burgebrach
Germany
Telephone: +49 (0) 9546 9223-0
E-mail: info@thomann.de
Internet: www.thomann.de

22.07.2015, ID: 114548

Table of contents

1	General notes.....	4
2	Safety instructions.....	6
3	Features.....	9
4	Instructions for use.....	10
5	Components and functions.....	11
6	Connections.....	17
7	Technical specifications.....	19
8	Protecting the environment.....	20

1 General notes

This user manual contains important information on safe operation of the device. Read and follow all safety notes and all instructions. Save this manual for future reference. Make sure that it is available to all persons using this device. If you sell the device to other users, be sure that they also receive this manual.

Our products are subject to a process of continuous development. We therefore reserve the right to make changes without notice.

Symbols and signal words

This section provides an overview of the symbols and signal words used in this user manual.

Signal word	Meaning
DANGER!	This combination of symbol and signal word indicates an immediate dangerous situation that will result in death or serious injury if it is not avoided.
NOTICE!	This combination of symbol and signal word indicates a possible dangerous situation that can result in material and environmental damage if it is not avoided.

Warning signs	Type of danger
	<p>Warning – danger zone.</p>

2 Safety instructions

Intended use

This device is intended to be used for sound processing of signals from musical instruments with electromagnetic pickups. Any other use or use under other operating conditions is considered to be improper and may result in personal injury or property damage. No liability will be assumed for damages resulting from improper use.

This device may be used only by persons with sufficient physical, sensorial, and intellectual abilities and having corresponding knowledge and experience. Other persons may use this device only if they are supervised or instructed by a person who is responsible for their safety.

Safety



DANGER!

Danger for children

Ensure that plastic bags, packaging, etc. are disposed of properly and are not within reach of babies and young children. Choking hazard!

Ensure that children do not detach any small parts (e.g. knobs or the like) from the unit. They could swallow the pieces and choke!

Never let children unattended use electrical devices.



NOTICE!

Operating conditions

This device has been designed for indoor use only. To prevent damage, never expose the device to any liquid or moisture. Avoid direct sunlight, heavy dirt, and strong vibrations.

**NOTICE!****Risk of fire due to incorrect polarity**

Incorrectly inserted batteries may destroy the device or the batteries.

Ensure that proper polarity is observed when inserting batteries.

**NOTICE!****Possible damage by leaking batteries**

Leaking batteries can cause permanent damage to the device.

Take batteries out of the device if it is not going to be used for a longer period.

3 Features

The CE-100 effects pedal

- processes the instrument signal with a chorus effect
- offers a 2-band filter for variable chorus effects
- provides a stereo output for broad stereo effects
- operates on 9 V battery or power adapter (both not supplied).

4 Instructions for use

Unpack and carefully check that there is no transportation damage before using the unit. Keep the equipment packaging. To fully protect the device against vibration, dust and moisture during transportation or storage use the original packaging or your own packaging material suitable for transport or storage, respectively.

Handle the device with care.

Do not try to disassemble or repair the device yourself in the unlikely event that it does not work.

Do not use solvents such as alcohol to clean the device.

5 Components and functions

Input, outputs, controls, indicator

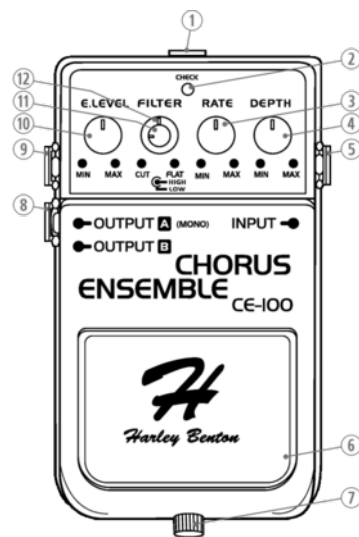

CE-100

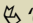
1	Connector for an optional 9 V power adaptor (not supplied). Using a power adaptor leaves you independent of the battery lifetime.
2	The LED 'CHECK' lights up when the effects pedal is active. If the LED is not lit or just glowing low during operation the battery is depleted and needs to be replaced.
3	Use the 'RATE' control to adjust the speed of the chorus effect. Turn it clockwise to increase the speed, turn it counter-clockwise to decrease the speed.
4	Use the 'DEPTH' control to adjust the depth of the chorus effect. Turn it clockwise for a deeper sounding effect, turn it counter-clockwise for less depth.
5	1/4" phone input socket for a shielded instrument cable.
6	The foot switch toggles the effect on / off.
7	Knurled-head screw to open the battery compartment. See details @  'Changing the battery' on page 14
8	Output socket B: Use a shielded instrument cable to connect this outlet to another effects pedal or directly to a second amplifier. Use this output additionally to output A for stereo operation. Then only the dry signal is available at output B.

9	<p>Output socket A: Use a shielded instrument cable to connect this outlet to another effects pedal or directly to your amplifier. Use this output for monaural operation. Both dry and processed signal are outputted here.</p> <p>In stereo operation, i.e. when a second cable is connected to output B, output A only provides the processed signal.</p>
10	Turn the 'E.LEVEL' control to adjust the output level of the effects signal.
11	Turn the 'HIGH FILTER' control to adjust the high frequencies of the chorus sound.
12	Turn the 'LOW FILTER' control to adjust the low frequencies of the chorus sound

Changing the battery

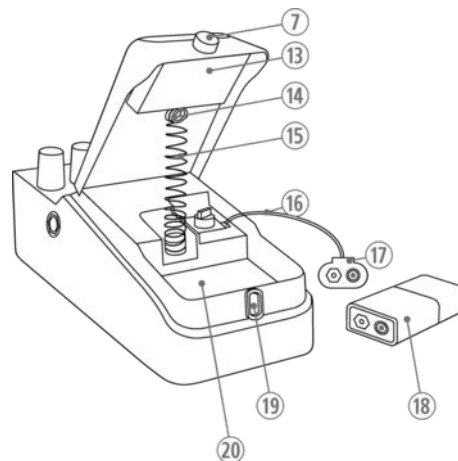

- | | |
|----|--|
| 7 | Knurled-head screw to open the battery compartment |
| 13 | Battery compartment cover |
| 14 | Spring suspension |

15	Coil spring
16	Battery cable
17	Battery clip for a 9 V battery
18	9 V battery
19	Feed hole
20	Battery compartment

Before installing or replacing the battery, disconnect the instrument cable from the input socket of the unit.

- 1.** ➤ Loosen the knurled-head screw (7) on the pedal to open the battery compartment cover (13).
- 2.** ➤ Take the 9 V battery out of the battery compartment (20) and pull off the battery clip (17) from the depleted battery.
- 3.** ➤ Attach the battery clip (17) to the new battery (respecting the pole marking) and put it into the battery compartment (20). Make sure that the battery cable (16) is not trapped in the coil spring (15) or between battery compartment cover (13) and housing.
- 4.** ➤ Press the coil spring (15) into the spring suspension (14) and close the battery compartment (13).

5. ➤ Insert the knurled-head screw (7) through the feed hole (19) and tighten the screw securely.

6 Connections

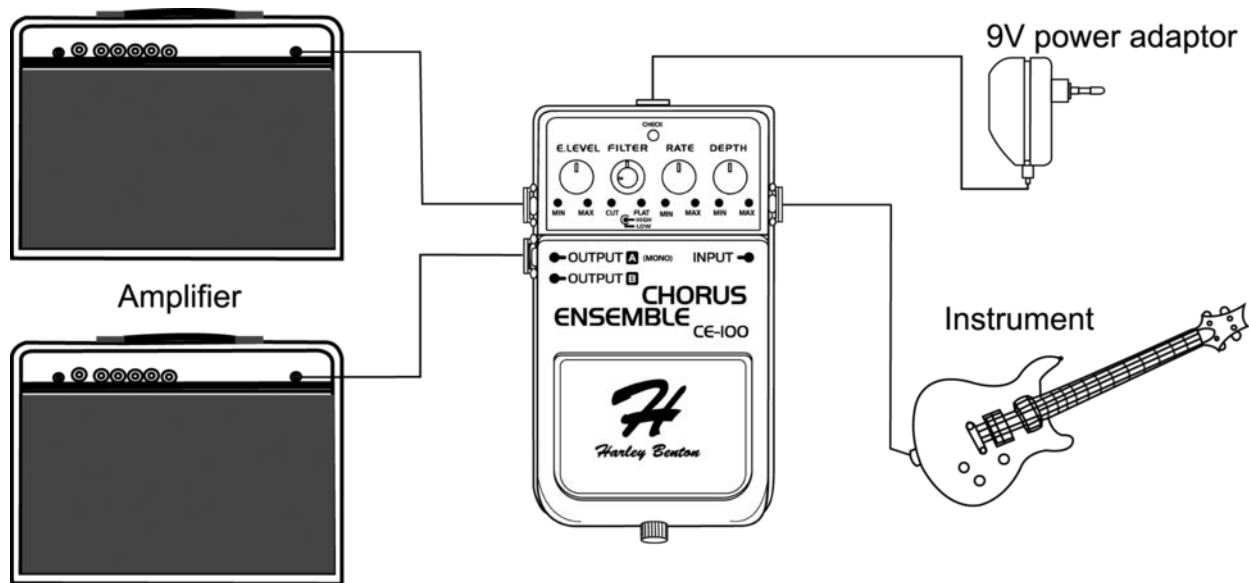

CE-100

Please note the following:

- 1.** ➤ If you connect an instrument cable to the input socket, the chorus pedal is automatically switched on. Thus, always disconnect the cable from the pedal when it is not in use.
- 2.** ➤ To avoid noise interference, set the amplifier volume to minimum, before inserting the instrument cable into the input socket.
- 3.** ➤ If you are using an instrument with a high output level, the sound may become distorted. If you notice distortion, turn down the volume of the instrument

7 Technical specifications

Input impedance	1 M Ω
Output impedance	1 k Ω
Recommended load impedance	10 k Ω or higher
Signal-to-noise ratio	93 dBu (IHF-A, typical), filter controls in centre position
Operating voltage supply	9 V battery (6F22) / 9 V power adaptor
Current draw	28 mA
Dimensions (W \times D \times H)	72 mm \times 128 mm \times 60 mm
Weight	412 g (without battery)
Option	9 V power adaptor

8 Protecting the environment

Disposal of the packaging material



For the transport and protective packaging, environmentally friendly materials have been chosen that can be supplied to normal recycling.

Ensure that plastic bags, packaging, etc. are properly disposed of.

Do not just dispose of these materials with your normal household waste, but make sure that they are fed to a recovery. Please follow the notes and markings on the packaging.

Disposal of batteries



Batteries must not be disposed of as domestic waste or thrown into fire. Dispose of the batteries according to national or local regulations regarding hazardous waste. To protect the environment, dispose of empty batteries at your retail store or at appropriate collection sites.

Disposal of your old device



This product is subject to the European Waste Electrical and Electronic Equipment Directive (WEEE). Do not dispose with your normal household waste.

Dispose this device through an approved waste disposal firm or through your local waste facility. When discarding the device, comply with the rules and regulations that apply in your country. If in doubt, consult your local waste disposal facility.



