

Instruction Manual



□ VP-701A SD



□ VP-703A SD

COLOR VIDEO DOOR PHONE KITS



CONTENT

PAGE

1. Features	2
2. Outdoor Camera Performance Data	2
3. Indoor Monitor Performance Data	3
4. Indoor Monitor Installation	4
5. Outdoor Camera Installation	4
6. Notices of Wiring Diagram	5
7. Operation Instruction	6
8. Accessories	7
9. Notices	7

I. Features

1. Slim fit aluminum alloy panel of indoor monitor with simplicity and classic designing style.
2. Damage-proof,oxidation-proof and abrasion-proof metal outdoor camera, the outdoor camera angle adjustable when installation to ensure the best angle.
3. Low power consumption, no radiation and high definition.
4. Hands free communication.
5. Outdoor camera or indoor monitor electric-controlled door release function.
6. Monitoring the outside of house.
7. Fourteen chord musics.
8. Ring and volume of communication adjustable.
9. Enclosed an adapter and 15M cable with detail user manual suitable for DIY Installation.
10. Automatically take photo function.

2. Outdoor Camera Performance Data

1. IR distance more than 4M
2. Automatic gain control
3. Working temperature: -20°C~50°C
4. Resolution: CMOS more than 380 TV line
CCD more than 420 TV line
5. Outdoor camera dimension: 112 【W】 X 158 【H】 X 38 【D】 mm

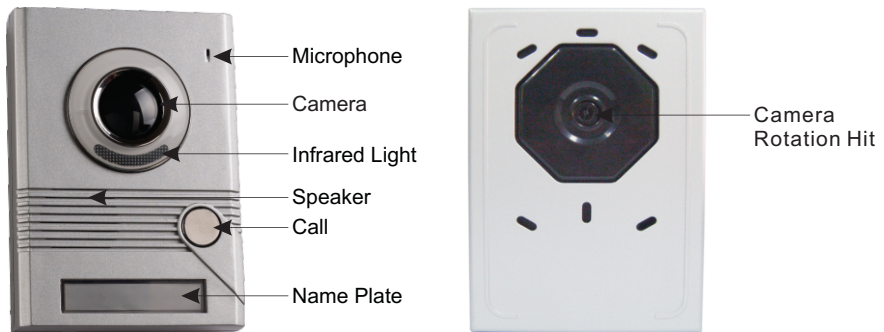

3. Indoor Monitor Performance Data

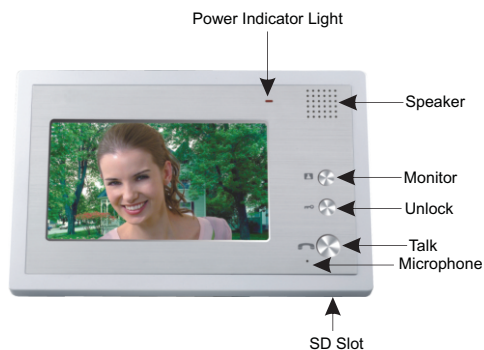

VP-701A SD Indoor Monitor

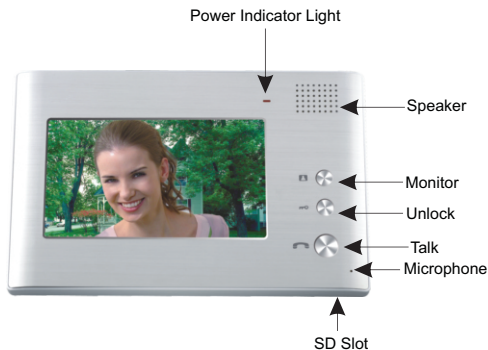

VP-703A SD Indoor Monitor

1. Adapter input voltage: AC110-120V/60Hz or AC220V-240V/50Hz
2. Adapter output voltage, output current: DC13V 1200mA
3. Talking last time: 120S ± 10%
4. Monitoring last time: 40S ± 10%
5. Working distance: 50M(5×0.5mm²)
6. Power consumption: standby <4W, working <10W
7. Illumination intensity: 2lux
8. Visual angle: 92° wide-angle
9. Working temperature: -10°C~40°C
10. Relative humidity: 10-90%(RH)

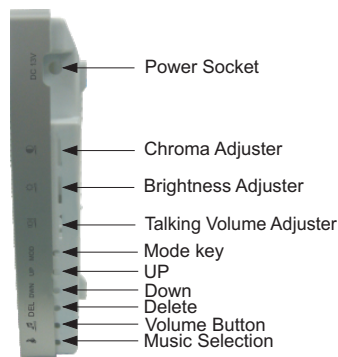

Parameter	Specifications	Unit
Screen Size	7.0	Inch
Resolution	480 X 3 X 234	Dot
Active Area	154.1 【H】 X 86.58 【V】	mm
Pixel Size	0.107 【W】 X 0.37 【H】	mm
Screen Figure Dimension	169.4 【W】 X 100 【H】 X 5.7 【D】	mm

4. Indoor Monitor Installation

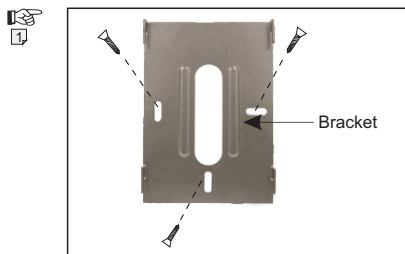

1. Fix the bracket of the video indoor monitor on the wall with enclosed screws . (Pictrue 1)
2. Hang the monitor on the bracket after finishing the wire connection. Plug the enclosed adapter into the sockets of AC power and the monitor (Picture 2).

5. Outdoor Camera Installation

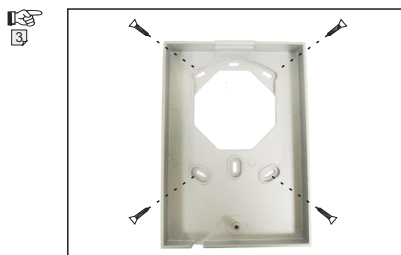
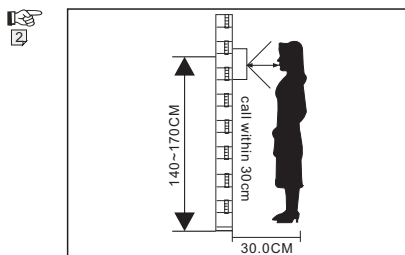

1. First, take down the name plate, and then loosen off the screws which are located under the name plate, take apart the metal front cover of the outdoor camera (Picture 1).
2. Choose a suitable place to install the outdoor camera where should be 1.4m-1.7m above the ground and keep away from direct sunshine and rain (Pictrue 2).

3. Fix the bracket of the outdoor camera on the wall by tightening screws (Picture 3).

6. Notices of Wiring Diagram

The video door phone kit including 15 meters wire. If wanting to extension to 15-50 meter, please use the $5 \times 0.5 \text{ mm}^2$ wire; If wanting extension to 50-100 meter, please use the $5 \times 0.75 \text{ mm}^2$ wire.

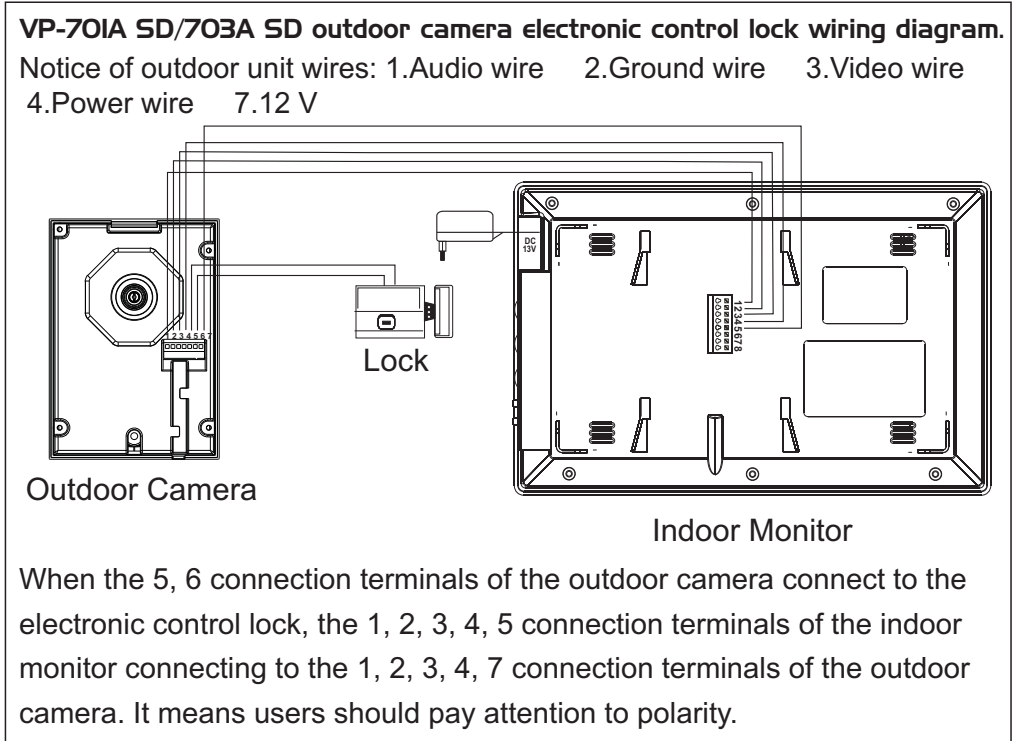

VP-70IA SD/703A SD indoor monitor electronic control lock wiring diagram.

Notice of outdoor unit wires: 1.Audio wire 2.Ground wire 3.Video wire
4.Power wire 7.12 V

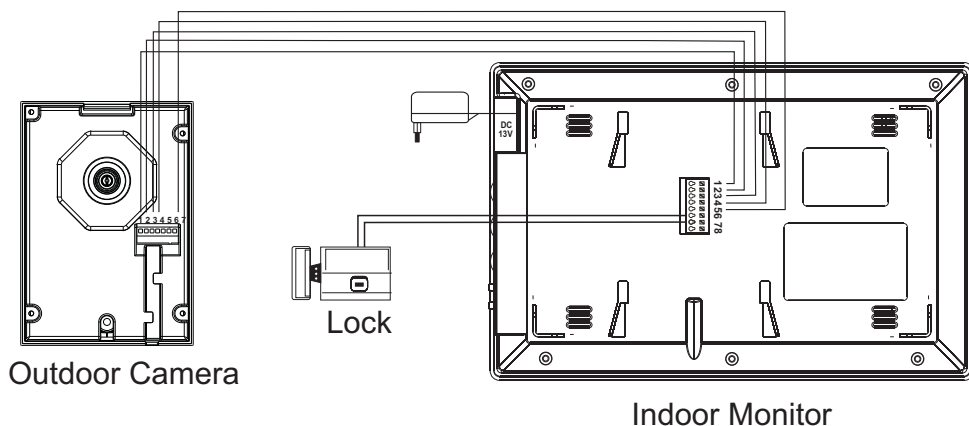

When the 6, 7 connection terminals of the indoor monitor connect to the electronic control lock, the 1, 2, 3, 4, 7 connection terminals of the outdoor camera connecting to the 1, 2, 3, 4, 5 connection terminals of the indoor monitor. It means users do not need pay attention to polarity.

7. Operation Instruction

1. Press the CALL button of outdoor camera, graceful rings will be heard from indoor monitor and images of visitors will be seen. Meanwhile, the images will be taken and saved automatically. The host can talk with the visitor just by pressing TALK button of the indoor monitor. The talking and image showing time can last 120 seconds. When outdoor station turns to auto-taking-photo mode, the camera will take pictures of anything or anyone within the detection area.
2. Considering checking the pictures easily, pictures taken under pressing call button and auto-taking modes are stored in different areas, remarked with "D" and "M" respectively. Pictures taken under auto-taking mode can't be deleted one by one. Only press the delete button continuously to delete them all. The maximum storage capacity is 200 pieces.
3. 1G SD card can store 20000 pieces of pictures, supporting 16G SD at a

- maximum. If no space left, the previous pictures will be covered automatically.
4. Press the monitoring button to monitor outside. If it is not the guest outside, the host can ask him/her to leave by TALK button, then press the monitoring button to close.
 5. When user wants to read the pictures from SD card on computer, a card reader is needed for transferring the pictures. With large storage capacity, the SD card itself is with a display software. After double-clicking "Mplayer", and single-clicking tay-suffix format or index pictures, there will be "Play", which, then, can be clicked to display the pictures one by one automatically or manually.
 6. 14 polyphonic melodies available.
 7. Press up, down button to browse the photo saved. Press up, or down button continuously will display the pictures automatically. Press any key (mode, up, down, function) or final page will stop auto-display.
 8. Press the menu button with up, down button to adjust the time. No need to adjust again when power is off.
 9. When the product is re-turned on, or changed with a new SD card, it would come into a detection mode for several seconds, during which user is not allowed to operate.

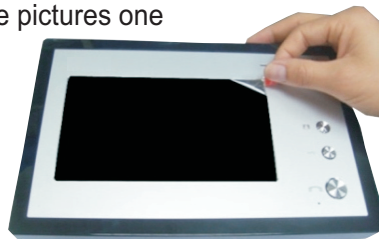

8. Accessories

- | | |
|----------------------|----------------------------------|
| ■ One indoor monitor | ■ One outdoor camera |
| ■ One adapter | ■ One bracket for indoor monitor |
| ■ 15M cable | ■ Screws |

9. Notices

1. Do not install the indoor monitor at high temperature, high humidity place or near TV.
2. No touching the Monitor Screen with wet hands.
3. Please use only softcloth to clear the Monitor Screen or Camera in order to get a clear image.
4. Please avoid throwing or hitting the units.

5. Image could be illegible if the camera is shined by the strong sunlight.
6. If host uses the internal wireless communication systems, image may be fuzzy because of interference from radio waves.
7. If there is a problem in saving images or checking picture occasionally, please check whether SD card is installed correctly, or re-install the SD card.
8. Please choose SPI agreement mode, common low speed SD card.
9. Turning on the product or plugging in SD card will have a reading procedure, and reading last time depends on the pictures' quantity saved
10. SD card should not be used with other appliances

