

User Manual



INTRODUCTION

GSM networks to operate. You can dial the local calls, domestic and international calls with this Terminal connecting with a common wired desktop phone and a standard SIM card.

It is widely used in these areas:

- Remote country
- Mountains
- Dwelling house with weak signals
- Public telephone shops
- Offices
- Removable places such as Ships, Trains, and Long distance buses

The Fixed Wireless Terminal also has these characteristics as below:

- Easy to install
- Easy to operation
- Powerful capacity of signals receiving
- Clear talking setting
- Long using life
- Steady performance

GSM Fixed Wireless Terminal (Model: ALB-3368GSM)

TECHNICAL SPECIFICATION

1. Networks support: GSM900/1800MHz
2. Frequency range: GSM 900MHz(Transmits: 890-915MHz, Receives: 935-960MHz)
GSM 1800MHz (Transmits: 1710-1785MHz, Receives: 1805-1880MHz)
3. Voltage: DC 5V
4. Stand by hours: 48 Hours
5. Talk time: 2-6 Hours
6. Charging time: 6 hours
7. Power consumption: Static $\leq 25\text{MA}$, Emission $\leq 500\text{MA}$
8. Peak power consumption: 0.25W/0.5W
9. Receive sensitivity: -104db
10. Antenna increment: All directions: 5.0db

KEY FUNCTIONS

1. Multicolor backlight display (e.g.: blue, green)
2. Can dial the local calls, mobile calls, international calls and special free calls
3. Supports modem mode
4. No need to dial area code when calling local numbers
5. Automatically connects to IP network when dialing long distance(optional)
6. Automatic card-locking and net-locking enable
7. Caller ID display, time and date display, the power supply of battery can display at the same time on the LCD.
8. Cost rate setting enable

CAUTIONS

1. This terminal should not be used at garage, oil storage, and chemical plant or near to any inflammable or explosive substance.
2. This terminal should be avoided in the hospital. It will interfere with medical electronic equipment such as pacemaker and audiphones.
3. If it is found that the terminal is not successful in login onto network, please check whether the SIM card or antenna is well installed.
4. It is blocked to touch the antenna when the Terminal is being used. (Being making calls or receiving calls), otherwise the terminal will be damaged. This kind of damage is beyond the range of warranty.
5. When the terminal is being used, it should be placed where signal is strong enough. In order to ensure good voice quality, the terminal should be far from other electronic equipment.
6. Don't use chemic substance to clean the terminal, but use dry soft cloth to clean it.
7. Don't disassemble the terminal by yourself. If there is any problem, please contact the authorized personnel.

GSM Fixed Wireless Terminal (Model: ALB-3368GSM)

STORAGE

1. The terminal that is packed or not could piled up no more than 10 layers.
2. The terminal should be saved in ventilate and dry place.
3. Don't knock the terminal to avoid breaking the case.

CONNECTING YOUR NETWORK SERVICE PROVIDER

To use the networks services available in you terminal, you will need to sign up with wireless network service provider and purchase a SIM (Subscriber Identity Module) Card or purchase a prepaid SIM card. In many cases, the wireless provider will make available descriptions of its services and instructions for using its features. Wireless provider may differ in their support of features. Before you sign up, make sure a wireless provider support the features that you need.

INSTALLING THE ANTENNA

- To choose a proper place for the antenna is the first and very important step for antenna installing. You can use your mobile phone to search for the place where the strongest signal is. Then put the antenna here.
- Please do not make the antenna too close to the terminal. It will disturb the signal of the terminal.
- Please do not make the antenna and the terminal too close to the TV set, computer, and radiogram. It will disturb the signal of the terminal.

INSERT A SIM CARD

Make sure the terminal is switched off and the AC adapter is unplugged: insert the SIM card only when the terminal is switched off and the AC adapter is unplugged. Follow the instructions below to insert a SIM Card into the terminal.

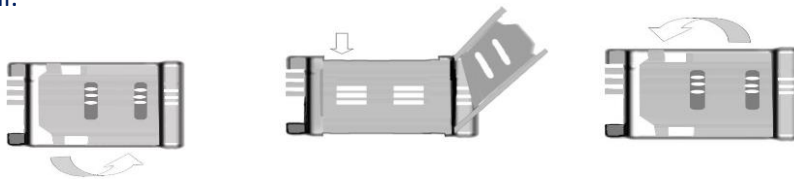

1. Screw off the screw of SIM card case, and open the cover.
2. Slide back the SIM card door and lift it up.
3. Slide the SIM card into the SIM door making sure that the clipped corner of the SIM card lines up with the clipped corner of the SIM holder.
4. Close the SIM card door and slide it to lock the SIM card in place.
5. Replace the cover of SIM card case and fixes it with a screw.

GSM Fixed Wireless Terminal (Model: ALB-3368GSM)

CONNECTING YOUR TERMINAL WITH DESKTOP PHONE

If you want to use the terminal to make calls, you should connect the terminal with a common wired desktop phone.

OPERATING AND SETTING

Enter to set up

1. Take up the telephone or press the hand free key, then press "0**#".
2. LCD displays "?SETUP?" and then after about one second the LCD displays "INPUT PASS"; Please input six digits password (The Approved default password is 332808)
3. Please input six digits password, LCD displays "INPUT CON?" when it succeed. And then, this terminal will ask user to input a setting order. If you put the wrong password, the setting will be terminated.

COMMON SETTING

When LCD displays "INPUT CON?" input any digit (from zero to nine) to enter different settings. The number "1" is for time setting, "2" for cost rating setting and "3" for IP setting.

1. Time setting:

Form is (000...023) hour (000...059) minute;

For example: Now it is 17:30, you can set the time like this:

- a. Take up the telephone or press the hand free key, then press "0**#".
- b. When the LCD displays "INPUT PASS"; Please input six digits password "332808"
- c. And then the terminal will display "INPUT CON?" Please input 1 017 030(1 is the symbol of time setting, 017 means the hour is 17 and 030 means the minute is 30)

2. Cost rate setting:

You can use this wireless terminal to set the cost rate that you want. You can change the time unit, the unit cost rate freely by yourself with a common telephone. Each step begins with the number 2 if you want to change the cost rate. Now there are some numbers instead of the area setting (From 000 to 013) they are list as below:

GSM Fixed Wireless Terminal (Model: ALB-3368GSM)

Code	EXPLANATION	Code	EXPLANATION
000	To receive a call	008	HK MACAO TAIWAN
001	Make a local call	009	USA CANADA
002	Other international areas (except, MACAO, TAIWAN, AMERICA, CANADA and other areas which is in the second type and area code is beginning with 00)	010	INTERNATIONAL CALL
003	Make a Domestic long-distance desktop telephone call	011	Free telephone call, like: 1001
004	Local UNICOM mobile phone (optional)	012	IP telephone call (charged by each call), like: 193300, 17910
005	Local CHINA MOBILE phone (optional)	013	Arbitrary number
006	Long distance UNICOM mobile phone (optional)		
007	Long distance CHINA MOBILE phone (optional)		

With this terminal you can set the cost rate phase by phase (optional). For example the first minute is USD0.5 and after then it will charge USD 0.2/minute. You can use this terminal to set this.

There are also some number symbols for the area setting. They are list as below

Code	EXPLANATION	Code	EXPLANATION
000	To receive a call	006	Long distance UNICOM mobile phone (optional)
001	Make a local call	007	Long distance CHINA MOBILE phone (optional)
002	Other international areas (except, MACAO, TAIWAN, AMERICA, CANADA and other areas which is in the second type and area code is beginning with 00)	008	HK MACAO TAIWAN
003	Make a Domestic long-distance desktop telephone call	009	USA CANADA
004	Local UNICOM mobile phone (optional)		
005	Local CHINA MOBILE phone (optional)		

For example: The cost rate of receiving a call is USD0.2/minute (60seconds), you can set it in this way:

- 1) Take up the telephone or press the hand free key, then press "0**#".
- 2) Input "332808" when the LCD displays "INPUT PASS";
- 3) And then the terminal will display "INPUT CON?" Please input "2"+"0000"+"060"+"020"+"060"+"020"(the number "2" is the symbol of cost rate setting, "000" is the symbol of call receiving, "060" is the symbol of time unit and "020" is the symbol of unit cost.

GSM Fixed Wireless Terminal (Model: ALB-3368GSM)

If you make a local call and the cost rate was charged phase by phase (for example the first minute is USD0.3, after then USD0.25/minute), you can set it like this way :(optional setting)

- 1) Take up the telephone or press the hand free key, then press“0**#”.
- 2) Input “332808” when the LCD displays “INPUT PASS”;
- 3) And then the terminal will display “INPUT CON?” Please input “2”+ “0010”+ “060”+ “030” + “060”+ “025”(the number “2”is the symbol of cost rate setting, “001”is the symbol of local calling, the first“060” is the symbol of the first phase time unit and “030” is the symbol of the first phase unit cost. The second “060” is the symbol of the second phase time unit and “025” is the symbol of the second phase unit cost.

You can also use the terminal to set other cost rate in the similar way.

3. IP Route Setting (optional)

When you make a long distance call or an international call, you may use the IP route to save money. For example, when you use the desktop phone of China Telecom to make a long distance call, you can add the IP “17909” before you are dialling. But it is very inconvenient to add the IP route for your calling; you should dial a lot of numbers when you make a long distance call. Now you can set the IP route in advance by our wireless terminal .It is very convenient and it can also save a lot of time to do that. You can operate the setting in this way:

- 1) Take up the telephone or press the hand free key, then press“0**#”
- 2) Input “332808” when the LCD displays “INPUT PASS” and then the terminal will display “INPUT CON?” Please input “3”+Area symbols (you can check them in Form II) +IP route.

For example, you will make a call to USA with China Telecom desktop telephone, and the IP route is 17909.You can set the IP in the following way:

- 1) Take up the telephone or press the hand free key, then press“0**#”
- 2) Input “332808” when the LCD displays “INPUT PASS”
- 3) And then the terminal will display “INPUT CON?” Please input “3”+ “009”+ “17909”(the number “3”is the symbol of IP route setting, “009” is the area symbol of the USA, “17909” is the IP route of China Telecom.)

So when you make a international call to USA next time, there is no need to add the IP route again. The terminal will add the IP route automatically. So you can save a lot of time and also save a lot of money (compare with direct dial).

GSM Fixed Wireless Terminal (Model: ALB-3368GSM)

PACKING LIST

With the Fixed Wireless Terminal, there are some accessories. When you get the terminal please check them and to see whether you have all of them. Please contact us or call the distributor in your area to hand back the absent parts if you find that you lack one of them as below

Name	Quantity	Remark
DC adapter	1pcs	DC5V/1A
Special antenna	1pcs	
User Manual	1pcs	English

ATTENTIONS

In order to protect your Terminal and make sure the terminal have a long using life, you should pay attentions as below:

1. You'd better place the terminal in a safe place where the kids cannot be fetch, or the terminal will hit the kids.
2. Please keep the terminal and the accessories dry and do not place the terminal in a dirty place, or it will affect the use of the terminal.
3. Please use the terminal in a normal temperature. It will damage the using lift of the terminal if the temperature is too high or too low.
4. Make sure that there is no water immerge the terminal, or it will short-circuit and leads the perpetual damage of the terminal
5. Do not swab the terminal with the corrosive materials.
6. Do not open the terminal optionally. Please ask professional repairer for help if your terminal was damaged.
7. Please use the special battery and adapter. Do not use the common battery and adapter instead of the special battery and adapter.
8. Please charge the terminal if the terminal turns off automatically when you use the battery to work.