

 **BLACK & DECKER®**

Twin-Beam Spotlight

3,000,000 Power Series™
Corded • Cordless • Rechargeable



**53SB
E231887**

**BEFORE RETURNING THIS PRODUCT
FOR ANY REASON PLEASE CALL
1-877-571-2391**

BEFORE YOU CALL, HAVE THE CATALOG No
AVAILABLE IN MOST CASES A REPRESENTATIVE
CAN RESOLVE THE PROBLEM OVER THE PHONE.

SAVE THIS MANUAL FOR FUTURE REFERENCE.

IMPORTANT SAFETY INFORMATION

WARNINGS

- **Contains non-spillable sealed lead acid batteries. They must be recycled or disposed of properly.**
- **DO NOT dispose of batteries in fire, as this may result in an explosion.**
- **DO NOT open battery or short circuit, this may cause the battery to leak or get hot causing personal injury. Any disposal questions call toll-free (877) 288-7722.**
- **RISK OF FIRE/ELECTRIC SHOCK — do not plug in a power supply without the bulb lens and cover in place.**
- **ALL HALOGEN LIGHTS GIVE OFF HEAT.**
 - **Do not touch lens while operating.**
 - **Keep combustibles away from Spotlight lens. Extreme heat can cause fires.**
 - **Never place the light face-down on any surface when lit.**

CAUTIONS

- Never look directly into the light or shine the light into another person's eyes.
- Keep sharp objects away from lens — it is glass and can break.
- Do not immerse spotlight in water.
- Do not drop or throw spotlight. It contains glass and a sealed lead acid battery.
- Only replace bulbs with type indicated in specifications (12 volt, H3 quartz halogen. 75 watt).
- Use only with AC or DC charging adapters that are provided with unit.
- **DO NOT OVERCHARGE:**
 - AC recharge up to 30 hours maximum.
 - DC recharge up to 4 hours maximum.
 - After recharge, disconnect charging adapter and wait 5 minutes before use.
- **NEVER ATTEMPT TO USE THE AC CHARGER AND DC CHARGING PORT SIMULTANEOUSLY.**
- Do not crush, cut, pull or expose charging adapter cords to extreme heat.
- Position charging adapter cords so they do not become entangled or become a safety hazard. Keep charging adapter cords away from sharp edges.
- Use in a dry location only.
- Do not open body casing. There are no user-serviceable parts inside.

THIS UNIT IS NOT A TOY AND SHOULD ONLY BE OPERATED BY ADULTS. KEEP AWAY FROM CHILDREN!

Read This User's Manual Before Using This Spotlight.

SAVE THESE INSTRUCTIONS

TABLE OF CONTENTS

Introduction	1
Features	1
Charging/Recharging the Spotlight	2
Charging Using the 120 Volt AC Recharge Port	3
Charging Using the 12 Volt DC Charging Adapter	3
Operating Instructions	4
Operating the Spotlight and LED Area Lights	4
Using the 12 Volt DC Accessory Outlet	4
Care and Maintenance	4
Spotlight Bulb Replacement	4
Battery Replacement/Disposal	6
DC Plug Fuse Replacement	6
Troubleshooting	6
Charging Issues	6
Operating Issues	7
Specifications	7

INTRODUCTION

Thank you for purchasing the **Black & Decker 3,000,000 Power Series™ Twin-Beam Spotlight**. Please read this guide carefully before use to ensure optimum performance and to avoid damage to the unit.

FEATURES

- Two powerful, focused, replaceable quartz halogen bulbs
- Two magnified LED Area Lights
- Three-position Light Mode Switch selects single Spotlight, dual Spotlight or LED Area Lights
- Spotlight ON/OFF Trigger with Trigger Guard
- 12 Volt DC Accessory Outlet
- Protective rubber safety guard (bezel) around lens
- Rubber safety cap protects battery compartment
- Comfortable pistol grip handle
- Battery Status LED Indicator displays battery charge level while charging, or whenever Battery Status Pushbutton is pressed
- UL listed, built-in 120 Volt AC Charger
- 12 Volt DC Charging/Power Adapter included
- Rechargeable, non-spillable, sealed lead acid battery

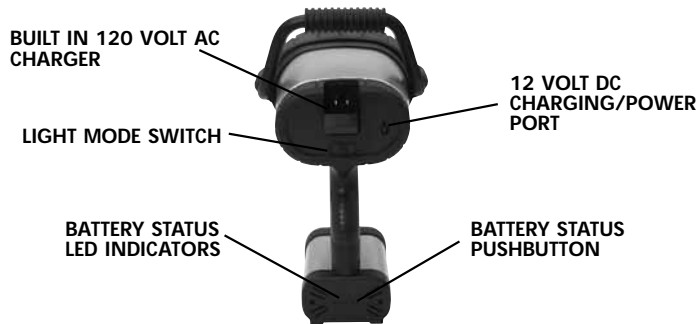

CHARGING/RECHARGING THE SPOTLIGHT

This unit is shipped in a partially charged state. BEFORE first use, charge the Spotlight using the 120 Volt AC Charger for 20-30 hours or until the green LED Indicator lights. To check the battery charge status at any time, press the Battery Status Pushbutton. The LED Indicators display the level of charge. Three red LEDs indicate a high level of charge; two, a medium level; and one red LED indicates that the unit should be charged soon.) The green LED lights to show a fully charged unit.



It is recommended that you charge the Spotlight after each use (or every 2 months when not in frequent use) until the green LED lights so the unit is always ready when you need it.

Charging Using the 120 Volt AC Charger

- Plug a standard North American 120 volt AC extension cord into the 120 Volt AC Charger on the back of the unit.



HOUSEHOLD EXTENSION CORD (NOT INCLUDED)



BUILT-IN 120 VOLT AC CHARGER

- Turn OFF the Area Lights and Spotlight (Light Mode Switch is not set to "AREA" and the Trigger is not depressed). Disconnect any 12 volt DC appliances from the 12 Volt DC Accessory Outlet.
- Charge until the Battery Status LED Indicator green LED lights (approximately 20-30 hours). DO NOT CHARGE FOR LONGER THAN 30 HOURS.
- Once recharging is completed, disconnect the adapter from the external charging source.
- After AC recharging, wait 5 minutes before using the Spotlight.

⚠ CAUTION

Do not turn on any lights or operate any appliances through the Spotlight's DC Accessory Outlet when using the 120 Volt AC Charger.

Charging Using the 12 Volt DC Charging Adapter

Make sure the DC source (jump-starter, battery pack, vehicle accessory outlet, etc.) is 12 volt DC and is able to supply at least one half amp at 12 volt DC for 8 hours. This means a battery pack should be charged with at least 4 amp hours capacity.

The **VEC158BD** can be simultaneously charged and operated from a 12 volt DC source. **Make sure the 12 volt DC source can supply minimum 15 amps of current if the Spotlight is to be operated while the batteries are being charged.**

- Insert the 12 volt DC plug end of the 12 Volt DC Charging/Power Adapter into the accessory outlet of your vehicle or other 12 volt DC power source.



12 VOLT DC CHARGING/POWER ADAPTER (INCLUDED)



12 VOLT DC CHARGING/POWER PORT

- Plug the barrel-tip end into the 12 Volt DC Charging/Power Port on the back of the unit.
- Charge until the Battery Status LED Indicator green LED lights when the Battery Status Display pushbutton is pressed (approximately 3-4 hours). DO NOT CHARGE FOR LONGER THAN 4 HOURS.
- Once recharging is completed, disconnect the adapter from the external charging/power source.

Note: When using a vehicle's 12 volt DC accessory outlet as a charging source, be aware that some vehicles require you to turn on the ignition to power the accessory outlet.

⚠ WARNING
NEVER ATTEMPT TO USE THE AC CHARGER AND DC CHARGING PORT SIMULTANEOUSLY.

OPERATING INSTRUCTIONS

Operating the Spotlight and LED Area Lights

To use the lights, first set the Light Mode Switch to the desired operation – “SINGLE” Spotlight beam, “TWIN” Spotlight beam or “AREA” for LED Area Lights.

To operate the LED Area Lights, simply slide the switch to select AREA. To turn the LED Area Lights OFF, slide the switch to any other setting.

To operate the Spotlight:

1. Slide the switch to select SINGLE or TWIN beam.
2. Flip up the Trigger Guard (see diagram on page 2).
3. Squeeze the Trigger.

To turn the Spotlight OFF, release the Trigger.



Using the 12 Volt DC Accessory Outlet

Flip up the cover on the 12 Volt DC Accessory Outlet just above the base on the front of the unit. Insert the appliance's DC plug and operate as usual.



Note: Do not operate the 12 Volt DC Accessory Outlet while charging/recharging using the 120 Volt AC Charger.

CARE AND MAINTENANCE

All batteries lose charge with time, especially when they are warm. Recharge the unit every two months when not in frequent use, preferably using the 120 volt AC method.

Never submerge the unit in water. If the unit gets dirty, gently clean the outer surfaces of the spotlight unit with a soft cloth moistened with a mild solution of water and detergent.

The quartz halogen bulbs are the only user-replaceable parts in the Spotlight. Periodically inspect the condition of adapters, connectors and wires. Contact Technical Support toll-free at (800) 618-5178 to replace any components that have become worn or broken.

Spotlight Bulb Replacement

To replace either or both H3 type 12 volt 75 watt bulbs, you will need a small

Phillips type screwdriver and a replacement bulb (or bulbs). During installation, avoid touching the glass part of the bulb. Bulb life may be shortened by installing a bulb with dirt or fingerprints on it. The bulb can be wiped clean with a cloth moistened with alcohol.

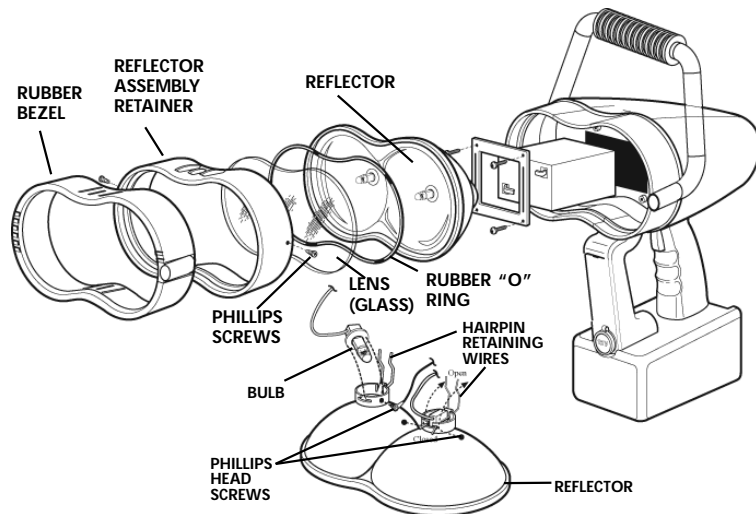

1. Disconnect the unit from any charging adapters.
2. Push the rubber bezel forward toward the front of the spotlight to reveal two small Phillips screws in the retaining ring.
3. Using the screwdriver, remove (counterclockwise) the two screws. Set them aside.
4. Lift off the retaining ring, glass lens and rubber “O” ring and set them aside.
5. Carefully remove the reflector and bulb assembly.
6. Disconnect the bulb wire from the red power wire.
7. Unsnap the hairpin retaining wires from the reflector's flange.
8. Using the screwdriver, loosen the retaining screw to remove the bulb from the reflector (no need to completely remove this screw).
9. Lift out the bulb and detach wire.
10. Insert the replacement bulb into the reflector's flange.
11. Put back and secure the hairpin retaining wires.
12. Connect the bulb power wire to the red power wire.
13. Tighten the retaining screw on the flange.
14. Place the reflector in position in the body of the spotlight.
15. Replace the rubber “O” ring in the groove around the perimeter of the reflector.
16. Replace glass and retaining ring so the screw holes are aligned.
17. Secure retaining ring with two screws.
18. Replace rubber bezel.
19. Operate switch to ensure proper operation of spotlight.

⚠ WARNING

To reduce the risk of electric shock, replace bulbs with 12 volt H3 75 watt only.

Battery Replacement/Disposal

Battery Replacement

The battery should last the service life of the unit. Contact Technical Support toll-free at (800) 618-5178 for any information you may need.

Safe Battery Disposal

Contains a maintenance-free, sealed, non-spillable, lead acid battery, which must be disposed of properly. Recycling is required, contact your local authority for information. Failure to comply with local, state and federal regulations can result in fines, or imprisonment.



⚠ WARNINGS

- **Do not dispose of the battery in fire as this may result in an explosion.**
- **Before disposing of the battery, protect exposed terminals with heavy-duty electrical tape to prevent shorting (shorting can result in injury or fire).**
- **Do not expose battery to fire or intense heat as it may explode.**
- **For more information on recycling this battery, call toll-free (877) 288-7722.**

12 Volt DC Charging Adapter Plug Fuse Replacement

The fuse in the plug end of the 12 Volt DC Charging Adapter protects the adapter's charging circuit. If the 120 Volt AC Charger operates, but the DC charging adapter does not, then this fuse may be opened (blown).

To replace the fuse:

1. Unscrew the end cap of the DC plug (counterclockwise).
2. Remove spring center contact and fuse.
3. Check fuse with a continuity checker.
4. If blown, locate a replacement 8 amp/250 volt fuse.
5. Replace the fuse, spring, contact and end cap.
6. Screw end cap clockwise until it is finger tight – DO NOT OVER-TIGHTEN.
7. Test for proper operation of the 12 Volt DC Charging Adapter.

TROUBLESHOOTING

Charging Issues

No Battery Status Indicator LEDs Light When Charging

1. Check connection to the 120 Volt AC Charger or 12 Volt DC Charging Port.
2. Check connection to AC or DC power source.
3. Confirm there is a functioning AC or DC current.

Operating Issues

The Area Light is operating, but the Spotlight is not.

- SINGLE or TWIN must be selected on the Light Mode Switch **and** the Trigger depressed to operate the Spotlight.
- The Spotlight will not operate while charging using the 120 volt AC method. Be sure all extension cords are disconnected from the AC charger before Spotlight use. (The Spotlight can be operated while charging using the 12 volt DC method.)
- If you suspect the bulb is blown, check the filament. If the filament is coiled and unbroken, the bulb is not blown. If bulb is blown, replace it.

None of the lights are operating.

- The battery may be completely discharged. Charge the unit following the directions on page 2.
- If the unit does not operate after recharging as directed, contact Technical Support toll-free at (800) 618-5178.

SPECIFICATIONS

Spotlight Bulb:	Dual 12 volt, H3 series, 75 watt
Battery:	Two maintenance-free, sealed lead acid, 6 volt, 6.0 amp hour
AC Charger:	UL Listed, Class 2, 12 volt DC (300 mA)
DC Plug Fuse	8A/250 V