

 LAKELAND

USER MANUAL



LAKELAND STEAM MOP

MODEL 23307

Helpline No: 015394 88100

Thank you for choosing the Lakeland Steam Mop. The steam mop uses the triple layered, steam activated microfibre pads to loosen and lift dirt.

It's quick heat-up time allows the mop to produce super-heated steam within 30 seconds. The steam sanitises floors, killing harmful germs and E-coli without the need for harmful chemicals. The 7.5m flex allows easy use around the home with the adjustable handle enabling you to set a height that's best for you.

To get the best from your new steam mop, please take a few moments to read these instructions, and keep them in a safe place for future reference.



Parts

- a Upper Extension Tube
- b Lower Extension Tube (Telescopic)
- c Steam Mop Base
- d Microfibre Pads
- e Filling Flask
- f Jug

TECHNICAL SPECIFICATIONS

Voltage: 230-240V., 50Hz.
Power: 1550 Watts
Water Capacity: 250 ml
HELPLINE: 015394 88100

Important safety instructions

When using your Lakeland Steam Mop, please follow these basic safety precautions.

Please use caution when using the steam mop. The steam emitted from the openings is very hot.

1. Use the system only for its intended use.
2. **Do not** use outdoors.
3. **Do not** leave the appliance unattended when plugged in. Always unplug the power cord from the electrical outlet when not in use and before servicing.
4. This appliance is not intended for use by persons (including children) with reduced physical, sensory or mental capabilities, or lack of experience and knowledge, unless they have been given supervision or instruction concerning the use of the appliance by a person responsible for their safety. **Do not** allow the appliance to be used as a toy.
6. Use only manufacturer's recommended accessories.
7. **Do not** operate the appliance with a damaged plug or cord, or if the unit has been dropped or damaged. Never attempt to repair or replace the cord yourself as this may lead to severe injury or electric shock. Call the helpline on 015394 88100 to arrange a replacement.
8. **Do not** immerse the steam mop into water or any other liquids.
9. **Do not** handle plug or steam mop with wet hands or operate appliance without shoes.
10. **Do not** pull or carry by power cord, use power cord as handle, close a door on the power cord, or pull the power cord around sharp edges or corners. Keep the power cord away from heated surfaces.
11. **Do not** unplug by pulling on power cord. To unplug, grasp the plug not the power cord.
Do not use extension cords or outlets with inadequate current carrying capacity.
12. **Do not** put any objects into openings. **Do not** use with any opening blocked.
13. **Do not** put hands or feet under the steam mop, the unit gets very hot.
14. Use **ONLY** on flat, horizontal surfaces. **Do not** use on walls, counters or windows.
15. **Do not** use on unsealed wood or unglazed ceramic floors. On surfaces that have been treated with wax or some no wax floors, the sheen may be removed by the heat and steam action. It is always recommended to test an isolated area of the surface to be cleaned before proceeding. We also recommend that you check the use and care instructions from the floor manufacturer.
16. **Do not** use on leather, waxed polished furniture, synthetic fabrics, velvet or other delicate, steam sensitive materials.
17. **Do not** add cleaning solutions, scented perfumes, oils or any other chemicals to the water used in this appliance as this may damage the unit or make it unsafe for use. If you live in a hard water area, we recommend using distilled water in your steam mop.
18. When in use, NEVER turn the appliance over or on its side. **Never direct steam towards people, animals or plants.**
19. **Never leave the steam mop in one spot on any surface for any period of time when microfibre pad is attached.**
20. Carefully remove the microfibre pad immediately after you have finished using the steam mop. **Do not** store the unit with damp/wet microfibre cleaning pad attached.
21. When cleaning the steam mop, unplug the power cord from the electrical outlet and clean with a dry or damp cloth. **Do not** pour water or use alcohol, benzene or paint thinner on the unit.
22. Extreme caution should be exercised when using this appliance to clean stairs.
23. **Do not** use steam mop without microfibre pad attached.
24. Store the steam mop indoors in a cool, dry place.
25. To avoid a circuit overload, **Do not** operate another appliance on the same socket (circuit) as the steam cleaner.
26. If an extension cord is absolutely necessary, an extension cord rated a minimum of 15 ampere, 14 gauge cord should be used. Cords rated for less amperage may overheat. Extension cords over 5 metres in length should not be used. Care should be taken to arrange cord so that it cannot be pulled or tripped over.

Getting Started

Assembly

1. Carefully unpack all the parts and remove any packaging. Do not plug in the mop until it is fully assembled and you have read all of the following instructions.
2. (fig1) Slide the upper extension tube (a) into the lower extension tube (b). Push the two extension tubes together in until you hear them click into place.
3. (fig2) Insert assembled pieces into the steam mop base. Push together until you hear it click into place. Insert the cord into the cord clip on the shaft of the steam-mop.
4. (fig3) Place one microfibre pad underneath the mop head, with the quick fastener strips facing up. Simply press the steam mop to the pad.

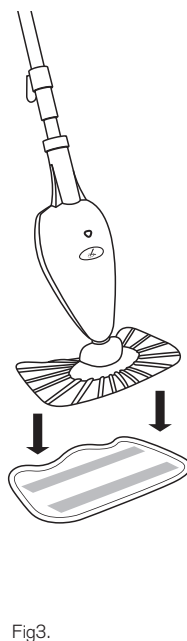
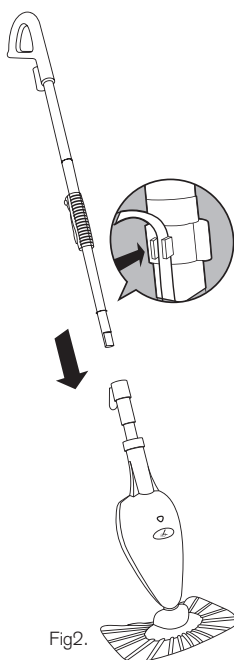
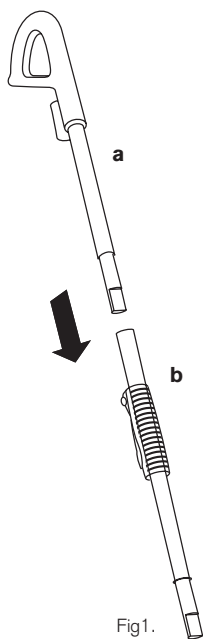

Filling the water tank

Please be aware that the first time you use the Lakeland Steam Mop you may find water droplets in the water tank. This is due to testing of the unit at the factory.

1. Make sure your steam mop is unplugged from the wall before you fill the water tank.
2. Remove the water tank cap by turning it anti-clockwise to the unlocked position. The water tank cap has an arrow to indicate the locked to unlocked position.
3. Use the jug (e) and funnel (f) to aid you in filling the water tank. The water tank must not be filled above the max fill line.
4. Replace the water tank cap by turning it clockwise to the locked position.

Using your steam mop

1. Sweep or vacuum your floors before using your steam mop.
2. Pull and twist the quick release cord holder to unwrap the power cord completely. Plug in and the "On" light will turn green. If your light doesn't turn on, turn to the Troubleshooting section, page 6.
3. To adjust the height of the mop lift the latch on the tube 90 degrees to the open position. Holding the handle, extend the tube to the height that's right for you and then close the latch to its locked position.
4. It takes about 30 seconds for the steam to be ready for use. Pump the handle a few times to prime the pump and activate steam.
5. Mop with a forward and backward motion to customize steam output automatically. If you find the steam mop difficult to push/pull during use, then simply increase the height of the pole.

Microfibre pads

Washing instructions:-

- Machine washable up to 40°C
- Use liquid detergent only
- Do not bleach or use fabric conditioner
- Wash separately from other fabrics
- Air dry or tumble dry on low setting

If there are loose threads on the pad carefully cut the thread with scissors. **Do not** pull on them or cut at the base.

To order replacement pads, call the Helpline on 015394 88100.
3 Replacement Microfibre Pads ref: 23308

Troubleshooting

Problem - The steam mop will not turn on.

Solution 1 - Your steam-mop should be securely plugged into a 230-240V AC electrical outlet only.

Solution 2 - Check the plug fuse or your fuse-box trip-switches.

Problem - Steam mop will not make steam.

Solution 1 - Is there water in the water tank? If not, add water to your steam mop following instructions.

Problem - Steam mop leaves water on the floor.

Solution 1 - Is your microfibre cleaning pad too wet? Unplug your steam mop and change the microfibre cleaning pad.

Problem - Steam Mop left white spot on the floor.

Solution 1 - Don't leave your steam mop on the floor with a damp or wet cleaning pad.

Solution 2 - Do you have hard water? If you do you might want to switch to distilled water.

Problem - Floors are cloudy, streaky or spotty after steaming.

Solution 1 - The pad might be dirty, change the pad.

Solution 2 - If you washed the pocket with powder detergent then the pad might have residual detergent left on it. Wash it again with liquid detergent.

Solution 3 - If you are cleaning in a kitchen area where there might be a build-up of grease then use a de-greasing agent such as an all-purpose cleaner or dish soap and paper towels to clean the area first.

Solution 4 - You might have left the mop in the same spot for too long.

Solution 5 - Do you have hard water? If you do you might want to switch to distilled water.

Solution 6 - This might be left over from past cleaners used on the floor surface. Use the steam mop a few more times and see if the leftover cloudiness is removed.

Problem - Steam mop is hard to push.

Solution 1 - Make sure the cleaning pad is on properly. If you find the steam mop difficult to push/pull during use, then simply increase the height of the pole.

ELECTRICAL CONNECTIONS

THIS APPLIANCE MUST BE EARTHED

This appliance is fitted with a fused three pin plug to BS1363 which is suitable for use in all homes fitted with sockets to current specifications. If the fitted plug is not suitable for your socket outlets, it should be cut off and carefully disposed of. To avoid an electric shock, do not insert the discarded plug into a socket.

FITTING A NEW PLUG

If for any reason you need to fit a new plug, the flexible mains lead must be connected as shown here. The wires in the mains lead fitted to this appliance are coloured in accordance with the following code:

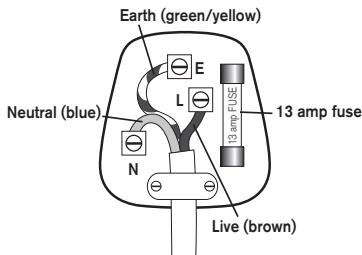

Connect BLUE to Neutral (N)

Connect GREEN & YELLOW to Earth (E)

Connect BROWN to Live (L)

13 amp fuse to be used

If the colours of the wires in the mains lead of this appliance do not correspond with the coloured markings identifying the terminals in your plug, proceed as follows. The wire which is coloured green and yellow **MUST** be connected to the terminal which is marked with the letter E (Earth) or coloured green. The wire which is coloured blue **MUST** be connected to the terminal which is marked with the letter N (Neutral) or coloured black. The wire which is coloured brown **MUST** be connected to the terminal which is marked with the letter L (Live) or coloured red.

Before refitting the plug cover, check that there are no cut or stray strands of wire inside the plug. Use a 13 amp BS1362 fuse. Only BSI or ASTA approved fuses should be used. If you are at all unsure which plug or fuse to use, always refer to a qualified electrician.

Note: after replacing or changing a fuse on a moulded plug which has a fuse cover, the cover must be refitted to the plug; the appliance must not be used without a fuse cover. If lost, replacement fuse covers can be obtained from an electrical shop. This appliance complies with the following EEC Directives: 73/23 EEC (Low Voltage Directive) and 89/336 EEC (EMC Directive).

RECYCLING YOUR ELECTRICALS

Along with many other High Street retailers, Lakeland has joined a scheme whereby customers can take their unwanted electricals to recycling points set up around the country.

Visit www.recycle-more.co.uk to find your nearest recycling point.



Alexandra Buildings, Windermere, Cumbria, UK LA23 1BQ
Tel: +44(0)15394 88100 www.lakeland.co.uk