



FIELDMANN®
Home & Garden Performance



FZS 1001-A

English	7 - 19
Čeština	21 - 32
Slovenčina	33 - 45
Magyarul	47 - 59
Polski	61 - 75
Русский	77 - 90
Lietuvių	91 - 103

1

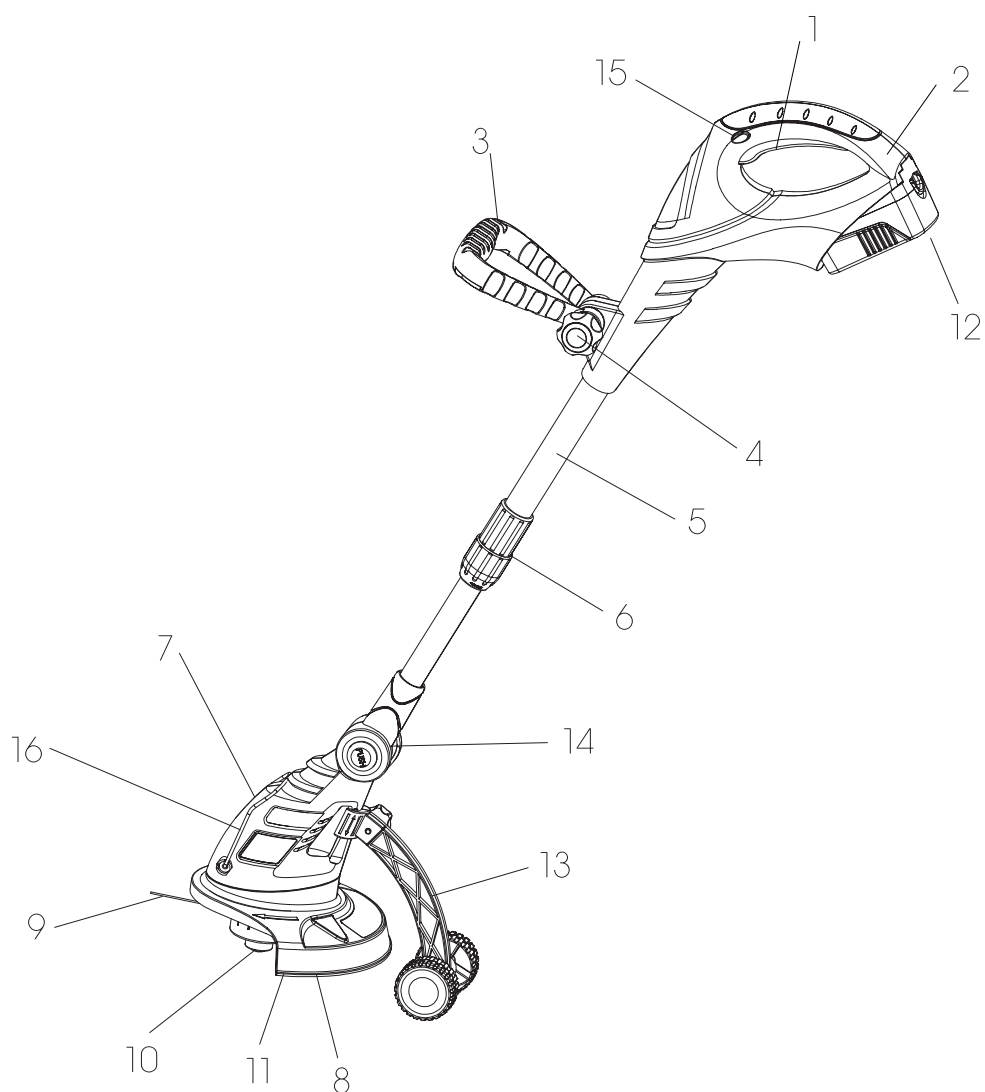

2

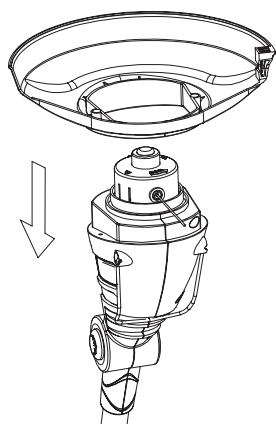

3

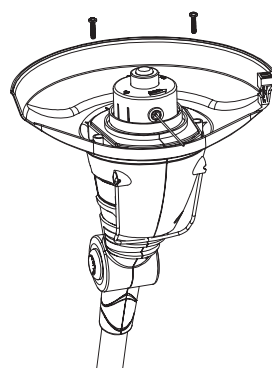

4

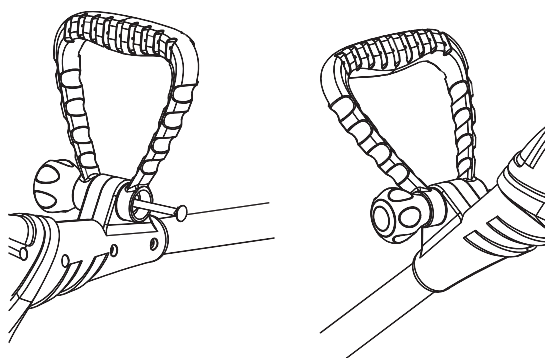

5

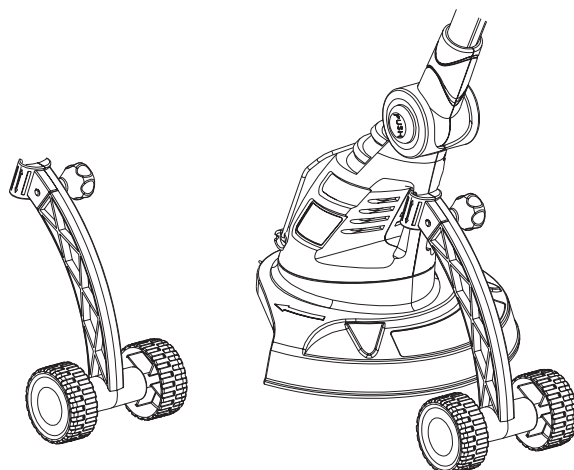

6

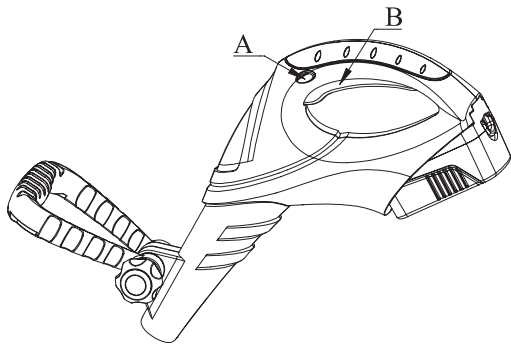

7

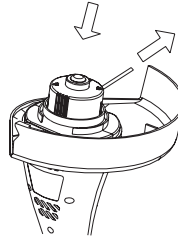

8

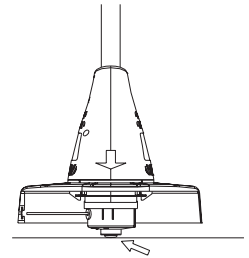

9

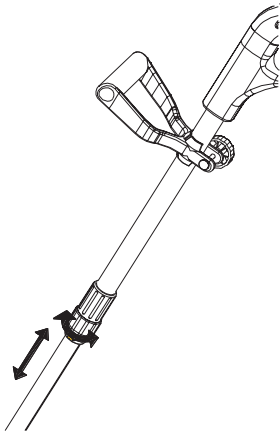

10

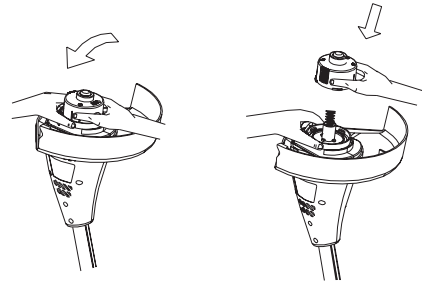

11

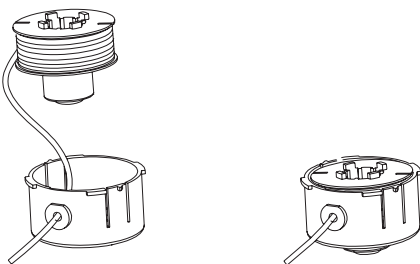

12

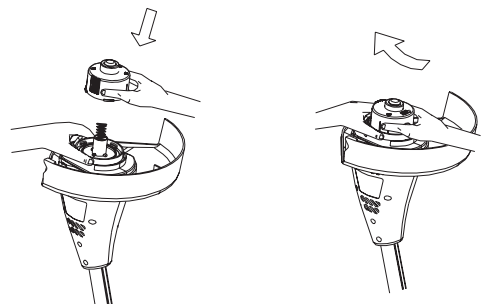

13

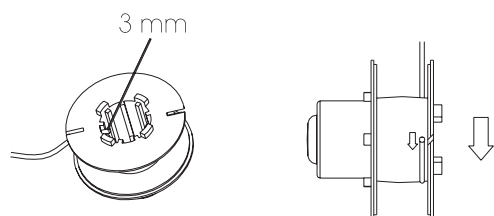

14

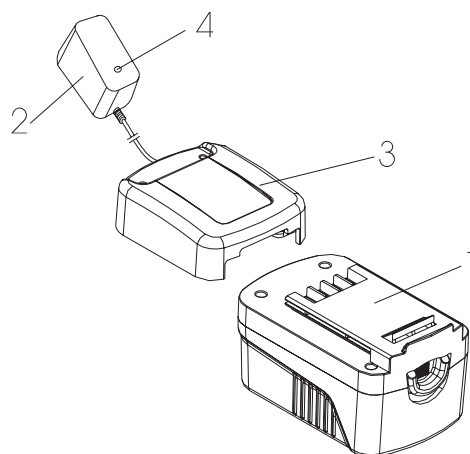

Cordless Grass Trimmer

USER'S MANUAL

Thank you for purchasing this garden cordless grass trimmer. Before you start using it, please, carefully read this user's manual and save it for possible future use.

CONTENTS

ILLUSTRATED ATTACHMENT	3
1. GENERAL SAFETY REGULATIONS	8
Important safety notices	
Packaging	
Operating instructions	
2. EXPLANATION OF INSTRUCTION LABELS ON THE MACHINE	9
3. MACHINE DESCRIPTION AND INCLUDED CONTENTS	10
4. OPERATING INSTRUCTIONS	11
Operation	
Purpose of use	
Use correct type of the tool	
5. SAFETY INSTRUCTIONS	12
Safety instructions for grass trimmer	
Safety instructions for batteries and chargers	
6. ASSEMBLY OF THE MACHINE	14
Guard installation	
Attach adjustable handle	
Wheel assembly installation	
7. PUTTING INTO OPERATION	15
Attaching the protective guard	
Turning on the machine	
Replace the spool of nylon line	
Charging the battery	
Important charging notes	
8. MAINTENANCE AND STORAGE	17
9. TECHNICAL SPECIFICATIONS	18
10. DISPOSAL	19

1. GENERAL SAFETY REGULATIONS

Important safety notices

- ✿ Carefully unpack the product and take care not to throw away any part of the packaging before you find all the parts of the product.
- ✿ Store the string trimmer in a dry place out of reach of children.
- ✿ Read all warnings and instructions. Not following warnings or instructions may lead to injury by electrical shock, a fire and/or serious injuries.

Packaging

The product is packed in a package that prevents damage during transport. This package is a resource and so can be handed over for recycling.

Operating instructions

Before you start working with the electric string trimmer, read the following safety and usage instructions. Understand the operating elements and the correct use of the device. Keep the user's manual in a safe place where it can be easily retrieved for future use. Save the original packaging, including the internal packing material, warranty card and proof of purchase receipt, at least for the duration of the warranty. If you need to ship this machine, pack it in the original cardboard box to ensure maximum protection during shipping or transport (e.g. when moving or when you need to send this product for repair).

 **Note:** If you hand over the machine to somebody else, do so together with the user's manual. Following the instructions in the included user's manual is a prerequisite for the proper use of the string trimmer. The user's manual also contains operating, maintenance and repair instructions

The manufacturer takes no responsibility for accidents or damages resulting from not following the instructions in this manual.

2. EXPLANATION OF INSTRUCTION LABELS ON THE MACHINE



General danger warnings!



Before putting into operation, carefully read the user's manual.



Keep other people away from the work area.



Do not use in the rain or in unfavorable climatic conditions



While working use protective aids.



Make sure that persons standing nearby were not injured by foreign elements.



Keep other people (especially children) and animals at least 6 m away from the work area.



Before performing any maintenance or cleaning on the tool, remove the battery from the tool.



Risk of injury from the machine running out.

3. MACHINE DESCRIPTION AND INCLUDED CONTENTS

Machine description (see pic 1)

- | | |
|--|---|
| 1 - Switch | 10 - Spool with line |
| 2 - Handle | 11 - Blade for shortening the line |
| 3 - Adjustable second handle | 12 - Battery pack |
| 4 - Screw for attaching the second handle | 13 - Wheel assembly |
| 5 - Telescopic pole for setting the working height | 14 - Joint for setting up the slope of the trimmer head |
| 6 - Locking bolt for fastening the telescopic pole | 15 - Trigger lock-off button |
| 7 - Trimmer head | 16 - Collapsible distance span for protection of plants |
| 8 - Safety guard | |
| 9 - Line | |

⚠ ATTENTION: The line cutting blade on the protective cover is sharp!

Supplied contents

Carefully take out the garden tool from the packaging and check whether all the following parts are present:

- ✿ Cordless grass trimmer
- ✿ Distance span
- ✿ Battery pack
- ✿ Wheel assembly with screw for tightening
- ✿ Charger
- ✿ Charging station
- ✿ Protective guard
- ✿ Handle with attachment screw
- ✿ User´s manual

If there are parts missing or they are damaged, please contact the vendor from whom you bought the machine.

4. OPERATING INSTRUCTIONS

Operation

- ✿ This product must not be used by children and persons with physical or mental impairments or by inexperienced persons, unless properly trained or schooled in the safe use of the product, or unless they have been properly supervised by a qualified person who will be responsible for their safety.
- ✿ Never use the cordless grass trimmer if you are in close vicinity to other people, children or freely moving household pets.
- ✿ Use extra care if the product is used near children. Always keep the appliance out of reach of children. Children must be supervised to ensure that they do not play with the product.
- ✿ Never allow children or persons who do not know the contents of this user's manual to work with the device. Local regulations may set the minimum age of the user. The user is responsible for damages caused to third parties in the string trimmer's working area as a result of its use.
- ✿ Do not use the machine if you are tired, under the influence of alcohol or narcotics.

Purpose of use

Your grass trimmer has been designed for trimming grass. Do not use the product for purposes other than those intended. The string trimmer is suitable for use in private gardens. Your charger has been designed for charging batteries of the type supplied with this tool. Do not use to charge other batteries.

Use correct type of the tool

- ✿ The intended use of the tools is described in this manual. Do not force small tools or attachments to do the job of a heavy-duty tool. The tool will do the job better and safer at the rate for which it was intended. The use of any accessory or attachment or performance of any operation with this tool other than those recommended in this instruction manual may present a risk of personal injury. Do not force the tool.
- ✿ Do not carry the tool with your hands on the switch unless the battery has been removed.
- ✿ Never carry the charger by its cord or pull it to disconnect from the socket. Keep the cord away from heat, oil and sharp edges.

5. SAFETY INSTRUCTIONS

⚠ WARNING: When using the machine the safety rules must be followed.

For your own safety and that of bystanders please read these instructions before operating the machine. Please keep the instructions safe for later use.

Safety instructions for grass trimmer

- ✿ Wear safety goggles when operating this tool.
- ✿ Wear gloves when operating this tool.
- ✿ Do not expose the tool to rain or high humidity.
- ✿ Be familiar with the controls and proper use of trimmer;
- ✿ Never allow children to use the trimmer. Please read these instructions before operating the machine.
- ✿ Keep other people (especially children) and pets away from the trimmer; the grass which is cut and dispersed may contain stones and debris. Stop using the trimmer while people, especially children, or pets are nearby.
- ✿ Do not let other people (especially children) or animals come within 6m of the trimmer when in use.
- ✿ Only use the trimmer in daylight or good artificial light.
- ✿ Before using the trimmer and after any impact, check for signs of wear or damage and repair as necessary. Do not use the trimmer if the cutting device is not secured properly or is damaged.
- ✿ Always check the good working order of the trimmer (especially the tightness of all bolts and nuts, usage of the guard) which, if not adequate, could endanger the user.
- ✿ Always use the guards when using the grass trimmer.
- ✿ Do not use the trimmer if the guards are damaged.
- ✿ Before starting the trimmer, make sure that the nylon line is not touching stones or debris.
- ✿ Keep hands and feet away from the cutting area at all times and especially, when switching on the motor.
- ✿ Guard against injury from the cutting blade fitted for trimming the filament line length. After extending new cutting line always return the trimmer to its normal operating position before switching on.
- ✿ Do not use metal cutting elements.
- ✿ Do not use replacement parts or accessories not provided or not recommended by the manufacturer.
- ✿ Remove the battery before checking, cleaning or working on the trimmer and when it is not in use.
- ✿ Always ensure that ventilation openings are kept clear of debris.
- ✿ To avoid unintentional starting, do not carry the machine with a finger on the on/off switch.
- ✿ Remain in a stable and secure position while operating the trimmer.
- ✿ Keeps the area being cut free from wires, stones and debris.

- ✿ Do not cut against hard objects. This could cause injury or damage the trimmer.

⚠ Warning: Cutting elements continue to rotate after the motor is switched off.

- ✿ Do not try to stop the cutting device (nylon line) with your hands. Always let it come to a stop by itself.
- ✿ Do not use the trimmer to cut grass which is not in contact with the ground; for example do not cut grass which is on walls or rocks etc.
- ✿ Do not cross roads or gravel paths with the trimmer still running.

Safety instructions for batteries and chargers

Batteries

- ✿ Never attempt to open for any reason.
- ✿ Do not expose to water.
- ✿ Do not incinerate the battery pack even if it is severely damaged or is completely worn out. The battery pack can explode in a fire.
- ✿ Do not store in locations where the temperature may exceed 40°C.
- ✿ Do not leave the battery pack in the charger when the charging is finished, otherwise battery leakage may occur.
- ✿ Charge only at room temperature.
- ✿ Charge only using the charger provided with the tool.
- ✿ Before charging, make sure that the battery is dry and clean.
- ✿ Use only the correct type of battery for the tool.
- ✿ When dispose of batteries follow the instructions given in the section „protecting the environment“.
- ✿ Under extreme conditions, battery leakage may occur. When you notice liquid on the battery, proceed as follows:
 - Carefully wipe the liquid off using a cloth. Avoid skin contact.
 - In case of skin or eye contact, follow the instructions below.
- ✿ The battery fluid, a 25-30% solution of potassium hydroxide, can be harmful. In case of skin contact, immediately rinse with water. Neutralize with a mild acid such as lemon juice or vinegar. In case of eye contact, rinse abundantly with clean water for at least 10 minutes. Consult a physician.

 **Note:** The batteries in your battery pack are the Lithium-Ion type. Do not dispose of battery packs/batteries into household waste, fire or water. Battery packs/batteries should be collected, recycled or disposed of in an environmental-friendly manner.

Chargers

- ✿ Never modify the plug in any way. Unmodified plugs and matching outlets will reduce risk of electric shock.

- ✿ Use your charger only to charge batteries of the type supplied with your tool. Other batteries could burst, causing personal injury and damage.
- ✿ Only 2 battery packs are allowed to be charged continuously in order to prevent overheating of charger, necessary rest time is required to let the charger cool down before further charging.
- ✿ When charging is finished, unplug the charger from mains socket outlet and take away the battery pack from the charger.
- ✿ Do not leave the battery pack in the charger.
- ✿ Never carry the charger by its cord or pull the cord to disconnect from the socket. Keep the cord away from heat, oil and sharp edges.
- ✿ Never attempt to charge non-rechargeable batteries.
- ✿ The cord of charger is not changeable, do not continue to use if the cord is damaged.
- ✿ Do not expose to water or rain, do not use in wet conditions.
- ✿ Do not open the charger.
- ✿ Do not probe the charger.
- ✿ The charger is intended for indoor use only.

6. ASSEMBLY INSTRUCTIONS

Guard installation (see pic 2,3)

- ✿ Remove two screws from the motor housing.
- ✿ Slide guard over motor housing.(see pic 2)
- ✿ Re-insert two screws into the guard and tighten as described in pic 3.

Attach adjustable handle (see pic 4)

- ✿ Turn the handle knob and draw out the bolt from the adjustable handle.
- ✿ Insert the adjustable handle in the machine handle into the requested working position. Insert the bolt and handle knob, then turn the handle knob lightly tighten.
- ✿ Before tightening completely, turn the adjustable handle in desired angle. When adjustable handle is in desired angle, tighten the handle knob securely.

Wheel assembly installation (see pic 5)

- ✿ Turn out the lock button from the wheel assembly.
- ✿ Insert the wheel assembly into the correct position and perfect height on the motor housing.
- ✿ Turn the lock button tightly.

7. OPERATION

- ✿ Grip rear handle and press trigger lock-off button (A) with thumb then pull trigger switch (B) (see pic 6). Switch off the trimmer by pulling of the trigger switch.

Turning on the machine

- ✿ Before starting the grass trimmer for the first time, check that the nylon lines touch or pass over the wire cutting blade. If they are not long enough:
 - Press the spool button (see pic 7)
 - Pull more nylon wires to lengthen. (see pic 7)
- ✿ The lengthened nylon line will be cut to size automatically by the wire cutting blade once the lawn trimmer is turned on.
- ✿ During use, the nylon line will become shortened or worn. To automatically lengthen or advance the nylon cutting line, tap the spool button lightly on ground (while the unit is running). (see pic 8)

These operations should be repeated a few times before starting work to make sure that everything is functioning properly and to familiarize yourself with the grass trimmer. Start off slowly, when you have gained experience, you will be able to use the grass trimmer to its full potential.

- ✿ The length of the grass trimmer can be infinitely varied and therefore adjusted to your individual height (see pic 9)
 - Hold the tube with one hand, and then loosen the adjusting bolt.
 - Set the handle to the correct length and tighten the adjusting bolt.

Replace the spool of nylon line

- ✿ Switch off the trimmer and wait for all parts to stop moving.
- ✿ Remove the battery pack.
- ✿ Remove the spool assembly from the trimmer. To do so, hold the outer ribbed part of the assembly with one hand, while pushing down and turning the spool head with the other to unlock it (see pic 10). The spool carrier and spool will now disassemble easily.

 **Note:** There is a spring inside the head that could easily be lost. Ensure that it is put in a safe place.

- ✿ Choose either OPTION 1 or OPTION 2 below for spool or line replacement.
 - OPTION 1: ACCESSORY REPLACEMENT SPOOL
Use replacement spool
- ✿ Insert the line through the eyelet in the spool carrier and slide the spool into it. (see pic 11)
- ✿ Making sure to insert the spring, assemble the spool and spool carrier back onto the trimmer. To do so, push the head on and turn it clockwise until it locks. (see pic 12)

- ✿ To test if the line is advancing properly, push the button with your thumbs while pulling the wire with your fingers. The line should advance freely.
 - OPTION 2: REWINDING SPOOL USING LINE
- ✿ To install line, follow the steps below:
 - Insert one end of line into the hole in the spool as shown in picture 13 about 3 mm.
 - Snugly and evenly wind the line onto the spool in the direction of the arrow on the spool (see pic 13), until the line builds up to the notches in the spool rim. Do not overfill spool. The spool holds about 6.5 m of line.

 **Note:** Line for your trimmer is available at extra cost from your local dealer.

Charging the battery (see pic 14)

The battery needs to be charged before first use and whenever it fails to produce sufficient power on jobs that were easily done before. The battery may become warm while charging; this is normal and does not indicate a problem.

 **Note:** After several charge and discharge cycles, the battery will attain full capacity.

 **Note:** DO NOT CHARGE THE BATTERY AT AMBIENT TEMPERATURES BELOW 4°C OR ABOVE 40°C. RECOMMENDED CHARGING TEMPERATURES: APPROX. 24°C.

- ✿ Connect the charger (2) to the charger station (3).
- ✿ Plug the charger into an appropriate AC power outlet. The LED (4) lights green to tell you that the charger is ready for use.
- ✿ Insert the battery pack (1) into the charger station (3) as shown in picture 13. Make sure the battery pack is fully seated in the charger station. The LED (4) lights red to tell you that the battery pack is on charge.
- ✿ The battery pack will be fully charged in about 4 hours. And the LED (4) lights green again to tell you that the battery pack is fully charged.

Important charging notes

 **Note:** Longest life and best performance can be obtained if the battery pack is charged when the air temperature is between 18-24°C. Do not charge the battery pack in a very low or very high air temperature. This is important and will prevent serious damage to the battery pack.

- ✿ When using your tool continuously, the batteries in your battery pack will become hot. You should let a hot battery pack cool down for approximately 30 minutes before attempting to recharge
- ✿ The charger and battery pack may become warm to touch while charging. This is a normal condition, and does not indicate a problem.
- ✿ Use the charger in normal room temperatures whenever possible. To prevent overheating, do not cover the charger and do not charge battery packs in direct sunlight or near heat sources.

- ✿ If the battery pack does not charge properly:
 - check current at receptacle by plugging in a lamp or other appliance.
 - move charger and battery pack to a location where the surrounding air temperature is approximately 18-24°C.
 - if charging problems persist, take or send the tool, battery pack and charger to your local service center.
- ✿ The battery pack should be recharged when it fails to produce sufficient power on jobs which were easily done previously. DO NOT CONTINUE to use under these conditions. Follow the charging procedure. You may also charge a partially used pack whenever you desire with no adverse affect on the battery pack.
- ✿ Under certain conditions, with the charger plugged in to the power supply, the exposed charging contacts inside the charger can be shorted by foreign material. Foreign materials of a conductive nature such as, but no limited to, steel wool, aluminum foil, or any buildup of metallic particles should be kept away from charger cavities. Always unplug the charger from the power supply when there is no battery pack in the cavity. Unplug charger before attempting to clean.
- ✿ Do not immerse charger in water or any other liquid.
- ⚠ **WARNING:** Don't allow any liquid to get inside charger. Electric shock may result. To facilitate the cooling of the battery pack after use, avoid placing the charger or battery pack in a warm environment such as in a metal shed, or an uninsulated trailer.
- ⚠ **WARNING:** Never attempt to open the battery pack for any reason. If the plastic housing of the battery pack breaks or cracks, return to a service center for recycling; do not put it into further use.

8. MAINTENANCE AND STORAGE

Maintenance

- ✿ After use, remove the battery pack from the trimmer.
- ✿ Use only manufacturer recommended replacement parts and accessories.
- ✿ To keep your line in top condition, store spare pre-wound spools or bulk line in a plastic, sealable bag.
- ✿ To clean the tool, remove battery pack and use only mild soap and a damp cloth to clean the tool. Do not immerse tool in water or squirt it with a hose. Do not allow any liquid to get inside it. Do not clean with a pressure washer.
- ✿ The line cutter on the edge of the guard can dull over time. It is recommended you periodically touch-up the sharpness of the blade with a file.

Storage

- ✿ Store the cordless grass trimmer in a dry location.
- ✿ Do not place any other items on the machine.
- ✿ Regularly check that the tool has not been damaged during the course of standard operation and at the end of the season clean the grass from the trimmer.
- ✿ If the product is damaged or malfunctions, contact an authorized service centre or the vendor.

9. TECHNICAL SPECIFICATIONS

Type	Cordless Grass Trimmer
Voltage	18VDC
Battery type	Lithium-Ion
Battery capacity.....	1.3 Ah
Charging time	about 4 Hours
No load speed	8000 /min
Cutting width	230 mm
Input voltage	230V / 50Hz

10. DISPOSAL

INSTRUCTIONS AND INFORMATION REGARDING THE DISPOSAL OF USED PACKAGING MATERIALS

Dispose of packaging material at a public waste disposal site.

DISPOSAL OF USED ELECTRICAL AND ELECTRONIC APPLIANCES



The meaning of the symbol on the product, its accessory or packaging indicates that this product shall not be treated as household waste. Please, dispose of this product at your applicable collection point for the recycling of electrical & electronic equipment waste. Alternatively in some states of the European Union or other European states you may return your products to your local retailer when buying an equivalent new product. The correct disposal of this product will help save valuable natural resources and help in preventing the potential negative impact on the environment and human health, which could be caused as a result of improper liquidation of waste. Please ask your local authorities or the nearest waste collection centre for further details. The improper disposal of this type of waste may fall subject to national regulations for fines.

For business entities in the European Union If you wish to dispose of an electrical or electronic device, request the necessary information from your seller or supplier.

Disposal in other countries outside the European Union

If you wish to dispose of this product, request the necessary information about the correct disposal method from local government departments or from your seller.



This product meets all the basic EU regulation requirements that relate to it.

Changes to the text, design and technical specifications may occur without prior notice and we reserve the right to make these changes.