



Deckless Bluetooth Car Stereo

MODEL NUMBER: 60474

USER GUIDE

After Sales Support

UK/N.IRELAND HELPLINE N°: 01270 508538
REP.IRELAND HELPLINE N°: 1800 995 036
WEBSITE: www.qesh.co.uk
EMAIL: enquiries@qesh.co.uk



Contents

1. Welcome Section
2. General Information & Safety Instructions
3. Installation
4.
5. Wiring Connections
6. Fascia Controls
7. Remote Control
8. Basic Operation
9. Radio Operation
10. USB, SD/MMC Operation
11. AUX In, RCA Out
12. Bluetooth Operation
13. FAQ

After Sales Support

UK/N.IRELAND HELPLINE N^o: 01270 508538

REP.IRELAND HELPLINE N^o: 1800 995 036

WEBSITE: www.qesh.co.uk

EMAIL: enquiries@qesh.co.uk

Welcome Section

Congratulations!

You have made an excellent choice with the purchase of this quality MAXTEK® product.

By doing so you now have the assurance and peace of mind which comes from purchasing a product that has been manufactured to the highest standards of performance and safety, supported by the high quality standards of Qesh.

We want you to be completely satisfied with your purchase so this MAXTEK® product is backed by a comprehensive manufacturer's 3 year warranty and outstanding after sales service through our dedicated helpline.

We hope you enjoy using this product for many years to come.

If you require technical support or in the unlikely event that your purchase is faulty, please telephone our helpline for immediate assistance. Faulty product claims made within the 3 year warranty period will be repaired or replaced free of charge provided that you have a satisfactory proof of purchase (keep your receipt safe). This does not affect your statutory rights. However be aware that the warranty will become null and void if the product is found to have been deliberately damaged, misused and/or disassembled.

After Sales Support

UK/N.IRELAND HELPLINE N°: 01270 508538
REP.IRELAND HELPLINE N°: 1800 995 036
WEBSITE: www.qesh.co.uk
EMAIL: enquiries@qesh.co.uk



General information & Safety Instructions

This remote control is powered by 1 x 'CR-2025' lithium battery.

Do not dispose of batteries in your household waste.

Please contact your local authority for details on safe disposal.

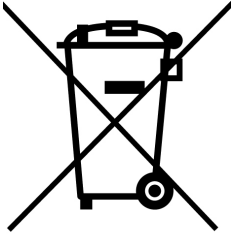

- Never throw batteries into a fire or expose to excessive heat sources.
- If batteries are swallowed, please seek immediate medical attention.
- Always ensure correct +/- battery polarity when installing batteries.
- Do not recharge non-rechargeable batteries.

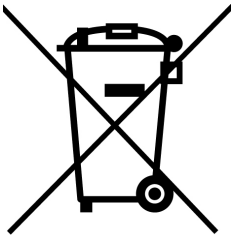

Electrical and electronic equipment (WEEE) contains materials, parts and substances, which can be dangerous to the environment and harmful to human health if the waste of electrical and electronic equipment (WEEE) is not disposed of correctly.

Equipment, which is marked with the WEEE logo (as shown on the left), should not be thrown away with your household waste. Contact your local authority waste disposal department, as they will be able to provide details of the recycling options available in your area.

After Sales Support

UK/N.IRELAND HELPLINE N°: 01270 508538

REP.IRELAND HELPLINE N°: 1800 995 036

WEBSITE: www.qesh.co.uk

EMAIL: enquiries@qesh.co.uk

Installation

WARNING!

Disconnect negative battery terminal from battery before starting installation. Consult the vehicle owner's manual for proper instructions.

Please Note:

Mark the polarity of the existing speaker wires before disconnecting battery.

DIN Front Mount

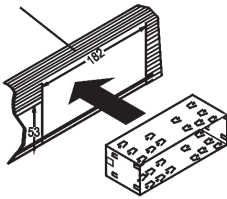

1. After removing the old radio and mounting sleeve, insert supplied mounting sleeve into opening.

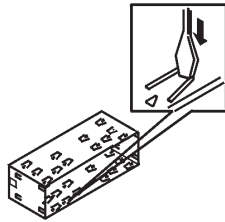

2. Bend the tabs on the mounting sleeve to keep the mounting sleeve firmly in place.

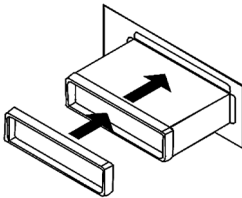

3. Attach the wires from the unit to the existing wires. See wiring connections diagram. Insert radio into dashboard. Then apply the trim frame to outside of radio.

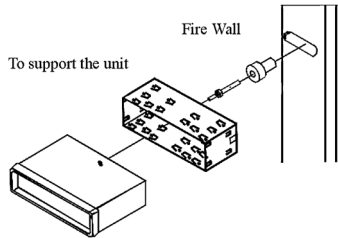

4. Support radio using supplied rear mounting bolt and steel bar. See parts list.

After Sales Support

UK/N.IRELAND HELPLINE N°: 01270 508538
REP.IRELAND HELPLINE N°: 1800 995 036
WEBSITE: www.qesh.co.uk
EMAIL: enquiries@qesh.co.uk

Installation

Din Rear-Mount

Installation using the screw holes on both sides of the unit.

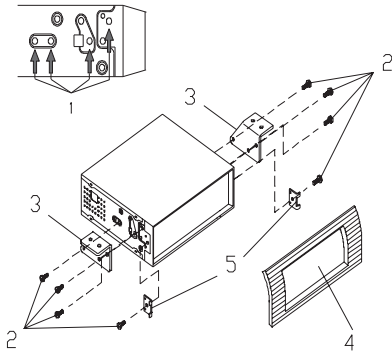

1. Screw holes on the side of the unit.
2. Screws. Use either truss screws (5x8mm) or flush surface screws (4x8mm), depending on the shape of the screw holes in the bracket.
3. Vehicle factory mounting bracket.
4. Dashboard or console.
5. Hook (remove this part)

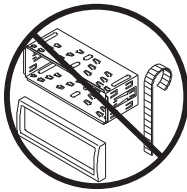

Please Note:

The mounting sleeve, outer trim ring and the mounting strap are not used for this method of installation.

Supplied Parts

- 2 Keys
- 1 Faceplate Case (not shown)
- 1 1/8" Stereo Cable
- 1 Remote control

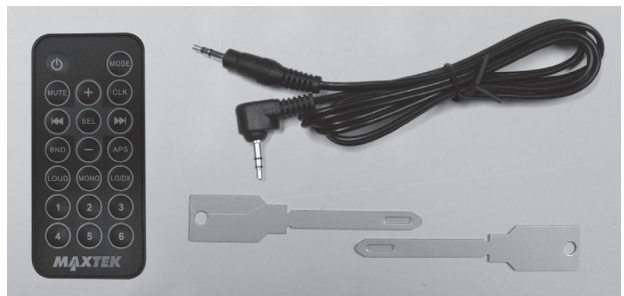

After Sales Support

UK/N.IRELAND HELPLINE N°: 01270 508538
REP.IRELAND HELPLINE N°: 1800 995 036
WEBSITE: www.qesh.co.uk
EMAIL: enquiries@qesh.co.uk

Wiring Connection

Make sure that you have a good chassis ground. Good ground connections will eliminate most electrical noise problems. A good chassis ground requires a tight connection to the vehicle's metal chassis. The area around the ground connection should be clean, bare metal without rust, paint, plastic, dust, or dirt for a good electrical connection.

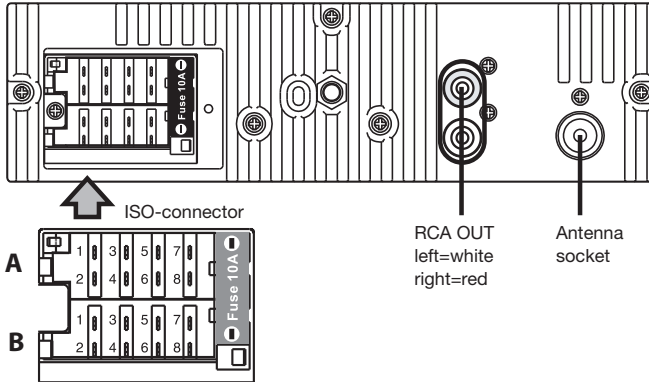

- Connector A
1. Rear right speaker(+)/Purple
 2. Rear right speaker(-)/Purple-Black
 3. Front right speaker(+)/Grey
 4. Front right speaker(-)/Grey-Black
 5. Front left speaker(+)/White
 6. Front left speaker(-)/White-Black
 7. Rear left speaker(+)/Green
 8. Rear left speaker(-)/Green-Black

- Connector B
1. -
 2. -
 3. -
 4. Battery 12V (+)/Yellow
 5. Antenna power/Blue-White
 6. -
 7. ACC+/Red
 8. Ground/Black

Please Note:

Follow the above wiring diagram to install the head unit with new or existing speakers.

This unit is designed for use with four (4) speakers with an impedance between 4 Ohms to 8 Ohms.

An impedance load of less than 4 Ohms could damage the unit.

Never bridge or combine the speaker wire outputs. When not using four speakers, use electrical tape to tape the ends of the un-used speaker outputs to prevent a short circuit.

Never ground the negative speaker terminals to chassis ground.

After Sales Support

UK/N.IRELAND HELPLINE N^o: 01270 508538
 REP.IRELAND HELPLINE N^o: 1800 995 036
 WEBSITE: www.quesh.co.uk
 EMAIL: enquiries@quesh.co.uk

Fascia Controls

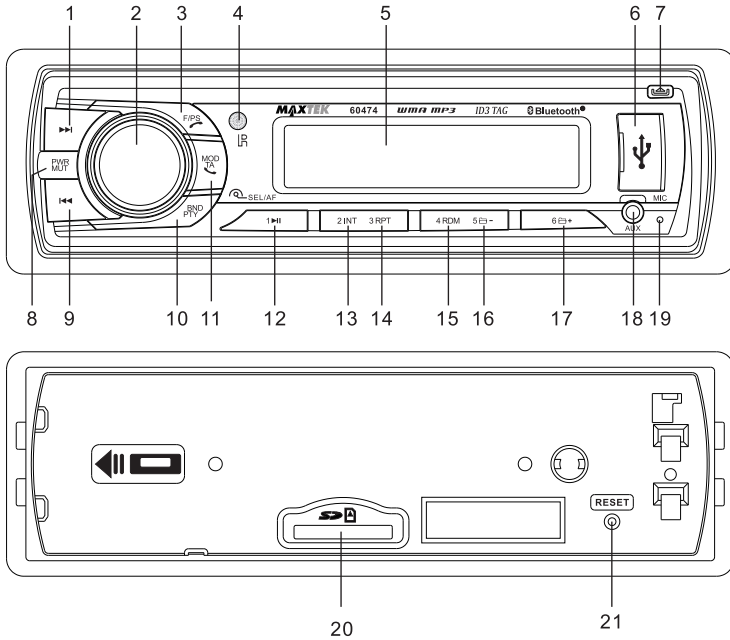

- | | |
|--------------------------------------|-----------------------------|
| 1. Next Track / Fast Forward Button | 12. Number 1 / Play / Pause |
| 2. Sound Select / Volume +/- / AF | 13. Number 2 / Introduction |
| 3. Auto Preset Scan / Reject Button | 14. Number 3 / Repeat |
| 4. Remote Control Receiver | 15. Number 4 / Random |
| 5. LCD Screen | 16. Number 5 / Folder Down |
| 6. USB Slot | 17. Number 6 / Folder Up |
| 7. Release Panel Button | 18. Aux input port |
| 8. Power on / off / Mute | 19. MIC Receiver |
| 9. Previous Track / Backward Button | 20. SD Card Slot |
| 10. Band Switch / PTY | 21. Reset Button |
| 11. Mode Select / TA / Answer Button | |

After Sales Support

UK/N.IRELAND HELPLINE N^o: 01270 508538
 REP.IRELAND HELPLINE N^o: 1800 995 036
 WEBSITE: www.qesh.co.uk
 EMAIL: enquiries@qesh.co.uk

Remote Control

Operating the remote control

- Aim at the face panel of the CD receiver, the maximum distance at which signals can be received is about 6 metres.
- Make sure that the signal path is not obstructed.

Battery Safety

- Take care when fitting batteries, observing the polarity marking on the battery and the product.
- Never dispose of batteries in fire. Risk of explosion.
- Never attempt to recharge non-rechargeable batteries.
- Seek immediate medical advice if you believe a cell has been swallowed.
- Keep batteries away from children.
- Remove batteries from a product if it is not to be used for a period of time.

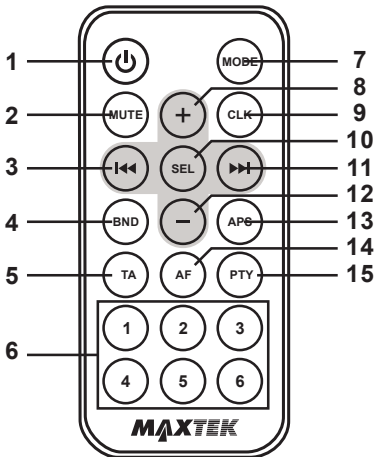

1. Power On / off
2. Mute Sound Button
3. Stations Tune / Seek / Track Down
4. Band Switch
5. TA Control
6. Radio Memory 1-6
7. Mode Select
8. Sound +
9. Time Clock Display
10. Sound Select Key
11. Stations Tune / Seek / Track Up
12. Sound -
13. Auto Preset Scan
14. AF Control
15. PTY Control

Replacing the batteries

Follow the 3 steps below:

1. Remove the cover from the back of the remote control.
2. Insert a CR-2025 Lithium battery.
3. Replace the cover on the back of the remote control.

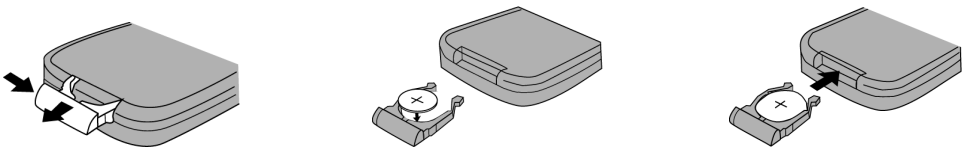

After Sales Support

UK/N.IRELAND HELPLINE N°: 01270 508538
REP.IRELAND HELPLINE N°: 1800 995 036
WEBSITE: www.qesh.co.uk
EMAIL: enquiries@qesh.co.uk

Basic Operation

Tuning the unit On / Off

Press POWER button to turn the unit on. Press again to turn the unit off.

Mode Selection

Press the MODE button to cycle through different play modes.

Loudness Control

Press the SEL dial repeatedly until the display shows "LOUD ON" or "LOUD OFF". Rotate the VOL dial to adjust. When "LOUD ON" is shown on the display indicates that loudness function is on.

Mute Control

Press the MUTE button to activate the mute function. Press the button again to cancel.

Volume

Rotate the VOL dial to adjust the volume level. Turn the VOL dial clockwise to increase the volume, and vice versa. The larger the number of volume, the louder the volume level.

Bass

Press the SEL dial repeatedly until the display shows "BAS". Rotate the VOL dial to adjust. When DSP is ON, bass control is not available.

Treble

Press SEL dial repeatedly until the display shows "TRE". Rotate the VOL dial to adjust. When DSP is ON, treble control is not available.

Balance

Press SEL dial repeatedly until the display shows "BAL", then Rotate the VOL dial to adjust the balance between the left & right speakers. When "L=R" is shown on the screen, it indicates that the balance is 0.

Fader

Press SEL dial repeatedly until the display shows "FAD", Rotate the VOL dial to adjust the balance between the front & rear speakers. When "F=R" is shown on the screen, it indicates that the fader is 0.

Preset Equalizer Function

Press SEL dial until the display shows "EQ", then rotate the SEL dial to choose the EQ sound effects. The Sequence of equalizer setting will be as follows: FLAT-ROCK-POP-CLASS
Press SEL dial to confirm.

Beep Function

Press SEL dial repeatedly until the "BEEP" shown on the screen. Rotate the VOL dial to choose "BEEP OFF" or "BEEP ON". "BEEP OFF" means Beep function is inactive. "BEEP ON" means a beep sound will be heard when any button pressed.

Clock

Press the CLK button on the remote, the clock will show on the display. Press and hold the button until the hour digits flash on the display, rotate the SEL dial to set hours, then press the SEL button until the minutes digits flash and rotate the SEL dial to set. Press the CLK button to confirm.

After Sales Support

UK/N.IRELAND HELPLINE N^o: 01270 508538
REP.IRELAND HELPLINE N^o: 1800 995 036
WEBSITE: www.qesh.co.uk
EMAIL: enquiries@qesh.co.uk

Radio Operation

Choose Radio Band

Press the BND Button anytime to access the radio function. The unit comes with five bands, three FM Bands (FM1, FM2, and FM3) and two AM Bands (AM1, and AM2). Each of the five bands can store up to six preset stations, for a total of 30 preset memory stations.

Radio Tune / Seek Function

In radio mode, press the Seek +/- button to automatically seek the next strong and clear radio station. Press and hold the Seek +/- button until the screen shows MANUAL. At this time, you can manually fine tune your desired frequency. Wait until the MANUAL to disappear in order to perform auto seek again.

Press and hold the SEEK [<< or >>] button for 2 seconds and the radio will seek the next strong and clear frequency station. Repeat to seek more stations in your listening area with a strong signal.

Mono / Stereo Reception Control

In FM radio mode, Press SEL button repeatedly until the display shows 'MONO' or "STEREO". Rotate the VOL dial to choose the reception control, the word "MONO" shown on the screen indicating the mono reception is received and "STEREO" for stereo.

Save Your Preset Stations

There are six numbered preset buttons which can store and recall stations for each band. While listening to a radio station you would like to save as a pre-set, press and hold one of the buttons numbered 1-6 until the preset station number is shown. The button you pressed is now the pre-set button for that station.

Automatic Scan & Store

While listening to the FM or AM Radio, press and hold the F/PS Button for 3 seconds. The receiver will automatically scan and save to the presets the strongest radio station signals available to you in your area.

Scan Saved Stations

Press the F/PS button once to perform the preset scanning function. In FM or AM mode, press the F/PS button and the stations stored in the FM band preset will be scanned. The scan will pause on each preset for 6 seconds before moving on to the next. To stop and listen to a preset of your choice press the SEL dial.

Local / DX

Press SEL Button repeatedly until the display shown "LOC". Rotate the VOL button to choose, "LOC ON" or "LOC OFF". When "LOC ON" shown on the display, this means local reception is turned on. When "LOC OFF" is shown on the display, this means distant reception is turned on.

Local and distance reception settings can facilitate the radio reception, depending on the location in which the radio is being used.

After Sales Support

UK/N.IRELAND HELPLINE N^o: 01270 508538
REP.IRELAND HELPLINE N^o: 1800 995 036
WEBSITE: www.qesh.co.uk
EMAIL: enquiries@qesh.co.uk

Radio Operation

AF - (Alternative Frequency)

When AF function is on the unit will choose the strongest FM signal for the selected station, so that you do not have to re-tune the stations when driving between different transmitter coverage areas. When AF is on, it means RDS information is being received. When AF is flashing, it means that RDS information is not yet received. Press and hold the SEL dial , "AF ON" will be shown on the display rotate the VOL dial to choose "AF ON" or "AF OFF".

TA - (Traffic Announcement)

Press and hold the TA button so that the unit will receive traffic announcement from local radio stations.

To choose the TA mode, press the SEL dial for 2 seconds, the display will show "TA SEEK". Rotate the encoder volume to choose between the TA SEEK and TA ALARM, after choosing, please leave the unit idle for the mode to activate. In TA SEEK mode, the unit will seek for traffic announcement program when TA is pressed. When in TA ALARM mode, no TA/TP is displayed and the alarm is set off.

PTY - (Program Type)

This radio will allow you to select the type of program required, and will search for a station broadcasting that type of program. Press and hold the PTY button once to show the music type. Then press 1-6 button to choose the different music types available.

Press the PTY button twice to show the speech type program. Then press 1-6 button to choose the different speech type program. Each number key will show 3 different speech programs for you to choose.

Mask DPI - Mask ALL

Press the sound select button for 2 seconds, the display will show "TA SEEK". Press the sound select button again so that the unit will show "MASK DPI". Rotate the encoder volume to toggle between MASK DPI and MASK ALL mode. Then leave the unit idle for the mode to take effect. During MASK DPI mode, the unit will mask only the AF which has different PI, this is the default mode; during MASK ALL mode, the unit will mask the AF which has different PI and no RDS signal with high field strength.

Retune S/L - (Short/Long)

This function is to set the initial duration of automatic TA Search. Press and hold the SEL dial until "TA SEEK" is shown on the display, then press the SEL dial to cycle through the menu selections until "RETUNE_S" is shown, rotate the VOL dial to choose "RETUNE_S" or "RETUNE_L". The default is "RETUNE_S".

RDS Operation

This unit is equipped with the latest technology of EON control, so that when you are listening to Radio or CD, if there is any travel announcement from a nearby local station, the radio will already know the frequency of that radio station. Then it will receive the station, turn up the volume, or interrupt the playback of the music for the duration of the announcement. At the end of the announcement the radio will return to its previous state ready for the next announcement.

After Sales Support

UK/N.IRELAND HELPLINE N°: 01270 508538
REP.IRELAND HELPLINE N°: 1800 995 036
WEBSITE: www.qesh.co.uk
EMAIL: enquiries@qesh.co.uk

USB, SD/MMC Operation

Play MP3 / WMA from USB/SD

Plug the USB or SD card into the USB or SD port. The MP3 and WMA files in the USB or SD card will be played automatically. If there is no MP3 or WMA files in the USB or SD card, "USB PLAY" or "SD/MMC" will be shown on the screen.

Play Mode

The USB or SD/MMC mode can be chosen by pressing the MODE button. The "USB PLAY" means it is in USB play mode, while "SD/MMC" means it is in SD play mode.

Track / Folder Search

Press >>| button once to advance one track, Press |<< button once to go back one track. Press F/PS button once, the track number will be blink on the screen. Rotate the VOL dial to select the track number in this folder. Press SEL dial to confirm the selection.

ID3

The name of the song will be displayed automatically on the screen.

Play / pause

When the card/ USB device has been already loaded the playback of the first track starts automatically. Press the "1 PAU" button and the "PAUSE" will be flashing on the screen.

Introduction

Press the "2 INT" button to select the previous part of each song in the card / USB to play. The "INT + Track no." will be shown on the screen, indicating each song will be played for 10 seconds. After the ending of one song, the consequent song will be played for 10 seconds and so on. Press the "2 INT" button to cancel.

Repeat

Press the "3 RPT" button to repeat the same song continuously. The "RPT+ Track no." will be shown on the screen, indicating the repeat process is operating. Press "3 RPT" button to cancel.

Random

Press the "4 RDM" button to play all the files in card/ USB in random order. The "RDM + Track no." will be shown on the screen, indicating the songs are arranged in random order. Press "4 RDM" button to cancel.

Folder Down

Press the "5 ⏪-" button once to go back one folder.

Folder UP

Press the "6 ⏩+" button once to advance one folder.

AUX IN, RCA OUT

Auxiliary Input

The auxiliary input port is on the fascia. Insert the stereo 3.5mm plug into the AUX IN port on the panel of the unit. Connect the other end of the cable to the headphone port of any external audio device such as an MP3 player, portable DVD player, etc. Press the Mode button to select AUX.

RCA Output

The RCA output port is on the back of the unit. (Refer to page 5) This output is for connecting amplifier, equalizer, or other audio component that requires a pre-amp out connection. (Red = Right, White = Left) Follow the manufacturers instructions for the audio component that you are connecting.

After Sales Support

UK/N.IRELAND HELPLINE N°: 01270 508538
REP.IRELAND HELPLINE N°: 1800 995 036
WEBSITE: www.quesh.co.uk
EMAIL: enquiries@quesh.co.uk

Bluetooth Operation

Pairing

The bluetooth function of this radio is always in standby mode ready for pairing and connection, signalled by a flashing bluetooth icon on the LCD Display.

Run the bluetooth search and connect function on your mobile phone. Find and select "BT car stereo" on your mobile phone. If you are asked for a connection password, please input "0000" on your mobile phone to finish the pairing. The bluetooth icon on the display will be on indicating that the connection is established. The bluetooth functions are ready to use.

Calling

In any play mode, dial the desired number on your mobile phone. The unit will switch to bluetooth handsfree mode automatically. "CALL OUT" will be shown on the display indicating the dialling is in progress.

Accepting Calls

When there is incoming call, the call number will be shown on the display indicating there is phone call to answer. "BT TALK" will be shown after the "ANSWER" button is pressed. Rotate the VOL dial during the ring tone or conversation to adjust the respective volume level.

Rejecting Calls

During the ring tone or conversation, press the "EJECT" button to end the call or reject the call. "END CALL" will be shown on the display and the unit will resume to the original play mode.

BT Audio (A2DP)

Press MOD/(with green phone logo) button until the unit displays "BT MUSIC". BT audio will play automatically when you play the song on the mobile phone.

You can pause by the "▶■" button.

To choose previous or next song press [<< or >>] button.

Disconnecting

Disconnect the paired phone by operating on the cellphone. You cannot process disconnection on the car radio headunit.

After Sales Support

UK/N.IRELAND HELPLINE N^o: 01270 508538

REP.IRELAND HELPLINE N^o: 1800 995 036

WEBSITE:

www.qesh.co.uk

EMAIL:

enquiries@qesh.co.uk

FAQ

Problem	Cause	Solution
No power.	The car ignition is switched off. The fuse is blown.	If the power supply is properly connected, switch the ignition key to ON or ACC. Replace the fuse according to the wiring diagram.
Error on LCD display or no function when buttons are pressed.	Inbuilt processor is not operating due to noise. Fascia is not mounted correctly.	Press the RESET button. (See page 6.) Reattach fascia correctly.
Poor or no radio reception.	Loose connection / Not connected. Poor reception area. Bad earth connection. Internal vehicle aerial.	Check aerial connection on the back of the unit. Manually tune in station. Check the cradle has a rust free, tight connection to the vehicle's chassis. 3rd party signal booster maybe required.
Auto scan does not stop at a station.	Transmission signal are too weak.	Manually tune in station.
No sound.	Volume control set too low. The device has not been connected properly.	Turn up volume properly. Check wiring according to the wiring diagram.
MP3/WMA files on USB or SD/MMC do not play.	Storage greater than 8Gb. Incorrect file format. (NTSC) The music files are DRM protected.	Use a USB, SD/MMC storage device with no greater storage capacity the 8Gb Format the storage device into either FAT or FAT32 file format. This unit is not DRM compatible.
Bluetooth not working.	Bluetooth module locked up.	Disconnect and reconnect ISO cable.
Device connecting via bluetooth but not functioning.	Bad pairing profile on device. Bluetooth version not compatible	Delete the pairing profile off of your device, press RESET on fascia (see page 6.) and re-pair device. No solution.

After Sales Support

UK/N.IRELAND HELPLINE N°: 01270 508538
 REP.IRELAND HELPLINE N°: 1800 995 036
 WEBSITE: www.qesh.co.uk
 EMAIL: enquiries@qesh.co.uk



Warranty Certificate

Warranty

This product is guaranteed to be free from defects in workmanship and parts for a period of 36 months from the date of purchase. Defects that occur within this warranty period, under normal use and care, will be repaired, replaced or refunded at our discretion, solely at our option with no charge for parts and labour. The benefits conferred by this warranty are in addition to all rights and remedies in respect of the product the consumer has under existing U.K. laws.

Proof of Purchase

This warranty is valid for the original purchase and is not transferable.

Please keep your purchase receipt as proof of purchase and as proof of the date of when the purchase was made. The receipt must be presented with the warranty card when making a claim under this warranty.

Service during the Warranty Period

Please ensure the product is properly packaged so as to ensure that no damage occurs in transit. Also make sure that you have included a detailed explanation of the problem.

Extent Warranty

This warranty is limited to defects in workmanship or parts. All defective products or parts will be repaired or replaced. This warranty does not extend to accessories.

Normal Wear and Tear

This warranty does not cover normal wear and tear of the product or parts.

Exclusions

This warranty does not cover the following:

- Any defect caused by accident, misuse, abuse, improper installation or operation, lack of reasonable care, unauthorised modification, loss of parts, tampering or attempted repair by a person not authorised by the distributor.
- Any product that has been damaged by lightning strike either directly or indirectly, or on a main's or vehicle outlet power surge or liquid ingress.
- Any product that has not been installed, operated or maintained in accordance with the manufacturer's operating instructions provided with the product.
- Any product that has been used for purposes other than domestic use.
- The product if it is located outside of the U.K.
- Any damage caused by improper power input or improper cable connection.

After Sales Support

UK/N.IRELAND HELPLINE N°: 01270 508538
REP.IRELAND HELPLINE N°: 1800 995 036
WEBSITE: www.qesh.co.uk
EMAIL: enquiries@qesh.co.uk



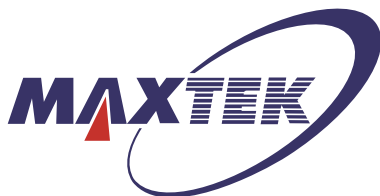

Warranty Card

Deckless Bluetooth Car Stereo

Model Number: 60474

Please keep your purchase receipt together with your warranty card

Name: _____

Address: _____

 _____

Date of purchase: _____

Location of purchase: _____

Fault Description:

We recommend that you attach a photocopy of your receipt, showing the date of purchase, to this warranty card and keep it for your reference. In the event of a product fault, please call the After Sales Support team. Please ensure that you have the product details (as shown on this card) to hand so that the support team are able to respond as quickly and efficiently as possible.

After Sales Support

UK/N.IRELAND HELPLINE N^o: 01270 508538
REP.IRELAND HELPLINE N^o: 1800 995 036
WEBSITE: www.quesh.co.uk
EMAIL: enquiries@quesh.co.uk

Service Helpline

QUESH LTD,
1 SOLWAY COURT,
CREWE BUSINESS PARK,
CW1 6LD



