

FUNCTIONAL AND CONSTRUCTION FEATURES

- ◆ Internal and external structure in stainless steel or white painted steel, top and back in galvanized steel (stainless steel on model RS06NX1F). 150 mm high - adjustable feet.
- ◆ Digital control panel allowing the easy and precise setting and control of the internal temperature.
- ◆ Completely automatic defrosting and automatic evaporation of defrost water (304 AISI models), manual emptying of defrost water (stainless steel models).
- ◆ High standards of hygiene and ease of cleaning are guaranteed by the rounded internal corners of the cabinet and easily removable runners and grids (without the use of tools).
- ◆ The refrigeration unit can operate in tropical climates (+43°C ambient temperature).
- ◆ Excellent forced air cooling system that ensures the utmost uniformity of temperature in the cabinet and guarantees a perfect storage quality of the goods.
- ◆ Extremely quiet operation at 51 dBA.
- ◆ High-density expanded polyurethane insulating foam, 60 mm in thickness, with cyclopentane injection, guarantees exceptional, long-term insulation and notable energy savings.
- ◆ The rational use of the internal space of the refrigerator guarantees a large storage area suitable to contain 2/1 GN grids.
- ◆ Reversible self-closing door, in positions less than 90°, with a stop at 95° and a maximum opening at 180°, equipped with a magnetic door seal to guarantee perfect closure. The pressed stainless steel recessed door handle without joints makes opening the cabinet extremely easy.
- ◆ All the doors are fitted as standard with locks and keys and a microswitch to switch off the fan when the door is opened.
- ◆ Stainless steel feet (plastic interior).
- ◆ A wide range of optional accessories are available.
- ◆ CFC and HCFC free.
- ◆ All models comply with the standards required by the main international approval bodies and are H marked.

ACCESSORIES	MODELS								
	RS06P41F 726454	RS06PX1F 726452	RS06RX1F 726317	RS06RX2H 726689	RS06NX1F 726455	RS06PW1F 726473	RS06N41F 728638	RS06DX2F 726319	RS06RX1FR 727103
2 S/S RUNNERS FOR 600-650/1300-1400L.REF	881456	881456	881456		881456	881456	881456		881456
2 S/S SIDE RUNNERS FOR 600-1300L REFRIG.				880557				880557	
2 WHEELS FOR REFRIGERATORS/REFRIG.TABLES	880539	880539	880539	880539	880539	880539	880539	880539	880539
2/1 GN AISI 304 S/S GRID	881067	881067	881067	881067	881067		881067	881067	881067
2/1 GN GREY "RILSAN" GRID	880720	880720	880720	880720	880720	880720	880720	880720	880720
ENERGY FREE ALARM DEVICE	881089	881089	881089	881089		881089	881089		881089
KIT HACCP EKIS	922166	922166	922166	922166	922166	922166	922166	922166	922166
KIT INTEGRATED HACCP-DIG. REFR. (IR33)	880205	880205	880205	880205	880205	880205	880205	880205	880205
KIT TO FIT 11 PASTRY TRAYS (400X600 MM)	881031	881031	881031	881031	881031	881031	881031		881031
MEAT RAIL FOR 650-1400 L REFRIGERATORS	881451	881451	881451		881451			881451	881451
PRINTER FOR HACCP BASIC VERSION REFRIG.	881457	881457	881457	881457	881457	881457	881457	881457	881457
REMOTE UNIT -2/+10°C FOR 550/650 L									881463



www.zanussiprofessional.com

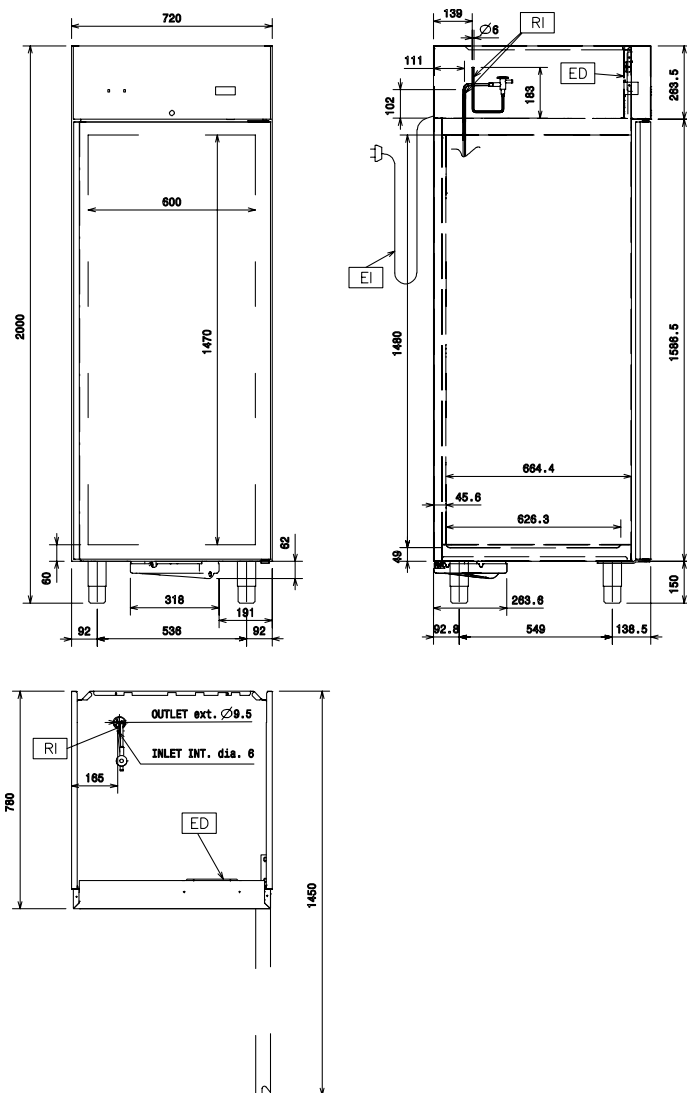

	RS06P41F 726454	RS06PX1F 726452	RS06RX1F 726317	RS06NX1F 726455	RS06PW1F 726473	RS06N41F 728638	RS06DX2F 726319
EI - Electrical connection	230 V, 1, 50	230 V, 1, 50	230 V, 1, 50	230 V, 1, 50	230 V, 1, 50	230 V, 1, 50	230 V, 1, 50



www.zanussiprofessional.com

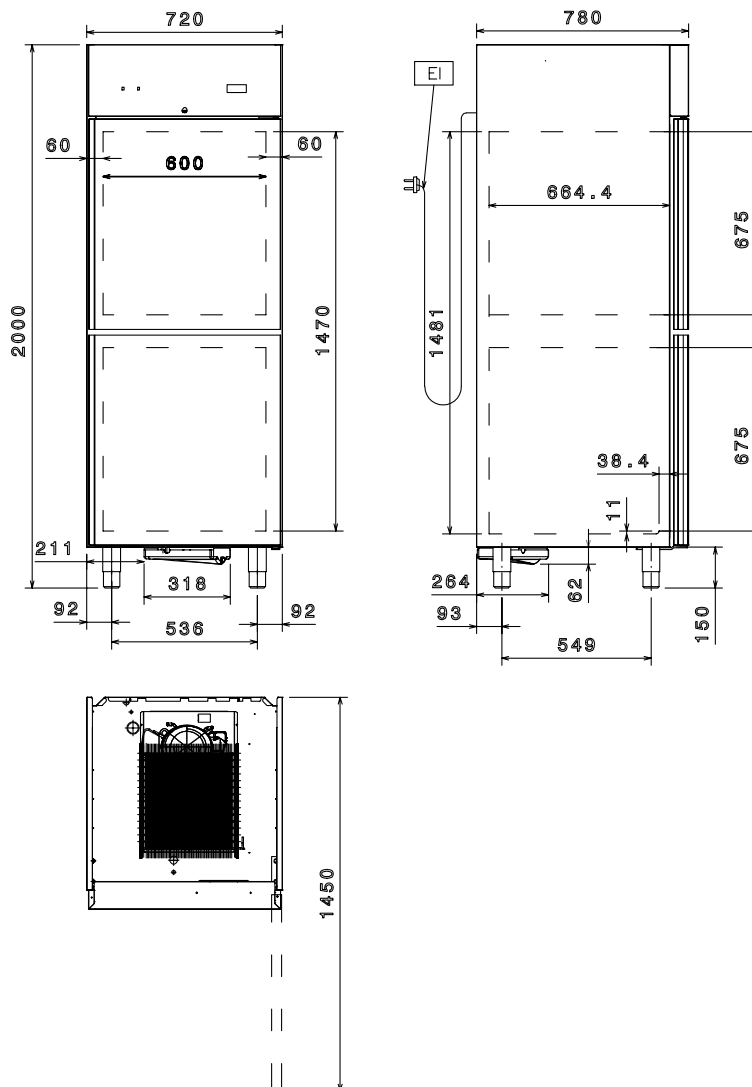

EI - Electrical connection	RS06RX2H 726689
	230 V, 1, 50



www.zanussiprofessional.com

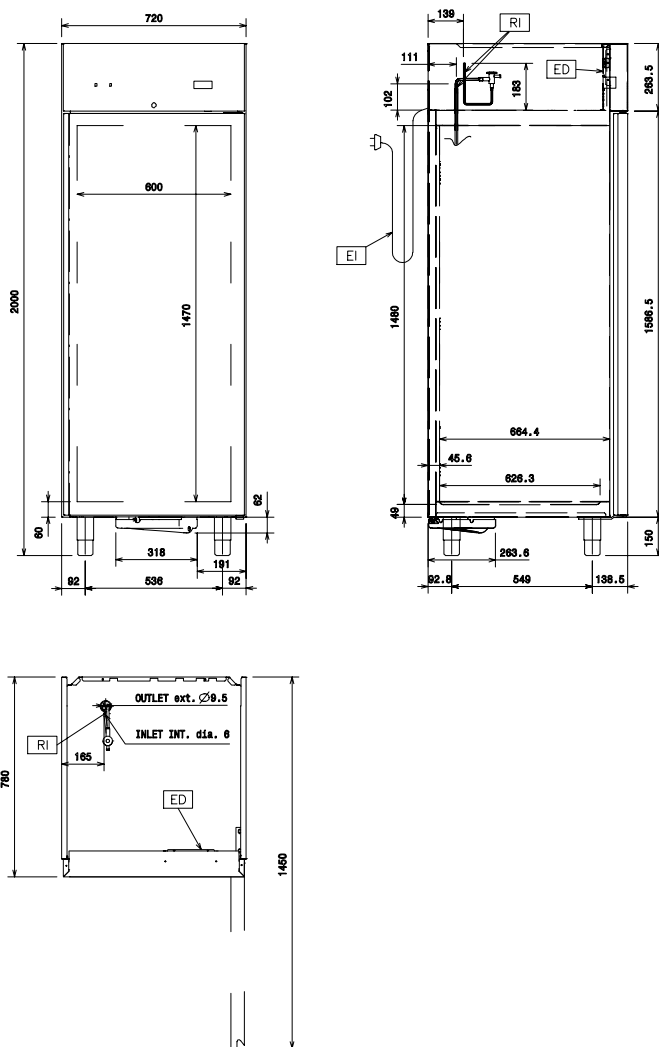

	RS06RX1FR 727103
ED - Remote electrical connection	●
EI - Electrical connection	230 V, 1, 50
RI - Remote refrigeration connection	●



www.zanussiprofessional.com