

OPERATING INSTRUCTIONS

**ZANUSSI**

**REFRIGERATOR-FREEZER**  
**RONDO**

# CONTENTS

<b>Safety information</b>	Page	2
<b>Technical specification</b>	Page	3
<b>General features</b>	Page	4
<b>Installation</b>	Page	5
Positioning	Page	5
Levelling	Page	5
<b>Electrical connections</b>	Page	6
<b>Using your appliance</b>	Page	7
Thermostat control	Page	7
Refrigerator compartment	Page	7
Freezer compartment	Page	7
Fast freeze function	Page	7
Frozen food storage	Page	7
Thawing	Page	7
Defrosting	Page	7
<b>Health and Safety Guidelines</b>	Page	8
<b>Maintenance and Cleaning</b>	Page	9
When the appliance is not in use	Page	9
Replacing the light bulb	Page	9
<b>Something Not Working</b>	Page	10
<b>Guarantee Conditions</b>	Page	11

# SAFETY INFORMATION

It is most important that this instruction book should be retained with the appliance for future reference. Should the appliance be sold or transferred to another owner, or should you move house and leave the appliance, always ensure that the book is left with the appliance in order that the new owner can get to know the functioning of the appliance and the relevant safety information.

This information has been provided in the interest of safety. You **MUST** read them carefully before installing or using the appliance.

## Installation

- This text affects appliances with gas R600a only. The refrigeration circuit contains isobutane (R600a), which is a natural gas noted for its excellent ecological properties. In the event of a mechanical rupture causing a leak, this gas could ignite if naked flames or sparks are present. For this reason do not use electrical appliances inside the refrigerator, and do not place heating equipment or other sources of heat using naked flames inside or close to the refrigerator. The refrigerant is heavier than air and for this reason would be concentrated at the bottom of the appliance. In the event of a gas leak air the room thoroughly.
- This appliance is heavy. Care should be taken when moving it.
- It is dangerous to alter the specifications or attempt to modify this product in any way.
- Care must be taken to ensure that the appliance does not stand on the electrical supply cable.
- Any electrical work required to install this appliance should be carried out by a qualified electrician or competent person.
- This appliance should be left for 4 hours after installation before it is turned on in order to allow the refrigerant to settle.
- There are working parts in this product which heat up. Always ensure that there is adequate ventilation as a failure to do this will result in possible food loss. See installation instructions.
- Parts which heat up should not be exposed. Wherever possible, the back of the appliance should be close to a wall but leaving the required distance for ventilation as stated in the installation instructions.

## Child Safety

- This appliance is designed to be operated by adults. Children should not be allowed to tamper with the controls or play with the product.

## During Use

- Zanussi domestic refrigerators, freezers and fridge/freezers are designed to be used specifically for the storage of edible foodstuffs only.
- Before defrosting, cleaning or maintenance work is carried out, be sure to switch off the appliance and unplug it.
- Frozen food should NOT be refrozen once it has thawed out.
- Do not place carbonated or fizzy drinks in the

freezer as it creates pressure on the container, which may cause it to explode, resulting in damage to the appliance.

- Ice lollies can cause «frost/freezer burns» if consumed straight from the freezer.
- Do not remove items from the freezer compartment if your hands are damp/wet, as this could cause skin abrasions or «frost/freezer burns».
- The cooling plate or refrigerated freezer shelves in this appliance contain channels through which refrigerant passes. If these are punctured this would cause substantial damage to the appliance and result in food loss. **DO NOT USE SHARP INSTRUMENTS** to scrape off frost or ice. Under **NO** circumstances should solid ice be forced off the lining or shelves. Solid ice should be allowed to thaw, when defrosting the appliance. See Defrost instructions.
- Manufacturers' recommended storage times should be adhered to. Refer to relevant instructions.
- This product should be serviced by an authorised engineer, and only genuine Zanussi spare parts should be used.
- Under no circumstances should you attempt to repair the machine yourself. Repairs carried out by inexperienced persons may cause injury or serious malfunctioning. Contact your local Zanussi Service Force Centre.

## For Maximum Efficiency

- Make sure that the appliance is cleaned properly.
- Make sure that the door is closed properly.
- Do not position the appliance near to sources of heat.
- Do not over-fill your appliance, air **MUST** be allowed to circulate.
- Do not open the door for longer than is absolutely necessary, as warm air will enter the appliance.

## In the interests of the Environment

When disposing of your old fridge, freezer or fridge/freezer:

- Help to keep your country tidy - use authorised disposal sites for your old appliance
- If you are discarding an old appliance that has a lock or catch on the door, you must ensure that it is made unusable to prevent young children being trapped inside.

Check with your local Council or Environment Health Office to see if there are facilities in your area for recycling this appliance.

# TECHNICAL SPECIFICATIONS

## DIMENSIONS

Height:	1.650 mm.
Width:	695 mm.
Depth:	660 mm.

## CAPACITY:

Gross:	Fridge:	313 litres
	Freezer:	80 litres
Net:	Fridge:	297 litres
	Freezer:	74 litres

**FREEZING CAPACITY:** 4 kg./24 hrs.

**HOLD OVER TIME:** 25 hrs.

**POWER ABSORBED:** 140 W

**VOLTAGE:** 220...230 V

**FREQUENCY:** 50 Hz

**AVERAGE DAILY**

**UNITS OF ENERGY:** 1.66 kwh\*

\* This figure is based on standard test results in accordance with the European Standard EN153. Actual consumption will depend on how the appliance is used and where it is located.

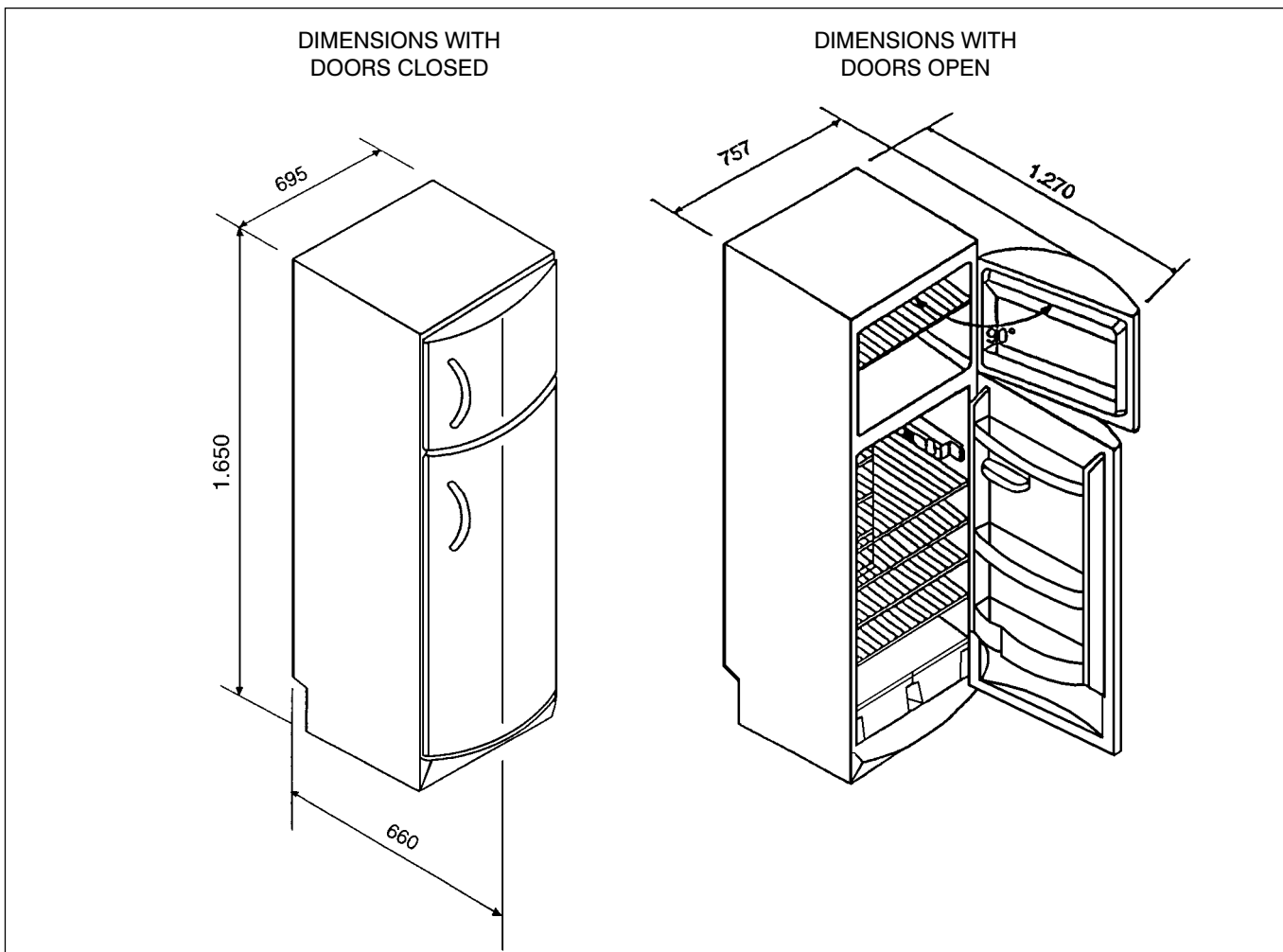

This appliance complies with E.E.C. directive No 87/308 of 2.6.87 relative to radio interference suppression.



This appliance complies with the following E.E.C. Directives:

- 73/23 EEC of 19.2.73 (Low Voltage Directive) and subsequent modifications;
- 89/336 EEC of 3.5.89 (Electromagnetic Compatibility Directive) and subsequent modifications.

GENERAL FEATURES

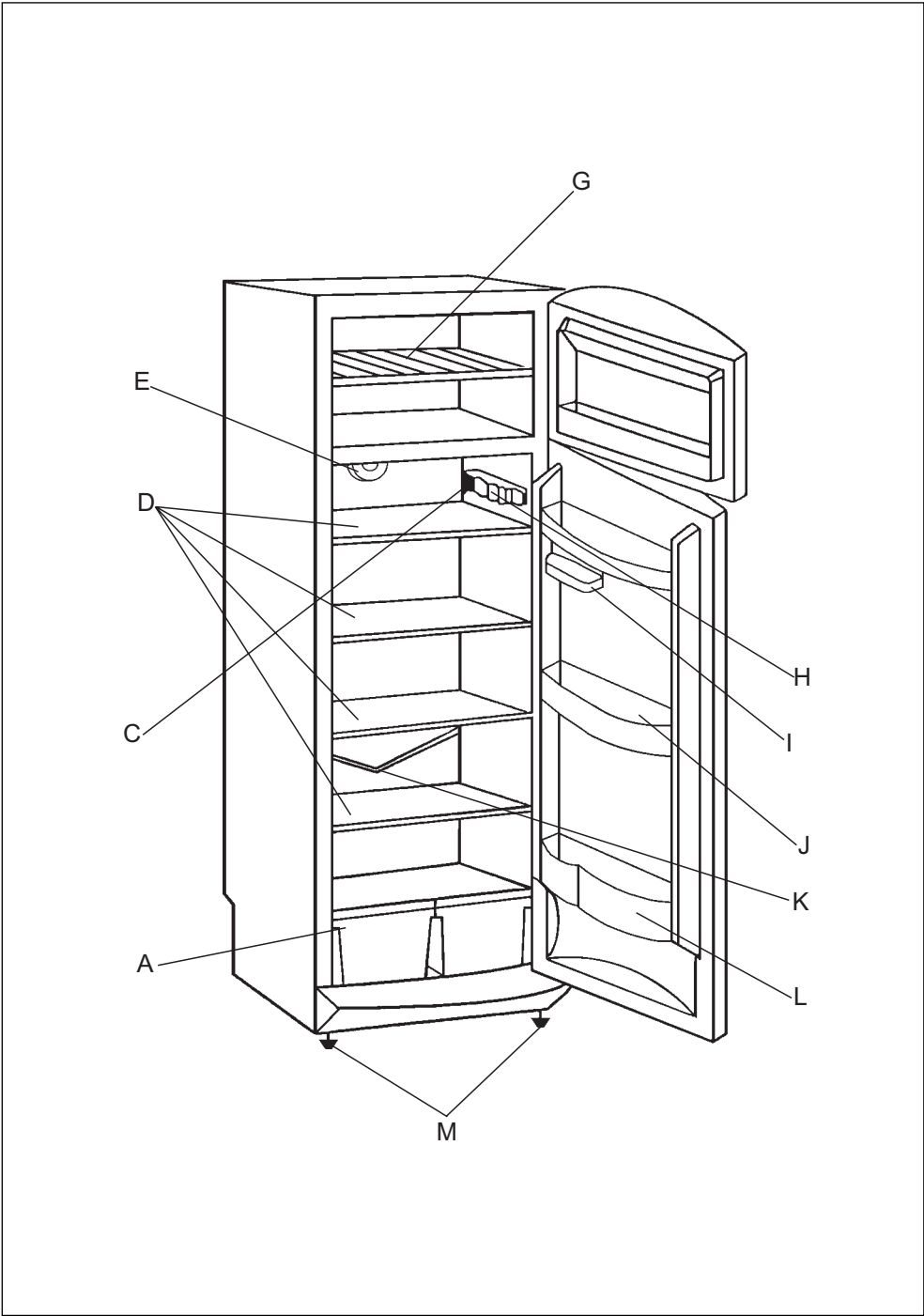

Fig. 1

- |   |                            |   |                                |
|---|----------------------------|---|--------------------------------|
| A | SALAD CRISPERS             | I | SLIDING EGG RACK               |
| C | BULB                       | J | STORAGE SHELF                  |
| D | GLASS STORAGE SHELF        | K | WATER TROUGH DRAIN HOLE        |
| E | DYNAMIC AIR COOLING SYSTEM | L | STORAGE SHELF WITH BOTTLE GRIP |
| G | FREEZING SHELF             | M | ADJUSTABLE FEET                |
| H | THERMOSTAT CONTROL         |   |                                |

# INSTALLATION

## Before using

Remove all securing tapes. Wash inside the appliance with lukewarm water and bicarbonate of soda (5 ml. to 0.5 litre of water). Do not use soap or detergent as the smell may linger.

Dry thoroughly.

## Positioning

When the appliance is sited in its chosen position, ensure that it is both level and stable and there is adequate ventilation to the back, and top of the appliance.

For this appliance to work efficiently, it should be located away from heat sources, e.g. cookers, radiators, boilers, direct sunlight, etc. This also includes locations or rooms where the ambient temperature reaches above 32°C or drops below 10°C.

You should also ensure that air can circulate freely around the back and at the top of the cabinet. There must also be at least 50 mm. (2") distance between the top of the cabinet and any overhanging kitchen furniture. See Fig. 2.

The climate classification can be found on the serial plate, which is located at the left on the inside of the appliance.

The following table shows which ambient temperature is correct for each climate classification:

Climate classification	for an ambient temperature of
SN	+ 10 to + 32°C
N	+ 16 to + 32°C
ST	+ 18 to + 38°C
T	+ 18 to + 43°C

## Levelling

Your appliance will be heavy when loaded with food and must therefore be stood on a strong firm floor. It should be level. Adjust the level of the appliance by screwing out the adjustable feet, at the bottom of the cabinet using your fingers.

Make sure the appliance is upright and both adjusters are in firm contact with the floor so that the cabinet is level and does not rock in any direction. See fig. 3.

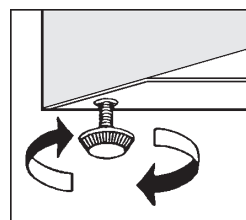

Fig. 3

The appliance should be left for 4 hours after installation before it is turned on, in order to allow the refrigerant to settle. After switching on the appliance leave for approx 4 hours for the correct temperature to be reached, before placing food inside.

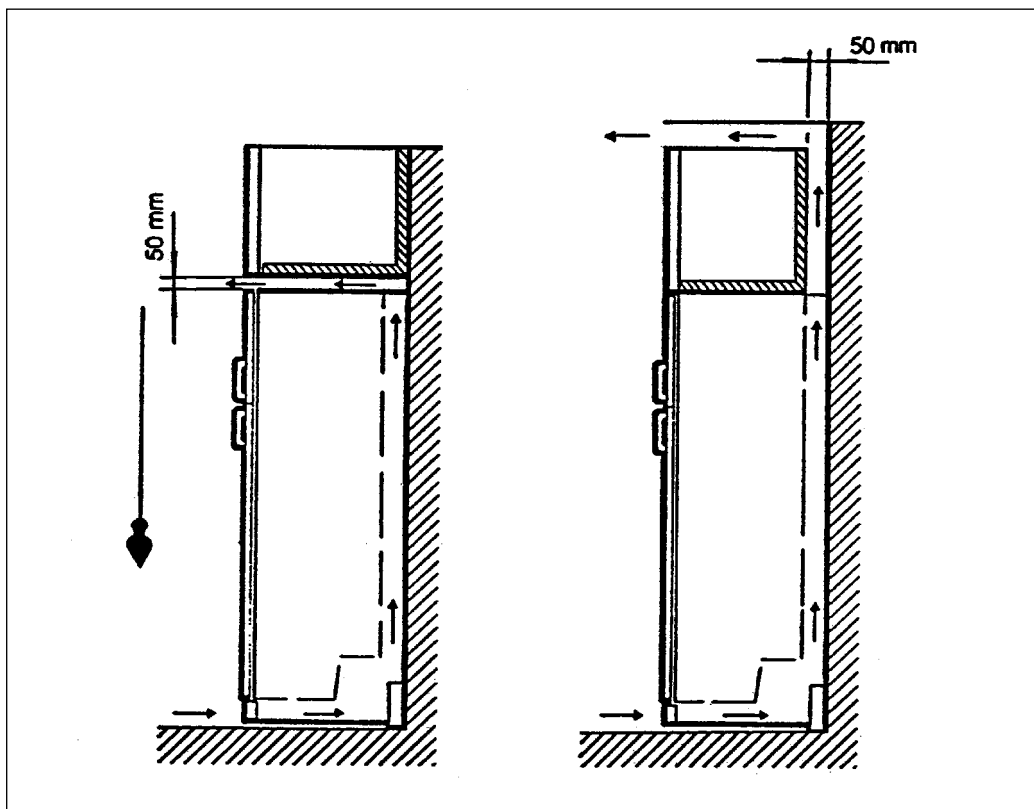

Fig. 2

## ELECTRICAL CONNECTIONS

**WARNING: This appliance must be earthed. The manufacturer declines any liability should this safety measure not be observed.**

Before you use your appliance, check that the voltage shown on the data plate inside the cabinet conforms with your mains supply.

The mains lead of the appliance is fitted with a non-rewireable moulded-on 13A plug containing a 13 amp fuse. In the event of the fuse requiring replacement, the fuse cover/carrier should be removed, using a small screw driver to lever it out.

The old fuse should be replaced by a 13 amp ASTA approved BS1362 fuse and the fuse cover/carrier must be refitted before the plug is used again.

If the plug fitted is not suitable for your socket outlet, it must be cut off and the appropriate plug fitted.

Remove the fuse from the cut off plug. The cut off plug should then be disposed of to prevent the hazard of shocks in case it should be plugged into a 13 Amp socket in another part of your home.

### IMPORTANT

The wires in the mains lead are coloured in accordance with the following code:

Green and Yellow	-	Earth
Blue	-	Neutral
Brown	-	Live

The wire coloured green and yellow (earth) must be connected to the terminal in the plug which is marked with the letter «E» or the earth symbol  $\perp$  or coloured green and yellow.

The wire coloured blue (neutral) must be connected to the terminal in the plug which is marked with the letter «N» or coloured black.

The wire coloured brown (live) must be connected to the terminal in the plug which is marked with the letter «L» or coloured red.

Upon completion, there must be no cut, loose or stray strands of wire present and the cord clamp must be secure over the outer sheath.

If the supply cable of this appliance is damaged, it must be replaced by special cord (spare part ref. 567364415) that can be obtained from your local Zanussi Service Centre.

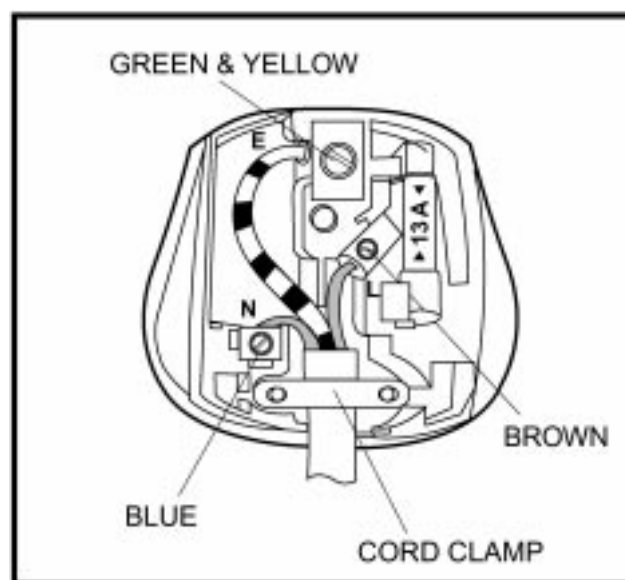

Fig. 4

## USING YOUR APPLIANCE

### Thermostat control

The thermostat control dial is located inside the appliance and regulates the temperature within the appliance. The thermostat control dial is marked from 1-6, the higher the number, the colder the setting.

Position 1 - minimum

Position 6 - maximum

Position 0 - Off

The temperature within your fridge will be effected by such factors as location, room temperature, frequency of door opening and frequency of defrosting.

In determining the correct temperature control setting, all these factors have to be considered and some experimentation may be necessary to achieve the most economic operation.

As a guide, in a normal kitchen temperature, a control setting of number 3 or 4 will apply.

### Refrigerator Compartment

The Dynamic Air Cooling system, which is fitted on the back wall of the refrigerator compartment, provides faster cooling and a more uniform temperature, thereby increasing the storage life of food. The DAC is particularly useful in warm weather conditions and when a large amount of food has been introduced into the compartment. To operate, push the button on the fan switch and the green pilot light will come on.

When DAC is switched on, the cold production is higher, thus you should turn the temperature regulator to an adequate position to avoid excessive cold.

### Freezer Compartment

This freezer is suitable for freezing food and permits the long term storage of frozen food. The appliance must be switched on for approximately 4 hours for the correct temperature to be reached, before placing food inside. The maximum quantity of food you can freeze in 24 hours is 4 kg.

### Fast Freeze Function

This is achieved by switching the DAC on and turning the thermostat to maximum. The time taken will depend on the type and quantity of the food being frozen. When the freezing operation is complete return the thermostat dial back to normal and switch the DAC off if not required.

### Frozen Food Storage

Frozen food should be placed in the frozen food compartment as soon as possible after purchase, and stored in accordance with instructions provided on the package by the frozen food manufacturer. The shelf situated in the freezer door is not designed to freeze fresh food but store pre frozen food. Storage times should not be exceeded; the volume is 7 litres.

Ensure that the external packaging is intact.

Packaging which is swollen or has traces of re-frozen water droplets on the pack could indicate that the product has not been kept at a suitable temperature and may have lost its original quality. Partially thawed food must not be re-frozen.

Do not open the compartment door too often and do not leave open longer than necessary.

In some models, on the freezer inner door there is usually an schematic drawing showing the

conservation time (in months) for the different types of food. It will also depend on the food quality in the moment of freezing and on the specific instructions on packages.

### Thawing

Food can be thawed in a number of ways, depending on the type of food and the size of the packs.

Meat, fish and fruit should be thawed in the refrigeration compartment.

Vegetables should be directly immersed in boiling water, ready-cooked dishes can be placed directly in the oven in their aluminium wrapping.

A microwave oven is particularly suitable for thawing any type of frozen or deep-frozen food; follow the oven instructions, with particular regard to the placement of aluminium wrapping in the oven.

### Important

Do not consume ice-lollies which have just come out of the frozen food compartment. Their extremely low temperature can cause frost burns.

Do not remove items from the compartment if your hand are damp/wet, as this could cause skin abrasions or «frost/freezer burns».

Do not keep carbonated or fizzy drinks in the freezer.

### Caution

In the event of a power cut the food in the frozen food compartment will not be affected if the power cut is short and if the compartment is full. Do not open the door. Should the food begin to thaw, it must be consumed quickly and must not be re-frozen.

### In the Event of a Power Failure

If there is a power failure during the storage of frozen foods, keep the door closed. If the temperature within your freezer should rise, do not refreeze the food without checking its condition. The following guidelines should assist you:

**Ice-cream:** Once thawed should be discarded.

**Fruits & Vegetables:** If soft should be cooked and used up.

**Breads & Cakes:** Can be refrozen without danger.

**Shellfish:** Should be refrigerated and used up quickly.

**Cooked Dishes:** i. e. casseroles should be refrigerated and used up.

**Large Pieces of Meat:** Can be refrozen providing there are still ice crystals remaining within them.

**Small Joints:** Should be cooked and can then be refrozen as cooked dishes.

**Chicken:** Should also be cooked and refrozen as a fresh dish.



# HEALTH AND SAFETY GUIDELINES

**Because of consumer demand, preservatives have been removed from many pre-prepared foods. This, together with the changes in shopping habits to a once-a-week shop, mean tht safe handling and storage of food is more important than ever.**

**The following tips should help you to ensure that the food in your home is an as perfect condition as possible.**

- Keep the time between buying chilled food and placing it in your fridge as short as possible. Tests showed that the temperature of 1 litre of orange juice rose to 22°C in an hour between the supermarket and home. It then took 11 hours to get down to 7°C in the refrigerator.
- Keep the refrigerator door closed as much as possible. Remember that warm air is flowing in as your are deciding what to have for tea.
- Do not push food together too much, try to allow air to circulate round each item.
- Cool cooked food as quickly as possible but do NOT place in the fridge until cool.
- Do not store food uncovered.
- The safest way to defrost food is to put it in the refrigerator to thaw slowly.
- It is important that food is used before its «best before» date.
- Ensure that food placed in the freezer is dated and labelled and used in date order to ensure that food is consumed at its best.
- Always wash your hands in soapy water and dry them with a clean towel before handling food.
- Keep work surfaces clean and avoid cross-contamination by not using the same work surface of knife, without washing them thoroughy.
- Use kitchen roll wherever possible for cleaning up food. If you use a dishcloth, be sure to boil it frequently.

## SOME SIMPLE DO'S AND DON'TS

- DO connect the appliance to an electricity point which is not liable to be switched off accidentally.
- DO follow the instructions given on the operation of the temperature control to ensure efficient operation.
- DO wrap and cover foods for perfect storage.
- DO ensure that when the fridge is to be put out of service for some time, that the interior is carefully cleaned, dried, the door left ajar and the plug is removed from the electrical supply socket.
- DO NOT open the door more often or for longer than is necessary, as this allows a temperature rise and also causes a rapid build-up of frost.
- DO NOT prevent the free passage of air to the back of the appliance.
- DO NOT turn the current off at the mains if your intend to leave the fridge in use whilst on holiday.
- DO NOT overload the interior. To do so will restrict the circulation of cooled air currents, which are necessary to help maintain the correct storage temperature conditions. This does not apply to the frozen food packages stored in the frozen food compartment, these can be packed closely together.

## MAINTENANCE AND CLEANING

Before any maintenance or cleaning is carried out, DISCONNECT the appliance from the ELECTRICITY supply.

### Interior Cleaning

Do not use alcohol or any cleaning product containing alcohol to prevent damaging the cabinet.

All parts of the interior should be wiped with a soft cloth warm water and bicarbonate of soda (5 ml to 0.5 litre of water). Rinse and dry thoroughly.

Ensure that no moisture runs down behind the thermostat control.

**Never use DETERGENTS, ABRASIVE POWDERS, HIGHLY PERFUMED CLEANING PRODUCTS OR WAX POLISHES, TO CLEAN THE INTERIOR AS THESE WILL DAMAGE THE SURFACE AND LEAVE A STRONG SMELL.**

Clean the drain hole of the water trough at regular intervals, and make sure that the drain hole is never obstructed, so that the defrost water can flow freely.

### Exterior Cleaning

Do not use alcohol or any cleaning product containing alcohol to prevent damaging the cabinet.

Wash the outer cabinet with warm soapy water. Do NOT use abrasive products.

Once or twice a year dust the condenser (Black grill) and the compressor at the back of the appliance, with a brush or vacuum cleaner, as an accumulation of dust will affect the performance of the appliance and cause excessive electricity consumption.

**You MUST ensure the appliance is switched OFF.**

### When the appliance is not in use

When the appliance is not in use for long periods, disconnect from the electricity supply, empty all foods and clean the appliance, leaving the door ajar to prevent unpleasant smells.

### Defrosting

It is important to remove frost from the frozen food compartment regularly, whenever the thickness of the frost exceeds 1/4" thick. To carry out complete defrosting proceed as follows:

- Remove any food from inside the frozen food compartment, wrap it in several sheets of newspaper and store in a cool dry place.
- To accelerate defrosting, place a bowl of hot water (not boiling) inside the compartment (with a place of cardboard underneath the bowl as protection).
- When defrosting is complete, clean and dry the appliance.

### Replacing the light bulb

Should the interior light fail to work, first switch off the appliance and pull out the mains plug.

Pull out the screw «Y» and the remove the protective cover «X».

Unscrew the bulb «H» and replace (See Fig. 7).

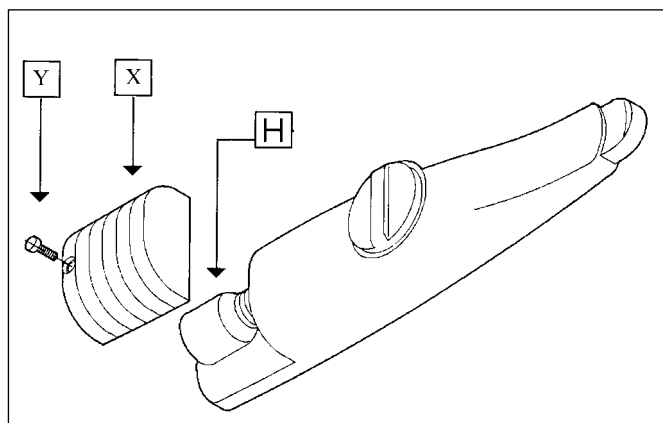

Fig. 7

## SOMETHING NOT WORKING

If your appliance is not operating correctly, carry out the following checks before contacting your local Service Force Centre.

**Important:** If you call out an engineer to a fault listed below, or to repair a fault caused by incorrect use or installation a charge will be made, even if the appliance is under guarantee.

Symptom	Cause	Solution
Interior Light (refrigerator) does not work	• Appliance is not plugged in	• Plug in the appliance
	• The appliance is not switched on	• Switch on the appliance
	• There is no power to the appliance	• Check the main fuse box in the house
	• The bulb is not fitted correctly or has fused.	• Refit the bulb or replace with a new bulb
The appliance does not cool down sufficiently	• The doors have not been closed properly	• Close the doors
	• A door has been opened frequently	• Avoid frequent opening of the doors
	• The temperature control knob is not set correctly	• Reset as required
	• Food has been introduced into the appliance	• The appliance will cool down in due course.
Food is freezing in the fridge	• The temperature control knob is incorrectly set	• Reset as required
The motor works continuously.	• Temperature control knob is incorrectly set	• Change the setting
	• The doors are not properly closed	• Close the doors
	• Doors have been opened frequently	• Avoid frequent opening of the doors
	• Food has recently been introduced into the appliance	• The appliance will cool down in due course.
	• The condenser is dirty	• Clean (read the Maintenance & Cleaning section).
Water/condensation in the vegetable drawer	• Wet vegetables have been put into the box	• This may occur from time to time
Condensation on the outside of the cabinet	• High humidity level in the room.	• It does not affect the performance of the appliance. Increase the room ventilation.
Doors do not close	• The appliance is not level	• Level the appliance correctly
	• The doors are incorrectly aligned	• Re-align the doors
	• Food is preventing the doors shutting	• Re-position food
Noises	• The appliance may not be level	• Level the appliance
	• Something may be vibrating inside	• Check the contents and shelves are properly positioned.

## SOMETHING NOT WORKING

### Normal Operating Sounds

- 1. Temperature control**  
May cause clicking sounds when the system is connected or disconnected.
- 2. Cooling system**  
The injected cooling gas may produce a gurgling sound while passing through the tubes.
- 3. Motor**  
May cause a humming noise and or slight knocking sound.
- 4. Fans**  
You may occasionally hear the fans working. This is normal; the fans help to ensure the air circulates more effectively.

### Service and Spare Parts

In the event of your appliance requiring service, or if you wish to purchase spare parts, please contact your local Zanussi Service Force Centre by telephoning:

**0870 5 929929**

Your telephone call will be automatically routed to the Service Force Centre covering your post code area. The addresses are listed on the following pages.

Before calling out an engineer, please ensure you have read the details under the heading «Something Not Working».

When you contact the Service Centre you will need to give the following details.

1. Your name, address and postcode
2. Your telephone number
3. Clear and concise details of the fault
4. The model and serial number of the appliance (found on the rating plate)
5. The purchase date

### Customer Care Department

For general enquiries concerning your Zanussi appliance or for further information on Zanussi products, please contact our Customer Care Department by letter or telephone at the address below or visit our website at [www.zanussi.co.uk](http://www.zanussi.co.uk)

Customer Care Department  
Zanussi  
55-77 High Street  
Slough  
Berkshire  
SL1 1DZ  
08705 727727 \*

\* Calls to this number may be recorded for training purposes.

# **GUARANTEE CONDITIONS**

## **Standard guarantee conditions**

We, Zanussi, undertake that if within 12 months of the date of purchase this Zanussi appliance or any part thereof is proved to be defective by reason only of faulty workmanship or materials, we will, at our option repair or replace the same FREE OF CHARGE for labour, materials or carriage on condition that:

- The appliance has been correctly installed and used only on the electricity supply stated on the rating plate.
- The appliance has been used for normal domestic purposes only, and in accordance with the manufacturer's instructions.
- The appliance has not been serviced, maintained repaired, taken apart or tampered with by any person not authorized by us.
- All service work under this guarantee must be undertaken by a Zanussi Service Force Centre.
- Any appliance or defective part replaced shall become the Company's property.
- This guarantee is in addition to your statutory and other legal rights.
- Home visits are made between 8.30am and 5.30pm Monday to Friday. Visits may be available outside these hours in which case a premium will be charged.

## **Exclusions**

### **This guarantee does not cover:**

- Damage or calls resulting from transportation, improper use or neglect, the replacement of any light bulbs or removable parts of glass or plastic.
- Costs incurred for calls to put right an appliance, which is improperly installed, or calls to appliances outside the United Kingdom.
- Appliances found to be in use within a commercial environment, plus those, which are subject to rental agreements.
- Products of Zanussi manufacture which are not marketed by Zanussi.

## **European Guarantee**

If you should move to another country within Europe then your guarantee moves with you to your new home subject to the following qualifications:

- The guarantee starts from the date you first purchased your product.
- The guarantee is for the same period and to the same extent for labour and parts as exists in the new country of use for this brand or range of products.
- This guarantee relates to you and cannot be transferred to another user.
- Your new home is within European Community (EC) or European Free Trade Area. The product is installed and used in accordance with our instructions and is only used domestically, i.e. a normal household.
- The product is installed taking into account regulations in your new country.
- Before you move please contact your nearest Customer Care Centre, listed below, to give them details of your new home. They will then ensure that the local Service Organisation is aware of your move and able to look after you and your appliance.

France Senlis +33 (0) 44 62 29 29

Germany Nuremberg +49 (0) 0800 358 9737

Italy Pordenone +39 (0) 0434 39 4700

Sweden Stockholm +46 (0) 8 672 53 90

UK Slough +44 (0) 1753 219897

To contact your local Zanussi Service Centre telephone **08705 929 929**

<b>CHANNEL ISLANDS</b>		ORKNEY	7 King Street Kirkwall Orkney KW15 1JF	<b>NORTH EAST</b>	
GUERNSEY	Guernsey Electricity PO Box 4 Vale, Guernsey Channel Islands GY1 3AD			GATESHEAD	Unit 356a Dukesway Court Dukesway Gateshead NE11 0BH
JERSEY	Jersey Electricity Company Haut De L'orme Rue De Haut De L'orme Trinity Jersey Channel Islands JE3 3FG	PERTH	Scottish Hydro Electric Central Warehouse Inveralmond Perth PH1 3AF	GRIMSBY	15 Hainton Avenue Grimsby N.E. Lincs DN32 9AS
<b>SCOTLAND</b>		(OWN SALES)		HULL	Unit 1 Boulevard Industrial Estate Hull HU3 4AY
ABERDEEN	54 Claremont Street Aberdeen AB10 6RA	EDINBURGH	Unit 12 Dumbryden Ind. Estate 2 Dumbryden Road Edinburgh EH14 2AB	LEEDS	64-66 Cross Gates Road Cross Gates Leeds LS15 7YS
AUCHTERMUCHY	33a Burnside Auchtermuchy Fife KY14 7AJ	SHETLAND Lerwick	3-4 Carlton Place  Shetland ZE1 0PW	NEWTON AYCLIFFE	Unit 23 Northfield Way Aycliffe Industrial Park Newton Aycliffe DL5 6EJ
BLANTYRE	Unit 5 Block 2 Auchenraith Ind. Estate Rosendale Way Blantyre G72 0NJ	(OWN SALES)		SHEFFIELD	Pennine House Roman Ridge Road Sheffield S9 1GB
DUMFRIES	93 Irish Street Dumfries DG1 2 PQ	SHETLAND	Bolts Shetland 26 North Road Lerwick Shetland ZE1 0PE	<b>NORTH WEST</b>	
DUNOON	7 Hill Street Dunoon Argyll PA23 7AL	WHALSAY	Leask Electrical Harisdale Symbister, Whalsay Shetland ZE2 9AA	BIRKENHEAD	1 Kelvin Park Dock Road Birkenhead CH41 1LT
GLASGOW	Unit 4 Wellington Road Bishopriggs Glasgow G64 2SA	<b>NORTHERN IRELAND</b>		CARLISLE	Unit 7 James Street Workshops James Street Carlisle Cumbria CA2 5AH
INVERNESS	Unit 3BI Smithton Ind. Estate Smithton Inverness IV2 7WL	BELFAST	Owenmore House Kilwee Business Park Dunmurry Belfast BT17 0HD	ISLE OF MAN	South Quay Ind. Estate Douglas Isle of Man IM1 5AT
ISLE OF ARRAN	R Haggerty Bruach Blackwaterfoot Isle of Arran	<b>WALES</b>		BOLTON	Unit B Central Industrial Estate St Marks Street Bolton BL3 6NR
ISLE OF BARRA	J Zerfah 244 Bruernish Isle of Barra Western Islands HS9 5QY	CARDIFF	Unit 4 Guardian Industrial Estate Clydesmuir Road Cardiff CF2 2QS	PRESTON	Unit 250 Dawson Place Bamber Bridge Preston Lancashire PR5 8AL
ISLES OF BUTE	Walker Engineering Glenmhor Upper Serpentine Road Rothesay Isle of Bute PA20 9EH	CLYWD	Unit 6-7 Coed Parc Abergele Road Rhuddlan Clwyd LL18 5UG	STOCKPORT	Unit 20 Haigh Park Haigh Avenue Stockport SK4 1QR
ISLE OF LEWIS	ND Macleod 16 James Street Stornoway Isle of Lewis PA87 2QW	DYFED	Unit 9 St. Clears Business Park Tenby Road St. Clears Carmarthen SA33 4J		
KELSO	2, 6 & 8 Woodmarket Kelso Borders TD5 7AX	OSWESTRY	Plas Ffynnon Warehouse Middleton Road Oswestry SY11 2PP		

To contact your local Zanussi Service Centre telephone 08705 929 929

MIDLANDS		LONDON & EAST ANGLIA		SOUTH EAST	
BIRMINGHAM	66 Birch Road East Wyrley Trading Estate Wilton Birmingham B6 7DB	BECKENHAM	11a Gardener Ind. Estate Kent House Lane Beckenham Kent BR3 1QZ	ASHFORD	Unit 2 Bridge Road Business Est. Bridge Road Ashford Kent TN23 1BB
BOURNE	Pinfold Road Bourne PE10 9HT	CHELMSFORD	Hanbury Road Widford Ind Estate Chelmsford Essex CM12 3AE	FLEET	Unit 1 Redsfield Ind. Estate Church Crookham Fleet Hampshire GU13 0RD
BRIDGNORTH	68 St. Mary's Street Bridgnorth Shropshire WV16 4DR	COLINDALE	Unit 14 Capitol Park Capitol Way Colindale London NW9 0EQ	HAYWARDS HEATH	21-25 Bridge Road Haywards Heath Sussex RH16 1UA
GLOUCESTER	101 Rycroft Street Gloucester GL1 4NB	ELTHAM	194 Court Road Mottingham Eltham London SE9 4EW	TONBRIDGE	Unit 30 Deacon Trading Estate Morley Road Tonbridge TN9 1RA
HEREFORD	Unit 3 & 4 Bank Buildings Cattle market Hereford HE4 9HX	ENFIELD	284 Alma Road Enfield London EN3 7BB	SOUTH WEST	
HIGHAM FERRERS	30 High Street Higham Ferrers Northants NN10 8PL	GRAVESEND	Unit B4 Imperial Business Estate West Mill Gravesend Kent DA11 0DL	BARNSTAPLE	Main Road Fremington Barnstaple North Devon EX31 2NT
ILKESTON	Unit 2 Furnace Road Ilkeston DE7 5EP	LETCHWORTH	16-17 Woodside Ind. Estate Works Road Letchworth Herts SG6 1LA	BOURNEMOUTH	63-65 Curzon Road Bournemouth Dorset BH1 4PW
LEICESTER	Unit 7 Oaks Industrial Estate Coventry Road Narborough Leicestershire LE0 5GF	LONDON	2 - 4 Royal Lane Yiewsley West Drayton Middlesex UB7 8DL	BRIDGEWATER	6 Herswell Business Park Salmon Parade Bridgewater Somerset TA6 5PY
LINCOLN	Unit 8 Clifton Street Stonefield Park Lincoln LN5 8LQ	MAIDENHEAD	Reform Road Maidenhead Berkshire SL6 8BY	BRISTOL	11 Eldon Way Eldonwall Trading Estate Bristol Avon BS4 3QQ
NEWCASTLE UNDER LYME	18-21 Croft Road Brampton Ind. Estate Newcastle under Lyme Staffordshire ST5 0TW	MOLESEY	10 Island Farm Avenue West Molesey Surrey KT8 2UZ	EMSWORTH	266 Main Road Southbourne Emsworth PO10 8JL
REDDITCH	13 Thornhill Road North Moons Moat Redditch Worcestershire B98 9ND	NEWBURY	9 Pipers Court Berkshire Drive Thatcham Berkshire RG19 4ER	ISLE OF WIGHT	Unit 8 Enterprise Court Ryde Business Park Ryde Isle of Wight PO33 1DB
TAMWORTH	Unit 3 Sterling Park Claymore Tamworth B77 5DQ	IPSWICH	Unit 6C Elton Park Business Centre Hadleigh Road Ipswich IP2 0DD	NEWTON ABBOT	Unit 2 Zealley Ind. Estate Kingsteignton Newton Abbot TQ12 3TD
WORCESTER	Units 1 & 2 Northbrook Close Gregorys Mill Ind. Estate Worcester WR3 8BP	NORWICH	2b Trafalgar Street Norwich NR1 3HN	REDRUTH	Unit 7D Pool Ind. Estate Wilson Way Redruth Cornwall TR15 3QW
		SUNBURY	Unit 1a The Summit Hanworth Road Sunbury on Thames TW16 5DB		

*The Electrolux Group is the world's largest producer of powered appliances for kitchen, cleaning and outdoor use. More than 55 million Electrolux Group products (such as refrigerators, cookers, vacuum cleaners, chain saws and lawn mowers) are sold each year to a value of approx. 14 billion USD in more than 150 countries around the world.*

 **From the Electrolux Group. The world's No.1 choice.**