

RANGE COMPOSITION

A range of refrigerators designed to satisfy the food-conservation requirements of professional caterers who want the high performance and reliability of a commercial unit suited for use with trolleys. The range of ROLL-IN cabinets consists of 5 refrigerator models: 3 ROLL-IN with a stainless steel door and 2 ROLL-THROUGH with stainless steel doors on both sides.



726496

ROLL IN - PASS THROUGH

REFRIGERATORS **ZANUSSI**
PROFESSIONAL

FUNCTIONAL AND CONSTRUCTION FEATURES

- ◆ Internal and external structure in AISI 304 stainless steel
- ◆ Control panel featuring an ON/OFF button and a digital control.
- ◆ Completely automatic defrosting and defrost water evaporation
- ◆ All refrigerator models use CFC free R134a for the refrigerant
- ◆ High-density expanded polyurethane insulating foam, 75 mm in thickness, guarantees exceptional, long-term insulation and notable energy savings
- ◆ The rational use of the internal space of the refrigerator guarantees a large storage area suitable to contain standard dimension trolleys.
- ◆ The appliance is designed in compliance to NSF regulation.

CHARACTERISTICS	MODELS				
	RI16R1F 726496	RI16R2FT 726497	RI16R2FGT 726498	RI16R1G 726869	RIP270 732054
Operating temperature - min/max °C	2/10	2/10	2/10	2/10	2/10
Operating mode	Ventilated	Ventilated	Ventilated	Ventilated	Ventilated
Type of stainless steel					
external	304 AISI	304 AISI	304 AISI	304 AISI	304 AISI
internal	304 AISI	304 AISI	304 AISI	304 AISI	304 AISI
Gross capacity (D.I.N. 8952) - l.	1630	1630	1630	1630	2700
External dimensions - mm					
width	1021	1021	1021	1021	1800
depth/with open doors	1163, 2112	1237, 3136	1237, 3136	1163, 2112	1056, 1892
height	2272	2272	2271	2271	2265
Internal dimensions - mm					
width	870	870	870	870	1650
depth	1039	1105	1105	1039	900
height	1860	1860	1860	1860	1815
Min/Max internal humidity - %		75/90	75/90	75/90	75/90
N° and type of door	1	2	2	1	2
Door hinges	Right Side	1 Left+1 Right	Right Side	Right Side	1 Left+1 Right
Compressor power - HP	3/8	3/8	3/8	3/8	3/4
N° defrost in 24 hrs.		3/30'	3/30'	3/30'	2/16'
Refrigerant type	R134a	R134a	R134a	R134a	R134a
Refrigerant quantity - g.	340	340	340	340	660
Refrigeration power - W	546	546	546	546	998
Refrigerant power					
at evaporation temperature - °C	-10	-10	-10	-10	
Power - kW					
installed-electric	0.6	0.6	0.58	0.58	1.25
Noise level - dBA		56.5	56.5	56.5	Less 58
Net weight - kg.	200	200	220	220	350
Power supply - V, phases, Hz	230 V, 1N, 50	230 V, 1, 50	230 V, 1, 50	230 V, 1, 50	230 V, 1N, 50
Maximum trolley size					
width - mm	820	820	820	820	
depth - mm	1015	1088	1088	1015	
height - mm	1840	1840	1840	1840	

◆ A reversible self-closing door equipped with an easily replaceable magnetic door seal to guarantee perfect closure. The recessed door handle makes opening the cabinet extremely easy. The door open to a maximum of 180° and remains open at 95°

◆ High standards of hygiene and ease of cleaning are guaranteed by the rounded internal corners of the cabinet.

- ◆ CFC and HCFC free
- ◆ All models comply with the standards required by the main international approval bodies and are H marked.

ACCESSORIES	MODELS				
	RI16R1F 726496	RI16R2FT 726497	RI16R2FGT 726498	RI16R1G 726869	RIP270 732054
17 GN 2/1 CONTAINER TROLLEY					361258
17 GN 2/1 CONTAINER TROLLEY SPACE SAVING					361260
60 MM PITCH ROLL-IN RACK FOR 20X2/1	922204	922204	922204	922204	922204
80MM PITCH ROLL-IN RACK 14X2/1GN	922206	922206	922206	922206	922206
BANQ.TROLLEY-92PLATES 85MM PITCH-20GN2/1	922055	922055	922055	922055	
BASE FOR 20X2/1 ROLL-IN RACK	922142	922142	922142	922142	922142
BASE FOR ROLL-IN-RACK	880018	880018	880018	880018	880018
KIT HACCP EKIS		922166	922166	922166	
KIT WITH 2 HINGES FOR DOOR REVERSIBILITY					881432
PRINTER FOR HACCP BASIC VERSION REFRIG.					881457
ROLL-IN RACK FOR 2/1 GASTRONORM GRIDS	881449	881449	881449	881449	881449
TROLLEY FOR 2/1-GN ROLL-IN RACK	880017	880017	880017	880017	880017
TROLLEY FOR 20X2/1 ROLL-IN RACK	922134	922134	922134	922134	922134



www.zanussiprofessional.com

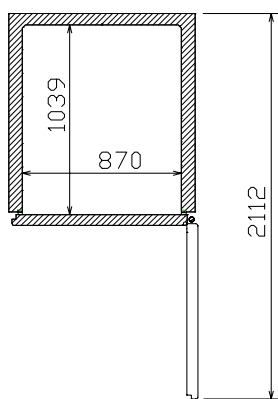
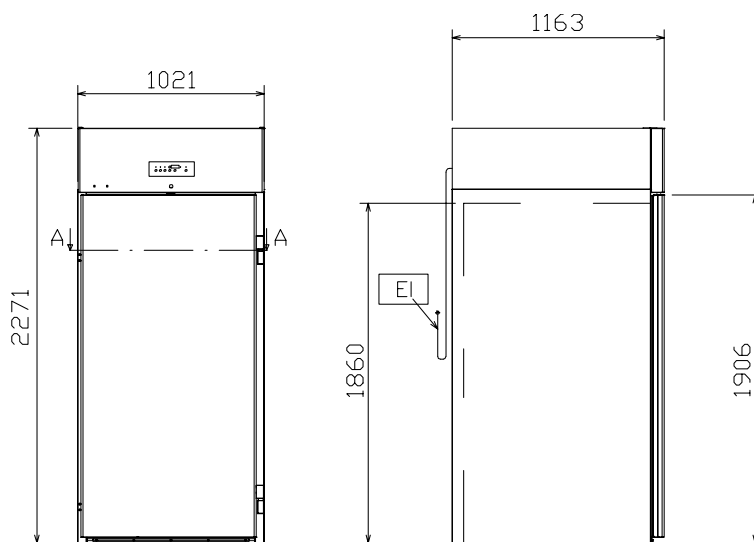

726496

	RI16R1F 726496
EI - Electrical connection	230 V, 1N, 50



www.zanussiprofessional.com

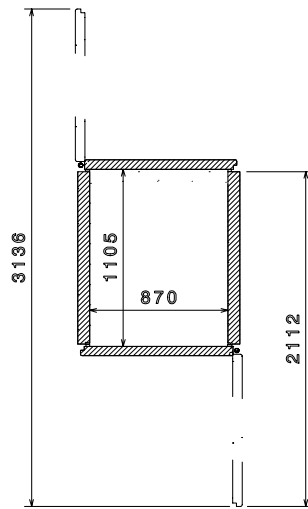
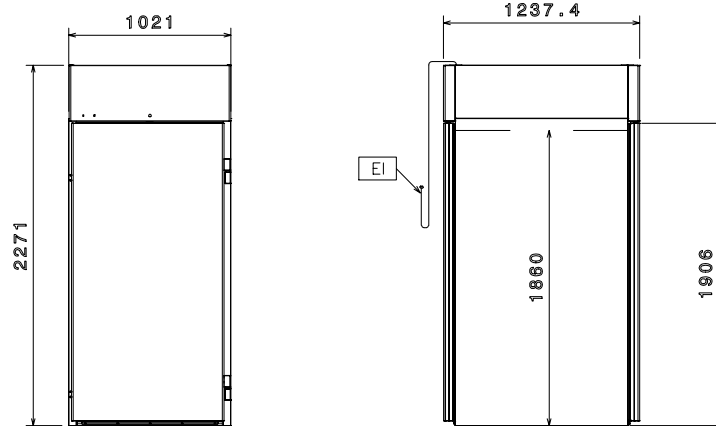

ROLL TROUGH 20 GN2/1 COLD

	RI16R2FT 726497
EI - Electrical connection	230 V, 1, 50



www.zanussiprofessional.com

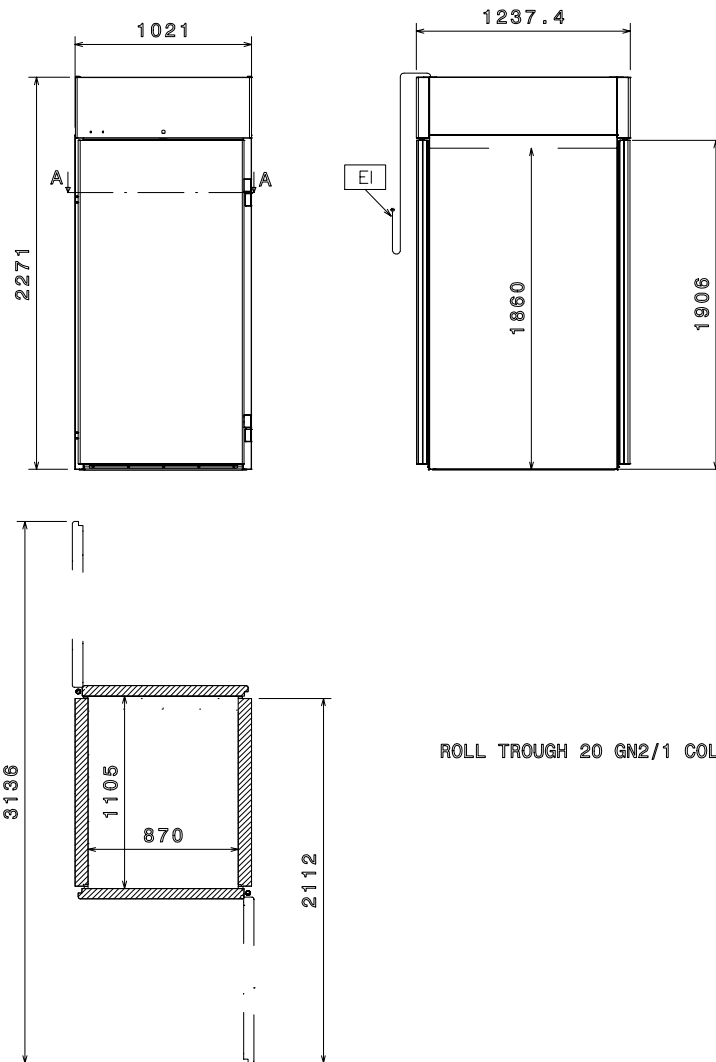

ROLL TROUGH 20 GN2/1 COLD

	RI16R2FGT 726498
EI - Electrical connection	230 V, 1, 50



www.zanussiprofessional.com

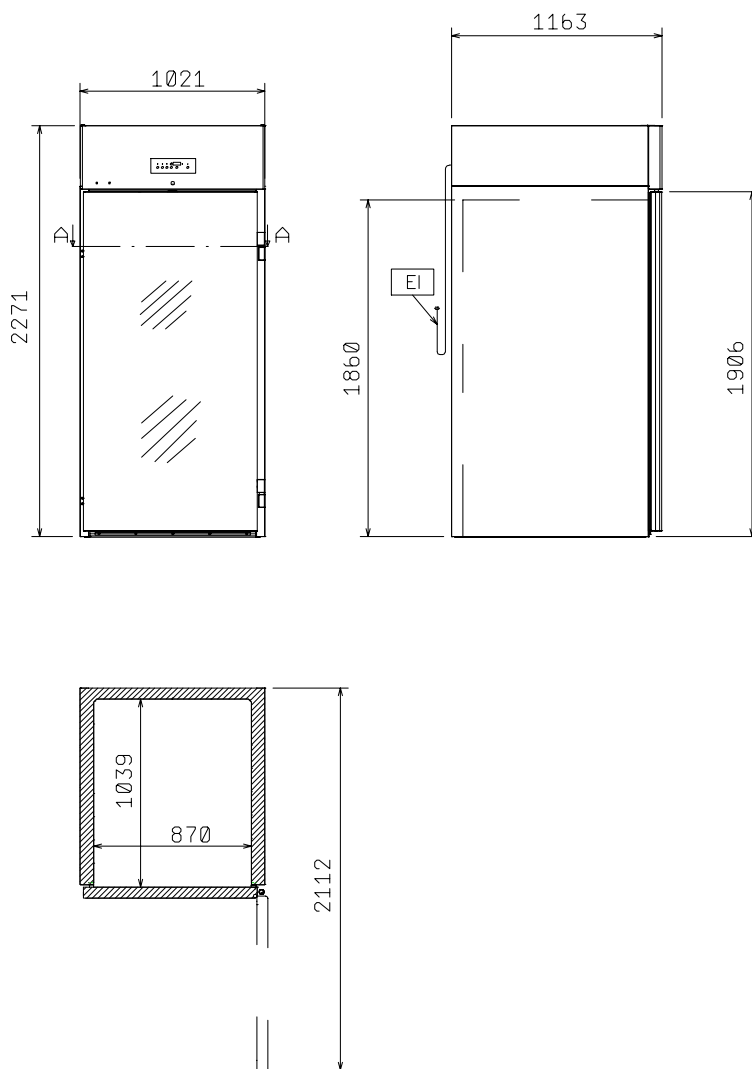

	RI16R1G 726869
EI - Electrical connection	230 V, 1, 50



www.zanussiprofessional.com

REFRIGERATORS
ROLL IN - PASS THROUGH

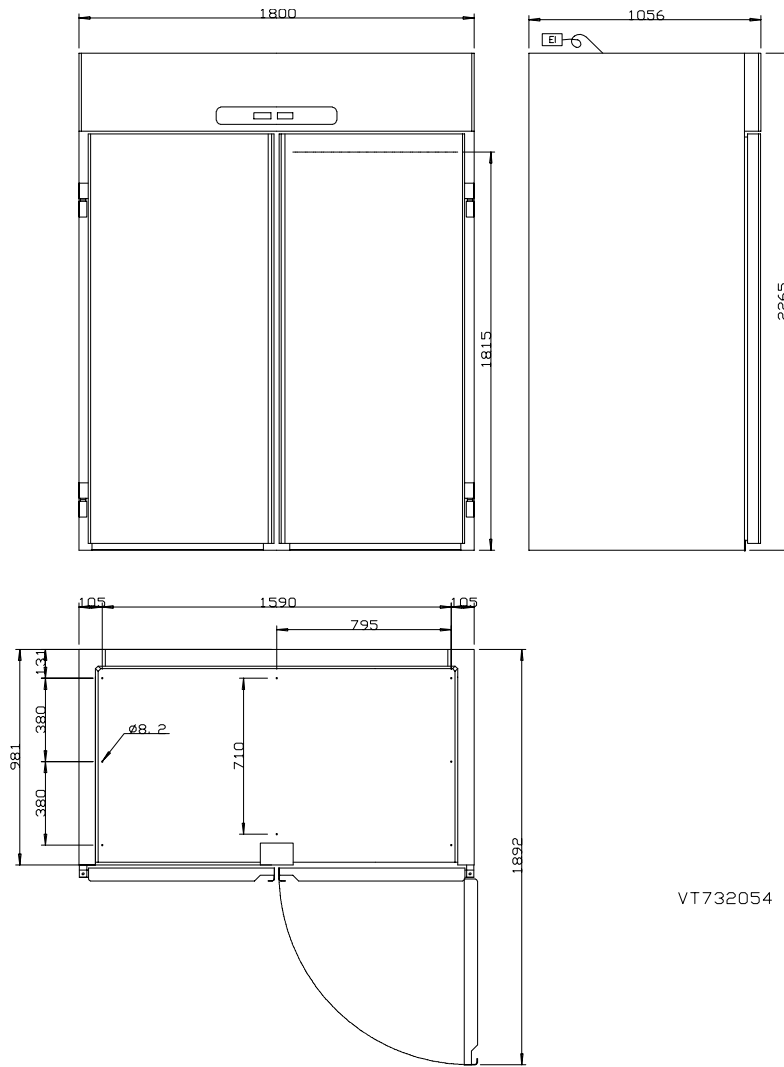

VT732054

	RIP270 732054
El - Electrical connection	230 V, 1N, 50



www.zanussiprofessional.com