

***18v Li-ion
Cordless Blower***

User Manual

BLI

CEL™

THANK YOU

Thank you for investing in a CEL product. The 18v Li-Ion Blower has been engineered and made to demanding high quality standards; ease of operation and safety have taken a major role in development. Proper care of your product will give you years of trouble-free use.

Normal wear and tear, including accessory wear, is not covered under guarantee. The product is guaranteed for **domestic use** against manufacturing faults for a period of 12 months (for additional guarantee period (if any) please refer to the store or agent from which you purchased the product or contact the nearest authorized dealer). This product is not guaranteed for HIRE purposes.

If you have any questions, please contact us at:

sales@cel-global.com

It is possible to download updated user manuals, view demonstration videos and find information about new products at: **www.cel-global.com**

Warning: User must read and understand the user manual before using the product to reduce the risk of injury. Failure to follow all instructions may result in electric shock, fire and/or serious personal injury. The product must be used only for its prescribed purpose. Any use other than those mentioned in this manual will be considered a case of misuse. The manufacturer shall NOT be liable for any damage or injury resulting from such cases of misuse, use of force, partially or completely dismantled appliances.



Contents

- 1.0 Important Safety Notes
- 2.0 Unpacking and Description of Features
- 3.0 Assembly and Charging the Battery
- 4.0 Battery Information and Safety Notes

GETTING STARTED

- 5.0 Blowing Tips

BLOWING

- 6.0 Maintenance, Storage, Environment
- 7.0 FAQ
- 8.0 Technical Specifications

CARE

Description of symbols

The rating plate on your tool may show symbols .

These represent important information about the product or instructions on its use .



General
Hazard



Read
Instructions



Keep Dry



Protect
Eyes, Ears,
Lungs



Keep
Bystanders
Away



Flying
Debris



Wear
Appropriate
Clothing

Eye protection must be worn.

Breathing protection must be worn.

Use at a distance of at least 10m from other people .

Conforms to relevant standards for electromagnetic compatibility .

Safety instructions

To use this tool properly , you must observe the safety limitations , the assembly instructions and the operating instructions to be found in this Manual . All persons who use and service this machine must be acquainted with this Manual and must be informed about it 's potential hazards . Children and infirm people must not use this tool . Children should be supervised at all times if they are in the area in which the tool is being used . It is also imperative that you observe the accident prevention regulations in force in your area . The same applies for general rules of occupational health and safety .

The manufacturer shall not be liable for any changes made to the tool nor for any damage resulting from such changes .

Even when the tool is used as prescribed it is not possible to eliminate all residual risk factors . The following hazards may arise in connection with the tool 's construction and design :

Damage from flying debris .

Damage to eyes if effective safety glasses or shield are not worn .

Damage to ears if effective ear defenders are not worn .

Injury or illness caused by inhalation of dust and debris if breathing protection is not sufficient.

Always remove the battery from the tool before making any adjustments or performing maintenance .

Store tools safely . When not in use , tools should be stored in a dry place inaccessible to children .

Do not force the tool . The tool will do the job better and safer working at the rate for which it was designed .

Use the correct tool for the job . Do not force small tools or attachments to do the job best handled by a heavier duty tool .

Never use a tool for a purpose other than that for which it was intended .

Dress appropriately. Do not wear loose clothing or jewellery . They can be caught in moving parts .

Rubber gloves and non slip footwear are recommended while working outdoors . If you have long hair , wear a protective hair covering .

Use safety accessories . Safety glasses and ear protection should always be worn .

Do not overreach . Keep your footing secure and balanced at all times .

Look after your tools . Keep tools clean and sharp for better and safer performance . Follow the instructions regarding lubrication and accessory changes . Keep tool handles dry , clean and free from oil and grease .

Disable idle tools . Remove the battery from the tool before servicing and when the tool is not in use .

Avoid unintentional starting . Make sure that the switches are in the OFF position before attaching the battery .

Stay alert Watch what you are doing , use common sense . Do not operate a power tool when you are tired or distracted .

Before using a tool , check that there are no damaged parts . If a part is slightly damaged , carefully determine it will operate properly and perform its intended function . Check for alignment of moving parts , binding of moving parts , breakage of parts , proper mounting and any other conditions that may affect the operation of the tool . A guard or other part that is damaged should be properly repaired or replaced by an authorized service facility , unless otherwise indicated in this Instruction Manual .

Defective switches must be replaced by an authorised service facility . Do not use a tool if the switch does not turn the tool on and off correctly .

Guard against electric shock . Prevent contact with grounded objects such as water pipes .

Use only approved parts . When servicing , use only identical replacement parts . Use an authorised service facility to fit replacement parts .

Do not let tool run unattended . Always wait until your power tool has come to a complete stop and remove the battery before leaving it .

Damaged batteries must be disposed of immediately. Liquids contained within can be extremely harmful.

WARNING . The use of an accessory or attachment , other than those recommended in this Instruction Manual , may present a risk of personal injury .

The tool must be used only for its prescribed purpose . Any use other than those mentioned in this Manual will be considered a case of misuse . The user and not the manufacturer shall be liable for any damage or injury resulting from such cases of misuse .

Additional safety rules for blowers

Never point the blower in the general direction of any person, animal or delicate object as debris may be flung by the air stream.

Do not use the blower in the rain or in a damp area.

Keep hands and fingers well away from the outlets, air stream and moving parts.

Wear work gloves , eye, ear and breathing protection , solid shoes and suitable clothing while using this blower .

Always grasp both handles when operating the unit, only operate the machine in its intended orientation .

Remove the battery when you have finished blowing , before cleaning or if you have been interrupted .

This blower has been designed to clear light debris and leaves from hard surfaces not for clearing grassed areas.

Do not attempt to free debris or adjust the blower and it's accessories before first switching off the machine and removing the battery .

Check the area to be cleared for stones and anything that may be flung by the tool. Remove wire and string as it may damage the blower.

Do not block the air outlets, this may damage the tool and cause injury.

Never use the machine without the safety devices properly fitted and undamaged

WARNING, the guards are for the safety of the operator and bystanders, never remove them while operating the machine.

Never touch or go near the blowing area while the motor is still turning, the tool may take a few seconds to slow down after the trigger is released.

Only use battery as supplied or identical replacements designed specifically for this tool.

Only blow if lighting levels are adequate.

Do not activate the tool if there is debris in the vents or otherwise obstructing operation.

Release trigger when moving between work areas, gravel paths can create flying debris danger.

If the machine appears to have any fault or makes any unusual sounds please consult the manual a service centre or your retailer.

If you are interrupted while operating the trimmer , complete the process and switch off before looking up .

Never allow untrained users or children to use the blower.

**Wear goggles ,Wear ear protections, Wear breathing protection,
Wear work boots, Wear protective clothing .**

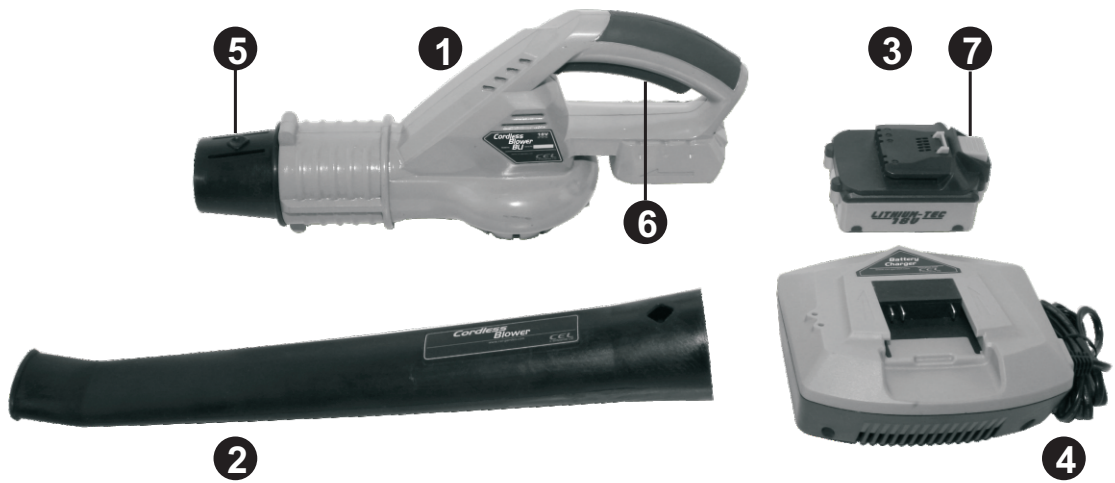

- 1 BL1 Blower
- 2 Tube
- 3 WL18-BP01 18V Li-ion Battery
- 4 WL18-CG01 Charger
- 5 Tube Release Button
- 6 Operation Trigger
- 7 Battery Release Button
- 8 This User Manual

NOTE, due to modern mass production techniques and product testing , it is unlikely that your power tool is faulty or that a part is missing . If you find anything wrong , do not operate the tool until the parts have been replaced or the fault has been rectified . Failure to do so could result in serious personal Injury .

Before using the blower familiarise yourself with all the operating features and safety requirements .
Only use the blower as intended.

BEFORE STARTING THE BLOWER YOU MUST FIT THE TUBE.

To fit the tube, align with the head of the blower taking note of the notch to aid alignment. The release button should click as the tube is engaged. Check the tube is secure before operating the blower.

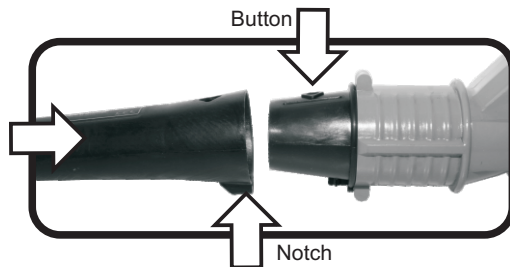

A new battery or one that is completely run down should be charged for 4 hours . After normal use a battery should be fully charged in about 1 hour .

1. Place the charger in a safe position away from moisture , heat or any hazard to the charger or other danger .
2. Connect to suitable power outlet and switch on .



3. Turn the battery so the rails slide smoothly into place on the charger and press together firmly .

The red light blinking and green light lit indicates an error . Check the temperature in the area is within specified limits or wait for the battery to cool down .

Charging lights indicator

| LIGHT | RED | GREEN |
|----------|-------|-------|
| POWER ON | ON | OFF |
| CHARGING | ON | BLINK |
| CHARGED | ON | ON |
| ERROR | BLINK | OFF |

It is normal for the battery charger to hum and be warm but not hot during operation.

If the battery does not charge properly , check to make sure the electrical outlet is "live" and that the air surrounding the battery and charger is between 10°C and 24°C (50°F) and (75°F).

Make sure the battery is correctly fitted.

Always remove the battery pack and unplug the charger and store it in a dry, secure place when not in use .

To reduce the risk of fire do not leave the charger on for longer than 24 hours.



The battery pack for this tool has been shipped in a low charge condition . Before use you should charge the battery pack fully.



WARNING, Lithium Ion batteries contain a circuit board to protect charge condition, this can be damaged by shock, Please take care.

WARNING, batteries can contain harmful liquids, NEVER use or handle a damaged battery.

WARNING, Do not throw used batteries into fire or water, It could cause an explosion!

WARNING, Do not use an extension cord when charging.

WARNING. Charge indoors only.

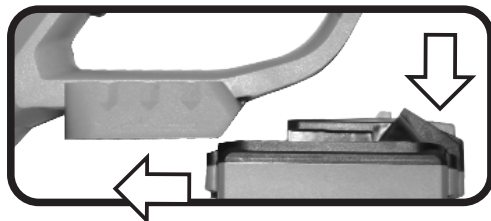

Always charge the battery before storage.
To reduce risk of fire, never leave the battery on the charger for more than 24 hours.

To Fit

1. Ensure that you are not pressing any of the activation triggers.
2. Align the rails on battery and trimmer and slide into place until a firm click is felt.

To Remove

1. Allow the trimmer to stop
2. Hold the handle firmly
3. Grip the battery and press the release catch
4. Pull the battery toward the rear of the trimmer



Always disconnect the battery and ensure the motor has stopped before cleaning or making any adjustments.

Before starting work examine the blower and accessories for defects and damage.

Check all fittings and fixings are present and correctly fitted.

Ensure repairs are carried out before using the trimmer or any of the accessories.

Repairs should only be carried out by qualified and authorised persons, if in doubt ask your retailer.

Run the blower briefly and check for unusual sound or vibration, and for any other signs of damage or deterioration.

Do not use batteries other than those specified on the product, the battery supplied with this product is specifically made for this tool and the supplied charger. Other batteries and chargers may cause explosions, leaks or fire.

If you feel any physical discomfort or pain stop work immediately.

Please dispose of batteries at your local battery disposal depot .



Make sure bystanders are safe, do not blow if you cannot see the area being effected.

Check the area to be blown for stones and anything that may be flung by the tool.



Some plants and trees contain harmful substances, always be aware of risks and take appropriate measures before beginning work.

Always start the blower away from debris or materials that may cause harm



Some small sparks and a slight burning smell may emanate from the motor, this is normal and is due to the electronic brake.

If the battery or motor become too hot to touch stop work immediately.



Switching on and off

1. Fit a charged battery as shown in previous section
2. Hold the tool in both hands keeping moving parts away from yourself, bystanders and any other objects. Ensure it is safe to start it and warn bystanders.
3. Squeeze the trigger
4. Direct the airstream into the area to be cleared. Work gradually in an arc pattern.

Sweeping/Clearing

Start the blower before approaching the work area so as allow it to reach full speed and so debris is not accidentally thrown.

Be aware that the tool could react in your grip when the stream of air contacts objects..

Stand with a good posture and be aware of your surroundings, keep 2 hands on the blower and control with firm even pressure.

Clear larger areas by swinging the blower in an arc. The blower is designed for clearing dry leaves from hard surfaces, not clearing debris from grassed areas.

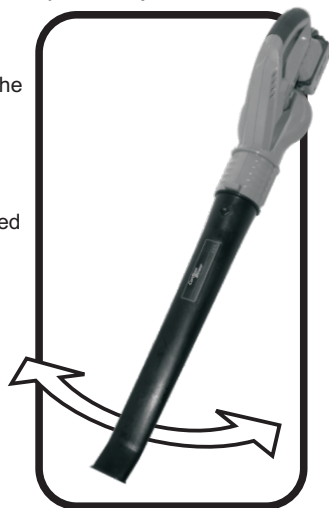

WARNING ,

Switch off and remove the battery before carrying out any maintenance on the tool .

Lubrication

No Lubrication is necessary, the bearing area is sealed.

After each: use, carefully clean the blower with a brush or rag.

Clear any debris from around the moving parts.

General inspection

Regularly check that all the fixing screws are present and tight. They may vibrate loose over time.

Keep the tool's air vents unclogged and clean at all times.

Remove dust and dirt regularly.

Cleaning is best done with compressed air or a rag.

Never use caustic agents to clean plastic parts.

CAUTION, Do not use cleaning agents to clean the plastic parts of the tool. A mild detergent on a damp cloth is recommended. Water must never come into contact with the tool.

When the time comes to dispose of this product please consider the environment and take it to a recognised recycling facility instead of disposing with general household waste.

The blower uses a Lithium Ion (Li-Ion) battery which must be disposed of properly.

Call your local council, civic amenity site, or recycling centre for information on the recycling and disposal of electrical products and Lithium Ion (Li-Ion) batteries.

Storage

Store the tool, instruction manual and accessories in a secure, dry place. In this way you will always have all the information and parts ready to hand.

Never store the Blower with a flat battery.

The battery should ideally be stored between 10°C and 24°C (50°F) and (75°F).

Where can I get additional batteries and accessories?

www.cel-garden.com or ask your retailer.

The Blower is not clearing the debris, why?

Most likely the debris is too heavy or compacted for the blower. Clear more often so leaves and debris cannot build up or loosen first with a rake. Ensure a charged battery.

The blower wont start, what's wrong?

a) Check the battery is charged and properly fitted, also make sure the triggers are working correctly and both are being squeezed at the same time. b) Remove the battery and check for debris, clean accordingly. c) The Lithium Ion battery has a protection circuit to prevent it from completely discharging. The battery will provide constant power then stop rather than slowing down. Recharge fully.

Why does my blower stop sometimes?

See c) above. Generating the air pressure needed to blow leaves and debris with any force is by its nature a very inefficient action. The battery charge will be quickly depleted. See www.cel-global.com for compatible products which will provide additional battery power.

Do I need to fully discharge the battery before recharging it?

No the Li-Ion system has no memory effect so you can charge it at any time. The charge will be retained in storage for much longer than older battery technology.

Where should I keep my Blower ?

In a dry place at a stable temperature between 10°C and 24°C (50°F and 75°F).

What should I do if my Blower gets wet?

Dry fully for at least 14 days in a warm but not hot place before trying to charge or use.

How can I get my Blower repaired if it is damaged?

Contact your retailer.

Where do I find my serial number?

On the left hand side of the blower head.

Where can I get replacement parts, advice or help?

Ask at your retailer or visit www.cel-garden.com

How long is the warranty and what is covered?

Please see inside cover

Technical Specifications

8.0

| | |
|--|-----------------------------------|
| Unit operating time with full battery | - Approx. 20 minutes with no load |
| Fan speed | - 12500rpm with no load |
| Airflow speed | - 200kph 120mph |
| Sound Pressure Level (dB(A)) | - 86dB |
| Battery operating voltage | - 18V DC (5 cells) |
| Battery makeup | - Lithium Ion (Li-ion) 1300mAh |
| Charging period for fully discharged battery | - Approx. 1 hour |
| Charger Input | - 100-120V 60Hz |
| Charger Output | - 18V DC 1.5A |
| Boxed Dimensions | - 485x290x215mm |
| | - approx (19x11x8") |
| Weight including battery | - 1.6Kg (3.5lbs) |
| Product Code | - BL1 |

If you experience any problems with the product please contact

email: sales@cel-global.com

phone: UK +44 (0) 8453 88 97 69

www.cel-global.com



**GENERAL HAZARD
SAFETY ALERT**



**BEWARE OF FLYING
OBJECTS AND DEBRIS**



READ INSTRUCTION MANUAL



KEEP BYSTANDERS AWAY

CEL
C Enterprise Ltd

C Enterprise Limited www.cel-global.com info@cel-global.com

UK • HK • USA • China • Europe • Australia • Japan