

Instruction Manual EC-383

Thank you for purchasing the EC-383 Massage Chair. Before using your massage chair, please read the contents of this instruction manual and refer to it when needed.

Table of Contents

Luxury Features	2
Safety Precautions	3-4
Chair Components	5-6
Moving the Chair	7
Grounding Instructions	8
Chair Specifications	9
Operation Guide	10-15
Troubleshooting	16
Warnings	17
Consumer warranty	18-20
Warranty Card (Attachment)	

01 Luxury Features

The operation of massage chair is controlled by a compact microcomputer that performs various intelligent massage methods and combinations, like Kneading, Tapping, Clapping, Shiatsu, Rolling, Vibration, Heat and Air massage. All these methods massage acupressure points accurately to effectively alleviate fatigue, promote metabolism and improve blood circulation.

- Spring-styled massage that is specially structured for the back is designed according to curve of the human body to provide a more effective massage.
- Designed with 1-touch Zero-GroV position button.
- The chair's backrest can be adjusted from 117° to 157°, while the footrest, from 0 to 90 to suit you. Also they can be adjusted manually.
- Five sets of full body automatic programs with automatic backrest scanning.
- Three patrol air massage modes in lumbar/seat, neck and leg rest with adjustable intensity.
- Vibration/heat function at seat/lumbar area.
- Various types of massage functions can be combined for customized massaging programs.
- The timer function can be adjusted according to your desired duration of the massage program.
- Liquid crystal display and glow-in-the-dark display for a user friendly operation even in the dark.
- Designed with power surge and pressure detector as well as automatic temperature sensor and auto shutdown mechanism for safety.

02 Safety Precautions

When using the massage chair, basic precautions should always be followed to reduce the risk of electric shock, burns, fire or injury to persons. Please read the following precautions before using the massage chair.

- Make sure the power plug is securely inserted into a proper electrical outlet to reduce the risk of short-circuit and fire.
- Always unplug the massage chair from the electrical outlet immediately after using and before cleaning.
- DO NOT** use the massage chair in areas where the humidity is high such as a sauna or steam room.
- DO NOT** use the massage chair outdoors and avoid areas with direct sunlight.
- If the electricity is off, turn the power switch to the OFF position and unplug the massage chair from the electrical outlet to prevent any damages to the chair when the electricity comes back on.
- Never plug/unplug the power cord plug socket with wet hands.
- DO NOT** use the chair when your body is wet.
- Close and continuous supervision is necessary when the massage chair is used by, on or near children or disabled persons.
- DO NOT** use heat function on an infant or invalid or unconscious person, check the skin in contact with heated area frequently to reduce the risk of blistering.
- Burns may result from improper use.
- No more than one person should use the massage chair at a time.
- The massage chair is intended for use as described in the Instruction Manual.
- Do not use any attachments other than those recommended by Cozzia.
- DO NOT** attempt to stand or sit on the backrest, armrest or footrest in order to prevent accident, injury or damage to the chair.
- If your legs or feet slip off the legrest during massage, do not force them back in as this may result in injury.
- Avoid falling asleep while using the massage chair.
- Always keep the massage chair clean, and never insert any objects into or around the gaps of the massage chair.

- Softening of foams and filling composites in pillows, pads, and memory foam occurs naturally and does not constitute a defect under this warranty.
- Fading, wear and piling of fabrics occurs naturally and does not constitute a defect under this warranty.
- Natural markings, grain and dye variations in leather do not constitute a defect under this warranty.
- Warranties do not cover any loss or damage resulting from improper installation, unauthorized repairs or modifications, improper use of electrical/power supply, loss of power, dropped product, a malfunction or damage of an operating part from failure to provide manufacturer's recommended maintenance, transportation damage, theft, abuse, misuse, neglect, vandalism or environmental conditions (fire, floods, rust, corrosion, sand, dirt, windstorm, hail, earthquake or exposure to weather conditions), loss of use during the period the product is at a repair facility, or otherwise awaiting parts or repair.
- Damage due to shipping and handling does not constitute a defect under this warranty.
- Under no circumstance shall COZZIA or its representatives be liable for indirect, consequential, or incidental damages (including damages for lost profits, business interruption, bodily injury, medical and the like), even if any party has been advised of the possibility of such damages.
- Warranties are non-transferable and shall be in lieu of any other warranty, express or implied, including but not limited to any implied warranty or merchantability or fitness for particular use.
- COZZIA's sole liability and the purchaser's exclusive remedy shall be for the repair, or at COZZIA's option, for the replacement of the defective part. Notwithstanding the above, if replacements parts for defective materials are not available, COZZIA reserves the right to make substitutions in lieu of repair or replacement.
- All warranties begin on the DATE OF PURCHASE; no allowance or extension is offered for delivery and/or installation.**
- Warranties do not apply to rental, business, commercial, institutional or other non-residential users.

PRODUCT REPAIRS

Many COZZIA product repairs may be performed by the consumer in their own home with parts and instructions supplied by COZZIA such as remote controller replacements that don't require a technician.

Canadian consumers may contact COZZIA's customer service department at 1-877-977-0656 between 9:00 am and 5:00 pm PST, Monday through Friday for warranty or service issues.

- Floor Models and Demonstration Units** have a prorated warranty period that begins the day the model is placed on the floor and connected to an electrical outlet by the retail partner. Proof of purchase is required for all warranty repairs. The warranty time period is measured by continuous calendar days based on a seven-day week.
- Field Service** – COZZIA customer service department will diagnose and schedule an authorized service provider to repair the chair in the consumer's residence.
- Parts** - All parts deemed necessary for repairs will be shipped to the consumer at no charge by the COZZIA service department.

- Warranties are only valid in the 48 contiguous United States and Canada and are contingent upon the consumer operating the chair according to the corresponding instruction manual.
- The warranty only applies to COZZIA products and does not include any accessories or enhancements.
- Field service requires pre-approval and must be performed by COZZIA's authorized field service personnel. Field service is only available in the United States and in major metropolitan areas in Canada.

- DO NOT** move the massage chair by pulling on the power supply cord.
- Make sure there are no children, pets or other obstacles behind or underneath the massage chair.
- If you find any rips or tears in the fabric of the massage chair contact the Cozzia service department and stop using the chair immediately.
- This massage chair is designed for household use and should not be used in non-residential settings.
- Please consult your doctor if you are in doubt as to whether or not you should use this massage chair.
- Please consult a doctor before using the massage chair if you are pregnant, undergoing any medical treatment, using a medical electronic device such as a pacemaker, or are experiencing any of the following: Malignant tumor, heart disease, back pain, abnormal or curved back bone, osteoporosis or acute illness.
- DO NOT** combine with other therapeutic equipment or electric blanket, etc., as this may result in injury.
- If you experience pain while using the massage chair, stop using the chair immediately and consult your doctor.
- Never use a massage function on swollen or inflamed parts of the body.
- DO NOT** use the massage chair for more than 30 minutes at a time.
- DO NOT** use the massage chair where aerosol (spray) products are being used or where oxygen is being administered.
- This massage chair is a non-professional product designed to provide a comfortable massage and should not be substituted for appropriate medical treatment.
- Keep the cord away from heated surface.
- DO NOT** use chair with a damaged cord as this may result in malfunction and electric shock.

- If the supply cord is damaged, it must be replaced by the manufacturer, its service agent or similarly qualified persons in order to avoid a hazard.

03 Chair components

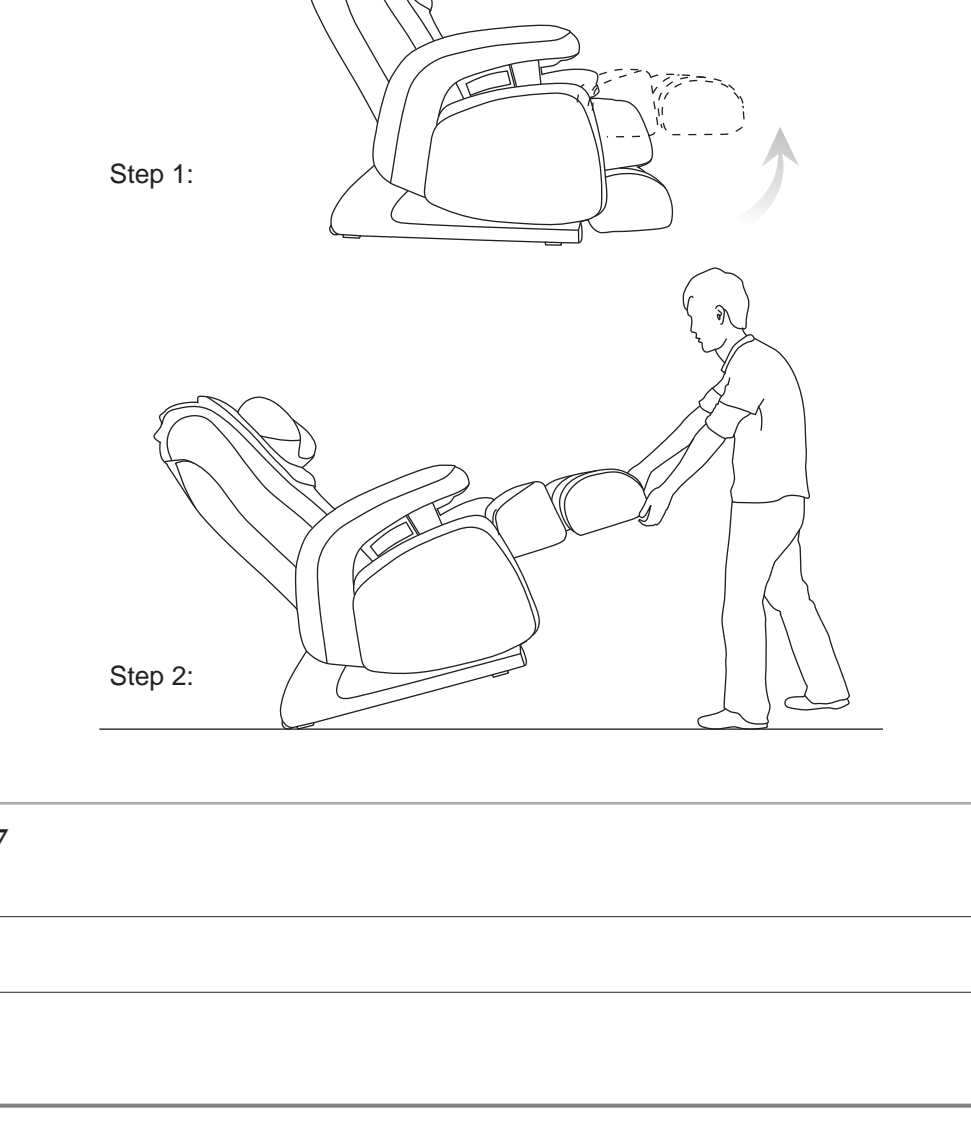

10 COZZIA Consumer Warranty

COZZIA products have the following warranty: COZZIA's massage chairs, motion upholstery and home theater massage seating provide a one year in-home service warranty and a two-year parts warranty. COZZIA customer service will not issue Return Material Authorizations (RMAs) for products. COZZIA products will be either repaired by the consumer or by an in-home technician. COZZIA will not issue Return Material Authorizations (RMAs) for buyer's remorse.

Consumers are required to provide the unit serial number and dated proof of purchase (sales receipt) when they contact the COZZIA service department regarding a repair.

A COZZIA customer service representative will provide most consumer inquiries, but in some cases a technical service specialist will attend advanced support.

Non-warranty repair is provided on a "per incident" basis. COZZIA customer service will verify that the unit has failed and provide instructions for repairing a unit. All applicable repairs, parts, shipping, handling, local tax and a "per incident" fee will be charged for non-warranty repairs and support calls.

Proof of purchase (original receipt) is required for all warranty repairs or service.

EXTENDED WARRANTIES: Cozzia offers extended warranty programs to enhance ownership of Cozzia product. Extended warranty periods: 3-year limited repair or replacement massage chair warranty on-site service. Please visit www.cozzia-usa.com for the latest terms and pricing for extended warranties.

09 Warnings

- Do not use water and other cleaning detergents on the massage chair.
- Do not stack, stab, sit or harshly pull on the surface of the massage chair.
- Gently press the buttons during operation and avoid hitting the buttons with hard objects.
- Pull out the power supply plug after each use.
- Do not use the massage chair for more than 30 minutes at a time.
- If you have to rise from the chair to stop accident, injury or damage to others by you or you want to get your feet and calves out, please press PAUSE button as demonstrated PIC 1, the footrest will gradually deflate in some seconds and then quickly get you foot and calves out.

Note: This way as above mentioned just using in emergencies. Please bear in mind that always return the footrest to its original position, then rise from the chair in order to prevent accident, injury or damage to yourself and chair.

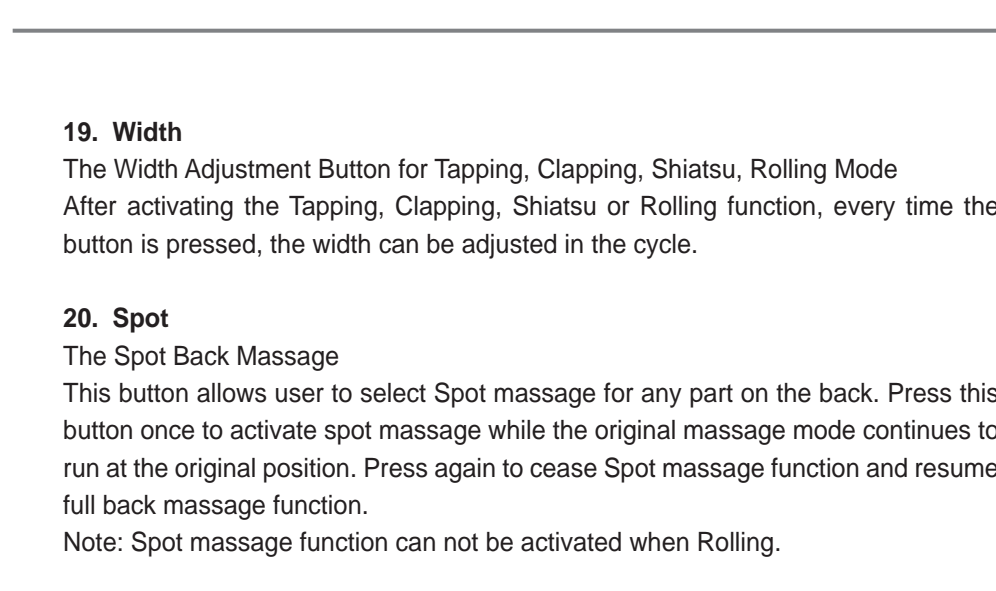
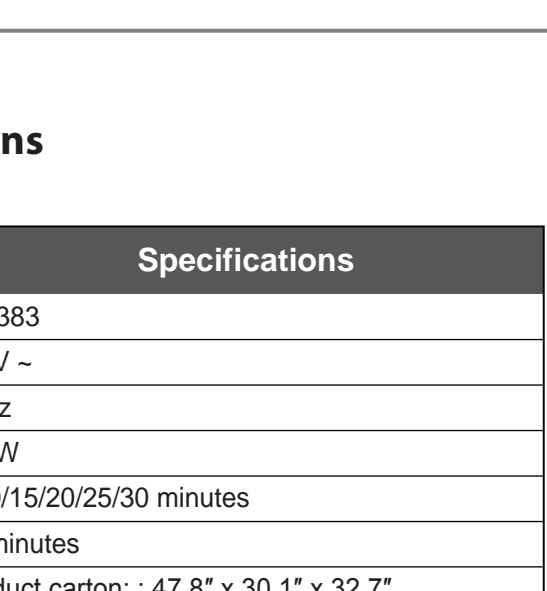

04 Moving the Chair

- Lift up the Calves Rest.
- Then recline the chair to approximately to 45 degrees, so that you can easily move the chair around the house with a slight pull push.

- Caution:**
- Avoid moving the massage chair when there is someone seated on it.
 - Please lay a mat underneath the massage chair, as the moving process might cause scratches on the floor surface.

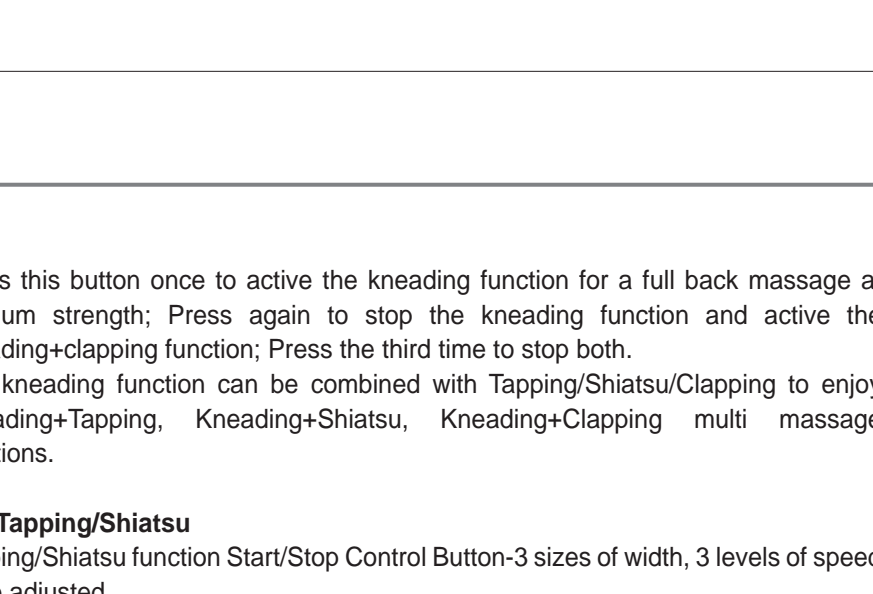

08 Troubleshooting & Product Maintenance

This massage chair is controlled by a microcomputer and is susceptible to power surges of +10 to -15%.

The following situations may display in the event of a power surge:

Situation	Solution
The massage chair is connected to the power supply but is not functioning.	1. Check to see that the plug is well connected and working. 2. Make sure that the massage chair switch is turned on the "1" position.
The remote control works, but the massage chair is not functioning.	The massage chair may have overheated due to prolonged use. Turn off the power and allow the chair to cool for 30-50 minutes.
Both the remote control and the massage chair are not functioning.	1. Make sure the chair is plugged into a working outlet. 2. Turn the power OFF and then ON again.

2) Localized Air Massage Programme

23. Lumbar&Seat-3 levels of intensity to be adjusted
Lumbar and Seat Air-Pressure Start / Stop Control Button
Press once to activate Lumbar and Seat Air-pressure massage mode. Press again to stop the function.

24. Neck-3 levels of intensity to be adjusted
Neck Air-pressure Control Button
Press once to activate neck Air-pressure Massage Mode to enjoy rhythmic Air-pressure massage at the neck. Press again to stop the function.

25. Leg Rest-3 levels of intensity to be adjusted
Leg Rest Air-Pressure Start/Stop Control Button
Press once to activate Leg Rest Air-pressure Massage Mode to enjoy rhythmic Air-pressure massage at the leg. Press again to stop the function.

26. Intensity
The Intensity Adjustment Button for Air-pressure, Auto or Manual-3 levels of intensity to be chosen.
After activating the Air-pressure function, press this button to adjust the intensity in the cycle.

27. Vibration
Seat Vibration Start/Stop Control Button

28. Heat
Lumbar Heating Start/Stop Control Button

Finish Operating
Please press the "ON/OFF" button after use, the chair will stop operation, Massage Rollers will resume to its original position; then switch the power supply button under the chair to "O" and unplugging the machine from the socket.

05 Grounding Instructions

Fully insert the plug into an appropriate outlet.

An improper equipment-grounding conductor may result in electric shock. Contact a qualified electrician if you are not sure that the product is properly grounded. Do not modify the plug that is included with the massage chair. If the plug does not fit the outlet, contact a qualified electrician to install an outlet to fit the massage chair plug.

06 Chair Specifications

Description	Specifications
Model No.	EC-383
Rated Voltage	110V ~
Rated Frequency	60Hz
Rated Power Consumption	220W
Timer	5/10/15/20/25/30 minutes
Max Time Rate	30 minutes
Dimensions(LxWxH)	Product carton: 147.8" x 30.1" x 32.7"
Weight	Product gross weight: 166 lbs
	Product net weight: 171 lbs
Length of Wire	Controller wire: 72"
	Power supply wire: 118.1"
Usage Condition	Environment temperature: 10°-40°
	Environment humidity level: 30-85RH
	Contrasting temperature level: 20°-60°
Storage Condition	Storage humidity level: 30-85RH
	Storage temperature level: 30-85RH
Safety feature	Equipped with overheat and power surge safety protection
Using benefits	Increasing blood circulation Relieving muscular fatigue

19. Width
The Width Adjustment Button for Tapping, Clapping, Shiatsu, Rolling Mode
After activating the Tapping, Clapping, Shiatsu or Rolling function, every time the button is pressed, the width can be adjusted in the cycle.

20. Spot
The Spot Back Massage
This button allows user to select Spot massage for any part on the back. Press this button once to activate spot massage while the original massage mode continues to run at the original position. Press again to cease Spot massage function and resume full back massage function.
Note: Spot massage function can not be activated when Rolling.

21. Partial
The Partial Back Massage
This button allows user to select Partial Massage for any part of the back. The position for Partial Massage can be adjusted, as a user friendly method of Localised Massage.
Press this button once to continue the original massage mode, while activating Partial Massage, which takes the original position as the centre to perform Partial Massage with the width of approx. 8 cm. Press again to stop Partial Massage function and resume full back massage function.

22. Upward & Downward
Position Adjustment Button for Spot or Partial Massage
This Button is used for adjusting backrest massage position to achieve spot massage. When the massage functions are activated, hold the joystick up or down to move the massage rollers upward or downward until the rollers to ideal position. And then release the joystick to get the spot massage function. Press Spot key to eliminate spot function.
Also under Partial mode, hold the joystick up or down to adjust the center with the width of approx. 8cm. Press Partial key to eliminate partial function.

15. Tapping/Shiatsu
Tapping/Shiatsu function Start/Stop Control Button-3 sizes of width, 3 levels of speed to be adjusted.
Press this button once to activate the tapping function for a full back massage at medium speed; Press again to stop the tapping function and activate the shiatsu function; Press the third time to stop both.

16. Clapping/Rolling
Clapping/Rolling function Start/Stop Control Button-3 sizes of width and 3 levels of speed/3 sizes of width to be adjusted.
Press this button once to activate the clapping function for a full back massage at medium speed; Press again to stop the clapping function and activate the rolling function; Press the third time to stop both.

When you choose one of the above back massage functions, the corresponding LED light.

17. Strength
The Adjustment Button for Kneading Strength
After activating the Kneading function, every time the button is pressed, the strength can be adjusted in the cycle.
Note: Lowest and highest strength is suitable for most people and is advisable. You can choose the medium strength according to your need.

18. Speed
The Speed Adjustment Button for Tapping, Clapping and Shiatsu Mode.
After activating the Tapping, Clapping or Shiatsu function, every time the button is pressed, the speed can be adjusted in the cycle.

7. Zero-G
Press this button to activate the Zero-G function. Press the button again to stop the Zero-G massage function.

8. Timer
The Timer's Time Interval
After the massage process is activated, the chair will be automatically set on a 15-minute timer. Subsequently, every time the "Timer" button is pressed, the Timer's interval will be changed in the sequence of "20-25-30-35-10-15" minutes.
When there is only 1 minute remaining in the set time, 10 beeps will be heard to alert the user.

A. Full Body Auto Programme
Once one of the five Full Body Auto Programmes is activated, the machine will automatically do a height scan for the back.
The following are the Auto Programmes available:

- 9. Comfort
- 10. Stretch
- 11. Healthcare
- 12. Relax
- 13. Full Air

B. Localised Back Programme
This programme gives precise massage at the exact part of the body for better localized massage effect.

1) Localized Back Massage Programme
14. Kneading/Kneading+Clapping
Kneading+Kneading+Clapping function Start/Stop Control Button-3 strength levels/3 strength levels and 5/15 levels of speed to be adjusted.

23. Recline Leg / Lift Leg
Angle Adjustment Control Button for Calves
These two control buttons can adjust massage angle on the Leg rest.
You may adjust the recline position by hold the Recline Leg / or Lift Leg control button until the leg rest is at your desired angle, releasing the button to confirm the massage angle.

4/5. Recline / Sit up
Angle Adjustment Control Button for Massage Chair
You may adjust the recline position by hold the Recline / or Sit up control button until the chair is at your desired angle, releasing the button to confirm the massage angle.

6. The Pause Button
When the chair is in massage mode and the user wants to temporarily pause it, press the Pause button and all massage functions will stop. The "Pause" icon will be blinking on the Liquid Crystal Display and the set time countdown will be paused as well. The chair is now in idle mode. Only the "ON/OFF", Pause, Recline, Sit Up, Lift Leg, Recline Leg can be used. Press the Pause button again to immediately cease the "Pause" function and resume the original massage function. The countdown continues.

13

14

11

12