

## LIMITED TWO YEAR WARRANTY

Conair will repair or replace (at our option) your unit free of charge for 24 months from the date of purchase if the appliance is defective in workmanship or materials.

To obtain service under this warranty, return the defective product to the service centre listed below, together with your purchase receipt and \$5.50 for postage and handling. In the absence of a purchase receipt, the warranty period shall be 24 months from the date of manufacture.

**ANY IMPLIED WARRANTIES, OBLIGATIONS, OR LIABILITIES, INCLUDING BUT NOT LIMITED TO THE IMPLIED WARRANTY OF MERCHANTABILITY AND FITNESS FOR A PARTICULAR PURPOSE, SHALL BE LIMITED IN DURATION TO THE 24 MONTH DURATION OF THIS WRITTEN, LIMITED WARRANTY.**

**IN NO EVENT SHALL CONAIR BE LIABLE FOR ANY SPECIAL, INCIDENTAL, OR CONSEQUENTIAL DAMAGES FOR BREACH OF THIS OR ANY OTHER WARRANTY, EXPRESS OR IMPLIED, WHATSOEVER.**

This warranty gives you specific legal rights, and you may also have other rights, which vary from province to province.

### SERVICE CENTRE:

**Conair Consumer Products ULC**

100 Conair Parkway

Woodbridge Ontario, L4H 0L2

©2014 CONAIR CONSUMER PRODUCTS ULC

For more information on any Conair product call:

1855-926-6247 (18559 CONAIR)

Visit our Web site: [www.conaircanada.ca](http://www.conaircanada.ca)

Consumer Call Centre E-mail:

[Consumer\\_canada@conair.com](mailto:Consumer_canada@conair.com)

14CN146462

IB-11557

# STUBBLE TRIM

## 14 Piece GROOMING SYSTEM



## Have a Question?

*Please do not return this product  
to the retailer.*

### Call Us First!

Our customer service and product experts are ready to answer ALL your questions.

Please call our TOLL-FREE customer service number at: 1-800-472-7606

or visit us online at  
[www.conaircanada.ca](http://www.conaircanada.ca)

**Instruction Booklet**  
Model GMT265XC

be slightly damp (NOT WET) when using your trimmer. This will prevent the trimmer from removing more hair than desired.

## TYPES OF BEARDS/MUSTACHES



## GETTING STARTED:

### OUTLINING YOUR BEARD

1. It is always best to begin with a clean, slightly damp beard.
2. After you have combed through your beard in the direction it grows naturally, you will want to outline the desired shape, beginning under your jawline.
3. Begin defining your beard's shape under your chin and work upward on each side of your face toward your ears. Then define the upper outline of your beard across your cheeks, past your sideburns, and toward your hairline.



### NOW YOU'RE READY TO TRIM YOUR BEARD

1. The trimmer includes a five position comb for use with the hair trimming blade (2-10mm) which provide lengths of 3/32" (shortest) to 3/8" (longest).
2. To use the 5-position comb, slide the unit over the trimmer blades and snap it down into position. At first, until you become familiar with the adjustments, use the longest trim

setting. (You can always go back and make your beard a little shorter.)

3. Begin trimming your beard using smooth, even strokes. Start with your sideburns and work downward toward your chin. (Never attempt to trim against the natural growth of your beard because the hair will be cut too short.)

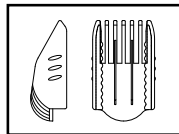

4. If you decide you want a closer trim, you can now adjust the 5-position comb attachment to a shorter setting (such as 3/32" or 5/32") and go over your beard again until you achieve the desired length.



## HOW TO GET THE STUBBLE LOOK

This trimmer includes 5 stubble combs. These combs allow you to achieve 15 different looks of stubble or shadow looks to your already existing growth. Simply use comb #1-#5 for any look you would like to achieve. You can also use the taper control, which has 3 settings. Combined with 5 total stubble combs you can achieve your 15 different looks. Each comb has a different length. Comb # 1 is closest to the skin of the face while comb # 5 is farthest off the face. Customizing a different look each day! The stubble combs fit on the blade just like the jawline combs, note blending the jawline section for specifics on how combs/jawline combs go on.

# USER MAINTENANCE INSTRUCTIONS

## TAKING CARE OF YOUR TRIMMER

### OILING THE BLADES

About once a month you should oil the trimmer blades with the oil provided in your kit. It is best to do this over a piece of newspaper. Turn the trimmer on and hold it so that the blades are pointed downward. Spread one drop of oil across the blades, then turn the trimmer off and wipe away the excess oil with a soft cloth.

Be careful not to use too much oil and don't oil your trimmer more than necessary, as this could damage the motor. (Never attempt to oil the motor bearing, as it is permanently lubricated.) After oiling the blades, return the trimmer and oil packet to the trimmer storage base. Keep oil away from children.

### BLADE CARE

Because the trimmer blades are precision-made for a very special use, they should always be handled with care. Each time you finish using the trimmer, take the cleaning brush provided and brush away any loose hair that has collected in the blades.

Be especially careful when changing or adjusting blades. When you have your trimmer serviced, be sure that both blades are sharpened or replaced at the same time.

To promote the long life of the appliance, use your trimmer only for the purpose intended by the manufacturer – to trim your beard and mustache.

### THREE POSITION TAPER CONTROL

The Conair trimmer taper control switch is positioned at the back of the unit. You can hold the trimmer in your hand and adjust the switch as needed. The taper control eliminates the need in some situations for an attachment comb because it lets you gradually adjust the closeness of the cut. For closest cut and shortest hair, push switch all the way to level #3. This is the setting to use for the 2 day shave look. To increase the cutting length, slowly push control down to level #2 or #1 for longer cut. Note that too much clipped hair on the clipper can slow down its operation. To remove it without removing the blades simply use the enclosed cleaning brush and gently sweep away the clipped hair from cutting surfaces. Note: The taper control only works with the facial hair trimmer.



### GROWING A BEARD AND MUSTACHE

There are three key factors that will determine which beard or mustache style is best for you:

1. The shape and dimensions of your face.
2. The natural growth of your beard/ mustache.
3. The thickness of your beard/mustache. If you are unsure about the type of beard or mustache that would most suit your face, speak with a professional hair stylist and ask for an opinion on what style would be best. Once your beard or mustache has been styled, it is essential that you maintain its appearance. To do this, use your trimmer to trim your beard/mustache weekly.

For the best trimming results, your beard should

# MODEL GMT265CSC STUBBLE TRIMMER

2 Jawline Combs      5-Position  
Attachment Comb      Nose/Ear Trimmer



Facial Hair Blade

5 Stubble Combs



Soft Storage Bag



Multi-use Trimmer



Lubricating Oil



Adaptor

# SAVE THESE INSTRUCTIONS

## USER MANUAL

Before using the Class 2 Power Supply, read these instructions carefully.

Model: CA51

Rated input voltage: 100-240Vac, 50/60Hz, 0.2A max

Rated output: 6.0VDC, 70mA

## OPERATION

1. For dry location use only. Do not expose to water.
2. When not in use, unplug unit completely.
3. Never operate this unit if the specification is out of the rating.
4. When using this unit, a warm temperature will be reached.

## CAUTION

1. Risk of electric shock, dry location use only or do not expose to liquid, vapor, or rain.
2. Do not short the polarity (output cord). Ensure jack is plugged into the Trimmer unit before plugging the adaptor into the outlet.
3. Do not operate any appliance which has a damaged output cord or housing.
4. Always unplug the unit before cleaning or when not in use.
5. This power unit is intended to be correctly oriented in a vertical or floor mount position.
6. Be sure voltage is in correct voltage before plugging in.

## TROUBLESHOOTING

If your rechargeable trimmer does not seem to be taking a charge, take the following troubleshooting steps before returning it for repair:

1. Be sure the electrical outlet is working by plugging in another appliance to test the outlet.
2. Make sure the electrical plug is not connected to a switch which turns power off when lights are turned off.
3. Be sure that all connections are secure, and that the trimmer switch is in the "OFF" position.

## OPERATING INSTRUCTIONS

1. Before using your trimmer for the first time, charge it for 16 hours. Always charge the trimmer with the ON/OFF switch in the OFF position.
2. Always check to see if the charging light is on when you charge the trimmer.
3. Plug the adaptor into any wall outlet (at the voltage listed on the label affixed to the adaptor). Unplug adaptor when not in use.
4. The adaptor may become warm while charging. This is normal.
5. Battery life can be improved by periodically allowing the trimmer to run until the motor stops. Immediately shut the switch OFF and fully recharge.
6. Maximum battery capacity will only be reached after three complete charging and discharging cycles.
7. To maintain the optimum capacity of the rechargeable batteries, the trimmer should be recharged for 16 hours approximately every three months.

7. Hold the trimmer in the way as shown in Fig.3 with the thumb pressing the top front part of the trimmer head and snap it off.

## ON/OFF SWITCH

To operate, simply slide switch toward blade, to stop push slide away from blade.



## CARE OF YOUR TRIMMER REPLACEMENT

### (REMOVAL) OF BLADE SET

To remove blade set from your trimmer, make sure the trimmer is in the OFF position. Remove the blade set by placing thumb against the smaller cutter and pushing forward, releasing the cutter assembly from the trimmer housing. Replace with new cutting system and reverse the removal procedure, only this time place your thumb on the large cutter and snap into place. Make sure the taper control is set to the longest #1 position.

## BATTERY REMOVAL



CONTAINS NICKEL-METAL HYDRIDE BATTERY. MUST BE COLLECTED, RECYCLED OR DISPOSED OF PROPERLY. DO NOT DISPOSE OF IN THE MUNICIPAL WASTE.

1. Using a small Phillips head screwdriver, remove the 3 screws at the back of the trimmer.
2. Remove the bottom housing and push the batteries out and disconnect the leadwire connected with +/– pole. Bring the batteries to the nearest collection center for proper disposal. DO NOT throw the battery into the normal municipal waste system.

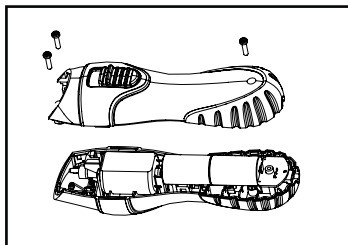

# IMPORTANT SAFETY INSTRUCTIONS

When using electrical appliances, especially when children are present, basic safety precautions should always be taken, including the following:

## READ ALL INSTRUCTIONS BEFORE USING

### *KEEP AWAY FROM WATER*

**DANGER —** Any appliance is electrically live, even when the switch is off.

To reduce the risk of death or injury by electric shock:

- 1. Always unplug appliance from electrical outlet immediately after using (except when charging unit).**
2. Do not place or store appliance where it could fall or be pulled into a tub or sink.
3. Do not use appliance while bathing or in the shower.
4. Do not place appliance in, or drop into, water or other liquid.
5. If appliance has fallen into water, do not reach for it. Unplug immediately.
6. Unplug this appliance before cleaning.

## DO NOT REACH INTO THE WATER

**WARNING —** To reduce the risk of burns, electric shock, fire, or injury to persons:

1. Never leave a plugged-in appliance unattended.
2. This appliance should not be used by, on, or near children or individuals with certain disabilities.
3. Use appliance only for its intended use as described in this manual. Only use attachments recommended by the manufacturer. Do not use an extension cord to operate the appliance.
4. Never operate the appliance if it has a damaged cord or plug, is not working properly, has been dropped or damaged, or dropped into water. Return the appliance to a Conair service center for examination and repair.
5. Keep the appliance cord away from heated surfaces.
6. Do not pull, twist or wrap the cord around the appliance.
7. Never drop or insert any object into any opening of the appliance.
8. Do not place the appliance on any surface while it is operating.
9. Do not use the appliance with a damaged or broken comb or with teeth missing from the blades, as injury may result. Before each use, make certain the blades are aligned properly and oiled.
10. Do not use the appliance outdoors or where aerosol (spray) products are being used or oxygen is being administered.
- 11. THIS PRODUCT IS FOR HOUSEHOLD USE ONLY.**

## BLENDING THE JAWLINE

1. The two jawline attachments (jawline AC12 provides 7 mm and jawline AC13 provides 5 mm) will help you to achieve a neat, finished trim under your chin. To use one of the attachments, press it down over the trimmer blades until it clicks into position.
2. Hold the trimmer in an upright position and begin trimming under your jawline, using short, even strokes.
3. After your beard is blended, turn off the

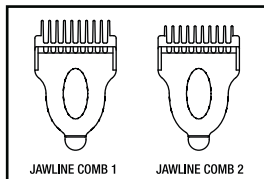

trimmer and remove the attachment by gently pulling up on tab.

## TO TRIM YOUR MUSTACHE

1. For best results, start with a clean, slightly damp mustache.
2. Comb through your mustache in the direction it grows.
3. Place the 5-position comb over the facial hair blade and snap it into position. It is a good idea to start with



the longest trim setting adjustment. (You can always go back and cut your mustache more closely with a shorter setting.)



## ALWAYS TRIM YOUR MUSTACHE FROM THE TOP DOWN

4. After your mustache has been trimmed to the desired length, remove the 5-position comb and, using the blades only, define the outline of the bottom of your mustache.
5. Use the precision goatee trimmer blade for fine detailing and hair art.

## ROTARY NOSE & EAR TRIMMER

For easy, safe grooming of long nose and ear hairs, attach the rotary nose/ear trimmer and hold unit to areas that need trimming.

1. Make sure the trimmer on/off switch is in the "off" position

2. Detach normal trimming blade (see "Repl-acement (Removal) of Blade Set" instructions)

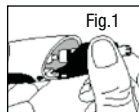

3. Installing the nose & ear trimmer

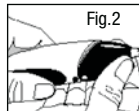

4. Insert the pin of the trimmer body into the hexagonal hole of the trimmer head as shown in Fig.1

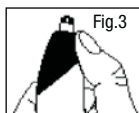

5. Press and snap the trimmer head onto the body as shown in Fig.2

6. Detaching the nose & ear trimmer