

**RF Projection Clock
Model: RM939P**

**POLERMO Projection Clock
Model: RM939PA**

USER MANUAL

CONTENTS

Introduction	1
Overview	1
Clock Front View	1
Clock Back View	2
LCD Display	2
Getting Started	3
Batteries	3
AC Adapter	3
Clock Reception	3
Reception Signal	4
Clock	4
Alarm	4
Sleep Timer	5
Temperature	6
Projector	6
Backlight	6
Reset	6
Motion Sensor – MSR939 / MSR939A (Optional)	6
Motion Alarm Display	6
Motion Alarm	6
The Vibrating Device – VR101 / VR101A (Optional)	7
Precautions	7
Specifications	8
About Oregon Scientific	8
EU-Declaration of Conformity	9
FCC Statement	9
Declaration of Conformity	9

INTRODUCTION

Thank you for selecting the Oregon Scientific™ projection clock. The Motion Sensor (MSR939 / MSR939A) and Vibration Wake-Up Alarm (VR101 / VR101A) are compatible with this product and can be purchased separately.

NOTE Please keep this manual handy as you use your new product. It contains practical step-by-step instructions, as well as technical specifications and warnings you should know.

OVERVIEW

CLOCK FRONT VIEW

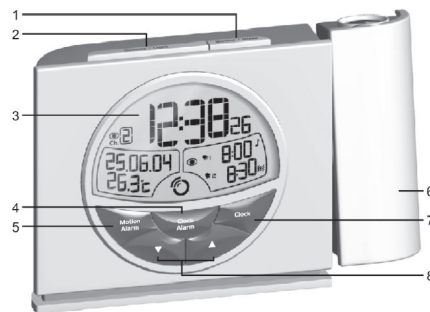

1. **SOUND / SLEEP:** Activate soothing sound; set sleep time
2. **SNOOZE / LIGHT:** Activate snooze / light
3. **LCD display**
4. **CLOCK ALARM:** Toggle alarm 1 / 2 ON/OFF; enter alarm setting mode
5. **MOTION ALARM:** Enter Motion Alarm Mode; set motion alarm time
6. **Projector:** Projects time and alarm status
7. **CLOCK:** Toggle display modes
8. **▲ / ▼:** Change settings

CLOCK BACK VIEW

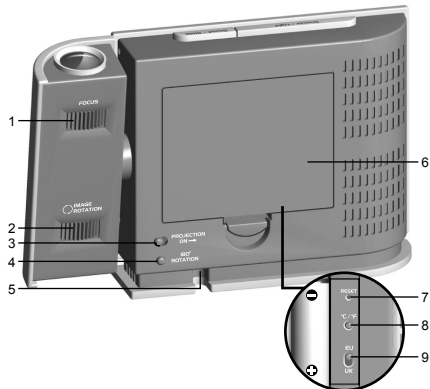

1. Projector **FOCUS** knob
2. Projector **IMAGE ROTATION** knob
3. **PROJECTION ON / OFF:** Enables continuous projection with AC adapter connected
4. **180° ROTATION** button
5. **6V AC / DC** adapter socket
6. **Battery compartment** (cover on)
7. **RESET:** Press to reset default settings
8. **°C / °F:** Toggle temperature display unit
9. **UK / EU** (RM939P only)

LCD DISPLAY

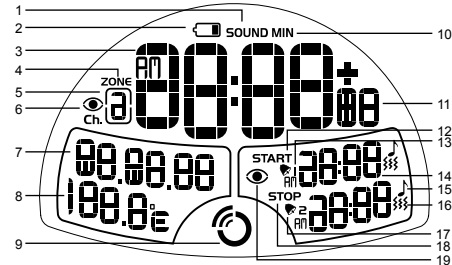

1. **SOUND:** Soothing sound function set
2. Battery low icon
3. Time
4. **ZONE:** Indicates time zone offset displayed

5. Channel 1 / 2: Appears when related sensor is activated
6. Motion alarm ON icon
7. Calendar
8. Temperature
9. Clock reception icon: Shows signal strength
10. MIN icon: Indicates sleep time is displayed when soothing sound is activated
11. Time zone offset
12. Motion sensor start time
13. Alarm 1 indicator
14. Alarm 1 / 2 time
15. Melody alarm icon
16. Vibration alarm icon
17. Alarm 2 indicator
18. Motion sensor stop time
19. Motion alarm settings icon

GETTING STARTED

BATTERIES

Insert batteries before first use, matching the polarity (+ and -). **RESET** after each battery change.

To install the clock batteries:

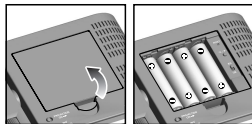

 indicates batteries are low.

NOTE Do not use rechargeable batteries. It is recommended that you use alkaline batteries with this product for longer performance.

NOTE Batteries should be used as a back-up power supply, for continuous projection please use the AC adapter.

AC ADAPTER

To insert the 6V AC / DC adapter into the clock:

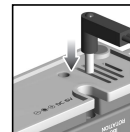

CLOCK RECEPTION

This product is designed to synchronize its calendar clock automatically once it is brought within range of a radio signal:

RM939P:

- DCF-77 generated from Frankfurt, Germany for Central Europe
- MSF-60 generated from Rugby, England.

The radio signal range is 1500km (932 miles).

RM939PA



- WWVB-60 generated from the atomic clock in Fort Collins, Colorado.

The radio signal range is 3219km (2000 miles).

NOTE For RM939P slide the **UK / EU** switch to the appropriate setting for your location. **RESET** whenever you change the selected setting.

RECEPTION SIGNAL

Once batteries have been installed  will flash to indicate it is searching for a signal.

STRONG	WEAK	NO SIGNAL
		

To force a signal search and enable / disable the clock radio signal reception, press **▲ / ▼** and hold for 2 seconds.  will then disappear from the display.

CLOCK

You only need to do this if you have disabled the clock radio reception, or if you are too far from the radio signal.

To manually set the clock:

1. Press and hold **CLOCK** for 2 seconds. The setting will blink.
2. Use **▲ / ▼** to change the setting.
3. Press **CLOCK** to confirm.
4. Repeat steps 2 and 3 to set the time zone offset, 12 / 24 hour format, hour, minute, year, day-month format, month, day and language.
5. Press **CLOCK ALARM** or **MOTION ALARM** to exit settings mode.

NOTE For the RM939PA, the time zone options are (-8) Pacific, (-7) Mountain, (-6) Central, and (-5) Eastern.

NOTE The language options are: English (E) French (F), German (D), Italian (I), and Spanish (S).



To change the clock display:

Press **CLOCK** to toggle between: Clock with Seconds, Clock with Day and Clock with Time Zone Offset.

ALARM

Two daily alarms can be activated. The alarm sound can be a melody, beeping tone or vibration. (Vibration wake-up device VR101 / VR101A must be purchased separately).

See the table below for alarm icons:

ICON	MEANING
	Melody alarm is set. (There are 5 melodies and 1 beep alarm to choose from)
	Vibration alarm is set
	Melody and vibration alarms are set
No icons	No alarm is set

To set the alarm:

1. Press and hold **CLOCK ALARM** for 2 seconds.
2. Use **▲** and **▼** to toggle between alarm 1 and 2.
3. Press **CLOCK ALARM** to select alarm 1 or 2.
4. Press **▲** or **▼** to change the hour setting.
5. Press **CLOCK ALARM** to confirm the hour setting and move to the next setting.
6. The settings appear in the following order: hour, minute, alarm type, alarm sound and alarm volume (if melody alarm has been selected).

NOTE Press **CLOCK ALARM** at any time to exit Alarm setting mode.

To toggle alarm 1 and alarm 2 ON / OFF:

- Press **CLOCK ALARM**.

To silence the alarm:

- Press **SNOOZE / LIGHT** to silence it for 8 minutes
- OR
- Press any key except **SNOOZE / LIGHT** to turn the alarm off and activate it again after 24 hours.

NOTE If no button is pressed the alarm will automatically silence after 2 minutes and sound again after 24 hours.

SLEEP TIMER

There is a choice of 6 soothing sounds to play while you fall asleep:

- Bird
- Raindrop
- Wind
- Waterfall
- River
- Ocean Wave

To turn the sleep timer ON:

1. Press **SOUND / SLEEP** once to activate the last setting used.
2. Press **SOUND / SLEEP** to set soothing sound duration (120, 90, 60, 30, 15 or 0 minutes).
3. Press **▲** or **▼** to change the soothing sound volume.

NOTE SOUND will flash on the LCD display to indicate that the sleep timer is activated.

To change soothing sound:

1. Press and hold **SOUND / SLEEP** for 2 seconds while the soothing sound is on.
2. Press **▲** or **▼** to change the soothing sound.
3. Press **SOUND / SLEEP** to confirm.

TEMPERATURE

To select indoor temperature unit press °C / °F.

PROJECTOR

Press **SNOOZE / LIGHT** to project the time and alarm for 5 seconds.

To use the projector continuously, you **MUST** plug in the adapter and slide the **PROJECTION** switch to ON.

You can also:

- Adjust the **FOCUS** knob to make the image clearer.
- Adjust the **IMAGE ROTATION** knob to rotate the image clockwise or counter-clockwise.
- Manually tilt the projection unit to position the image or press **180° ROTATION** to reverse the image and turn it upside down.

BACKLIGHT

Press **SNOOZE / LIGHT** to activate the backlight for 5 seconds.

RESET



To return the unit to the default settings, insert a thin blunt object into the **RESET** hole.

MOTION SENSOR – MSR939 / MSR939A (OPTIONAL)

This product can support up to two motion sensors. To enable the motion alarm you must purchase this device separately.

NOTE Please refer to the motion sensor (MSR939 / MSR939A) user manual for further information.

MOTION ALARM DISPLAY

ICON	MEANING
	Motion sensor alarm icon
	Code icons

MOTION ALARM**To set the motion alarm:**

1. Press and hold **MOTION ALARM** for 2 seconds.
2. Use **▲** and **▼** to select a code setting that matches the **CODE** switch on the rear of the sensor.
3. Press **MOTION ALARM** to confirm.
4. Press **▲** or **▼** to select the motion sensor start time.

5. Press **MOTION ALARM** to confirm.
6. Repeat steps 4 and 5 to set the motion sensor stop time, beep / melody and volume.
7. The motion alarm is automatically turned on after setting.

NOTE Press **CLOCK** or **CLOCK ALARM** at any time to exit Alarm setting mode.

To silence the motion alarm:

- Press any button. It will sound again if any motion is detected.

THE VIBRATING DEVICE – VR101 / VR101A (OPTIONAL)

The vibrating wake-up device can be placed under your pillow and will wake you up by gently vibrating. All you need to do is activate the vibrating alarm option on the clock and switch the vibrating device to alarm 1, alarm 2 or both.

You can purchase this device separately.

NOTE Please refer to the vibrating wake-up alarm (VR101 / VR101A) user manual for further information.

PRECAUTIONS

This product is engineered to give you years of satisfactory service if you handle it carefully. Here are a few precautions:

- Placement of this product on wood surfaces with certain types of finishes, such as clear varnish, may result in damage to the finish. Consult the furniture manufacturer's care instructions for direction as to the types of objects that may safely be placed on the wood surface. Oregon Scientific shall not be responsible for any damage to wood surfaces from contact with this product.
- Do not immerse the unit in water. If you spill liquid over it, dry it immediately with a soft, lint-free cloth.
- Do not clean the unit with abrasive or corrosive materials.
- Do not subject the unit to excessive force, shock, dust, temperature or humidity, which may result in malfunction, shorter electronic life span, damaged battery and distorted parts.
- Do not tamper with the unit's internal components. Doing so will invalidate the warranty on the unit and may cause unnecessary damage. The unit contains no user-serviceable parts.
- Only use fresh batteries as specified in the user's instructions. Do not mix new and old batteries.
- Due to printing limitations, the displays shown in this manual may differ from the actual display.
- The contents of this manual may not be reproduced without the permission of the manufacturer.
- Do not dispose this product as unsorted municipal waste. Collection of such waste separately for special treatment is necessary.

NOTE The technical specifications for this product and the contents of the user manual are subject to change without notice.

SPECIFICATIONS

TYPE	DESCRIPTION
MAIN UNIT	
L x W x H	161 x 30 x 103 mm (6.34 x 1.18 x 4.06 inches)
Weight	268 g (0.59 lbs)
Temp. unit	°C / °F
Operating range	0°C to 50°C (32°F to 122°F)
Indoor temp.	-5°C to 50°C (23°F to 122°F)
Resolution	0.1°C (0.2°F)
Clock frequency	DCF-77(EU), MSF-60(UK) or WWVB-60 (US)
Synchronization	Auto or disabled
Signal frequency	433MHz
Clock	Auto or manual (disabled)
Reception range	30 meters (98 feet) with no obstructions
Clock display	HH:MM:SS HH:MM:Day of Week HH:MM:Time Zone Offset

Hour format	12 / 24 hour format
Calendar	MM / DD or DD / MM Language: E, F, D, I, ES
Alarm duration	Daily alarm: 2 minutes Motion alarm: 5 minutes
Snooze	8 minutes
Power	4 x UM-3 (AA) 1.5V batteries or 6V AC / DC adapter

ABOUT OREGON SCIENTIFIC

Visit our website (www.oregonscientific.com) to learn more about Oregon Scientific products such as digital cameras; MP3 players; children's electronic learning products and games; projection clocks; health and fitness gear; weather stations; and digital and conference phones. The website also includes contact information for our Customer Care department in case you need to reach us, as well as frequently asked questions and customer downloads.

We hope you will find all the information you need on our website, however if you're in the US and would like to contact the Oregon Scientific Customer Care department directly, please visit:

www2.oregonscientific.com/service/default.asp

OR

Call 1-800-853-8883.

For international inquiries, please visit: www2.oregonscientific.com/about/international.asp



EU- DECLARATION OF CONFORMITY

Hereby, Oregon Scientific, declares that the Projection Clock (RM939P) is in compliance with the essential requirements and other relevant provisions of Directive 1999/5/EC.

A copy of the signed and dated Declaration of Conformity is available on request via our Oregon Scientific Customer Service.



COUNTRIES RTTE APPROVAL COMPLIED

All EU countries, Switzerland 
and Norway 

FCC STATEMENT

This device complies with Part 15 of the FCC Rules. Operation is subject to the following two conditions: (1) This device may not cause harmful interference, and (2) This device must accept any interference received, including interference that may cause undesired operation.

WARNING Changes or modifications not expressly approved by the party responsible for compliance could void the user's authority to operate the equipment.

NOTE This equipment has been tested and found to comply with the limits for a Class B digital device, pursuant

to Part 15 of the FCC Rules. These limits are designed to provide reasonable protection against harmful interference in a residential installation.

This equipment generates, uses and can radiate radio frequency energy and, if not installed and used in accordance with the instructions, may cause harmful interference to radio communications. However, there is no guarantee that interference will not occur in a particular installation. If this equipment does cause harmful interference to radio or television reception, which can be determined by turning the equipment off and on, the user is encouraged to try to correct the interference by one or more of the following measures:

- Reorient or relocate the receiving antenna.
- Increase the separation between the equipment and receiver.
- Connect the equipment into an outlet on a circuit different from that to which the receiver is connected.
- Consult the dealer or an experienced radio / TV technician for help.

DECLARATION OF CONFORMITY

The following information is not to be used as contact for support or sales. Please call our customer service number (listed on our website at www.oregonscientific.com), or on the warranty card for this product) for all inquiries instead.



EN

We

Name: Oregon Scientific, Inc.
Address: 19861 SW 95th Ave., Tualatin,
Oregon 97062 USA
Telephone No.: 1-800-853-8883

declare that the product

Product No.: RM939PA
Product Name: Projection Clock
Manufacturer: IDT Technology Limited
Address: Block C, 9/F, Kaiser Estate,
Phase 1, 41 Man Yue St.,
Hung Hom, Kowloon,
Hong Kong

is in conformity with Part 15 of the FCC Rules. Operation is subject to the following two conditions: 1) This device may not cause harmful interference. 2) This device must accept any interference received, including interference that may cause undesired operation.