

# YardWorks

## 20m Mobile Retractable Hose Reel

MODEL NO. HRT-200



**2 YEAR**  
REPLACEMENT  
WARRANTY

## OPERATING INSTRUCTIONS

0809

Black	Magenta	Code: HRT-200		
Cyan	Yellow	Date: 24/08/09	Edition: 06	Op: Even
用本处所有显示的颜色打印包装资料。Print artwork using ALL inks shown here.				

## SPECIFICATIONS - MODEL NO. HRT-200

<b>Hose Length:</b>	20m
<b>Connection Hose Length:</b>	2m
<b>Hose Diameter:</b>	12mm (1/2")
<b>Hose Material:</b>	PVC
<b>Working Pressure:</b>	72.5psi 6 Bar
<b>Weight:</b>	11kg
<b>On-board storage compartment:</b>	Yes
<b>Auto-locking hose:</b>	Yes
<b>Wall mount bracket:</b>	Yes
<b>Mobile trolley:</b>	Yes

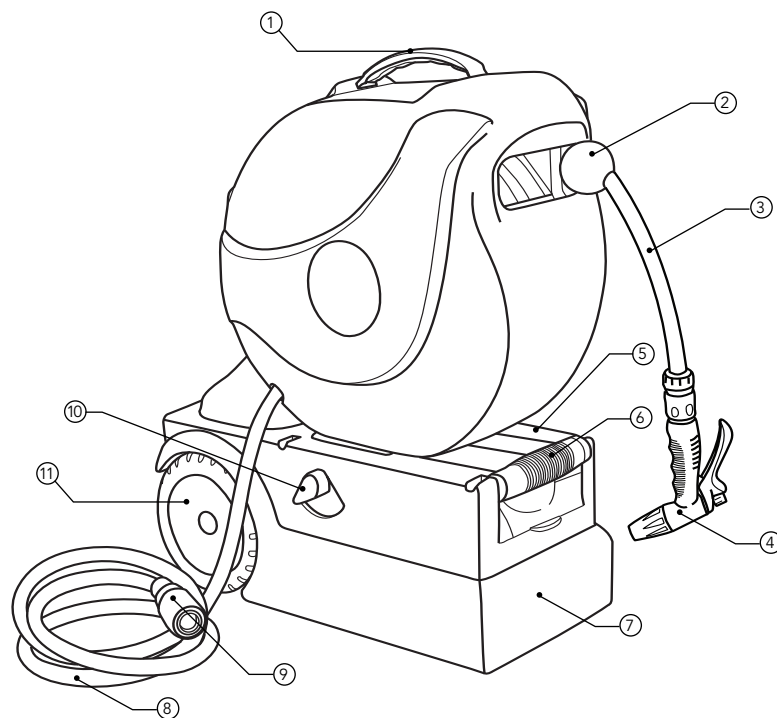

- |                        |                         |
|------------------------|-------------------------|
| 1. Carry handle        | 7. Trolley              |
| 2. Hose stop           | 8. Inlet hose           |
| 3. Hose                | 9. Inlet hose connector |
| 4. Trigger nozzle      | 10. Locking lever       |
| 5. Storage compartment | 11. Wheels              |
| 6. Trolley handle      |                         |

## TABLE OF CONTENTS

SPECIFICATIONS.....	Page 2
INTRODUCTION.....	Page 4
CONTENTS.....	Page 4
INSTALLATION.....	Page 5
OPERATION.....	Page 8
MAINTENANCE.....	Page 9
SPARE PARTS .....	Page 9
WARRANTY.....	Page 11

## INTRODUCTION

The YardWorks Mobile Retractable Hose Reel eliminates the problem of tangled hoses and brings the joy back into watering gardens and lawns.

It provides secure storage for 20 metres of hose, keeps the hose protected from the elements and helps it to retract without any kinks or knots.

The hose reel offers the flexibility of being mounted onto a wall/post or transported around the garden and used on its mobile trolley.

The slow rewind function allows greater control when retracting the hose whilst the auto-track will ensure the hose winds evenly every time.

The combination of a mobile support trolley with integrated handle allows easy maneuvering around the garden. The on-board storage compartment provides a convenient place to store your garden tools and accessories.

## CONTENTS

- 1 x 20m Mobile retractable hose reel
- 1 x Trolley
- 1 x Trigger nozzle
- 1 x Inlet hose
- 1 x Inlet connector (fitted)
- 1 x Wall mount
- 1 x Support tube
- 1 x Wall mount installation kit  
(3 x bolts & washers, 2 x locating pins, 3 x wall plugs)
- 2 x Spare wall plugs
- 4 x Ground pegs
- 1 x Operational manual

## INSTALLATION

### Wall mounting the hose reel

1. Carefully plan where you will install the mobile retractable hose reel so it can be used effectively within the garden.
2. It is recommended that the hose reel wall mount is installed near a water source. For large areas it is more convenient for the hose reel to be installed in the middle of the garden or near the work area, this allows the hose to easily reach all parts of the garden.
3. The wall mount can be installed either onto a brick wall or wooden post. The key point is that the bracket is installed in a location that suits the primary user of the hose reel. The most appropriate location is on a wall with the bracket located approximately 1.25 metres from the ground.
4. The wall bracket has 5 holes, align the bracket on the wall and mark the position of the 5 holes on the wall. Drill the holes using the correct drill accessory (not supplied) and insert the wall plugs into the 3 upper holes.
5. Insert the locating pins in the 2 holes at the base of the bracket.
6. Align the bracket on the wall and secure with the 3 remaining bolts and washers.
7. Fit the support tube into the base of the hose reel, ensure that it is pushed in all the way.
8. Align the support tube with the hole in the wall bracket and fit the hose reel onto the wall bracket (Fig. 1)
9. Connect the inlet hose to the tap (Fig. 2).



Fig. 1



Fig. 2

10. When the hose reel is wall mounted it can swivel 180 degrees.

## INSTALLATION (cont.)

### Fitting the hose reel to the mobile trolley cart

1. Pull the trolley handle (7) to the end of the rail (Fig. 3).



2. Fit the support tube into the base of the hose reel, ensure that it is pushed in all the way.

**Note:** The 1 support tube is used on both the trolley base and the wall mount.

3. Align the support tube with the hole in the trolley (7) and fit the hose reel onto the trolley.
4. Switch the locking lever (10) to the left position (Fig. 4). This secures the hose reel on the trolley and prevents it from rotating. It allows you to safely transport the hose reel around the garden (Fig. 6).
5. Switch the locking lever (10) to the right position (Fig. 5) to release the hose reel and allow it to be removed from the trolley.

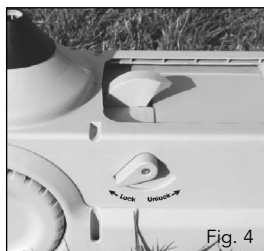

## INSTALLATION (cont.)

### Using the trolley cart in 360 degree operation

1. Ensure the hose reel is removed from the trolley.
2. Remove the 4 ground pegs from the trolley storage compartment (5) (Fig. 7).



3. Ensure the ground is soft enough to insert the four ground pegs securely into the ground.
4. Place each ground peg through the slot in the trolley (7) and push into the ground (Fig. 8).
5. Place the hose reel on the trolley. Ensure the locking lever (10) is in the right hand unlock position. The hose reel can now be rotated 360 degrees (Fig. 9).

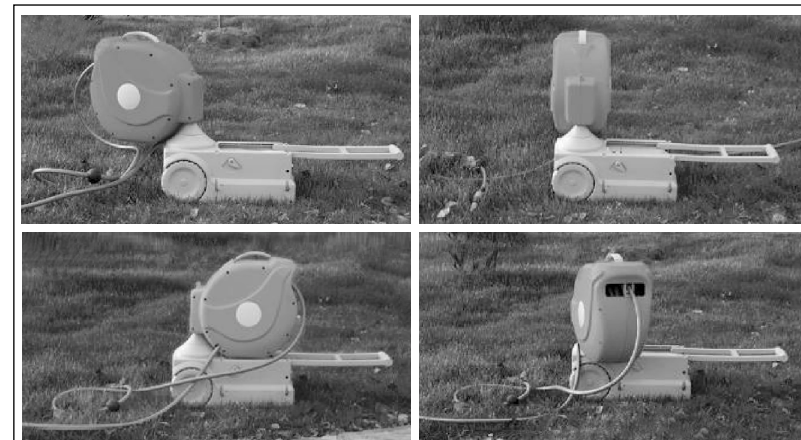
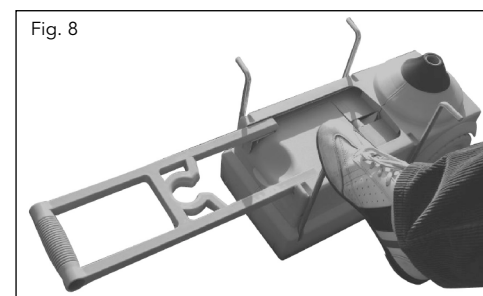

6. Connect the inlet hose (8) to the water source.

Fig. 9

**Note:** When the trolley is used on a hard surface (concrete or pavers) the ground pegs cannot be used. Ensure that the hose reel is not rotated when being used on a hard surface, there is a risk of the unit being pulled over onto its side.

## OPERATION

### Prior to use

The Mobile retractable hose reel comes fitted with a high quality hose. It is designed for home watering applications using cold water only, it is not intended for commercial use.

1. Before use, ensure the hose reel is securely fixed on the wall bracket or positioned on the mobile trolley.
2. Do not place undue force on the hose reel casing. This may damage the casing, bracket or trolley.
3. Children should not be allowed to operate or play with the mobile retractable hose reel or trolley. Ensure children are away from the working area when the hose reel is in operation.
4. Try to find ways to prevent sunlight from heating the hose, especially in areas with high temperatures and high water pressure. This can damage the hose and make it difficult to rewind properly.
5. It is recommended to turn the shut-off the water supply to the hose reel before using the hose reel and prior to rewinding the hose.
6. Do not allow the hose reel to come in contact with any substances containing acetone, caustic products, lactic acids, etc.

**WARNING:** The hose cannot be used for drinking water.

### Unwinding and retracting the hose

1. The Mobile retractable hose reel features a ratchet wheel to retract the hose.
2. When pulling out the hose you will hear a clicking sound. If you stop pulling when you hear a "click" the hose will lock in that position.
3. When you want to rewind the hose, pull it out about 30cm until you no longer hear a "click". The hose can now be retracted back into the hose reel housing.
4. When retracting the hose always hold the hose and walk back towards the hose reel. Do not simply let go of the hose.
5. It is recommended that you pull out a minimum of 25% (5 metres) of the hose before reeling it back in.
6. Whilst retracting the hose always keep the hose reel in line with the hose and retract the full length of the hose to prevent any accidents. Retracting the full length of the hose also helps keep the hose protected from the elements.

## MAINTENANCE

1. When not in use always turn the water source off at the tap and press the trigger nozzle to release the water pressure.
2. Do not submerge the hose reel in water for cleaning. If the hose is dirty, clean it using a damp cloth before reeling it back in.
3. When the hose is not in use, it is recommended to keep it wound on the reel.
4. Regularly inspect the hose reel casing, wall mount bracket, support tube and trolley for signs of wear.
5. The hose reel cannot be used to transmit any chemicals.
6. When not in use for an extended period it is recommended that you store the Mobile retractable hose reel in a protected environment.

## SPARE PARTS

Limited spare parts are available subject to availability. Please contact your local Bunnings Special Orders Desk to order the required spare parts.

### Most common spare parts listed below

Spare Part	Part No.
Wall bracket	SPHRT200-08
Support tube	SPHRT200-09
Left wheel	SPHRT200-21
Right wheel	SPHRT200-22

## CARING FOR THE ENVIRONMENT

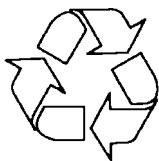

Recycling packaging reduces the need for landfill and raw materials. Reuse of recycled material decreases pollution in the environment. Please recycle packaging where facilities exist. Check with your local council authority for recycling advice.

## YARDWORKS

### AUSTRALIA (Head Office)

1-23 Letcon Drive, Bangholme, Victoria, Australia 3175

Telephone: 1800 069 486

Facsimile: + 61 3 9238 5588

Website: [www.ozito.com.au](http://www.ozito.com.au)

Email: [enquiries@ozito.com.au](mailto:enquiries@ozito.com.au)

# WARRANTY

THIS WARRANTY FORM SHOULD BE **RETAINED BY THE CUSTOMER** AT ALL TIMES

The warranty is only made available by returning the tool to your nearest Bunnings Warehouse with a **confirmed Bunnings register receipt**.

**YOUR WARRANTY FORM SHOULD BE RETAINED BY YOU AT ALL TIMES.**

**SHOULD YOU HAVE ANY QUESTIONS PRIOR TO RETURNING YOUR PRODUCT FOR WARRANTY OR REPAIR PLEASE TELEPHONE OUR CUSTOMER SERVICE HELPLINE:**

**Australia 1800 069 486  
New Zealand 0508 069 486**

TO ENSURE A SPEEDY RESPONSE PLEASE HAVE THE MODEL NUMBER AND DATE OF PURCHASE AVAILABLE. A YARDWORKS CUSTOMER SERVICE REPRESENTATIVE WILL TAKE YOUR CALL AND ANSWER ANY QUESTIONS YOU MAY HAVE RELATING TO THE WARRANTY POLICY OR PROCEDURE.

PURCHASED FROM: \_\_\_\_\_

DATE PURCHASED: \_\_\_\_\_

### 2 YEAR REPLACEMENT WARRANTY

Your Yardworks tool is guaranteed for a period of **24 months from the original date of purchase** and is intended for DIY (Do it yourself) use only.

### WARNING

**The following actions will result in the warranty being void.**

- Professional, Industrial or high frequency use.
- If the tool has been operated on a supply voltage other than that specified on the tool.
- If the tool shows signs of damage or defects caused by or resulting from abuse, accidents or alterations.
- If the tool is disassembled or tampered with in any way.

**Note:** Warranty excludes consumable parts such as Spray Guns, wheels, hose connectors, inlet outlet fittings and Hose Fittings.