

Instruction Manual

Infant car Seat and ISOFIX system

This car seat conforms to ECE R
No.44/04.
It is for children up to
13kg(group 0+)

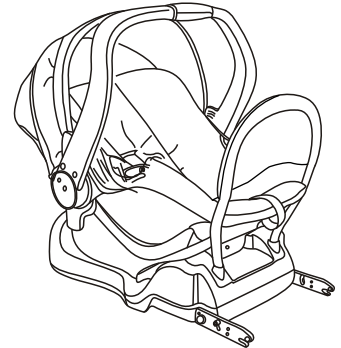

Warning

Failure to use this car seat properly will increase the risk of serious injury or death in a sudden stop or crash.

Introduction

Thank you very much for using this car seat. We sincerely hope it can bring your child safety convenience and happiness when you travel.

The main structure of this product consists of car seat and base. The latch system of the base can fit different kinds of cars including both the new car system (ISOFIX car seat fixing system) and the old car system (safety belt system). (The additional leading cover can be inserted easily into the anchor of the infant car seat)

The device is intended for group 0+ and fixture ISO/R1

Car seat fixing pole and the stand tube of the base can increase the safety level of your car seat. Death or serious injury can be decreased by 22%.

Table of contents

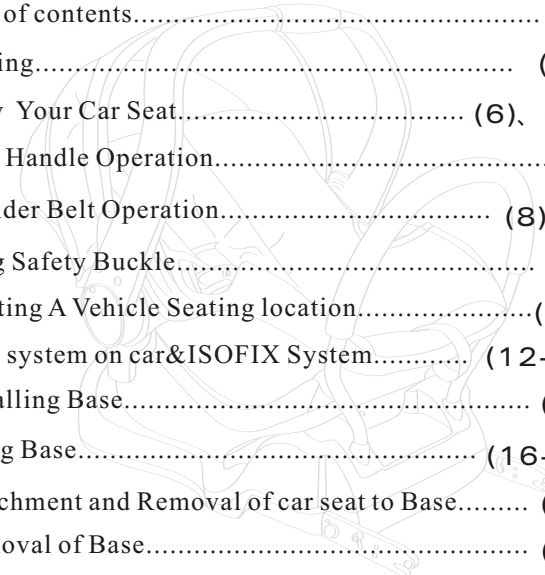

1.Introduction.....	(1)
2.Table of contents.....	(2)
3.Warning.....	(3-5)
4.Know Your Car Seat.....	(6)、(14)
5.Carry Handle Operation.....	(7)
6.Shoulder Belt Operation.....	(8)-(9)
7.Using Safety Buckle.....	(10)
8.Selecting A Vehicle Seating location.....	(11)
9.Latch system on car&ISOFIX System.....	(12-13)
10.Installing Base.....	(15)
11.Using Base.....	(16-18)
12.Attachment and Removal of car seat to Base.....	(19)
13.Removal of Base.....	(19)
14.Care and Cleaning.....	(20)

Warning

- ◆ Direct sunlight can make this car seat surface hot enough to burn child. Use caution and check them on hot, sunny days.
- ◆ Do not use this car seat if it is damaged, missing instructions or missing parts.
- ◆ Do not use car seat if it has been in a crash, it must be replaced. A crash can cause unseen damage and using it again could result in serious injury or death.
- ◆ Never leave child unattended.
- ◆ Do not use car seat again or throw it away if the label time at the back of the car seat becomes overdue. Do not sell it to the consigner or to the flea market, abandon it into a dark rubbish bin.
- ◆ Never place the car seat directly to the back of a person. Make sure that the car seat is on one side behind of your back.
- ◆ Do not attach car seat to a shopping trolley.
- ◆ Do not use car seat in rear seat of a compact pickup truck. Severe head injury or death can occur.
- ◆ Never use car seat in any vehicle seating position equipped with an active air bag.
- ◆ Read your vehicle manual if you need to use car seat in the front when there is no rear seat in your vehicle.

Warning

- ◆ This is ISOFIX CHILD RESTRAINT SYSTEM. It is approved to regulation No.44/04.
- ◆ It will fit vehicles with positions approved as ISOFIX positions (as detailed in the vehicle handbook), depending on the category of the child seat and of the fixture.
- ◆ The mass group and the ISOFIX size class for which this device is intended is: Group 0+, E – ISO/R1
- ◆ When the device is used in combination with an adult safety-belt to be used by means of the following wording: Only suitable for use in the listed vehicles fitted 3 point, approved to ECE Regulation No.16 or other equivalent standards.
- ◆ It is recommended that any straps holding the restraint to the vehicle should be tight, that any straps restraining the child should be adjusted to the child's body, and that straps should not be twisted
- ◆ It is recommended that any luggage or other objects liable to cause injuries in the event of a collision shall be properly secured.

Warning

- ◆ It is dangerous that making any alterations or additions to the device without the approval of the competent authority, and not following closely the installation instructions provided by the child restraint manufacturer.
- ◆ There shall be provisions made so that the instructions can be retained on the child restraint for its life period.
- ◆ It is recommended that:
 - a) The child restraint must not be used without the cover.
 - b) The seat cover should not be replaced with any other than the one recommended by the manufacturer, because the cover constitutes an integral part of the restraint performance.
- ◆ The rigid items and plastic parts of the ISOFIX child restraint system must be so located and installed that they are not liable, during everyday use of the vehicle, to become trapped by a movable seat or in a door of the vehicle.
- ◆ The ISOFIX base can only be used with the special designed shell.

Notice

This Child Restraint is classified for "Semi-universal " Use and is suitable for fixing into the seat positions with ISOFIX anchorage points like following cars:

<u>CAR</u>	<u>FRONT</u>	<u>REAR</u>	
		<u>Outer</u>	<u>centre</u>
BMW(Mini)	No	Yes	No
SAAB	No	Yes	No
VOLVO(xc70)	No	Yes	No

Seat positions in other cars may also be suitable to accept this child restraint. If in doubt, consult either the child restraint manufacturer or the retailer.

Car seat parts

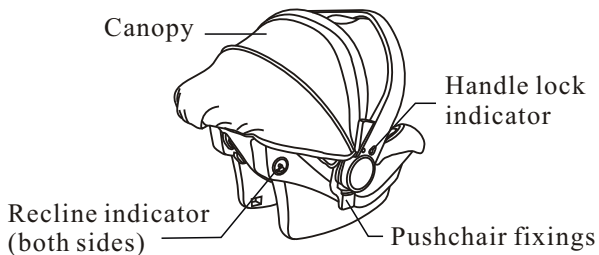
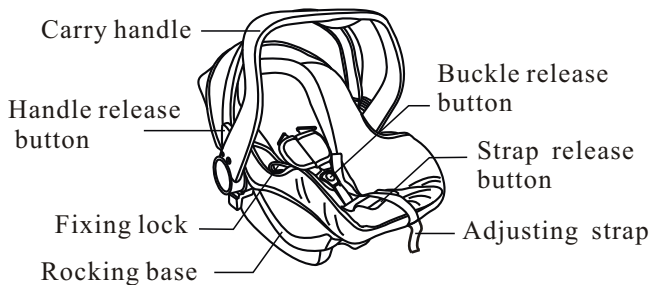

Carry handle operation

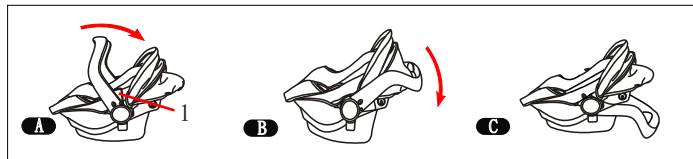

To move the handle from one position to another, press both release buttons at the same time to the direction of the arrow (see A B C)

Functions of different positions:

- A. For carrying your child or fitting in the car
- B. When fitted on the pushchair or for rocking your baby
- C. When used as a seat, e.g. for feeding

Warning

Secure infant in car seat with harness at all time to avoid fall hazard.

Shoulder belt adjustment

Shoulder belt release adjustment:

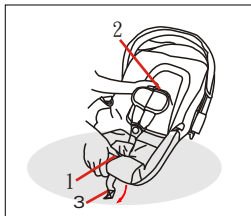

Put car seat on the ground, move the handle to the fixed position (see three positions of the handle on page 5). Use one hand to pull the shoulder belt out of the pad (see position 2), and at the same time use the other hand to press the adjustment

button in order to release the safety belt.

⚠ Warning:

When you need to adjust the shoulder belt, make sure your child is at the right position and try to adjust the strap before you install car seat to your vehicle.

Shoulder belt adjustment

Height selection:

1. the right height selection:

-As your child grows you will need to move the straps to the next slots. The correct slots are those at, or just below your child's shoulders (fig.1) Diagram 1 shows a correct shoulder strap position, all the others are incorrect.

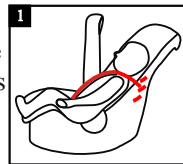

⚠ Warning:

Before tightening the harness, ensure that the shoulder straps sit conformably on the child's shoulders, and that the straps are not twisted.

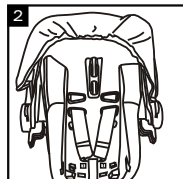

2. The adjustment of the safety belt:

- Step 1. Remove the ends of the shoulder straps from the metal plate at the rear of the seat.
- Step 2. pull the straps through to the front.
- Step 3. Re-insert the straps through the appropriate slots in the seat shell, polystyrene pad, seat cover and head hugger.
- Step 4. Re-attach the loops on the shoulder straps to the slots on the metal plate, Check that the loops are within the metal plate slots and are securely attached.

Using safety buckle

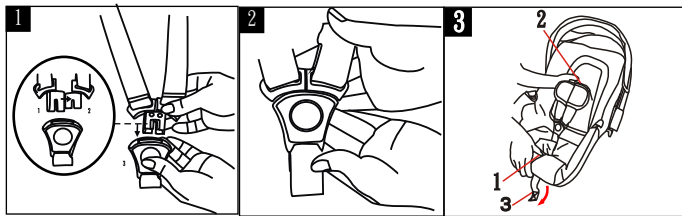

Step1:pull the strap out of the backrest and put infant into the car seat.

Step2:fasten the two locating parts together(fig.1).

Step3.push the locating parts into the socket(fig.2).
A positive click should be heard.

Step 4.cheek by pulling the straps above and below the buckle(fig.3)

Step5.the buckle is released by pressing the red button.

Selecting A Vehicle Seating Location



NO
Seats which
face the side
of the vehicle

NO
Seats which
face the rear
of the vehicle

NO
Do not use the
car seat in any
vehicle seat
where an airbag
is fitted

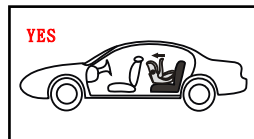

 **Warning:**

After selecting a right vehicle seating location, you need to check the installation of your car seat carefully.

Latch system on car&ISO-FIX System

The latch system can be used when securing this infant car seat with the stay-in-car base and should be used whenever possible.

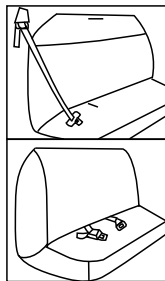

Latch system on car

The design and the use method are different for different latch systems. Refer to your vehicle manual when you need to use the latch system.

ISOFIX system

ISOFIX system consists of two anchors of two anchors at the bottom of the base and one connector for the backrest and base. This kind of system can bring much convenience for the use of the infant car seat.

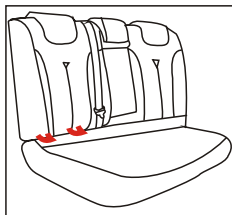

Latch system on car&ISO-FIX system

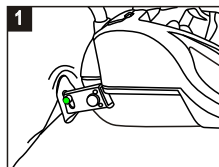

Read this manual before you use ISOFIX system
The two leading covers are unnecessary if you do not have the ISOFIX system (the usage of the leading cover is on page 13).

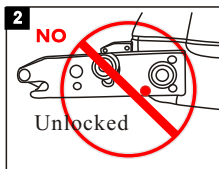

 Attention: Death or serious injury can occur

1. After directing the ISOFIX system into the leading cover, green will be shown by the indicator (fig.3).

2. Use ISOFIX system or Latch system to ensure security.

3. The latch system should be used whenever possible.

4. Use the stand tube to adjust the height until it can reach the most appropriate position.

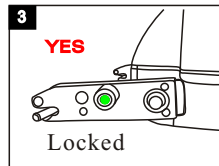

Death or injury can occur at a lower position.

Suffocation can occur at a higher position.

Base parts

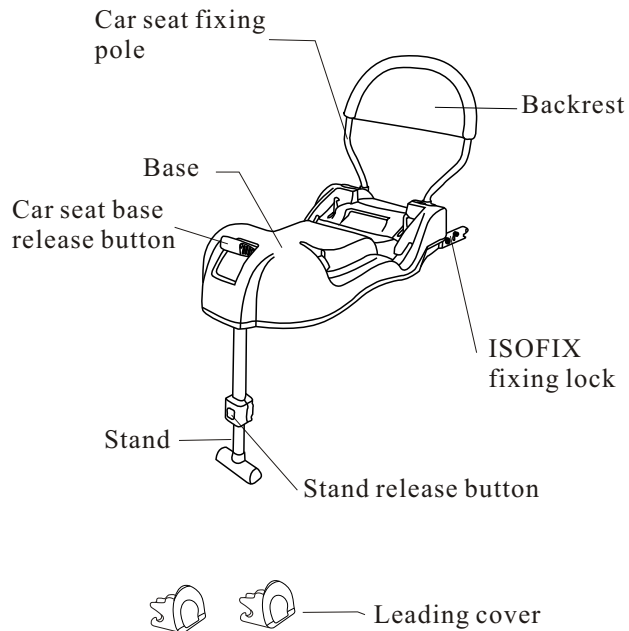

Installing Base

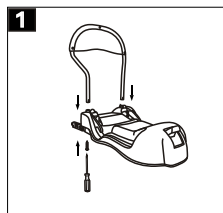

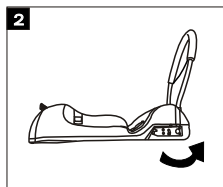

Put the backrest tube into the socket according to the direction of the arrow(fig.1),and fix it with screws.

 **Warning:** Do not remove again at random after adjustment correctly.

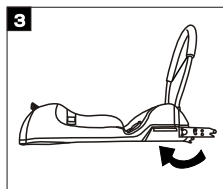

2.turn to open according to the direction of the arrow when ISOFIX fixing lock is needed. Turn back according to the opposite direction when the fixing lock is unnecessary.(fig.2&fig.3)



 **Warning:** keep base folded when your vehicle is an old style.

Using Base

Both latch system on car and ISOFIX system can be used to tie a car seat base. Refer to your vehicle manual when you need to use ISOFIX system.

Using latch system on car with an old car style:

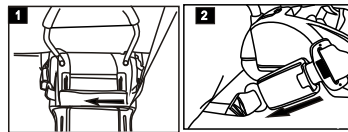

1. pull the safety belt directly through the base with an old car style (fig. 1); then fasten the safety buckle, attach the base to the vehicle seat (fig. 2)

2. press the stand release button to adjust the height the height of the stand tube, ensure that it can touch the floor of the vehicle.

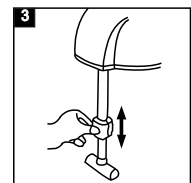

3. check that the base is firmly attached to the vehicle seat.

 **Warning:**

You should check that the angle of the car Seat base is within the safety standard

when you attach car seat to it. Death or serious injury may occur at a lower position. Suffocation may occur at a higher position. You should select an appropriate height position.

Using base

Using base with ISOFIX system in a new car style:

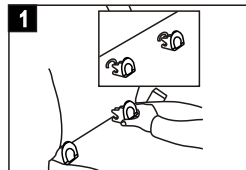

1. Direct two leading cover into the anchor of the latch system on car (fig. 1).

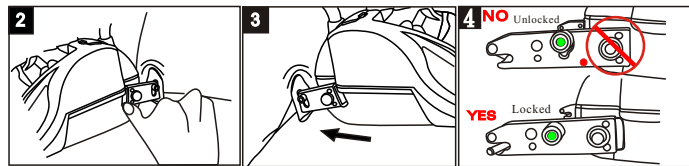

2. Inset the fixing lock of the ISOFIX system into the leading cover until you hear a click (fig 2 & 3 & 4). Repeat it on the other side.

 **Warning:**

The indicator will show green when insert rightly.

Using base

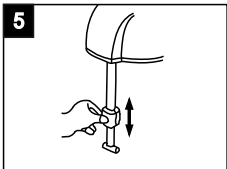

3. press the stand release button to adjust the height of the stand tube, ensure that it can touch the floor of the vehicle(fig.5).

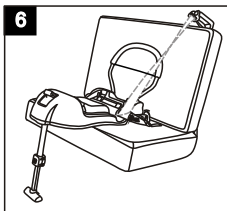

4. Check that the base is firmly installed in the vehicle seat.

5. Finished as it shows in fig6.

 Attention: It may be better to use both kinds of safety systems.

 Attention:

You should check that the angle of the car seat base is within the safety standard when you attach car seat to it. Death or serious injury may occur at a lower position. Suffocation may occur at a higher position. You should select an appropriate height position.

Attachment and removal of car seat to base

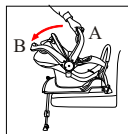

1. Lower car seat into base and push down for lock. You should hear a click as it securely locked. Then push down handle to the use position B as showed in left fig.

 Warning : Carefully check that the car seat is locked into base. Lift it up to verify that it is securely locked.

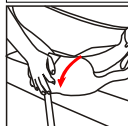

2. Press the release button to release the car seat base, see the picture on the left.

 Warning: keep child with safety belt at all time to avoid fall hazard.

Removal of base

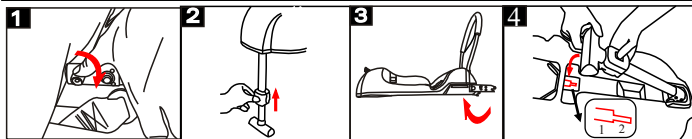

Remove ISOFIX fixing lock with your fingers according to the direction of the arrow(fig.1). Press the stand release button to unfold the stand tube(fig.2). Turn ISO-FIX fixing lock back according to the direction of the arrow(fig.3). press the release button while pushing the stand plastic from slot1 to slot2 according to the arrow direction (fig.4). Then pull backward to check that the stand tube is securely locked.(Do it in reverse order for installation).

