



# TWIN AIRBED WITH PUMP

User manual



English.....3

## AFTER SALES SUPPORT



USA

**888-919-0070**

MODEL: ME1-495H-337-G PRODUCT CODE #:6049 06/2014

Type: 6049

# TWIN AIRBED WITH PUMP

## INSTRUCTION MANUAL

### IMPORTANT SAFETY INSTRUCTIONS

When using an electrical furnishing, basic precautions should always be followed, including the following:  
Read all instructions before using the air pump.

### **DANGER** – To reduce the risk of electric shock:

1. Always unplug this furnishing from the electrical outlet before cleaning.

### **WARNING** – To reduce the risk of burns, fire, electric shock, or injury to persons:

1. This air pump must be used with the 4 x D-size Dry Cell Battery.
2. Do not operate the pumps for more than 5 minutes. The air pump is designed to fully inflate your inflatable in about 3 minutes.
3. Never leave the pump unattended when power is on.
4. Close supervision is necessary when this air pump is used by, or near children, invalids, or disabled persons.
5. Keep infant and small children away from the air pump when it is not in use.
6. This appliance is not intended for use by persons (including children) with reduced physical, sensory or mental capabilities, or lack of experience and knowledge, unless they have been given supervision or instruction concerning use of the appliance by a person responsible for their safety.
7. Children should be supervised to ensure that they do not play with the appliance.
8. Use this air pump only for its intended use as described in these instructions. Do not use attachments not recommended by the manufacturer.
9. Never operate this air pump if it has been dropped or damaged, or dropped into water. Return the air pump to a service center for examination and repair. Do not attempt to service the air pump.
10. Never operate the furnishing with the air openings blocked. Keep the air openings free of lint, hair, and the like.
11. Never drop or insert any object into any opening.
12. For indoor use only. Do not use outdoors. Do not use or place this product near water.
13. For household / residential use only.
14. Keep this product away from sharp and pointed objects.
15. Do not operate where aerosol (spray) products are being used or where oxygen is being administered.
16. After the inflatable is properly inflated and desired firmness is attained, always switch off the air pump.
17. Remove batteries from the air pump before servicing.
18. Carefully follow instructions on items being inflated. Never exceed recommended pressures or do not over inflate. Over inflation may result in bursting of the item, possibly causing serious injury to yourself or others nearby.
19. Never use the air pump where sand, small rocks, twigs, etc, will be sucked into inflation / deflation ports.
20. **READ AND SAVE THESE INSTRUCTIONS** for future reference.

## SET UP AND OPERATION INSTRUCTIONS

1. Pull the Latch to unlock the Battery Door. (Fig. 1)
2. Put in four D-size batteries into the battery compartment.
3. The polarity of each battery should be aware of. Place the batteries with the polarity according to the marking on the battery compartment.
4. Close the Battery Door and use the Latch to lock it properly. (Fig. 2)

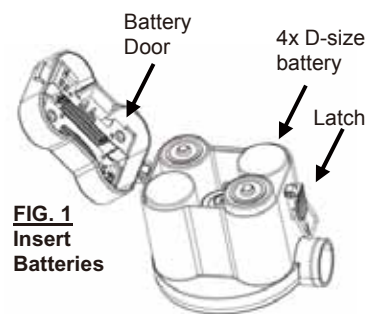

**Polygroup Limited (MCO)**

**Tel: 86-769-83915520**

## AFTER SALES SUPPORT



MODEL: ME1-495H-337-G PRODUCT CODE #:6049 06/2014

5. To Inflate the inflatables:
  - Select a flat indoor surface large enough to accommodate the inflatable.
  - Remove all sharp and pointy objects on and near this surface.
  - Insert the nozzle that fits with the inflatable to the pump inflate outlet. (Fig. 2)
  - Lay the inflatable on the surface with the bottom surface attaching the floor.
  - Orient the inflatable properly.
  - Push the power button to start the pump. (Fig. 2)
  - The inflatable will be automatically inflated in about 3 minutes.
  - Turn off the pump by pressing the power button again.
6. To quick deflate the product:
  - Clean and dry the inflatable. See below "Care, Storage & Maintenance".
  - Insert the nozzle to the pump deflate outlet. (Fig. 3)
  - Push the power button to start deflating the bed or inflatable. (Fig. 3)
  - The inflatable will be deflated automatically in about 3 minutes.
  - Once completely deflated, press the power button to stop the pump.
7. Replace ALL four new batteries at once. Do not mix use with old and new batteries to reduce the risk of explosion.

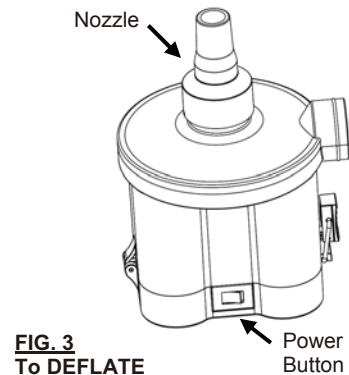
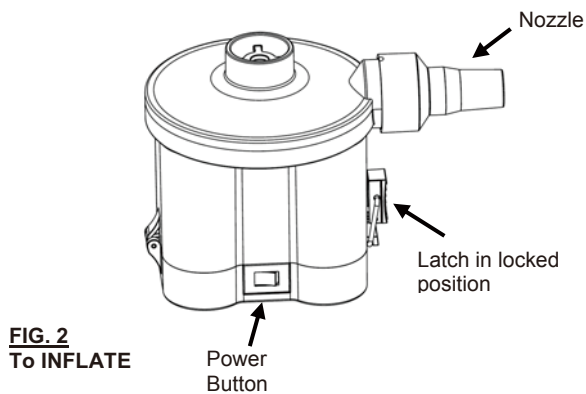

## INFLATING THE AIRBED

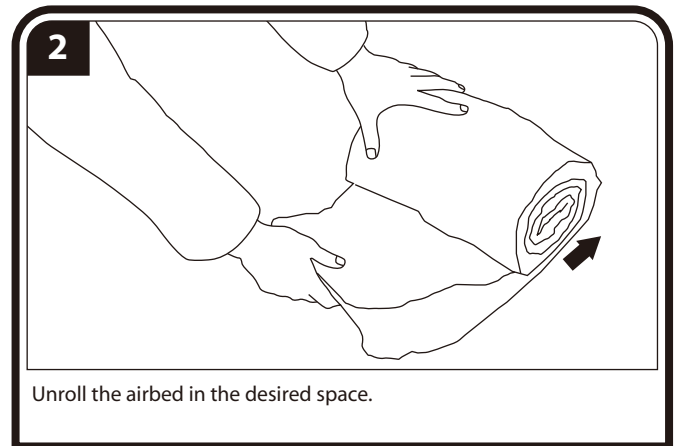
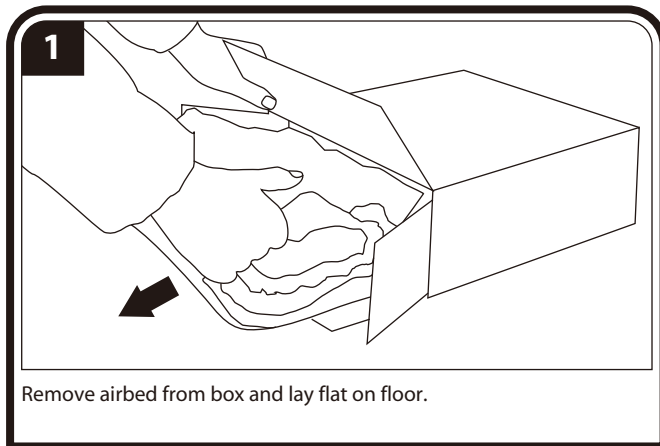

3

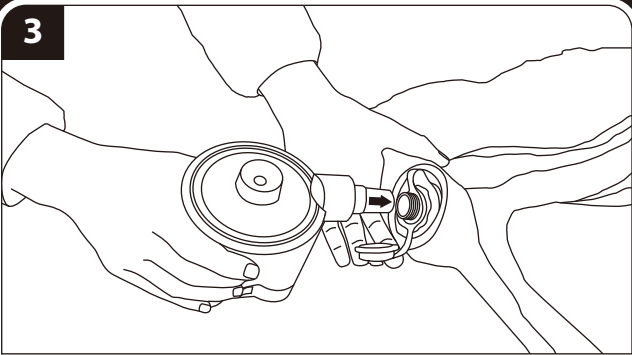

Insert the appropriate size nozzle of the air pump into the inflation valve.

4

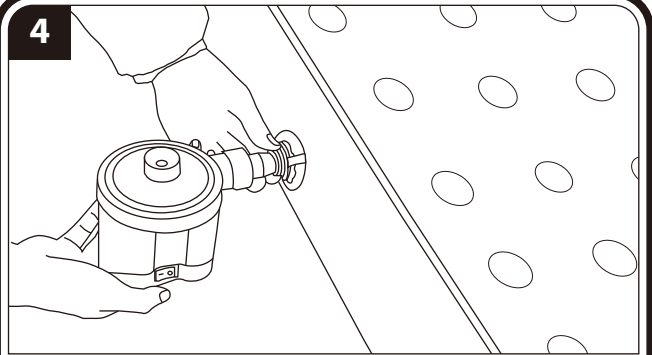

Turn on the pump and inflate the airbed to the desired comfort level.

5

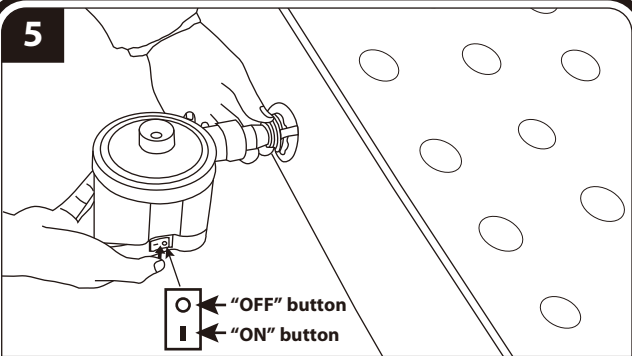

Turn off the pump and remove the nozzle from the inflation valve.

6

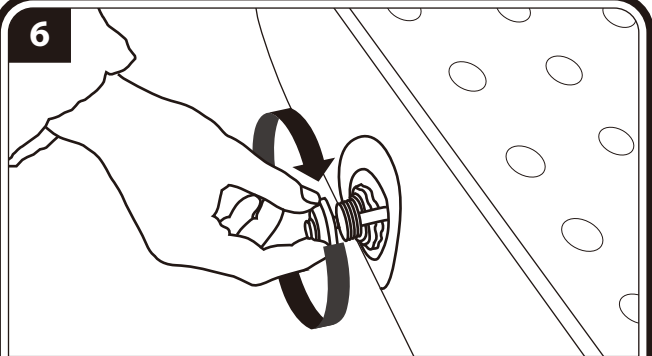

Place the cap inside the inflation valve to prevent air from leaking out of the airbed.

## CARE, STORAGE AND MAINTENANCE

1. Save the original packing box for storage purpose.
2. Let the air pump cool down for at least 30 minutes before storage.
3. Store the air pump in a cool/dry place. Keep out of reach of direct sunlight and chemical substances.
4. This air pump does not contain any user serviceable part, any other servicing is to be performed by an authorized service representative.

## DISPOSAL & ENVIRONMENT

1. This product must not be disposed with domestic wastes.
2. This product has to be disposed at an authorized place for recycling of electrical & electronic appliances.
3. By collecting and recycling waste, you help save natural resources, and make sure the product is disposed in an environmental and healthy way.



This marking indicates that this product should not be disposed with other household wastes throughout the EU. To prevent possible harm to the environment or human health from uncontrolled waste disposal, recycle it responsibly to promote the sustainable reuse of material resources. To return your used device, please use the return and collection systems or contact the retailer where the product was purchased. They can take this product for environmental safe recycling.

PATENT PENDING

MADE IN CHINA

## AFTER SALES SUPPORT



USA 888-919-0070

MODEL: ME1-495H-337-G PRODUCT CODE #:6049 06/2014