

# Quick Release (for Disc Brake)



User's manuals in other languages are available at : <http://si.shimano.com>

## IMPORTANT NOTICE

- Contact the place of purchase or a bicycle dealer for information on installation and adjustment of the products which are not found in the user's manual. A dealer's manual for professional and experienced bicycle mechanics is available on our website (<http://si.shimano.com>).
- Do not disassemble or alter this product.

**For safety, be sure to read this user's manual thoroughly before use, and follow them for correct use.**

## Important Safety Information

Guidelines that require replacement, contact the place of purchase or a bicycle dealer.

### WARNING

- This wheel is equipped with a quick release hub to facilitate installation and removal. Failure to properly install this quick release hub (wheel) onto your bicycle may cause the wheel to become detached from the bicycle while you are riding and result in serious bodily injury.
- Use a front fork which is equipped with a wheel retention mechanism.
- BEFORE USE, CAREFULLY READ THE QUICK RELEASE USER'S MANUALS IN YOUR OWNER'S MANUAL. IF YOU HAVE ANY QUESTIONS, ASK YOUR DEALER. IMPROPER HUB INSTALLATION CAN RESULT IN SERIOUS BODILY INJURY.
- If the quick release lever is on the same side as the rotor, the quick release lever may fail to have sufficient clearance as shown in Figure 1. If the quick release lever interferes with the rotor, install the lever on the other side of the rotor. Make sure that the front fork does not interfere with the quick release lever. Adjust the quick release lever within the range specified in Figure 2. Interference of the lever with the front fork may loosen the wheel, thereby causing the wheel to become detached from the bicycle while you are riding and result in serious bodily injury.

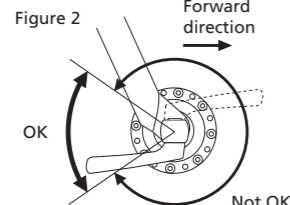
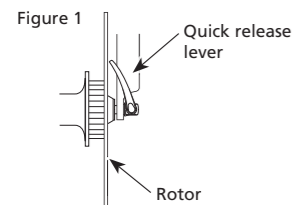

- After reading the user's manual carefully, keep it in a safe place for later reference.

### NOTICE

- Be sure to operate the quick release lever by hand only. Never use any other tool such as a hammer to tighten the quick release lever, as this could cause damage to the lever.

### Note

- Products are not guaranteed against natural wear and deterioration from normal use and aging.
- For maximum performance we highly recommend Shimano lubricants and maintenance products.

### What is a Quick Release?

It is a mechanism that uses a single quick release lever operation on the hub to enable the wheel to be easily installed and removed.

### Quick Release function

When the quick release lever is brought to the closed position, the lever nut moves inward. The force of this clamps the wheel to the frame and holds the wheel securely in place.

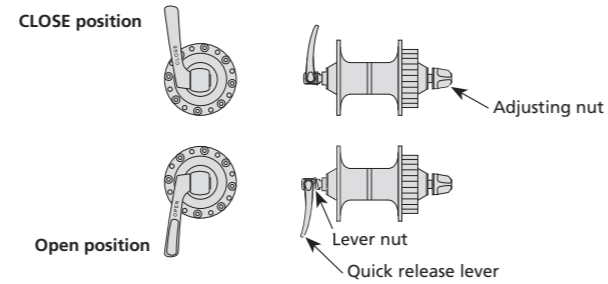

The clamping strength is adjusted by turning the adjusting nut. When the nut is turned in a clockwise direction, the clamping strength increases, and when the nut is turned in a counter-clockwise direction, the clamping strength decreases.

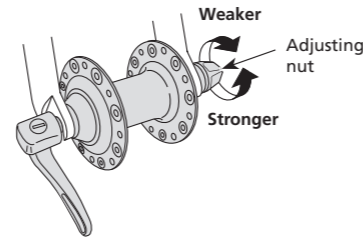

### Suitable dimensions of the fork end

Be sure to use only fork widths with suitable dimensions.

**Front ...**  
cannot use fork thicknesses less than 4 mm.  
(Dura-Ace, 600 Ultegra: not less than 5 mm.)



**Rear ...**  
cannot use fork thicknesses less than 5 mm.  
(Dura-Ace, 600 Ultegra: not less than 6 mm.)



## Operation

The front axle is explained as an example. The rear axle works in the same way.

### How to fasten this quick release hub

1. Move the quick release lever to the OPEN position and set the wheel so it firmly touches the interior of the fork end (See sketch below).

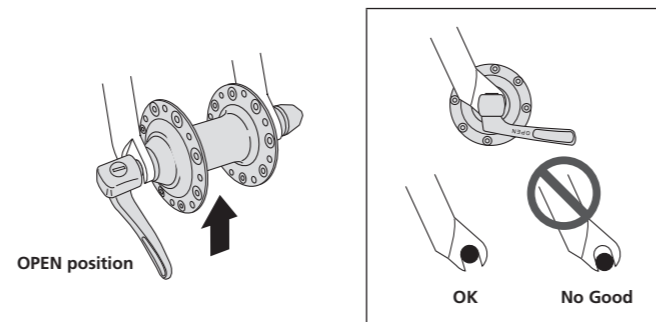

2. Open and close the quick release lever with your right hand while gradually tightening the adjusting nut with your left hand in the clockwise direction. Continue tightening the nut until you feel resistance with your hand at the point when the lever is parallel to the hub (as indicated by the dotted position in the diagram on the right).

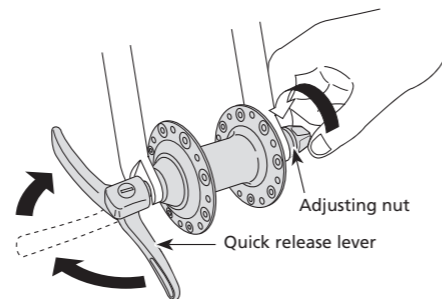

3. Grip the fork with your fingers and use the palm of your hand to close the quick release lever with as much strength as possible. When closed, the quick release lever must be in the "CLOSE" position shown below in the diagram on the right. The side of the lever with the inscription "CLOSE" must be facing away from the bicycle, and the lever should be parallel to the fork as shown below in the diagram on the left.

**Tightening torque:**  
5 - 7.5 N·m (43 - 65 in. lbs.)

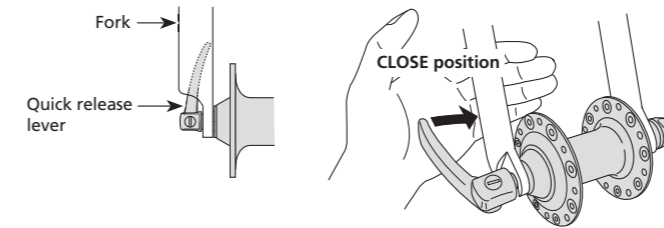

### CAUTION

Never fasten a wheel to a frame by rotating the quick release lever as shown in the diagram on the right. Simply rotating the lever in a circular motion will not fasten the wheel to the frame. Detachment of the wheel as a result of improper hub installation can result in serious bodily injury.

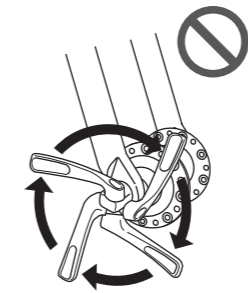

### Note

If the quick release lever can be easily pushed to the CLOSE position, this means the clamping strength is insufficient. Return the quick release lever to the position perpendicular to the bicycle frame and again turn the adjusting nut clockwise to increase the clamping length. Push the quick release lever back to the CLOSE position.

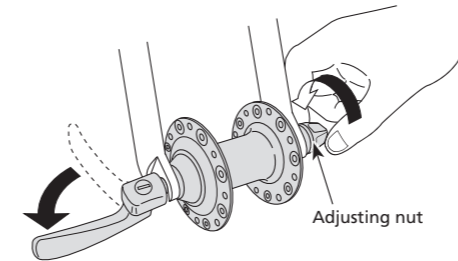

If the clamping strength is adjusted too strong and the quick release lever cannot be pushed to the CLOSE position, turn the adjusting nut in a counter-clockwise direction to reduce the clamping strength. When doing this, do not fully release the adjuster nut. Turn it 1/8 of a revolution, and then try to push the lever to CLOSE, **to set the maximum clamping strength with which you can push the quick release lever to the CLOSE position.**

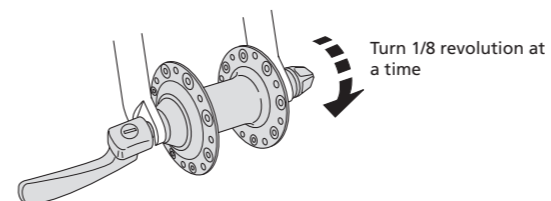

### Positioning of the quick release lever

For safety, the quick release lever should be along the bicycle frame when in the CLOSE position.

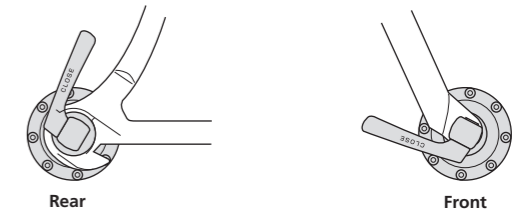

### Removing the wheel

Move the quick release lever from the CLOSE position to the OPEN position. Loosen the adjusting nut, and then remove the wheel.

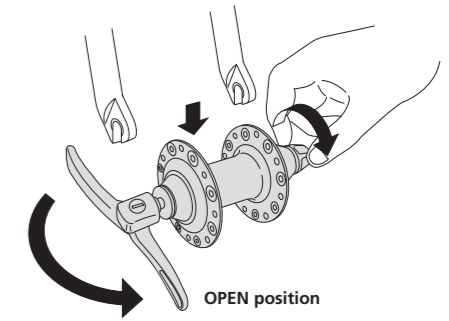

## Regular inspections before riding the bicycle

Before riding the bicycle, check the following items. If any problems are found with the following items, contact the place of purchase or a bicycle dealer.

### WARNING

#### THINGS TO CHECK BEFORE RIDING

1. Always check your quick release hubs before riding to make sure that the wheels are correctly installed on the bicycle frame. This is especially important after you park your bicycle in a public place.
2. Make sure that the quick release levers are pushed fully to the CLOSE position (the side of the lever with the inscription "CLOSE" must be facing away from the bicycle). As shown in the diagram the lever must be lifted, not rotated.

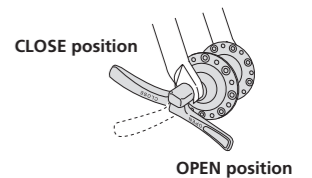

#### QUICK CHECK

Lift up the bicycle so that the wheel is off the ground, and give the top of the tire a few sharp downward blows as shown in the diagram. The wheel should not be loose or come off. **This check does not guarantee that the quick release lever has received adequate tightening torque.** If you are uncertain as to whether the quick release is tightened correctly, repeat the installation procedure as explained in "How to fasten this quick release hub" of this user's manual.

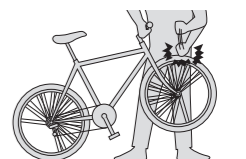

**If the quick release will not adjust properly, please contact a professional dealer for advice.**

## SHIMANO

SHIMANO AMERICAN CORPORATION  
One Holland, Irvine, California 92618, U.S.A. Phone: +1-949-951-5003

SHIMANO EUROPE B.V.  
Industrieweg 24, 8071 CT Nunspeet, The Netherlands Phone: +31-341-272222

SHIMANO INC.  
3-77 Oimatsu-cho, Sakai-ku, Sakai-shi, Osaka 590-8577, Japan

Please note: specifications are subject to change for improvement without notice. (English)  
© May 2012 by Shimano Inc. HTR 52K