

7.9 Store the unit in a dry location under the following conditions:

Temperature 60 degrees – 110 degrees F. Humidity 30% - 90%

8. Function test

8.1 With the unit turned on either the high or low setting, wait for the beep and apply a drop of water to the center of the probe. The water will begin to vibrate and atomize when functioning properly.

8.2 If the LED lights are displayed during operation, the unit should be functioning correctly.

9. Trouble Shooting

No	Problem	Possible Cause	Counter-measure
1	No front panel display and the unit does not work.	AC/DC adaptor is not connected to the electrical wall outlet.	Re-insert plug.
		Wrong AC/DC power adaptor is used.	Replace with the specified AC/DC adaptor.
2	LED "OFF" flickers and unit will not work normally.	AC/DC adaptor is not connected to the electrical wall outlet.	Re-insert plug.
		Wrong AC/DC power adaptor is used.	Replace with the specified AC/DC adaptor.
		Unit overheats when turned on and left idle.	Turn the unit off and wait 10 minutes before using again.
3	Discomfort on skin after usage.	Skin is sensitive to the conductive gel.	Discontinue use and contact your health professional.

Attention: Repairing Unit;

Do not attempt to repair, disassemble, or modify the unit by yourself. You may injure yourself as a result of fire or abnormal operation. If the unit and/or AC/DC power adaptor cord/plug is damaged, discontinue use immediately. Bring the unit to the nearest authorized replacement center or qualified repair technician for repair or replacement. If repair is done by non-qualified personnel, extreme hazards such as fire can result under normal operation.

10. Prescription Statement

Caution: Federal law restricts this device to sales by or on the order of a practitioner licensed by law in the state in which he/she practices, according to 21 CFR 801.109.

11. Specifications

Item	Ultrasound Device
Voltage	Input 100VAC/110VAC/220VAC/240VAC: Output 12.0 VDC
Working Voltage	12.0VDC
Power Consumption	Approximately 5 Watts
Ultrasound Frequency	1 MHZ 3 MHZ 5 MHZ
Auto Shutoff	10 +/- 1 minutes
Unit Size	172X55X55 for main unit, Probe diameter 36 MM
Unit Weight	110 Grams
Beep Alarm	2 beeps every 9 seconds for "High" setting. 1 Beep every 9 seconds for "Low" setting.
Operating Limits	Temperature: 10 deg C – 40 deg C Humidity: 30% - 90%
Storage Limits	Temperature: -20 deg C – 60 deg C Humidity: 30% - 90%

Specifications are subject to change without notice for purposes of improvement.

12. Warranty

This ultrasound device is warranted to be free from defects in materials and workmanship for a period of two (2) years from date of purchase.

If the device exhibits such a defect, the unit should be taken to an authorized repair dealer for examination before returning it for repair or replacement.

This warranty does not cover damage to the finish nor damage resulting from accident, misuse, neglect, dirt, water, temperature, unreasonable use, servicing performed or attempted by unauthorized personnel or units that have been modified.

Assembled in USA

THANK YOU FOR YOUR PURCHASE

100% Satisfaction Guaranteed



Phone: 440-353-2830

www.brace-mart.com



**Premium Portable
Ultrasound
Model Numbers
SPU-1000 SPU-3000
SPU-5000
User Manual**



Phone: 440-353-2830

www.brace-mart.com



Before operating the unit, Please read this manual completely and retain it for future reference.

Table of Contents:

- 1. Important Safety Instructions - 1
- 2. Intended Use - 2
- 3. Safety Precautions - 2
- 4. Parts of Body to Avoid - 2
- 5. Medical Conditions - 3
- 6. Part Identification - 3
- 7. Device Usage - 3
- 8. Function Test - 4
- 9. Trouble Shooting - 4
- 10. Prescription Statement - 4
- 11. Specifications - 5
- 12. Warranty - 5

1. Important Safety Instructions

1.1 IMPORTANT: Please read the safety instructions before using this product. The safety instructions explained here are to help you use this product safely and correctly. It will also prevent injury to yourself and others.

1.1.1 Keep this manual for future reference and technical information.

1.1.2 WARNING: Indicates contents which may lead to death or serious injury.

1.1.3 CAUTION: Indicates contents which may lead to serious injuries or damage to property.

1.1.4 After reading these instructions, store the manual where it is accessible to user(s).

1.2 WARNING:

1.2.1 Remove the plug of the AC/DC adapter from the outlet when not in use. Always grasp the plug while removing and never remove by pulling on the cord. Failure to do so may lead to fire and or an accident.

1.2.2 Do not cut, damage, or modify the AC/DC adaptor cord. Do not pull, twist or band the cord with unnecessary force. Do not place heavy objects on the cord or allow the cord to get pinched between objects. Do not wind the cord around the product. These actions may cause fire and/or electric shock. If the cord is damaged or generates heat discontinue use immediately to prevent fire, electric shock, short circuit and/or burns.

1.2.3 Do not use near flammable materials such as benzene, paint thinner, sprays, etc. They can cause an explosion or fire.

1.2.4 Do not handle the AC/DC power adaptor while your hands are wet. It may cause electric shock and/or a short circuit.

1.2.5 Do not place or store the AC/DC power adaptor near places where it could be exposed to water such as bathtubs, washbasins, other containers and areas of high humidity. Do not submerge the AC/DC power cord in water. These actions could cause electric shock and/or short circuit.

1.2.6 Keep the unit away from children. Do not let them use or play with the unit. Allowing children to play with the unit may result in burns, electric shock or other injuries.

1.3 CAUTION:

1.3.1 Do not use the unit other than for intended purposes.

1.3.2 Do not use the AC/DC power adaptor supplied with the product if you have damaged it by dropping or knocking it. This may cause electric shock and/or fire.

1.3.3 Do not use thinner, benzene, or other solvents to clean the unit as it may damage the unit.

1.3.4 Do not use the AC/DC power adaptor supplied with the unit when exposed to direct sunlight, heat or excessive moisture.

1.3.5 Use only the AC/DC power adaptor supplied with the unit.

1.3.6 Do not use an extension cord to connect the AC/DC power adaptor to an electrical wall outlet.

1.3.7 Do not submerge the unit.

1.3.7 Store the AC/DC power adaptor and its cord in a dry place.

2. Intended Use

2.1.1 This ultrasound device generates deep heat within the body tissues for the treatment of selected medical conditions such as pain relief and muscle spasms.

2.1.2 This ultrasound device can also be used in the treatment of facial conditions such as wrinkles to improve personal appearance.

3. Safety Precautions

3.1 Although ultrasound therapy is generally very safe, operators of ultrasound devices must take all necessary precautions to minimize exposure to their patients and themselves to avoid any potential adverse health effects.

3.2 Ensure that the applicator is facing away from people and only onto the application site when in operation. The applicator must be kept moving slowly in a circular motion to prevent hot spots and burns on the skin.

3.3 If any pain is felt, stop treatment immediately.

4. Parts of the Body to Avoid

4.1 Ultrasound should not be used over the skin where organs or mucous membranes are located including the following: Heart, Lungs, Kidneys, Liver, Bowels, Vagina, Ovaries, Testes, Rectum, Brain, Spinal Cord, Nose, Eyes and Mouth.

4.2 Pregnant women should not expose their abdomen or lower back region to ultrasound waves as they may harm the fetus.

5. Medical Conditions

5.1 Ultrasound therapy should not be used if certain medical conditions exist including but not limited to: Severe Arterial Insufficiency, Cardiac Disease, Deep Vein Thrombosis, Spina Bifida, Bone Infections and Bleeding Disorders.

5.2 Ultrasound should not be used on growth plates of children, as it may affect their potential growth.

5.3 People with metal implants such as pacemakers should not use ultrasound in that area of the body.

6. Part Identification

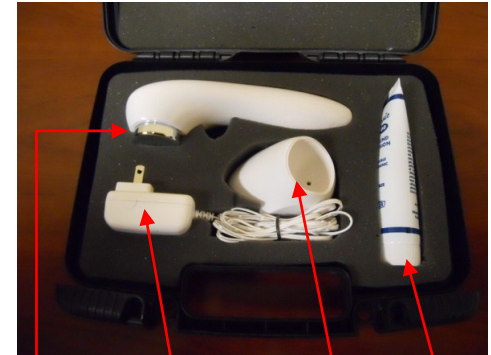

[Main Unit] [AC/DC Power Adaptor] [Holder] [Transmission Gel]

7. Device Usage

7.1 Connect the AC/DC power adaptor to the main unit.

7.2 Plug the AC/DC power unit into an electrical wall outlet.

7.3 Apply an appropriate amount of conductive gel on the probe and area to be treated.

7.4 Press the select button to turn the unit on the high setting (suggested for normal use). Press the select button again to obtain the low setting. Continue to press the select button to turn the main unit off.

7.5 During operation the unit will beep twice every 9 seconds when on the high setting and once every 9 seconds when on the low setting.

7.6 The unit will turn off automatically after 10 minutes of continuous usage.

7.7 When using the ultrasound unit for facial treatment, limit treatment to 10 minutes per application, 3 times per week to prevent skin damage.

7.8 When done with treatment, wipe the probe with a clean damp cloth or tissue. Do not use coarse fabric on the unit. Dry the unit immediately with a clean cloth.